

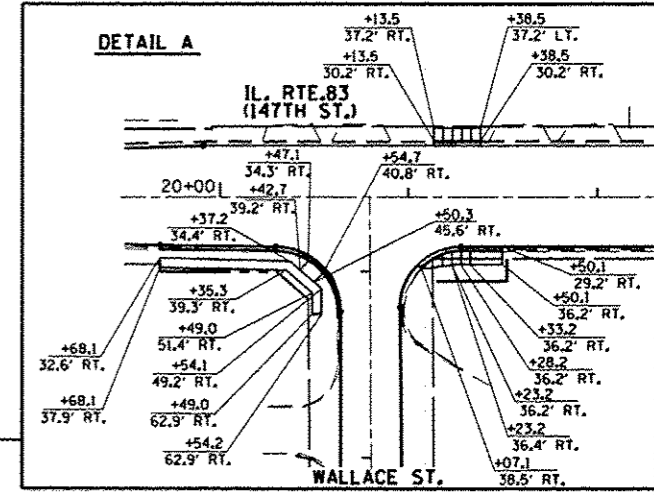

IL. ROUTE 83  
(147TH STREET)

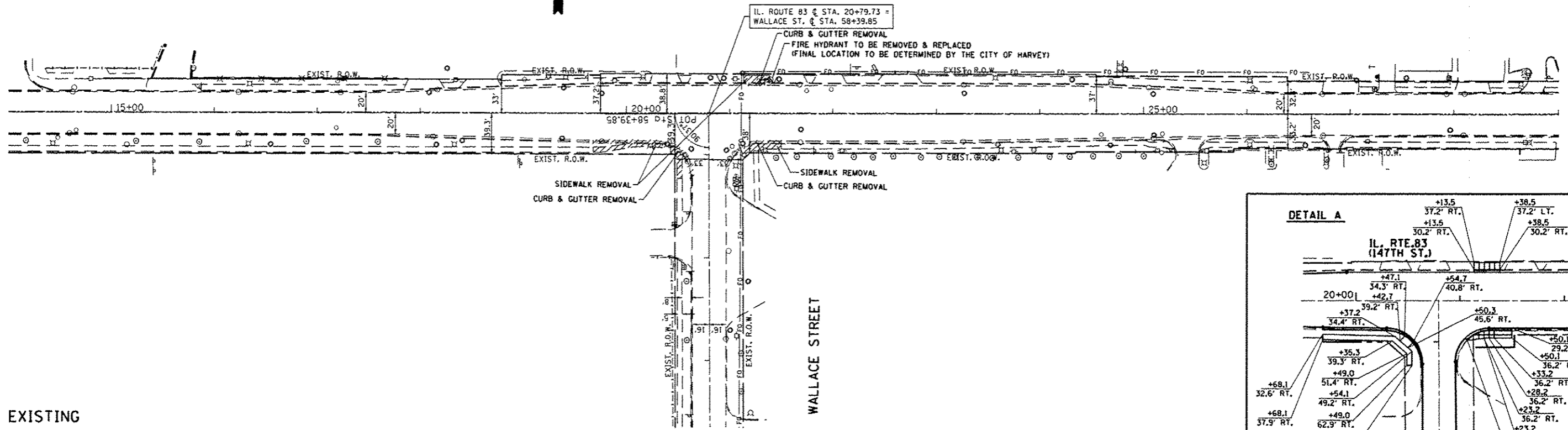

EXISTING



IL. ROUTE 83  
(147TH STREET)

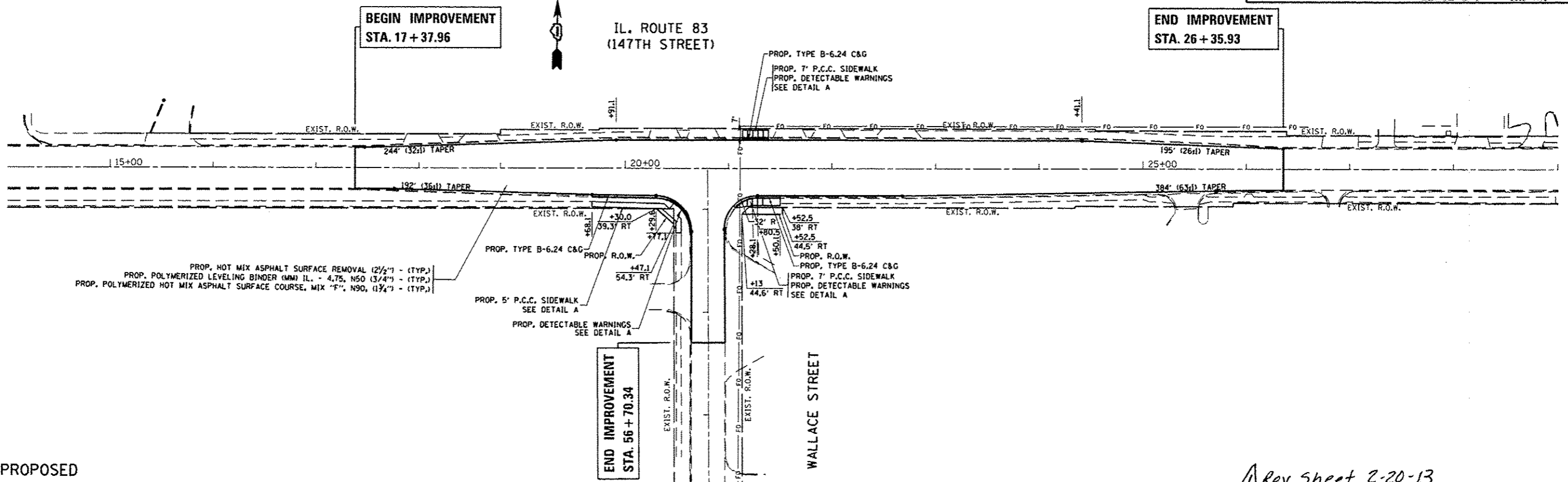

BEGIN IMPROVEMENT  
STA. 17 + 37.96

END IMPROVEMENT  
STA. 26 + 35.93

END IMPROVEMENT  
STA. 56 + 70.34

PROPOSED

Rev. Sheet 2-20-13

FILE NAME *	USER NAME * guilleumefp	DESIGNED -	REVISED -	<b>STATE OF ILLINOIS DEPARTMENT OF TRANSPORTATION</b>	<b>ROADWAY PLAN IL. RTE. 83 AT WALLACE ST.</b>	F.A.P. RTE.	SECTION	COUNTY	TOTAL SHEETS	SHEET NO.	
0:\pwork\pwork\guilleumefp\03071419	3609-shr-plan.dgn	DRAWN -	REVISED -			397	1047S-1(12)	COOK	30	8	
PLOT SCALE * 1/8"=1'-0"		CHECKED -	REVISED -			CONTRACT NO. 60T92					
*MODELNAME*	PLOT DATE * 1/28/2013	DATE -	REVISED -			ILLINOIS FED. AID PROJECT					