

MATCHLINE 81+50

WILLOW RD.

EXIST. R.O.W.

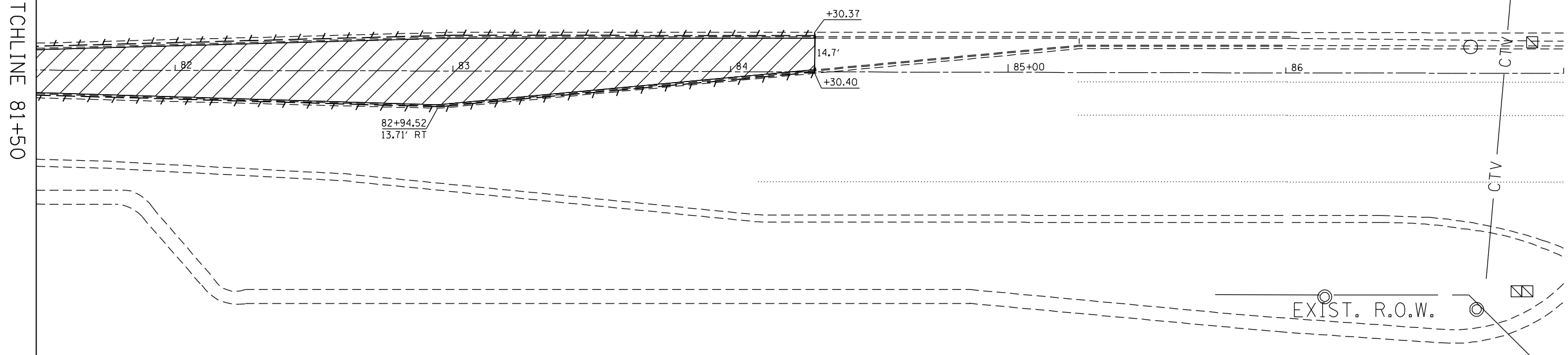

FILE NAME : P:\2011\ME11007_Ver-Var-Phil\CADD\W08_Willow_Rd\Shets\DI60W04-sh1-Rem-02.DGN
 PLOT SCALE : 48.0000' = 1" IN.
 USER NAME : Millennium Professional Services



200 22ND Street, Suite 216, Lombard, IL 60148
 630.705.0110 voice, 630.839.2566 fax
 www.mps-ll.com
MILLENNIA PROFESSIONAL SERVICES

DESIGNED - TVN	REVISED -
DRAWN - MJW	REVISED -
CHECKED - TVN	REVISED -
DATE - 12/26/2012	REVISED -

STATE OF ILLINOIS
DEPARTMENT OF TRANSPORTATION

WILLOW ROAD

EXISTING PLAN
AND REMOVALS

F.A.P. RTE.	SECTION	COUNTY	TOTAL SHEETS	SHEET NO.
305	1920.01-B-R	COOK	60	8
FED. ROAD DIST. NO. 1 [ILLINOIS] FED. AID PROJECT			CONTRACT NO. 60W04	

SCALE: SHEET NO. OF SHEETS STA. TO STA.

P:\2011\ME11007_Ver-Var-Phil\CADD\W08_Willow_Rd\Shets\DI60W04-sh1-Rem-02.DGN