

ELEVATION

(Looking East)

(Dimensions shown are at right angle to \perp roadway unless noted)

* a_{107} bars in skew portion at north end of slab shall be ordered full length and cut to fit. Balance of bar to be used in opposite end of culvert.

** Cut bars in field to fit

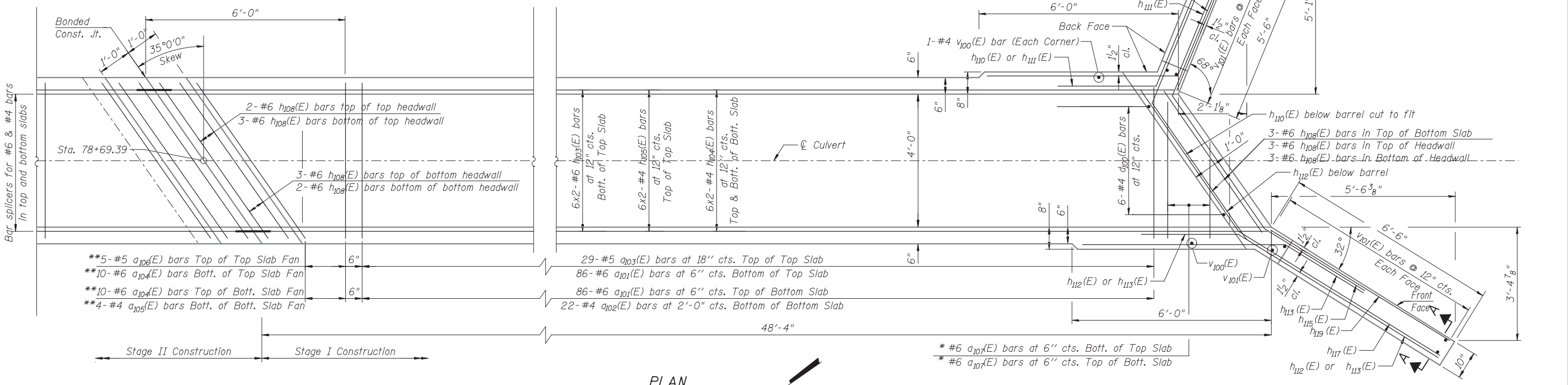

PLAN

Notes:

1. For notes, see Sheet S2-05.

HBM
ENGINEERING GROUP, LLC
CONSULTING & DESIGN
INSPECTION & RATING
RESEARCH & TESTING

4415 WEST HARRISON ST.
SUITE 231
HILLSIDE, IL 60162
PHONE: (708) 236-0900
FAX: (708) 236-0901

DESIGNED - MI, LAB
CHECKED - MI
DRAWN - WM, AI
CHECKED - MAI, MI

REVISED -
REVISED -
REVISED -
REVISED -

**STATE OF ILLINOIS
DEPARTMENT OF TRANSPORTATION**

**PLAN AND ELEVATION II
BOX CULVERT (4'-0" x 2'-6") - STA. 78 + 69.39**

SHEET NO. S2-06 OF S2-10 SHEETS

F.A.P. RTE.	SECTION	COUNTY	TOTAL SHEETS	SHEET NO.
305	1920.01-B-R	COOK	60	42
CONTRACT NO. 60W04			ILLINOIS FED. AID PROJECT	

DATE - 12/24/2012