

LEGEND

- MEDIAN REMOVAL
- BARRIER MEDIAN REMOVAL
- CONCRETE MEDIAN REMOVAL
- SELECTIVE CLEARING
- TREE REMOVAL
- PAVEMENT REMOVAL
- R.O.W. NOT YET ACQUIRED
- PROPOSED STORM SEWER
- EXISTING STORM SEWER
- STORM SEWER TO BE PLUGGED AND ABANDONED (REMOVED IN FUTURE CONTRACT)
- TREE TO BE REMOVED
- STORM STRUCTURE TO BE ADJUSTED
- SIGN TO BE REMOVED
- PROPOSED MANHOLE
- FUTURE STORM SEWER

SEE SHEET P-17
MATCH LINE STA. 117+50.00

MATCH LINE STA. 123+50.00
SEE SHEET P-19

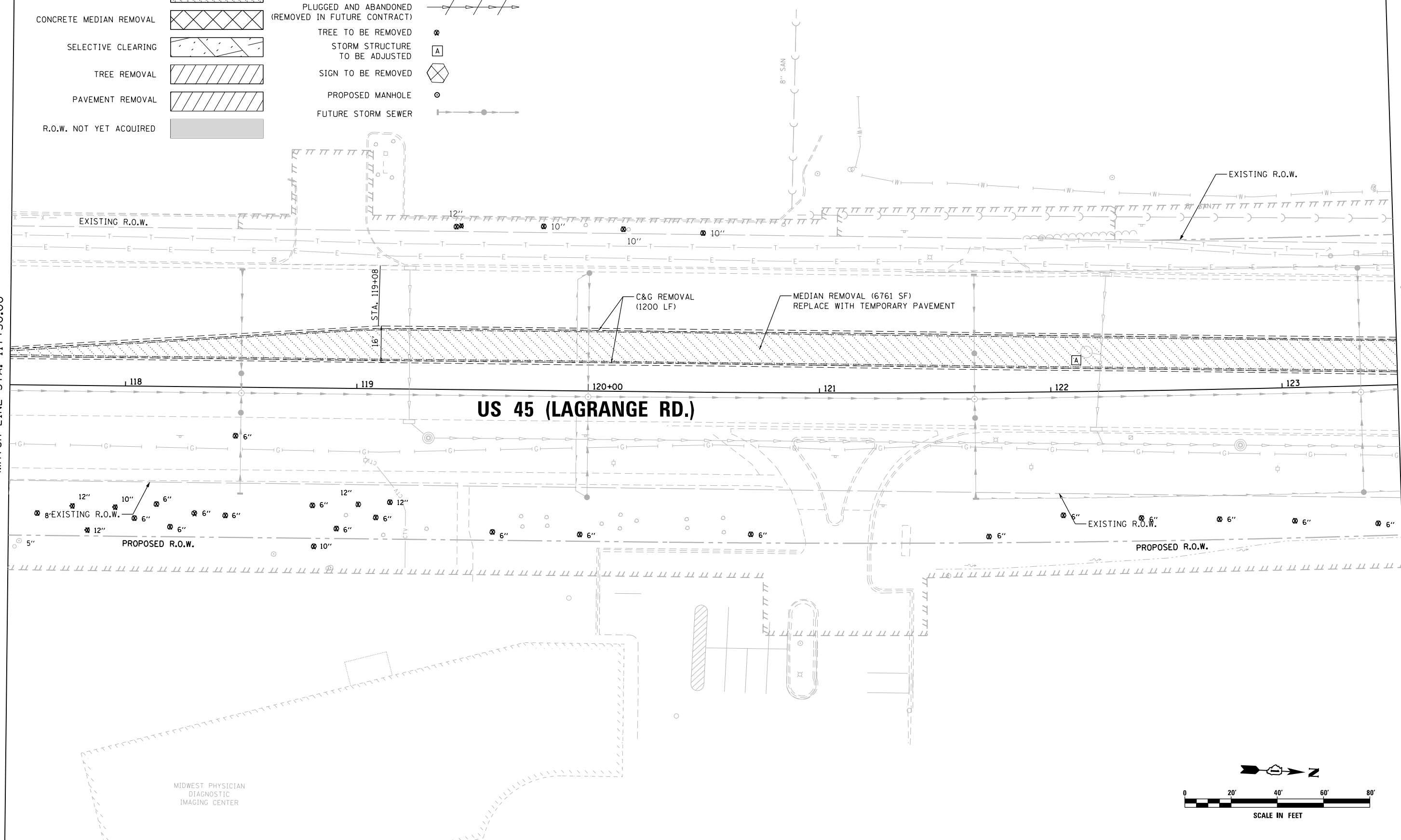

US 45 (LAGRANGE RD.)

MIDWEST PHYSICIAN
DIAGNOSTIC
IMAGING CENTER

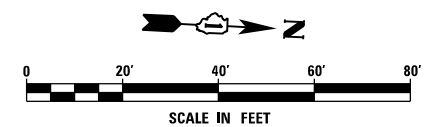

URS
100 S. WACKER DR.
SUITE 600
CHICAGO, IL 60606
TEL (312) 939-1000
FAX (312) 939-4998

FILE NAME = D160W07-SHT-PLAN18.dgn	USER NAME = Frank.Stallone	DESIGNED - MGS	REVISED -	STATE OF ILLINOIS DEPARTMENT OF TRANSPORTATION	REMOVAL, TEMPORARY PAVEMENT, AND DRAINAGE PLAN			F.A.P. RTE. 330	SECTION 2012-0861	COUNTY COOK	TOTAL SHEETS 98	SHEET NO. 33
SHT.PLAN	PLOT SCALE = 40.0000' / in.	CHECKED - JRS	REVISED -		SCALE: 1"=20'	SHEET 18 OF 26 SHEETS	STA. 117+50.00 TO STA. 123+50.00	P-18		CONTRACT NO. 60W07		
	PLOT DATE = 1/7/2013	DATE - 01/02/13	REVISED -		ILLINOIS FED. AID PROJECT							