

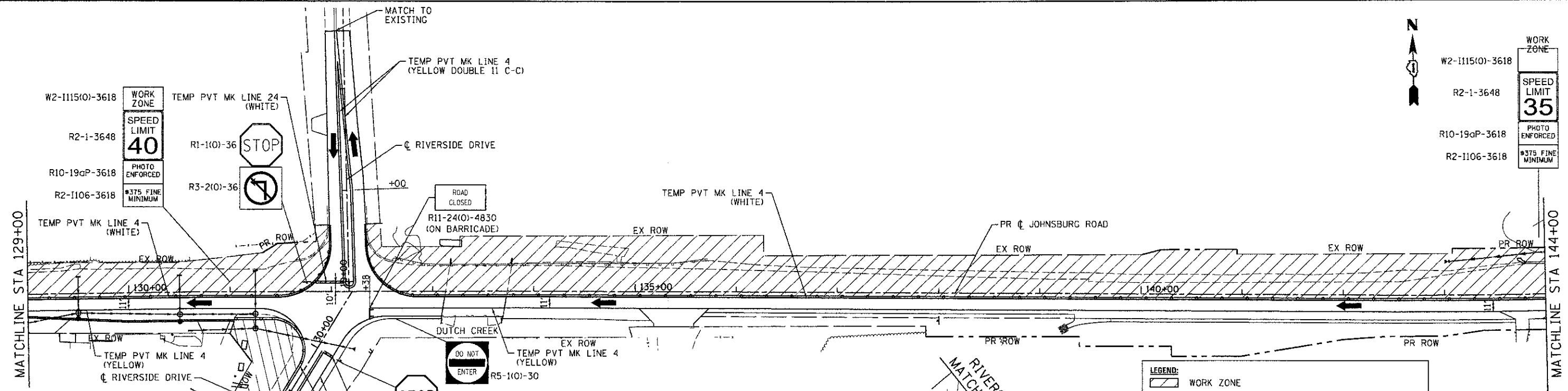

WORK ZONE	W2-1115(0)-3618
SPEED LIMIT	R2-1-3648
PHOTO ENFORCED	R10-19aP-3618
#375 FINE MINIMUM	R2-1106-3618



LEGEND:

- WORK ZONE
- TEMPORARY PAVEMENT
- DIRECTION OF TRAFFIC
- TYPE III BARRICADE W/TWO(2) FLASHING LIGHTS
- TEMPORARY CONCRETE BARRIER
- MAINTENANCE OF TRAFFIC SIGN
- TYPE II BARRICADES OR DRUMS WITH STEADY BURNING LIGHTS @ 50 FT CENTERS ALONG ROADWAY TANGENTS, 25 FT CENTERS ALONG TAPERS, AND 12 FT CENTERS ALONG RADII
- VERTICAL PANEL WITH STEADY BURNING LIGHT 50 FT C-C

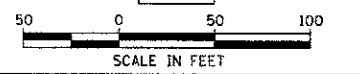
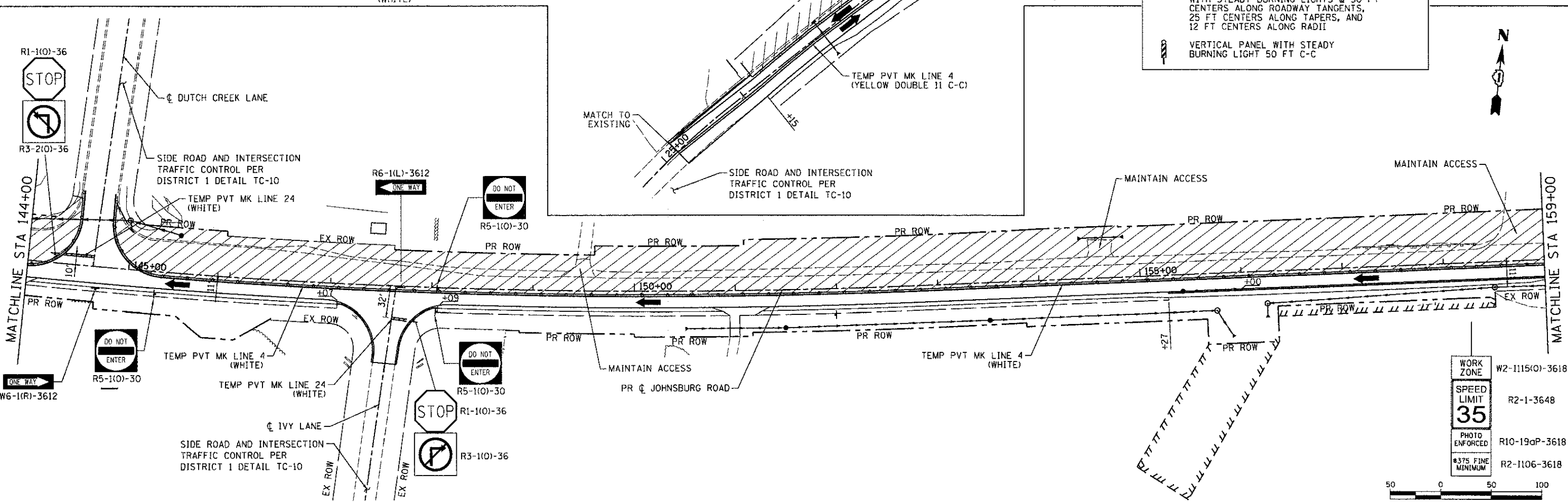

WORK ZONE	W2-1115(0)-3618
SPEED LIMIT	R2-1-3648
PHOTO ENFORCED	R10-19aP-3618
#375 FINE MINIMUM	R2-1106-3618

12/19/2012 2:27:44 PM
 CLIENT: MCHENRY COUNTY
 FILE NAME: 080622-mo12-r2.dgn
 PLOT DRIVER: perf.ctb, no, bw, plot, cto
 PEN TABLE: standard.ctb



USER NAME = jettano	DESIGNED -	REVISED -
FILE NAME = 080622-mo12-r2.dgn	DRAWN -	REVISED -
PLOT SCALE = 1" = 50'	CHECKED - TH	REVISED -
PLOT DATE = 12/19/2012	DATE - 12/19/12	REVISED -

**MCHENRY COUNTY
 DIVISION OF TRANSPORTATION**

**SUGGESTED MAINTENANCE OF TRAFFIC - STAGE 2
 JOHNSBURG ROAD**

SCALE: 1" = 50' SHEET NO. 9 OF 10 SHEETS STA. TO STA.

F.A.U. RTE.	SECTION	COUNTY	TOTAL SHEETS	SHEET NO.
168	05-00314-00-WR	MCHENRY	187	32
CONTRACT NO. 63515				
FED. ROAD DIST. NO. ILLINOIS FED. AID PROJECT				