

TRAFFIC SIGNAL NOTES

- IT SHALL BE THE CONTRACTOR'S RESPONSIBILITY TO VERIFY ALL DIMENSIONS AND CONDITIONS EXISTING IN THE FIELD PRIOR TO ORDERING MATERIALS AND BEGINNING CONSTRUCTION. THIS SHALL INCLUDE LOCATING THE MAST ARM FOUNDATIONS AND VERIFYING THE MAST ARM LENGTHS.
- THE EXACT LOCATION OF ALL UTILITIES SHALL BE FIELD VERIFIED BY THE CONTRACTOR BEFORE ORDERING ANY MATERIALS AND STARTING ANY WORK. FOR LOCATIONS OF UTILITIES, LOCALLY OWNED EQUIPMENT, LEASED ENFORCEMENT CAMERA SYSTEM FACILITIES AND IDOT UNDERGROUND FACILITIES, CONTACT THE LOCAL COUNTIES, MUNICIPALITIES AND IDOT FOR LOCATES. THE CONTRACTOR SHALL CALL 'JULIE' AT (800) 892-0123 OR 811, IN THE CITY OF CHICAGO CONTACT DIGGER AT (312) 744-7000 FOR FIELD LOCATIONS OF BURIED UTILITIES (48 HOURS NOTIFICATION REQUIRED).
- THE CONTRACTOR SHALL CHECK THE PROPOSED TRAFFIC SIGNAL EQUIPMENT LOCATIONS FOR OVERHEAD UTILITY CONFLICTS. THE CONTRACTOR SHALL COORDINATE ANY CONFLICTS WITH THE UTILITY COMPANIES AND THE RESIDENT ENGINEER BEFORE ORDERING MATERIALS.
- THE CONTRACTOR SHALL COORDINATE CONSTRUCTION ACTIVITIES WITH UTILITY COMPANIES, LOCAL GOVERNMENT AGENCIES AND IDOT.
- PORTABLE CHANGEABLE MESSAGE SIGNS SHALL BE PRESENT ON THE BARRINGTON ROAD APPROACHES TO THE INTERSECTION, AND SHALL BE OPERATIONAL ONE WEEK IN ADVANCE AND ONE WEEK FOLLOWING THE SIGNAL TURN-ON. THE MESSAGE ON THE SIGNS SHALL INCLUDE THE DATE ON WHICH THE SIGNAL WILL BE TURNED ON.

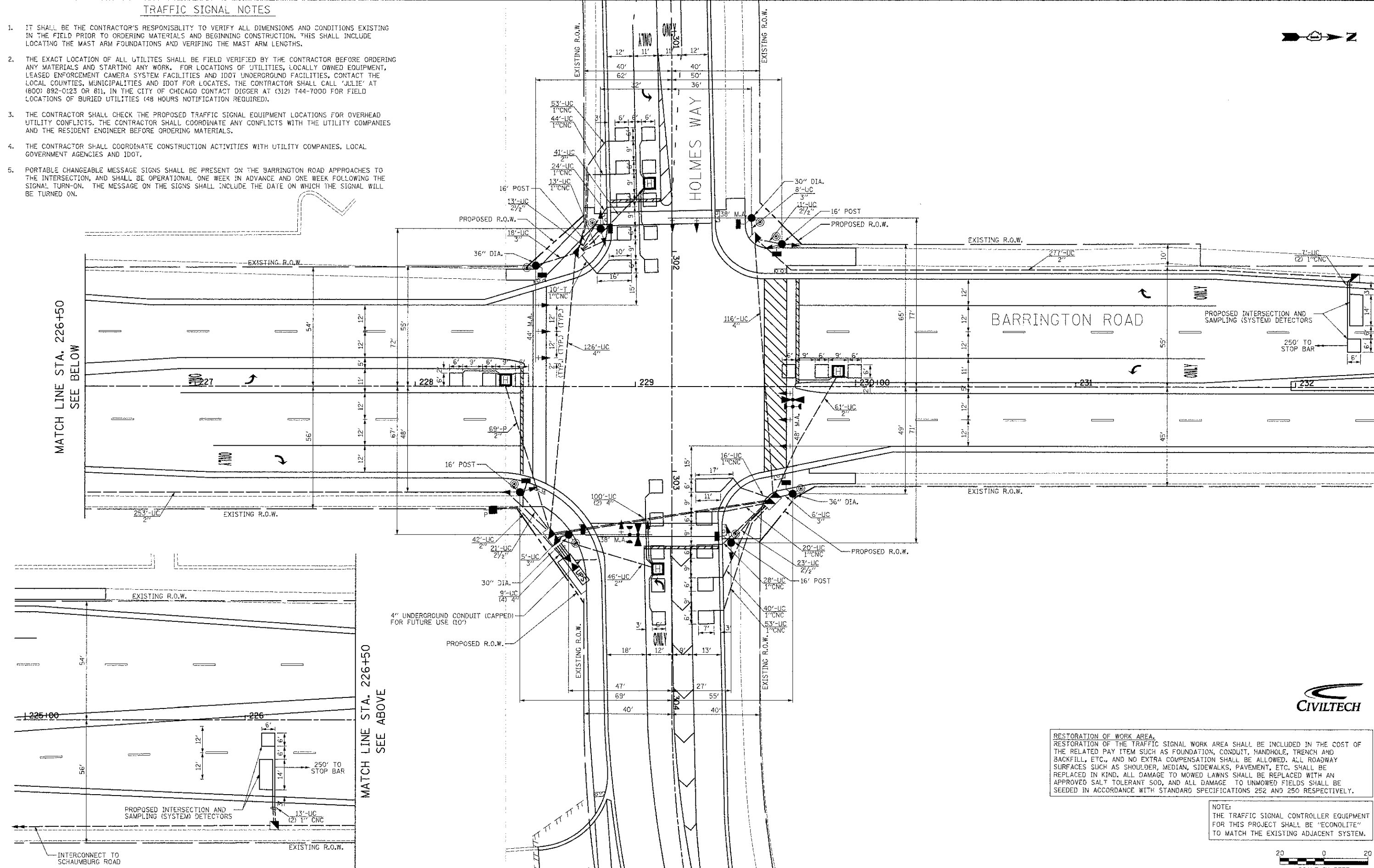

RESTORATION OF WORK AREA.  
 RESTORATION OF THE TRAFFIC SIGNAL WORK AREA SHALL BE INCLUDED IN THE COST OF THE RELATED PAY ITEM SUCH AS FOUNDATION, CONDUIT, HANDHOLE, TRENCH AND BACKFILL, ETC., AND NO EXTRA COMPENSATION SHALL BE ALLOWED. ALL ROADWAY SURFACES SUCH AS SHOULDER, MEDIAN, SIDEWALKS, PAVEMENT, ETC. SHALL BE REPLACED IN KIND. ALL DAMAGE TO MOWED LAWNS SHALL BE REPLACED WITH AN APPROVED SALT TOLERANT SOD, AND ALL DAMAGE TO UNMOWED FIELDS SHALL BE SEEDED IN ACCORDANCE WITH STANDARD SPECIFICATIONS 252 AND 250 RESPECTIVELY.

NOTE:  
 THE TRAFFIC SIGNAL CONTROLLER EQUIPMENT FOR THIS PROJECT SHALL BE "ECONOLITE" TO MATCH THE EXISTING ADJACENT SYSTEM.

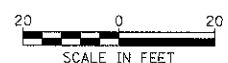

FILE NAME = ...106_Barrington-Holmes Sig Inst Plan.dwg	USER NAME = djjk	DESIGNED - BRD	REVISED -	<b>STATE OF ILLINOIS DEPARTMENT OF TRANSPORTATION</b>	<b>TRAFFIC SIGNAL INSTALLATION PLAN BARRINGTON ROAD AND HOLMES WAY</b>	F.A.U. RTE. 1322	SECTION 01-00074-GO-CH	COUNTY COOK	TOTAL SHEETS 245	SHEET NO. 132
PLOT SCALE = 20.0000' / 1" =	CHECKED - JJE	REVISI	REVISI			CONTRACT NO. 63629				
PLOT DATE = 8/17/2012	DATE - 8-20-12	REVISI	REVISI			FED. ROAD DIST. NO. 1 ILLINOIS	FED. AID PROJECT W-CMA-80030501			
						SCALE: 1" = 20'	SHEET NO. 1 OF 1 SHEETS	STA. TO STA.		