

CONTRACT NO. 63629				
County	Year	Sheet	Total	
Cook	1994	181	245	
05-00350-00-CH				

NOTES (SUPPLEMENTAL TO I.D.O.T. STANDARDS)

STANDARDS 60610, 60620 AND 60605 - TYPE A CUTTER, TYPE B GUTTER AND OUTLET FOR CURB AND GUTTER

TIE BARS SHALL BE NO. 15 (NO. 5) SPACED AT 750 mm (30 IN.) CENTERS.

CONCRETE INLETS, ENTRANCES AND OUTLETS FOR GUTTER OR COMBINATION CURB AND GUTTER SHALL BE PAID FOR AT THE CONTRACT UNIT PRICE PER METER (FOOT) FOR THE PARTICULAR TYPE OF GUTTER OR COMBINATION CURB AND GUTTER SPECIFIED.

STANDARD 60600 - CURB AND COMBINATION CURB AND GUTTER

TYPE	A	B	C	D	R
B-V-30	300	50	125	VARIES	25
B-V-121	121	21	151		11
B-V-15	450	50	125	VARIES	25
B-V-181	181	21	151		11
B-V-60	600	50	125	VARIES	25
B-V-241	241	21	151		11

VARIABLE CURB AND GUTTER SHALL BE CONSTRUCTED WITH THE HEIGHT OF CURB VARYING BETWEEN 100 mm (4 IN.) AND 225 mm (9 IN.) AS REQUIRED. THE TOP OF CURB ELEVATION SHALL BE DETERMINED BY THE ENGINEER.

LONGITUDINAL JOINT TIE BARS SHALL BE NO. 15 (NO. 5) SPACED AT 750 mm (30 IN.) CENTERS. AT THE CONTRACTOR'S OPTION, TIE BARS MAY BE BENT AT RIGHT ANGLES AGAINST THE EDGE OF THE CONCRETE PAVEMENT AND STRAIGHTENED INTO FINAL POSITION BEFORE THE CURB AND GUTTER IS PLACED, SUBJECT TO THE APPROVAL OF THE ENGINEER.

WHERE EXISTING CURB AND GUTTER IS TO BE REMOVED AND REPLACED ADJACENT TO EXISTING CONCRETE PAVEMENT REMAINING IN PLACE, THE CONTRACTOR SHALL PERFORM THE REMOVAL SO THAT THE EXISTING TIE BARS CAN BE USED IN TYING THE NEW CURB AND GUTTER TO THE EXISTING PAVEMENT. ANY TIE BARS WHICH ARE DAMAGED OR MISSING SHALL BE REPLACED WITH NO. 20 (NO. 6) TIE BARS, 600 mm (24 INCHES) LONG, EMBEDDED 200 mm (8 INCHES) AT 600 mm (24 INCH) CENTERS IN ACCORDANCE WITH THE ARTICLE 420.10 (B) OF THE STANDARD SPECIFICATIONS. THE COST OF FURNISHING AND INSTALLING THE TIE BARS SHALL BE CONSIDERED AS INCLUDED IN THE CONTRACT UNIT PRICE FOR THE PARTICULAR TYPE OF CURB AND GUTTER SPECIFIED.

THE DEPTH OF THE CURB OR COMBINATION CURB AND GUTTER SHALL BE EQUIVALENT TO THE DEPTH OF THE ADJACENT PAVEMENT, REGARDLESS OF PAVEMENT COMPOSITION.

STANDARD 353001 - PCC BASE WITH HOT MIX ASPHALT BINDER AND SURFACE COURSE

TIE BARS SHALL BE NO. 15 (NO. 5) SPACED AT 750 mm (30 IN.) CENTERS.

STANDARD 420001 - PAVEMENT JOINTS

JOINTS AND REINFORCEMENT BARS SHALL BE PLACED IN ACCORDANCE WITH THE P.C. CONCRETE PAVEMENT DETAIL SHOWN ON THIS SHEET.

LONGITUDINAL CONSTRUCTION JOINTS SHALL BE CONSTRUCTED IN ACCORDANCE WITH THE DETAIL SHOWN ON THIS SHEET. AT THE CONTRACTOR'S OPTION, TIE BARS MAY BE BENT AT RIGHT ANGLES AGAINST THE TYPE C METAL JOINT AND STRAIGHTENED INTO FINAL POSITION BEFORE THE ADJACENT CONCRETE PAVEMENT POUR, SUBJECT TO THE APPROVAL OF THE ENGINEER.

TIE BARS SHALL BE NO. 15 (NO. 5).

TRANSVERSE SAWED CONTRACTION JOINTS, TRANSVERSE CONSTRUCTION JOINTS AND JOINTS AT CONTRACT TERMINALS SHALL BE CONSTRUCTED IN ACCORDANCE WITH THE DETAILS SHOWN ON THIS SHEET.

STANDARD 420701 - PAVEMENT FABRIC

PAVEMENT FABRIC DEPTH SHALL BE IN ACCORDANCE WITH THE DETAIL SHOWN ON THIS SHEET.

DISREGARD ALL DETAILS AND NOTES REGARDING PAVEMENTS BLOCK-OUTS, AND COMPLY WITH STANDARD 42011-P.C.C. PAVEMENT ROUNDOUTS AT ALL DRAINAGE/UTILITY STRUCTURE LOCATIONS.

STANDARD 442101 - CLASS B PATCHES

IF A SAWED LONGITUDINAL JOINT IS REQUIRED, TIE BARS SHALL BE NO. 15 (NO. 5) SPACED AT 750 mm (30 IN.) CENTERS.

STANDARD 442201 - CLASS C AND D PATCHES

CLASS C PATCHES SHALL BE TIED TO THE EXISTING PAVEMENT ALONG ALL SIDES OF THE PATCH WITH NO. 20 (NO. 6) TIE BARS, 600 mm (24 INCHES) LONG, EMBEDDED 200 mm (8 INCHES) AT 600 mm (24 INCH) CENTERS IN ACCORDANCE WITH ARTICLE 420.10 (B) OF THE STANDARD SPECIFICATIONS. MINIMUM 3 BARS ON EACH SIDE. THE COST OF FURNISHING AND INSTALLING THE TIE BARS SHALL BE CONSIDERED AS INCLUDED IN THE CONTRACT UNIT PRICE FOR CLASS C PATCHES.

ALL GUARDRAIL AND TRAFFIC BARRIER TERMINAL STANDARDS

HOT MIX ASPHALT SHOULDERS 150 mm (6 IN.) SHALL BE PLACED UNDERNEATH THE ENTIRE LENGTH OF ALL PROPOSED GUARDRAIL AND TRAFFIC BARRIER TERMINALS AND EXTEND 0.6 (12 FT.) BEYOND THE TERMINAL ENDS. THE WIDTH OF THE SHOULDER SHALL EXTEND ONE FOOT BEYOND EITHER SIDE OF THE POSTS FOR THE GUARDRAIL AND TRAFFIC BARRIER TERMINALS AND AS SHOWN ON THE PLANS. EARTH EXCAVATION NECESSARY FOR PLACEMENT OF THE SHOULDER SHALL BE CONSIDERED AS INCLUDED IN THE CONTRACT UNIT PRICE FOR HOT MIX ASPHALT SHOULDER, 11-19.8, 13B 164.

NOTE:  
THE INTENT OF THIS STANDARD IS TO REFLECT ADDITIONS OR VARIATIONS TO I.D.O.T. STANDARDS CONTAINED IN THE PLANS. THIS STANDARD SHALL GOVERN OVER THE I.D.O.T. STANDARDS.

DETAIL NOTES  
SEE I.D.O.T. STANDARDS FOR DETAILS NOT SHOWN.  
ALL DIMENSIONS ARE IN MILLIMETERS (INCHES) UNLESS OTHERWISE SHOWN.  
ALL TIE BAR SIZES ARE METRIC (STANDARD)  
t = PAVEMENT THICKNESS

REVISED AUG. 2007 (HOT MIX ASPHALT SHOULDERS)  
REVISED OCT. 2004 (GUARDRAIL BARRIER CONTRACT IT, DETAILS)  
REVISED SEPTEMBER 2004 (HOT MIX ASPHALT CONTRACT IT)

REVISED JUNE 1994 (SAVED CONTRACT, IT)  
REVISED FEB. 2000  
REVISED NOVEMBER 2002

COUNTY OF COOK  
DEPARTMENT OF HIGHWAYS  
DETAILS AND NOTES FOR CONSTRUCTION OF PAVEMENT AND PAVEMENT APPURTENANCES (SEE PARTIAL TO I.D.O.T. STANDARDS)  
DRAWN: J.M.V.  
CHECKED: J.M.V.  
DATE: 11-19-83

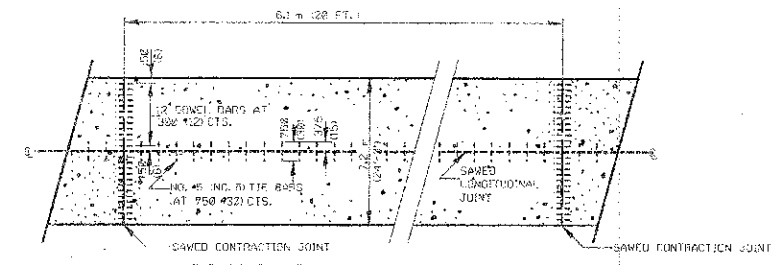

P.C. CONCRETE PAVEMENT DETAIL  
SEE I.D.O.T. STANDARDS 20001 AND 42071 FOR ADDITIONAL DETAILS

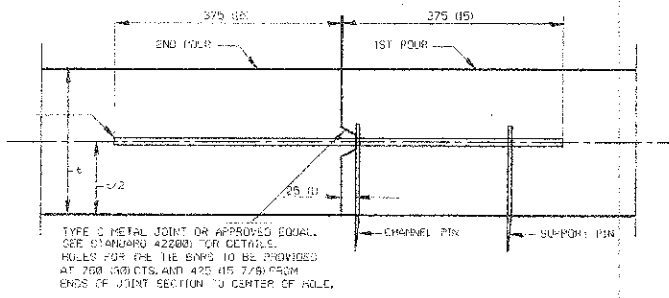

LONGITUDINAL CONSTRUCTION JOINT DETAIL  
TYPE A - INSTALL TIE BARS  
TYPE B - OMIT TIE BARS

NOTE: PAVEMENT FABRIC SHALL BE OMITTED PER CCHD COMMENTS

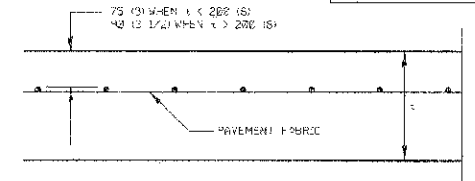

PAVEMENT FABRIC DETAIL  
SEE I.D.O.T. STANDARD 42071 FOR ADDITIONAL DETAILS

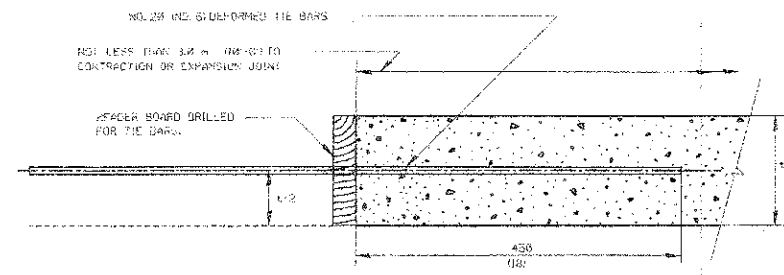

TRANSVERSE CONSTRUCTION JOINT DETAIL

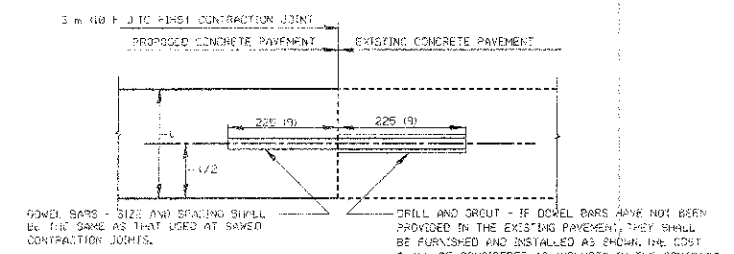

JOINT DETAIL AT CONTRACT TERMINAL(S)

NOTE: DETAIL APPLIES TO SCHAUMBURG ROAD ONLY

FILE NAME = ...\\2325\oad\sheet\2329\_07\_DET.dgn

USER NAME = djc	DESIGNED = KRK	REVISED =
PLOT SCALE = 20.0000 / 1x	DRAWN = KRK	REVISED =
PLOT DATE = 8/17/2012	CHECKED = DJC	REVISED =
	DATE = 8-20-12	REVISED =

STATE OF ILLINOIS  
DEPARTMENT OF TRANSPORTATION

BARRINGTON ROAD AND SCHAUMBURG ROAD  
DETAILS

SCALE: SHEET NO. 6 OF 10 SHEETS STA. TO STA.

F.A.U. RTE. 1322	SECTION 01-00074-00-CH	COUNTY COOK	TOTAL SHEETS 245	SHEET NO. 181
CONTRACT NO. 63629				
FED. ROAD DIST. NO. 1 (ILLINOIS) FED. AID PROJECT M-CUM-8003063				