

STA 31+00-STA 37+00
 SOILS INDICATED ELEVATED
 pH VALUES ABOVE MAXIMUM
 ALLOWABLE CONCENTRATIONS.
 ALL SOILS REMOVED FROM SITE
 TO BE TREATED AS AND PAID FOR
 AS NON-SPECIAL WASTE DISPOSAL.

POPLAR COMMONS
 MALL

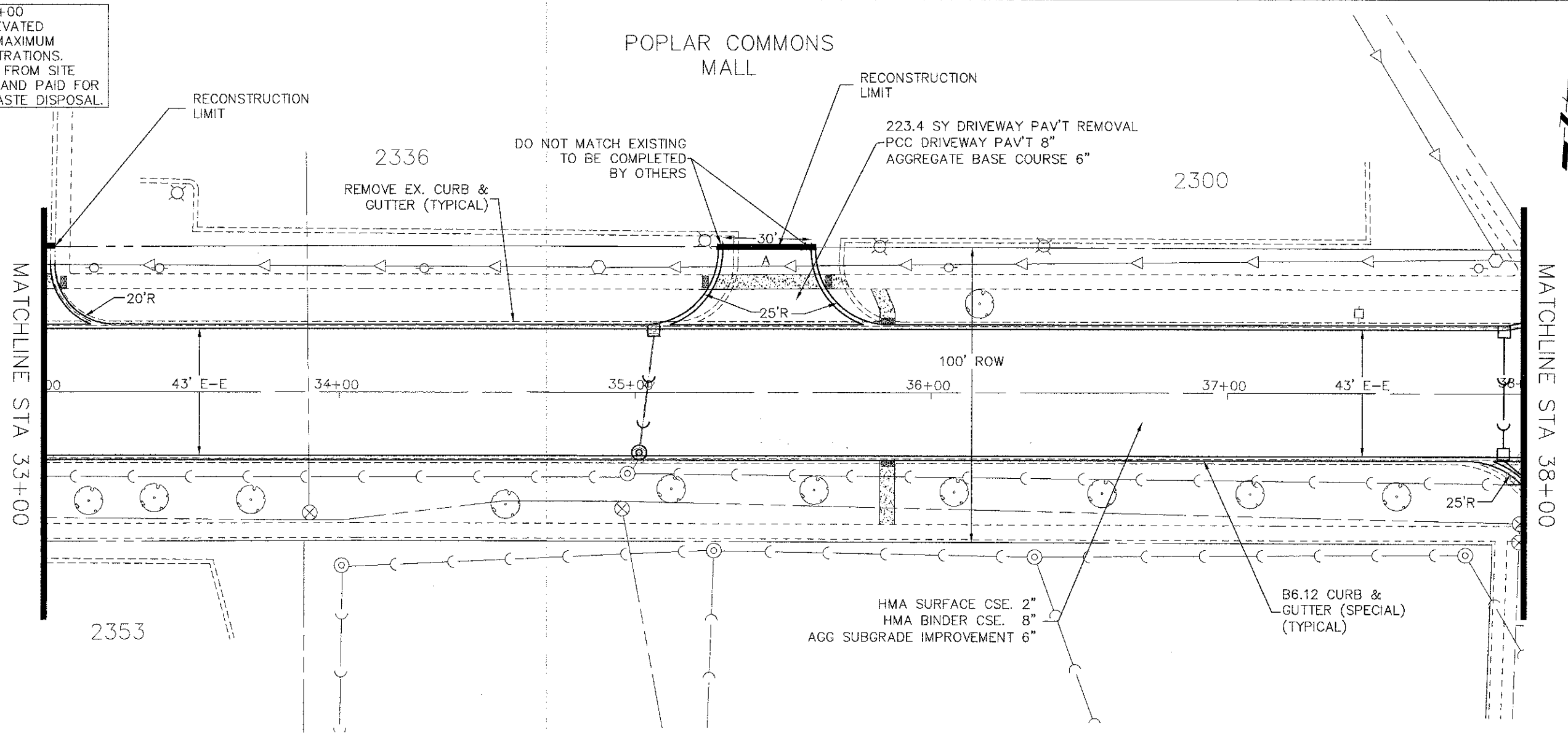

PLAN	SURVEYED	DATE	BY
	NOTE BOOK		
	ALLOTTMENT CHECKED		
	FILE NO.		
	DATE		
	BY		

PROFILE	SURVEYED	DATE	BY
	NOTE BOOK		
	GRADES CHECKED		
	S.M. NOTED		
	STRUCTURE NOTATIONS CH'NO		

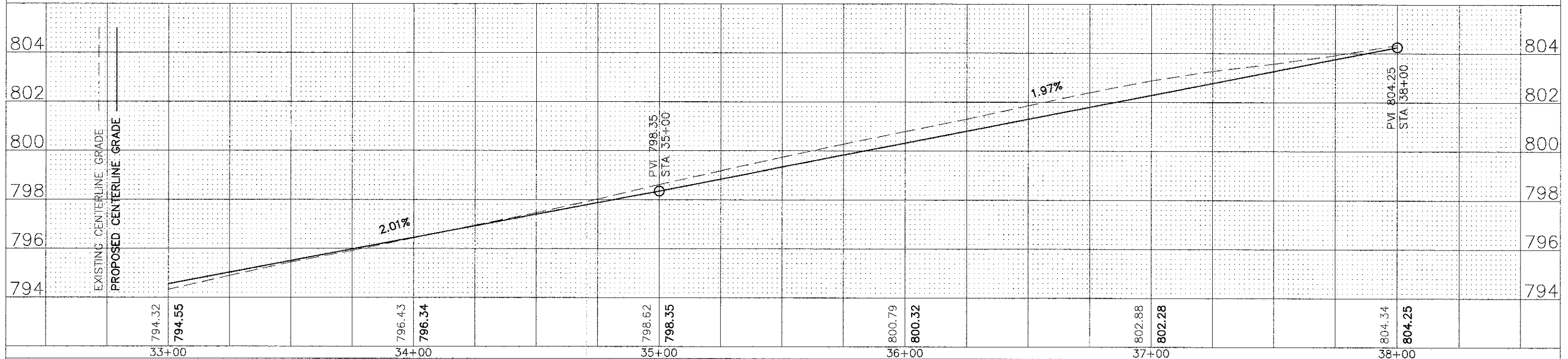

FILE NAME =	DESIGNED -	REVISED -
Hassell Plan-Profile.dwg	DRAWN -	REVISED -
	CHECKED -	REVISED -
	DATE -	REVISED -

STATE OF ILLINOIS
 DEPARTMENT OF TRANSPORTATION

Hassell Road STP Project
 Plan and Profile

SCALE: 1" = 20' SHEET NO. 6 OF 16 SHEETS STA. 33+00 TO STA 38+00

F.A.U. RTE.	SECTION	COUNTY	TOTAL SHEETS	SHEET NO.
1100	11-00087-00-FP	Cook	164	20
CONTRACT NO. 63770			ILLINOIS FED. AID PROJECT CMM 9003(757)	