

QUANTITY
 4 (100) LINE = 64.1 ft. (19.7 m)
 21.1 sq. ft. (1.97 sq. m)

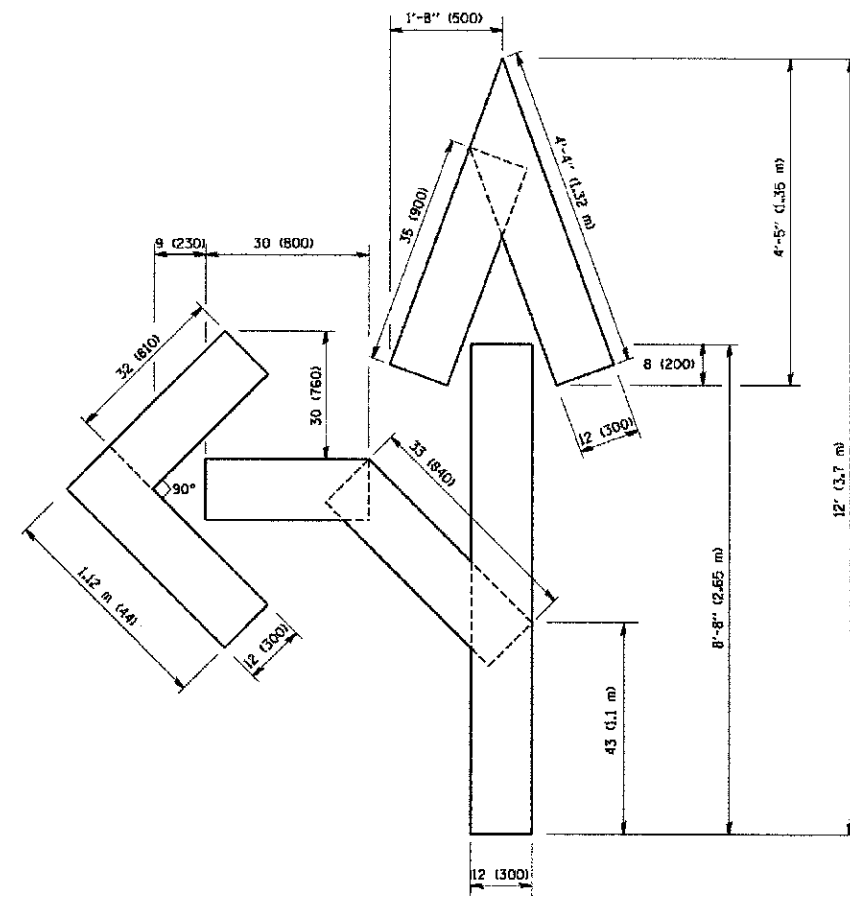

QUANTITY
 4 (100) LINE = 82.5 ft. (25.3 m)
 27.5 sq. ft. (2.53 sq. m)

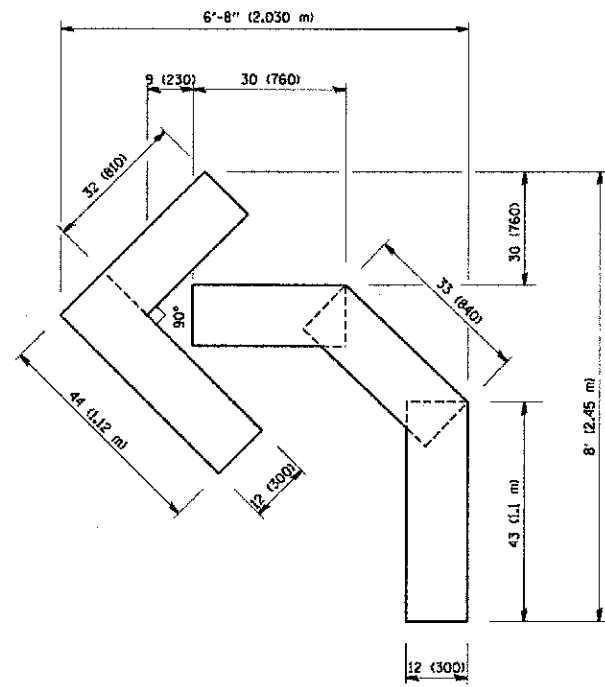

QUANTITY
 4 (100) LINE = 45.5 ft. (13.9 m)
 15.2 sq. ft. (1.39 sq. m)

All dimensions are in inches (millimeters) unless otherwise shown.

OWNER: STATE OF ILLINOIS, DEPARTMENT OF TRANSPORTATION
 PROJECT: I-55/US-51, I-55/US-51, I-55/US-51, I-55/US-51, I-55/US-51, I-55/US-51, I-55/US-51, I-55/US-51
 DRAWN BY: T. RAMWACHER
 DATE: 06-05-96
 CHECKED BY: T. RAMWACHER
 DATE: 11-04-97
 DESIGNED BY: T. RAMWACHER
 DATE: 03-02-98
 REVISED BY: E. GOMEZ
 DATE: 08-28-00

FILE NAME = M:\address\22x34\1616.dgn	USER NAME = gje1amrob	DESIGNED - DRAWN - CHECKED - DATE - 09-18-94	REVISED - T. RAMWACHER 06-05-96 REVISED - T. RAMWACHER 11-04-97 REVISED - T. RAMWACHER 03-02-98 REVISED - E. GOMEZ 08-28-00
--	-----------------------	---	--

STATE OF ILLINOIS
 DEPARTMENT OF TRANSPORTATION

PAVEMENT MARKING LETTERS AND SYMBOLS
 FOR TRAFFIC STAGING

F.A.I. RTE.	SECTION	COUNTY	TOTAL SHEETS	SHEET NO.
3533	09-00072-00-PV	COOK	21	19
TC-16			CONTRACT NO.	63811
FED. ROAD DIST. NO. 1 ILLINOIS FED. AID PROJECT				

SCALE: NONE SHEET NO. 1 OF 1 SHEETS STA. TO STA.