

	STATION PROPOSED US BUS 20	OFFSET PROPOSED US BUS 20	PROPOSED EOP ELEVATION
A	245+50.000	35.05' LT	768.67
B	245+62.501	35.50' LT	768.20
C	245+75.000	36.41' LT	767.72
D	245+87.504	37.79' LT	767.14
E	246+00.000	39.64' LT	766.46
F	246+12.501	42.91' LT	765.58
G	246+25.000	49.43' LT	764.72
H	246+29.749	53.03' LT	764.55
I	246+40.000	64.12' LT	764.30
	STATION PROPOSED N CENTRAL	OFFSET PROPOSED N CENTRAL	PROPOSED EOP ELEVATION
J	12004+62.505	23.81' LT	763.79
K	12004+75.000	19.49' LT	763.30
L	12004+77.270	18.00' LT	762.97

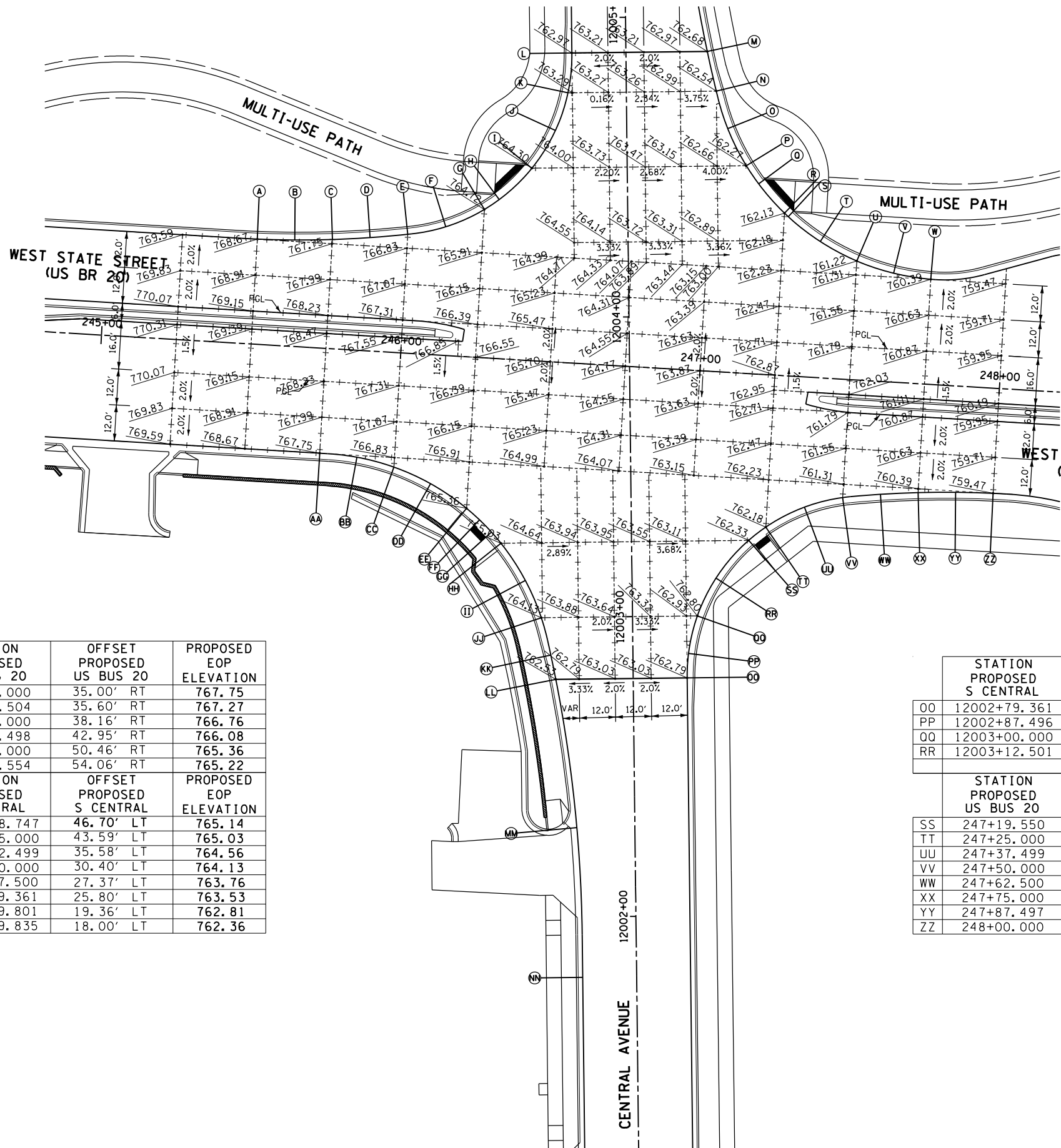

	STATION PROPOSED N CENTRAL	OFFSET PROPOSED N CENTRAL	PROPOSED EOP ELEVATION
M	12004+88.270	27.14' RT	762.68
N	12004+75.000	29.99' RT	762.54
O	12004+62.453	33.68' RT	762.41
P	12004+50.000	29.72' RT	762.27
	STATION PROPOSED US BUS 20	OFFSET PROPOSED US BUS 20	PROPOSED EOP ELEVATION
Q	247+15.816	63.37' LT	762.24
R	247+25.000	54.14' LT	762.13
S	247+26.317	53.04' LT	762.08
T	247+37.486	45.40' LT	761.68
U	247+50.000	39.67' LT	761.22
V	247+62.503	36.31' LT	760.80
W	247+75.000	35.02' LT	760.39

	STATION PROPOSED US BUS 20	OFFSET PROPOSED US BUS 20	PROPOSED EOP ELEVATION
AA	245+75.000	35.00' RT	767.75
BB	245+87.504	35.60' RT	767.27
CC	246+00.000	38.16' RT	766.76
DD	246+12.498	42.95' RT	766.08
EE	246+25.000	50.46' RT	765.36
FF	246+29.554	54.06' RT	765.22
	STATION PROPOSED S CENTRAL	OFFSET PROPOSED S CENTRAL	PROPOSED EOP ELEVATION
GG	12003+28.747	46.70' LT	765.14
HH	12003+25.000	43.59' LT	765.03
II	12003+12.499	35.58' LT	764.56
JJ	12003+00.000	30.40' LT	764.13
KK	12002+87.500	27.37' LT	763.76
LL	12002+79.361	25.80' LT	763.53
MM	12002+29.801	19.36' LT	762.81
NN	12001+79.835	18.00' LT	762.36

	STATION PROPOSED S CENTRAL	OFFSET PROPOSED S CENTRAL	PROPOSED EOP ELEVATION
OO	12002+79.361	18.00' RT	762.79
PP	12002+87.496	18.55' RT	762.82
QQ	12003+00.000	21.66' RT	762.80
RR	12003+12.501	27.98' RT	762.65
	STATION PROPOSED US BUS 20	OFFSET PROPOSED US BUS 20	PROPOSED EOP ELEVATION
SS	247+19.550	55.54' RT	762.33
TT	247+25.000	50.78' RT	762.18
UU	247+37.499	43.36' RT	761.70
VV	247+50.000	39.43' RT	761.24
WW	247+62.500	37.60' RT	760.80
XX	247+75.000	36.28' RT	760.36
YY	247+87.497	35.42' RT	759.92
ZZ	248+00.000	35.03' RT	759.47

- NOTES:
- ELEVATIONS ARE FOR INFORMATION ONLY. CONTRACTOR SHALL VERIFY ALL INFORMATION PRIOR TO CONSTRUCTION.
 - REFER TO STANDARDS 420001, 420101 AND 420106 FOR JOINT DETAILS AND SPACING.