

	STATION PROPOSED US BUS 20	OFFSET PROPOSED US BUS 20	PROPOSED EOP ELEVATION
P	259+98.237	31.00' LT	734.69
Q	260+08.134	32.24' LT	734.70
R	260+17.414	35.90' LT	734.69
S	260+25.503	41.73' LT	734.63
	STATION PROPOSED HINKLEY	OFFSET PROPOSED HINKLEY	PROPOSED EOP ELEVATION
T	13900+49.145	19.72' LT	734.55
U	13900+58.167	15.47' LT	734.45
V	13900+67.961	13.59' LT	734.36
W	13900+70.752	13.50' LT	734.33

	STATION PROPOSED HINKLEY	OFFSET PROPOSED HINKLEY	PROPOSED EOP ELEVATION
X	13900+72.706	13.50' RT	734.44
Y	13900+62.809	14.74' RT	734.63
Z	13900+53.529	18.40' RT	734.86
AA	13900+45.440	24.23' RT	735.11
	STATION PROPOSED US BUS 20	OFFSET PROPOSED US BUS 20	PROPOSED EOP ELEVATION
BB	260+84.536	38.22' LT	735.36
CC	260+93.536	33.60' LT	735.58
DD	261+03.392	31.26' LT	735.75
EE	261+04.550	31.00' LT	735.81

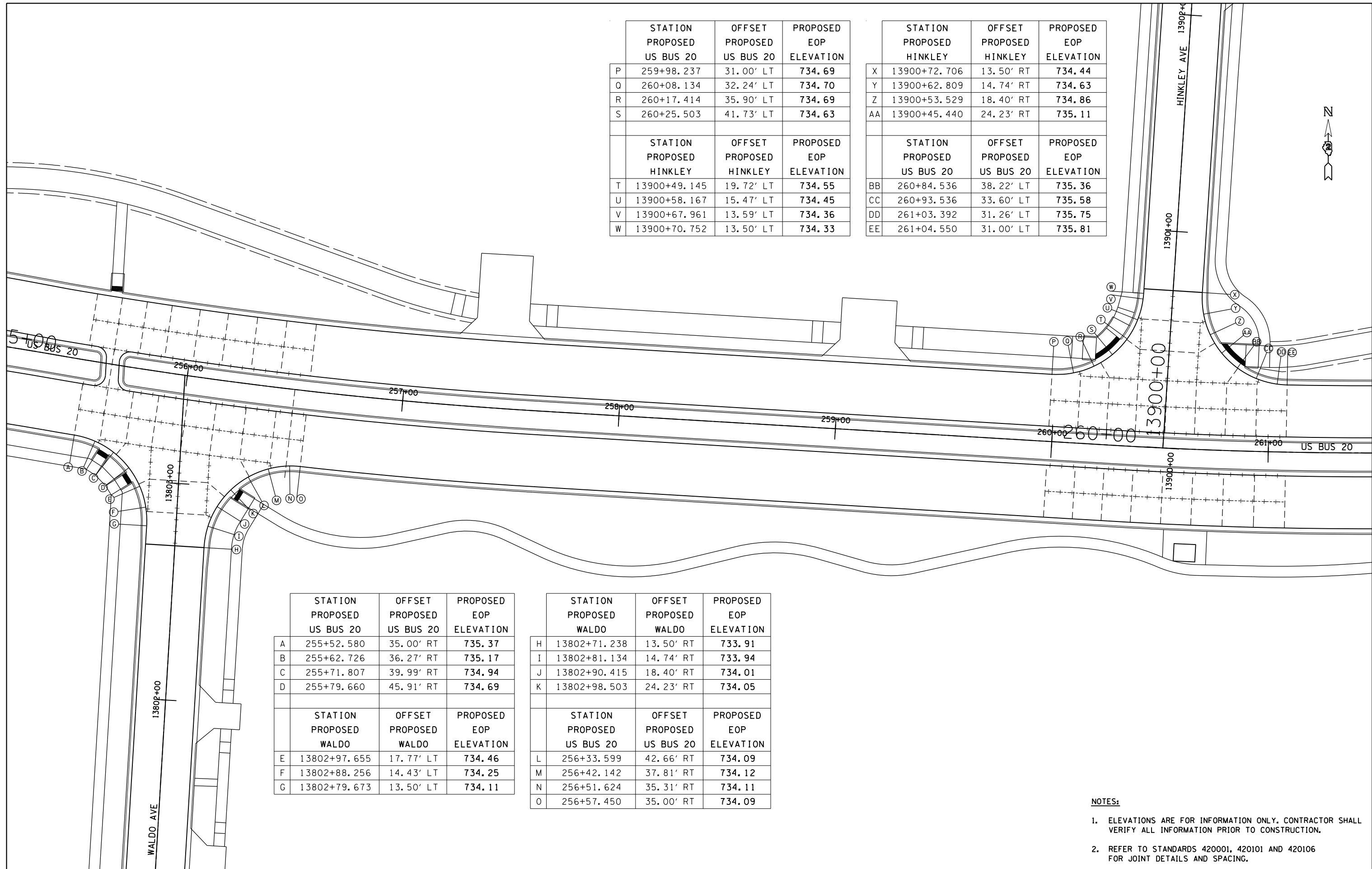

	STATION PROPOSED US BUS 20	OFFSET PROPOSED US BUS 20	PROPOSED EOP ELEVATION
A	255+52.580	35.00' RT	735.37
B	255+62.726	36.27' RT	735.17
C	255+71.807	39.99' RT	734.94
D	255+79.660	45.91' RT	734.69
	STATION PROPOSED WALDO	OFFSET PROPOSED WALDO	PROPOSED EOP ELEVATION
E	13802+97.655	17.77' LT	734.46
F	13802+88.256	14.43' LT	734.25
G	13802+79.673	13.50' LT	734.11

	STATION PROPOSED WALDO	OFFSET PROPOSED WALDO	PROPOSED EOP ELEVATION
H	13802+71.238	13.50' RT	733.91
I	13802+81.134	14.74' RT	733.94
J	13802+90.415	18.40' RT	734.01
K	13802+98.503	24.23' RT	734.05
	STATION PROPOSED US BUS 20	OFFSET PROPOSED US BUS 20	PROPOSED EOP ELEVATION
L	256+33.599	42.66' RT	734.09
M	256+42.142	37.81' RT	734.12
N	256+51.624	35.31' RT	734.11
O	256+57.450	35.00' RT	734.09

- NOTES:**
- ELEVATIONS ARE FOR INFORMATION ONLY. CONTRACTOR SHALL VERIFY ALL INFORMATION PRIOR TO CONSTRUCTION.
 - REFER TO STANDARDS 420001, 420101 AND 420106 FOR JOINT DETAILS AND SPACING.