

WEST STATE ST (US BR 20) & AVON ST INTERSECTION NORTHWEST - SIDEWALK RAMP GRADES				
POINT NO.	STATION	OFFSET	SIDE	ELEVATION
A	272+66.13	55.59	LT	736.03
B	272+57.26	56.05	LT	736.77
C	272+51.75	56.74	LT	736.88
D	272+53.26	66.62	LT	736.72
E	272+58.22	66.00	LT	736.62
F	272+66.21	65.59	LT	735.95
G	272+78.33	66.03	LT	735.71

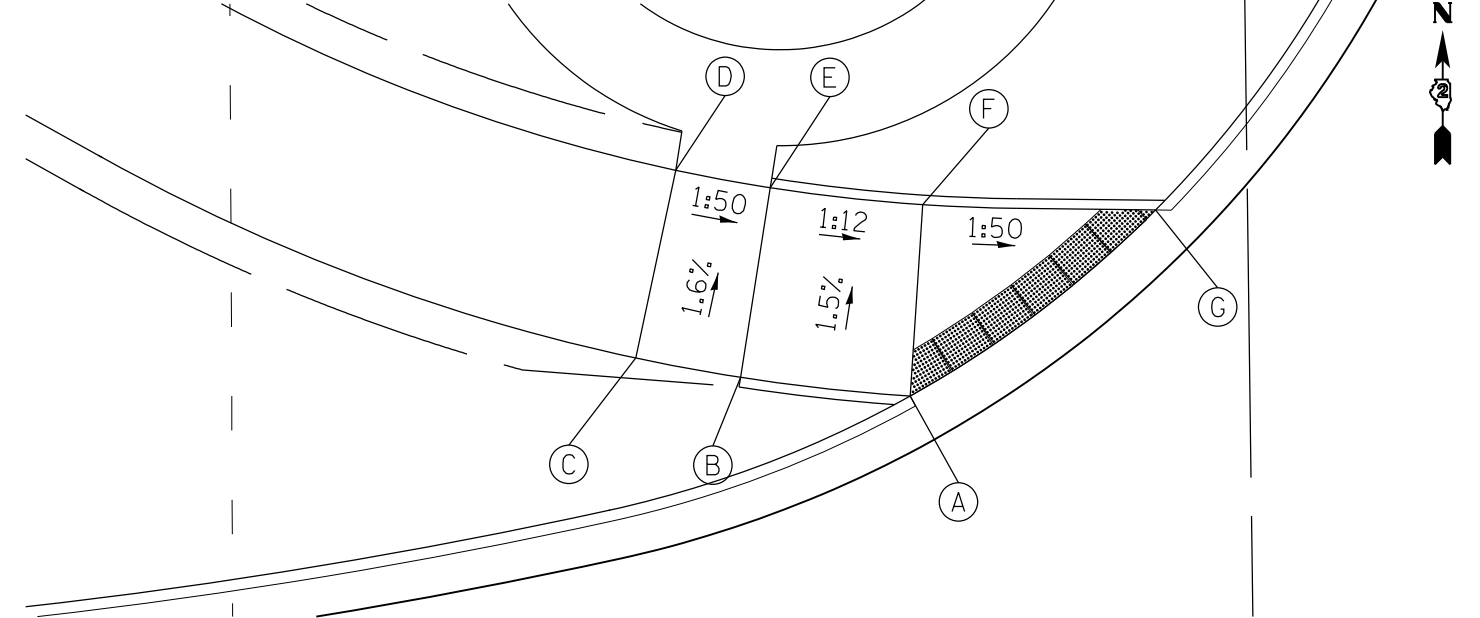

WEST STATE ST (US BR 20)

WEST STATE ST (US BR 20)

WEST STATE ST (US BR 20) & AVON ST INTERSECTION NORTHEAST - SIDEWALK RAMP GRADES				
POINT NO.	STATION	OFFSET	SIDE	ELEVATION
A	273+20.97	75.89	LT	734.07
B	273+93.69	82.38	LT	734.81
C	273+99.08	83.73	LT	734.92
D	273+20.97	92.77	LT	735.03
E	273.20.97	88.90	LT	734.93
F	273.20.97	83.36	LT	734.27
G	273+20.97	78.56	LT	734.14

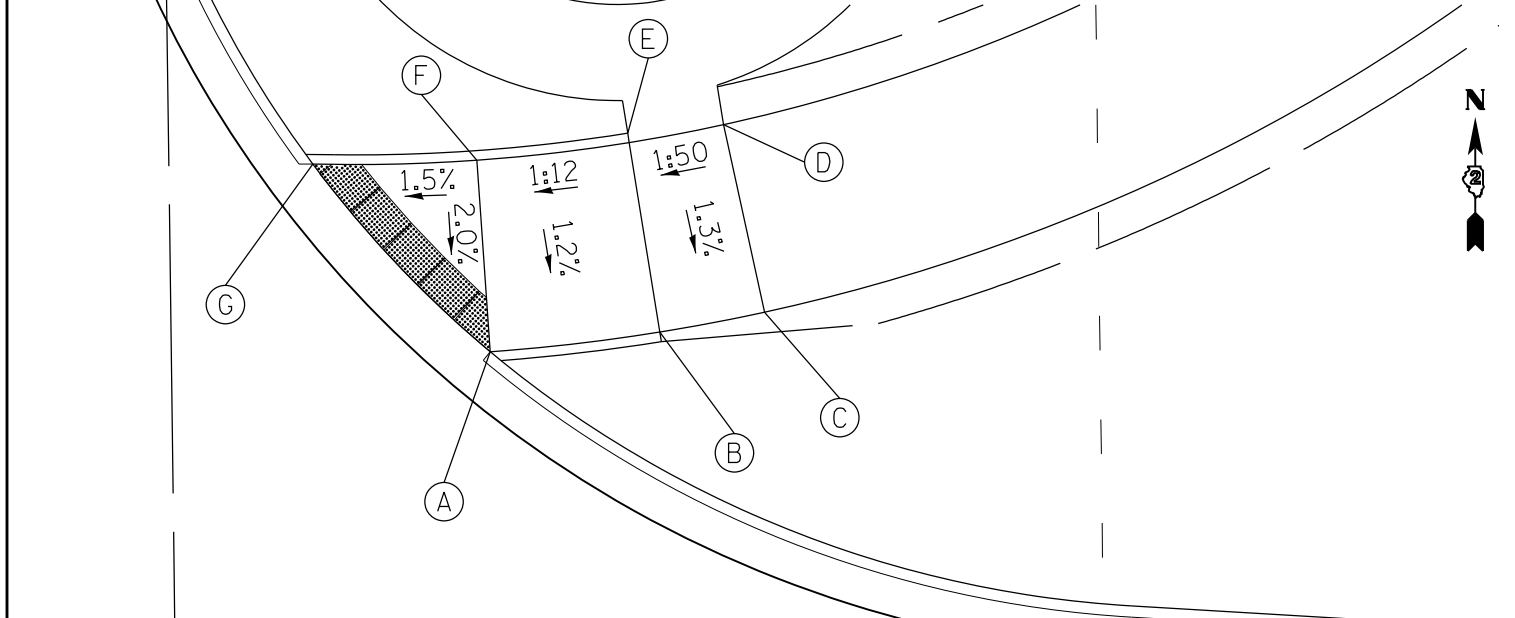

WEST STATE ST (US BR 20)

WEST STATE ST (US BR 20)

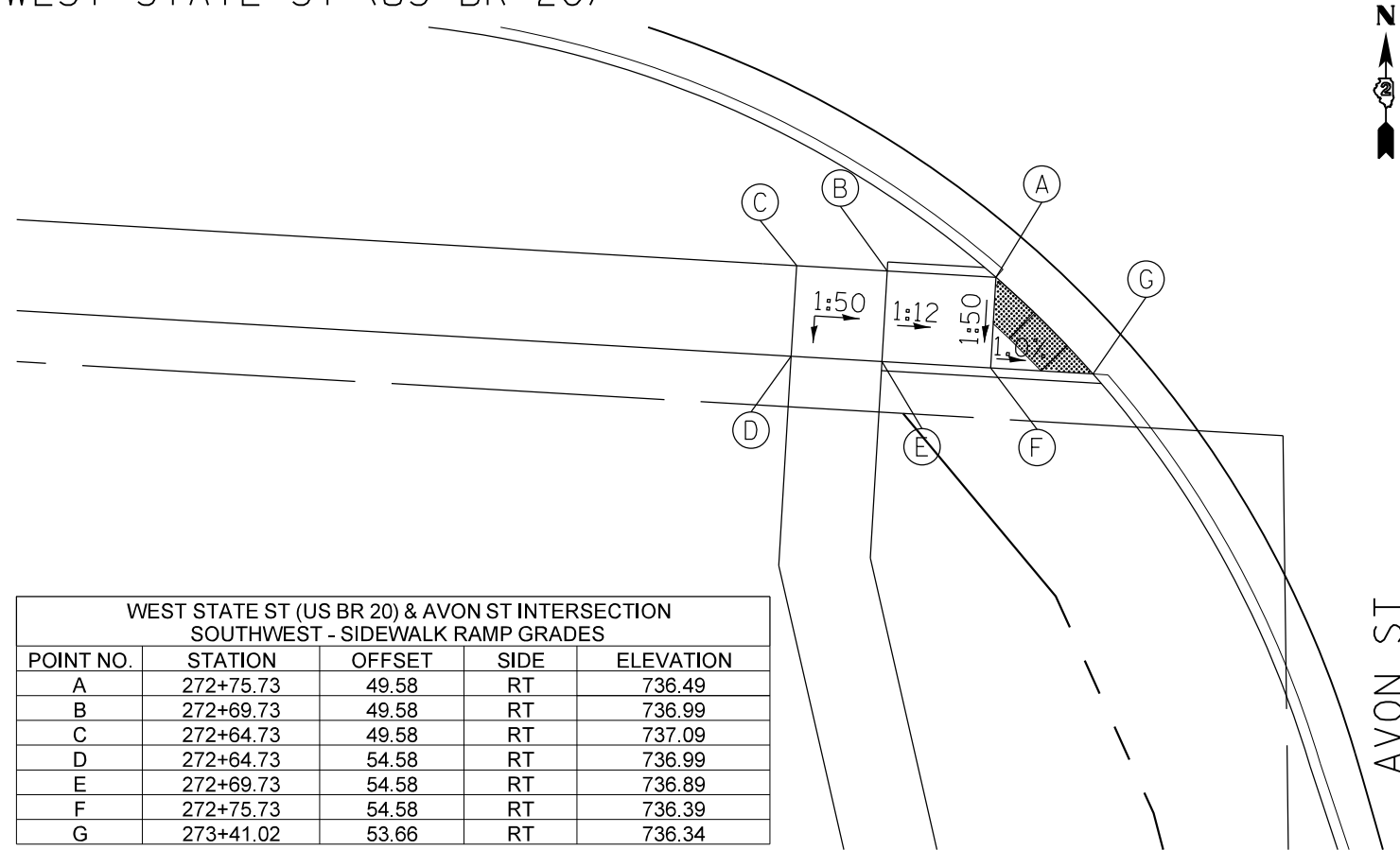

WEST STATE ST (US BR 20) & AVON ST INTERSECTION SOUTHWEST - SIDEWALK RAMP GRADES				
POINT NO.	STATION	OFFSET	SIDE	ELEVATION
A	272+75.73	49.58	RT	736.49
B	272+69.73	49.58	RT	736.99
C	272+64.73	49.58	RT	737.09
D	272+64.73	54.58	RT	736.99
E	272+69.73	54.58	RT	736.89
F	272+75.73	54.58	RT	736.39
G	273+41.02	53.66	RT	736.34



WEST STATE ST (US BR 20) & AVON ST INTERSECTION SOUTHEAST - SIDEWALK RAMP GRADES				
POINT NO.	STATION	OFFSET	SIDE	ELEVATION
A	273+87.00	56.35	RT	734.33
B	273+89.57	52.12	RT	733.86
C	273+94.36	55.63	RT	734.16
D	273+98.40	58.59	RT	734.26
E	274+01.35	54.55	RT	734.16
F	273+97.32	51.60	RT	734.06
G	273+92.52	48.09	RT	733.77
H	273+95.78	44.36	RT	734.13

FILE NAME =	USER NAME = dosddd	DESIGNED -	REVISED -
et:\pw\work\p1dot\dosddd\d0326838\01sabled_Ramps.dgn		DRAWN -	REVISED -
Default	PLOT SCALE = 10.0000' / in.	CHECKED -	REVISED -
	PLOT DATE = Mon Dec 17 15:44:28 2012	DATE -	REVISED -

STATE OF ILLINOIS
DEPARTMENT OF TRANSPORTATION

WEST STATE ST (US BR 20) AND AVON ST
SIDEWALK RAMP DETAIL

SCALE: SHEET OF SHEETS STA. TO STA.

F.A.P. RTE.	SECTION	COUNTY	TOTAL SHEETS	SHEET NO.
303	41R	WINNEBAGO	327	193
CONTRACT NO. 64750				
ILLINOIS FED. AID PROJECT				