

DATE	
BY	
PLAN	SURVEYED
	PLOTTED
	CHECKED
	ALIGNED
	FILED
NOTE BOOK NO.	
CADD FILE NAME	

DATE	
BY	
PROFILE	SURVEYED
	PLOTTED
	CHECKED
	GRADES
	STRUCTURE
	NOTATIONS
	CHKD
NOTE BOOK NO.	
STRUCTURE	

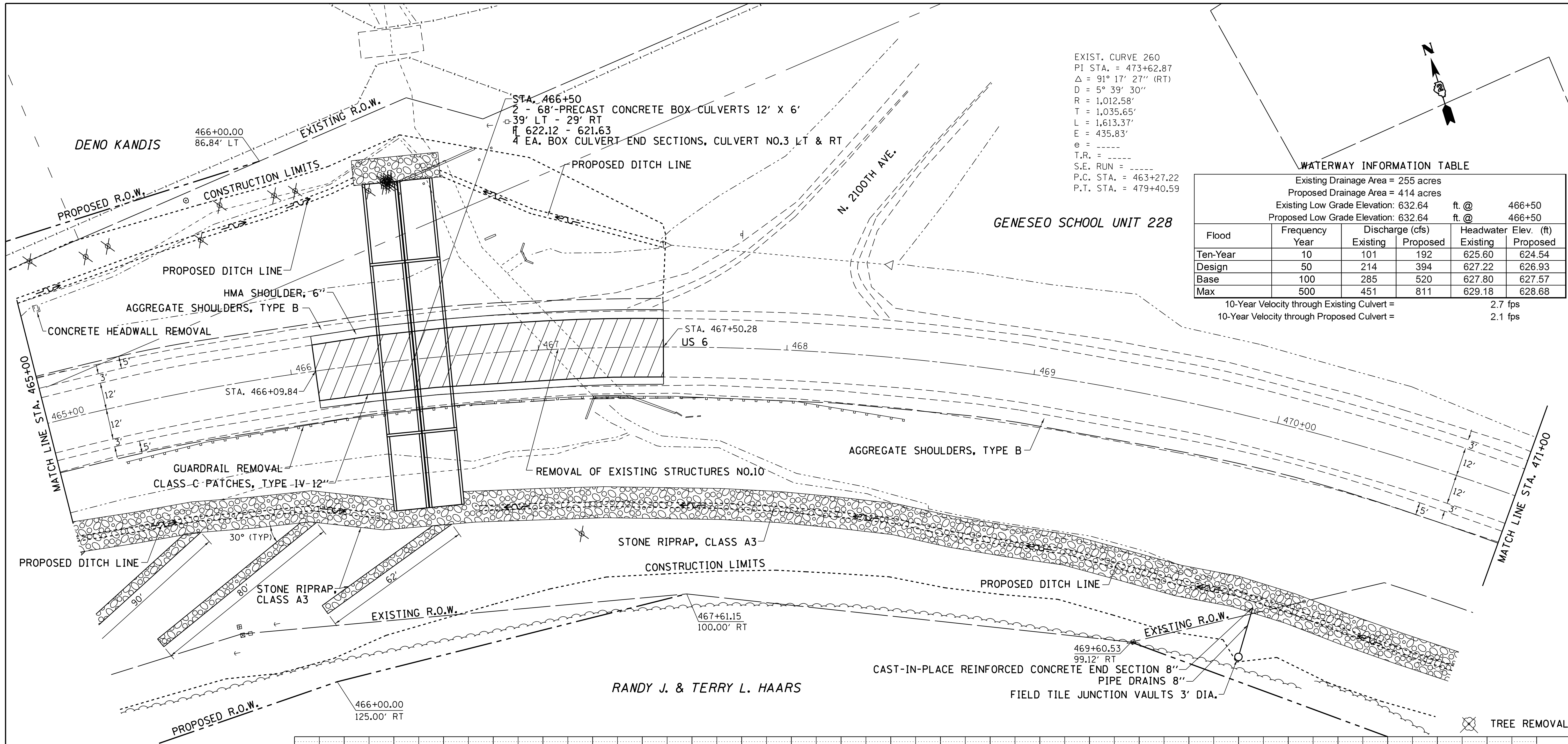

EXIST. CURVE 260  
 PI STA. = 473+62.87  
 $\Delta = 91^\circ 17' 27''$  (RT)  
 D = 5° 39' 30"  
 R = 1,012.58'  
 T = 1,035.65'  
 L = 1,613.37'  
 E = 435.83'  
 e = -----  
 T.R. = -----  
 S.E. RUN = -----  
 P.C. STA. = 463+27.22  
 P.T. STA. = 479+40.59

**WATERWAY INFORMATION TABLE**

Existing Drainage Area = 255 acres					
Proposed Drainage Area = 414 acres					
Existing Low Grade Elevation: 632.64 ft. @ 466+50					
Proposed Low Grade Elevation: 632.64 ft. @ 466+50					
Flood Year	Frequency	Discharge (cfs)		Headwater Elev. (ft)	
		Existing	Proposed	Existing	Proposed
Ten-Year	10	101	192	625.60	624.54
Design	50	214	394	627.22	626.93
Base	100	285	520	627.80	627.57
Max	500	451	811	629.18	628.68
10-Year Velocity through Existing Culvert =					2.7 fps
10-Year Velocity through Proposed Culvert =					2.1 fps

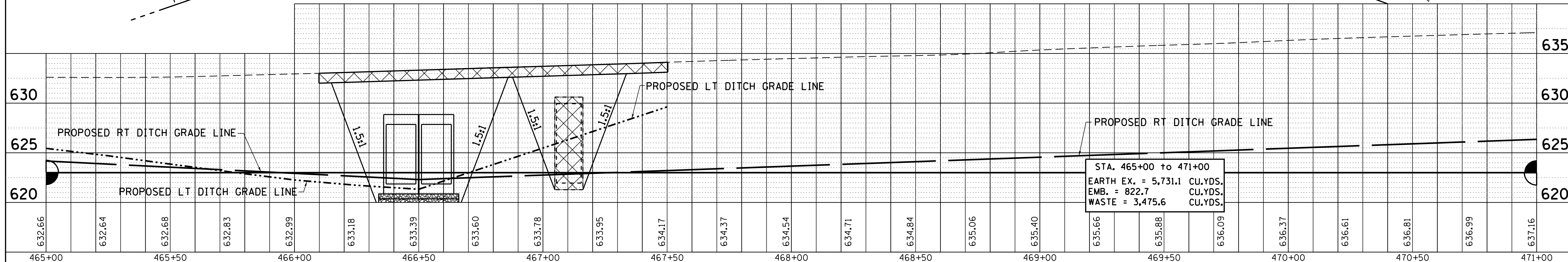

STA. 465+00 to 471+00  
 EARTH EX. = 5,731.1 CU.YDS.  
 EMB. = 822.7 CU.YDS.  
 WASTE = 3,475.6 CU.YDS.

FILE NAME =	USER NAME = cushmanbw	DESIGNED -	REVISED -	<b>STATE OF ILLINOIS DEPARTMENT OF TRANSPORTATION</b>	<b>US 6 PLAN &amp; PROFILE</b>	F.A.S. R.T.E.	SECTION	COUNTY	TOTAL SHEETS	SHEET NO.
c:\pwwork\pwwork\cushmanbw\d01619166\0208009-shd-plnprf.dgn		DRAWN -	REVISED -			226	3T & 3BR-1	HENRY	210	38
PLOT SCALE = 20.0000' / in.		CHECKED -	REVISED -			CONTRACT NO. 64F25				
PLOT DATE = Fri Oct 19 12:40:23 2012		DATE -	REVISED -			ILLINOIS FED. AID PROJECT				