

STATE OF ILLINOIS
DEPARTMENT OF TRANSPORTATION

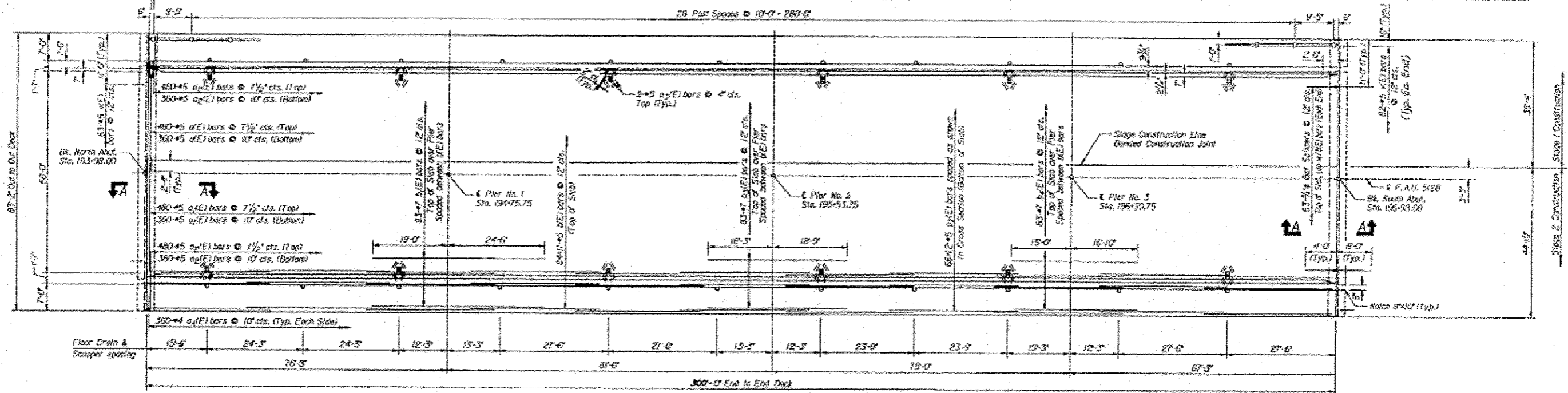

PROJECT NO.	SECTION	COUNTY	TOTAL SHEETS	SHEET NO.	SHEET OF
101-0163	105BR-2	WINNEBAGO	54	37	28
PROJECT TITLE: ILLINOIS PROJECT					



PLAN

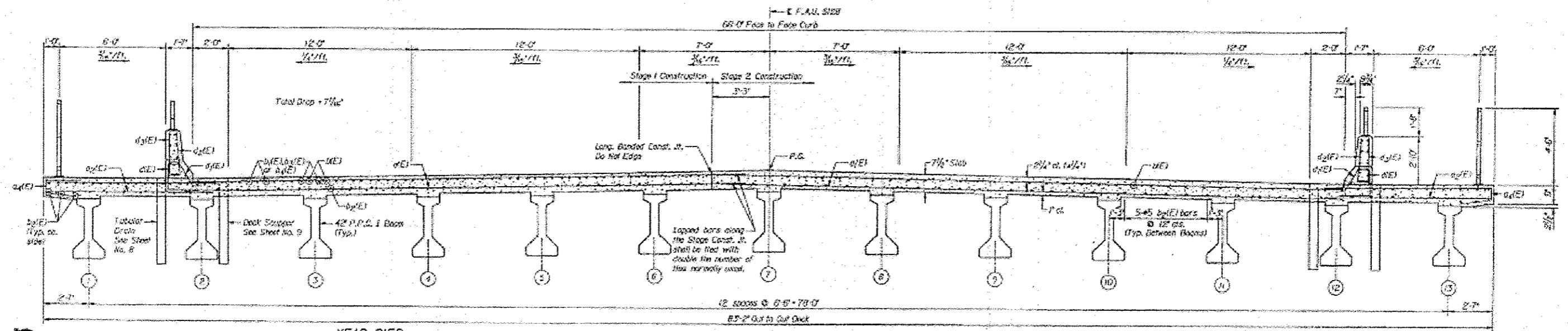

CROSS SECTION
(Looking South)

Bascor, Inc.
consulting engineers and planners

DESIGNED	JLT
CHECKED	GSP
DRAWN	SAW
CHECKED	JLT

MINIMUM BAR LAPS
#5 bars - 2'-2"

- NOTES:
- See Sheet No. 8 for Superstructure Details and Bill of Material.
 - Bars indicated thru 20'-3"-45' etc. indicates 20' lines of bars with 3 lengths per line.
 - Reinforcement bars designated (E) shall be epoxy coated.
 - See Sheet No. 16 for Section A-A.

SUPERSTRUCTURE
IL. 251 OVER KISHWAUKEE RIVER
F.A.U. 5128 SECTION 105BR-2
WINNEBAGO COUNTY
STA. 195+48.00
STRUCTURE NO. 101-0163

USER NAME: bartese	DESIGNED -	REVISED -
PLOT SCALE: 1/8" = 1'-0"	DRAWN -	REVISED -
PLOT DATE: Tue Dec 04 14:35:40 2012	CHECKED -	REVISED -
	DATE -	REVISED -

STATE OF ILLINOIS
DEPARTMENT OF TRANSPORTATION

EXISTING BRIDGE PLANS FOR INFORMATION ONLY

F.A.U. R/E.	SECTION	COUNTY	TOTAL SHEETS	SHEET NO.
5128	D2 BRIDGE REPAIR 2013-4	WINNEBAGO	5	4
CONTRACT NO. 64J45				