

Notes:
See sheet 19 of 38 for Sections C-C & D-D and View E-E.
a₃(E) and a₄(E) bar spacings measured along \varnothing Rdwy.

*** Cost included with Concrete Superstructure.

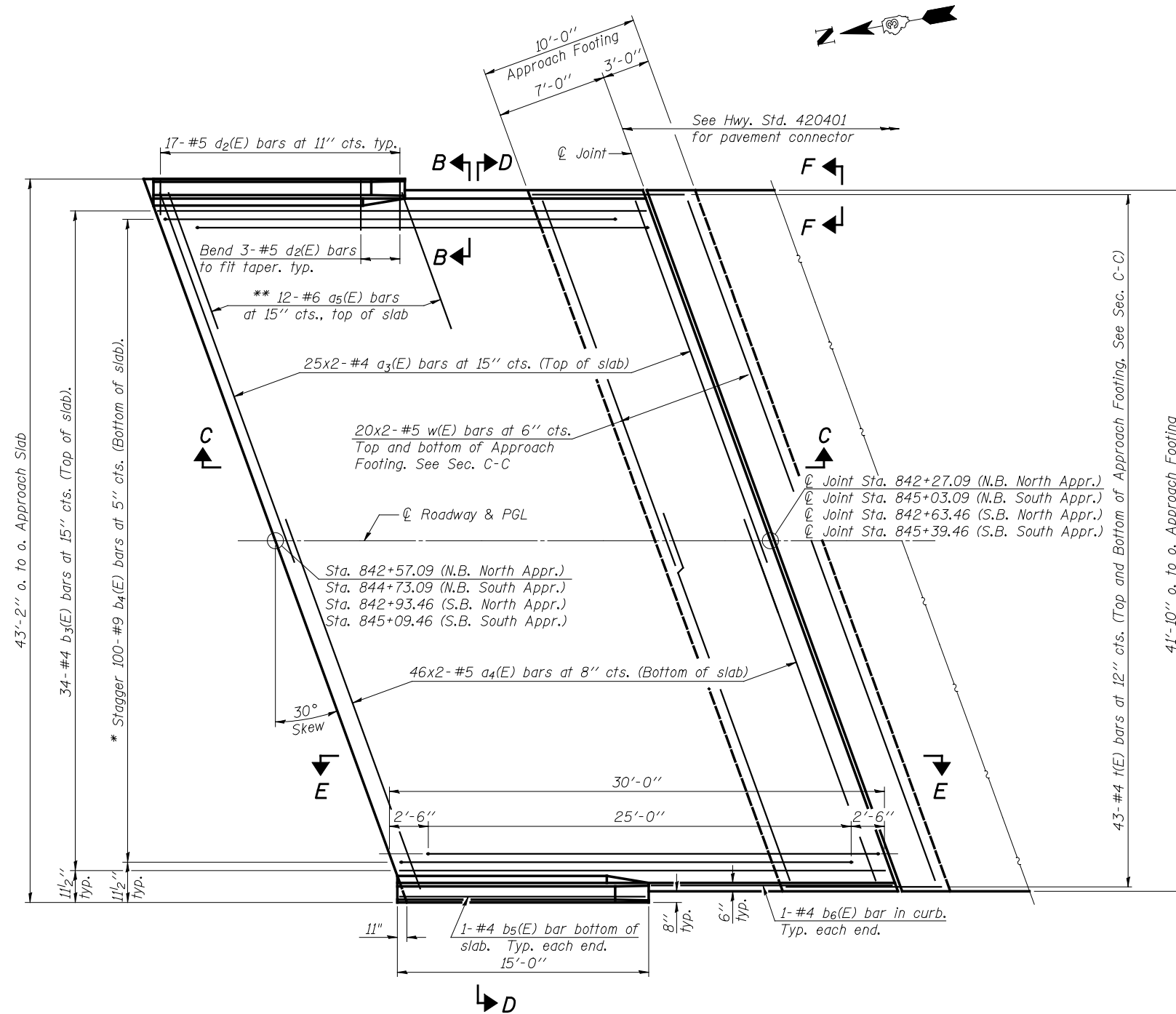

PLAN

(South Approach of SN 038-0215 (N.B.) shown, North Approach and SN 038-0215 (S.B.) similar)

* Tilt #9 b₄(E) bars as required to maintain clearance.
** Space between a₃(E) bars, typ. each parapet.

MINIMUM BAR LAP

(Appr. Slab)
#4 bar = 2'-7"
#5 bar = 3'-3"

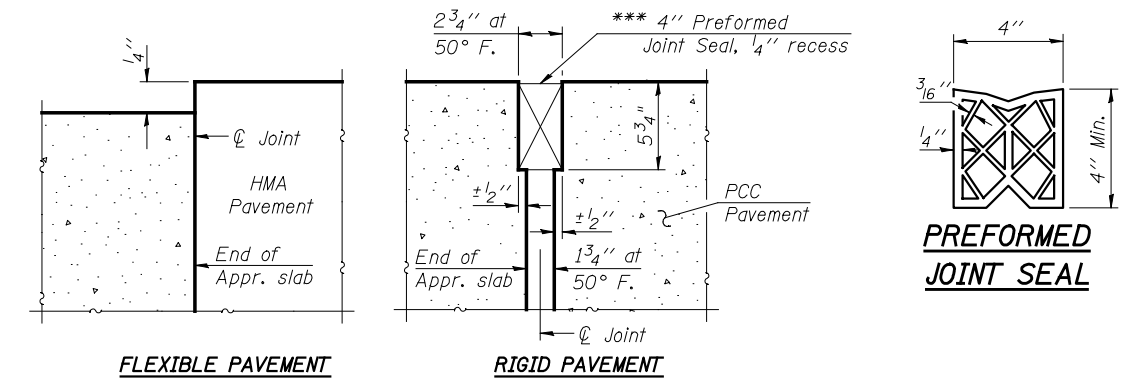

DETAIL A

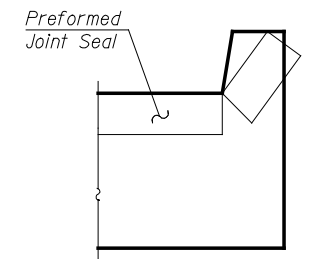

VIEW F-F

Angle Preformed Joint Seal at 45° at curbs when req'd for drainage.

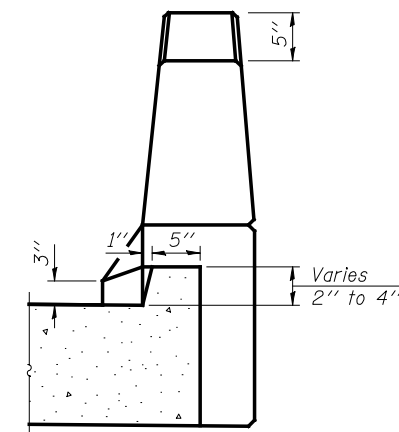

VIEW B-B

1/28/2013 4:46:05 PM 0380215_66944_01B_APPR_01.dgn



DESIGNED	TAY	REVISED	
CHECKED	MWS	REVISED	
DRAWN	MWS	REVISED	
CHECKED	BJM	REVISED	

**STATE OF ILLINOIS
DEPARTMENT OF TRANSPORTATION**

**BRIDGE APPROACH SLAB DETAILS
STRUCTURE NO. 038-0215 (S.B.) & 038-0216 (N.B.)**

SHEET NO. 18 OF 38 SHEETS

F.A.I. RTE.	SECTION	COUNTY	TOTAL SHEETS	SHEET NO.
57	141 BR(SB) & 38-1 BR(NB)	IROQUOIS	138	56
CONTRACT NO. 66944				
ILLINOIS FED. AID PROJECT				