

DATE
BY
ORIGINAL SURVEY
SURVEYED
PLOTTED
TEMPLATE
NOTE BOOK
AREAS CHECKED
NO.

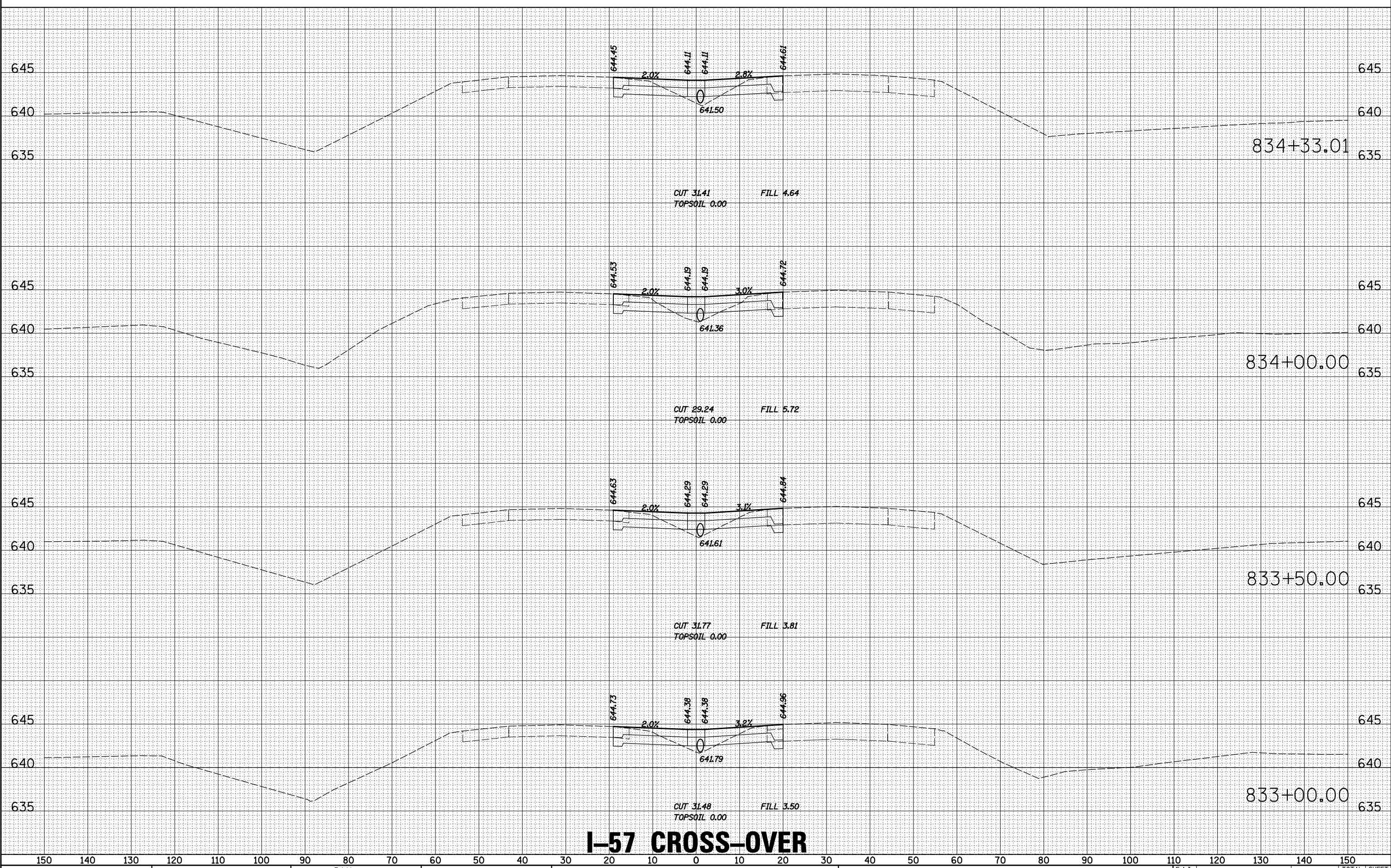

**I-57 CROSS-OVER**

DATE
BY
ORIGINAL SURVEY
SURVEYED
PLOTTED
TEMPLATE
NOTE BOOK
AREAS CHECKED
NO.

150 140 130 120 110 100 90 80 70 60 50 40 30 20 10 0 10 20 30 40 50 60 70 80 90 100 110 120 130 140 150



USER NAME = bhenrichs  
 DESIGNED BAH  
 DRAWN BAH  
 CHECKED KAC  
 DATE 12-07-2012

REVISED -  
 REVISED -  
 REVISED -  
 REVISED -

STATE OF ILLINOIS  
 DEPARTMENT OF TRANSPORTATION

PROPOSED CROSS SECTIONS  
 SCALE: SHEET 5 OF 16 SHEETS STA. 833+00.00 TO STA. 834+33.01

F.A.I. RTE.	SECTION	COUNTY	TOTAL SHEETS	SHEET NO.
57	141 BR(SB) & 38-1 BR(NB)	IROQUOIS	138	127
CONTRACT NO. 66944			ILLINOIS FED. AID PROJECT	