

SECTION A-A
STAGE I
LOOKING EAST

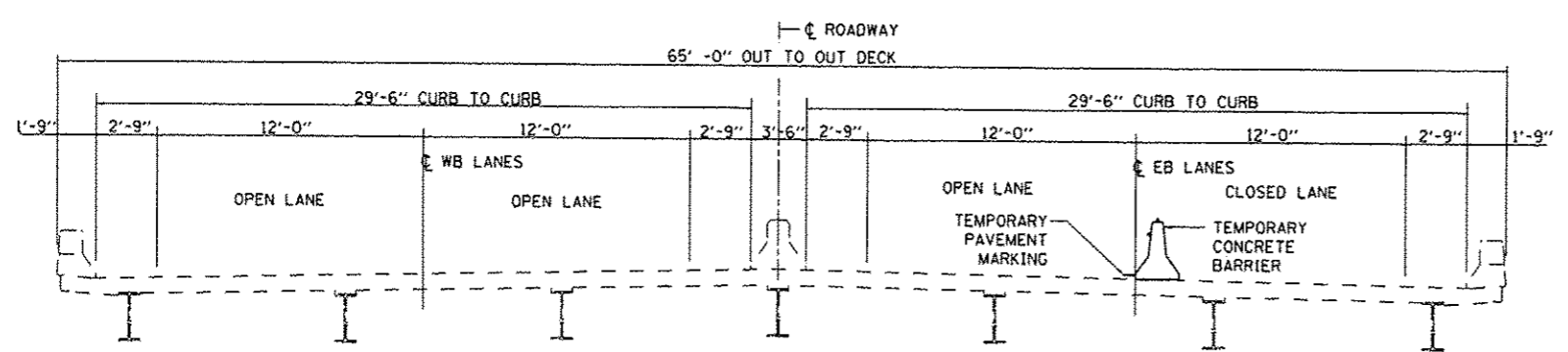

SECTION B-B
STAGE I
LOOKING EAST

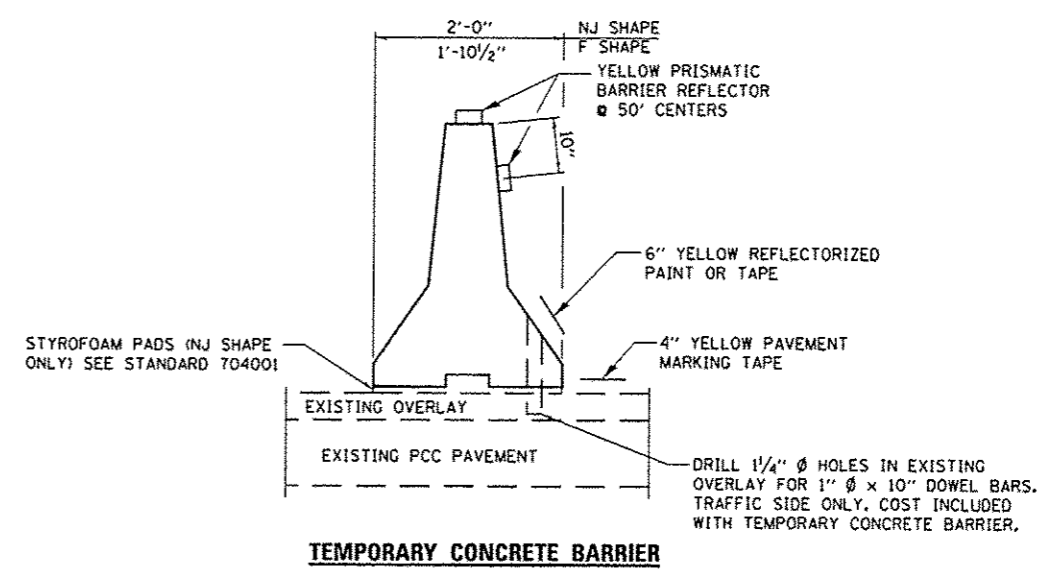

TEMPORARY CONCRETE BARRIER

- SYMBOLS**
- Work area
 - Drum, with steady burn monodirectional light
 - Temporary concrete barrier
 - Monodirectional barrier wall/guardrail marker
 - Impact attenuator

GENERAL NOTES

This standard is used where at any time any vehicle, equipment, workers or their activities will encroach on the pavement or on the shoulder within 24 (600) of the edge of pavement for day light operation exceeding one day and where temporary concrete barrier is utilized.

This Standard must always be used in combination with Standard 701402.

When work is being performed in the left lane, the set up would be a mirror image to what is shown.

FILE NAME =	USER NAME = woodshankr1	DESIGNED - RW	REVISED -	STATE OF ILLINOIS DEPARTMENT OF TRANSPORTATION	STAGING DETAILS - STAGE I FOR STRUCTURE NO. 078-0001	F.A.I. R.T.E.	SECTION	COUNTY	TOTAL SHEETS	SHEET NO.
c:\p\work\p\dot\woodshankr1\0314761\066C56\stg-detailed.dgn	DRAWN - RW	REVISED -	180			106-3.78-11PM	BUREAU	10	5	
#MODELNAME#	PLOT SCALE = 1/80,000 @ 1/4" = 100'	CHECKED -	REVISED -			CONTRACT NO. 66C56				
	PLOT DATE = 11/15/2012	DATE -	REVISED -			ILLINOIS FED. AID PROJECT				
					SCALE:	SHEET 1 OF 1 SHEETS		STA.	TO STA.	