

PLAN

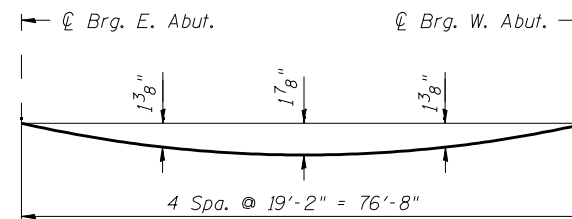

DEAD LOAD DEFLECTION DIAGRAM

(Includes weight of concrete only.)

Note:

The above deflections are not to be used in the field if the engineer is working from the grade elevations adjusted for dead load deflections as shown below and on sheet 4 of 19.

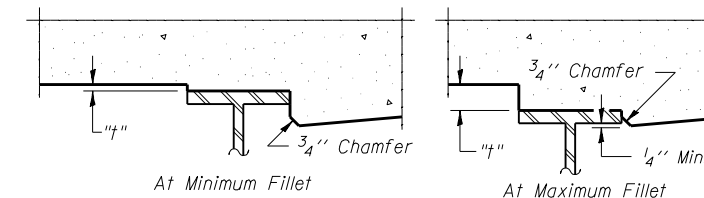

FILLET HEIGHTS

To determine "f": After all structural steel has been erected, elevations of the top flanges of the beams shall be taken at intervals shown in the Plan view. These elevations subtracted from the "Theoretical Grade Elevations Adjusted For Dead Load Deflection" shown below and on sheet 4 of 19, minus slab thickness, equals the fillet heights "f" above top flange of beams.

BEAM 1

Location	Station	Offset	Theoretical Grade Elevations	Theoretical Grade Elevations Adjusted For Dead Load Deflection
Bk. E. Abut.	1424+12.85	-16.67	461.88	461.88
☉ Brg. E. Abut.	1424+14.14	-16.67	461.88	461.88
A	1424+24.14	-16.67	461.92	461.99
B	1424+34.14	-16.67	461.96	462.08
C	1424+44.14	-16.67	462.00	462.15
D	1424+54.14	-16.67	462.03	462.18
E	1424+64.14	-16.67	462.05	462.19
F	1424+74.14	-16.67	462.08	462.18
G	1424+84.14	-16.67	462.09	462.14
☉ Brg. W. Abut.	1424+90.80	-16.67	462.10	462.10
Bk. W. Abut.	1424+92.10	-16.67	462.11	462.11

BEAM 3

Location	Station	Offset	Theoretical Grade Elevations	Theoretical Grade Elevations Adjusted For Dead Load Deflection
Bk. E. Abut.	1424+09.27	-3.33	462.09	462.09
☉ Brg. E. Abut.	1424+10.57	-3.33	462.10	462.10
A	1424+20.57	-3.33	462.14	462.21
B	1424+30.57	-3.33	462.18	462.30
C	1424+40.57	-3.33	462.22	462.37
D	1424+50.57	-3.33	462.25	462.41
E	1424+60.57	-3.33	462.28	462.42
F	1424+70.57	-3.33	462.30	462.41
G	1424+80.57	-3.33	462.32	462.37
☉ Brg. W. Abut.	1424+87.23	-3.33	462.33	462.33
Bk. W. Abut.	1424+88.52	-3.33	462.33	462.33

☉ ROADWAY & P.G.

Location	Station	Offset	Theoretical Grade Elevations	Theoretical Grade Elevations Adjusted For Dead Load Deflection
Bk. E. Abut.	1424+08.38	0.00	462.14	462.14
☉ Brg. E. Abut.	1424+09.67	0.00	462.15	462.15
A	1424+19.67	0.00	462.19	462.26
B	1424+29.67	0.00	462.23	462.35
C	1424+39.67	0.00	462.27	462.42
D	1424+49.67	0.00	462.30	462.46
E	1424+59.67	0.00	462.33	462.47
F	1424+69.67	0.00	462.35	462.46
G	1424+79.67	0.00	462.37	462.42
☉ Brg. W. Abut.	1424+86.34	0.00	462.38	462.38
Bk. W. Abut.	1424+87.63	0.00	462.38	462.38

BEAM 2

Location	Station	Offset	Theoretical Grade Elevations	Theoretical Grade Elevations Adjusted For Dead Load Deflection
Bk. E. Abut.	1424+11.06	-10.00	462.00	462.00
☉ Brg. E. Abut.	1424+12.35	-10.00	462.00	462.00
A	1424+22.35	-10.00	462.05	462.11
B	1424+32.35	-10.00	462.09	462.20
C	1424+42.35	-10.00	462.12	462.27
D	1424+52.35	-10.00	462.15	462.31
E	1424+62.35	-10.00	462.18	462.32
F	1424+72.35	-10.00	462.20	462.30
G	1424+82.35	-10.00	462.22	462.27
☉ Brg. W. Abut.	1424+89.02	-10.00	462.23	462.23
Bk. W. Abut.	1424+90.31	-10.00	462.23	462.23

STAGE CONSTRUCTION LINE

Location	Station	Offset	Theoretical Grade Elevations	Theoretical Grade Elevations Adjusted For Dead Load Deflection
Bk. E. Abut.	1424+08.65	-1.00	462.13	462.12
☉ Brg. E. Abut.	1424+09.94	-1.00	462.13	462.13
A	1424+19.94	-1.00	462.18	462.25
B	1424+29.94	-1.00	462.22	462.34
C	1424+39.94	-1.00	462.25	462.40
D	1424+49.94	-1.00	462.28	462.44
E	1424+59.94	-1.00	462.31	462.45
F	1424+69.94	-1.00	462.34	462.45
G	1424+79.94	-1.00	462.36	462.41
☉ Brg. W. Abut.	1424+86.60	-1.00	462.37	462.37
Bk. W. Abut.	1424+87.90	-1.00	462.37	462.37

BEAM 4

Location	Station	Offset	Theoretical Grade Elevations	Theoretical Grade Elevations Adjusted For Dead Load Deflection
Bk. E. Abut.	1424+07.49	3.33	462.08	462.08
☉ Brg. E. Abut.	1424+08.78	3.33	462.09	462.09
A	1424+18.78	3.33	462.14	462.20
B	1424+28.78	3.33	462.18	462.29
C	1424+38.78	3.33	462.21	462.36
D	1424+48.78	3.33	462.24	462.40
E	1424+58.78	3.33	462.27	462.41
F	1424+68.78	3.33	462.30	462.40
G	1424+78.78	3.33	462.32	462.36
☉ Brg. W. Abut.	1424+85.44	3.33	462.33	462.33
Bk. W. Abut.	1424+86.74	3.33	462.33	462.33