

FINAL SURVEY	SURVEYED	BY	DATE
NOTE BOOK	PLOTTED		
AREAS CHECKED	TEMPLATE		
NO.	AREAS CHECKED		

ORIGINAL SURVEY	SURVEYED	BY	DATE
NOTE BOOK	PLOTTED		
AREAS CHECKED	TEMPLATE		
NO.	AREAS CHECKED		

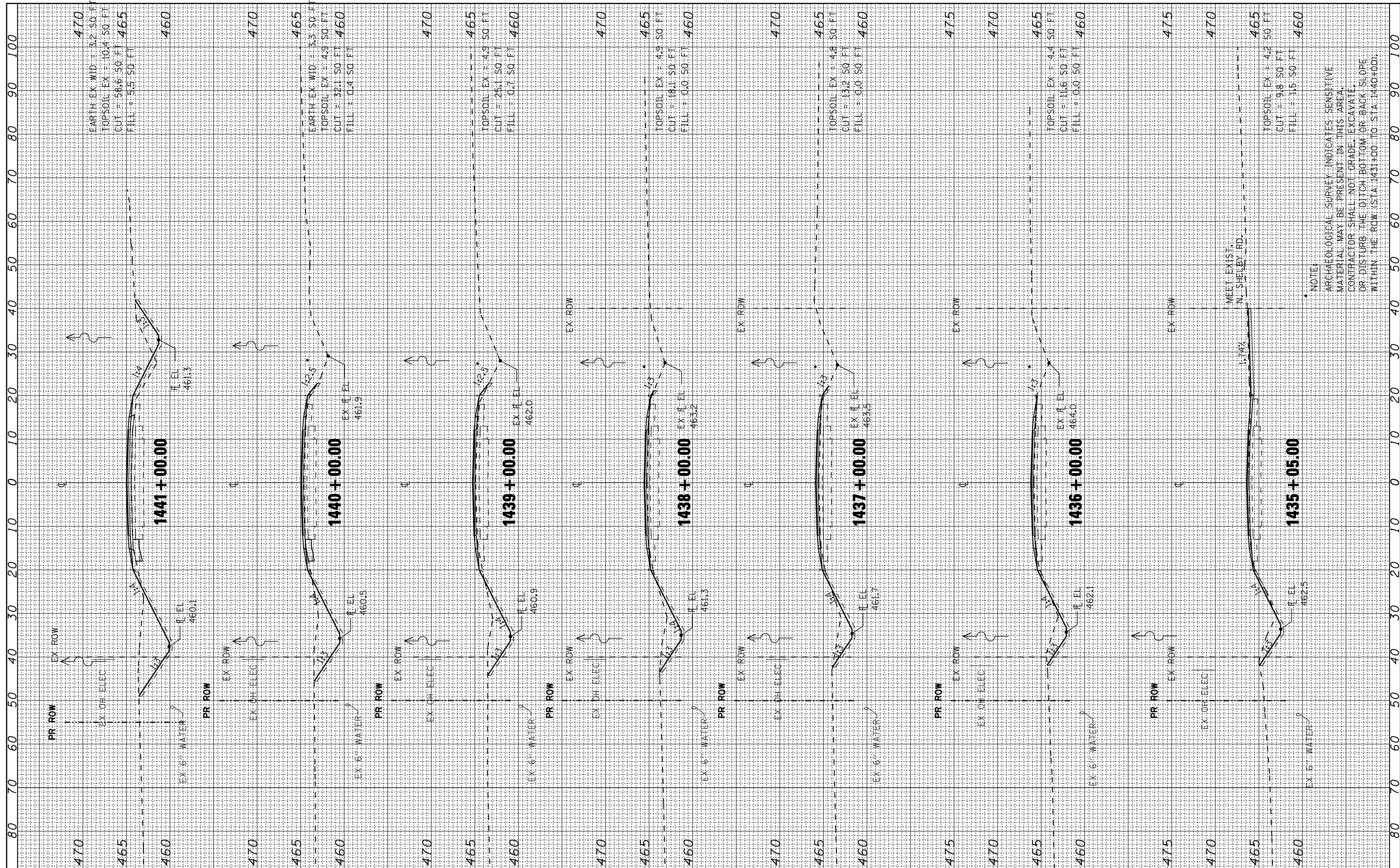

NOTE:
 ARCHAEOLOGICAL SURVEY INDICATES SENSITIVE MATERIAL MAY BE PRESENT IN THIS AREA. CONTRACTOR SHALL NOT GRADE, EXCAVATE, OR DISTURB THE DITCH BOTTOM OR BANK SLOPE WITHIN THE ROW (STA 1431+00 TO STA 1440+00).

FILE NAME =	USER NAME = *USER*
FILEL	DESIGNED - JL
	DRAWN - JL
	CHECKED - JES
	DATE - 12-07-12
	REVISIONS
	REVISED -
	REVISED -
	REVISED -

DESIGNED - JL	REVISED -
DRAWN - JL	REVISED -
CHECKED - JES	REVISED -
DATE - 12-07-12	REVISED -

**STATE OF ILLINOIS
 DEPARTMENT OF TRANSPORTATION**

CROSS SECTIONS	
US RTE 24 OVER BIG SISTER CREEK & LITTLE SISTER CREEK	
SCALE: 1" = 10'	SHEET NO. 5 OF 12 SHEETS
STA. 1435+05	TO STA. 1441+00

F.A.P. RTE.	SECTION	COUNTY	TOTAL SHEETS	SHEET NO.
317	(137BR, BR-1)BR	FULTON	118	111
CONTRACT NO. 68699				
ILLINOIS FED. AID PROJECT				