

NORTH EDGE OF SHOULDER

Location	Station	Offset	Theoretical Grade Elevations
End W. Appr. Slab	135+04.04	-44.85	694.76
A	135+14.03	-44.98	694.65
B	135+24.03	-45.11	694.53
End W. Vault Slab	135+34.04	-45.24	694.42

NORTH EDGE OF PAVEMENT

Location	Station	Offset	Theoretical Grade Elevations
End W. Appr. Slab	135+04.18	-38.85	694.89
A	135+14.18	-38.98	694.77
B	135+24.18	-39.11	694.65
End W. Vault Slab	135+34.17	-39.24	694.54

SOUTH EDGE OF RAMP

Location	Station	Offset	Theoretical Grade Elevations
End W. Appr. Slab	135+04.54	-24.00	695.19
A	135+14.54	-24.00	695.08
B	135+24.54	-24.00	694.96
End W. Vault Slab	135+34.54	-24.00	694.86

☉ W.B. ROADWAY

Location	Station	Offset	Theoretical Grade Elevations
End W. Appr. Slab	135+04.82	-12.00	695.38
A	135+14.82	-12.00	695.26
B	135+24.82	-12.00	695.15
End W. Vault Slab	135+34.82	-12.00	695.04

SOUTH EDGE OF PAVEMENT & PG

Location	Station	Offset	Theoretical Grade Elevations
End W. Appr. Slab	135+05.11	0.00	695.19
A	135+15.11	0.00	695.07
B	135+25.11	0.00	694.96
End W. Vault Slab	135+35.11	0.00	694.86

SOUTH EDGE OF SHOULDER

Location	Station	Offset	Theoretical Grade Elevations
End W. Appr. Slab	135+05.25	6.00	695.06
A	135+15.25	6.00	694.95
B	135+25.25	6.00	694.84
End W. Vault Slab	135+35.25	6.00	694.73

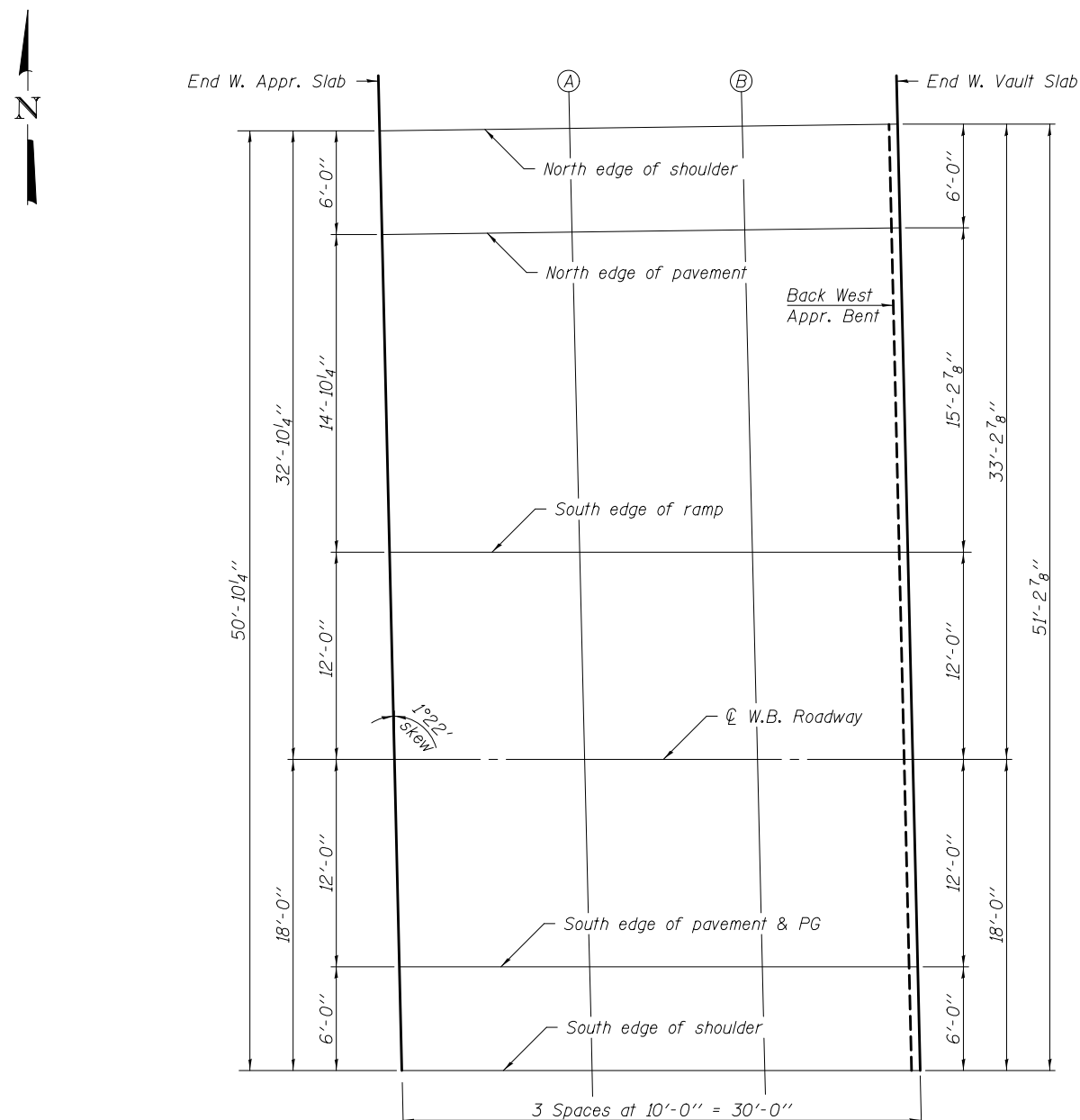

PLAN

Note:
All offsets based off of PG W.B. Roadway. Negative offset denotes an offset to the left of Profile Grade.

FILE NAME =	USER NAME = #USER*	DESIGNED K.A. KLUES	REVISED - 12/17/12 DHC/JKS
#FILE*		CHECKED E.M. LAGEMANN	Del. Staging (IDOT)
PLOT SCALE =		DRAWN K.A. KLUES	REVISED -
PLOT DATE = #DATE*		CHECKED E.M. LAGEMANN	REVISED -

**STATE OF ILLINOIS
DEPARTMENT OF TRANSPORTATION**

**HORNER &
SHIRIN, INC.
ENGINEERS**

**TOP OF WEST APPROACH SLAB ELEVATIONS (W.B.)
STRUCTURE NOS. 072-0119 (E.B.) & 072-0120 (W.B.)**

F.A.I. RTE.	SECTION	COUNTY	TOTAL SHEETS	SHEET NO.
474	(72-3HB-1),I	PEORIA	88	32
CONTRACT NO. 68883				
ILLINOIS FED. AID PROJECT				