

A ← → B

\* 3 spaces at 3" = 9".

\*\* 4-3/4"  $\phi$  threaded dowel rods at 3" cts., Each Face

**ELEVATION OF BEAM**  
(Showing reinforcement & dimensions)

Note A:  
Hex nuts (top and bottom) with lock washers (top). Only tighten sufficiently to compress lock washers.

**\*\*\*BAR LIST**  
**ONE BEAM ONLY**

Bar	No.	Size	Length	Shape
G <sub>1</sub>	66	#4	7'-5"	⌒
G <sub>2</sub>	8	#4	5'-8"	⌒
G <sub>3</sub>	3	#5	39'-8"	—
G <sub>4</sub>	38	#3	4'-1"	⌒

\*\*\*For information only

Notes:  
See sheet 53 of 62 for additional details and Bill of Material.  
Required release strength, f'ci, shall be 5,000 psi.

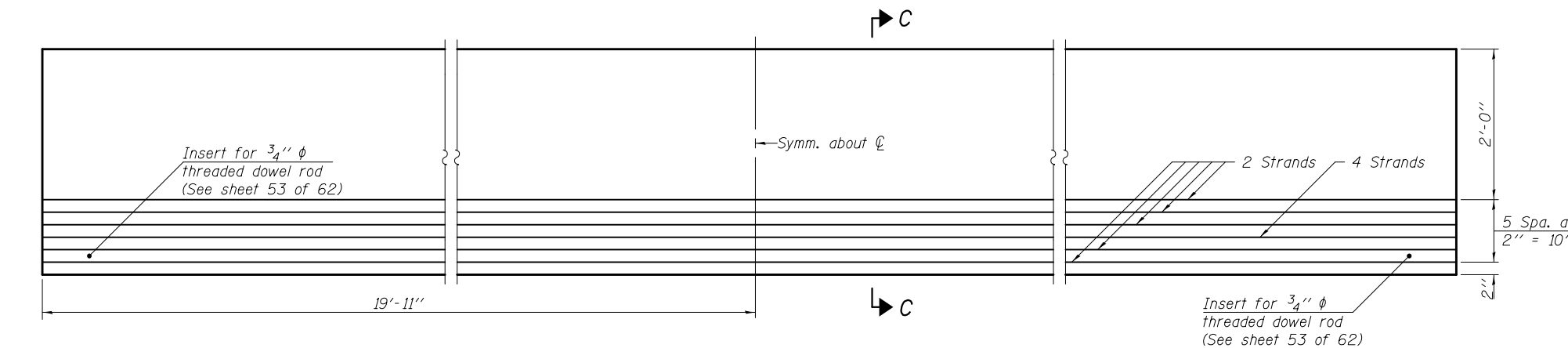

**ELEVATION OF BEAM**  
(Showing prestressing steel)

