

DATE	
BY	
DESIGNED	
DRAWN	
CHECKED	
DATE	

DATE	
BY	
DESIGNED	
DRAWN	
CHECKED	
DATE	

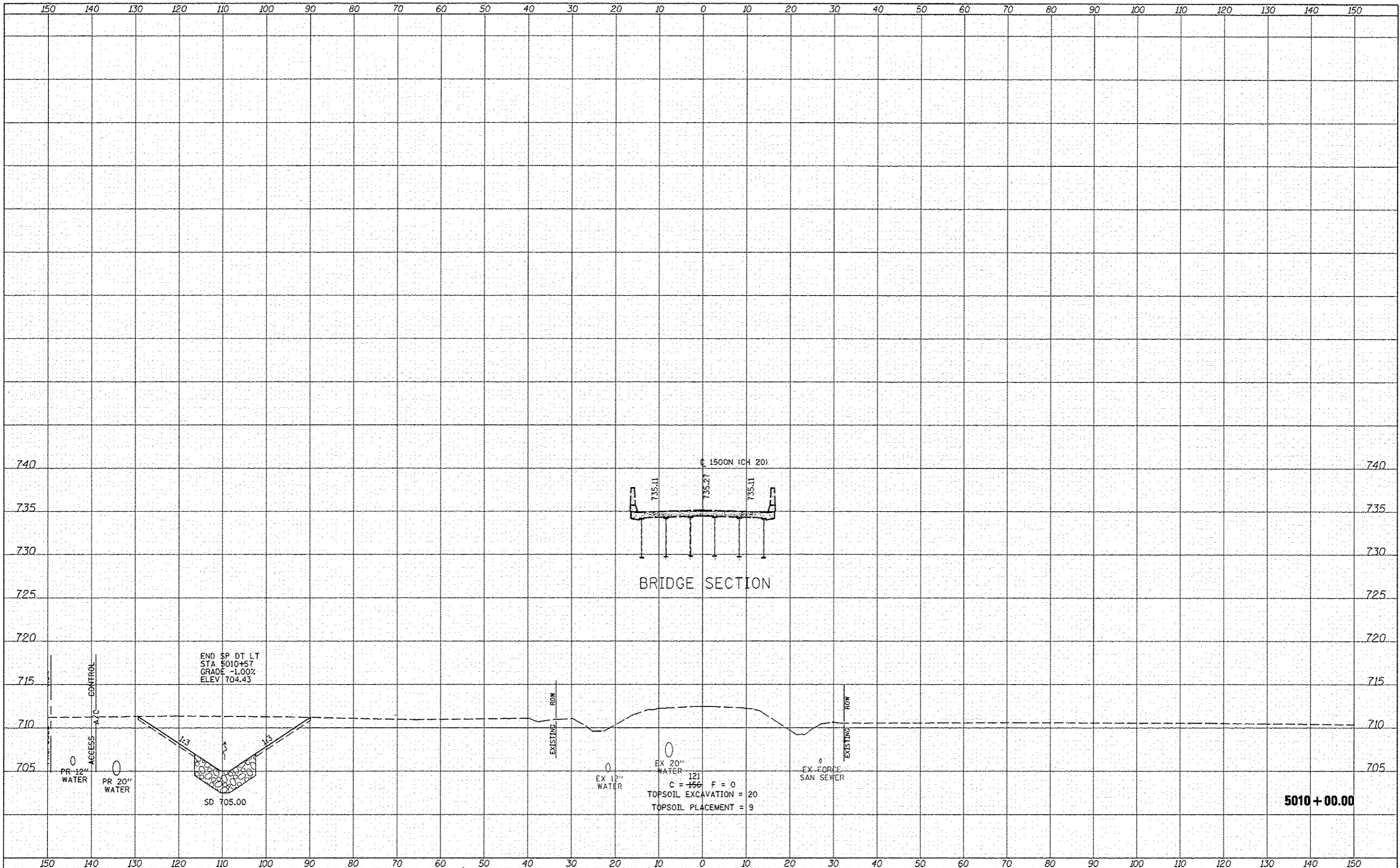

FILE NAME: \\transportation\2891\Grading Plans\CADD Sheets\046842-9ht-ssht\CH20.dgn	USER NAME: jdean	DESIGNED: JRB	REVISED: 02/21/2013	STATE OF ILLINOIS DEPARTMENT OF TRANSPORTATION	FAP 407 (IL RTE 336) CROSS SECTIONS - 1500N (CH 20)			F.A.P. RTE. 407	SECTION 155-31A	COUNTY McDONOUGH	TOTAL SHEETS 671	SHEET NO. 564
PLT SCALE: 20.00' / 1"	CHECKED: AWM	DATE: 12-12-12	REVISED:		SCALE: 1" = 20'	SHEET NO. 7 OF 27 SHEETS	STA. 5010+00.00 TO STA. 5010+00.00	CONTRACT NO. 68A42 ILLINOIS FED. AID PROJECT				