

STATE OF ILLINOIS
 DEPARTMENT OF TRANSPORTATION
 DIVISION OF HIGHWAYS

**PROPOSED
 HIGHWAY PLANS**

FAP ROUTE 75 (IL 29)
 SECTION (6) L
 PROJECT HSIP-0075 (157)
 ADDITION OF OVERHEAD LIGHTING
 SANGAMON COUNTY
 C-96-046-12

F.A.P. RTE.	SECTION	COUNTY	TOTAL SHEETS	SHEET NO.
75	(6) L	SANGAMON	7	1
		ILLINOIS	CONTRACT NO.	72F31

* 7+1=8

D-96-046-12

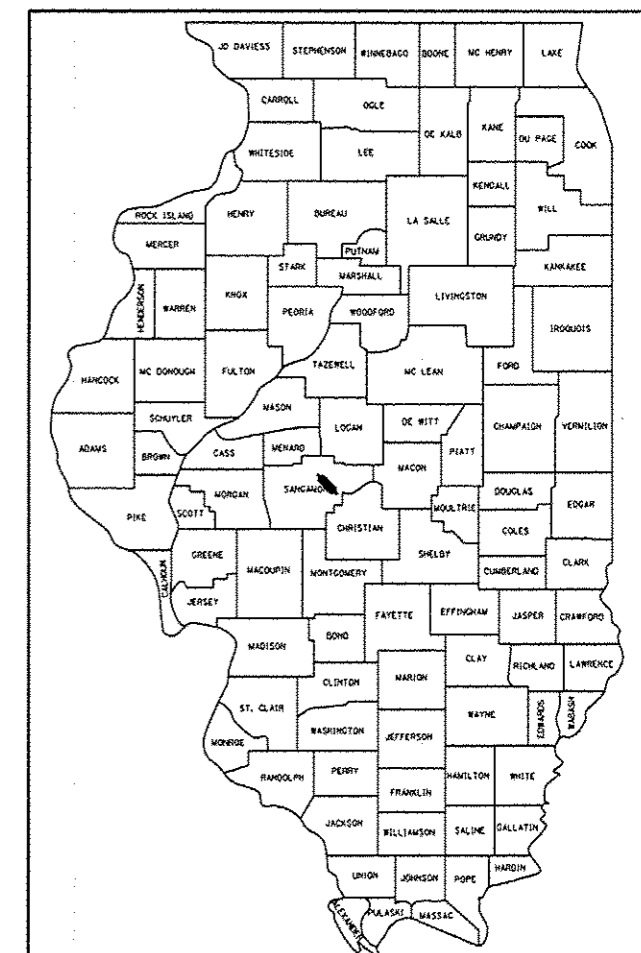

LOCATION OF SECTION INDICATED THUS: - [Symbol]

INDEX OF SHEETS

- 1 COVER SHEET
- 2 GENERAL NOTES
- 3 SUMMARY OF QUANTITIES
- 4-5 PLAN SHEETS
- 6-7 PLAN DETAILS

STANDARDS

- 000001-06
- 001006
- 701101-03
- 701106-02
- 701421-05
- 701701-08
- 701901-02
- 825001-01
- 830006-01
- 836001-02

PROJECT LOCATION

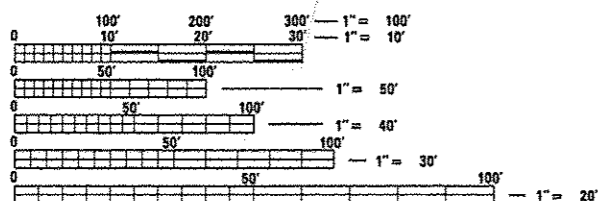
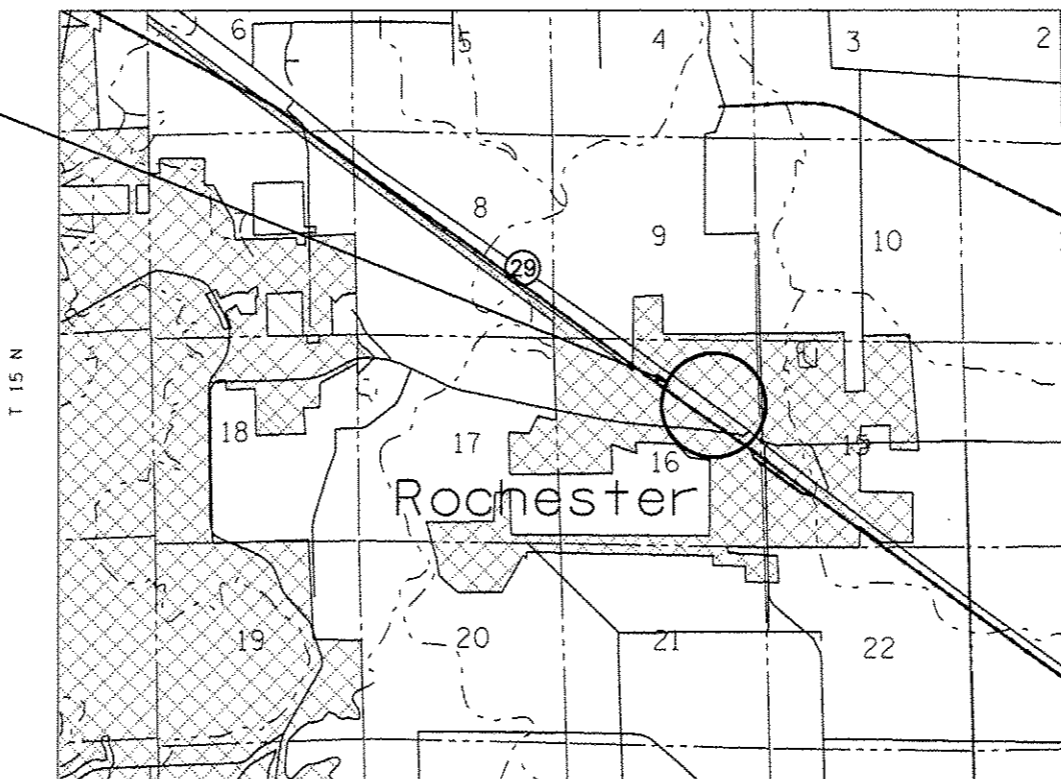

FULL SIZE PLANS HAVE BEEN PREPARED USING STANDARD ENGINEERING SCALES. REDUCED SIZED PLANS WILL NOT CONFORM TO STANDARD SCALES. IN MAKING MEASUREMENTS ON REDUCED PLANS, THE ABOVE SCALES MAY BE USED.

J.U.L.I.E.
 JOINT UTILITY LOCATION INFORMATION FOR EXCAVATION
 1-800-892-0123
 OR 811

PROJECT ENGINEER: JEFF MYERS (217) 782-4761
 PROJECT MANAGER: GARY TURNER (217) 524-0946

GROSS LENGTH = 2215.37 FT. = 0.42 MILE
 NET LENGTH = 2215.37 FT. = 0.42 MILE

CONTRACT NO. 72F31

STATE OF ILLINOIS
 DEPARTMENT OF TRANSPORTATION
 DIVISION OF HIGHWAYS

SUBMITTED Dec 14 20 12
Ray Z. Dinkley
 DEPUTY DIRECTOR OF HIGHWAYS, REGION ENGINEER

Feb 1 20 13
John D. Baranzelli, P.E.
 ENGINEER OF DESIGN AND ENVIRONMENT

Feb 1 20 13
Over Osman, P.E.
 DIRECTOR OF HIGHWAYS, CHIEF ENGINEER

**PRINTED BY THE AUTHORITY
 OF THE STATE OF ILLINOIS**