

EXIST. CURVE 120  
 PI STA. = 94+37.62  
 $\Delta = 5^\circ 26' 40''$  (RT)  
 $D = 0^\circ 39' 30''$   
 $R = 8,704.90'$   
 $T = 413.90'$   
 $L = 827.18'$   
 $E = 9.83'$   
 $e = N.C.$   
 P.C. STA. = 90+23.72  
 P.T. STA. = 98+50.90

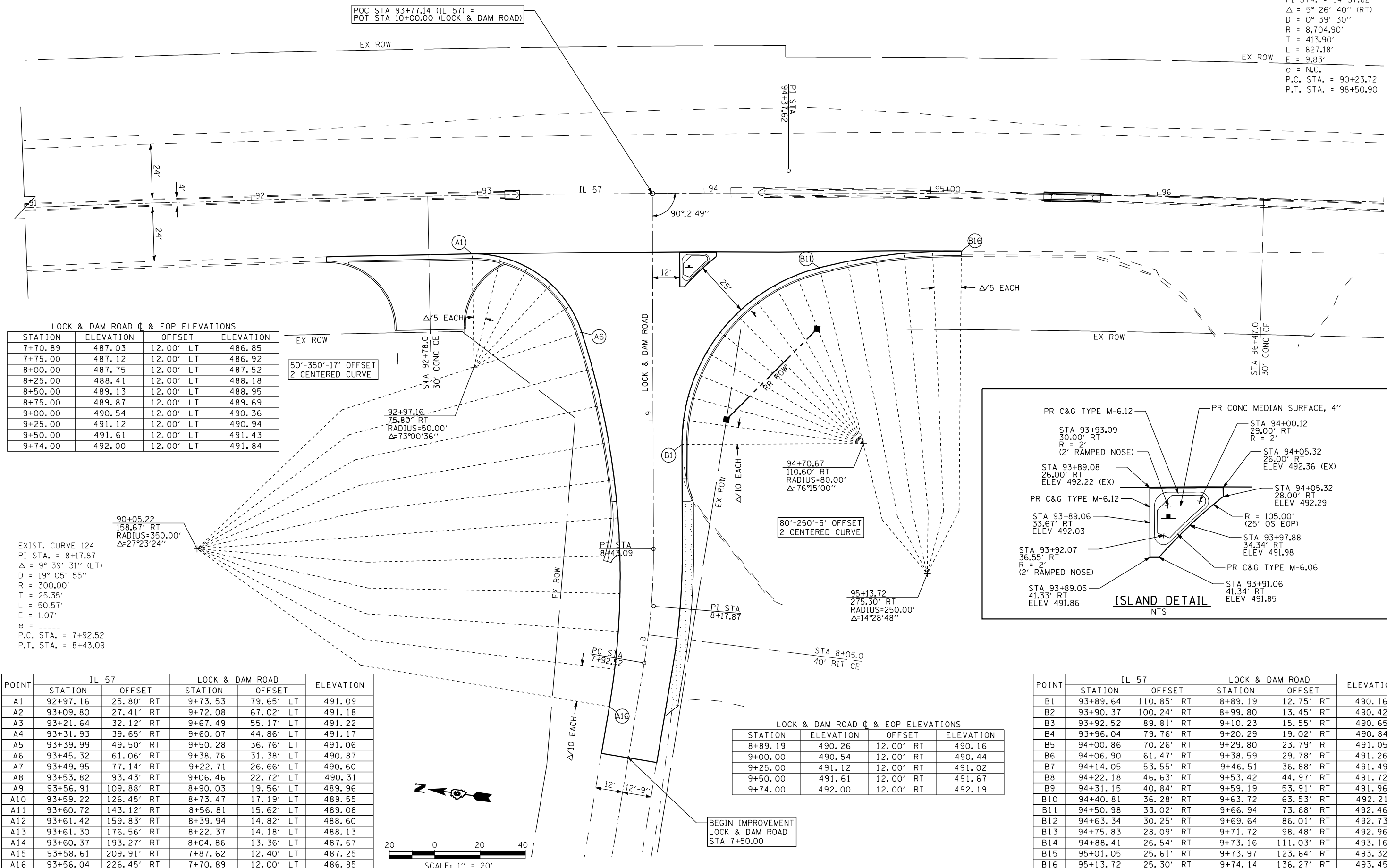

**LOCK & DAM ROAD C & EOP ELEVATIONS**

STATION	ELEVATION	OFFSET	ELEVATION
7+70.89	487.03	12.00' LT	486.85
7+75.00	487.12	12.00' LT	486.92
8+00.00	487.75	12.00' LT	487.52
8+25.00	488.41	12.00' LT	488.18
8+50.00	489.13	12.00' LT	488.95
8+75.00	489.87	12.00' LT	489.69
9+00.00	490.54	12.00' LT	490.36
9+25.00	491.12	12.00' LT	490.94
9+50.00	491.61	12.00' LT	491.43
9+74.00	492.00	12.00' LT	491.84

EXIST. CURVE 124  
 PI STA. = 8+17.87  
 $\Delta = 9^\circ 39' 31''$  (LT)  
 $D = 19^\circ 05' 55''$   
 $R = 300.00'$   
 $T = 25.35'$   
 $L = 50.57'$   
 $E = 1.07'$   
 $e =$   
 P.C. STA. = 7+92.52  
 P.T. STA. = 8+43.09

POINT	IL 57		LOCK & DAM ROAD		ELEVATION
	STATION	OFFSET	STATION	OFFSET	
A1	92+97.16	25.80' RT	9+73.53	79.65' LT	491.09
A2	93+09.80	27.41' RT	9+72.08	67.02' LT	491.18
A3	93+21.64	32.12' RT	9+67.49	55.17' LT	491.22
A4	93+31.93	39.65' RT	9+60.07	44.86' LT	491.17
A5	93+39.99	49.50' RT	9+50.28	36.76' LT	491.06
A6	93+45.32	61.06' RT	9+38.76	31.38' LT	490.87
A7	93+49.95	77.14' RT	9+22.71	26.66' LT	490.60
A8	93+53.82	93.43' RT	9+06.46	22.72' LT	490.31
A9	93+56.91	109.88' RT	8+90.03	19.56' LT	489.96
A10	93+59.22	126.45' RT	8+73.47	17.19' LT	489.55
A11	93+60.72	143.12' RT	8+56.81	15.62' LT	489.08
A12	93+61.42	159.83' RT	8+39.94	14.82' LT	488.60
A13	93+61.30	176.56' RT	8+22.37	14.18' LT	488.13
A14	93+60.37	193.27' RT	8+04.86	13.36' LT	487.67
A15	93+58.61	209.91' RT	7+87.62	12.40' LT	487.25
A16	93+56.04	226.45' RT	7+70.89	12.00' LT	486.85

**LOCK & DAM ROAD C & EOP ELEVATIONS**

STATION	ELEVATION	OFFSET	ELEVATION
8+89.19	490.26	12.00' RT	490.16
9+00.00	490.54	12.00' RT	490.44
9+25.00	491.12	12.00' RT	491.02
9+50.00	491.61	12.00' RT	491.67
9+74.00	492.00	12.00' RT	492.19

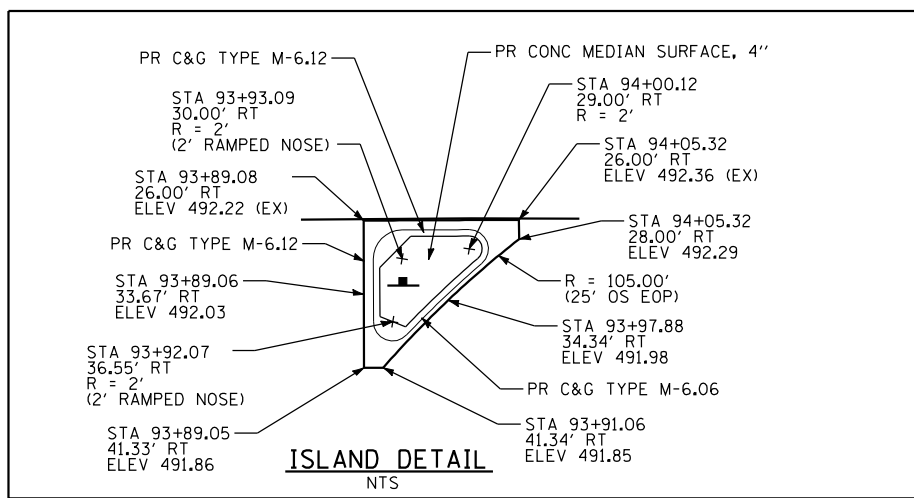

POINT	IL 57		LOCK & DAM ROAD		ELEVATION
	STATION	OFFSET	STATION	OFFSET	
B1	93+89.64	110.85' RT	8+89.19	12.75' RT	490.16
B2	93+90.37	100.24' RT	8+99.80	13.45' RT	490.42
B3	93+92.52	89.81' RT	9+10.23	15.55' RT	490.65
B4	93+96.04	79.76' RT	9+20.29	19.02' RT	490.84
B5	94+00.86	70.26' RT	9+29.80	23.79' RT	491.05
B6	94+06.90	61.47' RT	9+38.59	29.78' RT	491.26
B7	94+14.05	53.55' RT	9+46.51	36.88' RT	491.49
B8	94+22.18	46.63' RT	9+53.42	44.97' RT	491.72
B9	94+31.15	40.84' RT	9+59.19	53.91' RT	491.96
B10	94+40.81	36.28' RT	9+63.72	63.53' RT	492.21
B11	94+50.98	33.02' RT	9+66.94	73.68' RT	492.46
B12	94+63.34	30.25' RT	9+69.64	86.01' RT	492.73
B13	94+75.83	28.09' RT	9+71.72	98.48' RT	492.96
B14	94+88.41	26.54' RT	9+73.16	111.03' RT	493.16
B15	95+01.05	25.61' RT	9+73.97	123.64' RT	493.32
B16	95+13.72	25.30' RT	9+74.14	136.27' RT	493.45