

ELEVATION

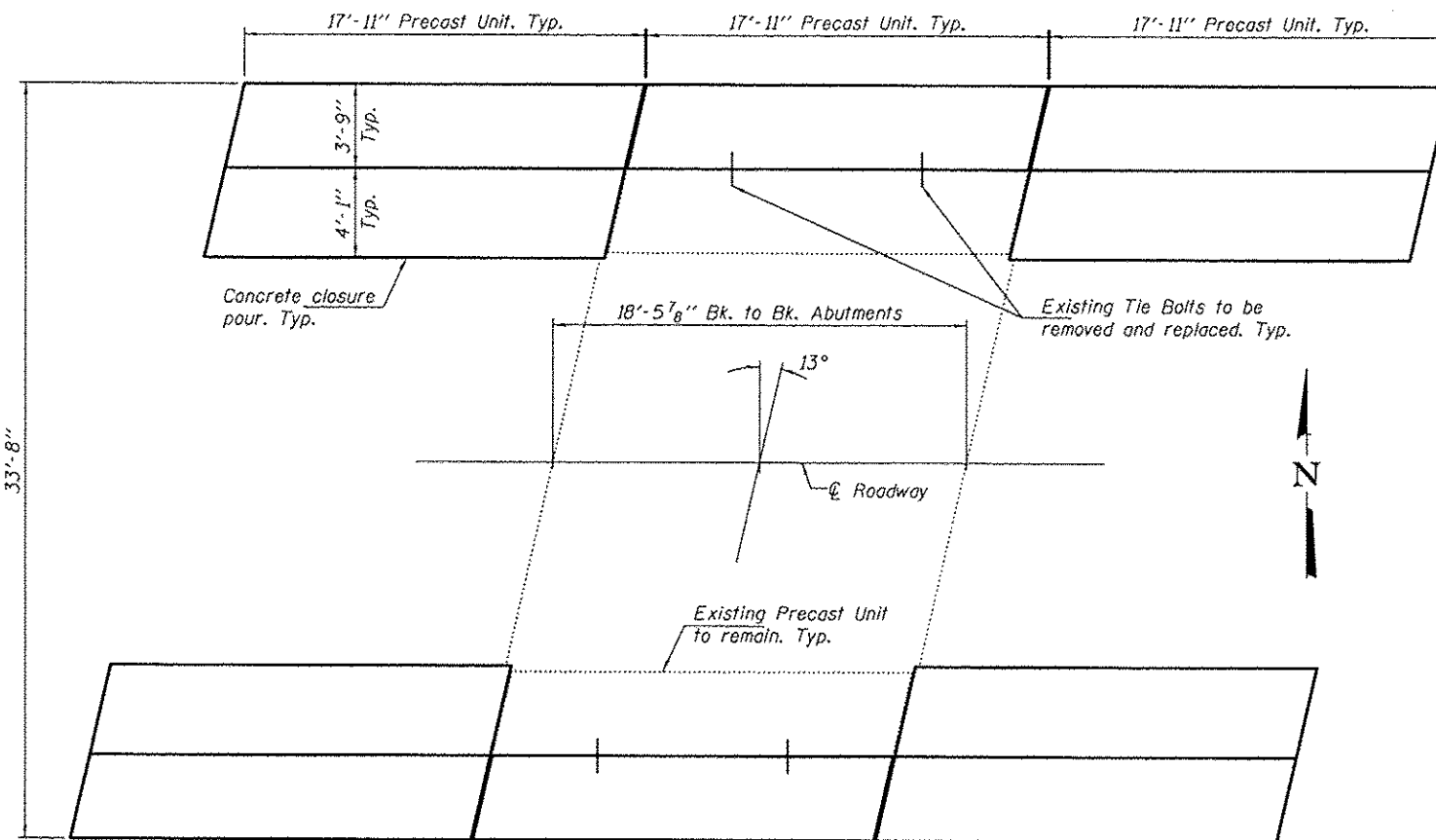

PLAN

GENERAL NOTES

Plan dimensions and details relative to existing structure have been taken from existing plans and are subject to nominal construction variations. It shall be the Contractor's responsibility to verify such dimensions and details in the field and make necessary approved adjustments prior to construction or ordering of materials. Such variations shall not be cause for additional compensation for a change in the scope of the work, however, the Contractor will be paid for the quantity actually furnished at the unit price bid for the work.

Any damage done to the bridge during Precast Unit removal shall be repaired by the Contractor. Cost to be included in the cost of Removal of Existing Precast Concrete Units.

Temporary concrete barrier shall only be anchored into the overlay and not the Precast Concrete Units.

Reinforcement bars designated (E) shall be epoxy coated.

The contractor shall salvage the existing bridge rail and posts and shall deliver them to:

IDOT Maintenance Facility
12540 Sportsman Road
Highland, Illinois 62249
Contact: Todd Reilson at 618-659-5110
Cost included with Bridge Rail Removal.

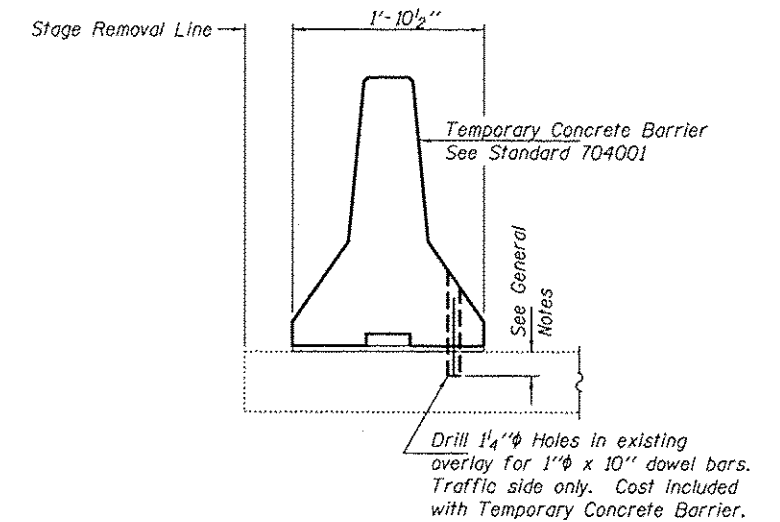

SECTION THRU SLAB

TOTAL BILL OF MATERIAL

| ITEM | UNIT | QUANTITY |
|--|---------|----------|
| Precast Concrete Bridge Slab | Sq. Ft. | 403 |
| Removal of Existing Precast Concrete Units | Sq. Ft. | 403 |
| Bridge Rail Removal | Foot | 108 |
| Reinforcement Bars, Epoxy Coated | Pound | 2230 |
| Steel Railing, Type SM | Foot | 108 |
| Waterproofing Membrane System | Sq. Yd. | 44.8 |
| Concrete Removal | Cu. Yd. | 13.5 |
| Concrete Superstructure | Cu. Yd. | 13.5 |

* On Precast Concrete Bridge Slab only.
For quantity of HMA Surface Course, see roadway plans

DESIGN STRESSES

PC UNITS

$f'_c = 1,800$ psi
 $f'_c = 4,500$ psi
 $f_s = 20,000$ psi (Reinforcement)
 $n = 8$

FIELD UNITS

$f'_c = 3,500$ psi
 $f_y = 60,000$ psi (Reinforcement)



EXPIRES 11-30-2014

| | | |
|--------------------------------|---|------------------------|
| DESIGNED: <i>John S. Vecit</i> | EXAMINED: <i>Timothy A. ...</i> | DATE: JANUARY 31, 2013 |
| CHECKED: <i>John S. Vecit</i> | PASSED: <i>David Carl Puzey</i> | REVISED: _____ |
| DRAWN: <i>Doliva</i> | ACTING ENGINEER OF BRIDGES AND STRUCTURES | REVISED: _____ |
| CHECKED: <i>VP</i> | | |

STATE OF ILLINOIS
DEPARTMENT OF TRANSPORTATION

PLAN AND ELEVATION
FAP 789 (IL. RTE. 143) OVER E. TRIBUTARY TO SILVER CREEK
SN 060-0249

| | | | | |
|-----------------|-----------------------|----------------|--------------------|--------------|
| F.A.P. RTE. 789 | SECTION 154.58.60RS-4 | COUNTY MADISON | TOTAL SHEETS 44 | SHEET NO. 40 |
| | | | CONTRACT NO. 76F27 | |

SHEET NO. 1 OF 5 SHEETS

ILLINOIS FED. AID PROJECT