

\DBCONN-99-MOTIF.LDGN, \DBCONN-17-BORDER.LDGN, \DBCONN-17-MOTIF.LDGN, \DBCONN-06-MOTIF.LDGN, \DBCONN-11-MOTIF.LDGN, \DBCONN-08-LEGEND.LDGN, \DBCONN-08-LAYOUT.LDGN, \DBCONN-17-LANDSCAP.LDGN, \DBTRF-76C52-MOTIF.LDGN
 12-17-2012, 14:08:40 BONDHUJ \FS-004\AM VALL.D, TRANS.07-2202-28868-001\CIVIL\CAD\99 ALL CONTRACTS\CONNSHEETS CONTRACT 17\DBCONN-17-SHT-LANDSCAP-19000.DGN

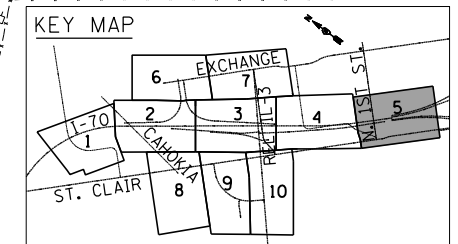
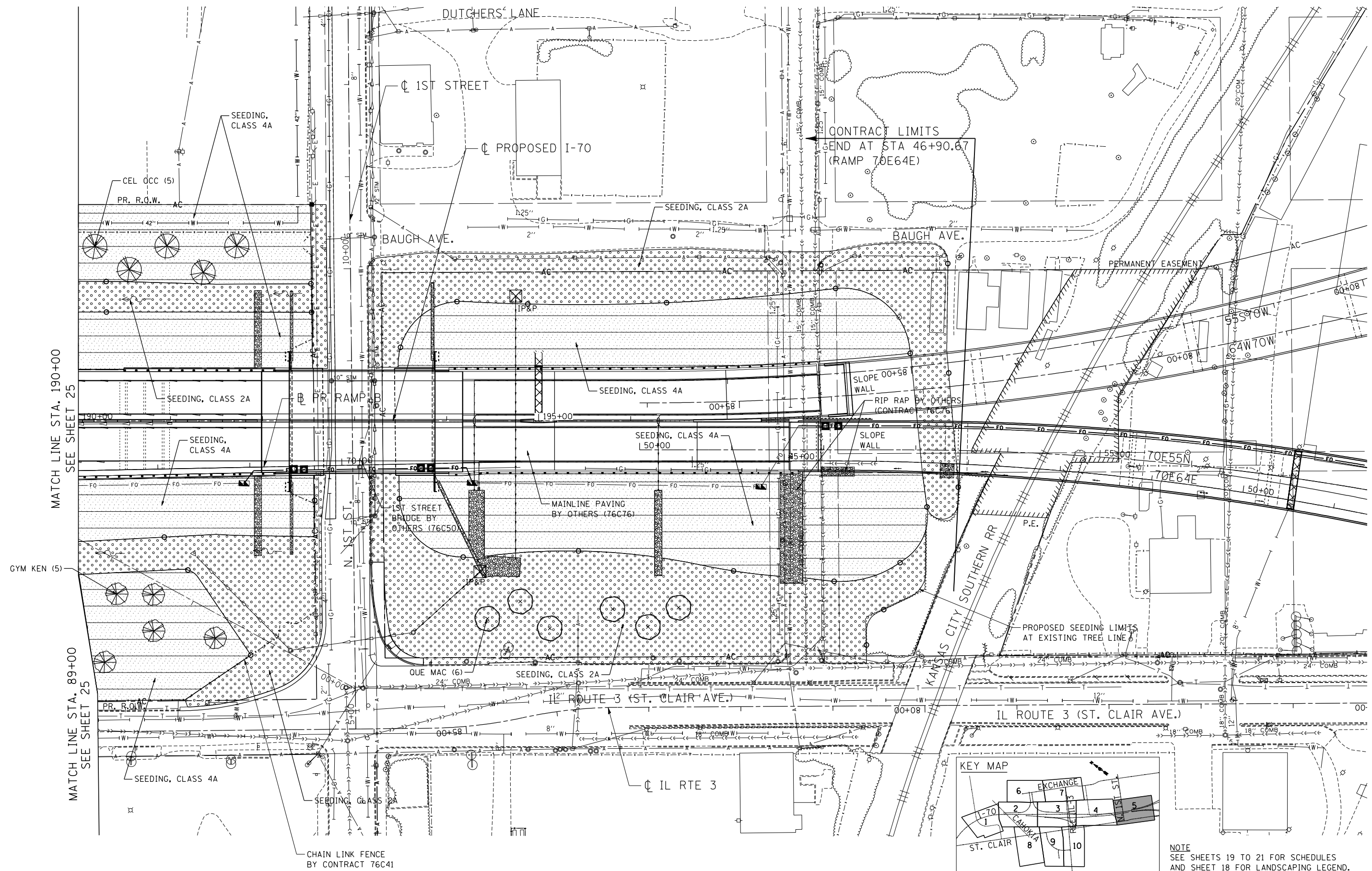

NOTE
SEE SHEETS 19 TO 21 FOR SCHEDULES
AND SHEET 18 FOR LANDSCAPING LEGEND.

FILE NAME =
#FILEL#

USER NAME = #USER#
PLOT SCALE = #SCALE#
PLOT DATE = #DATE#

DESIGNED - JB
DRAWN - JB
CHECKED - ACL
DATE - 12/21/12

REVISED -
REVISED -
REVISED -
REVISED -

STATE OF ILLINOIS
DEPARTMENT OF TRANSPORTATION
I-70 CONNECTION

PROPOSED I-70
LANDSCAPING PLAN
STA. 190+00 TO TRI-LEVEL
SCALE: 1"=50'
SHEET NO. 5 OF 10 SHEETS STA. TO STA.

F.A.P. RTE.	SECTION	COUNTY	TOTAL SHEETS	SHEET NO.
998	82-2-1LS	ST. CLAIR	71	26
CONTRACT NO. 76F39				
FED. ROAD DIST. NO. ILLINOIS FED. AID PROJECT				



TENG & ASSOCIATES, INC.
ENGINEERS/ARCHITECTS/PLANNERS
CHICAGO, ILLINOIS