

| TBE Pole Number | Approximate Location | Identification # on Pole | Utilities Attached to Poles | Utility Owners | Notes: Additional Items Attached to Poles |
|-----------------|--|--------------------------|-----------------------------|-----------------|---|
| 465 | W OF POLE 464 | 737405 | ELECTRIC | AMEREN ELECTRIC | GUY S |
| 631 | 584' W OF INDUSTRIAL CL N/S OF ST CLAIR | NO TAG | ELECTRIC | AMEREN ELECTRIC | |
| 632 | 591' W OF INDUSTRIAL CL N/S OF ST CLAIR | NO TAG | ELECTRIC | AMEREN ELECTRIC | |
| 633 | 718' W OF INDUSTRIAL CL N/S OF ST CLAIR | NO TAG | ELECTRIC | AMEREN ELECTRIC | |
| 634 | 768' W OF INDUSTRIAL CL S/S OF ST CLAIR | 19067 | ELECTRIC | AMEREN ELECTRIC | |
| 635 | 852' W OF INDUSTRIAL CL N/S OF ST CLAIR | NO TAG | ELECTRIC | AMEREN ELECTRIC | GUY - NE |
| 636 | 845' W OF INDUSTRIAL CL S/S OF ST CLAIR | 19068 | ELECTRIC | AMEREN ELECTRIC | |
| 637 | 979' W OF INDUSTRIAL CL N/S OF ST CLAIR | NO TAG | ELECTRIC | AMEREN ELECTRIC | |
| 638 | 988' W OF INDUSTRIAL CL S/S OF ST CLAIR | 19069 | ELECTRIC | AMEREN ELECTRIC | |
| 639 | 1112' W OF INDUSTRIAL CL N/S OF ST CLAIR | 397112 | NO UTILITIES | | GUY - SE |
| 640 | 1113' W OF INDUSTRIAL CL N/S OF ST CLAIR | NO TAG | ELECTRIC | AMEREN ELECTRIC | GUY - SE |
| 641 | 1144' W OF INDUSTRIAL CL S/S OF ST CLAIR | 19070 | ELECTRIC | AMEREN ELECTRIC | GUY - NW |
| 642 | 1192' W OF INDUSTRIAL CL S/S OF ST CLAIR | 19071 | NO UTILITIES | | GUY - NW |
| 643 | 1274' W OF INDUSTRIAL CL N/S OF ST CLAIR | NO TAG | ELECTRIC | AMEREN ELECTRIC | |
| 644 | 1439' W OF INDUSTRIAL CL N/S OF ST CLAIR | NO TAG | ELECTRIC | AMEREN ELECTRIC | |
| 648 | 594' W OF INDUSTRIAL CL S/S OF ST CLAIR | 19066 | ELECTRIC | AMEREN ELECTRIC | |

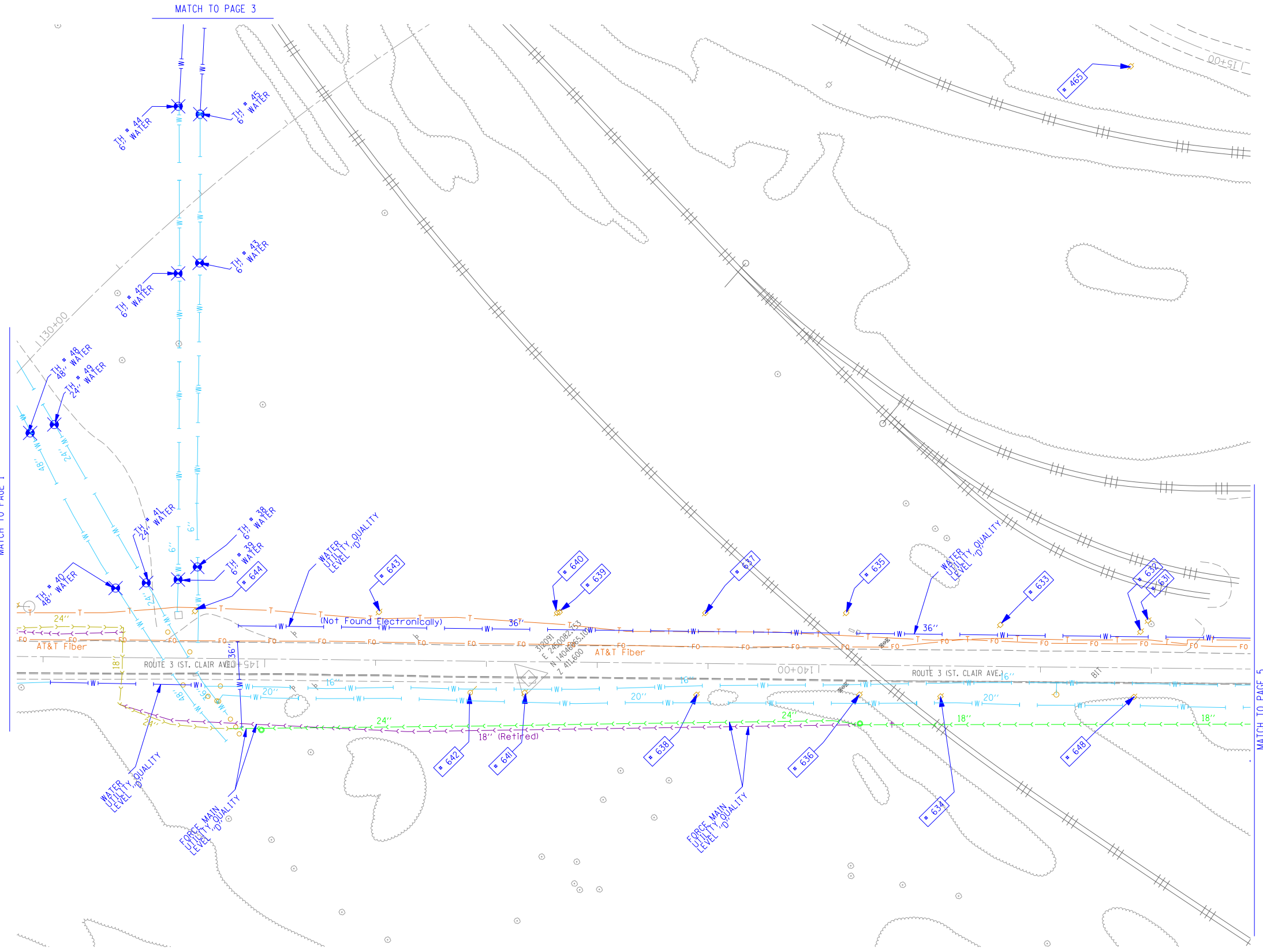

- UNKNOWN
- ABANDONED SANITARY
- FORCE MAIN (OL "D")
- CABLE TV
- TELEPHONE
- GAS (OL "D")
- ELECTRIC
- WATER
- WATER (OL "D")
- FIBER OPTIC (OL "D")
- WELL DRAINAGE
- UTILITY POLE
- TBE TEST HOLE

Utilities shown in color on these plans as depicted in the legend have been investigated by TBE Group, Inc in accordance with SUE Industry Standards. All other information shown has been provided to TBE Group, Inc by others. TBE's SUE field investigation was finished on 5/22/09. Changes to utilities after this date may have been made and therefore may result in variances from this plan. Consideration should be given to updating this plan if deemed advisable prior to final design and construction.

All sheets are printed in black and white. Color copies are available upon request.

ALL UTILITIES SHOWN QUALITY LEVEL "B" UNLESS NOTED OTHERWISE.

Utility Quality Level "A" : Test Hole
 Utility Quality Level "B" : Designating
 Utility Quality Level "C" : Research with Survey
 Utility Quality Level "D" : Records Research

TBE GROUP, INC.
 CIVIL ENGINEERING • TRANSPORTATION • ENVIRONMENTAL
 PLANNING • UTILITY ENGINEERING/LOCATING

Checked By: _____
 Date: _____

TBE Job No. IL09500601-602-603-604-607-608-609
 SUE Plan Pages: 2 of 35

| | | | |
|-------------|-----------------------|---------------------|--|
| FILE NAME = | USER NAME = | DESIGNED EG, JP, LP | REVISED |
| *FILE# | | DRAWN KLC | 7/28/09 - 8/26/09 ADDED TEST HOLES #60-108 |
| | PLOT SCALE = 1" = 50' | CHECKED JB | REVISED |
| | PLOT DATE = *DATE* | DATE 9/15/09 | REVISED |

STATE OF ILLINOIS
DEPARTMENT OF TRANSPORTATION

Mississippi River Bridge Project

SCALE: SHEET NO. STA. TO STA.

| | | | | |
|--|----------|-----------|--------------|-----------|
| F.A.P. RTE. | SECTION | COUNTY | TOTAL SHEETS | SHEET NO. |
| | 82-2-1LS | St. Clair | 71 | 35 |
| PTB NO. 147-038 | | | | |
| FED. ROAD DIST. NO. ILLINOIS Job No. D-98-061-08 | | | | |