

FAS ROUTE NO	SEC	COUNTY	TOTAL SHEETS	SHEET NO
188	*	LEE	22	5
ILLINOIS PROJECT BRS-0188(121)				
* 08-00303-00-BR				

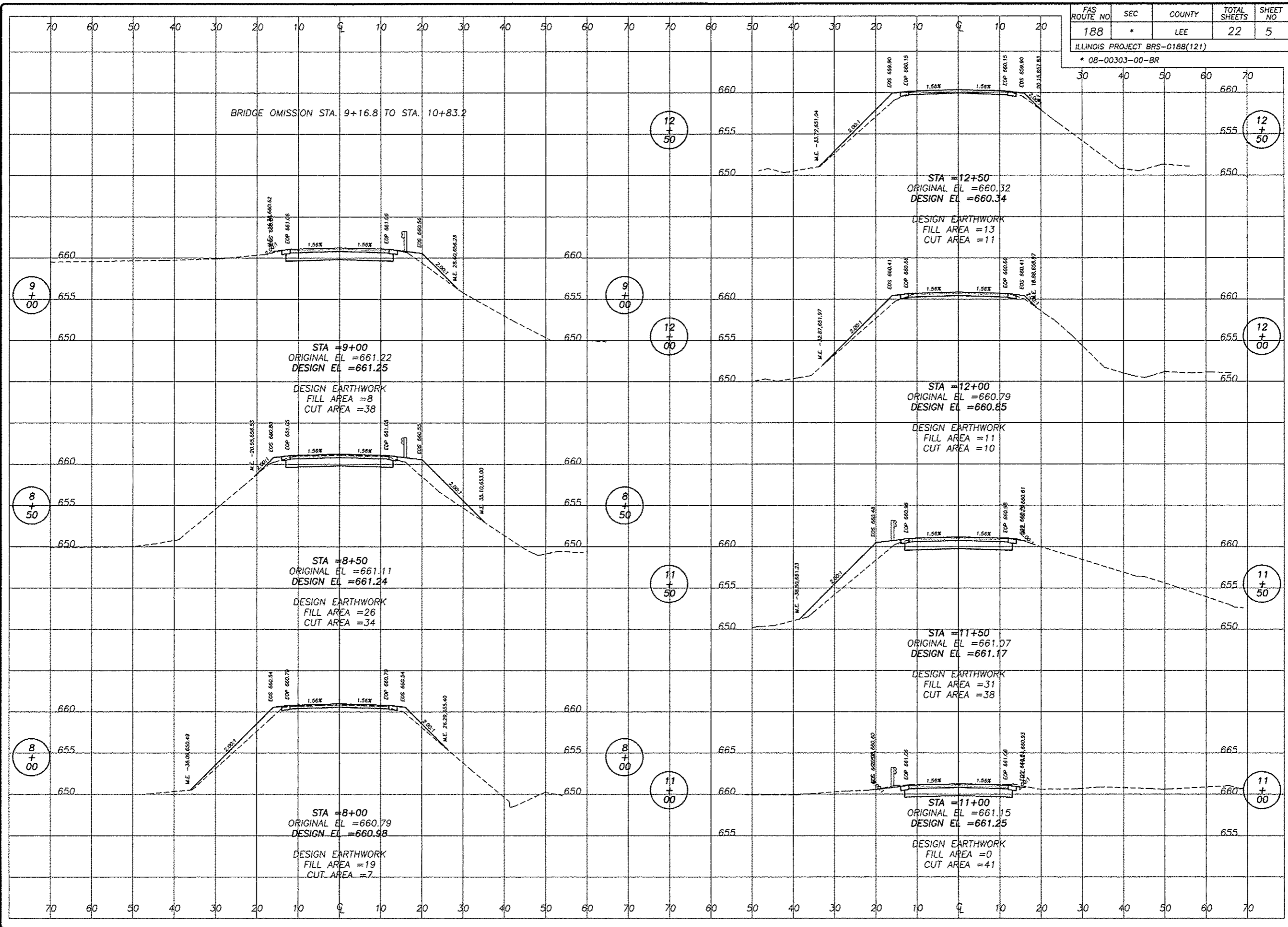

REVISIONS	DATE	REVISION

DESIGNED BY	DRAWN BY	CHECKED BY	DATE

wendler
 wendler engineering services, inc.
 geotechnical solutions
 engineers - surveyors - scientists
 www.wendlerinc.com ph: 815.238.2281
 Illinois Professional Design Firm No. 154272828X

CROSS SECTIONS
 OF
 INDIAN HEAD ROAD BRIDGE
 FOR
 LEE COUNTY HIGHWAY DEPARTMENT

SHEET TITLE
 CROSS SECTIONS

JOB NUMBER
 2080334

DATE
 11/19/2012

SHEET NO.
 5 of 22