

CURVE 1	CURVE 2	CURVE 2A	CURVE 2B
PI STA. = 107+76.40	PI STA. = 107+95.13	PI STA. = 111+81.42	PI STA. = 112+74.72
$\Delta = 10^\circ 44' 05''$ (RT)	$\Delta = 10^\circ 44' 05''$ (LT)	$\Delta = 2^\circ 51' 45''$ (LT)	$\Delta = 2^\circ 51' 45''$ (RT)
D = 57° 17' 45"	D = 57° 17' 45"	D = 57° 17' 45"	D = 57° 17' 45"
R = 100.00'	R = 100.00'	R = 100.00'	R = 100.00'
T = 9.40'	T = 9.40'	T = 2.50'	T = 2.50'
L = 18.74'	L = 18.74'	L = 5.00'	L = 5.00'
E = 0.44'	E = 0.44'	E = 0.03'	E = 0.03'
$\theta =$ -----	$\theta =$ -----	$\theta =$ -----	$\theta =$ -----
T.R. = -----	T.R. = -----	T.R. = -----	T.R. = -----
S.E. RUN = -----	S.E. RUN = -----	S.E. RUN = -----	S.E. RUN = -----
P.C. STA. = 107+67.00	P.C. STA. = 107+85.74	P.C. STA. = 111+78.92	P.C. STA. = 112+72.22
P.T. STA. = 107+85.74	P.T. STA. = 108+04.47	P.T. STA. = 111+83.92	P.T. STA. = 112+77.22

CONTROL	NORTHING	EASTING
POT STA 99+00.00	1263586.674	1176766.182
PC STA 107+67.00	1264453.644	1176758.928
PRC STA 107+85.73	1264472.284	1176760.522
PT STA 108+04.47	1264490.925	1176762.116
PC STA 111+78.92	1264865.361	1176758.984
PT STA 111+83.92	1264870.354	1176758.817
PC STA 112+72.22	1264985.510	1176753.669
PT STA 117+77.22	1264963.502	1176753.503

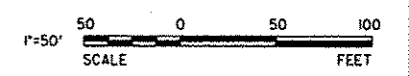

CURVE 2C	CURVE 2D
PI STA. = 116+33.40	PI STA. = 116+51.59
$\Delta = 10^\circ 25' 07''$ (RT)	$\Delta = 10^\circ 25' 07''$ (LT)
D = 57° 17' 45"	D = 57° 17' 45"
R = 100.00'	R = 100.00'
T = 9.12'	T = 9.12'
L = 18.18'	L = 18.18'
E = 0.41'	E = 0.41'
$\theta =$ -----	$\theta =$ -----
T.R. = -----	T.R. = -----
S.E. RUN = -----	S.E. RUN = -----
P.C. STA. = 116+24.30	P.C. STA. = 116+42.49
P.T. STA. = 116+42.49	P.T. STA. = 116+60.67

CURVE 3
PI STA. = 126+21.21
$\Delta = 88^\circ 37' 51''$ (RT)
D = 381° 58' 19"
R = 15.00'
T = 14.65'
L = 23.20'
E = 5.96'
$\theta =$ -----
T.R. = -----
S.E. RUN = -----
P.C. STA. = 126+06.57
P.T. STA. = 126+29.77

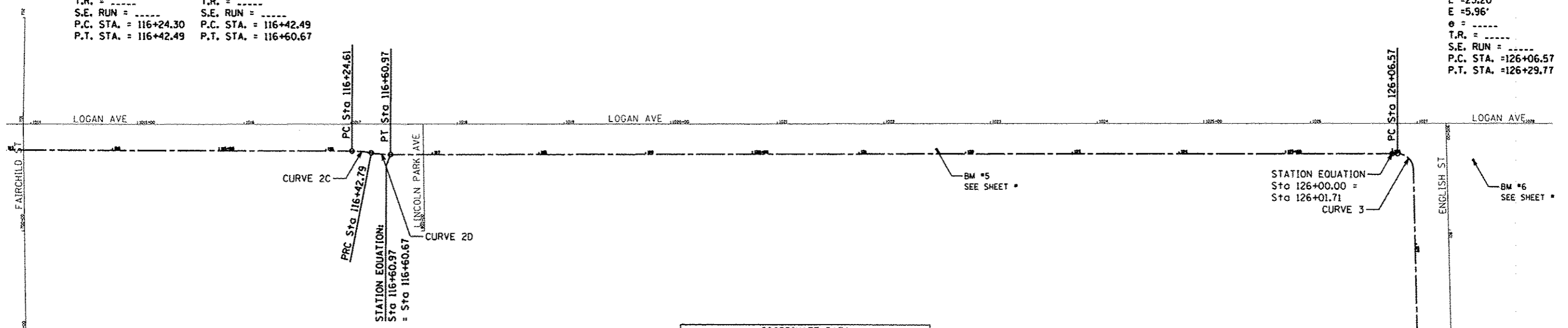

CONTROL	NORTHING	EASTING
PC STA 116+24.30	1265310.875	1176750.597
PRC STA 116+42.49	1265328.978	1176752.025
PT STA 116+60.67	1265347.080	1176753.453
PC STA 126+06.57	1266291.191	1176741.928

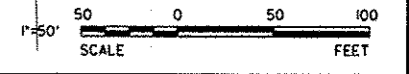

PRINTED DATE: 10/10/2012
 P:\Projects\2012\10-10-12-163-Danville-Historic-District-Shared-Use-Path-10-10-12.dwg

ESI CONSULTANTS, LTD
 753 WINDSOR ROAD
 CHARLESTON, IL 61820
 (217) 348-1900
 WWW.ESI-CONSULTANTS.COM
 ILLINOIS DEPARTMENT OF PROFESSIONAL REGULATION REGISTRATION #184-003905

CITY OF DANVILLE
 1155 E. VOORHEES STREET
 SUITE A
 DANVILLE, IL 61832

NO.	DATE	DESCRIPTION OF REVISIONS	NO.	DATE	DESCRIPTION OF REVISIONS

SECTION NO. 08-00224-00-BT	ENGR: ADG
ESI PROJECT NO: 07-163-074-01	DRAWN BY: ADG
DATE: 10-31-2012	DRAWN BY: JEH
	QC/QA: DLCPAT

LINCOLN PARK HISTORIC DIST SHARED USE PATH
 CITY OF DANVILLE, VERMILION COUNTY

ALIGNMENT
 STA 100+00 TO STA 126+50
 SHEET 1 OF 3

10
 OF 40