

SECTION THRU ABUTMENT

NOTES
 All exposed edges shall have standard 3/4" chamfer.
 Space reinforcement in cap to miss beam anchor dowels.
 Wingwalls and Backwalls may, at the contractor's option, be cast monolithically.
 Hatched area and wingwalls shall be poured after deck beams are anchored in place.

BILL OF MATERIAL EAST ABUTMENT

BAR	NO.	SIZE	LENGTH	SHAPE
h	6	#4	34'-0"	—
h1	12	#7	10'-11"	—
h2	6	#4	8'-3"	—
h3	14	#7	13'-1"	—
h4	6	#4	10'-9"	—
p	8	#7	30'-9"	—
p1	8	#5	30'-9"	—
s	56	#4	9'-4"	□
s1	4	#4	9'-5"	□
u	12	#6	10'-2"	□
v	62	#4	3'-9"	—
v1	4	#4	9'-11"	—
v2	8	#4	5'-11"	—
v3	7	#4	12'-2"	—
v4	8	#4	7'-9"	—
Structure Excavation				Cu. Yd. 78
Concrete Structures				Cu. Yd. 20.4
Reinforcement Bars				Pound 2485
Furnishing Metal Shell Piles 12"x0.250"				Foot 268
Driving Piles				Foot 268
Test Pile Metal Shells				Each 1
Controlled Low Strength Material				Cu. Yd. 14.4

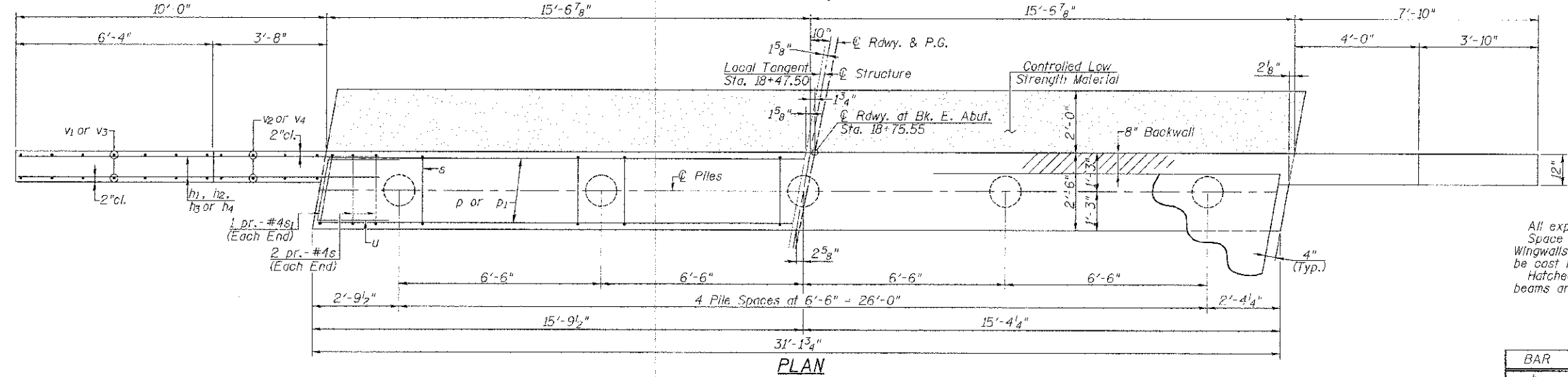

ELEVATION (E. Abut. Looking East)

PLAN

PILE DATA

E. Abut.
 Pile Type & Size: Metal Shell Piles
 12" ϕ x 0.25" walls
 Nominal Required Bearing: 348 Kips
 Factored Resistance Available: 192 Kips
 Estimated Pile Length: 67'
 Number of Production: 4
 Number of Test Piles: 1

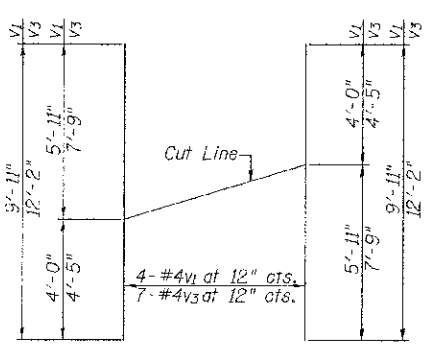

V1 & V3 - BAR CUT DIAGRAM
 Order v1 & v3 bars full length; Layout in field according to diagram. Cut v1 & v3 bars along cut line. Use remainder of each bar in opposite face.

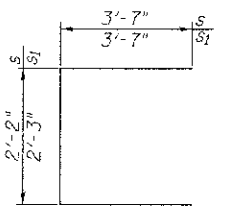

BARS s & s1

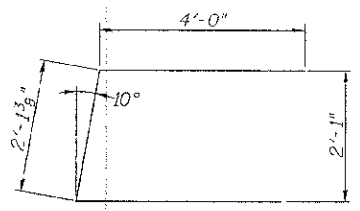

BAR u

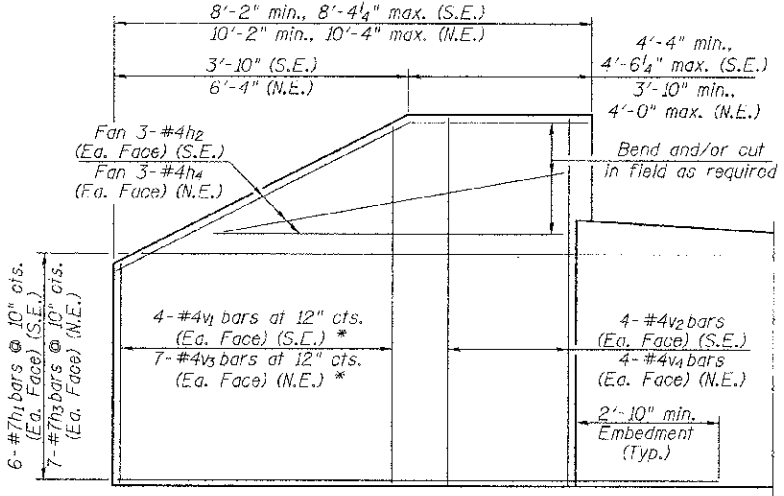

WINGWALL ELEVATION (Showing Reinforcement)
 * See v1 & v3 bar cut diagram