

CONTROL POINT #1
IRON ROD

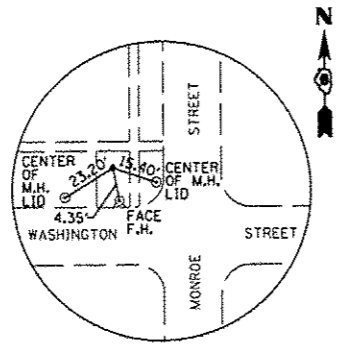

CONTROL POINT #2
IRON ROD

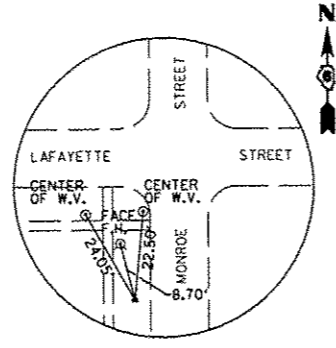

CONTROL POINT #3
IRON ROD

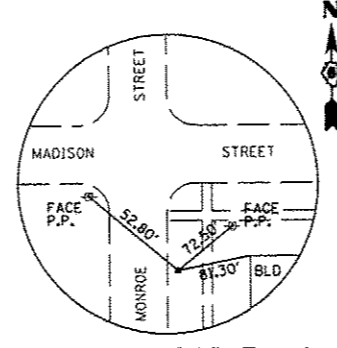

CONTROL POINT #4
IRON ROD

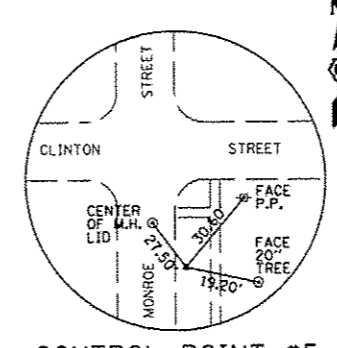

CONTROL POINT #5
IRON ROD

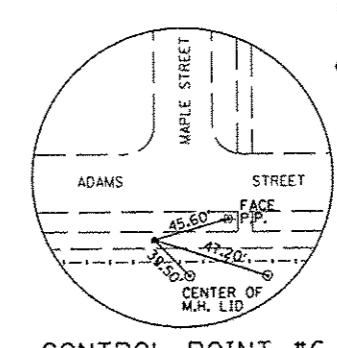

CONTROL POINT #6
MAG NAIL

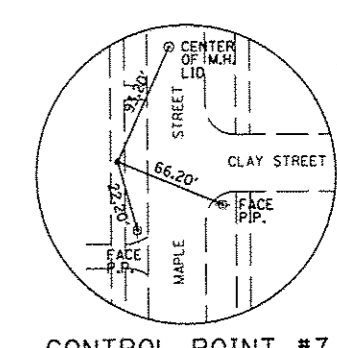

CONTROL POINT #7
MAG NAIL

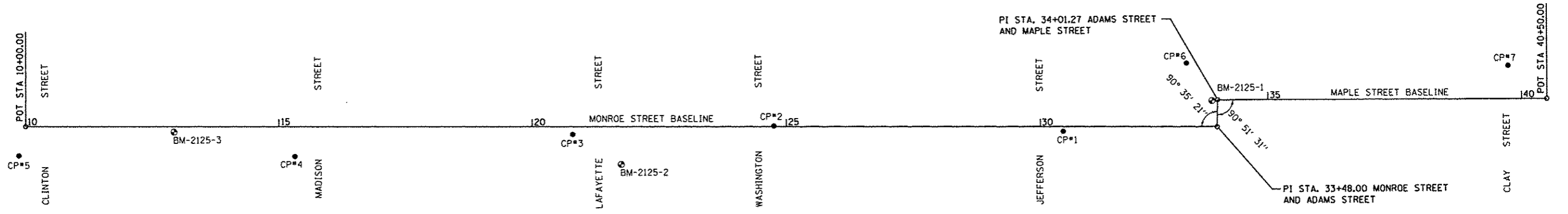

GROUND COORDINATES

DESCRIPTION	POINT NO.	NORTHING	EASTING
CONTROL POINT			
	1	1259065.623	2185293.550
	2	1258496.481	2185278.168
	3	1258100.333	2185291.908
	4	1257552.149	2185331.174
	5	1257007.377	2185325.876
	6	1259309.488	2185160.175
	7	1259942.226	2185169.038
MONROE STREET			
POT STA. 10+00		1257020.840	2185268.235
POT STA. 11+00		1257120.837	2185269.007
POT STA. 15+00		1257520.825	2185272.094
POT STA. 16+00		1257620.822	2185272.866
POT STA. 20+50		1258070.809	2185276.340
POT STA. 22+00		1258220.804	2185277.497
POT STA. 24+00		1258420.798	2185279.041
POT STA. 25+00		1258520.795	2185279.813
POT STA. 29+00		1258920.783	2185282.900
POT STA. 31+00		1259120.777	2185284.444
PI STA. 33+48		1259368.770	2185286.358
MAPLE STREET			
PI STA. 34+01.27		1034431.447	2408903.362
POT STA. 39+00		1259868.454	2185234.600
POT STA. 40+50		1260018.454	2185235.053

BM-2125-1
"M" IN MUELLER, TOP FLANGE OF F. HYDRANT,
N.E. COR. OF ADAMS STREET AND MAPLE STREET
ELEVATION 675.62

BM-2125-2
CHISELED "□" S. CORNER 2x2 CONC. LIGHT
POLE BASE FOR "FAMILY DOLLAR", N.E. CORNER
MONROE STREET AND LAFAYETTE STREET
ELEVATION 672.79

BM-2125-3
CHISELED "4" BOTTOM W. FLANGE BOLT OF F. HYDRANT,
W. SIDE OF MONROE STREET, 250'± N. OF CLINTON STREET
ELEVATION 666.34

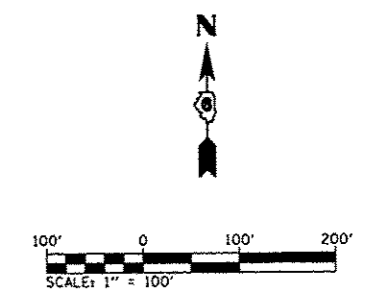

FILE NAME *	USER NAME * #USER*	DESIGNED -	REVISED -
P:\09\2125\Design\Design\CADD Sheets\09-sh1-ATB.dgn		DRAWN - MGM	REVISED -
		CHECKED - WJS	REVISED -
		DATE - 09/2012	REVISED -

**CITY OF RUSHVILLE
SAFE ROUTES TO SCHOOLS PROGRAM**

ALIGNMENT, TIES & BENCHMARKS			
SCALE:	SHEET NO.	OF SHEETS	STA. TO STA.

F.A. RTE.	SECTION	COUNTY	TOTAL SHEETS	SHEET NO.
	09-00018-00-SW	SCHUYLER	11	5
CONTRACT NO.			SRTS-40090601	