

VILLAGE OF BROWNSTOWN FAYETTE COUNTY, ILLINOIS SAFE ROUTES TO SCHOOL

FAS 1714 (CH. 2) COLLEGE ST. AND SOUTH STREET

SECTION: 08-00004-00-SW

JOB # C-40-037-08

PROJECT # SRTS-4008 (008)

INDEX OF SHEETS

- 1 COVER SHEET
- 2 NOTES, QUANTITIES, AND DETAILS
- 3 SCHEDULES
- 4-11 PLAN SHEETS
- 12 X-SECTIONS

STANDARDS:

- 424001-05 CURB RAMPS FOR SIDEWALKS
- 701301-04 LANE CLOSURE, 2L, 2W, SHORT TIME OPERATIONS
- 701501-06 URBAN LANE CLOSURE, 2L, 2W, UNDIVIDED
- 701901-03 TRAFFIC CONTROL DEVICES
- 720001-01 SIGN PANEL MOUNTING DETAIL
- 720011-01 MARKERS & DELINEATORS
- 780001-03 TYPICAL PAVEMENT MARKINGS

J.U.L.I.E 1-800-892-0123

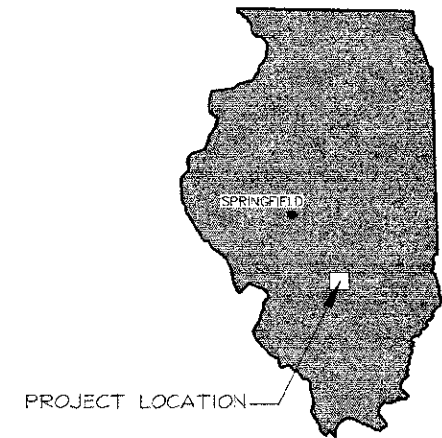
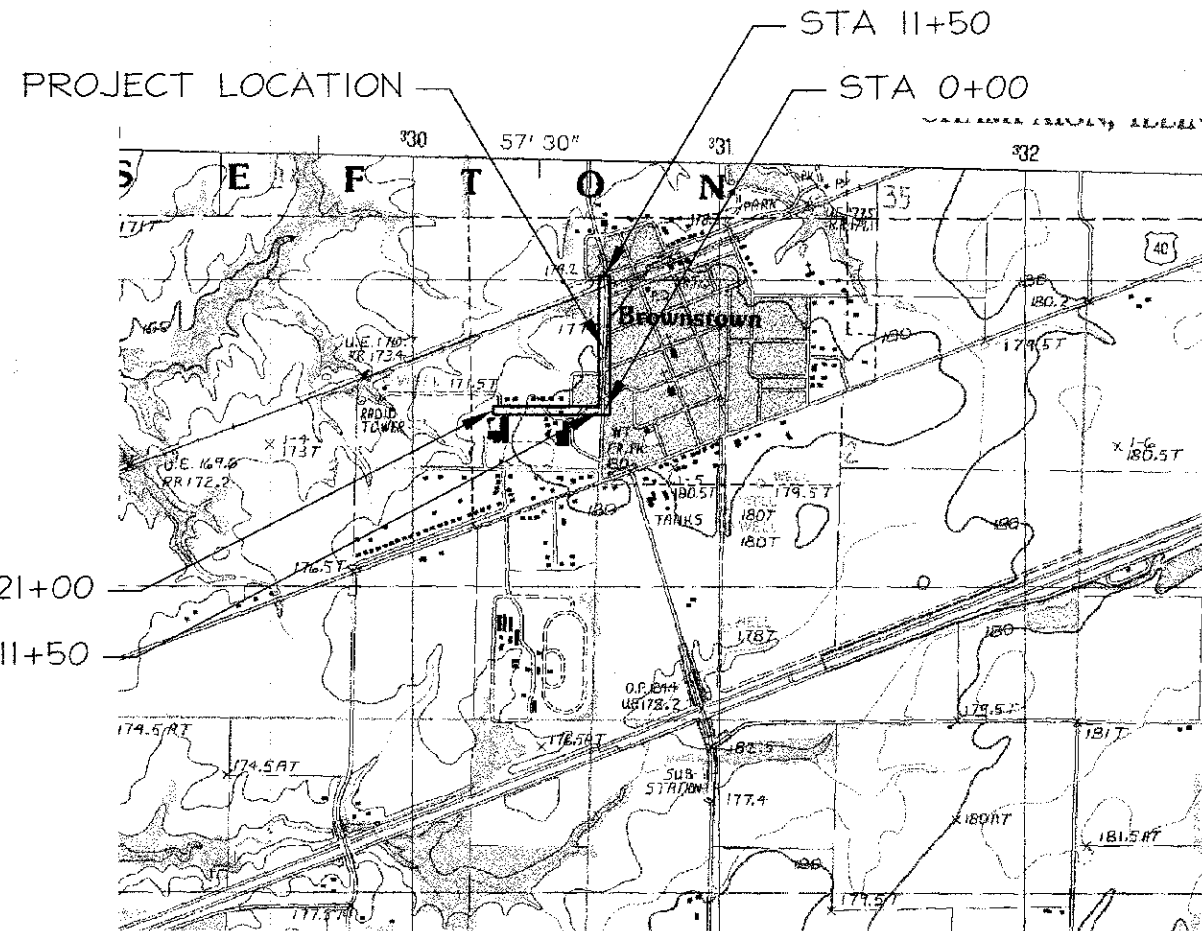

Approved 12-24, 2012

[Signature]
PRESIDENT, VILLAGE OF BROWNSTOWN

Passed 1-10, 2013

[Signature]
District 7 Engineer of Local Roads and Streets

Releasing for Bid
Based on Limited
Review 1-10, 2013

[Signature]
Deputy Director of Highways, Region 4 Engineer

SCALES (24"X36" SHEET)
1 INCH = 10 FEET (HORZ)

SCALES (11"X17" SHEET)
1 INCH = 22 FEET (HORZ)

COLLEGE STREET STATION 0+00 - 11+50 = 1,150 FEET
SOUTH STREET STATION 11+50 - 21+00 = 950 FEET
TOTAL LENGTH OF PROJECT 2,100 FEET (0.40 MILES)

ENGINEER AND SURVEYOR'S CERTIFICATE

STATE OF ILLINOIS)
COUNTY OF WILLIAMSON) SS

I, JOHN H. CRAWFORD, ILLINOIS PROFESSIONAL ENGINEER NO. 29206 AND ILLINOIS PROFESSIONAL LAND SURVEYOR NO. 2061 DO HEREBY CERTIFY THAT THESE DRAWINGS WERE PREPARED BY ME, OR PREPARED UNDER MY DIRECT SUPERVISION.

IN WITNESS THEREOF, I HAVE SET MY HAND AND SEAL THIS 20TH DAY OF JANUARY 2012.

[Signature]

JOHN H. CRAWFORD
I.P.E. NO. 29206
I.P.L.S. NO. 2061
CARTERVILLE, ILLINOIS

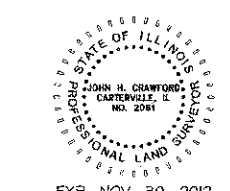
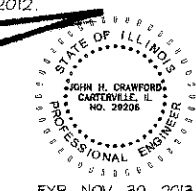

EXP. NOV. 30, 2013

EXP. NOV. 30, 2012

NO.	DESCRIPTION	BY	DATE	NO.	DESCRIPTION	BY	DATE
					DESIGNED		
					DRAWN	WFL	12/12/12
					CHECKED	JHC	12/12/12

VILLAGE OF BROWNSTOWN
FAYETTE COUNTY, IL
SAFE ROUTES TO SCHOOL
COVER SHEET

JOHN H. CRAWFORD & ASSOCIATES, P.C.
CIVIL ENGINEERS, LAND SURVEYORS
201 SOUTH DIVISION STREET, CARTERVILLE, ILLINOIS 62918
PHONE (618) 986-6370 FAX (618) 985-4892
PROFESSIONAL DESIGN FIRM # 184-002886

SHEET NO.	
1	of 12
ISSUE	DATE
A	12/12/12

GENERAL NOTES

1. ALL MATERIALS AND METHODS SHALL BE IN ACCORDANCE WITH STANDARD SPECIFICATIONS FOR ROAD AND BRIDGE CONSTRUCTION, ADOPTED JANUARY 1ST, 2012.
2. CONTRACTORS SHALL CONTACT EACH UTILITY COMPANY PRIOR TO CONSTRUCTION. ANY DAMAGE CAUSED TO EXISTING UTILITIES SHALL BE THE CONTRACTORS RESPONSIBILITY AND CONTRACTOR SHALL LEND ALL POSSIBLE ASSISTANCE IN RESTORING SERVICE.
3. NOT ALL OF THE GAS, POWER OR TELEPHONE LINES, WERE ABOVE OR BELOW GROUND, HAVE BEEN SHOWN ON THE PLANS. THE LOCATION OF EXISTING UNDERGROUND UTILITIES, SUCH AS GAS OR WATER MAINS, ETC., AS SHOWN ON THE PLANS HAVE BEEN DETERMINED FROM THE BEST AVAILABLE INFORMATION AND ARE GIVEN FOR THE CONVENIENCE OF THE CONTRACTOR. THE CONTRACTOR SHALL ASSUME RESPONSIBILITY FOR ALL UTILITIES, WHETHER SHOWN OR NOT, AND MUST REALIZE THAT THE ACTUAL LOCATIONS AND THOSE SHOWN MAY BE DIFFERENT.
4. INTERRUPTION OF UTILITY SERVICE IS NOT EXPECTED. HOWEVER, IF INTERRUPTION OF ANY UTILITY SERVICE IS NECESSARY, THE CONTRACTOR SHALL GIVE AT LEAST ONE DAY NOTICE TO CUSTOMERS INVOLVED AND SHALL USE ALL HIS RESOURCES TO MINIMIZE INTERRUPTION.
5. ALL DISTURBED AREAS SHALL BE GRADED TO PROVIDE POSITIVE DRAINAGE. CULVERTS, FIELD TILES AND OTHER DRAINAGE FACILITIES DAMAGED DURING CONSTRUCTION SHALL BE REPLACED BY CONTRACTOR AT NO ADDITIONAL COST TO THE VILLAGE.
6. ANY PERMANENT SURFACE, STREET, DRIVEWAY, OR SIDEWALK DAMAGE BY CONTRACTOR SHALL BE REPAIRED BY CONTRACTOR.

SUMMARY OF QUANTITIES

CODE #	ITEM DESCRIPTION	TOTAL	UNIT
20100210	TREE REMOVAL (OVER 15 UNITS DIAMETER)	72	UNIT
42300100	PORTLAND CEMENT CONCRETE DRIVEWAY PAVEMENT, 5 INCH	66.4	SQ YD
42400200	PORTLAND CEMENT CONCRETE SIDEWALK 5 INCH	4727	SQ FT
42400400	PORTLAND CEMENT CONCRETE SIDEWALK 7 INCH	1113	SQ FT
42400800	DETECTABLE WARNINGS	126	SQ FT
44000200	DRIVEWAY PAVEMENT REMOVAL	59	SQ YD
44000300	CURB REMOVAL	50	FOOT
44000600	SIDEWALK REMOVAL	2058	SQ FT
Δ 56109210	WATER VALVES TO BE ADJUSTED	1	EACH
67100100	MOBILIZATION	1	L SUM
72000100	SIGN PANEL - TYPE I	83	SQ FT
72900200	METAL POST - TYPE B	12	EACH
Δ 78001130	PAINT PAVEMENT MARKING - LINE 6"	435	FOOT
X0322881	TREE TRIMMING	3	EACH
Δ X004040	DOMESTIC WATER METER TO BE RELOCATED	5	EACH
X0327301	RELOCATE EXISTING MAILBOX	1	EACH
X2500900	SEEDING, CLASS I (SPECIAL)	0.04	ACRES
X7240500	RELOCATE EXISTING SIGNS	3	EACH
Z0004544	HOT-MIX ASPHALT DRIVEWAY PAVEMENT REMOVAL	9	SQ YD

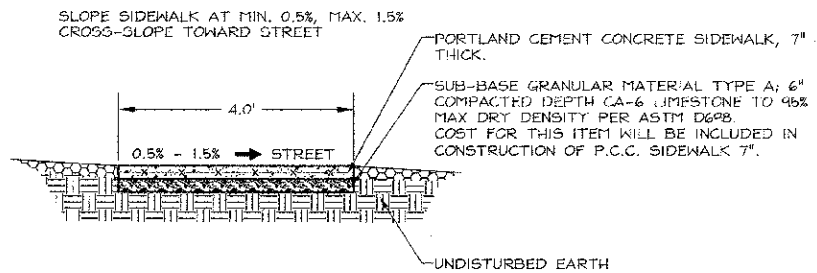

**P.C.C. SIDEWALK
TYPICAL DRIVEWAY SECTION**

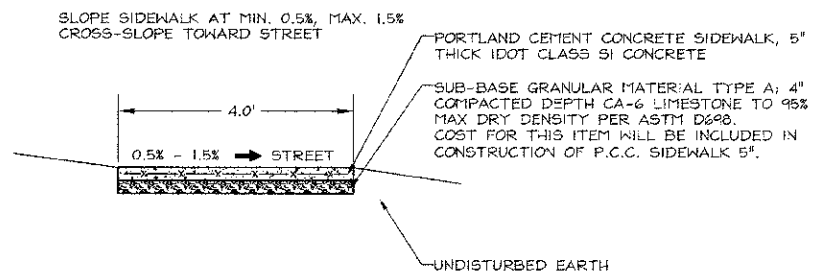

**P.C.C. SIDEWALK
TYPICAL SECTION**

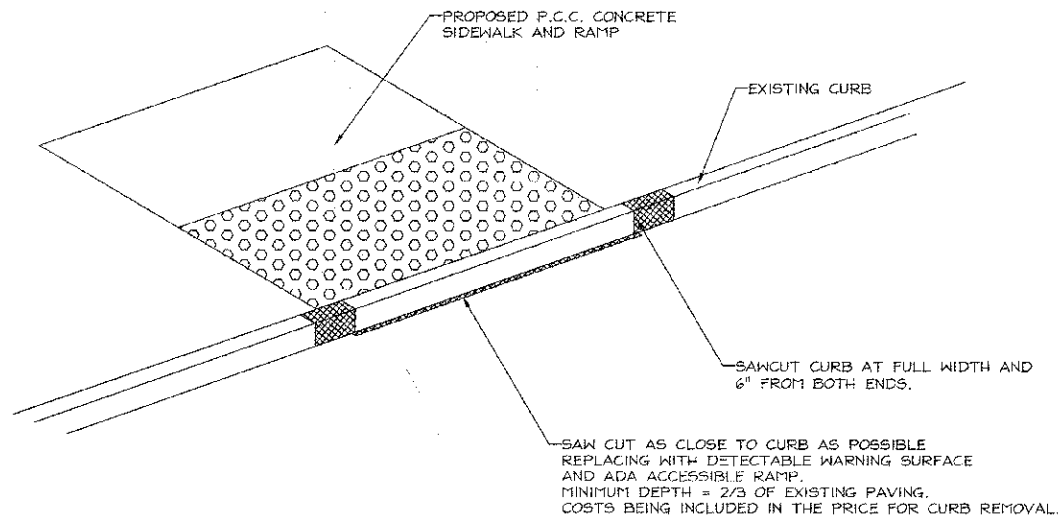

NO.	DESCRIPTION	BY	DATE	NO.	DESCRIPTION	BY	DATE
						DESIGNED	
						DRAWN	WFL 12/12/12
						CHECKED	JHC 12/12/12

VILLAGE OF BROWNSTOWN
FAYETTE COUNTY, IL
SAFE ROUTES TO SCHOOL
NOTES & QUANTITIES

JOHN H. CRAWFORD & ASSOCIATES, P.C.
CIVIL ENGINEERS, LAND SURVEYORS
201 SOUTH DIVISION STREET, CARTERSVILLE, ILLINOIS 62018
PHONE (618) 585-8370 FAX (618) 965-4892
PROFESSIONAL DESIGN FIRM # 184-002865

SHEET NO.	
2	of 12
ISSUE	DATE
A	12/12/12

TREE REMOVAL

STATIONS	TREE REMOVAL OVER 15" DIAMETER
	INCH
COLLEGE STREET	
3+13 - 30' LT	24
3+96 - 30' LT	24
4+98 - 29' LT	24

WATER VALVES TO BE ADJUSTED

STATIONS	WATER VALVES TO BE ADJUSTED
	EACH
COLLEGE STREET	
8+34 - 25' LT	1

CURB REMOVAL

STATION TO STATION	CURB REMOVAL
	FOOT
COLLEGE STREET	
1+56 - 20' LT	
1+60 - 20' LT	5
1+56 - 20' RT	
1+60 - 20' RT	5
3+52 - 24' LT	
3+54 - 28' LT	5
3+89 - 28' LT	
3+97 - 22' LT	10
3+92 - 20' RT	
3+96 - 20' RT	5
11+28 - 21' LT	
11+32 - 21' LT	5
11+45 - 22' RT	
11+49 - 22' RT	5
SOUTH STREET	
17+51 - 40' LT	
17+55 - 35' LT	5
17+79 - 40' LT	
17+82 - 35' LT	5

PORTLAND CEMENT CONCRETE SIDEWALK 7 INCH

EXISTING STATION	PORTLAND CEMENT CONCRETE SIDEWALK 7"
	SQ. FT.
COLLEGE STREET	
1+15 - 23' LT	66
1+89 - 23' LT	45
2+41 - 26' RT	45
2+94 - 23' LT	70
3+39 - 25' RT	57
5+06 - 24' LT	50
5+40 - 24' LT	43
6+41 - 24' LT	37
7+12 - 24' LT	73
7+74 - 24' LT	44
9+54 - 24' LT	78
10+02 - 24' LT	42
10+84 - 24' LT	71
SOUTH STREET	
13+39 - 26' LT	127
17+69 - 37' LT	141
19+58 - 39' LT	126

EXISTING MAILBOX RELOCATE

EXISTING STATION	PROPOSED STATION	MAILBOX RELOCATION
		EACH
COLLEGE STREET	COLLEGE STREET	
3+92 - 26' LT	3+90 - 31' LT	1

DRIVEWAY PAVEMENT REMOVAL & REPLACEMENT

EXISTING STATION	PORTLAND CEMENT DRIVEWAY PAVEMENT 5"	DRIVEWAY PAVEMENT REMOVAL
	SQUARE YARD	SQUARE YARD
COLLEGE STREET		
1+15 - 20' LT	7.1	6.0
1+89 - 20' LT	3.6	
2+40 - 24' RT	2.9	
2+96 - 19' LT	7.0	
3+40 - 23' RT	4.0	
5+06 - 20' LT	5.6	
5+40 - 21' LT	4.4	
6+41 - 20' LT	3.8	
7+12 - 21' LT	6.4	
7+74 - 20' LT	4.4	
9+54 - 20' LT	8.0	9.0
10+02 - 20' LT	4.3	
10+84 - 20' LT	6.9	
SOUTH STREET		
13+39 - 24' LT		14.0
17+69 - 37' LT		16.0
19+58 - 39' LT		14.0

EXISTING SIGN RELOCATE

EXISTING STATION	PROPOSED STATION	SIGN RELOCATION
		EACH
COLLEGE STREET	COLLEGE STREET	
1+75 - 26' LT	1+75 - 21' LT	1
3+49 - 28' LT	3+49 - 24' LT	1
3+53 - 28' LT	3+53 - 29' LT	1

WATER METER RELOCATE

EXISTING STATION	PROPOSED STATION	WATER METER RELOCATION
		EACH
COLLEGE STREET	COLLEGE STREET	
1+82 - 27' LT	1+82 - 28' LT	1
3+08 - 27' LT	3+08 - 29' LT	1
6+16 - 23' LT	6+16 - 29' LT	1
5+84 - 26' LT	5+84 - 28' LT	1
6+55 - 26' LT	6+55 - 28' LT	1

PORTLAND CEMENT CONCRET SIDEWALK 5"

STATION TO STATION	PORTLAND CEMENT CONCRETE SIDEWALK 5"
	SQUARE FOOT
COLLEGE STREET	
0+36 - 40' LT	
1+07 - 27' LT	308
1+22 - 27' LT	
1+83 - 27' LT	253
1+65 - 27' RT	
2+36 - 27' RT	284
1+94 - 27' LT	
2+86 - 27' LT	362
2+46 - 27' RT	
3+32 - 27' RT	339
3+03 - 27' LT	
3+54 - 27' LT	96
3+45 - 27' RT	
3+99 - 27' RT	222
3+88 - 27' LT	
4+99 - 27' LT	487
5+11 - 27' LT	
5+31 - 27' LT	79
5+43 - 27' LT	
6+36 - 27' LT	376
6+45 - 27' LT	
7+02 - 27' LT	223
7+19 - 27' LT	
7+69 - 27' LT	194
7+79 - 27' LT	
9+43 - 27' LT	656
9+62 - 27' LT	
9+95 - 27' LT	132
10+06 - 27' LT	
10+74 - 27' LT	274
10+92 - 27' LT	
11+31 - 27' LT	161
SOUTH STREET	
11+85 - 22' LT	
11+89 - 22' LT	41
13+68 - 24' LT	
13+73 - 24' LT	20
15+60 - 32' LT	
15+65 - 32' LT	25
16+96 - 34' LT	
17+06 - 34' LT	49
18+47 - 38' LT	
18+57 - 38' LT	49
19+13 - 39' LT	
19+23 - 39' LT	48

SIDEWALK REMOVAL

STATION TO STATION	SIDEWALK REMOVAL
	SQUARE FOOT
COLLEGE STREET	
0+40 - 26' LT	
3+51 - 25' LT	1226
1+60 - 25' RT	
2+29 - 25' RT	259
3+93 - 24' LT	
4+96 - 24' LT	341
SOUTH STREET	
11+85 - 22' LT	
11+89 - 22' LT	41
13+68 - 24' LT	
13+73 - 24' LT	20
15+60 - 32' LT	
15+65 - 32' LT	25
16+96 - 34' LT	
17+06 - 34' LT	49
18+47 - 38' LT	
18+57 - 38' LT	49
19+13 - 39' LT	
19+23 - 39' LT	48

NO.	DESCRIPTION	BY	DATE	NO.	DESCRIPTION	BY	DATE

VILLAGE OF BROWNSTOWN
 FAYETTE COUNTY, IL
 SAFE ROUTES TO SCHOOL
 SCHEDULES



JOHN H. CRAWFORD & ASSOCIATES, P.C.
 CIVIL ENGINEERS, LAND SURVEYORS
 201 SOUTH DIVISION STREET, CARTERSVILLE, ILLINOIS 62918
 PHONE (618) 985-8370 FAX (618) 985-4692
 PROFESSIONAL DESIGN FIRM # 184-002865

SHEET NO.	
3 of 12	
ISSUE	DATE
A	12/12/12

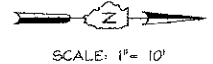

SCALE: 1" = 10'

- LEGEND**
- WATER METER
 - WATER VALVE
 - HYDRANT
 - MAILBOX
 - TREE POST
 - POWER POLE
 - ROAD SIGN
 - GUY WIRE
 - EASEMENT
 - DETECTABLE WARNING
 - PROPOSED NEW SIDEWALK

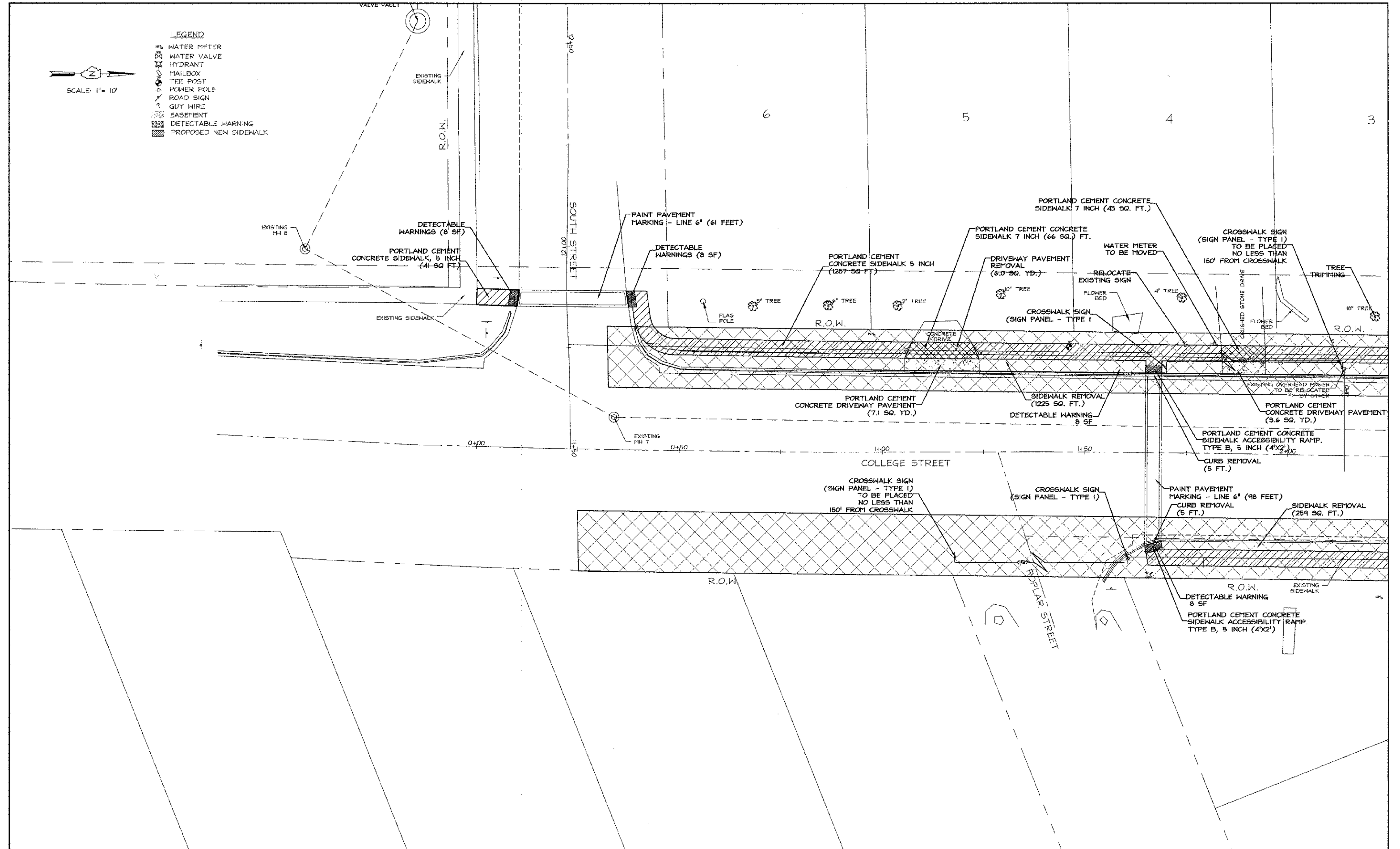

NO.	DESCRIPTION	BY	DATE	NO.	DESCRIPTION	BY	DATE
						DESIGNED	
						DRAWN	WFL 12/12/12
						CHECKED	JHC 12/12/12

VILLAGE OF BROWNSTOWN
 FAYETTE COUNTY, IL
 SAFE ROUTES TO SCHOOL
 PLAN SHEET

JOHN H. CRAWFORD & ASSOCIATES, P.C.
 CIVIL ENGINEERS, LAND SURVEYORS
 204 SOUTH DIVISION STREET, CARTERSVILLE, ILLINOIS 62918
 PHONE (618) 985-6370 FAX (618) 985-4692
 PROFESSIONAL DESIGN FIRM # 184-002885

SHEET NO.	
4 of 12	
ISSUE	DATE
A	12/12/12

LEGEND

- ⊗ WATER METER
- ⊕ WATER VALVE
- ⊙ HYDRANT
- MAILBOX
- ⊙ TEE POST
- ⊙ POWER POLE
- ⊙ ROAD SIGN
- ⊙ GUY WIRE
- ▭ EASEMENT
- ▨ DETECTABLE WARNING
- ▨ PROPOSED NEW SIDEWALK

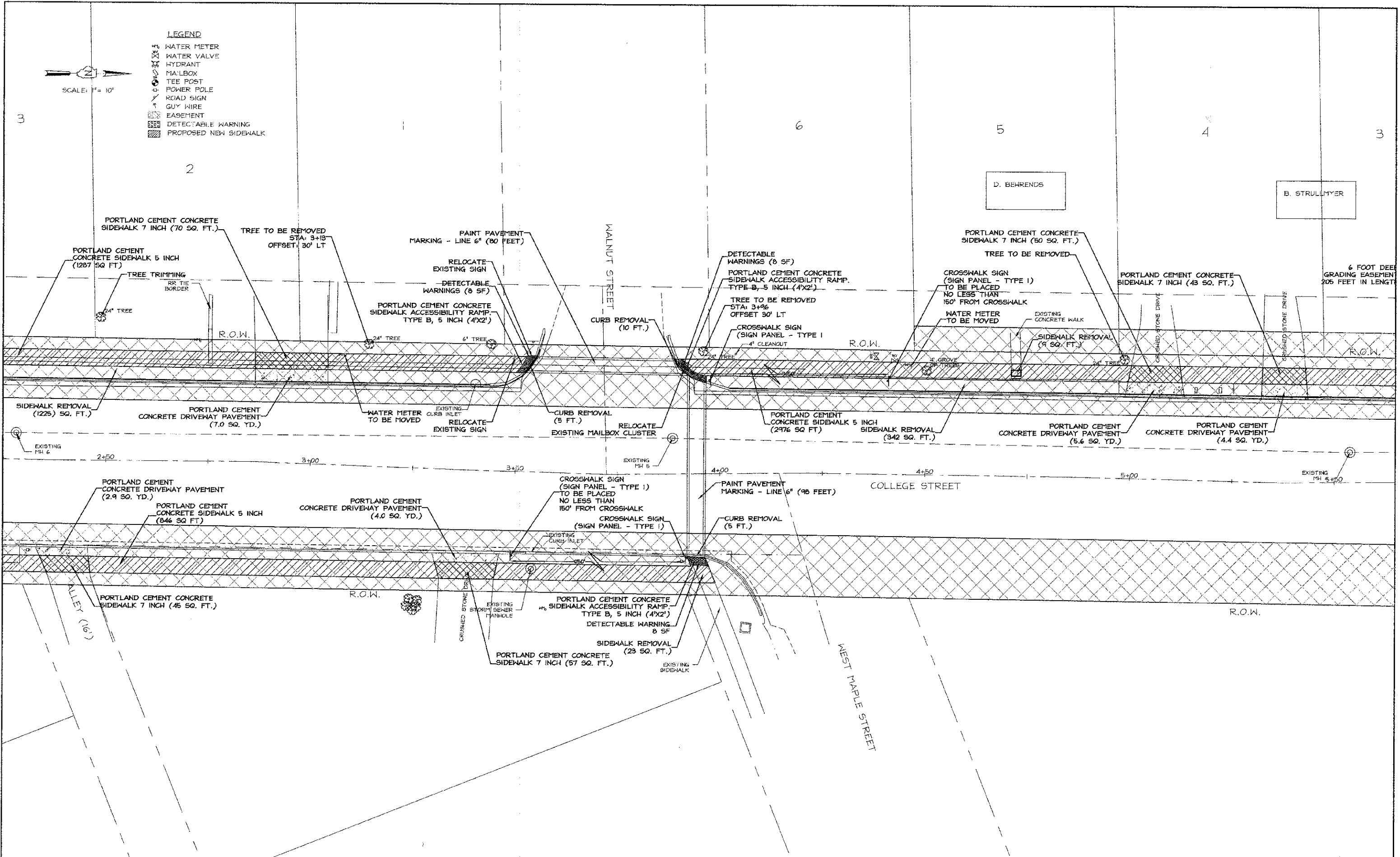
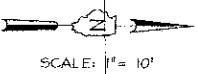

NO.	DESCRIPTION	BY	DATE	NO.	DESCRIPTION	BY	DATE
					DESIGNED		
					DRAWN	WFL	12/12/12
					CHECKED	JHC	12/12/12

VILLAGE OF BROWNSTOWN
 FAYETTE COUNTY, IL
 SAFE ROUTES TO SCHOOL
 PLAN SHEET

JOHN H. CRAWFORD & ASSOCIATES, P.C.
 CIVIL ENGINEERS, LAND SURVEYORS
 201 SOUTH DIVISION STREET, CARTERSVILLE, ILLINOIS 62918
 PHONE (618) 985-6370 FAX (618) 985-4992
 PROFESSIONAL DESIGN FIRM # 194-002885

SHEET NO.	5 of 12
ISSUE	DATE
A	12/12/12

SCALE: 1" = 10'

- LEGEND**
- WATER METER
 - WATER VALVE
 - HYDRANT
 - MANHOLE
 - TEE POST
 - POWER POLE
 - ROAD SIGN
 - GUY WIRE
 - EASEMENT
 - DETECTABLE WARNING
 - PROPOSED NEW SIDEWALK

G. GOLDSBORO

ALLEY (16')

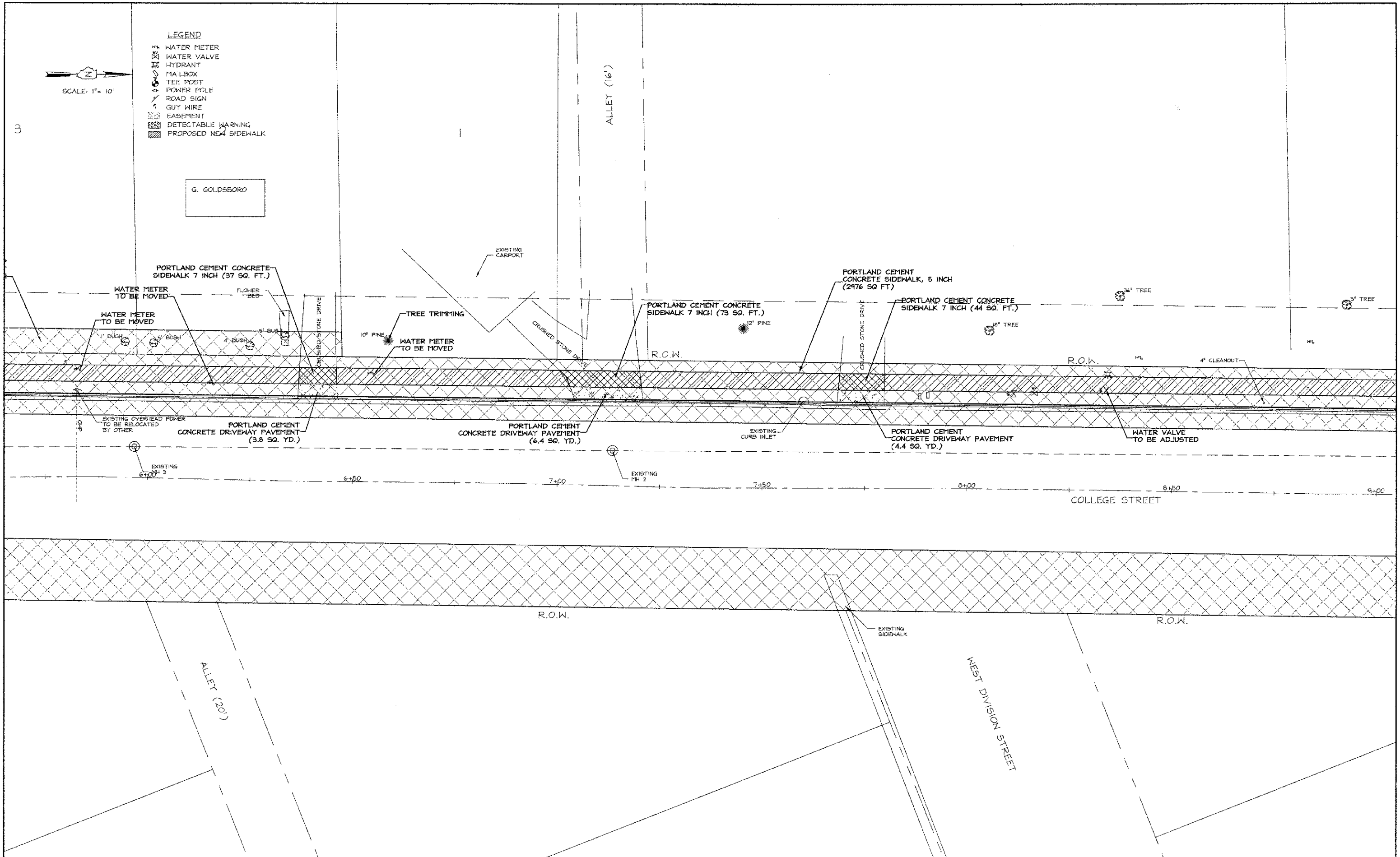

NO.	DESCRIPTION	BY	DATE	NO.	DESCRIPTION	BY	DATE
					DESIGNED		
					DRAWN	WFL	12/12/12
					CHECKED	JHC	12/12/12

VILLAGE OF BROWNSTOWN
 FAYETTE COUNTY, IL
 SAFE ROUTES TO SCHOOL
 PLAN SHEET

JOHN H. CRAWFORD & ASSOCIATES, P.C.
 CIVIL ENGINEERS, LAND SURVEYORS
 201 SOUTH DIVISION STREET, CARTERSVILLE, ILLINOIS 62918
 PHONE (618) 985-6370 FAX (618) 985-4892
 PROFESSIONAL DESIGN FIRM # 184-002886

SHEET NO.	
6 of 12	
ISSUE	DATE
A	12/12/12



SCALE: 1" = 10'

- LEGEND**
- WATER METER
 - WATER VALVE
 - HYDRANT
 - MAILBOX
 - TEE POST
 - POWER POLE
 - ROAD SIGN
 - GUY WIRE
 - EASEMENT
 - DETECTABLE WARNING
 - PROPOSED NEW SIDEWALK

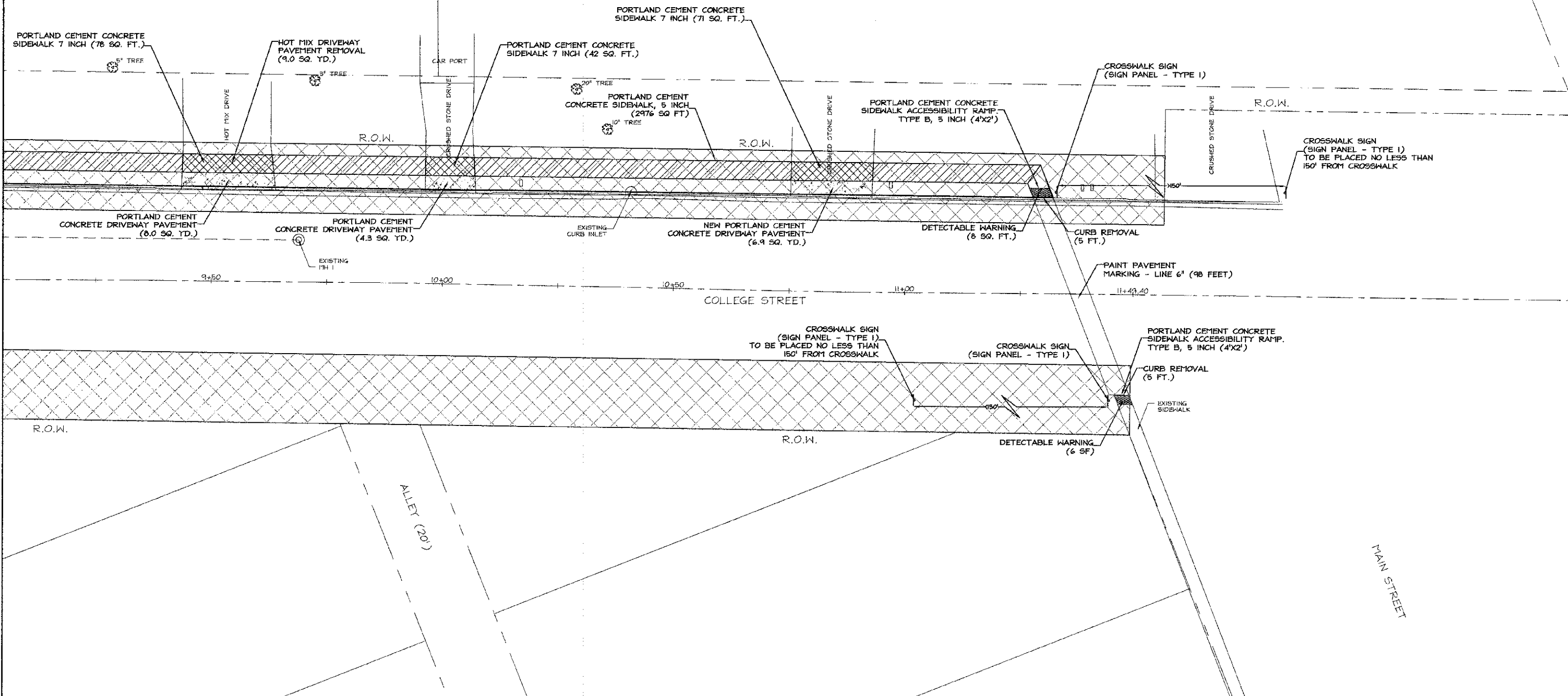

NO.	DESCRIPTION	BY	DATE	NO.	DESCRIPTION	BY	DATE	NO.	DESCRIPTION	BY	DATE
									DESIGNED		
									DRAWN	WFL	12/12/12
									CHECKED	JHC	12/12/12

VILLAGE OF BROWNSTOWN
 FAYETTE COUNTY, IL
 SAFE ROUTES TO SCHOOL
 PLAN SHEET

JOHN H. CRAWFORD & ASSOCIATES, P.C.
 CIVIL ENGINEERS, LAND SURVEYORS
 201 SOUTH DIVISION STREET, CARTERSVILLE, ILLINOIS 62018
 PHONE (618) 985-5370 FAX (618) 985-4982
 PROFESSIONAL DESIGN FIRM # 184-002685

SHEET NO.	
7	of 12
ISSUE	DATE
A	12/12/12



SCALE: 1" = 10'

LEGEND

- WATER METER
- WATER VALVE
- HYDRANT
- MAILBOX
- TEE POST
- POWER POLE
- ROAD SIGN
- GUY WIRE
- EASEMENT
- DETECTABLE WARNING
- PROPOSED NEW SIDEWALK

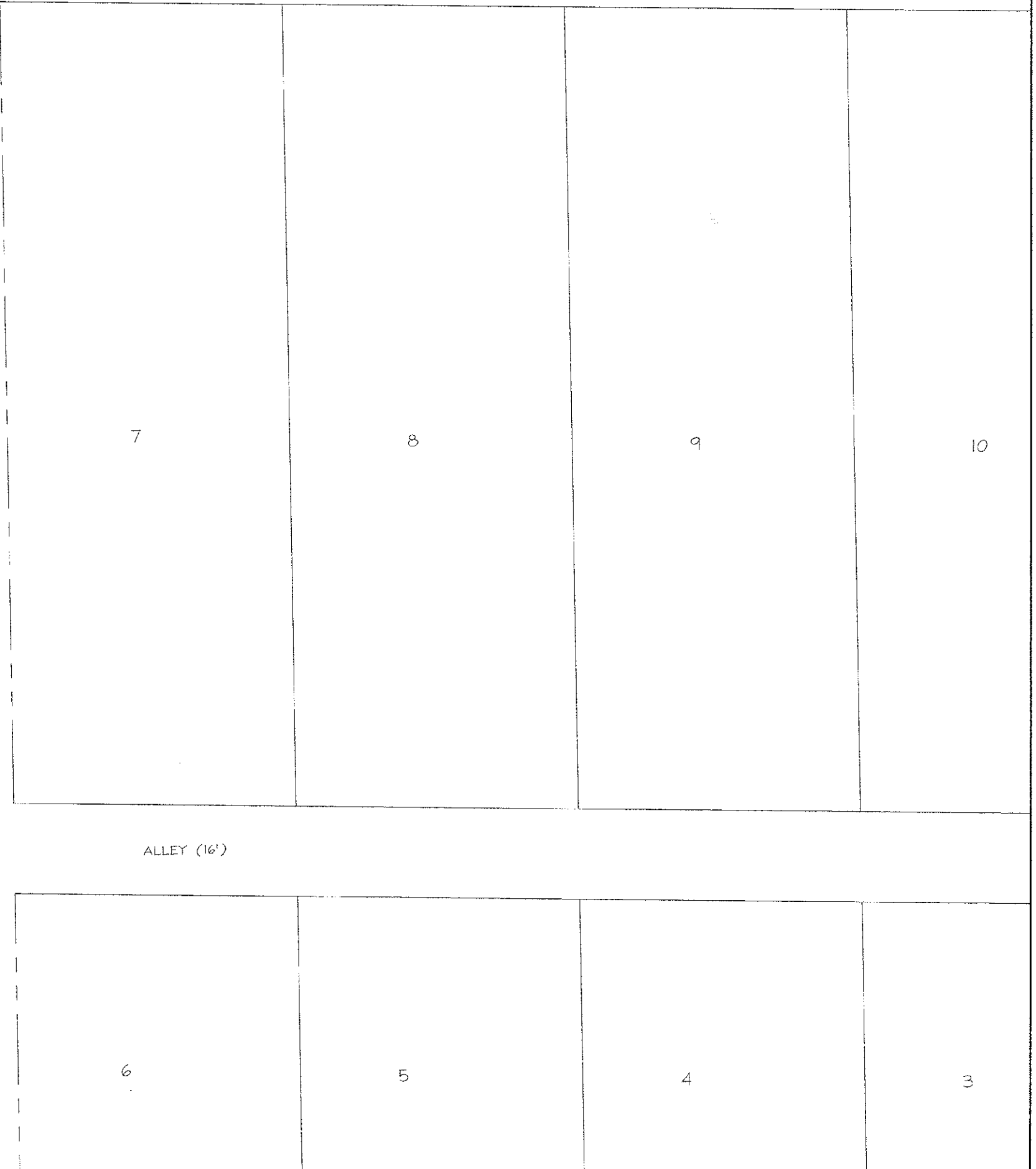
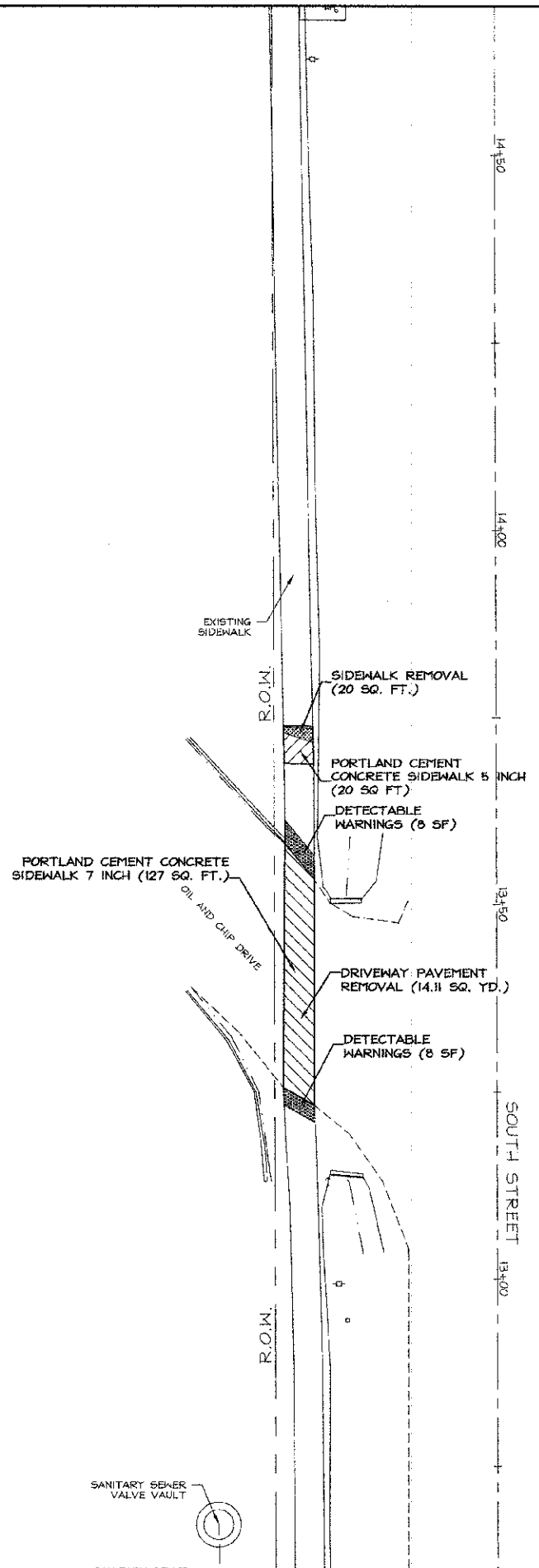

NO.	DESCRIPTION	BY	DATE	NO.	DESCRIPTION	BY	DATE
					DESIGNED		
					DRAWN	WFL	12/12/12
					CHECKED	JHC	12/12/12

VILLAGE OF BROWNSTOWN
 FAYETTE COUNTY, IL
 SAFE ROUTES TO SCHOOL
 PLAN SHEET

JOHN H. CRAWFORD & ASSOCIATES, P.C.
 CIVIL ENGINEERS, LAND SURVEYORS
 201 SOUTH DIVISION STREET, CARTERSVILLE, ILLINOIS 62916
 PHONE (618) 985-6370 FAX (618) 985-4892
 PROFESSIONAL DESIGN FIRM # 184-002885

SHEET NO.	
8 of 12	
ISSUE	DATE
A	12/12/12



SCALE: 1" = 10'

LEGEND

- WATER METER
- WATER VALVE
- HYDRANT
- MAILBOX
- TEE POST
- POWER POLE
- ROAD SIGN
- GUY WIRE
- EASEMENT
- DETECTABLE WARNING
- PROPOSED NEW SIDEWALK

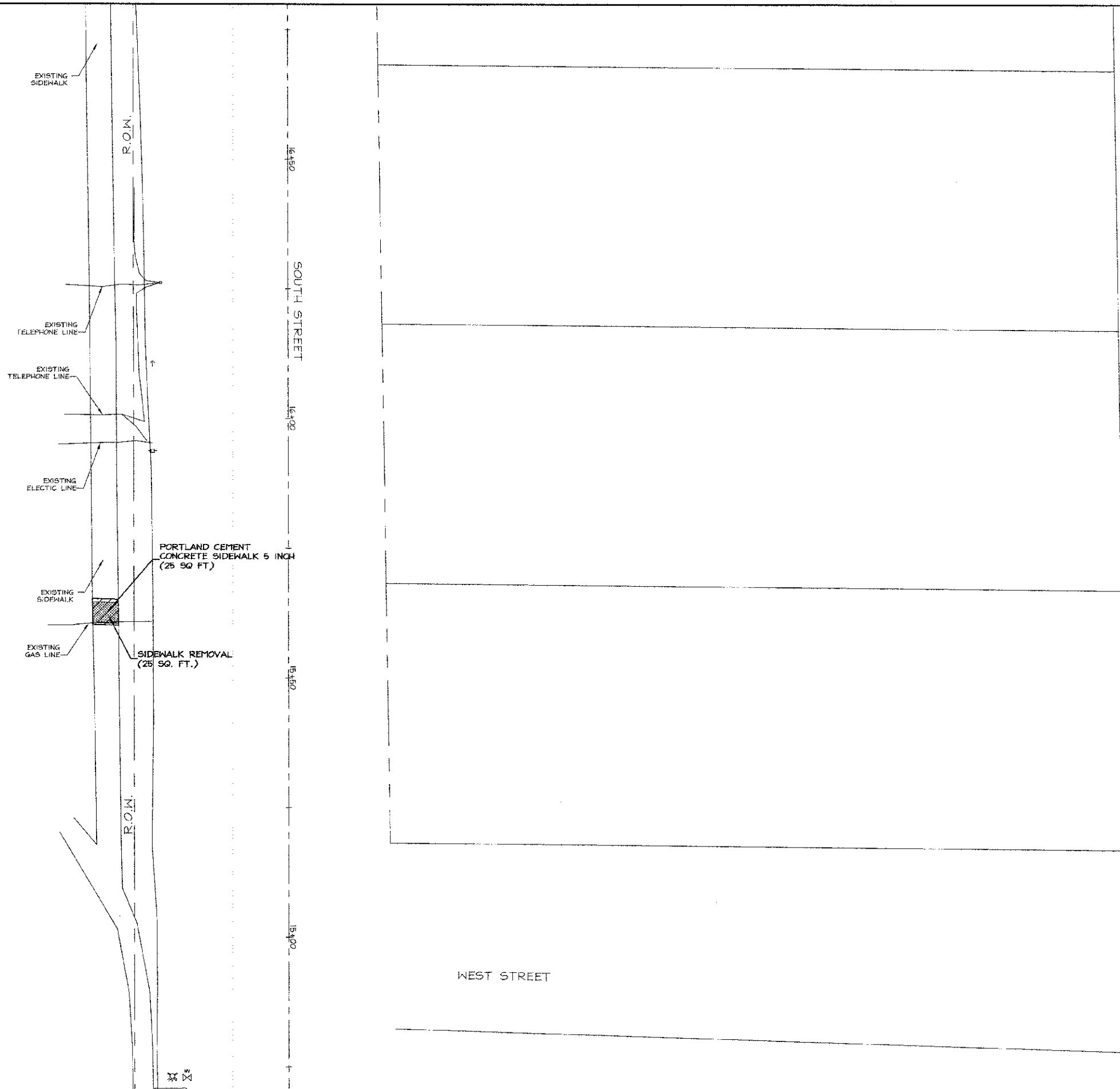

NO.	DESCRIPTION	BY	DATE	NO.	DESCRIPTION	BY	DATE

VILLAGE OF BROWNSTOWN
 FAYETTE COUNTY, IL
 SAFE ROUTES TO SCHOOL
 PLAN SHEET

JOHN H. CRAWFORD & ASSOCIATES, P.C.
 CIVIL ENGINEERS, LAND SURVEYORS
 201 SOUTH DIVISION STREET, CARTERSVILLE, ILLINOIS 62918
 PHONE (618) 955-6370 FAX (618) 955-4992
 PROFESSIONAL DESIGN FIRM # 184-002865

SHEET NO.	
9 of 12	
ISSUE	DATE
A	12/12/12

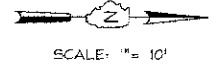

SCALE: 1" = 10'

- LEGEND**
- WATER METER
 - WATER VALVE
 - HYDRANT
 - MAILBOX
 - TEE POST
 - POWER POLE
 - ROAD SIGN
 - GUY WIRE
 - EASEMENT
 - DETECTABLE WARNING
 - PROPOSED NEW SIDEWALK

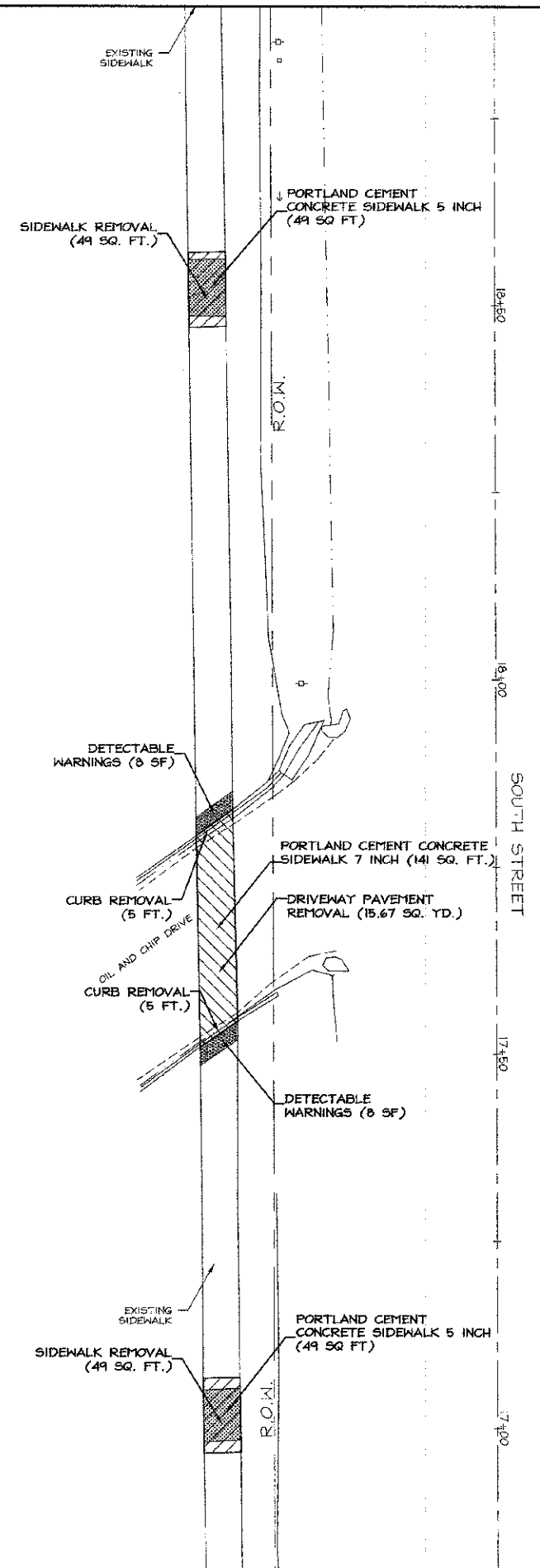

NO.	DESCRIPTION	BY	DATE	NO.	DESCRIPTION	BY	DATE	NO.	DESCRIPTION	BY	DATE
									DESIGNED		
									DRAWN	WFL	12/12/12
									CHECKED	JHC	12/12/12

VILLAGE OF BROWNSTOWN
 FAYETTE COUNTY, IL
 SAFE ROUTES TO SCHOOL
 PLAN SHEET

JOHN H. CRAWFORD & ASSOCIATES, P.C.
 CIVIL ENGINEERS, LAND SURVEYORS
 201 SOUTH DIVISION STREET, CARTERSVILLE, ILLINOIS 62918
 PHONE (618) 985-6370 FAX (618) 985-4602
 PROFESSIONAL DESIGN FIRM # 184-002395

SHEET NO.	
10 of 12	
ISSUE	DATE
A	12/12/12

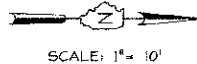

SCALE: 1" = 10'

- LEGEND**
- WATER METER
 - WATER VALVE
 - HYDRANT
 - MAILBOX
 - TEE POST
 - POWER POLE
 - ROAD SIGN
 - GUY WIRE
 - EASEMENT
 - DETECTABLE WARNING
 - PROPOSED NEW SIDEWALK

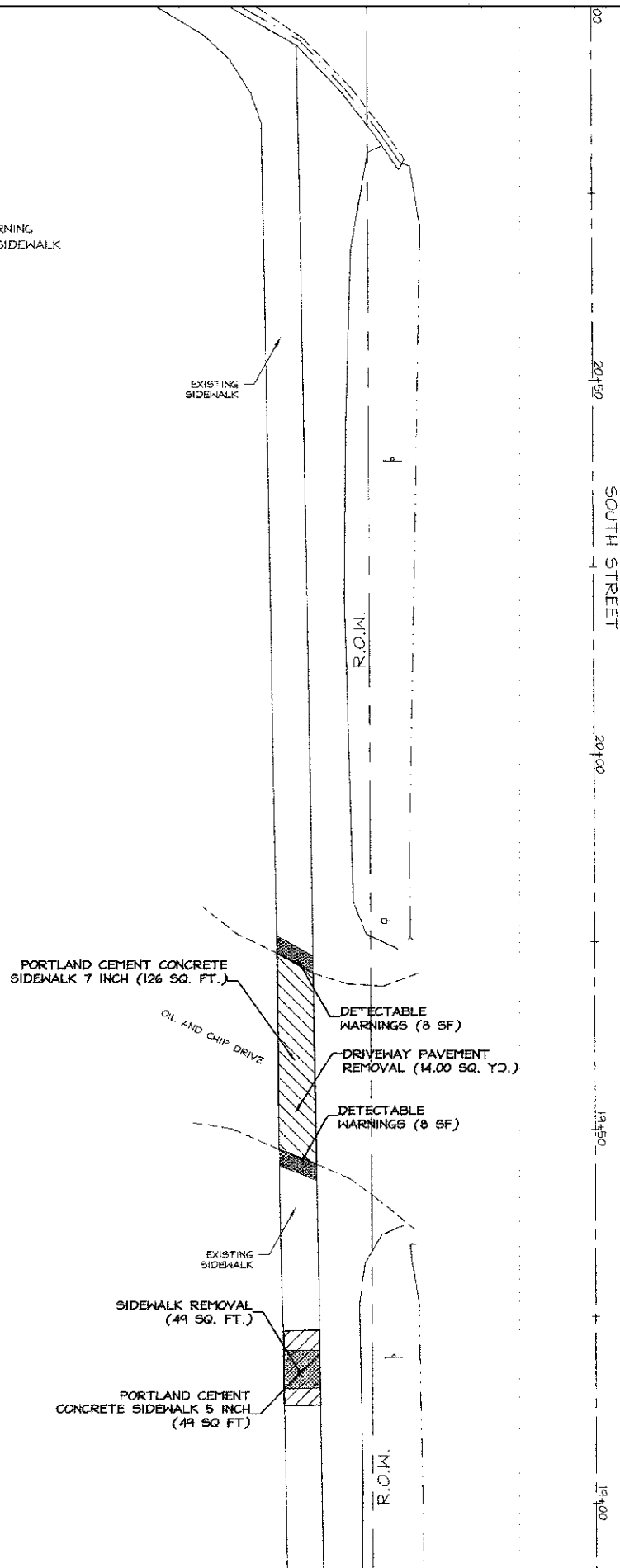

NO.	DESCRIPTION	BY	DATE	NO.	DESCRIPTION	BY	DATE

VILLAGE OF BROWNSTOWN
 FAYETTE COUNTY, IL
 SAFE ROUTES TO SCHOOL
 PLAN SHEET

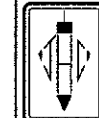

JOHN H. CRAWFORD & ASSOCIATES, P.C.
 CIVIL ENGINEERS, LAND SURVEYORS
 201 SOUTH DIVISION STREET, CARTERSVILLE, ILLINOIS 62918
 PHONE (618) 985-6370 FAX (618) 985-4692
 PROFESSIONAL DESIGN FIRM # 184-002885

SHEET NO.	
11 of 12	
ISSUE	DATE
A	12/12/12

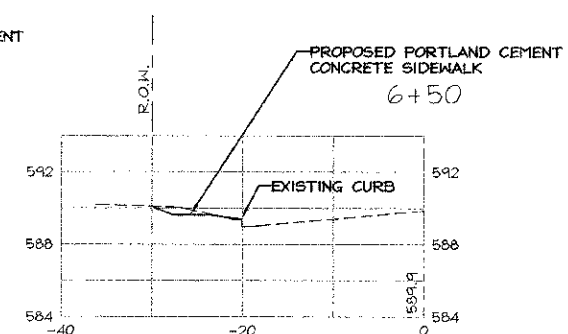
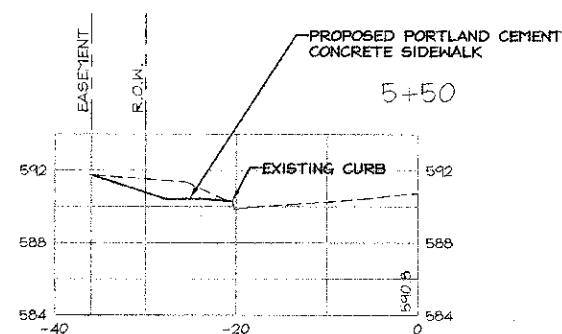
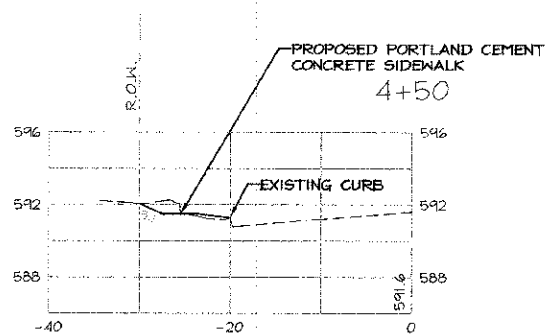
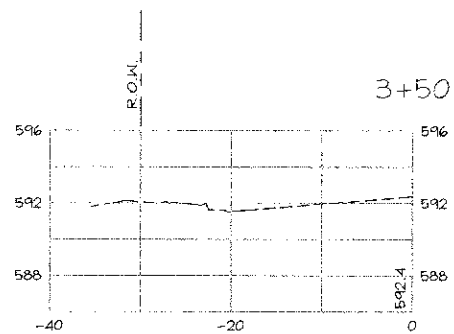
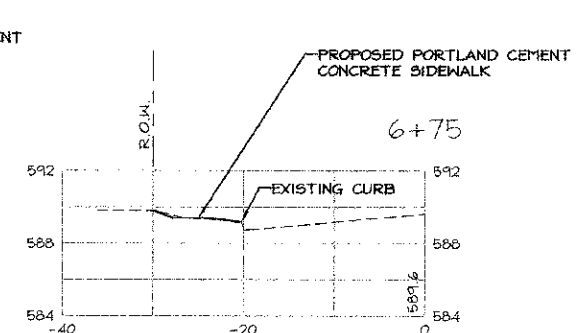
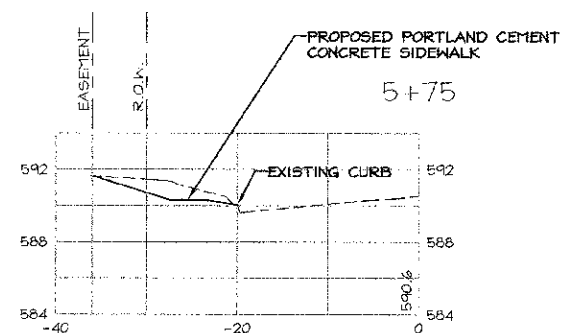
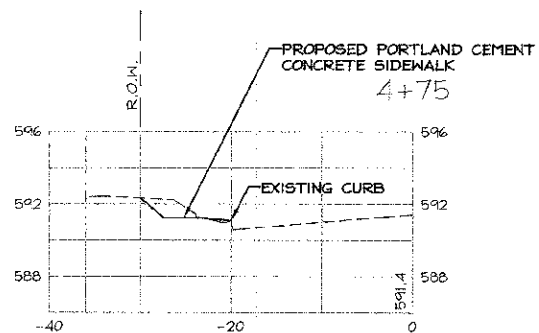
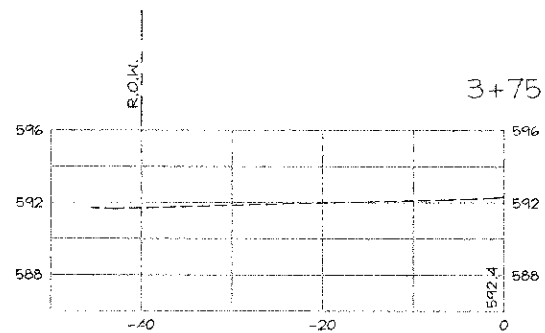
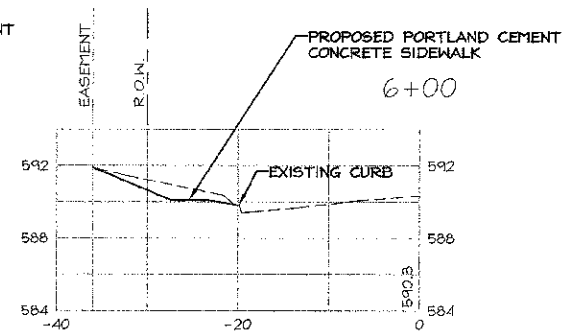
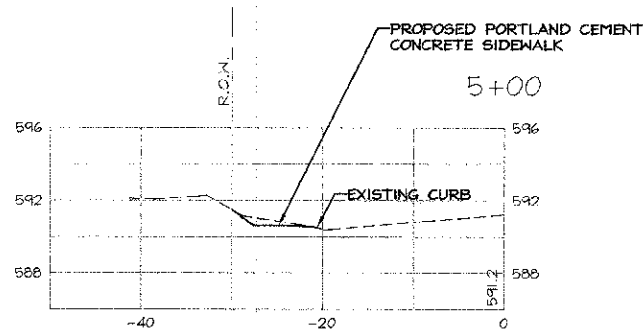
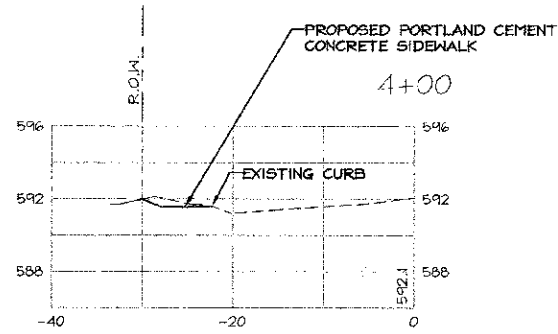
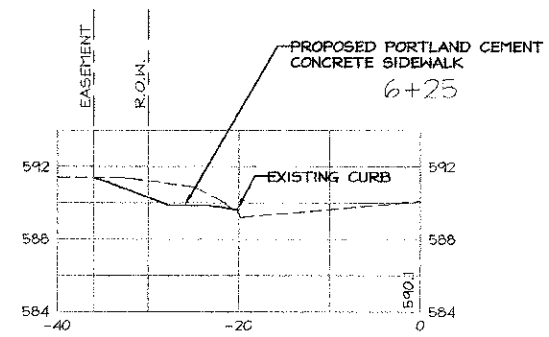
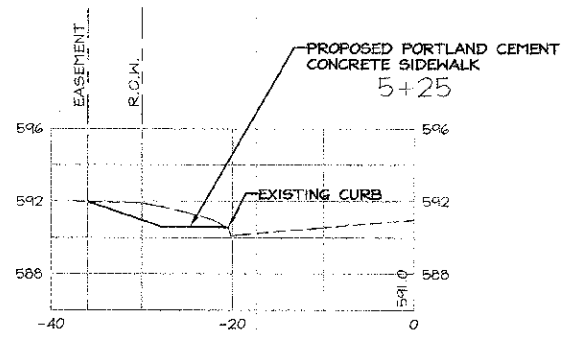
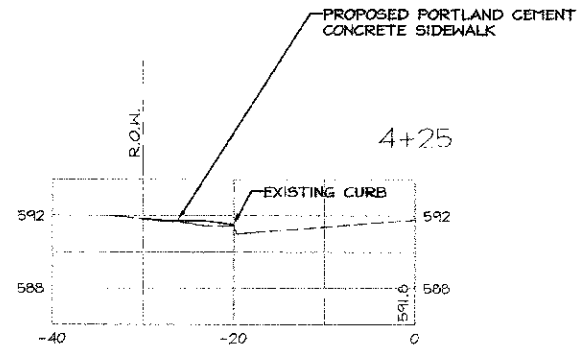

NO.	DESCRIPTION	BY	DATE	NO.	DESCRIPTION	BY	DATE
					DESIGNED		
					DRAWN	WFL	12/12/12
					CHECKED	JHC	12/12/12

VILLAGE OF BROWNSTOWN
FAYETTE COUNTY, IL
SAFE ROUTES TO SCHOOL
X-SECTIONS COLLEGE STREET (3+50-6+75)

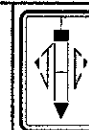

JOHN H. CRAWFORD & ASSOCIATES, P.C.
CIVIL ENGINEERS, LAND SURVEYORS
201 SOUTH DIVISION STREET, CARTRVILLE, ILLINOIS 62918
PHONE (618) 985-6370 FAX (618) 985-4392
PROFESSIONAL DESIGN FIRM # 164-002885

SHEET NO.	
12 of 12	
ISSUE	DATE
A	12/12/12