

| | |
|----------|------|
| PLAN | DATE |
| SURVEYED | |
| NOTED | |
| BY | |
| NO. | |

| | |
|----------|------|
| PROFILE | DATE |
| DESIGNED | |
| NOTED | |
| BY | |
| NO. | |

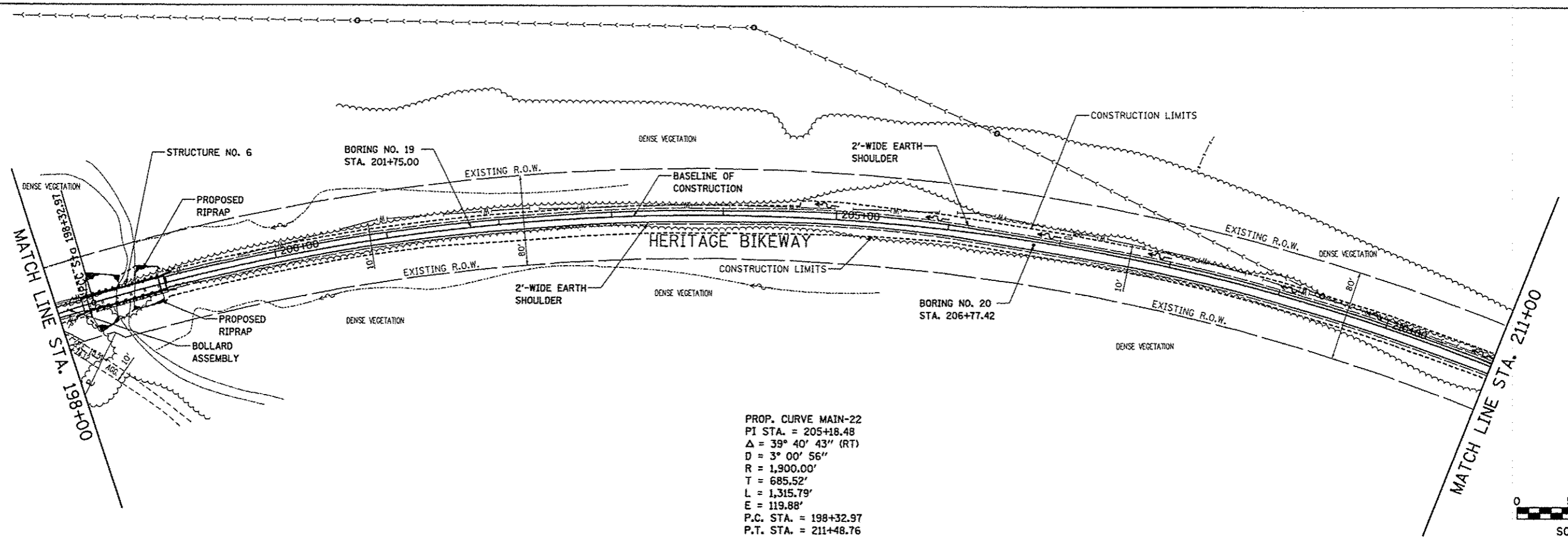

PROP. CURVE MAIN-22
 PI STA. = 205+18.48
 $\Delta = 39^\circ 40' 43''$ (RT)
 $D = 3^\circ 00' 56''$
 $R = 1,900.00'$
 $T = 685.52'$
 $L = 1,315.79'$
 $E = 119.88'$
 P.C. STA. = 198+32.97
 P.T. STA. = 211+48.76

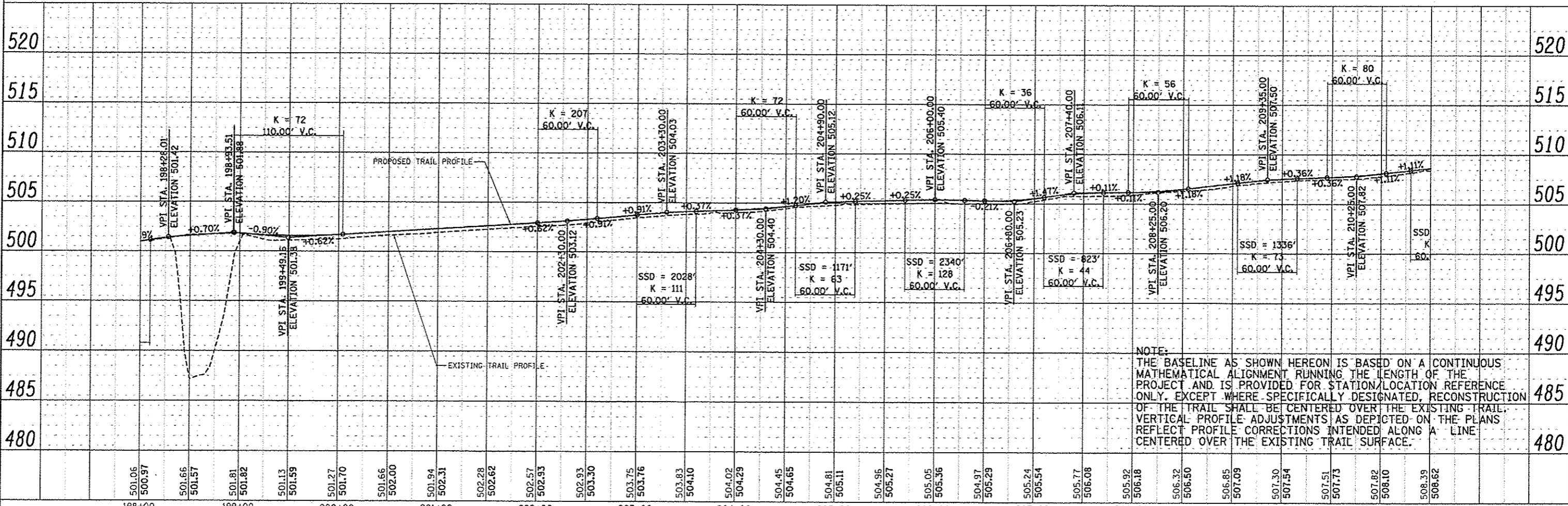
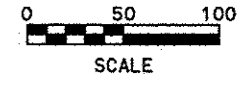

NOTE:
 THE BASELINE AS SHOWN HEREON IS BASED ON A CONTINUOUS MATHEMATICAL ALIGNMENT RUNNING THE LENGTH OF THE PROJECT AND IS PROVIDED FOR STATION/LOCATION REFERENCE ONLY. EXCEPT WHERE SPECIFICALLY DESIGNATED, RECONSTRUCTION OF THE TRAIL SHALL BE CENTERED OVER THE EXISTING TRAIL. VERTICAL PROFILE ADJUSTMENTS AS DEPICTED ON THE PLANS REFLECT PROFILE CORRECTIONS INTENDED ALONG A LINE CENTERED OVER THE EXISTING TRAIL SURFACE.

| | | | | | | | | | | |
|------------------------|--------------------|-----------------|---|-------------------------|--|--------------------------|----------------|----------------------------------|--------------|---------------------|
| FILE NAME = p19808.dgn | USER NAME = jeremy | DESIGNED - SAS | MADISON COUNTY TRANSIT DISTRICT HERITAGE TRAIL | PLAN AND PROFILE | | F.A. R.T.E. | SECTION | COUNTY | TOTAL SHEETS | SHEET NO. |
| | | DRAWN - JQH | | | | | 06-00016-00-BT | MADISON | 310 | 39 |
| | | CHECKED - WJB | | | | SCALE: 1" = 50' | | CONTRACT NO. 97433 | | |
| | | DATE - 11/30/12 | | | | SHEET NO. 8 OF 30 SHEETS | | STA. 198+00.00 TO STA. 211+00.00 | | FED. ROAD DIST. NO. |