

STATE OF ILLINOIS
DEPARTMENT OF TRANSPORTATION

| FAI RTE | SECTION | COUNTY | TOTAL SHEETS | SHEET NO. |
|---------|-----------------|----------|--------------------|-----------|
| 255 | 60-(7,8,9)CJS-1 | MADISON | 16 | 1 |
| | | ILLINOIS | CONTRACT NO. 76M14 | |

D-98-019-19



**PROPOSED
HIGHWAY PLANS**

FAI ROUTE 255 (I-255)
SECTION 60-(7,8,9)CJS-1
NHPP-IVSM (998)
CRACK AND JOINT SEAL
MADISON COUNTY

C-98-022-19
R 8 W

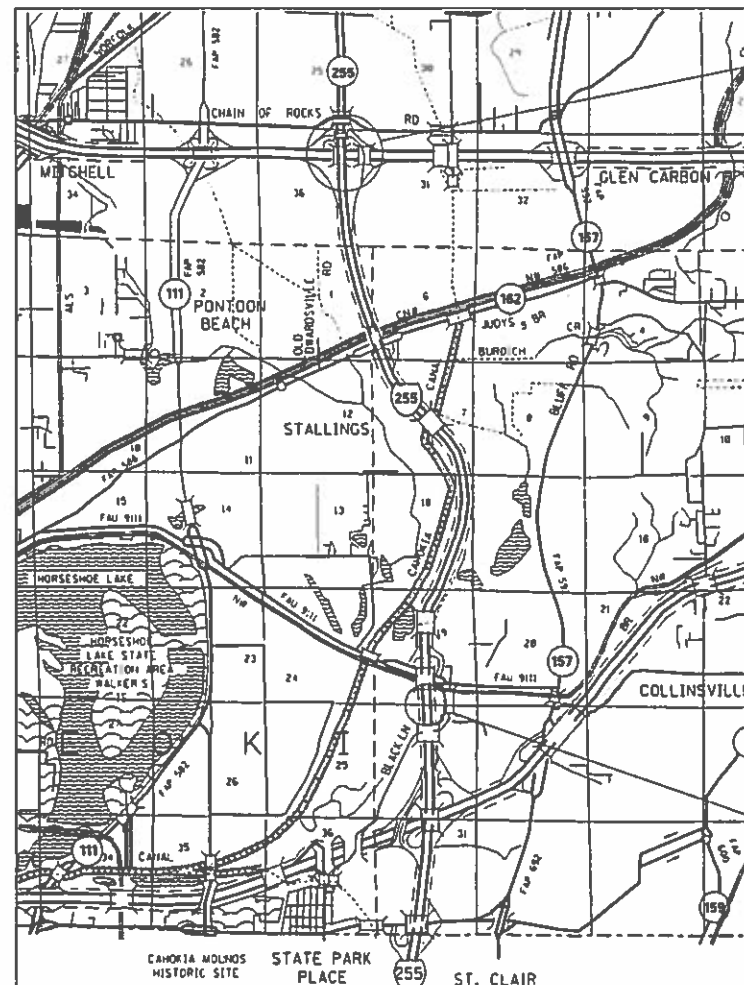

END PROJECT
I-255 AT I-270
LAT: 38.757493
LONG: -90.043894



BEGIN PROJECT
I-255 AT
ST. CLAIR CO. LINE
LAT: 38.659279
LONG: -90.031033

FOR INDEX OF SHEETS, SEE SHEET NO. 2

ADT

I-255 ST. CLAIR COUNTY LINE TO I-55 EXIT
2017 ADT = 54800 (ACTUAL)
2019 ADT = 55900 (ESTIMATED)
2039 ADT = 68200 (ESTIMATED)
SU = 2.6% MU = 10.9%

I-255 FROM I-55 EXIT TO HORSESHOE LAKE ROAD EXIT
2017 ADT = 47300 (ACTUAL)
2019 ADT = 48300 (ESTIMATED)
2039 ADT = 58900 (ESTIMATED)
SU = 2.6% MU = 7.3%

I-255 FROM HORSESHOE LAKE ROAD EXIT TO IL 162 EXIT
2017 ADT = 51500 (ACTUAL)
2019 ADT = 52500 (ESTIMATED)
2039 ADT = 64000 (ESTIMATED)
SU = 3.1% MU = 8.0%

I-255 FROM IL 162 EXIT TO I-270 EXIT
2017 ADT = 43100 (ACTUAL)
2019 ADT = 44000 (ESTIMATED)
2039 ADT = 53600 (ESTIMATED)
SU = 2.6% MU = 8.2%



FULL SIZE PLANS HAVE BEEN PREPARED USING STANDARD ENGINEERING SCALES. REDUCED SIZED PLANS WILL NOT CONFORM TO STANDARD SCALES. IN MAKING MEASUREMENTS ON REDUCED PLANS, THE ABOVE SCALES MAY BE USED.

J.U.L.I.E.
JOINT UTILITY LOCATION INFORMATION FOR EXCAVATION
1-800-892-0123
OR 811

PROJECT ENGINEER: HERVE GELIN (618) 346-3179
SQUAD LEADER: BILLIE OWEN (618) 346-3209

CONTRACT NO. 76M14

GROSS LENGTH = 7.07 MILE

STATE OF ILLINOIS
DEPARTMENT OF TRANSPORTATION

SUBMITTED *Dec 6 2018*

Jeffrey Z. Kain
REGIONAL ENGINEER

Feb 19 2019
Scott A. Etk
ENGINEER OF DESIGN AND ENVIRONMENT

Feb 20 2019
Paul P. Ch...
DIRECTOR OF HIGHWAYS PROJECT IMPLEMENTATION

**PRINTED BY THE AUTHORITY
OF THE STATE OF ILLINOIS**

INDEX OF SHEETS

- 1 COVER SHEET
- 2 INDEX OF SHEETS, HIGHWAY STANDARDS, GENERAL NOTES & COMMITMENTS
- 3 SUMMARY OF QUANTITIES
- 4-14 TYPICAL SECTION
- 15 SCHEDULES
- 16 CRACK & JOINT SEALING DETAIL

HIGHWAY STANDARDS

- 000001-07 STANDARD SYMBOLS, ABBREVIATIONS AND PATTERNS
- 701426-09 LANE CLOSURE, MULTILANE, INTERMITTENT OR MOVING OPER., FOR SPEEDS > 45MPH
- 701901-08 TRAFFIC CONTROL DEVICES

GENERAL NOTES

- 1. ILLINOIS STATE LAW REQUIRES A 48-HOUR NOTICE TO BE GIVEN TO UTILITIES BEFORE DIGGING. FIELD MARKING OF FACILITIES MAY BE OBTAINED BY CONTACTING J.U.L.I.E. (1-800-892-0123 OR 811) OR FOR NON-MEMBERS THE UTILITY COMPANY DIRECTLY.
- 2. ANY RAISED REFLECTIVE PAVEMENT MARKERS ENCOUNTERED SHALL BE LEFT IN PLACE. ROUTING SHALL BE GAPPED WHERE RAISED REFLECTIVE PAVEMENT MARKERS ARE ENCOUNTERED SO AS TO LEAVE THEM FUNCTIONAL.
- 3. RESIDENT ENGINEER SHALL DETERMINE EXACT LOCATION WHERE CRACKS ARE TO BE ROUTED AND FILLED.
- 4. ESTIMATED CRACK FILLING APPLICATION RATE : 0.33 LB/FT
- 5. THE CONTRACTOR AND THE ENGINEER SHALL BE AWARE THAT NO SURVEY WAS PERFORMED FOR THIS PROJECT. THE STATIONING, TOPOGRAPHY, AND QUANTITIES SHOWN IN THE PLANS WERE CREATED USING FIELD MEASUREMENTS. ALL SHALL BE ASSUMED TO BE APPROXIMATE. THE CONTRACTOR SHALL VERIFY DIMENSIONS AND CONDITIONS IN THE FIELD PRIOR TO CONSTRUCTION AND ORDERING OF MATERIALS.

- 6. THE ILLINOIS DEPARTMENT OF TRANSPORTATION STRONGLY ENCOURAGES THE PRIME CONTRACTOR AND THEIR APPROVED SUB-CONTRACTORS TO HIRE MINORITY, WOMEN AND DISADVANTAGED INDIVIDUALS FROM ITS FEDERALLY FUNDED HIGHWAY CONSTRUCTION CAREERS TRAINING PROGRAM (HCCTP) TO HELP MEET WORKFORCE AND TRAINEE GOALS. THIS PROGRAM IS TRAINING MINORITIES, WOMEN AND DISADVANTAGED INDIVIDUALS IN HIGHWAY CONSTRUCTION-RELATED SKILLS, E.G., MATH FOR THE TRADES, JOB READINESS, TECHNICAL SKILLS COURSEWORK (CARPENTRY, CONCRETE FLATWORK, BLUEPRINT READING, SITE PLANS, SITE WORK, TOOLS USE, ETC.) AND OSHA 10 HOUR CERTIFICATION, TO PREPARE THEM FOR A CAREER IN THE HIGHWAY CONSTRUCTION TRADES. GRADUATES ARE WELL-TRAINED AND READY TO BECOME PRODUCTIVE ENTRY-LEVEL CONSTRUCTION WORKERS. PLEASE CONTACT THE DISTRICT 8 EEO OFFICE AT 618-346-3360 AND/OR THE HCCTP COORDINATOR AT 618-874-6528 TO LEARN MORE ABOUT THE PROGRAM AND FOR ASSISTANCE IN MEETING WORKFORCE AND TRAINEE GOALS.
- 7. TWO CHANGEABLE MESSAGE BOARDS SHALL BE REQUIRED FOR THIS PROJECT. BOTH SHALL BE PLACED TWO WEEKS PRIOR TO ANY LANE CLOSURE, ONE ON EACH END OF THE PROJECT. ONE SHALL REMAIN FOR THE DURATION OF THE CONTRACT AND PLACED AT THE DIRECTION OF THE ENGINEER.
- 8. THE CONTRACTOR SHALL NOT GET ANY MATERIAL ON THE PAVEMENT MARKING AND RAISED REFLECTIVE PAVEMENT MARKERS.

COMMITMENTS
NONE

MODEL: Default
 FILE NAME: P:\11108\BID\NTEC\Illinois.gov\PWD\DOT\Documents\DOT Offices\District 8\Projects\0876M1\11CAD\0876M1\11CAD\0876M1\11-sht-gen.note.dgn

REV. - MS

| | | | | | | | | | | |
|-------------------------------|------------|-----------|---|--|----------------|-----------------|---------------------|--------------|--------------|--|
| USER NAME = lewisko | DESIGNED - | REVISED - | STATE OF ILLINOIS DEPARTMENT OF TRANSPORTATION | INDEX OF SHEETS, HIGHWAY STANDARDS, GENERAL NOTES & COMMITMENTS | F.A.I. RTE. | SECTION | COUNTY | TOTAL SHEETS | SHEET NO. | |
| PLOT SCALE = 100.0000' / 1in. | DRAWN - | REVISED - | | | 255 | 60-(7,8,9)CJS-1 | MADISON | 16 | 2 | |
| PLOT DATE = 12/7/2018 | CHECKED - | REVISED - | | | CONTRACT 76M14 | | | | | |
| | DATE - | REVISED - | | | SCALE: NTS | | SHEET NO. OF SHEETS | | STA. TO STA. | |

MODEL: Default
 FILE: \\nashc-pc\1\108\BID\NTEC\Illinois\gov\PIV\DOT\Documents\1\DOT_Offices\DI\ierfct 8\Projects\0776M1\ACADD\staCAD\cherecs\0776M1\4-shc-500.dgn

| CODE NO. | ITEM | UNIT | TOTAL QUANTITY | CONSTR. CODE | |
|----------|---|--------|----------------|-----------------|-------|
| | | | | MADISON ROADWAY | URBAN |
| | | | | | |
| | 90% FED 10% STATE | | | | |
| 45100100 | CRACK ROUTING (PAVEMENT) | FOOT | 174307 | 174307 | |
| 45100200 | CRACK FILLING | POUND | 57521 | 57521 | |
| 67100100 | MOBILIZATION | L SUM | 1 | 1 | |
| 70107025 | CHANGEABLE MESSAGE SIGN | CAL DA | 85 | 85 | |
| 70200100 | NIGHTTIME WORK ZONE LIGHTING | L SUM | 1 | 1 | |
| X7010216 | TRAFFIC CONTROL AND PROTECTION, (SPECIAL) | L SUM | 1 | 1 | |
| | | | | | |
| | | | | | |
| | | | | | |
| | | | | | |

| | | |
|-------------------------------|------------|-----------|
| USER NAME = lewiska | DESIGNED - | REVISED - |
| | DRAWN - | REVISED - |
| PLOT SCALE = 100.0000 ' / in. | CHECKED - | REVISED - |
| PLOT DATE = 12/10/2018 | DATE - | REVISED - |

**STATE OF ILLINOIS
 DEPARTMENT OF TRANSPORTATION**

SUMMARY OF QUANTITIES

SCALE: SHEET OF SHEETS STA. TO STA.

| F.A.I. RTE. | SECTION | COUNTY | TOTAL SHEETS | SHEET NO. |
|--------------------|-----------------|---------|---------------------------|-----------|
| 255 | 60-(7,8,9)C/S-1 | MADISON | 16 | 3 |
| CONTRACT NO. 76M14 | | | ILLINOIS FED. AID PROJECT | |

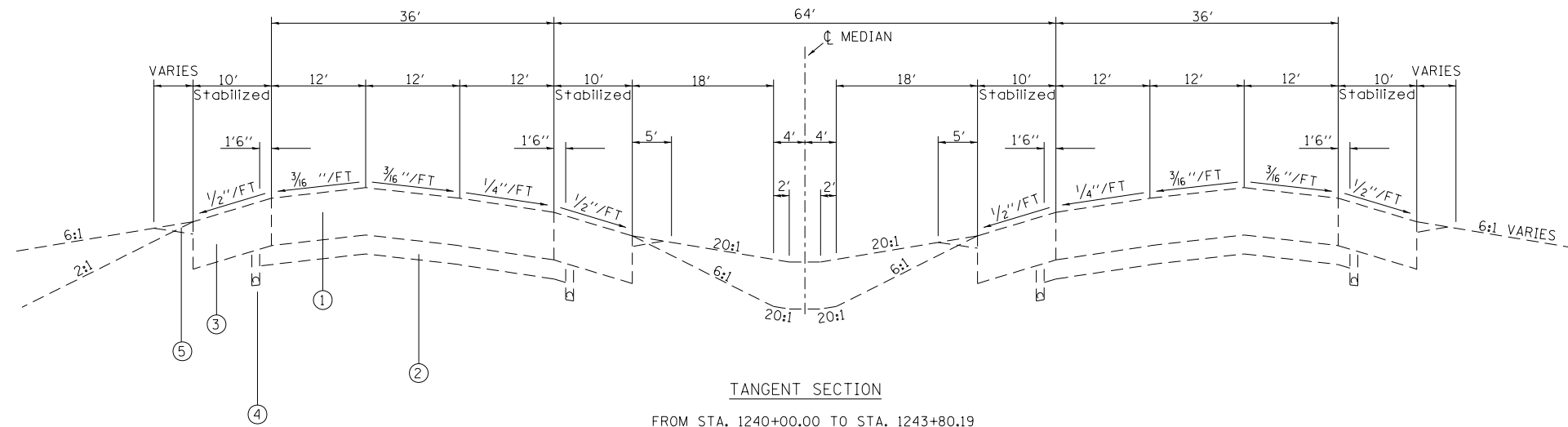

TANGENT SECTION
FROM STA. 1240+00.00 TO STA. 1243+80.19

LEGEND

- ① EXISTING 10" C.R.P.C.C. PAVEMENT
- ② EXISTING 4" STABILIZED SUB-BASE
- ③ EXISTING BITUMINOUS SHOULDER 10" (STD. 2237)
- ④ EXISTING 4" MIN. PIPE UNDERDRAIN (STD. 2327)
- ⑤ EXISTING AGGREGATE SHOULDERS TYPE B (STD. 2237)

MODEL: D:\default
 FILE: NAME: P:\A\108\B\BID\NTEG: I:\h\p\p\p\RD\DOT\Documents\DOT: Office\Bierfert: B\Projects\12476M11\CADD\12476M11\CAD\Sheet\12476M11-1-Sub-C\Sheet.dgn

| | | |
|-----------------------------|------------|-----------|
| USER NAME = lewisko | DESIGNED - | REVISED - |
| | DRAWN - | REVISED - |
| PLOT SCALE = 99.8718' / in. | CHECKED - | REVISED - |
| PLOT DATE = 12/7/2018 | DATE - | REVISED - |

STATE OF ILLINOIS
DEPARTMENT OF TRANSPORTATION

TYPICAL SECTION

SCALE: NTS SHEET NO. OF SHEETS STA. TO STA.

| F.A.I. RTE. | SECTION | COUNTY | TOTAL SHEETS | SHEET NO. |
|---|-----------------|---------|--------------|-----------|
| 255 | 60-(7,8,9)CJS-1 | MADISON | 16 | 4 |
| CONTRACT 76M14 | | | | |
| FED. ROAD DIST. NO. ILLINOIS FED. AID PROJECT | | | | |

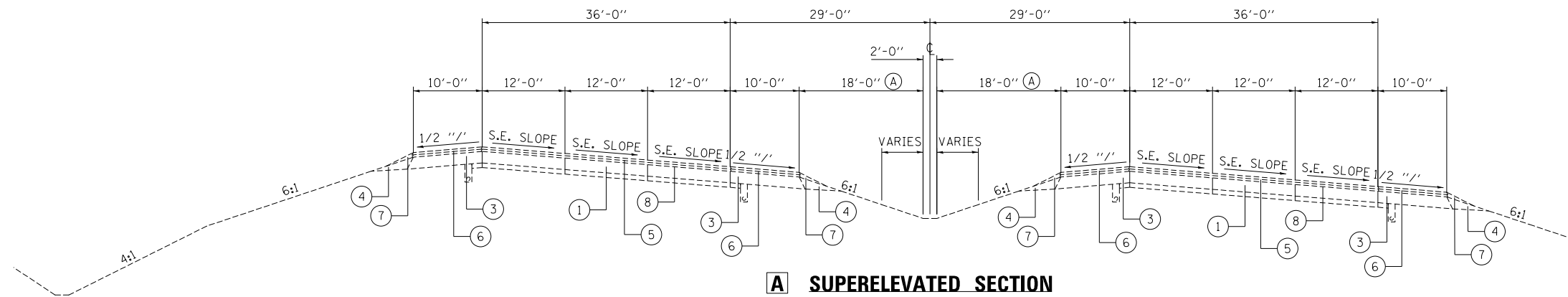

A SUPERELEVATED SECTION

Ⓐ MEDIAN TRANSITION 21' TO 18' - STA. 1387+05.68 TO STA 1401+50.94
 STA. 1390+00 TO STA. 1400+50
 STA. 1439+00 TO STA. 1475+00
 LT. STA. 1497+50 TO STA. 1497+91.39
 RT. STA. 1497+50 TO STA. 1504+18.14
 LT. STA. 1509+78 TO STA. 1514+50
 RT. STA. 1511+00 TO STA. 1514+50

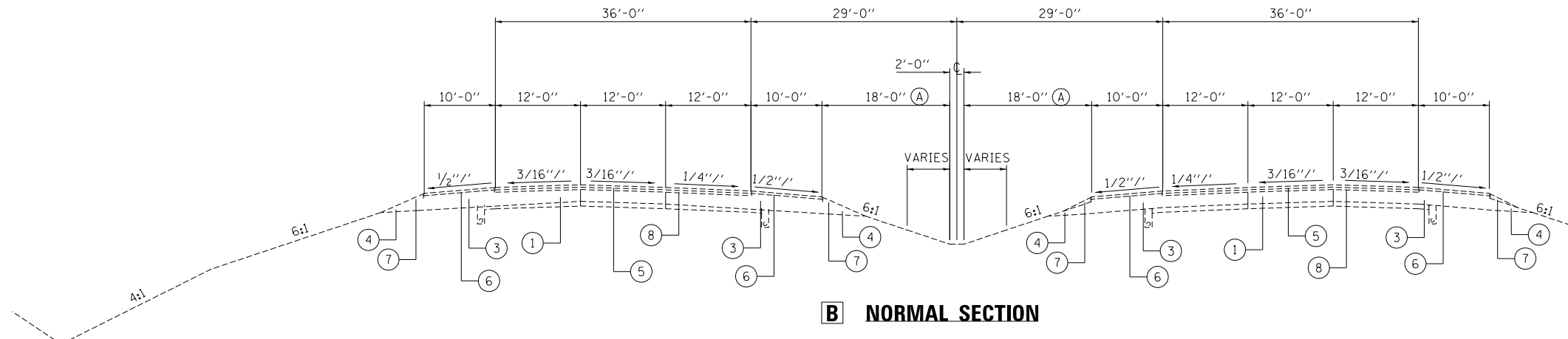

B NORMAL SECTION

Ⓐ MEDIAN TRANSITION 21' TO 18' - STA. 1387+05.68 TO STA 1401+50.94
 STA. 1400+50 TO STA. 1439+00
 STA. 1475+00 TO STA. 1497+50
 RT. STA. 1514+50 TO STA. 1522+79.80
 LT. STA. 1514+50 TO STA. 1523+70
 RT. STA. 1599+55 TO STA. 1612+92.15
 STA. 1626+02.37 TO END

- ① EXISTING PCC PAVEMENT
- ② EXISTING BITUMINOUS PAVEMENT
- ③ EXISTING BITUMINOUS SHOULDER
- ④ EXISTING AGGREGATE SHOULDERS
- ⑤ EXISTING POLYMERIZED HOT-MIX ASPHALT SURFACE COURSE, STONE MATRIX ASPHALT, N90 - 2 - 2" LIFTS
- ⑥ EXISTING HOT-MIX ASPHALT SHOULDERS, 4"
- ⑦ EXISTING AGGREGATE WEDGE SHOULDER, TYPE B - 4" TO 0"
- ⑧ EXISTING BITUMINOUS MATERIALS (PRIME COAT)

MODEL: D:\default
 FILE: NAME: P:\A\108\AEBID\NTEG: I:\h\p\p\WIDOT\Documents\DOT: Office\Bierfert: B\Projects\07\07\6M11\CADD\Drawings\07\6M11-Sub-Cy\plan.dgn

| | | |
|------------------------------|------------|-----------|
| USER NAME = lewiska | DESIGNED - | REVISED - |
| | DRAWN - | REVISED - |
| PLOT SCALE = 99.8718 ' / in. | CHECKED - | REVISED - |
| PLOT DATE = 12/7/2018 | DATE - | REVISED - |

**STATE OF ILLINOIS
 DEPARTMENT OF TRANSPORTATION**

| | | | |
|------------------------|-----------|-----------|--------------|
| TYPICAL SECTION | | | |
| SCALE: NTS | SHEET NO. | OF SHEETS | STA. TO STA. |

| F.A.I. RTE. | SECTION | COUNTY | TOTAL SHEETS | SHEET NO. |
|---|----------------|---------|--------------|-----------|
| 255 | 60-(7,8,9)CS-1 | MADISON | 16 | 8 |
| CONTRACT 76M14 | | | | |
| FED. ROAD DIST. NO. ILLINOIS FED. AID PROJECT | | | | |

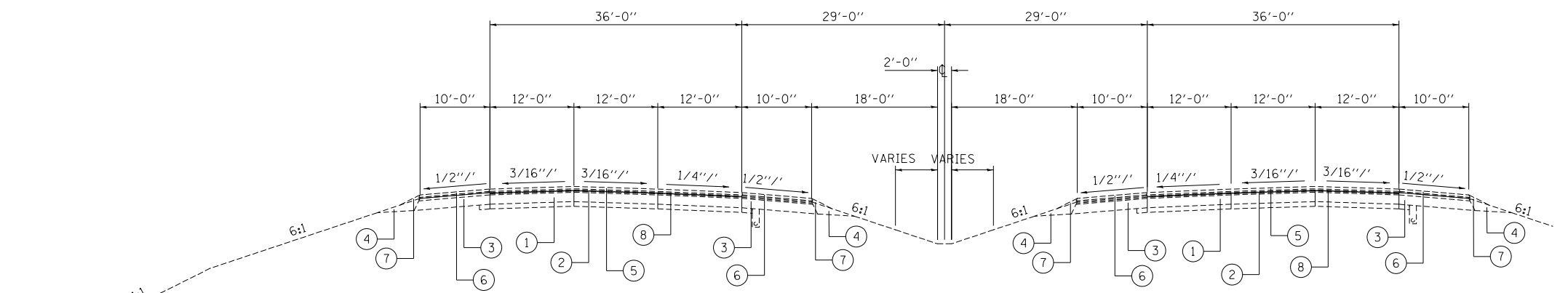

E NORMAL SECTION W/INLAY

RT. STA. 1534+40 TO STA. 1557+63.73
 LT. STA. 1534+40 TO STA. 1559+80
 LT. STA. 1586+88.95 TO STA. 1612+92.15
 RT. STA. 1597+28.72 TO STA. 1599+55

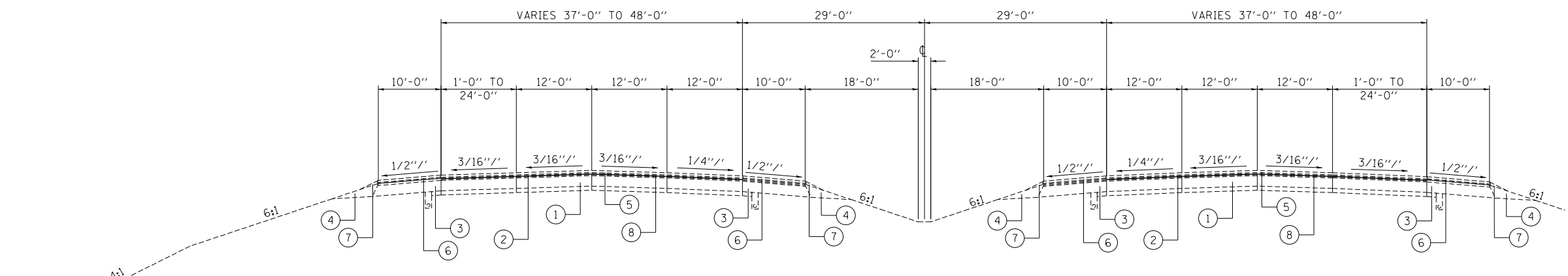

F EXTRA LANE W/INLAY SECTION

RT. STA. 1557+63.73 TO STA. 1566+34.35
 LT. STA. 1559+30 TO STA. 1566+34.35
 LT. STA. 1579+82.25 TO STA. 1581+30
 RT. STA. 1579+82.25 TO STA. 1588+63.30

- ① EXISTING PCC PAVEMENT
- ② EXISTING BITUMINOUS PAVEMENT
- ③ EXISTING BITUMINOUS SHOULDER
- ④ EXISTING AGGREGATE SHOULDERS
- ⑤ EXISTING POLYMERIZED HOT-MIX ASPHALT SURFACE COURSE, STONE MATRIX ASPHALT, N90 - 2 - 2" LIFTS
- ⑥ EXISTING HOT-MIX ASPHALT SHOULDERS, 4"
- ⑦ EXISTING AGGREGATE WEDGE SHOULDER, TYPE B - 4" TO 0"
- ⑧ EXISTING BITUMINOUS MATERIALS (PRIME COAT)

MODEL: D:\default
 FILE: NAME: P:\a\1108\B\BID\NTEG: 1108\p\p\WID\DOT\Documents\1108\DOT Office\Sheet\B\Projects\076M14\CADD\1108\CAD\Sheet\076M14-1-1-1-1-1.dgn

| | | |
|------------------------------|------------|-----------|
| USER NAME = lewisko | DESIGNED - | REVISED - |
| | DRAWN - | REVISED - |
| PLOT SCALE = 99.8718 ' / in. | CHECKED - | REVISED - |
| PLOT DATE = 12/7/2018 | DATE - | REVISED - |

**STATE OF ILLINOIS
 DEPARTMENT OF TRANSPORTATION**

TYPICAL SECTION

SCALE: NTS SHEET NO. OF SHEETS STA. TO STA.

| F.A.I. RTE. | SECTION | COUNTY | TOTAL SHEETS | SHEET NO. |
|---|-----------------|---------|--------------|-----------|
| 255 | 60-(7,8,9)CJS-1 | MADISON | 16 | 10 |
| CONTRACT 76M14 | | | | |
| FED. ROAD DIST. NO. ILLINOIS FED. AID PROJECT | | | | |

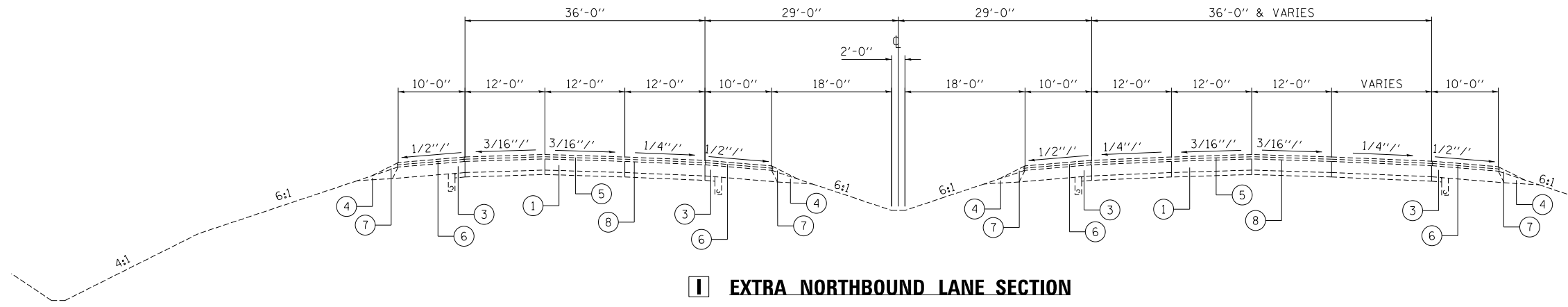

I EXTRA NORTHBOUND LANE SECTION

STA. 1612+92.15 TO STA. 1626+02.37

- ① EXISTING PCC PAVEMENT
- ② EXISTING BITUMINOUS PAVEMENT
- ③ EXISTING BITUMINOUS SHOULDER
- ④ EXISTING AGGREGATE SHOULDERS
- ⑤ EXISTING POLYMERIZED HOT-MIX ASPHALT SURFACE COURSE, STONE MATRIX ASPHALT, N90 - 2 - 2" LIFTS
- ⑥ EXISTING HOT-MIX ASPHALT SHOULDERS, 4"
- ⑦ EXISTING AGGREGATE WEDGE SHOULDER, TYPE B - 4" TO 0"
- ⑧ EXISTING BITUMINOUS MATERIALS (PRIME COAT)

MODEL: D:\default
 FILE: NAME: P:\A\1\08\AEBID\NTEG: IIR\h\p\p\WID\DOT\Documents\I\DOT Office\Sheet\B\Project\076M14\CADD\Drawings\Sheet\076M14-Sub-C\plan.dgn

| | | |
|------------------------------|------------|-----------|
| USER NAME = lewiska | DESIGNED - | REVISED - |
| | DRAWN - | REVISED - |
| PLOT SCALE = 99.8718 ' / in. | CHECKED - | REVISED - |
| PLOT DATE = 12/7/2018 | DATE - | REVISED - |

**STATE OF ILLINOIS
DEPARTMENT OF TRANSPORTATION**

TYPICAL SECTION

SCALE: NTS SHEET NO. OF SHEETS STA. TO STA.

| F.A.I. RTE. | SECTION | COUNTY | TOTAL SHEETS | SHEET NO. |
|---|-----------------|---------|--------------|-----------|
| 255 | 60-(7,8,9)CJS-1 | MADISON | 16 | 12 |
| CONTRACT 76M14 | | | | |
| FED. ROAD DIST. NO. ILLINOIS FED. AID PROJECT | | | | |

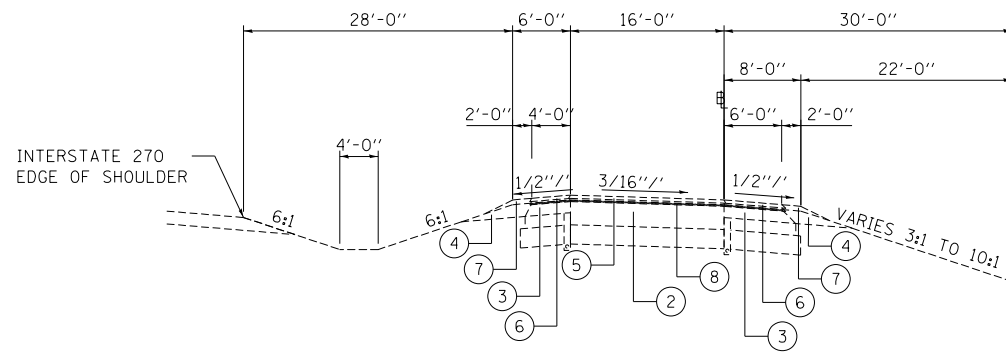

J INTERSTATE 270 COLLECTOR-DISTRIBUTOR ROAD SECTION

STA. 449+95.80 TO STA. 462+54.66
 STA. 472+98.78 TO STA. 482+54.48

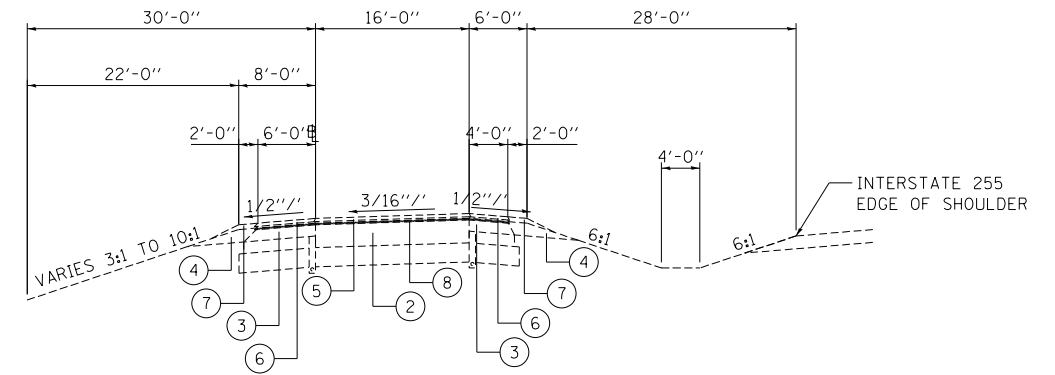

K INTERSTATE 255 COLLECTOR-DISTRIBUTOR ROAD SECTION

STA. 1593+72.56 TO STA. 1607+93.92
 STA. 1622+49.55 TO STA. END

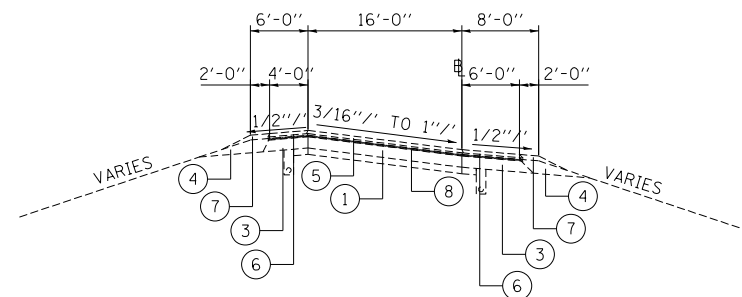

L 16' RAMP SECTION

STA. 1+72.07 TO STA. 19+36.87 (RAMP A)
 STA. 6+68.31 TO STA. 21+27.43 (RAMP B)
 STA. 1+72.06 TO STA. 14+07.28 (RAMP C)
 STA. 1511+05.58 (FAI 255) TO STA. 15+93.17 (RAMP D)
 STA. 149+94.41 TO STA. 179+64.12 (RAMP 1)
 STA. 214+24.09 TO STA. 229+95.61 (RAMP 2)
 STA. 354+04 TO STA. 354+69.49 (RAMP 3)
 STA. 462+62 TO STA. 482+85 (RAMP 4)
 STA. 709+84.89 TO STA. 721+35.24 (RAMP 7)
 STA. 872+68.92 TO STA. 885+39.21 (RAMP 8)

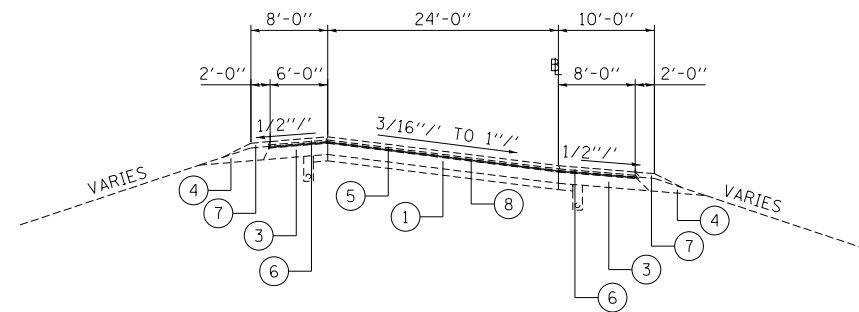

M 24' RAMP SECTION

STA. 697+24.85 TO STA. 761+00 (RAMP 6)

- ① EXISTING PCC PAVEMENT
- ② EXISTING BITUMINOUS PAVEMENT
- ③ EXISTING BITUMINOUS SHOULDER
- ④ EXISTING AGGREGATE SHOULDERS
- ⑤ EXISTING POLYMERIZED HOT-MIX ASPHALT SURFACE COURSE, STONE MATRIX ASPHALT, N90 - 2 - 2" LIFTS
- ⑥ EXISTING HOT-MIX ASPHALT SHOULDERS, 4"
- ⑦ EXISTING AGGREGATE WEDGE SHOULDER, TYPE B - 4" TO 0"
- ⑧ EXISTING BITUMINOUS MATERIALS (PRIME COAT)

| | | |
|-----------------------------|------------|-----------|
| USER NAME = lewisko | DESIGNED - | REVISED - |
| | DRAWN - | REVISED - |
| PLOT SCALE = 99.8718' / in. | CHECKED - | REVISED - |
| PLOT DATE = 12/7/2018 | DATE - | REVISED - |

**STATE OF ILLINOIS
 DEPARTMENT OF TRANSPORTATION**

TYPICAL SECTION

SCALE: NTS SHEET NO. OF SHEETS STA. TO STA.

| F.A.I. RTE. | SECTION | COUNTY | TOTAL SHEETS | SHEET NO. |
|---|-----------------|---------|--------------|-----------|
| 255 | 60-(7,8,9)CJS-1 | MADISON | 16 | 13 |
| CONTRACT 76M14 | | | | |
| FED. ROAD DIST. NO. ILLINOIS FED. AID PROJECT | | | | |

MODEL: D:\e\aut FILE: M:\MIS_P\31108\AEBID\NTEG:\H\h\p\p\WID\DOT\Documents\11\DOT Office\Sheet\B\Project\2018\76M14\CADD\Drawings\2018\76M14-13-13-13-13.dgn

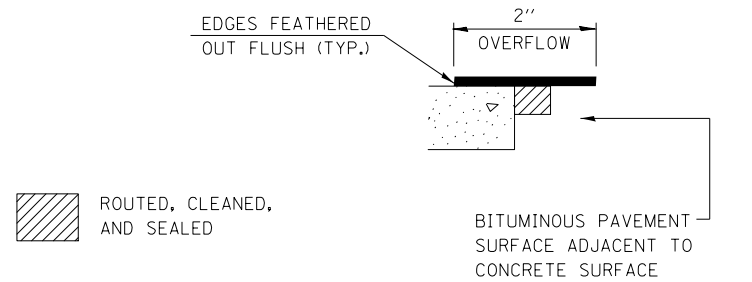
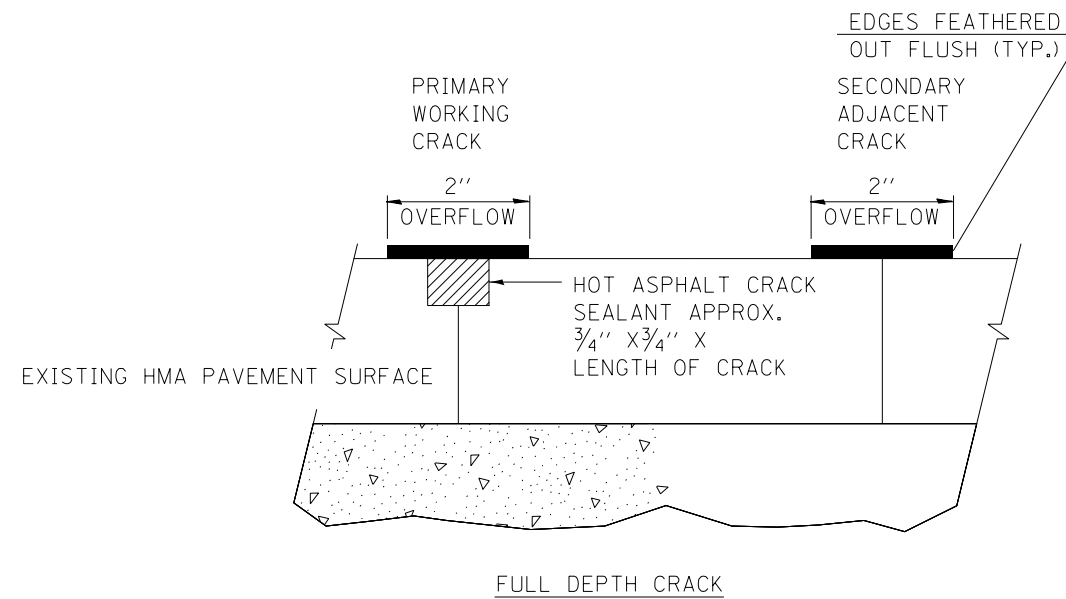

ROUTED, CLEANED, AND SEALED

TRANSVERSE/LONGITUDINAL JOINT

CRACK & JOINT SEALING DETAILS

MODEL: Default
FILE: \\nas101.pw.us:pub\dot\Documents\DOT_Offices\Director\Projects\0776M1\ACADD\staCAD\chereis\0776M14-sh-crack.dgn

| | | |
|------------------------------|------------|-----------|
| USER NAME = lewiska | DESIGNED - | REVISED - |
| | DRAWN - | REVISED - |
| PLOT SCALE = 100,0000' / in. | CHECKED - | REVISED - |
| PLOT DATE = 12/7/2018 | DATE - | REVISED - |

**STATE OF ILLINOIS
DEPARTMENT OF TRANSPORTATION**

CRACK & JOINT SEALING DETAIL

SCALE: SHEET OF SHEETS STA. TO STA.

| F.A.I. RTE. | SECTION | COUNTY | TOTAL SHEETS | SHEET NO. |
|--------------------|-----------------|---------|---------------------------|-----------|
| 255 | 60-(7,8,9)CJS-1 | MADISON | 16 | 16 |
| CONTRACT NO. 76M14 | | | ILLINOIS FED. AID PROJECT | |