

STATE OF ILLINOIS  
DEPARTMENT OF TRANSPORTATION

F.A.P. RTE.	SECTION	COUNTY	TOTAL SHEETS	SHEET NO.
770	12(W-1 RS-6)	SHELBY	18	1
		ILLINOIS	CONTRACT NO. 74879	

D-97-066-18

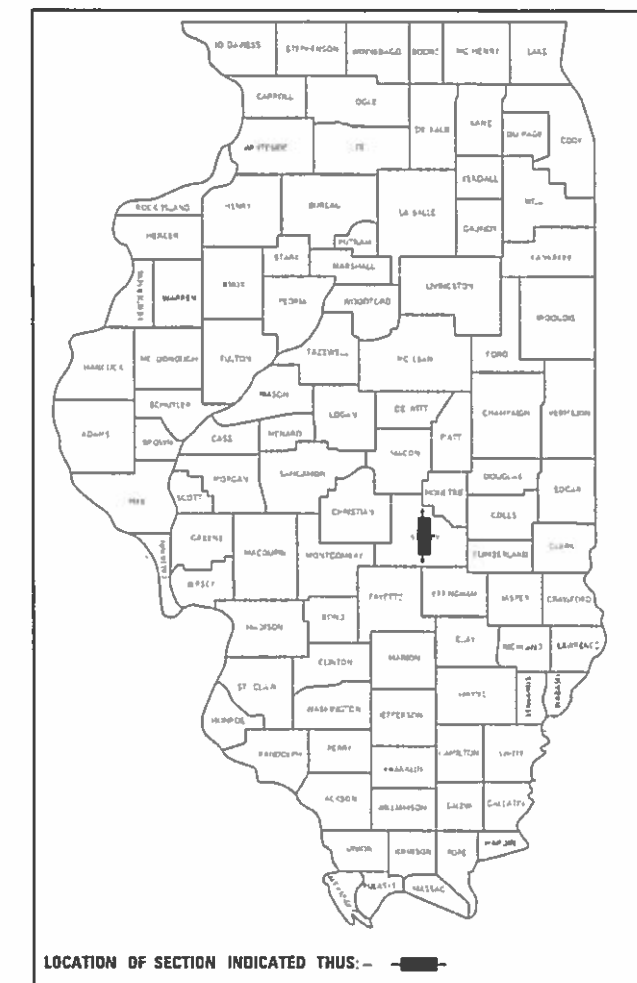

# PROPOSED HIGHWAY PLANS

FAP ROUTE 770 (IL 128)  
SECTION 12(W-1 RS-6)  
PROJECT STP-Y4ZF(683)  
RESURFACING (3P)  
SHELBY COUNTY

C-97-116-18

FOR INDEX OF SHEETS, SEE SHEET NO. 2

ADT = 8000 (2017)  
5.6% TRUCKS

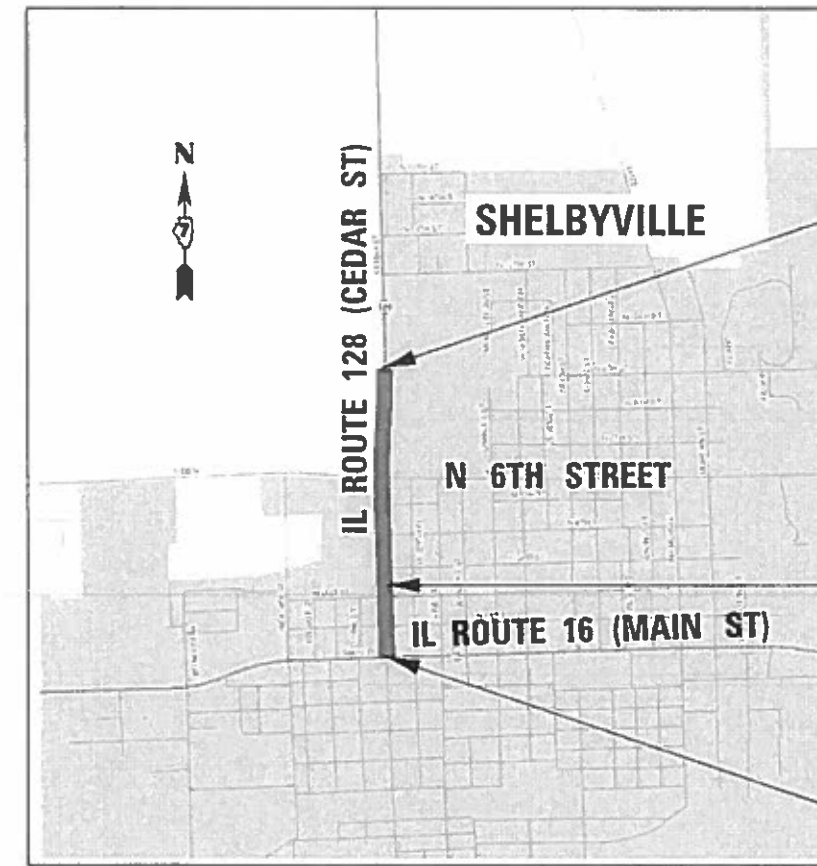

END PROJECT  
STA 34 + 60.00

STATION EQUATION  
STA 55 + 00.00 BK =  
STA 4 + 91.00 AH

BEGIN PROJECT  
STA 50 + 31.00

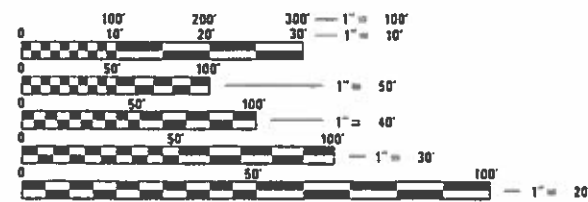

FULL SIZE PLANS HAVE BEEN PREPARED USING STANDARD ENGINEERING SCALES. REDUCED SIZED PLANS WILL NOT CONFORM TO STANDARD SCALES. IN MAKING MEASUREMENTS ON REDUCED PLANS, THE ABOVE SCALES MAY BE USED.

J.U.L.I.E.  
JOINT UTILITY LOCATION INFORMATION FOR EXCAVATION  
1-800-892-0123  
OR 811

PROJECT ENGINEER: DEBRA BARRETT  
PROJECT MANAGER: LEAH HILLE

CONTRACT NO. 74879

GROSS LENGTH = 3438.0 FT. = 0.65 MILE  
NET LENGTH = 3438.0 FT. = 0.65 MILE

STATE OF ILLINOIS  
DEPARTMENT OF TRANSPORTATION

SUBMITTED December 13 20 18  
Jeffrey M. Smith  
REGIONAL ENGINEER

Feb 1 20 19  
on E.A. ETC  
ENGINEER OF DESIGN AND ENVIRONMENT

Feb 20 19  
David L. Chaffin  
DIRECTOR OF HIGHWAYS PROJECT IMPLEMENTATION

PRINTED BY THE AUTHORITY  
OF THE STATE OF ILLINOIS

INDEX OF SHEETS

<u>SHEET NO.</u>	<u>ITEM</u>
1	COVER SHEET
2	INDEX OF SHEETS, LIST OF STANDARDS, AND GENERAL NOTES
3-4	SUMMARY OF QUANTITIES
5	TYPICAL CROSS SECTIONS
6	SCHEDULE OF QUANTITIES
7-8	REMOVAL DETAILS
9-10	ADA RAMP DETAILS
11	DETECTOR LOOP DETAIL
12	6TH STREET DETAIL
13-18	DISTRICT 7 DETAIL SHEETS

THE FOLLOWING STANDARDS ARE A PART OF THESE PLANS AND ARE INCLUDED AFTER SHEET NO. 18:

<u>STANDARD NO.</u>	<u>DESCRIPTION</u>
000001-07	STANDARD SYMBOLS, ABBREVIATIONS AND PATTERNS
001006	DECIMAL OF AN INCH AND OF A FOOT
424006-04	DIAGONAL CURB RAMPS FOR SIDEWALKS
424011-04	CORNER PARALLEL CURB RAMPS FOR SIDEWALKS
442201-03	CLASS C AND D PATCHES
606001-07	CONCRETE CURB TYPE B AND COMBINATION CONCRETE CURB AND GUTTER
667101-02	PERMANENT SURVEY MARKERS
701006-05	OFF-RD OPERATIONS, 2L, 2W, 15' TO 24" FROM PAVEMENT EDGE
701011-04	OFF-RD MOVING OPERATIONS, 2L, 2W, DAY ONLY
701301-04	LANE CLOSURE, 2L, 2W, SHORT TIME OPERATIONS
701311-03	LANE CLOSURE, 2L, 2W MOVING OPERATIONS-DAY ONLY
701501-06	URBAN LANE CLOSURE, 2L, 2W, UNDIVIDED
701502-09	URBAN LANE CLOSURE, 2L, 2W, WITH BIDIRECTIONAL LEFT TURN LANE
701701-10	URBAN LANE CLOSURE, MULTILANE INTERSECTION
701801-06	SIDEWALK, CORNER OR CROSSWALK CLOSURE
701901-08	TRAFFIC CONTROL DEVICES
780001-05	TYPICAL PAVEMENT MARKINGS
781001-04	TYPICAL APPLICATIONS RAISED REFLECTIVE PAVEMENT MARKERS
886001-01	DETECTOR LOOP INSTALLATIONS
886006-01	TYPICAL LAYOUT FOR DETECTION LOOPS

GENERAL NOTES

THIS PROJECT IS LOCATED ON FAP ROUTE 770 (IL 128) IN SHELBY COUNTY, FROM THE IL 16 / IL 128 INTERSECTION TO 0.2 MILES NORTH OF N 6TH STREET IN SHELBYVILLE. THE WORK INCLUDED IN SECTION 12 (W-1 RS-6) CONSISTS OF MILLING, HOT-MIX ASPHALT RESURFACING, PAVEMENT MARKING, SIDEWALK REMOVAL, ADA RAMPS AND ANY OTHER WORK NECESSARY TO COMPLETE THE SECTION.

THE CONTRACTOR SHALL BEGIN PLACING LEVELING BINDER WITHIN 72 HOURS OF COMPLETING THE HOT-MIX ASPHALT SURFACE REMOVAL. THE RESIDENT ENGINEER SHALL BE THE SOLE JUDGE CONCERNING THE CURING TIME FOR THE VARIOUS HOT-MIX ASPHALT LIFTS.

PAVEMENT MARKING SHALL BE APPLIED IN ACCORDANCE WITH SECTION 780 OF THE STANDARD SPECIFICATIONS. SHORT TERM PAVEMENT MARKING SHALL BE APPLIED TO THE MILLED SURFACE, LEVELING BINDER, AND HOT-MIX ASPHALT SURFACE COURSE AS SPECIFIED IN SECTION 703 OF THE STANDARD SPECIFICATIONS. TEMPORARY TAPE SHALL BE USED ON THE SURFACE COURSE AND PAINT SHALL BE USED ON THE MILLED SURFACE AND LEVELING BINDER.

AN ESTIMATED QUANTITY OF FRAMES AND LIDS TO BE ADJUSTED HAS BEEN INCLUDED FOR ANY DRAINAGE AND UTILITY STRUCTURE LIDS THAT ARE AFFECTED DURING CONSTRUCTION OPERATIONS. THE ACTUAL LOCATIONS AND FINAL QUANTITIES SHALL BE DETERMINED BY THE ENGINEER IN THE FIELD.

THE PROPOSED SIDEWALKS AND SIDEWALK REMOVAL WILL REQUIRE GRADING AND SHAPING TO BLEND THE SIDEWALK IN WITH THE EXISTING TERRAIN TO THE SATISFACTION OF THE ENGINEER. ALL DISTURBED AREAS WILL REQUIRE SEEDING, CLASS 2 AS WELL AS NITROGEN, PHOSPHORUS AND POTASSIUM FETILIZER NUTRIENTS. THE APPLICATION OF THE REQUIRED SEEDING AND FETILIZER NUTRIENTS SHALL CONFORM TO ARTICLE 250 OF THE STANDARD SPECIFICATIONS. THE GRADING AND SHAPING, SEEDING AND FERTILIZERS SHALL NOT BE PAID FOR SEPARATELY BUT SHALL BE INCLUDED IN THE COSTS OF PORTLAND CEMENT CONCRETE SIDEWALK, 6".

THE FOLLOWING MIXTURE REQUIREMENTS ARE APPLICABLE TO THIS PROJECT:

	APPLICATION	AC/PG	DESIGN AIR VOIDS	MIXTURE COMPOSITION	FRICTION AGGREGATE	QUALITY MANAGEMENT
MAINLINE	POLYMERIZED HMA SURFACE COURSE, MIX "D", N90 (1 1/2")	SBS 70-22	4.0% @ N=90	IL - 9.5	MIXTURE D	QC/QA
	POLYMERIZED HMA LEVEL BINDER, MACHINE METHOD, FINE GRADED, N90 (3/4")	SBS 70-22	4.0% @ N=90	IL - 9.5FG	N/A	QC/QA
	HMA PATCHING, CLASS "D"	PG 64-22	4.0% @ N=90	IL 19.0	N/A	QC/QA
6TH STREET	INCIDENTAL HMA SURFACE COURSE	PG 64-22	4.0% @ N=70	IL - 9.5	MIXTURE C	QC/QA

MODEL: Default  
 FILE NAME: P:\1108\B&E\BIDD\TEC\Illinois.gov\FWIDOT\Documents\BIDD\Office\BIDD\770\Project\770\CAD\DATA\CAD\Sheet\770\770-12-GENERAL.DWG

USER NAME = steffemk	DESIGNED - LMH	REVISED -	<b>STATE OF ILLINOIS DEPARTMENT OF TRANSPORTATION</b>	<b>INDEX OF SHEETS AND GENERAL NOTES</b>			F.A.P. RTE. = 770	SECTION = 12(W-1 RS-6)	COUNTY = SHELBY	TOTAL SHEETS = 18	SHEET NO. = 2
PLOT SCALE = 100.0000' / in.	CHECKED -	REVISED -					CONTRACT NO. 74879				
PLOT DATE = 12/13/2018	DATE - 12/13/2018	REVISED -		SCALE: NO SCALE	SHEET OF SHEETS	STA. TO STA.	ILLINOIS FED. AID PROJECT				

SUMMARY OF QUANTITIES			TOTAL QUANTITIES	CONSTRUCTION TYPE CODE		
CODE NO	ITEM	UNIT		0005 80% FED 20% STATE	0005 100% CITY	
40600290	BITUMINOUS MATERIALS (TACK COAT)	POUND	9290.9	9290.9		
40600847	POLYMERIZED LEVELING BINDER (MACHINE METHOD), IL-9.5FG, N90	TON	578	578		
40600990	TEMPORARY RAMP	SO YD	3515.8	3495.8	20	
40603545	POLYMERIZED HOT-MIX ASPHALT SURFACE COURSE, MIX "D", N90	TON	1156.2	1156.2		
40800050	INCIDENTAL HOT-MIX ASPHALT SURFACING	TON	51		51	
42400300	PORTLAND CEMENT CONCRETE SIDEWALK 6 INCH	SO FT	361.5	361.5		
42400800	DETECTABLE WARNINGS	SO FT	22	22		
44000100	PAVEMENT REMOVAL	SO YD	13	13		
44000155	HOT-MIX ASPHALT SURFACE REMOVAL, 1 1/2"	SO YD	605		605	
44000158	HOT-MIX ASPHALT SURFACE REMOVAL, 2 1/4"	SO YD	13751	13751		
44000300	CURB REMOVAL	FOOT	133	133		
44000500	COMBINATION CURB AND GUTTER REMOVAL	FOOT	59	59		
44000600	SIDEWALK REMOVAL	SO FT	452	452		

SUMMARY OF QUANTITIES			TOTAL QUANTITIES	CONSTRUCTION TYPE CODE		
CODE NO	ITEM	UNIT		0005 80% FED 20% STATE	0005 100% CITY	
44201815	CLASS D PATCHES, TYPE II, 14 INCH	SO YD	43	43		
44201851	CLASS D PATCHES, TYPE II, 17 INCH	SO YD	96	96		
60300105	FRAMES AND GRATES TO BE ADJUSTED	EACH	3	1	2	
60600605	CONCRETE CURB, TYPE B	FOOT	48.4	48.4		
60605000	COMBINATION CONCRETE CURB AND GUTTER, TYPE B-6.24	FOOT	61.5	61.5		
67000500	ENGINEER'S FIELD OFFICE, TYPE B	CAL MO	3	3		
67100100	MOBILIZATION	L SUM	1	1		
70102620	TRAFFIC CONTROL AND PROTECTION, STANDARD	L SUM	1	1		
	701501					
70102622	TRAFFIC CONTROL AND PROTECTION, STANDARD	L SUM	1	1		
	701502					
70102635	TRAFFIC CONTROL AND PROTECTION, STANDARD	L SUM	1	1		
	701701					
70102640	TRAFFIC CONTROL AND PROTECTION, STANDARD	L SUM	1	1		
	701801					
70107025	CHANGEABLE MESSAGE SIGN	CAL DA	42	42		

MODEL: Default  
 FILE: \\mhc-pw01\p01\DOT\Documents\DOT\_Offices\DLH\774879\CADD\DATA\CADD\Sheet\774879-PL-500.dgn

USER NAME = steffenmk	DESIGNED - LMH	REVISED -
	DRAWN - LMH	REVISED -
PLOT SCALE = 100.0000' / in.	CHECKED - BCH	REVISED -
PLOT DATE = 12/13/2018	DATE - 12/13/2018	REVISED -

**STATE OF ILLINOIS  
DEPARTMENT OF TRANSPORTATION**

**SUMMARY OF QUANTITIES**

SCALE: NO SCALE SHEET OF SHEETS STA. TO STA.

F.A.P. RTE.	SECTION	COUNTY	TOTAL SHEETS	SHEET NO.
770	12(W-1 RS-6)	SHELBY	18	3
CONTRACT NO. 74879				
ILLINOIS FED. AID PROJECT				

SUMMARY OF QUANTITIES			TOTAL QUANTITIES	CONSTRUCTION TYPE CODE		
CODE NO	ITEM	UNIT		0005 80% FED 20% STATE	0005 100% CITY	
70300100	SHORT TERM PAVEMENT MARKING	FOOT	2844	2844		
70300150	SHORT TERM PAVEMENT MARKING REMOVAL	SQ FT	948	948		
* 78000100	THERMOPLASTIC PAVEMENT MARKING - LETTERS AND SYMBOLS	SQ FT	328	312	16	
* 78000200	THERMOPLASTIC PAVEMENT MARKING - LINE 4"	FOOT	8591	8521	70	
* 78000400	THERMOPLASTIC PAVEMENT MARKING - LINE 6"	FOOT	297	260	37	
* 78000600	THERMOPLASTIC PAVEMENT MARKING - LINE 12"	FOOT	122	122		
* 78000650	THERMOPLASTIC PAVEMENT MARKING - LINE 24"	FOOT	68	32	36	
* 78100100	RAISED REFLECTIVE PAVEMENT MARKER	EACH	163	163		
* 88600100	DETECTOR LOOP, TYPE I	FOOT	384	384		
* X7830060	GROOVING FOR RECESSED PAVEMENT MARKING, LETTERS AND SYMBOLS	SQ FT	1008	960	48	
* X7830070	GROOVING FOR RECESSED PAVEMENT MARKING 5"	FOOT	8591	8521	70	
* X7830074	GROOVING FOR RECESSED PAVEMENT MARKING 7"	FOOT	297	260	37	
* X7830078	GROOVING FOR RECESSED PAVEMENT MARKING 13"	FOOT	122	122		

SUMMARY OF QUANTITIES			TOTAL QUANTITIES	CONSTRUCTION TYPE CODE		
CODE NO	ITEM	UNIT		0005 80% FED 20% STATE	0005 100% CITY	
* X7830090	GROOVING FOR RECESSED PAVEMENT MARKING 25"	FOOT	68	32	36	
Z0033700	LONGITUDINAL JOINT SEALANT	FOOT	6876	6876		
Z0049799	PROTECTING OR RESETTING SURVEY MARKERS	EACH	3	3		

\* SPECIALTY ITEM

MODEL: Default  
 FILE: \\mllcpc-pw01\B&E\BID\NTEC\Illinok\proj\RW\DOT\Documents\10DOT\_Offices\1074879\CADDData\CAD\pkcs1074879-plr-500.dgn

USER NAME = steffenmk	DESIGNED - LMH	REVISED -
	DRAWN - LMH	REVISED -
PLOT SCALE = 100.0000 ' / in.	CHECKED - BCH	REVISED -
PLOT DATE = 12/13/2018	DATE - 12/13/2018	REVISED -

**STATE OF ILLINOIS  
DEPARTMENT OF TRANSPORTATION**

**SUMMARY OF QUANTITIES**

SCALE: NO SCALE SHEET OF SHEETS STA. TO STA.

F.A.P. RTE.	SECTION	COUNTY	TOTAL SHEETS	SHEET NO.
770	12(W-1 RS-6)	SHELBY	18	4
CONTRACT NO. 74879			ILLINOIS FED. AID PROJECT	

**TYPICAL CROSS SECTION**  
 STA 50+31.00 TO STA 55+00.00 BK = 4+91.00 AH (STATION EQUATION)  
 STA. 4+91.00 TO STA 32+86.00

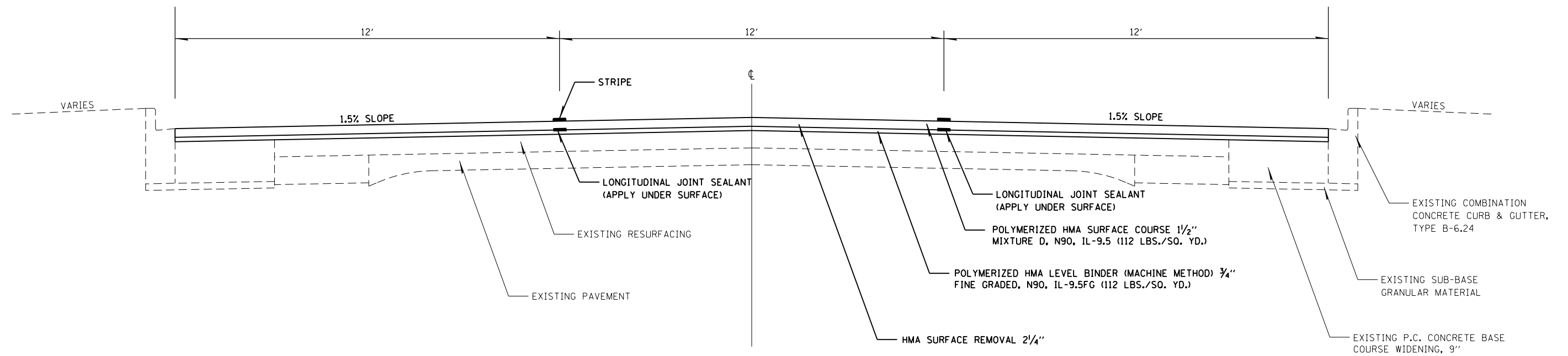

**TYPICAL CROSS SECTION**  
 STA 32+86.00 TO STA 34+60.00

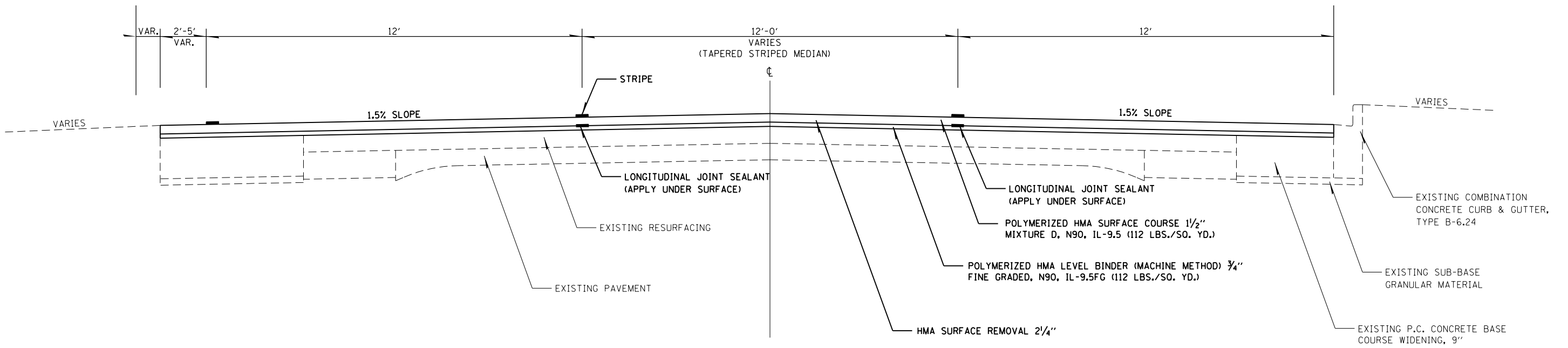

MODEL: Default  
 FILE: \\nas0101\proj\74879\CADD\Drawings\DOT Documents\Sheet 7\Project\74879\CADD\Drawings\74879-PCS\Typical.dgn

USER NAME = steffenmk	DESIGNED - LMH	REVISED -
	DRAWN - LMH	REVISED -
PLOT SCALE = 40.0000 ' / in.	CHECKED - MLB	REVISED -
PLOT DATE = 12/13/2018	DATE - 10/24/2018	REVISED -

**STATE OF ILLINOIS  
 DEPARTMENT OF TRANSPORTATION**

<b>TYPICAL CROSS SECTION</b>	
SCALE: NO SCALE	SHEET OF SHEETS
STA. 50+31.00	TO STA. 34+60.00

F.A.P. RTE.	SECTION	COUNTY	TOTAL SHEETS	SHEET NO.
770	12(W-1 RS-6)	SHELBY	18	5
CONTRACT NO. 74879				
ILLINOIS FED. AID PROJECT				

PATCHING SCHEDULE						
NUMBER	STATION	LANE	WIDTH	LENGTH	AREA OF 17" PATCHES	AREA OF 14" PATCHES
1	52+09	NB	12	4	5.3	-
2	52+09	CL	12	4	5.3	-
3	52+09	SB	12	4	5.3	-
4	52+64	NB	12	6	8.0	-
5	52+64	CL	12	6	8.0	-
6	52+64	SB	12	6	8.0	-
7	52+96	NB	12	10	13.3	-
8	52+96	CL	12	10	13.3	-
9	52+96	SB	12	10	13.3	-
10	53+16	NB	12	4	5.3	-
11	53+16	CL	12	4	5.3	-
12	53+16	SB	12	4	5.3	-
STATION EQUATION (55+00.0 BH = 4+91.0 AK)						
13	8+00	NB	12	4	-	5.3
14	32+93	NB	12	10	-	13.3
15	32+93	CL	10	10	-	11.1
16	32+93	SB	12	10	-	13.3
TOTALS:					96	43

SURVEY MARKER SCHEDULE				
NUMBER	STATION	OFFSET	TYPE	DESCRIPTION
-	21+ 15.14	0.00 FT	PC	IRON PIN WITH CAP IN TURNING LANE CL
503	25+ 59.32	10.0FT LT	PI	IRON PIN WITH CAP IN SB LANE 6 INCHES BELOW PAVEMENT
502	30+01.53	0.00 FT	PRC	IRON PIN WITH CAP IN TURNING LANE CL

PAVEMENT MARKING SCHEDULE																		
STATION	TO	STATION	LENGTH	SHORT TERM PAVEMENT MARKING (WHITE)	SHORT TERM PAVEMENT MARKING (YELLOW)	SHORT TERM PAVEMENT MARKING REMOVAL	THERMOPLASTIC PAVEMENT MARKING - 4" (WHITE)	THERMOPLASTIC PAVEMENT MARKING - 4" (YELLOW)	GROOVING FOR RECESSED PAVEMENT MARKING 5"	THERMOPLASTIC PAVEMENT MARKING - 6" (WHITE)	GROOVING FOR RECESSED PAVEMENT MARKING 7"	THERMOPLASTIC PAVEMENT MARKING - 12" (YELLOW)	GROOVING FOR RECESSED PAVEMENT MARKING 13"	THERMOPLASTIC PAVEMENT MARKING - 24" (WHITE)	GROOVING FOR RECESSED PAVEMENT MARKING 25"	THERMOPLASTIC PAVEMENT MARKING - LETTERS AND SYMBOLS	GROOVING FOR RECESSED PAVEMENT MARKING - LETTERS AND SYMBOLS	
50+31			-	-	-	-	-	-	-	-	-	-	-	-	-	-	-	-
50+41			-	-	-	-	-	-	-	160.0	160.0	-	-	-	-	-	-	-
50+52			-	576.0	-	192.0	-	-	-	-	-	-	-	32.0	32.0	-	-	-
50+52	TO	52+27	175.1	300.0	105.1	135.0	-	350.2	350.2	100.0	100.0	-	-	-	-	31.2	96.0	
52+27	TO	52+62	35.0	-	21.0	7.0	-	105.0	105.0	-	-	-	-	-	-	-	-	
52+62	TO	55+00	238.0	-	142.8	47.6	-	595.0	595.0	-	-	-	-	-	-	-	-	
STATION EQUATION (55+00.0 BH = 4+91.0 AK)																		
4+91	TO	31+84	2693.0	-	1615.8	538.6	-	6732.5	6732.5	-	-	-	-	-	-	280.8	864.0	
22+77			-	-	-	-	-	70.0	70.0	37.0	37.0	-	-	36.0	36.0	15.6	48.0	
31+84	TO	34+60	276.0	-	82.8	27.6	186.0	552.0	738.0	-	-	122.0	122.0	-	-	-	-	
TOTALS:				2844	948	8591	8591	297	297	122	122	68	68	328	1008			

ADA SCHEDULE									
LOCATION	SIDEWALK REMOVAL	CURB REMOVAL	COMBINATION CURB AND GUTTER REMOVAL	PAVEMENT REMOVAL	PORTLAND CEMENT CONCRETE SIDEWALK 6 INCH	DETECTABLE WARNINGS	CONCRETE CURB, TYPE B	COMBINATION CURB AND GUTTER, TYPE B-6.24	
IL 128/IL 16 NW QUADRANT	229.4	61.4	21.6	-	143.1	10.8	18.9	21.6	
IL 128/IL 16 NE QUADRANT	191.0	71.3	27.4	12.7	218.4	11.3	29.5	29.8	
W NORTH 1ST STREET	32.0	-	10.0	-	-	-	-	10.0	
TOTALS:									
	452	133	59	13	361.5	22	48.4	61.5	

REFLECTIVE PAVEMENT MARKER SCHEDULE					
STATION	TO	STATION	LENGTH	CRYSTAL RAISED REFLECTIVE PAVEMENT MARKER	AMBER RAISED REFLECTIVE PAVEMENT MARKER
50+31	TO	55+00	469.0	4	20
STATION EQUATION (55+00.0 BH = 4+91.0 AK)					
4+91	TO	34+60	2969.0	-	140
TOTALS:				4	159
GRAND TOTAL:				163	

LONGITUDINAL JOINT SEALANT				
STATION	TO	STATION	APPLICATION UNDER SURFACE - JOINT LEFT OF TURN LANE	APPLICATION UNDER SURFACE - JOINT RIGHT OF TURN LANE
50+31	TO	55+00	469.0	469.0
STATION EQUATION (55+00.0 BH = 4+91.0 AK)				
4+91	TO	34+60	2969.0	2969.0
TOTALS:			3438.0	3438.0
GRAND TOTAL:			6876	

MODEL: Default  
FILE: \\nas101\B&E\BID\NTEC\Illinois\gov\p\W\DOT\Documents\1\DOT\_Offices\1\74879\CADD\DATA\CAD\pkcses\1\74879\p\pc-schedule.dgn

USER NAME = steffemk	DESIGNED - LMH	REVISED -
DRAWN - LMH	REVISED -	
PLOT SCALE = 100.0000' / in.	CHECKED -	REVISED -
PLOT DATE = 12/13/2018	DATE - 12/13/2018	REVISED -



**STATE OF ILLINOIS  
DEPARTMENT OF TRANSPORTATION**

**SCHEDULE OF QUANTITIES**

SCALE: NO SCALE SHEET OF SHEETS STA. TO STA.

F.A.P. RTE.	SECTION	COUNTY	TOTAL SHEETS	SHEET NO.
770	12(W-1 RS-6)	SHELBY	18	6
CONTRACT NO. 74879				
ILLINOIS FED. AID PROJECT				

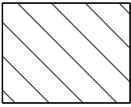

-  SIDEWALK REMOVAL
-  CURB REMOVAL
-  COMBINATION CURB AND GUTTER REMOVAL

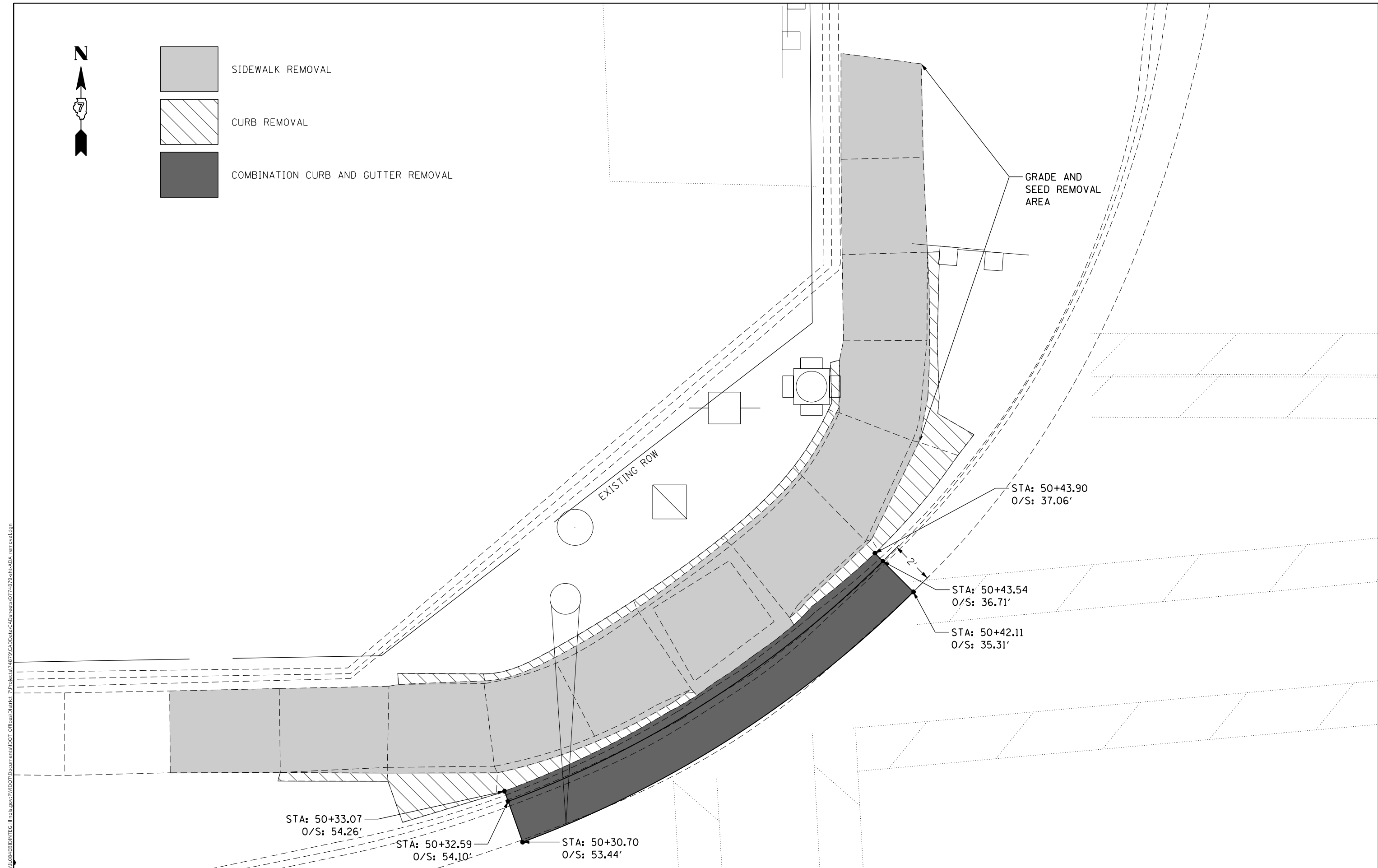

MODEL: Default  
 FILE NAME: P:\IL128\BARENDIN\TEG\_IL128\proj\DOT\Documents\DOT\_Offices\District 7\Projects\74879\CADD\DATA\CAD\lines\DOT74879-shc-ADA\_removal.dwg





USER NAME = hillelm	DESIGNED - LMH	REVISED -
	DRAWN - LMH	REVISED -
PLOT SCALE = 4.0000' / in.	CHECKED - MLB	REVISED -
PLOT DATE = 12/13/2018	DATE - 12/13/2018	REVISED -

**STATE OF ILLINOIS**  
**DEPARTMENT OF TRANSPORTATION**

<b>NORTHWEST QUADRANT REMOVAL</b> <b>IL 128 /IL 16 INTERSECTION</b>			
SCALE: 4.0000' / in.	SHEET	OF	SHEETS
	STA.		TO STA.

F.A.P. RTE.	SECTION	COUNTY	TOTAL SHEETS	SHEET NO.
770	12(W-1 R5-6)	SHELBY	18	7
CONTRACT NO. 74879				
ILLINOIS FED. AID PROJECT				



-  SIDEWALK REMOVAL
-  CURB REMOVAL
-  COMBINATION CURB AND GUTTER REMOVAL
-  PAVEMENT REMOVAL

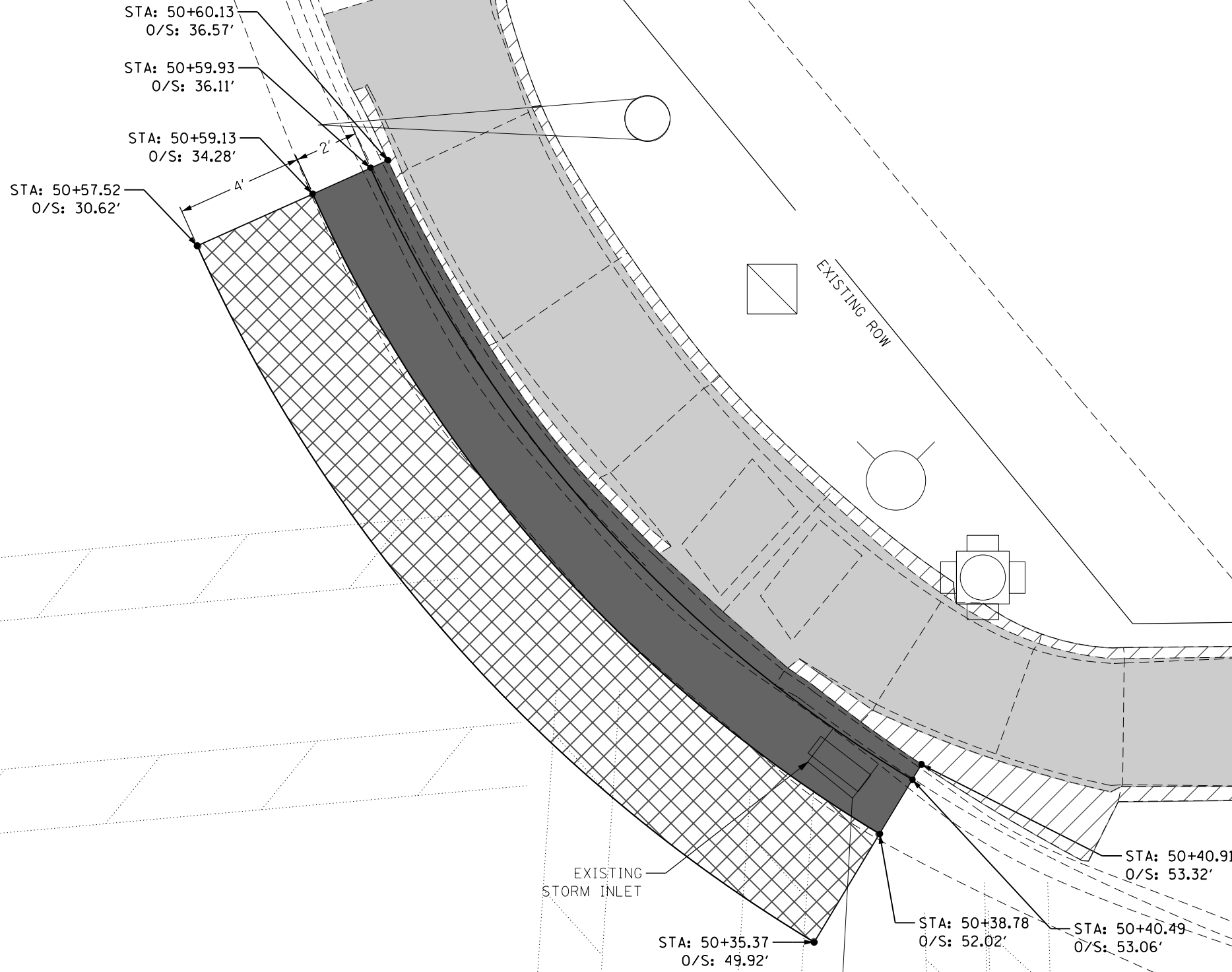

MODEL: Default  
 FILE NAME: p:\1108\BAE\BID\NITEG\_illinois.gov\PVID\DOT\Documents\10DOT\_Offices\District 7\Projects\12879\CADD\DATA\CAD\Sheet\12879-plc-ADA\_removal.dwg

USER NAME = nillelm	DESIGNED - LMH	REVISED -
DRAWN - LMH	REVISIONS -	
PLOT SCALE = 4.0000' / in.	CHECKED - MLB	REVISED -
PLOT DATE = 12/13/2018	DATE - 12/13/2018	REVISED -

**STATE OF ILLINOIS  
DEPARTMENT OF TRANSPORTATION**

**NORTHEAST QUADRANT REMOVAL  
IL 128 /IL 16 INTERSECTION**

SCALE: 4.0000' / in. SHEET OF SHEETS STA. TO STA.

F.A.P. RTE.	SECTION	COUNTY	TOTAL SHEETS	SHEET NO.
770	12(W-1 R5-6)	SHELBY	18	8
CONTRACT NO. 74879				
ILLINOIS FED. AID PROJECT				





MODEL: Default  
 FILE NAME: p:\11108\B&E\INDITEG\Illinois.gov-PWD\DOT\Documents\11DOT\_Offices\District 7\Projects\12174879\CADD\Drawings\12174879-11108.dwg

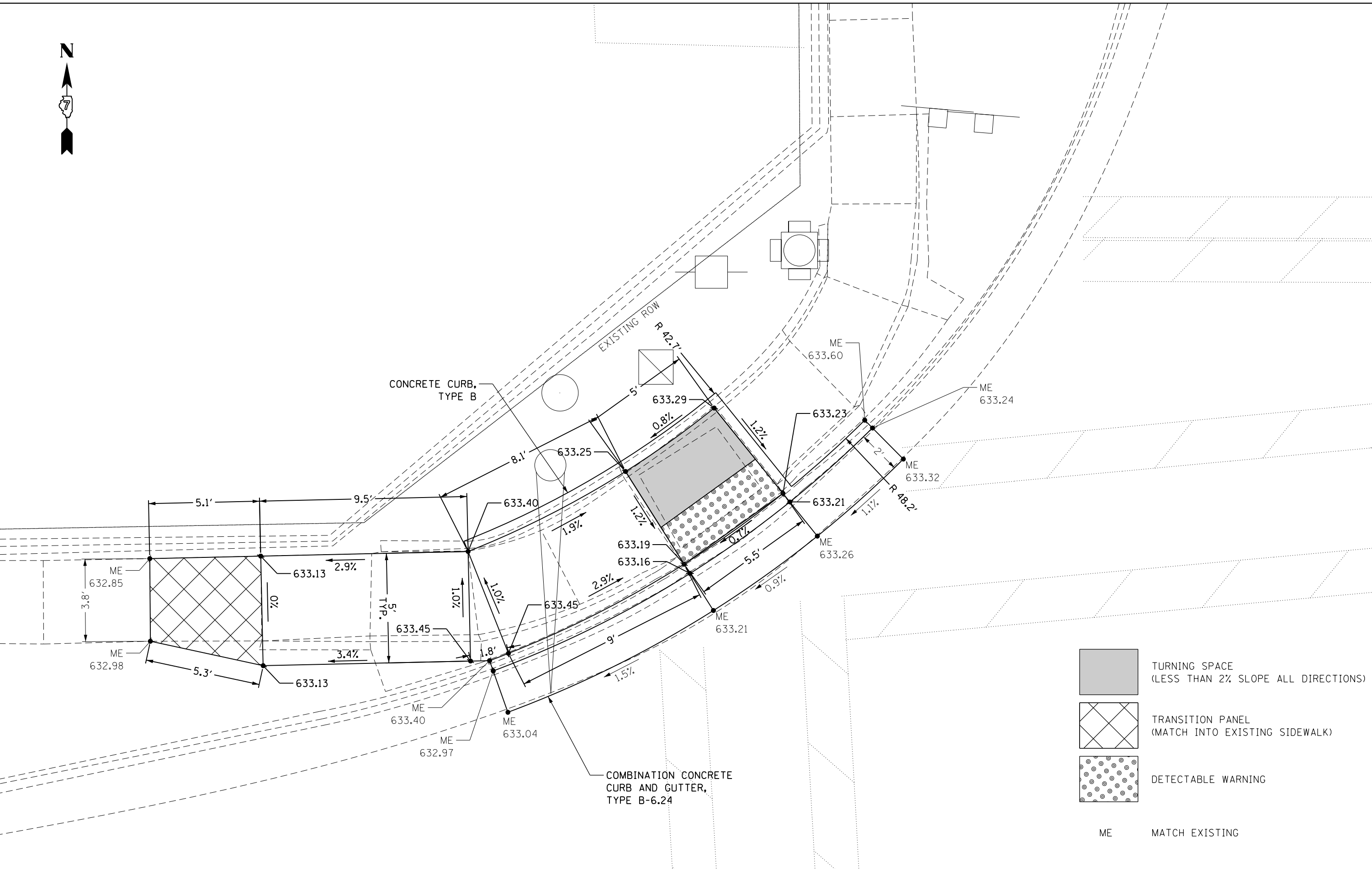

USER NAME = hillelm	DESIGNED - LMH	REVISED -
DRAWN - LMH	REVISED -	
PLOT SCALE = 4.0000 ' / in.	CHECKED - NAS	REVISED -
PLOT DATE = 12/13/2018	DATE - 12/13/2018	REVISED -



**STATE OF ILLINOIS**  
**DEPARTMENT OF TRANSPORTATION**

**NORTHWEST QUADRANT ADA RAMP**  
**IL 128 / IL 16 INTERSECTION**

SCALE: 4.0000 ' / in. SHEET OF SHEETS STA. TO STA.

F.A.P. RTE.	SECTION	COUNTY	TOTAL SHEETS	SHEET NO.
770	12(W-1 R5-6)	SHELBY	18	9
CONTRACT NO. 74879				
ILLINOIS FED. AID PROJECT				

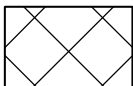

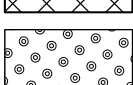
-  TURNING SPACE  
(LESS THAN 2% SLOPE ALL DIRECTIONS)
-  TRANSITION PANEL  
(MATCH INTO EXISTING SIDEWALK)
-  SIDE CURB  
(POUR MONOLITHICALLY WITH SIDEWALK)
-  DETECTABLE WARNING
- ME MATCH EXISTING

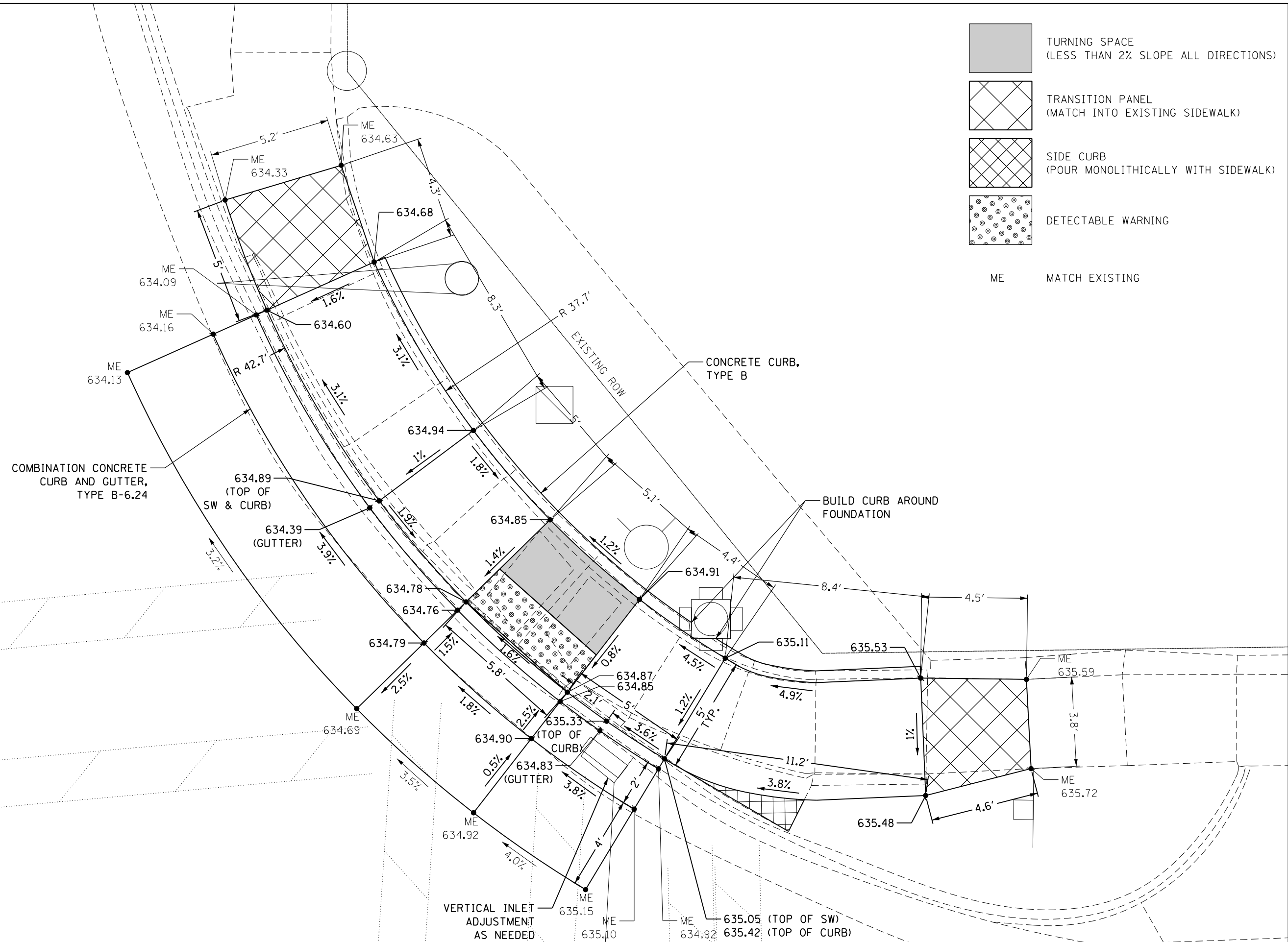

MODEL: Default  
 FILE NAME: P:\IL\B&E\BENTITEG\Illinois.gov\PWD\DOT\Documents\11DOT\_Offices\District 7\Projects\12879\CADD\DATA\CAD\Notes\12879-ph-ADA.dgn

USER NAME = hillelm	DESIGNED - LMH	REVISED -
DRAWN - LMH	REVISIONS -	
PLOT SCALE = 4.0000' / in.	CHECKED - NAS	REVISED -
PLOT DATE = 12/13/2018	DATE - 12/13/2018	REVISED -

**STATE OF ILLINOIS**  
**DEPARTMENT OF TRANSPORTATION**

NORTHEAST QUADRANT ADA RAMP IL 128 /IL 16 INTERSECTION			
SCALE: 4.0000' / in.	SHEET	OF SHEETS	STA. TO STA.

F.A.P. RTE.	SECTION	COUNTY	TOTAL SHEETS	SHEET NO.
770	12(W-1 R5-6)	SHELBY	18	10
CONTRACT NO. 74879				
ILLINOIS FED. AID PROJECT				

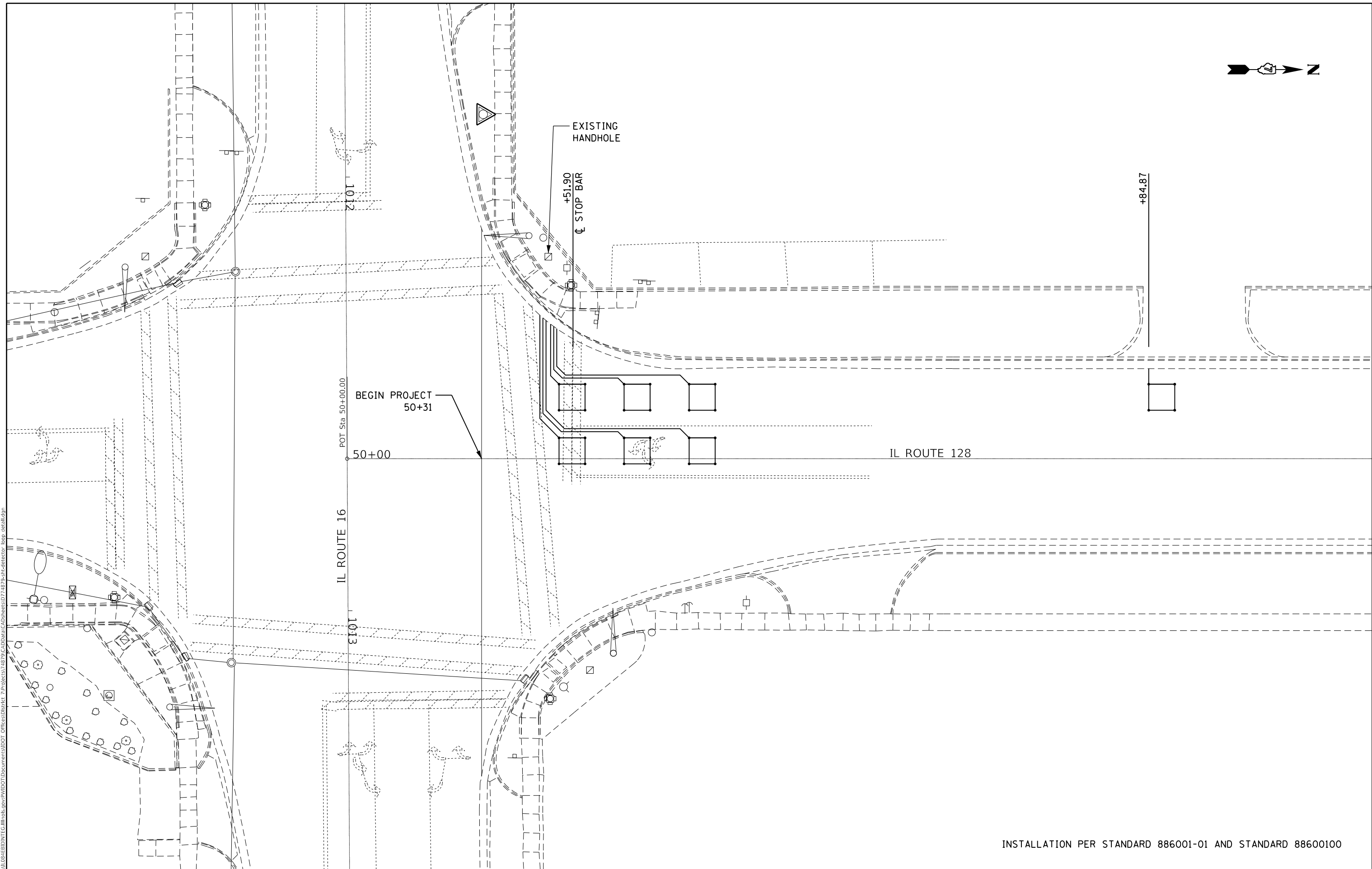

BEGIN PROJECT  
50+31

EXISTING  
HANDHOLE

+51.90  
CL STOP BAR

+84.87

50+00

IL ROUTE 128

IL ROUTE 16

INSTALLATION PER STANDARD 886001-01 AND STANDARD 88600100

MODEL: Default  
 FILE NAME: P:\IL\08\B&E\BID\NTEC\Illinois.gov\RWIDOT\Documents\BID\Office\BID\Detail 7\Project\174879\CADD\B&E\174879-16-detector\_loop\_detail.dgn

USER NAME = steffemk	DESIGNED - LMH	REVISED -
DRAWN - LMH	REVISED -	
PLOT SCALE = 20.0000' / in.	CHECKED - LM	REVISED -
PLOT DATE = 12/13/2018	DATE - 12/13/2018	REVISED -

**STATE OF ILLINOIS  
DEPARTMENT OF TRANSPORTATION**

**DETECTOR LOOP DETAIL  
INTERSECTION OF IL 128 /IL 16**

SCALE: 20.0000' / in. SHEET OF SHEETS STA. TO STA.

F.A.P. RTE.	SECTION	COUNTY	TOTAL SHEETS	SHEET NO.
770	12(W-1 R5-6)	SHELBY	18	11
CONTRACT NO. 74879			ILLINOIS FED. AID PROJECT	

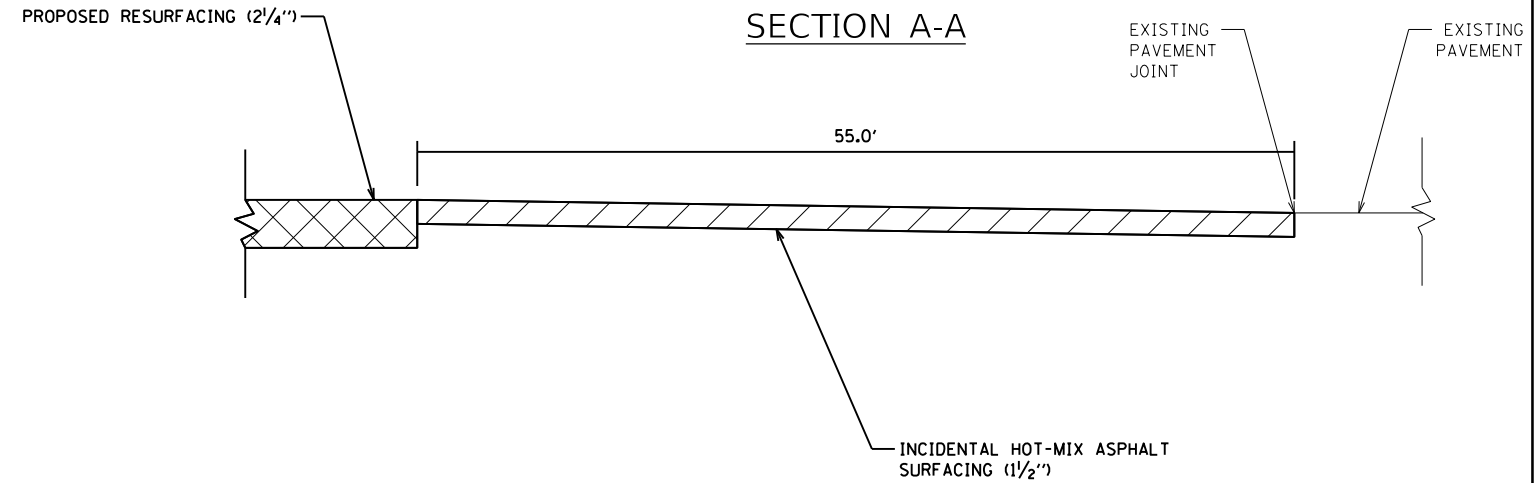
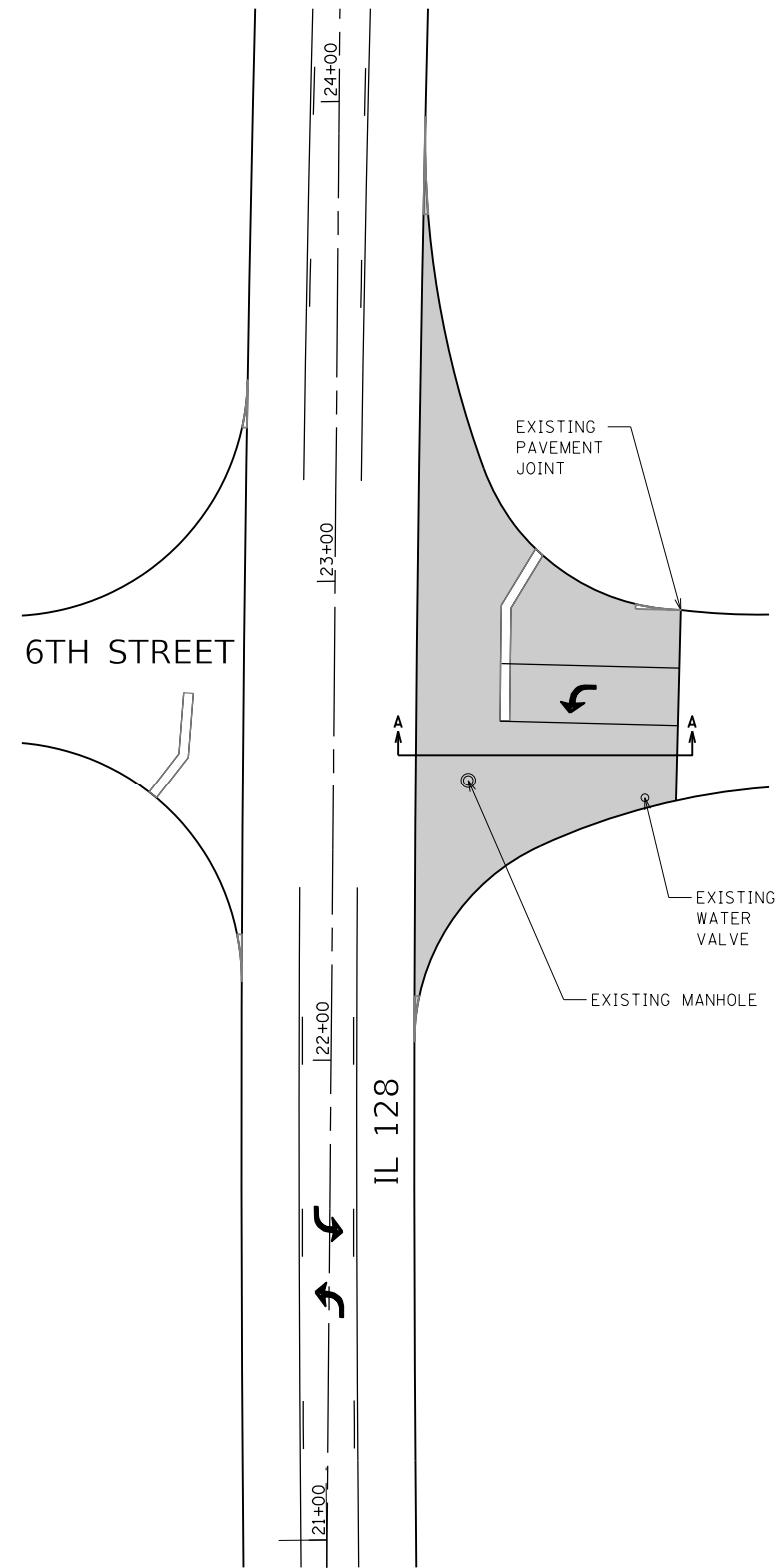

PROPOSED AREA FOR RESURFACING

SCHEDULE OF QUANTITIES			
PAY ITEM	DESCRIPTION	QUANTITY	UNIT
70600990	TEMPORARY RAMPS	20.0	SQ YD
40800050	INCIDENTAL HOT-MIX ASPHALT SURFACING	51.0	TON
44000155	HOT-MIX ASPHALT SURFACE REMOVAL, 1 1/2"	605.0	SQ YD
60300105	FRAMES AND GRATES TO BE ADJUSTED	2.0	EACH
78000100	THERMOPLASTIC PAVEMENT MARKING - LETTERS AND SYMBOLS	16.0	SQ FT
78000200	THERMOPLASTIC PAVEMENT MARKING - LINE 4"	70.0	FOOT
78000400	THERMOPLASTIC PAVEMENT MARKING - LINE 6"	37.0	FOOT
78000650	THERMOPLASTIC PAVEMENT MARKING - LINE 24"	36.0	FOOT
X7830060	GROOVING FOR RECESSED PAVEMENT MARKING, LETTERS AND SYMBOLS	48.0	SQ FT
X7830070	GROOVING FOR RECESSED PAVEMENT MARKING 5"	70.0	FOOT
X7830074	GROOVING FOR RECESSED PAVEMENT MARKING 7"	37.0	FOOT
X7830090	GROOVING FOR RECESSED PAVEMENT MARKING 25"	36.0	FOOT

MODEL: Default  
 FILE: \\nas01.cba.us.ibm.com\public\pww\dot\documents\dot\office\dlr\ct 7\project\74879\CADD\data\CAD\sheet\74879-pl-6th\_arcreet\_plans.dgn

USER NAME = steffemk	DESIGNED - LMH	REVISED -
PLOT SCALE = 40.0000 ' / in.	DRAWN - RCR	REVISED -
PLOT DATE = 12/13/2018	CHECKED - LMH	REVISED -
	DATE - 12/13/2018	REVISED -

**STATE OF ILLINOIS  
DEPARTMENT OF TRANSPORTATION**

<b>N 6TH STREET RADIUS RETURN RESURFACING</b>			
SCALE: NO SCALE	SHEET	OF SHEETS	STA. TO STA.

F.A.P. RTE.	SECTION	COUNTY	TOTAL SHEETS	SHEET NO.
770	12(W-1 RS-6)	SHELBY	18	12
CONTRACT NO. 74879				
ILLINOIS FED. AID PROJECT				

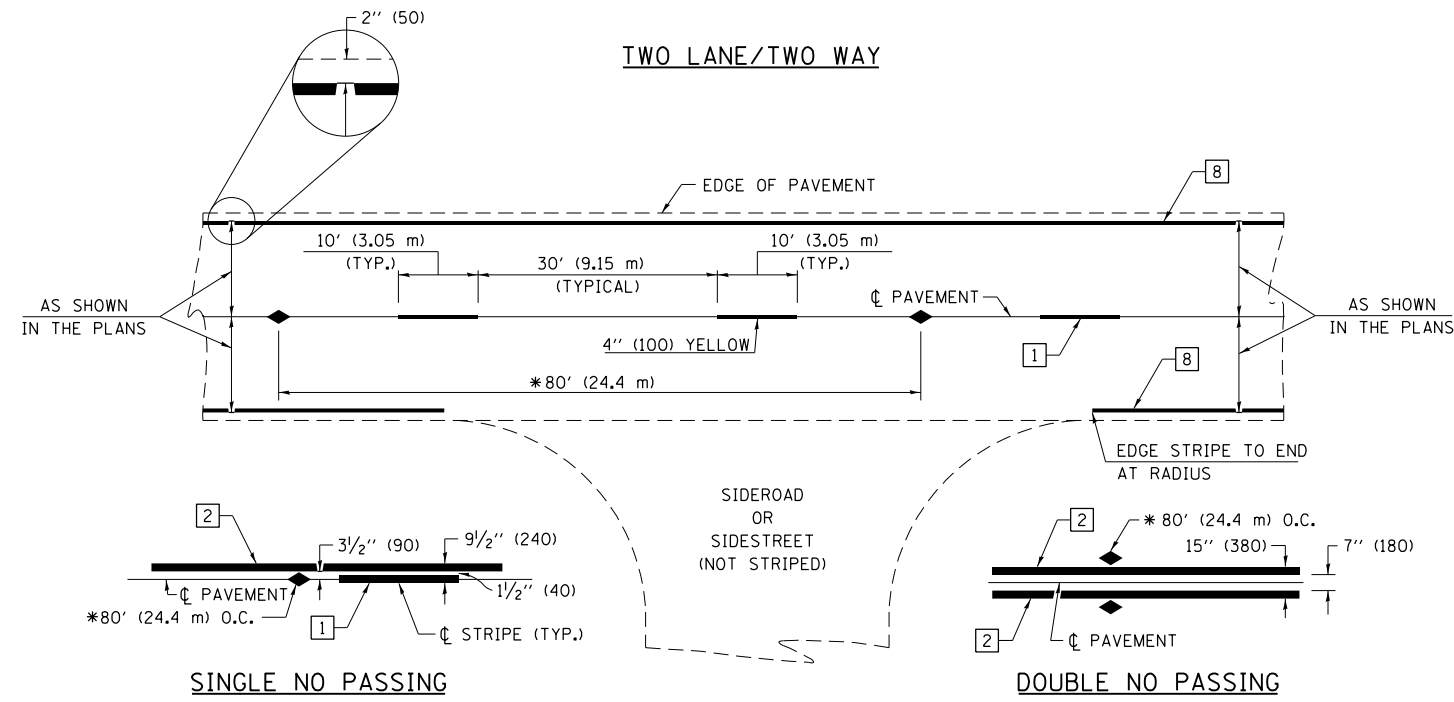

\* REDUCE TO 40' (12.2 m) O.C. ON CURVES WITH POSTED OR ADVISORY SPEEDS OF 45 mph (70 km/h) OR LESS.

PAVEMENT MARKING LEGEND

- 1 4" (100) SKIP-DASH (YELLOW)
- 2 4" (100) SOLID (YELLOW)
- 3 12" (300) DIAGONAL (YELLOW)
- 4 4" (100) DOUBLE YELLOW (NARROW)
- 5 12" (300) SOLID WHITE
- 6 RESERVED
- 7 6" (150) SKIP-DASH (WHITE)
- 8 4" (100) SOLID (WHITE)
- 9 12" (300) DIAGONAL (WHITE)
- 10 6" (150) SOLID (WHITE)
- 11 24" (600) STOP BAR (WHITE)
- 12 8" (200) SOLID (WHITE)
- 13 4" (100) PARKING WHITE

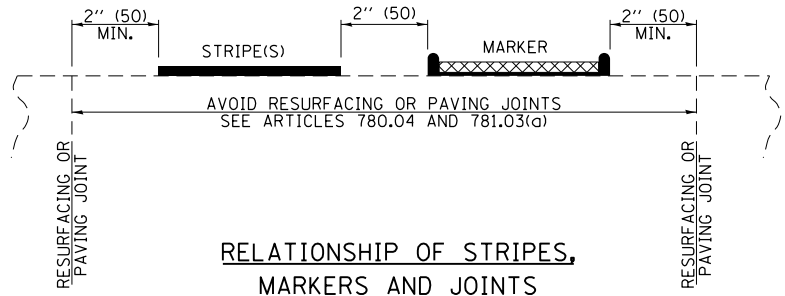

TYPICAL PAVEMENT MARKERS LEGEND

- ◆ TWO-WAY AMBER MARKER
- ▶ ONE-WAY AMBER MARKER
- ▷ ONE-WAY CRYSTAL MARKER

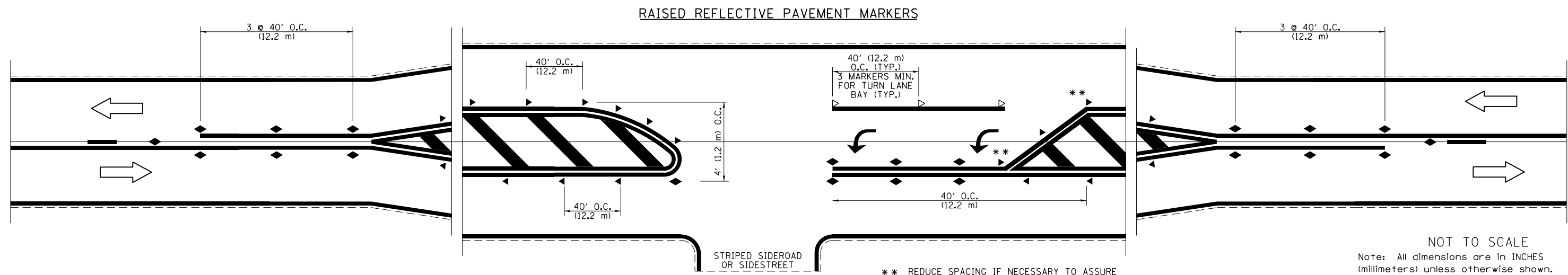

NOT TO SCALE  
Note: All dimensions are in INCHES (millimeters) unless otherwise shown.

FILE NAME =	USER NAME = steffenmk	DESIGNED -	REVISED -
pw:\IL\084EBIDINTEG\illinois.gov\PWIDOT\Documents\DOT Offices\District 7\Projects\74879\Drawings\CABsheets\0774879-sht-details.dwg		CHECKED -	REVISED -
	PLOT SCALE = 2.0000' / in.	DATE -	REVISED -
	PLOT DATE = 12/13/2018		

STATE OF ILLINOIS  
DEPARTMENT OF TRANSPORTATION

PAVEMENT MARKING AND RAISED REFLECTIVE PAVEMENT MARKERS  
(RURAL & URBAN APPLICATIONS)  
SCALE: NO SCALE SHEET NO. 1 OF 4 SHEETS STA. TO STA.

DISTRICT 7 DETAIL NO. 78000001				
F.A.P. RTE.	SECTION	COUNTY	TOTAL SHEETS	SHEET NO.
770	12(W-1 RS-6)	SHELBY	18	13
			CONTRACT NO. 74879	
ILLINOIS FED. AID PROJECT				

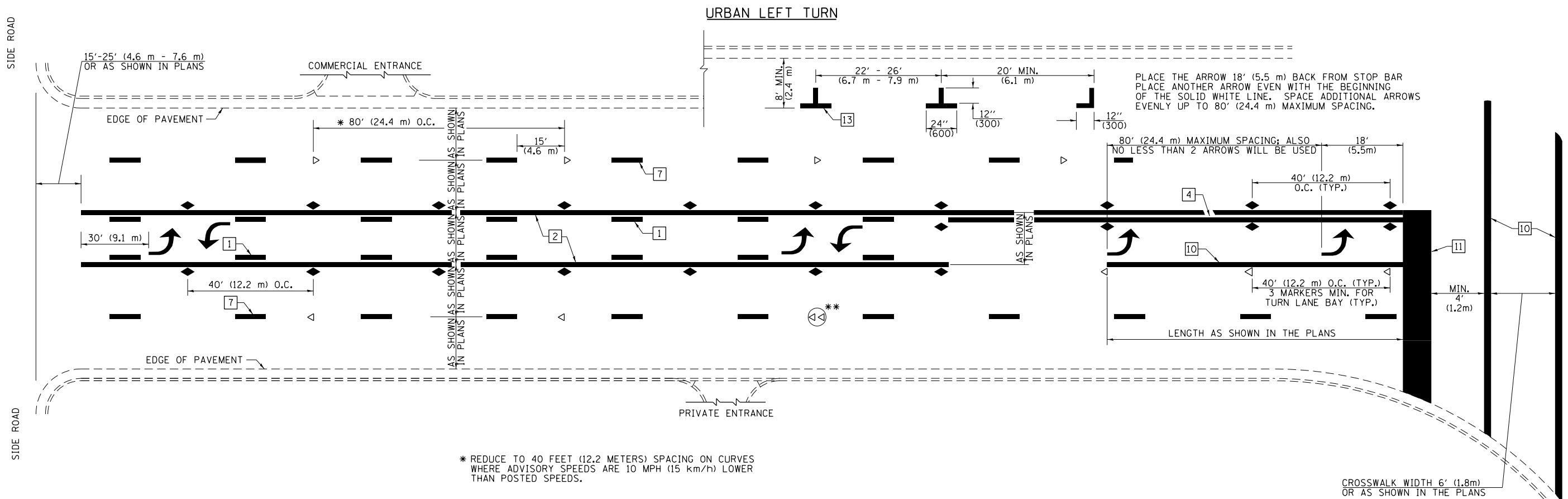

\* REDUCE TO 40 FEET (12.2 METERS) SPACING ON CURVES WHERE ADVISORY SPEEDS ARE 10 MPH (15 km/h) LOWER THAN POSTED SPEEDS.

\*\* DOUBLE LANE LINE MARKERS SHALL BE SPECIFIED AND SPACED AS SHOWN IN HIGHWAY STANDARD 781001 FOR MULTI-LANE DIVIDED AND UNDIVIDED HIGHWAYS.

**PAVEMENT MARKING LEGEND**

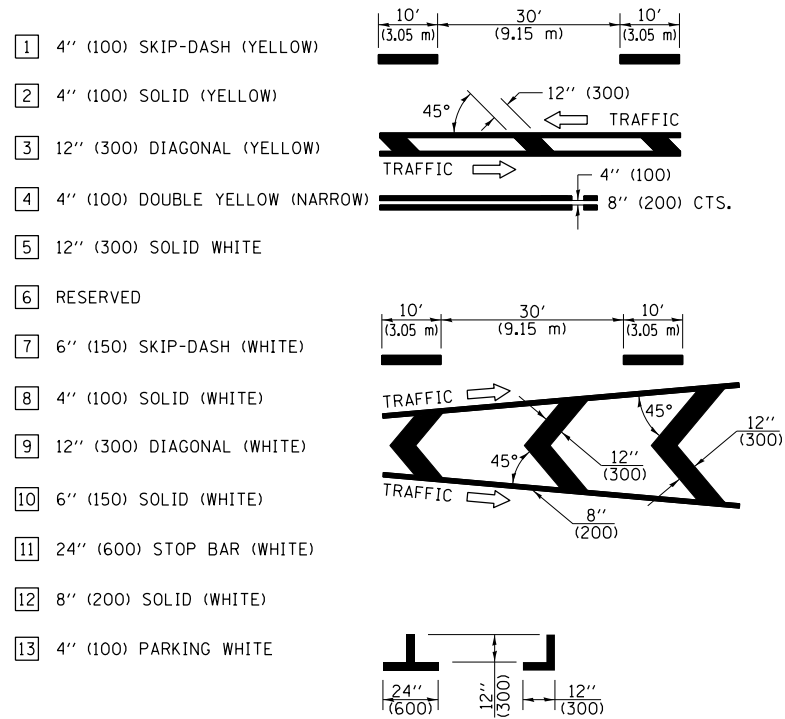

**GENERAL NOTES**

- TURN ARROW PAIRS SHALL BE PLACED AT 250' (75 m) INTERVALS AND SHALL BE EVENLY SPACED BETWEEN BOTH ENDS OF THE BIDIRECTIONAL LEFT TURN LANE. USE A MINIMUM OF TWO PAIRS PER BLOCK.
- THE SOLID YELLOW PAVEMENT MARKINGS [2] SHOULD GENERALLY START OR END NEAR THE RADIUS POINT OF EACH STREET RETURN EXCEPT WHERE ONE OR BOTH ENDS WOULD INCLUDE STOP BARS.
- THE SKIP-DASH PAVEMENT MARKINGS [1] OR [7] SHOULD BE CENTERED BETWEEN BOTH ENDS OF EACH CITY BLOCK AND SHALL BE PLACED SO THEY LINE UP ACROSS FROM EACH OTHER.
- USE LARGE ARROW SIZE FOR BOTH RURAL AND URBAN LOCATIONS. (SEE LAST PAGE OF SECTION 780x FOR SYMBOLS TABLE)
- LANE LINE EXTENSIONS SHALL BE THE SAME COLOR AND WIDTH AS THE LANE LINE BEING EXTENDED.

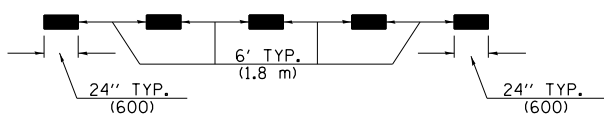

**LANE LINE EXTENSIONS**

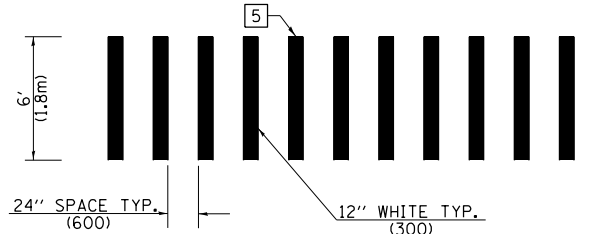

**CROSSWALK DETAIL (DECATUR CITY LIMITS ONLY)**

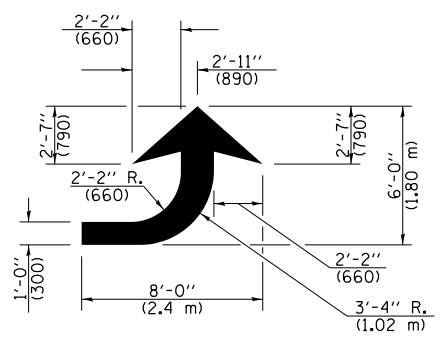

**LEFT ARROW**

REVERSE FOR RIGHT ARROW  
AREA = 15.6 SQ. FT. (1.47 m<sup>2</sup>)  
(WHITE)

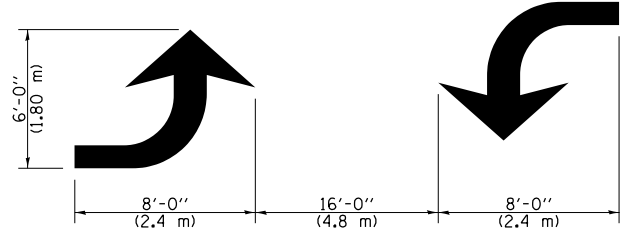

**TYPICAL DOUBLE TURN ARROWS (WHITE)**

NOT TO SCALE

Note: All dimensions are in INCHES (millimeters) unless otherwise shown.

**DISTRICT 7 DETAIL NO. 7800001**

FILE NAME =	USER NAME = steffenmk	DESIGNED -	REVISED -	<b>STATE OF ILLINOIS DEPARTMENT OF TRANSPORTATION</b>	<b>PAVEMENT MARKING AND RAISED REFLECTIVE PAVEMENT MARKERS (RURAL &amp; URBAN APPLICATIONS)</b>			F.A.P. RTE.	SECTION	COUNTY	TOTAL SHEETS	SHEET NO.
pw\11084EBIDINTEG.illinois.gov\PWIDOT\Documents\DOT Offices\District 7\Projects\74879\Drawings\CABsheets\0774879-sht-details.dgn	PLotted SCALE = 2.0000' / in.	CHECKED -	REVISED -					770	12(W-1 RS-6)	SHELBY	18	14
	PLOT DATE = 12/13/2018	DATE -	REVISED -					CONTRACT NO. 74879				
								ILLINOIS FED. AID PROJECT				

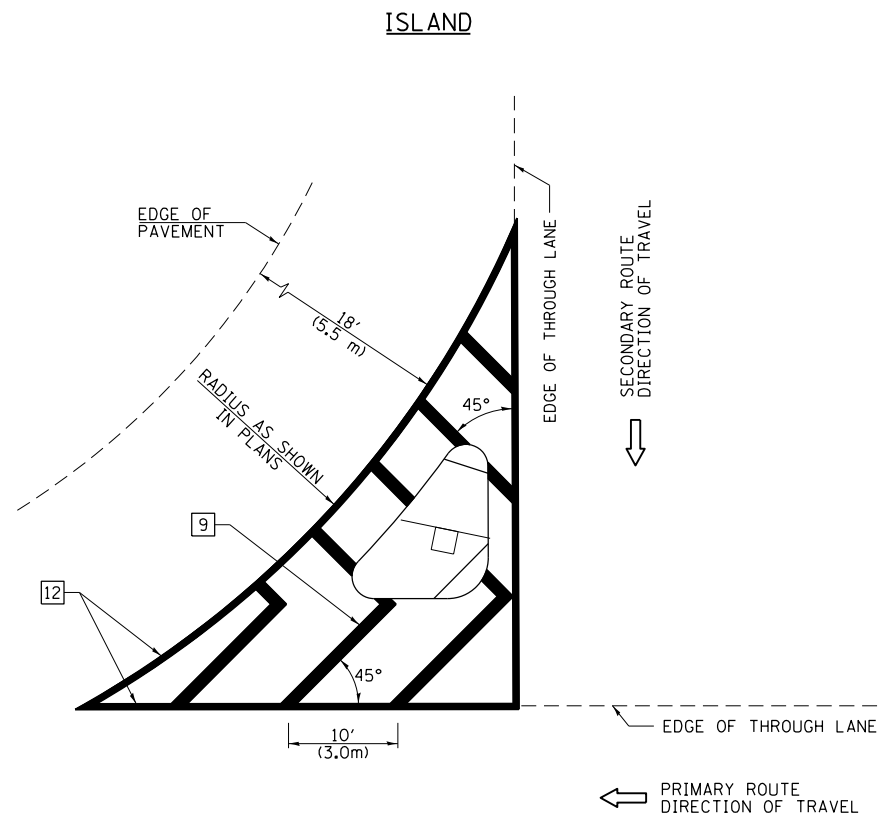

**GENERAL NOTES**

1. RAISED AND CORRUGATED MEDIANS SHALL BE OUTLINED WITH [2] IF PRESENT.
2. SOME OF THE INFORMATION INCLUDED WITH THIS DETAIL MAY NOT BE APPLICABLE TO THIS IMPROVEMENT.
3. PAVEMENT MARKINGS ARE TO BE EXTENDED THROUGH OMISSIONS WHEN APPLICABLE.
4. FINAL PAVEMENT MARKINGS SHALL BE IN PLACE PRIOR TO PLACING ANY RAISED REFLECTIVE PAVEMENT MARKERS.
5. THE FOLLOWING CRITERIA SHALL BE USED FOR SELECTING THE DIAGONAL PAVEMENT MARKING SPACING:
 

< 30 MPH (< 50 km/h)	15' (4.5 m)
30-45 MPH (50-75 km/h)	20' (6.0 m)
> 45 MPH (> 75 km/h)	30' (9.0 m)

**PAVEMENT MARKING LEGEND**

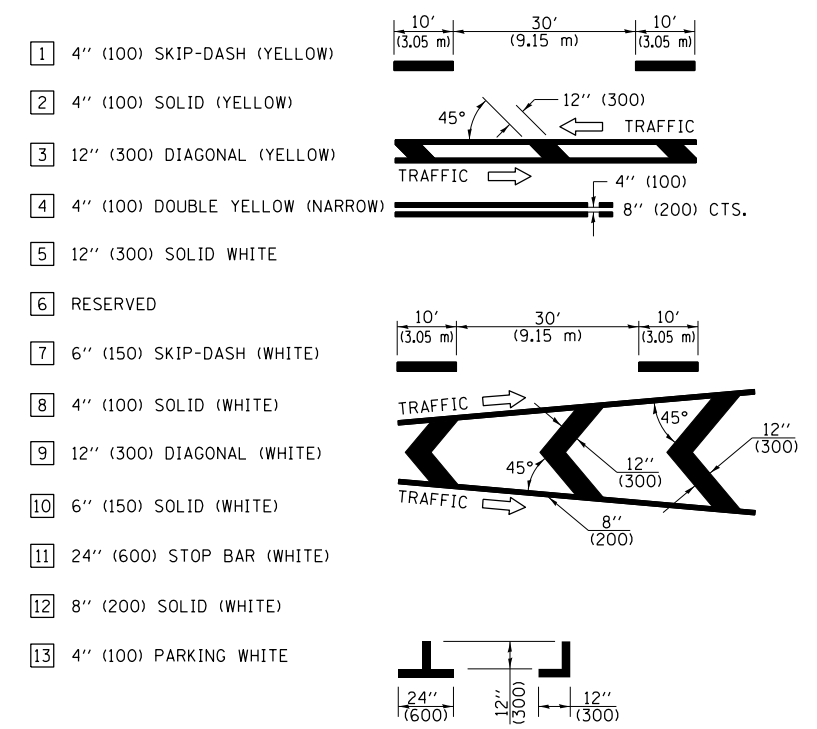

**RURAL LEFT TURN STRIPING**

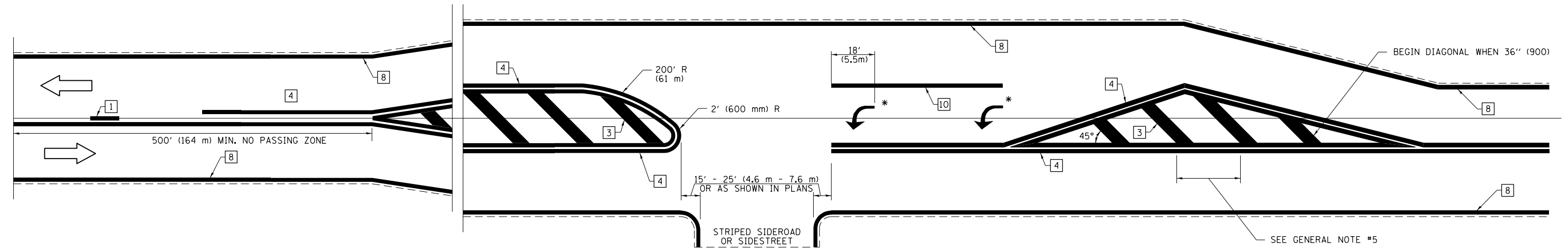

\* PLACE AN ARROW 18' (5.5 m) BACK FROM STOP BAR. PLACE ANOTHER ARROW EVEN WITH THE BEGINNING OF THE SOLID WHITE LINE. SPACE ADDITIONAL ARROWS EVENLY UP TO 80' (24.4 m) MAXIMUM SPACING. USE MINIMUM OF 2 ARROWS.

NOT TO SCALE  
 Note: All dimensions are in INCHES (millimeters) unless otherwise shown.

**DISTRICT 7 DETAIL NO. 7800001**

FILE NAME =	USER NAME = steffenmk	DESIGNED -	REVISED -
pw:\IL\084EBIDINTEG\illinois.gov\PWIDOT\Documents\IDOT Offices\District 7\Projects\74879\Drawings\CABsheets\0774879-sht-details.dwg		DRAWN -	REVISED -
	PLOT SCALE = 2.0000' / in.	CHECKED -	REVISED -
	PLOT DATE = 12/13/2018	DATE -	REVISED -

**STATE OF ILLINOIS  
 DEPARTMENT OF TRANSPORTATION**

**PAVEMENT MARKING AND RAISED REFLECTIVE PAVEMENT MARKERS  
 (RURAL & URBAN APPLICATIONS)**  
 SCALE: NO SCALE SHEET NO. 3 OF 4 SHEETS STA. TO STA.

F.A.P. RTE.	SECTION	COUNTY	TOTAL SHEETS	SHEET NO.
770	12(W-1 RS-6)	SHELBY	18	15
				CONTRACT NO. 74879
ILLINOIS FED. AID PROJECT				

PAVEMENT MARKINGS AT RAILROAD-HIGHWAY GRADE CROSSING

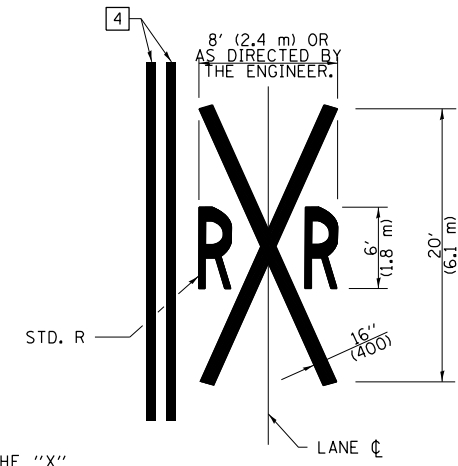
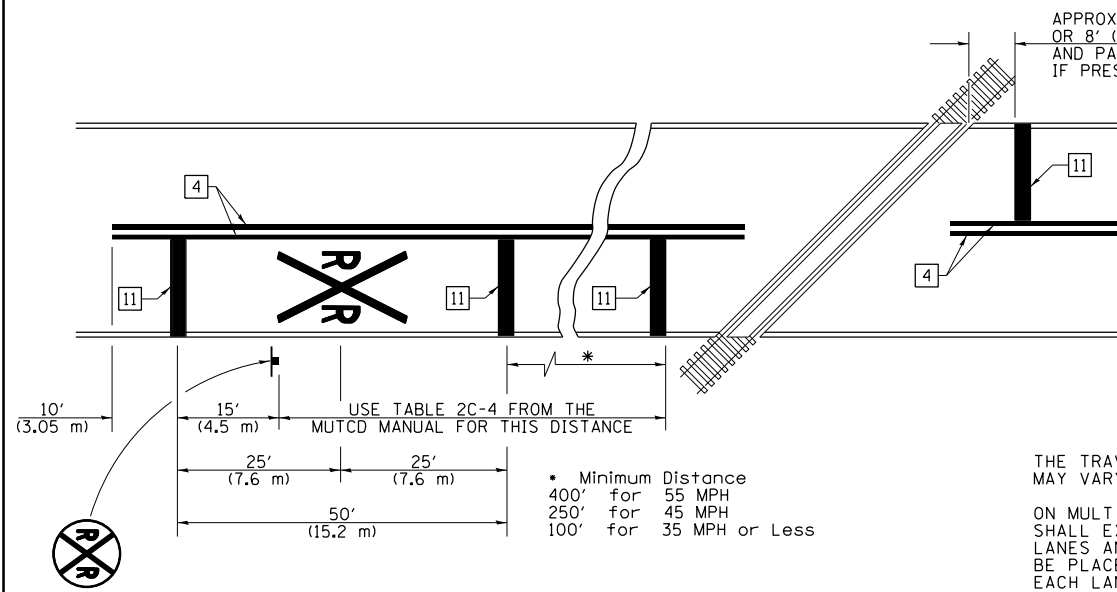

NOTES

THE TRAVERSE SPREAD OF THE "X" MAY VARY ACCORDING TO LANE WIDTH.

ON MULTI-LANE ROADS, THE STOP LINES SHALL EXTEND ACROSS ALL APPROACH LANES AND SEPARATE RXR SYMBOLS SHALL BE PLACED ADJACENT TO EACH OTHER IN EACH LANE.

WHEN THE PAVEMENT MARKING SYMBOL IS USED, A PORTION OF THE SYMBOL SHOULD BE LOCATED DIRECTLY ADJACENT TO THE ADVANCE WARNING SIGN (W10-1) AS PLACED BY TABLE II-1, CONDITION B OF THE MUTCD.

PAVEMENT MARKING LEGEND

- 1 4" (100) SKIP-DASH (YELLOW)
- 2 4" (100) SOLID (YELLOW)
- 3 12" (300) DIAGONAL (YELLOW)
- 4 4" (100) DOUBLE YELLOW (NARROW)
- 5 12" (300) SOLID WHITE
- 6 RESERVED
- 7 6" (150) SKIP-DASH (WHITE)
- 8 4" (100) SOLID (WHITE)
- 9 12" (300) DIAGONAL (WHITE)
- 10 6" (150) SOLID (WHITE)
- 11 24" (600) STOP BAR (WHITE)
- 12 8" (200) SOLID (WHITE)
- 13 4" (100) PARKING WHITE

RAILROAD CROSSING WITH INTERCONNECT ONLY

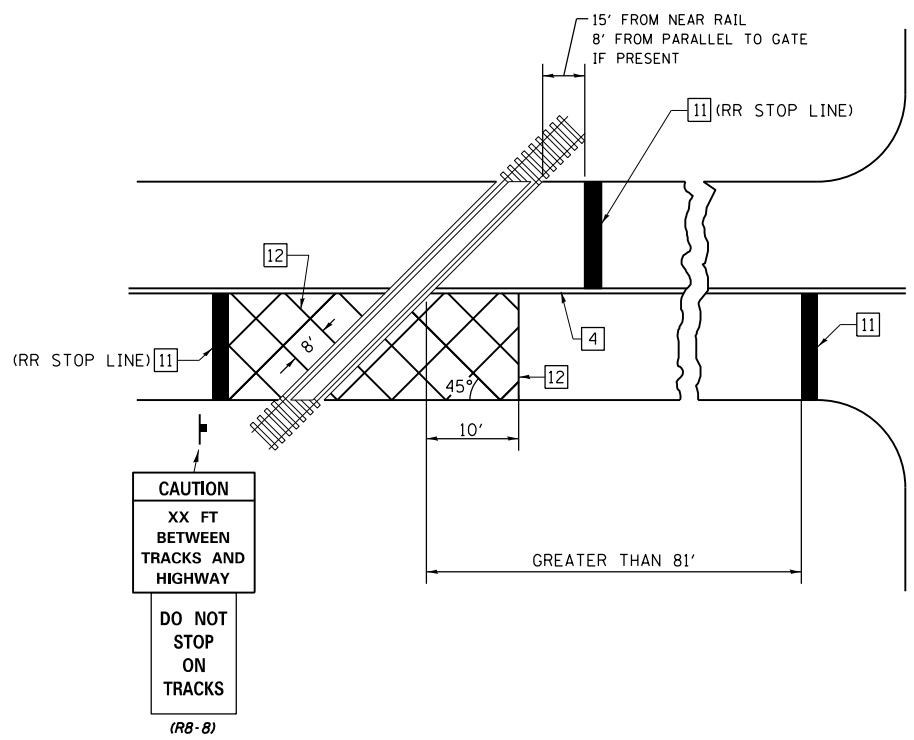

RAILROAD CROSSING WITH INTERCONNECT AND PRE-SIGNALS

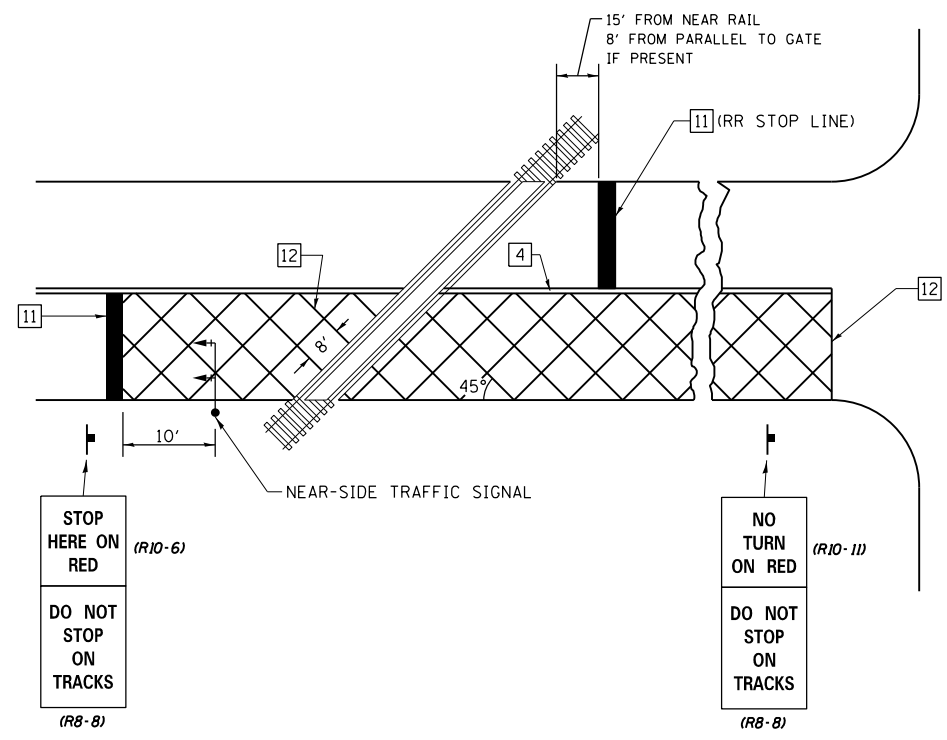

GENERAL NOTES

- SUPPLEMENTAL PAVEMENT MARKINGS TO BE INSTALLED ONLY ON APPROACHES TO INTERSECTIONS CONTROLLED BY TRAFFIC SIGNALS WHICH ARE INTERCONNECTED WITH THE RAILROAD WARNING SIGNALS.
- EXTEND PAVEMENT MARKINGS TO THE INTERSECTION ONLY WHERE NEAR-SIDE TRAFFIC SIGNALS ARE USED.

SUPPLEMENTAL PAVEMENT MARKING TREATMENT FOR RAILROAD-HIGHWAY GRADE CROSSING

NOT TO SCALE

Note: All dimensions are in INCHES (millimeters) unless otherwise shown.

DISTRICT 7 DETAIL NO. 7800001

FILE NAME =	USER NAME = steffenmk	DESIGNED -	REVISED -	<b>STATE OF ILLINOIS DEPARTMENT OF TRANSPORTATION</b>	<b>PAVEMENT MARKING AND RAISED REFLECTIVE PAVEMENT MARKERS (RURAL &amp; URBAN APPLICATIONS)</b>	F.A.P. R.T.E.	SECTION	COUNTY	TOTAL SHEETS	SHEET NO.	
pw:\11\084EBIDINTEG.illinois.gov\PIWIDOT\Documents\DOT Offices\District 7\Projects\74879\CAD\Drawings\74879-shd-details.dwg	PLT SCALE = 2.0000' / in.	CHECKED -	REVISED -			770	12(W-1 RS-6)	SHELBY	18	16	
	PLT DATE = 12/13/2018	DATE -	REVISED -			CONTRACT NO. 74879					
						ILLINOIS FED. AID PROJECT					



## TYPICAL APPLICATION OF DETECTOR LOOPS

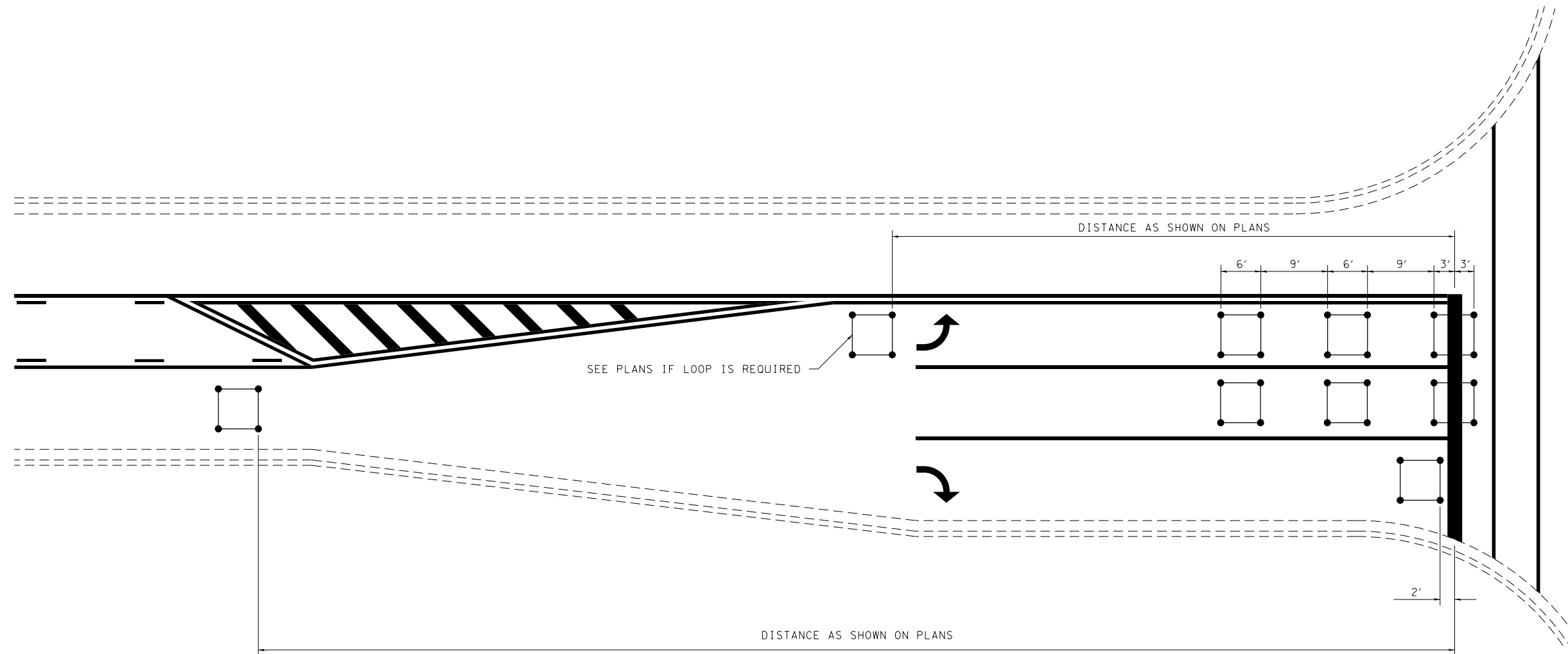

**NOTE:**

1. EACH LOOP SHALL HAVE ITS OWN HOMERUN TO THE GULFBOX/HANDHOLE.
2. LOOPS SHOULD BE CENTERED IN EACH LANE.
3. USE 6' BY 6' LOOPS FOR LANE WIDTHS OF 11' OR GREATER.
4. USE 5' BY 5' LOOPS IF LANE WIDTH IS LESS THAN 11'.

NOT TO SCALE

**DISTRICT 7 DETAIL NO. 88600100**

FILE NAME =	USER NAME = steffenmk	DESIGNED -	REVISED - MKS 4-08
pw\11\084EBIDINTEG.illinois.gov\PIWIDOT\Documents\DOT Offices\District 7\Projects\74879\CAD\CAD sheets\0774879-sht-details.dwg		DRAWN -	REVISED -
	PLOT SCALE = 2.0000' / in.	CHECKED -	REVISED -
	PLOT DATE = 12/13/2018	DATE -	REVISED -

**STATE OF ILLINOIS  
DEPARTMENT OF TRANSPORTATION**

**TYPICAL APPLICATIONS OF DETECTOR LOOPS**

SCALE: NO SCALE    SHEET NO.    OF    SHEETS    STA.    TO STA.

F.A.P. RTE.	SECTION	COUNTY	TOTAL SHEETS	SHEET NO.
770	12 (W-1 RS-6)	SHELBY	18	17
CONTRACT NO. 74879				
FED. ROAD DIST. NO.    ILLINOIS FED. AID PROJECT				

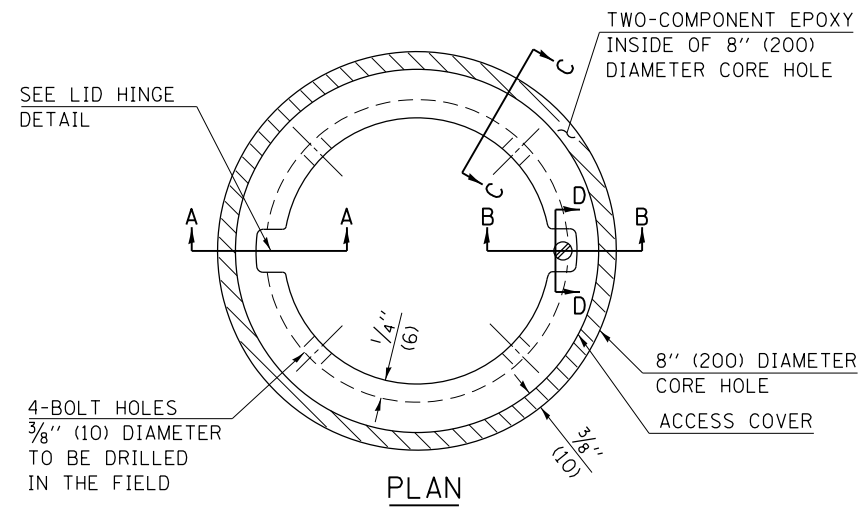

- LEGEND**
- ALUMINUM CASTING
  - 5" (125) OR 6" (150) P.V.C. PIPE
  - TWO-COMPONENT EPOXY
- T = THICKNESS OF PAVEMENT STRUCTURE
- H = THE THICKNESS OF THE SUB-BASE GRANULAR + 1" (25)

BILL OF MATERIAL	
ALUMINUM CASTING OF THE DIMENSIONS AND SPECIFICATIONS SHOWN OR OTHER SUBJECT TO ENGINEER'S APPROVAL OF SHOP DRAWINGS,	
4 EACH - 5/16" X 2" (M8 X 50) BOLTS WITH NUTS, EPOXY,	
5" OR 6" (125 mm OR 150 mm) DIAMETER P.V.C. PIPE, SCHEDULE 40 (WHEN REQUIRED).	

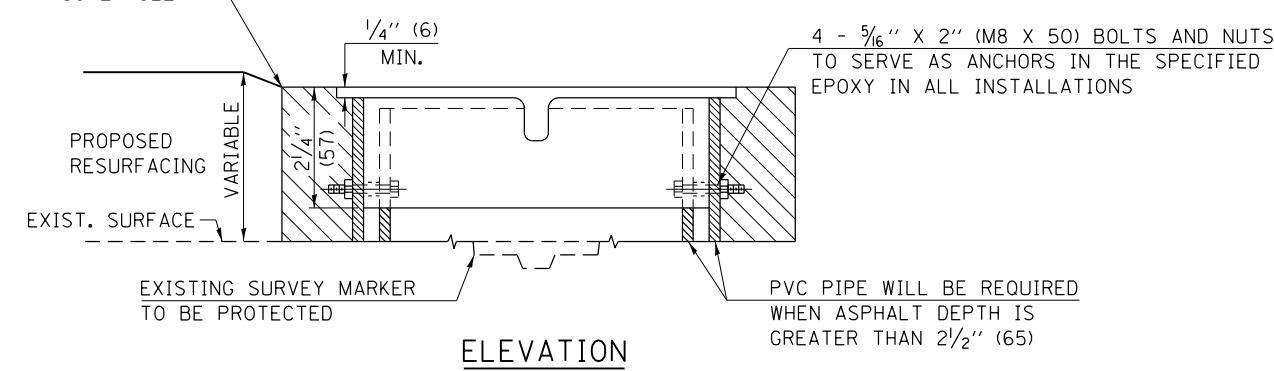
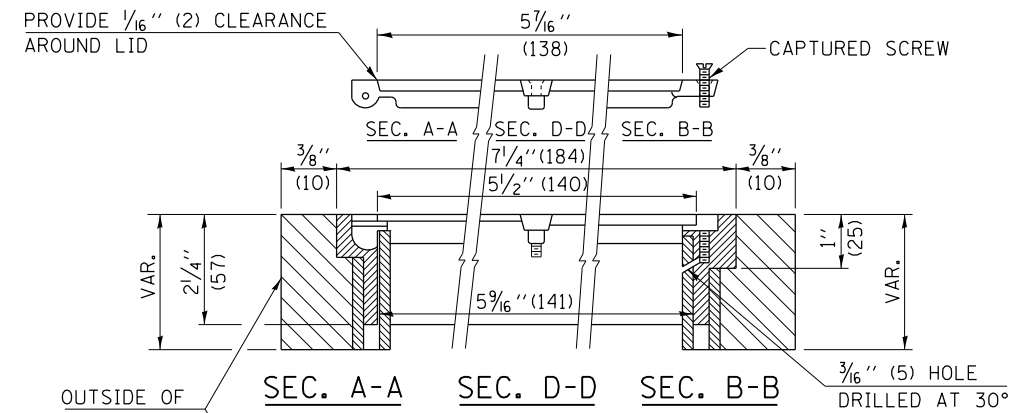
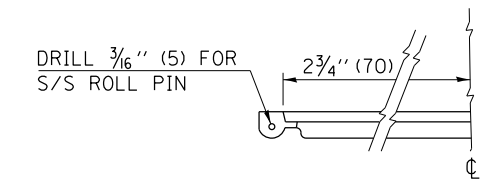
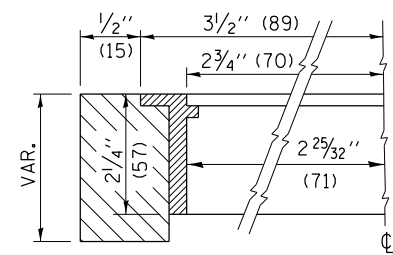

EXISTING SURVEY MARKER

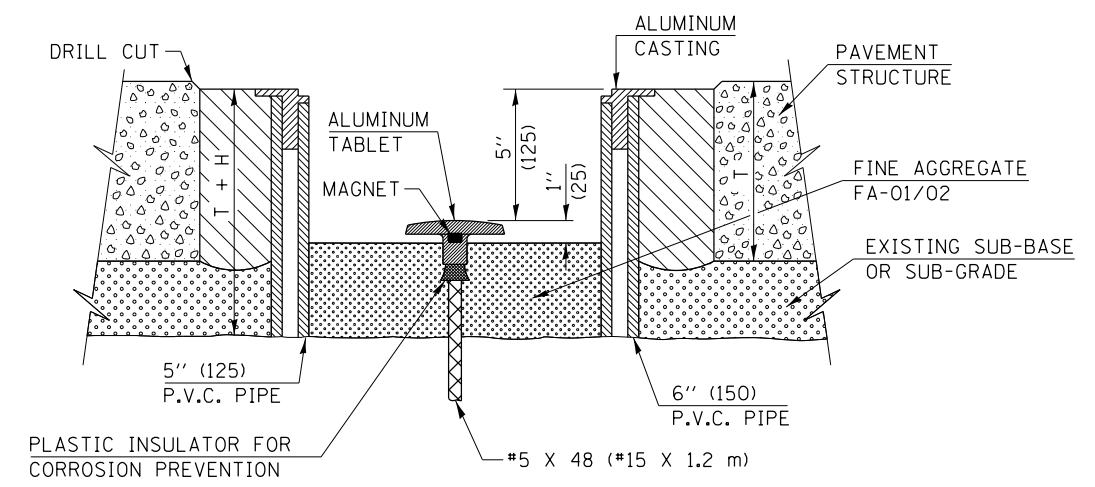

PROPOSED SURVEY MARKER

NOT TO SCALE

Note: All dimensions are in INCHES (millimeters) unless otherwise shown.

**DISTRICT 7 DETAIL NO. Z0070202**

FILE NAME =	USER NAME = steffennk	DESIGNED -	REVISED - MAD 6-11
pw:\11084EBID\INTEG.illinois.gov\PI\DOT\Documents\DOT Offices\District 7\Projects\74879\CAD\Drawings\74879-shd-details.dwg		CHECKED -	REVISED -
		DATE -	REVISED -

**STATE OF ILLINOIS**  
**DEPARTMENT OF TRANSPORTATION**

**SURVEY MARKER VAULT**

SCALE: NO SCALE	SHEET NO.	OF SHEETS	STA.	TO STA.
-----------------	-----------	-----------	------	---------

F.A.P. RTE.	SECTION	COUNTY	TOTAL SHEETS	SHEET NO.
770	12 (W-1 RS-6)	SHELBY	18	18
CONTRACT NO. 74879				
FED. ROAD DIST. NO. ILLINOIS FED. AID PROJECT				