

TOTAL BILL OF MATERIAL

ITEM	UNIT	SUPER	SUB	TOTAL
Stone Riprap, Class A3	Sq. Yd.	858		858
Filter Fabric	Sq. Yd.	858		858
Bituminous Materials (Tack Coat)	Pound	156		156
Hot Mix Asphalt Surface Course, Mix "D", N90	Ton	108		108
Removal Of Existing Superstructures	Each	1		1
Concrete Removal	Cu. Yd.		28.3	28.3
Protective Shield	Sq. Yd.	392		392
Structure Excavation	Cu. Yd.		311	311
Concrete Structures	Cu. Yd.		34.0	34.0
Concrete Superstructure	Cu. Yd.	352.3		352.3
Protective Coat	Sq. Yd.	377		377
Concrete Superstructure (Approach Slab)	Cu. Yd.	149.4		149.4
Furnishing And Erecting Structural Steel	L. Sum	1		1
Stud Shear Connectors	Each	6,948		6,948
Reinforcement Bars, Epoxy Coated	Each	131,260	5,980	137,230
Bar Splicers	Each	634	80	714
Bicycle Railing	Foot	343		343
Parapet Railing	Foot	343		343
Name Plate	Each	1		1
Elastomeric Bearing Assembly, Type I	Each	36		36
Anchor Bolts, 1"	Each	96		96
Temporary Soil Retention System	Sq. Ft.		112	112
Waterproofing Membrane System	Sq. Yd.	823		823
Granular Backfill For Structures	Cu. Yd.		308	308
Epoxy Crack Injection	Foot		8	8
Geocomposite Wall Drain	Sq. Yd.		115	115
Controlled Low-Strength Material	Cu. Yd.		1.7	1.7
Structural Repair Of Concrete (Depth Equal To Or Less Than 5 Inches)	Sq. Ft.		3	3
Longitudinal Joint Sealant	Foot	810		810
Pipe Underdrains For Structures, 4"	Foot		247	247
Polymer Modified Portland Cement Mortar	Sq. Ft.		8	8

GENERAL NOTES

Fasteners shall be ASTM A325 Type 1, mechanically galvanized bolts. Bolts 7/8 in. Ø, holes 1 1/16 in. Ø, unless otherwise noted.

Calculated weight of Structural Steel =
 AASHTO M270 Grade 50 = 159,190 pounds
 AASHTO M270 Grade 36 = 27,280 pounds

No field welding is permitted except as specified in the contract documents.

Reinforcement bars designated (E) shall be epoxy coated.

Plan dimensions and details relative to existing plans are subject to nominal construction variations. The Contractor shall field verify existing dimensions and details affecting new construction and make necessary approved adjustments prior to construction or ordering of materials. Such variations shall not be cause for additional compensation for a change in scope of the work, however, the Contractor will be paid for the quantity actually furnished at the unit price bid for the work.

Protective coat shall not be applied to surfaces to which Waterproofing Membrane System is applied.

The existing structural steel coating contains lead. The Contractor shall take appropriate precautions to deal with the presence of lead on this project.

All structural steel shall be galvanized in accordance with the special provisions.

The contractor shall submit a demolition plan to the Engineer for approval, including the proposed methods of demolition and the location(s) and type(s) of equipment to be used, for the removal of the existing superstructure. The demolition plan shall include an assesment of the structure condition and an evaluation of the capacity and stability of the structure during demolition and shall be sealed by an Illinois Licensed Structural Engineer.

The existing bridge plans are available from Madison County Highway Department.

The Contractor is advised that the existing structure contains members that are in a deteriorated condition with reduced load carrying capacity. It is the Contractor's responsibility to account for the condition of the existing structure when developing construction procedures for the complete or partial removal, or replacement of the structure.

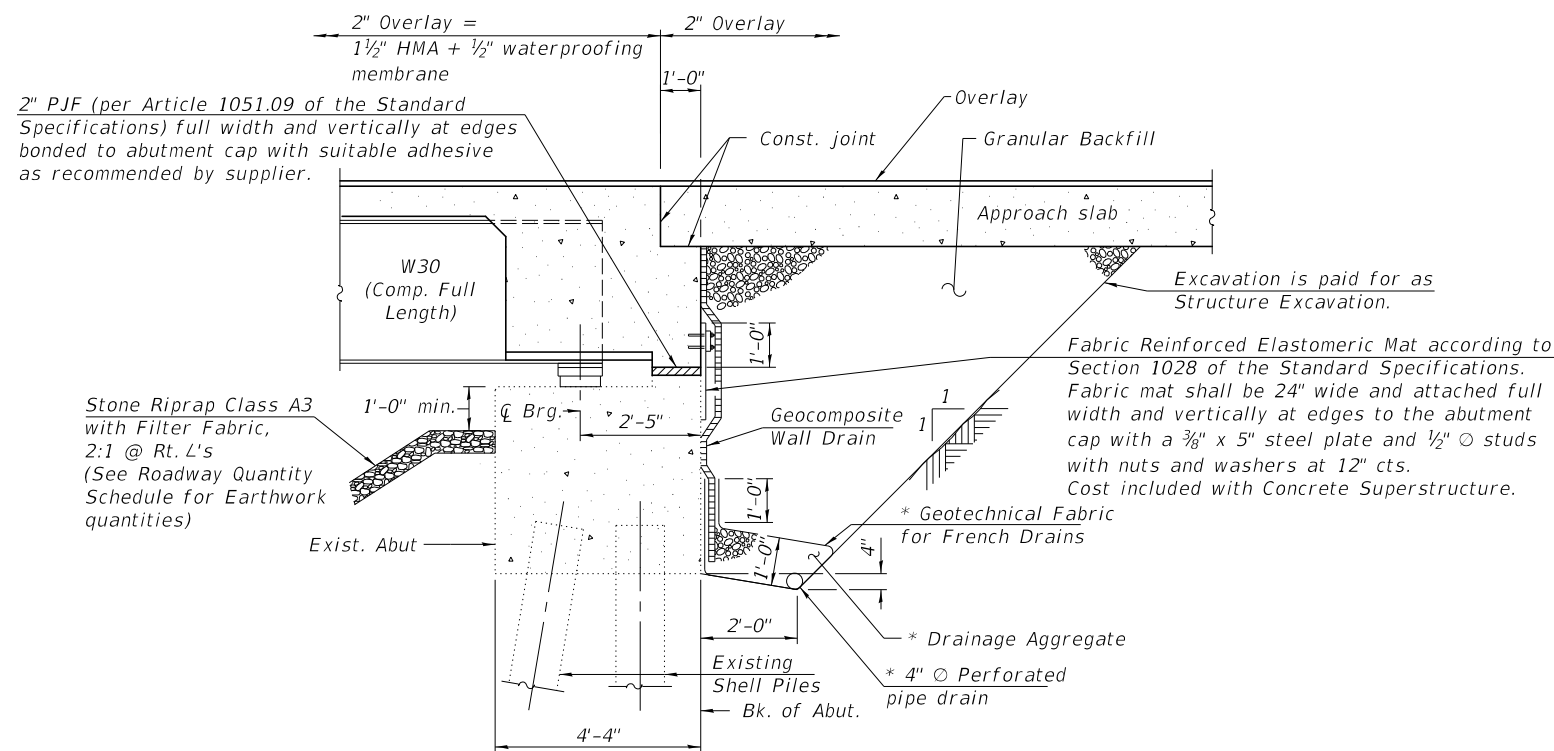

SECTION THRU SEMI-INTEGRAL ABUTMENT
(Horiz. dim. @ Rt. angles)

*Included in the cost of Pipe Underdrains for Structures.
(See Special Provisions).

Notes:

All drainage system components shall extend to 2'-0" from the end of each wingwall except an outlet pipe shall extend until intersecting with the side slopes. The pipes shall drain into concrete headwalls. (See Article 601.05 of the Standard Specifications and Highway Standard 601101).

For modifications to the existing abutment see sheet 14 of 20 for details.

STATION 306+18.75
 RE-BUILT 20__ BY
 MADISON COUNTY HIGHWAY DEPT.
 F.A.U. RTE. 8877 - SEC 15-00113-03-BR
 LOADING HL-93
 STR. NO. 060-0183

NAME PLATE

See Std. 515001

Existing Name Plate shall be cleaned and relocated next to the new Name Plate. Cost included with Name Plates.

FILE NAME = L:\Madison_Co\16401-32-00\Drawings\CADD_Sheets\Bridges\0600183-002-GENERAL_DATA.dgn



USER NAME = Josh Jolliff	DESIGNED - JDJ/DWL	REVISED - 2/13/2019 JDJ
	CHECKED - PA	REVISED -
PLOT SCALE = 0.1667' / in.	DRAWN - DWL	REVISED -
PLOT DATE = 2/13/2019 (10:50:52 AM)	CHECKED - PA	REVISED -

**STATE OF ILLINOIS
 DEPARTMENT OF TRANSPORTATION**

**GENERAL DATA
 STRUCTURE NO. 060-0183**

SHEET NO. 2 OF 20 SHEETS

F.A. RTE.	SECTION	COUNTY	TOTAL SHEETS	SHEET NO.
8877	15-00113-03-BR	MADISON	58	30
CONTRACT NO. 97683				

ILLINOIS FED. AID PROJECT