

STATE OF ILLINOIS
DEPARTMENT OF TRANSPORTATION

F.A.P. RTE.	SECTION	COUNTY	TOTAL SHEETS	SHEET NO.
	CHAMPAIGN IMP 2024-1	CHAMPAIGN	14	1
		ILLINOIS	CONTRACT NO. 70F51	

FOR INDEX OF SHEETS, SEE SHEET NO. 2

PROPOSED
HIGHWAY PLANS

SECTION CHAMPAIGN IMP 2024-1
PATCHING PARKING IMPROVEMENT
CHAMPAIGN COUNTY

C-95-061-21

CHAMPAIGN COMPLEX

R8E

PROJECT LOCATION
DISTRICT 5 CHAMPAIGN
STORAGE FACILITY
201 EISNER DRIVE
CHAMPAIGN, IL 61822

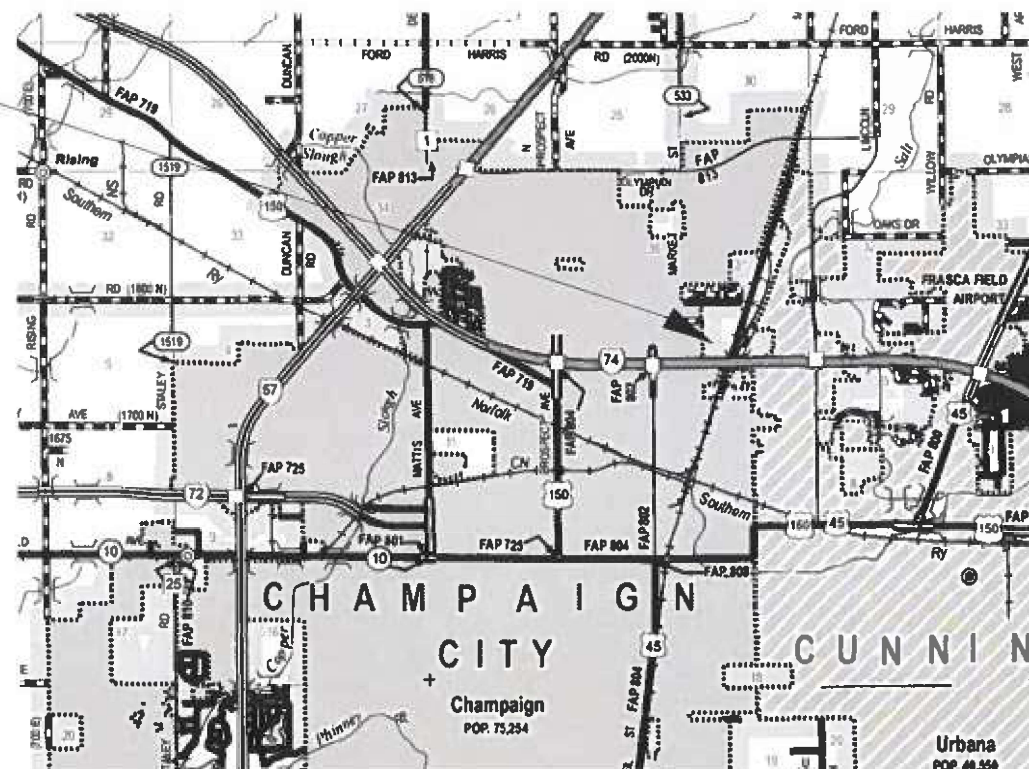

T19N

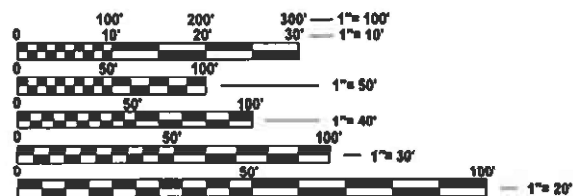

FULL SIZE PLANS HAVE BEEN PREPARED USING STANDARD ENGINEERING SCALES. REDUCED SIZED PLANS WILL NOT CONFORM TO STANDARD SCALES. IN MAKING MEASUREMENTS ON REDUCED PLANS, THE ABOVE SCALES MAY BE USED.

J.U.L.I.E.
JOINT UTILITY LOCATION INFORMATION FOR EXCAVATION
1-800-892-0123
OR 811
CHAMPAIGN CITY TOWNSHIP

PROJECT ENGINEER: RYAN CARROLL
SQUAD LEADER: CLARE DIETZ
DESIGNER: KARY DAWSON
PHONE: (217) 465-4181
CONTRACT NO. 70F51

GROSS LENGTH = N/A FT. = N/A MILE
NET LENGTH = N/A FT. = N/A MILE

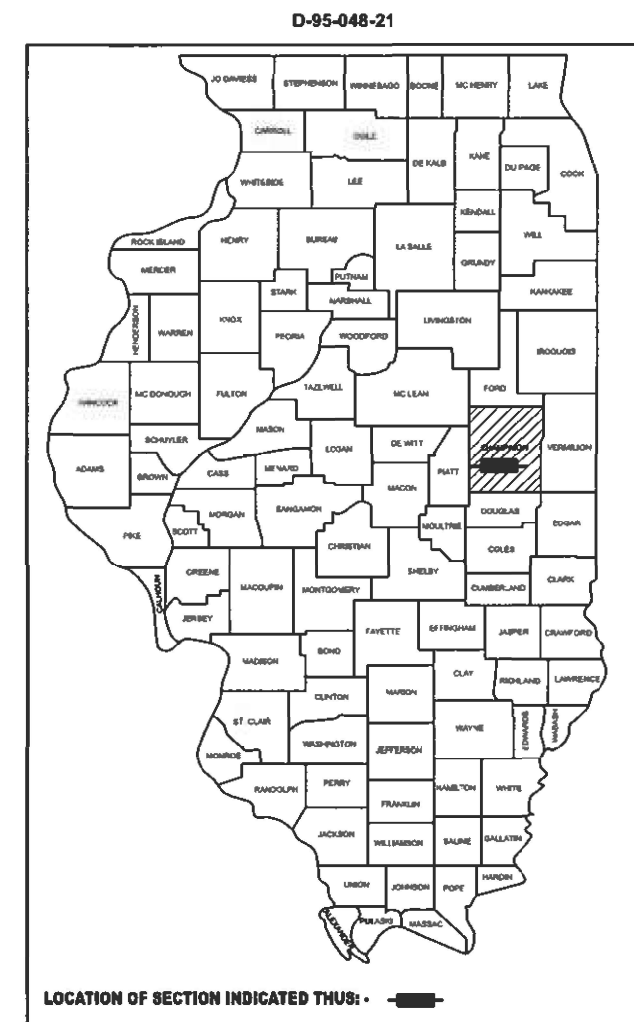
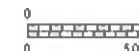

STATE OF ILLINOIS
DEPARTMENT OF TRANSPORTATION

SUBMITTED *December 7 20 23*
Tanya A. James
REGIONAL ENGINEER

February 2, 2024
Steve A. Etk
ENGINEER OF DESIGN AND ENVIRONMENT

February 2, 2024
Stephen M. Smith
DIRECTOR OF HIGHWAYS PROJECT IMPLEMENTATION

PRINTED BY THE AUTHORITY
OF THE STATE OF ILLINOIS

INDEX OF SHEETS

SHEET NO.	DESCRIPTION
1	COVER SHEET
2	INDEX OF SHEETS & LIST OF HIGHWAY STANDARDS
3	GENERAL NOTES
4-5	SUMMARY OF QUANTITIES
6-7	TYPICAL SECTIONS & MISCELLANEOUS DETAILS
8-9	SCHEDULE OF QUANTITIES
10	CONTROL POINTS & BENCHMARKS
11	REMOVAL PLAN
12	SITE PLAN
13	PUSHWALL DETAIL
14	DISTRICT 5 DETAIL- DISABLED PARKING

HIGHWAY STANDARDS

STANDARD NO.	DESCRIPTION
000001-08	STANDARD SYMBOLS, ABBREVIATIONS AND PATTERNS
001001-02	AREAS OF REINFORCEMENT BARS
001006	DECIMAL OF AN INCH AND OF A FOOT
701501-06	URBAN LANE CLOSURE, 2L, 2W, UNDIVIDED
701901-09	TRAFFIC CONTROL DEVICES
780001-05	TYPICAL PAVEMENT MARKINGS

MODEL: \\MODEL\M1E2
 FILE NAME: \\p1001\p1001\Documents\DOT Office\District 5\ORD Project\DOT\Drawings\CADD\Drawings\DOT\REF-SH-Details.dgn

USER NAME = Kary.Dawson	DESIGNED -	REVISED -	STATE OF ILLINOIS DEPARTMENT OF TRANSPORTATION	INDEX OF SHEETS & HIGHWAY STANDARDS	F.A. RTE.	SECTION	COUNTY	TOTAL SHEETS	SHEET NO.
DRAWN -	REVISED -	CHAMPAIGN IMP 2024-1			CHAMPAIGN	14	2		
PLOT SCALE = 0.16666633' / in.	CHECKED -	REVISED -			CONTRACT NO. 70F51				
PLOT DATE = 12/7/2023	DATE -	REVISED -			SCALE:	SHEET OF SHEETS	STA. TO STA.	ILLINOIS FED. AID PROJECT	

GENERAL NOTES

G.N.-100A
ELECTRONIC FILES AND/OR ELECTRONIC SURVEY INFORMATION INCLUDING CADD FILES WILL NOT BE AVAILABLE TO THE CONTRACTOR

G.N.-105.09A
ALL ELEVATIONS SHOWN IN THE PLANS ARE BASED ON NORTH AMERICAN VERTICAL DATUM OF 1988. (NAVD 88)

G.N.-406H
MIXTURE REQUIREMENTS

THE FOLLOWING MIXTURE REQUIREMENTS ARE APPLICABLE FOR THIS PROJECT:

LOCATION(S):	CHAMPAIGN STORAGE	CHAMPAIGN STORAGE
MIXTURE USE(S):	SURFACE	BINDER
AC/PG:	SBS PG 70-22	SBS PG 70-22
DESIGN AIR VOIDS	4.0% @ Ndes=50	4.0% @ Ndes=50
MIXTURE COMP (GRADATION)	IL 9.5	IL 9.5 FG
FRICION AGGREGATE	Mix C	N.A.
MIXTURE WEIGHT	112	112
QUALITY MANAGE- MENT PROGRAM	QC/QA	QC/QA
SUBLOT SIZE	3000	3000
MATERIAL TRANSFER DEVICE (REQUIRED?)	NO	NO

- NOTE:**
- INDIVIDUAL LIFT THICKNESS OF EACH MIX TYPE WILL BE NO LESS THAN 3 TIMES NOMINAL MAXIMUM AGGREGATE SIZE AND NO MORE THAN 6 TIMES NOMINAL MAXIMUM AGGREGATE SIZE, UNLESS OTHERWISE APPROVED BY THE ENGINEER.
 - FOR DESIGN PURPOSES MIXTURE WEIGHT FOR ALL MIXES IS DETERMINED TO BE 112.0 LBS/S.Y./IN., UNLESS OTHERWISE NOTED.

G.N.-503 SPL
SYNTHETIC FIBERS SHALL BE TYPE III ACCORDING TO ASTM C 1116. THE SYNTHETIC FIBER SHALL BE A MONOFILAMENT OR BUNDLED MONOFILAMENT WITH A MINIMUM LENGTH OF 1.0 INCH (25MM) AND A MAXIMUM LENGTH OF 2.5 INCH (63MM), AND SHALL HAVE A MAXIMUM ASPECT RATION (LENGTH DIVIDED BY THE EQUIVALENT DIAMETER OF THE FIBER) OF 150. THE MINIMUM QUANTITY OF SYNTHETIC FIBER(S) ADDED TO THE CONCRETE MIXTURE SHALL BE ACCORDING TO THE DEPARTMENT'S QUALIFIED PRODUCT LIST OF SYNTHETIC FIBERS. THE SYNTHETIC FIBERS SHALL BE ADDED TO THE CONCRETE AND MIXED PER THE MANUFACTURER'S RECOMMENDATION. THE SYNTHETIC FIBERS SHALL BE INCLUDED IN THE COST OF CONCRETE STRUCTURES.

BITUMINOUS MATERIALS RATES

SURFACE TYPE:	RESIDUAL RATE
AGGREGATE BASE COURSE:	0.25 LB /SQ FT
CONCRETE, EX, HMA, AND MILLED HMA:	0.05 LB/SQ FT
NEW HMA AND BRICK:	0.025 LB/SQ FT

HORIZONTAL CONTROL POINTS

CONTROL POINT #	NORTHING	EASTING
400	1264773.421	1010985.539
401	1264495.509	1010976.953
403	1264386.931	1011099.743
404	1264266.493	1011087.674

COMMITMENTS

THERE ARE NO COMMITMENTS.

MODEL: \\MODELS\MEE FILE NAME: \\P:\DOT\Documents\DOT Office\District 5\ORD Project\DOT\BEG\ICADD\Draws\CADD\Draws\DOT\BEG\SH-2024\1.dgn

USER NAME = Kary,Dawson	DESIGNED -	REVISED -	STATE OF ILLINOIS DEPARTMENT OF TRANSPORTATION	GENERAL NOTES	F.A. RTE.	SECTION	COUNTY	TOTAL SHEETS	SHEET NO.	
PLOT SCALE = 0.16666633' / in.	DRAWN -	REVISED -			CHAMPAIGN IMP 2024-1	CHAMPAIGN	14	3		
PLOT DATE = 12/7/2023	CHECKED -	REVISED -			CONTRACT NO. 70F51					
	DATE -	REVISED -			ILLINOIS FED. AID PROJECT					
					SCALE:	SHEET	OF	SHEETS	STA.	TO STA.

SUMMARY OF QUANTITIES

LOCATION OF WORK:	CHAMPAIGN STORAGE FACILITY
	URBAN
COUNTY:	CHAMPAIGN
FUNDING BREAKOUT:	100% STATE
CONSTRUCTION TYPE CODE:	0005

CODE NO.	ITEM	UNIT	TOTAL QUANTITY	STATE QUANTITY
20200100	EARTH EXCAVATION	CU YD	205.00	205.00
35800100	PREPARATION OF BASE	SQ YD	2,582.00	2,582.00
40600275	BITUMINOUS MATERIALS (PRIME COAT)	POUND	4,134.00	4,134.00
40600290	BITUMINOUS MATERIALS (TACK COAT)	POUND	1,754.00	1,754.00
40600982	HOT-MIX ASPHALT SURFACE REMOVAL - BUTT JOINT	SQ YD	973.00	973.00
40603215	POLYMERIZED HOT-MIX ASPHALT BINDER COURSE, IL-9.5FG, N50	TON	290.00	290.00
40604150	POLYMERIZED HOT-MIX ASPHALT SURFACE COURSE, IL-9.5, MIX "C", N50	TON	540.00	540.00
44000100	PAVEMENT REMOVAL	SQ YD	167.00	167.00
48102100	AGGREGATE WEDGE SHOULDER, TYPE B	TON	5.00	5.00
50300225	CONCRETE STRUCTURES	CU YD	36.70	36.70
50800205	REINFORCEMENT BARS, EPOXY COATED	POUND	3,990.00	3,990.00
60300305	FRAMES AND LIDS TO BE ADJUSTED	EACH	9.00	9.00
* 66900200	NON-SPECIAL WASTE DISPOSAL	CU YD	70.00	70.00
* 66900530	SOIL DISPOSAL ANALYSIS	EACH	1.00	1.00
* DENOTES SPECIALTY ITEM				

MODEL: \MODEL\MJEE
FILE NAME: P:\MIDOT\Documents\IDOT Office\District 5\ORD Project\042725\FEI\CADD\Drawings\CHAMPAIGN\CHAMPAIGN\CHAMPAIGN.dgn

USER NAME = Kary.Dawson	DESIGNED -	REVISED -
	DRAWN -	REVISED -
PLOT SCALE = 0.16666833' / in.	CHECKED -	REVISED -
PLOT DATE = 12/7/2023	DATE -	REVISED -

**STATE OF ILLINOIS
DEPARTMENT OF TRANSPORTATION**

SUMMARY OF QUANTITIES

SCALE: 1"=50' SHEET 1 OF 2 SHEETS STA. TO STA.

SECTION	COUNTY	TOTAL SHEETS	SHEET NO.
CHAMPAIGN IMP 2024-1	CHAMPAIGN	14	4
CONTRACT NO. 70F51			
ILLINOIS FED. AID PROJECT			

SUMMARY OF QUANTITIES

LOCATION OF WORK:	CHAMPAIGN STORAGE FACILITY
	URBAN
COUNTY:	CHAMPAIGN
FUNDING BREAKOUT:	100% STATE
CONSTRUCTION TYPE CODE:	0005

CODE NO.	ITEM	UNIT	TOTAL QUANTITY	
* 66901001	REGULATED SUBSTANCES PRE-CONSTRUCTION PLAN	L SUM	1.00	1.00
* 66901003	REGULATED SUBSTANCES FINAL CONSTRUCTION REPORT	L SUM	1.00	1.00
* 66901006	REGULATED SUBSTANCES MONITORING	CAL DA	2.00	2.00
67100100	MOBILIZATION	L SUM	1.00	1.00
* 78001100	PAINT PAVEMENT MARKING - LETTERS AND SYMBOLS	SQ FT	7.00	7.00
* 78001110	PAINT PAVEMENT MARKING - LINE 4"	FOOT	700.00	700.00
X7010216	TRAFFIC CONTROL AND PROTECTION, (SPECIAL)	L SUM	1.00	1.00
XZ177600	REMOVE EXISTING BUMPER BLOCKS	EACH	11.00	11.00
Z0007800	BUMPER BLOCKS	EACH	11.00	11.00
Z0013798	CONSTRUCTION LAYOUT	L SUM	1.00	1.00
Z0075496	CONCRETE RETAINING WALL REMOVAL	FOOT	43.00	43.00
* DENOTES SPECIALTY ITEM				

MODEL: \\MODELS\MEE
FILE NAME: P:\MIDOT\Documents\DOT Office\District 5\ORD Project\0278FE1C\ADDons\CAD\Sheet\0278FE1-5H-001.dgn

USER NAME = Kary.Dawson	DESIGNED -	REVISED -
	DRAWN -	REVISED -
PLOT SCALE = 0.16666833' / in.	CHECKED -	REVISED -
PLOT DATE = 12/7/2023	DATE -	REVISED -

**STATE OF ILLINOIS
DEPARTMENT OF TRANSPORTATION**

SUMMARY OF QUANTITIES

SCALE: 1"=50' SHEET 2 OF 2 SHEETS STA. TO STA.

SECTION	COUNTY	TOTAL SHEETS	SHEET NO.
CHAMPAIGN IMP 2024-1	CHAMPAIGN	14	5
CONTRACT NO. 70F51			
ILLINOIS FED. AID PROJECT			

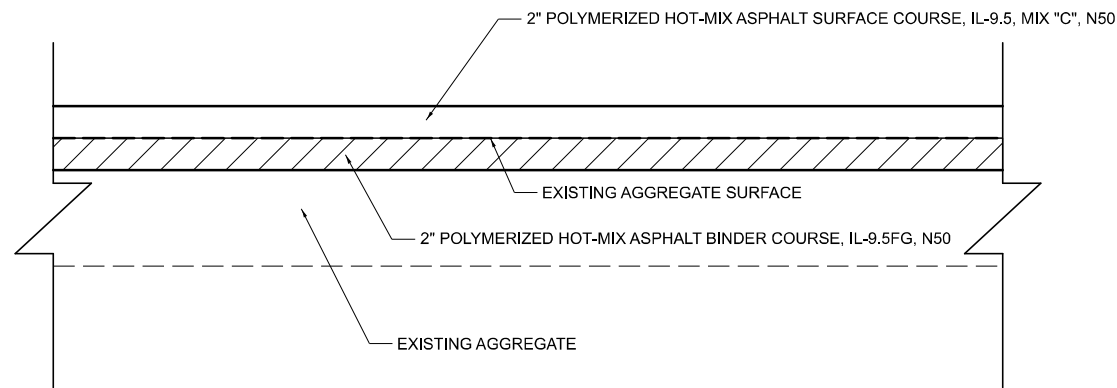

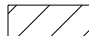
 2" EARTH EXCAVATION (NOMINAL - GRADE FOR POSITIVE DRAINAGE)

PROPOSED TYPICAL SECTION

HOT-MIX ASPHALT OVER EXISTING AGGREGATE
NOT TO SCALE

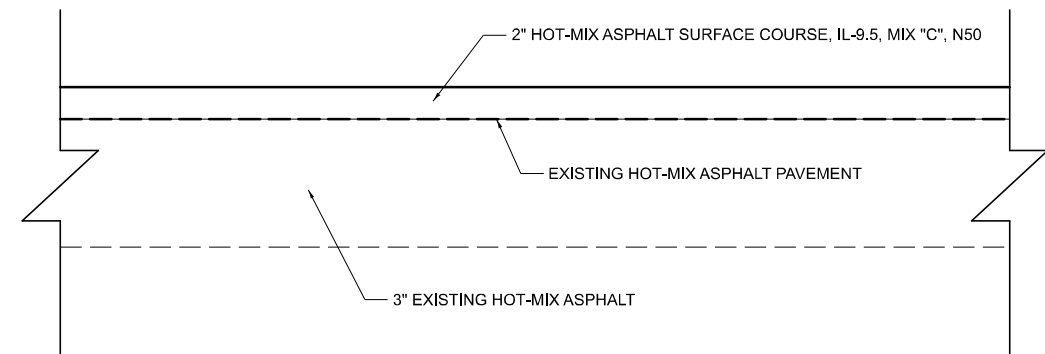

PROPOSED TYPICAL SECTION

HOT-MIX ASPHALT OVER EXISTING HOT-MIX ASPHALT
NOT TO SCALE

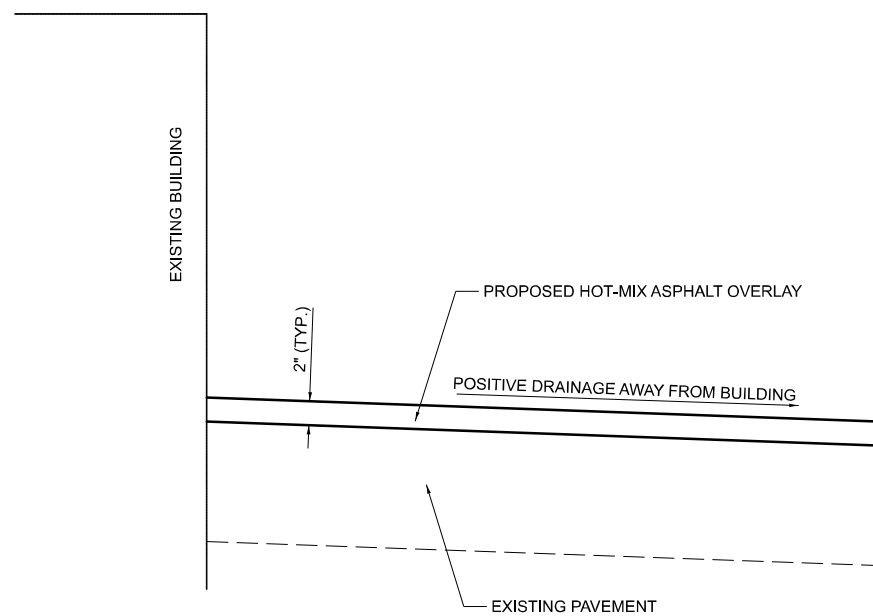

SECTION A-A

HOT-MIX ASPHALT OVERLAY ADJACENT TO EXISTING BUILDING
NOT TO SCALE

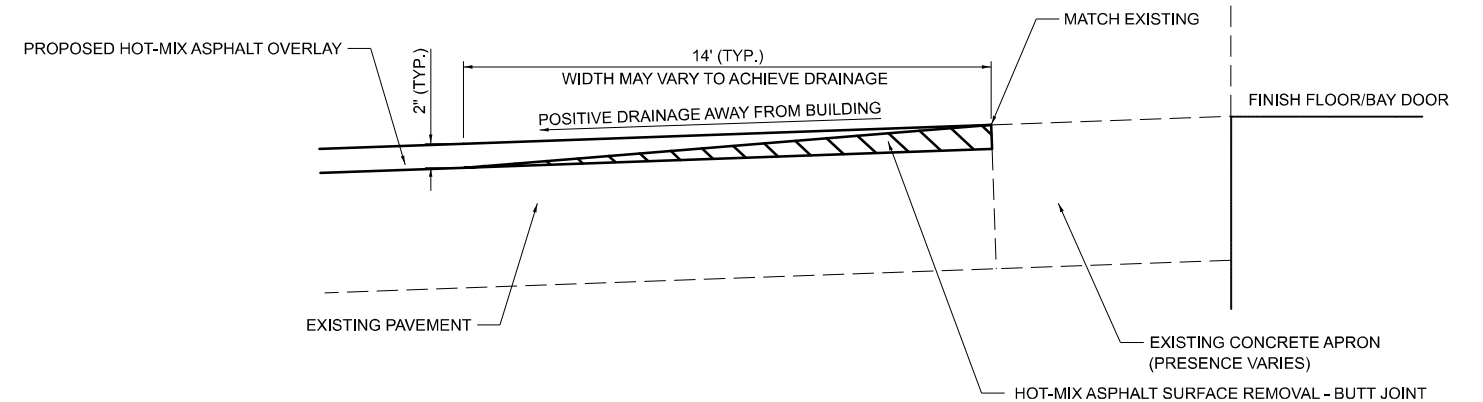

SECTION B-B

HOT-MIX ASPHALT OVERLAY WITH BUTT JOINT
AGAINST EXISTING FINISH FLOOR/BAY DOOR
NOT TO SCALE

MODEL: Untitled (Sheet)
FILE NAME: c:\p\work\kwdawson\0901360\0570F51-Sh-Typical.dgn

USER NAME = Kary.Dawson	DESIGNED -	REVISED -
	DRAWN -	REVISED -
PLOT SCALE = 0.16666633' / in.	CHECKED -	REVISED -
PLOT DATE = 12/7/2023	DATE -	REVISED -

**STATE OF ILLINOIS
DEPARTMENT OF TRANSPORTATION**

TYPICAL SECTION

SCALE: 1"=1'-0" SHEET 1 OF 2 SHEETS STA. TO STA.

F.A. RTE.	SECTION	COUNTY	TOTAL SHEETS	SHEET NO.
	CHAMPAIGN IMP 2024-1	CHAMPAIGN	14	6
CONTRACT NO. 70F51				
ILLINOIS FED. AID PROJECT				

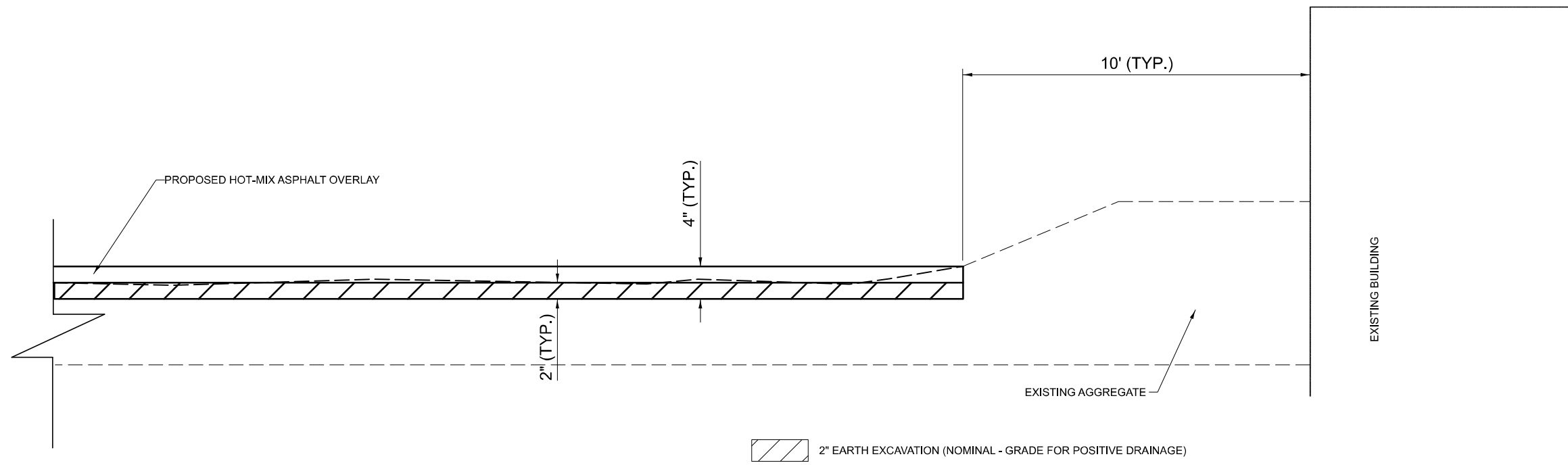

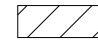
 2" EARTH EXCAVATION (NOMINAL - GRADE FOR POSITIVE DRAINAGE)

SECTION C-C

HOT-MIX ASPHALT OVER EXISTING AGGREGATE
NEAR EXISTING BUILDINGS
NOT TO SCALE

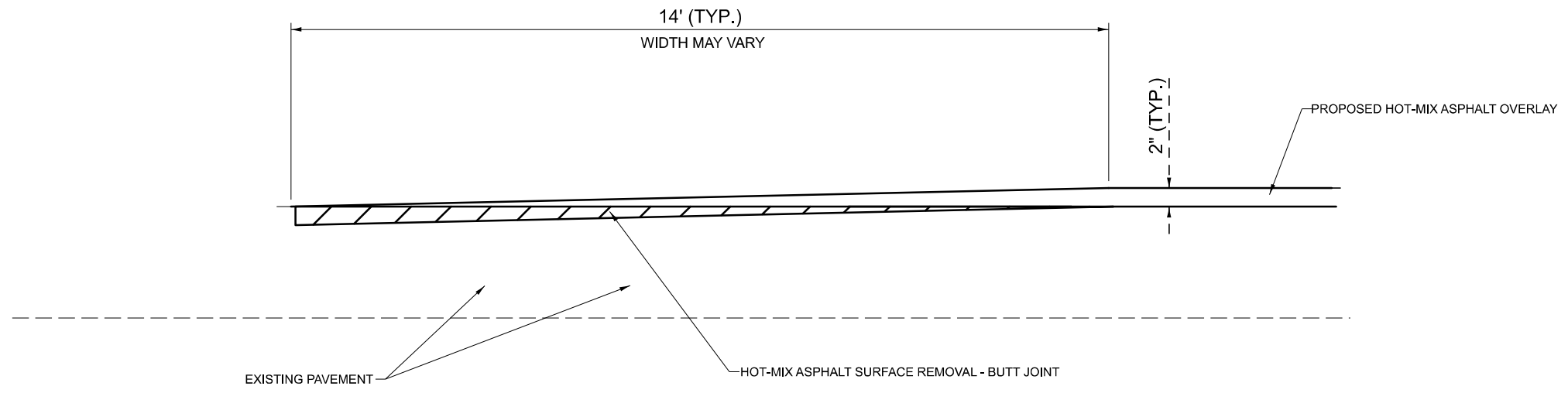

SECTION D-D

HOT-MIX ASPHALT OVERLAY ADJACENT TO EXISTING PAVEMENT
NOT TO SCALE

MODEL: I:\unfiled-1 [Sheet]
FILE NAME: c:\p\work\awid\awidawson\0801360\0570F51-Sh-1-Typical.dgn

USER NAME = Kary.Dawson	DESIGNED -	REVISED -
	DRAWN -	REVISED -
PLOT SCALE = 0.16666633' / in.	CHECKED -	REVISED -
PLOT DATE = 12/8/2023	DATE -	REVISED -

**STATE OF ILLINOIS
DEPARTMENT OF TRANSPORTATION**

TYPICAL SECTION

SCALE: 1"=1'-0" SHEET 2 OF 2 SHEETS STA. TO STA.

F.A. RTE.	SECTION	COUNTY	TOTAL SHEETS	SHEET NO.
	CHAMPAIGN IMP 2024-1	CHAMPAIGN	14	7
CONTRACT NO. 70F51				
ILLINOIS FED. AID PROJECT				

SCHEDULE OF QUANTITIES

20200100	EARTH EXCAVATION		
LOCATION		CU YD	
EX AGG SURFACE EAST OF SALT DOME			102.30
EX MATERIAL AT PUSH WALL			102.30
	SUBTOTAL		204.60
	ROUNDED TOTAL		205

35800100	PREPARATION OF BASE		
LOCATION		SQ YD	
EX AGG SURFACE EAST OF SALT DOME			1837.20
EX HMA SURFACE WEST OF SIGN SHOP X 25%			187.20
EX HMA SURFACE NORTH OF SIGN SHOP X 25%			499.40
EX HMA SURFACE EAST OF SALT DOME X 25%			58.00
	SUBTOTAL		2581.80
	ROUNDED TOTAL		2582

40600275	BITUMINOUS MATERIALS (PRIME COAT)		
LOCATION		LBS	
AREA EAST OF SALT DOME			4133.60
	SUBTOTAL		4133.60
	ROUNDED TOTAL		4134

40600290	BITUMINOUS MATERIALS (TACK COAT)		
LOCATION		LBS	
EX AGG SURFACE AREA EAST OF SALT DOME (AFTER BINDER)			413.36
EX HMA SURFACE EAST OF SALT DOME (BEFORE SURFACE)			104.35
EX HMA SURFACE AREA WEST OF SIGN SHOP			336.88
EX HMA SURFACE AREA NORTH OF SIGN SHOP			898.96
	SUBTOTAL		1753.55
	ROUNDED TOTAL		1754

40600982	HOT-MIX ASPHALT SURFACE REMOVAL - BUTT JOINT		
LOCATION		SQ YD	
AREAS SURROUNDING UNDERGROUND FUEL TANK AREA & CAN			283.50
NORTH SIDE OF SIGN SHOP			174.70
WEST SIDE OF SIGN SHOP			205.80
WEST SIDE OF SIGN SHOP AT SOUTH EDGE ADJACENT TO EXIST PCC			81.70
EISNER RD. WEST ENTRANCE			73.70
EAST OF SALT DOME			153.20
	SUBTOTAL		972.60
	ROUNDED TOTAL		973

40603215	POLYMERIZED HOT-MIX ASPHALT BINDER COURSE, IL-9.5FG, N50		
LOCATION		TON	
EX AGG SURFACE AREA EAST OF SALT DOME			205.77
EX HMA SURFACE AREAS REQUIRING PREPARATION OF BASE			
EX HMA SURFACE AREA WEST OF SIGN SHOP X 25%			20.97
EX HMA SURFACE AREA NORTH OF SIGN SHOP X 25%			55.93
EX HMA SURFACE AREA EAST OF SALT DOME X 25%			6.50
	SUBTOTAL		289.20
	ROUNDED TOTAL		290

40604150	POLYMERIZED HOT-MIX ASPHALT SURFACE COURSE, IL-9.5, MIX "C", N50		
LOCATION		TON	
EX AGG SURFACE AREA EAST OF SALT DOME			205.77
EX HMA SURFACE AREA WEST OF SIGN SHOP			83.84
EX HMA SURFACE AREA NORTH OF SIGN SHOP			223.74
EX HMA SURFACE AREA EAST OF SALT DOME			25.97
	SUBTOTAL		539.32
	ROUNDED TOTAL		540

44000100	PAVEMENT REMOVAL		
LOCATION		SQ YD	
PORTION OF THE EXIST HMA PAD IN FRONT OF SALT DOME			167.00
	SUBTOTAL		167.00
	ROUNDED TOTAL		167

MODEL: \\MODEL\AMEE
 FILE NAME: \\P:\DOT\Documents\DOT Office\District 5\ORD Project\DOT\AMEE\CADD\Drawings\DOT\AMEE\SH-Quant.sgn

	USER NAME = Kary.Dawson	DESIGNED -	REVISED -	STATE OF ILLINOIS	SCHEDULE OF QUANTITIES							
		DRAWN -	REVISED -	DEPARTMENT OF TRANSPORTATION					SECTION	COUNTY	TOTAL SHEETS	SHEET NO.
	PLOT SCALE = 0.16666633' / in.	CHECKED -	REVISED -						CHAMPAIGN IMP 2024-1	CHAMPAIGN	14	8
	PLOT DATE = 12/7/2023	DATE -	REVISED -		SCALE: 1"=50'	SHEET	OF	SHEETS	STA.	TO	STA.	CONTRACT NO. 70F51
												ILLINOIS FED. AID PROJECT

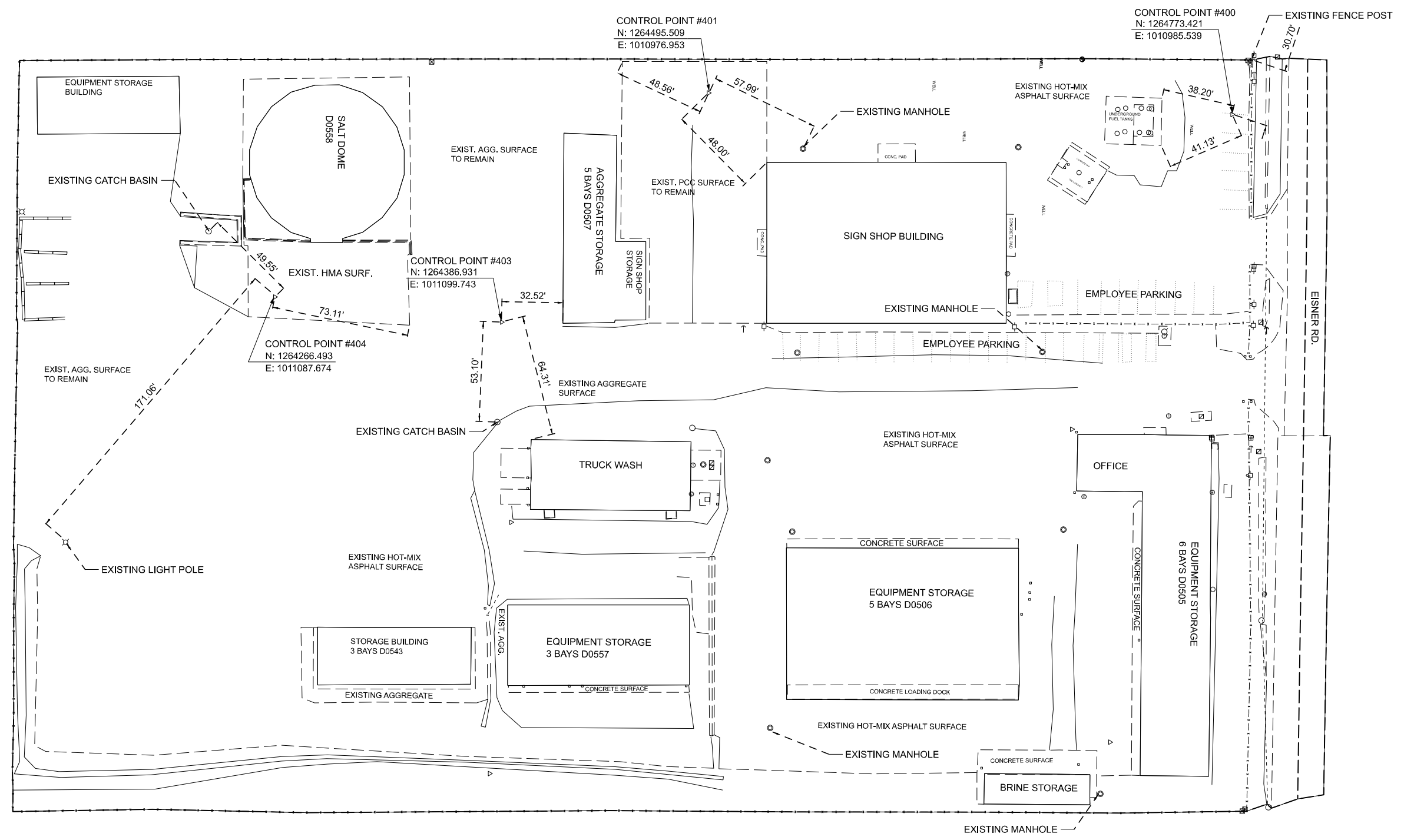
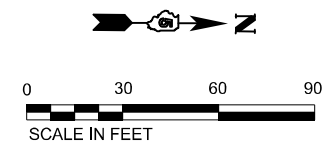

MODEL: ATB (Sheet)
 FILE NAME: c:\p\work\dw\atb\dawson\0901380\0570F51-Sh-ATB.dgn

USER NAME = Kary.Dawson	DESIGNED -	REVISED -
	DRAWN -	REVISED -
PLOT SCALE = 0.16666833' / in.	CHECKED -	REVISED -
PLOT DATE = 12/7/2023	DATE -	REVISED -



STATE OF ILLINOIS
DEPARTMENT OF TRANSPORTATION

DISTRICT 5 CHAMPAIGN STORAGE FACILITY
CONTROL POINTS & BENCHMARKS

SCALE:	SHEET	OF	SHEETS	STA.	TO	STA.
--------	-------	----	--------	------	----	------

F.A. RTE.	SECTION	COUNTY	TOTAL SHEETS	SHEET NO.
	CHAMPAIGN IMP 2024-1	CHAMPAIGN	14	10
CONTRACT NO. 70F51				
ILLINOIS FED. AID PROJECT				

LEGEND

-  HOT-MIX ASPHALT SURFACE REMOVAL - BUTT JOINT
-  PAVEMENT REMOVAL

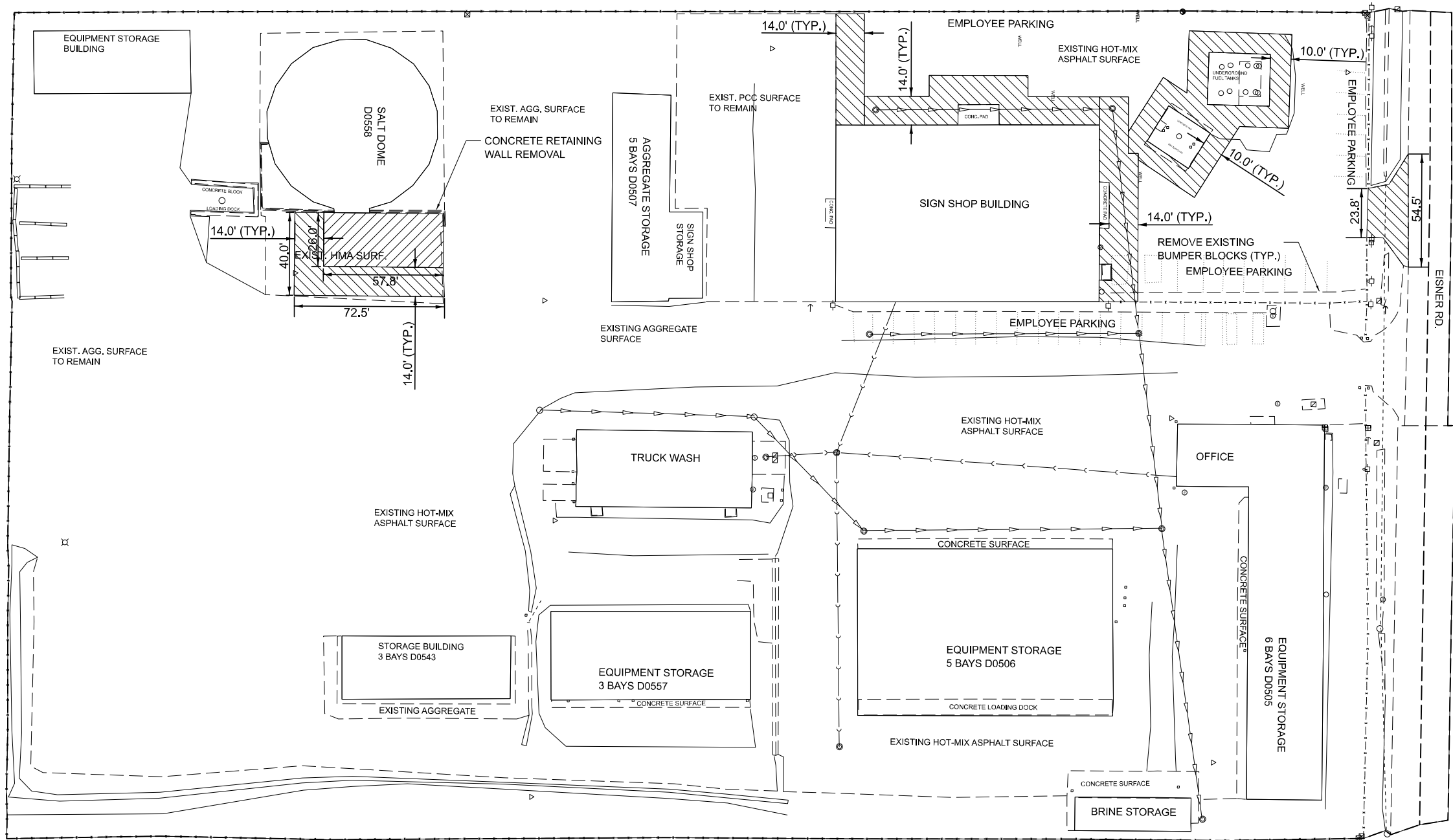
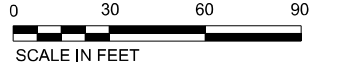

MODEL: Removal (Sheet)
FILE NAME: c:\p\work\k\awildawson\bd0901380\0570F51-Sh-Removal.dgn



USER NAME = Kary.Dawson	DESIGNED -	REVISED -
PLOT SCALE = 0.16666833' / in.	DRAWN -	REVISED -
PLOT DATE = 12/7/2023	CHECKED -	REVISED -
	DATE -	REVISED -

**STATE OF ILLINOIS
DEPARTMENT OF TRANSPORTATION**

**DISTRICT 5 CHAMPAIGN STORAGE FACILITY
REMOVAL PLAN**

SCALE: SHEET OF SHEETS STA. TO STA.

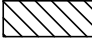
F.A. RTE.	SECTION	COUNTY	TOTAL SHEETS	SHEET NO.
	CHAMPAIGN IMP 2024-1	CHAMPAIGN	14	11
CONTRACT NO. 70F51				
ILLINOIS FED. AID PROJECT				

LEGEND	
	EXISTING AGGREGATE SURFACE TO BE PAVED 2" POLYMERIZED HOT-MIX ASPHALT SURFACE COURSE, IL-9.5, MIX "C", N50 & 2" POLYMERIZED HOT-MIX ASPHALT BINDER COURSE, IL-9.5FG, N50 & PREPARATION OF BASE
	EXISTING HOT-MIX ASPHALT SURFACE TO BE OVERLAYED 2" POLYMERIZED HOT-MIX ASPHALT SURFACE COURSE, IL-9.5, MIX "C", N50 & PREPARATION OF BASE FOR ESTIMATED 25% OF THE AREA

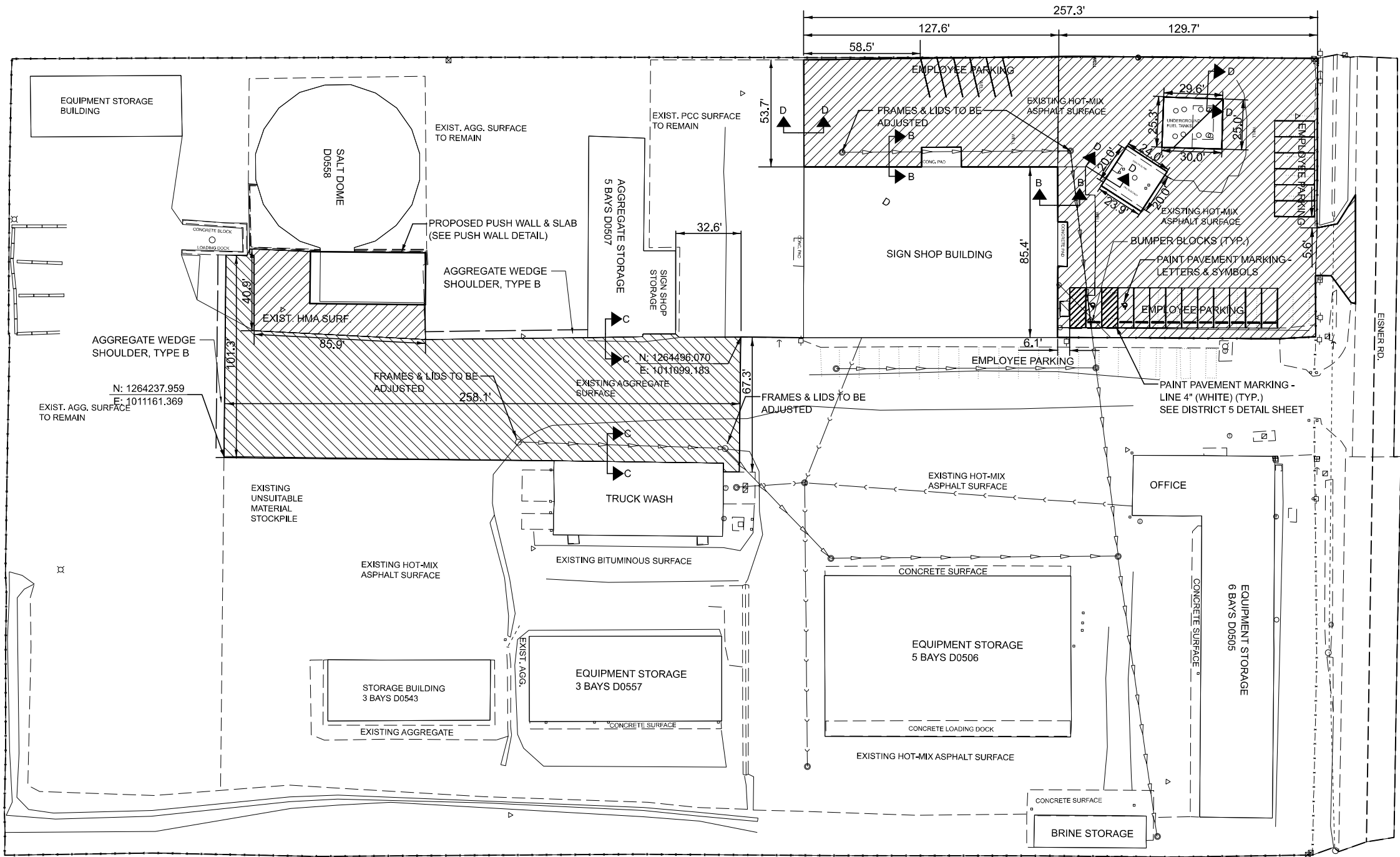
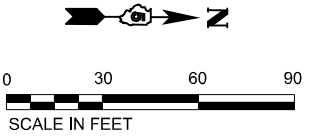

MODEL: Site (Sheet)
 FILE NAME: c:\p\work\dw\champaign\0901380\0570F51-SitePlan.dgn

USER NAME = Kary.Dawson	DESIGNED -	REVISED -
PLOT SCALE = 0.16666633' / in.	DRAWN -	REVISED -
PLOT DATE = 12/7/2023	CHECKED -	REVISED -
	DATE -	REVISED -

STATE OF ILLINOIS
DEPARTMENT OF TRANSPORTATION

DISTRICT 5 CHAMPAIGN STORAGE FACILITY
SITE PLAN

SCALE: SHEET OF SHEETS STA. TO STA.

F.A. RTE.	SECTION	COUNTY	TOTAL SHEETS	SHEET NO.
	CHAMPAIGN IMP 2024-1	CHAMPAIGN	14	12
CONTRACT NO. 70F51				
ILLINOIS FED. AID PROJECT				

DESIGN STRESSES
FIELD UNITS

$f'_c = 3,500$ psi
 $f_y = 60,000$ psi (Reinforcement)

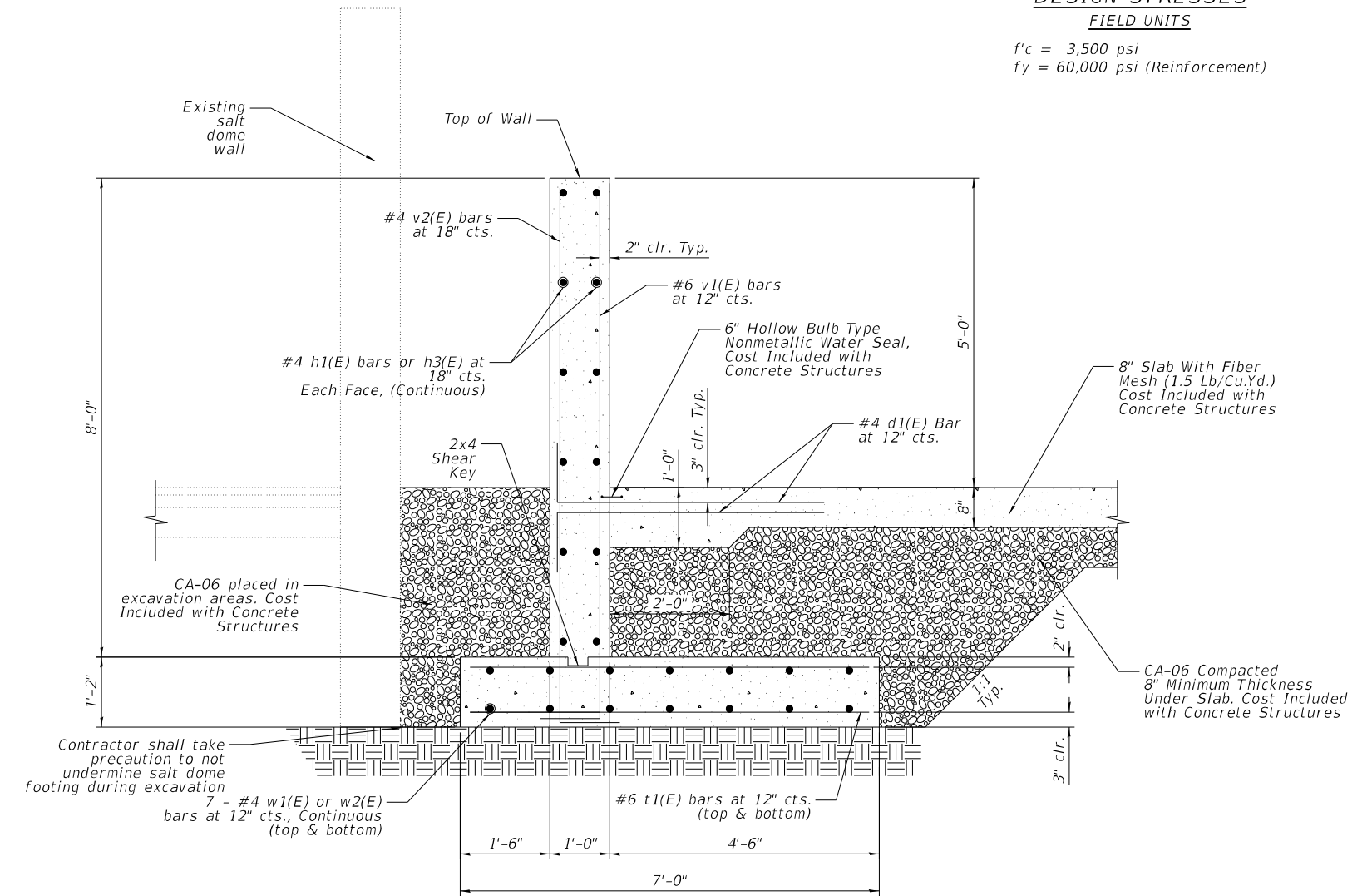
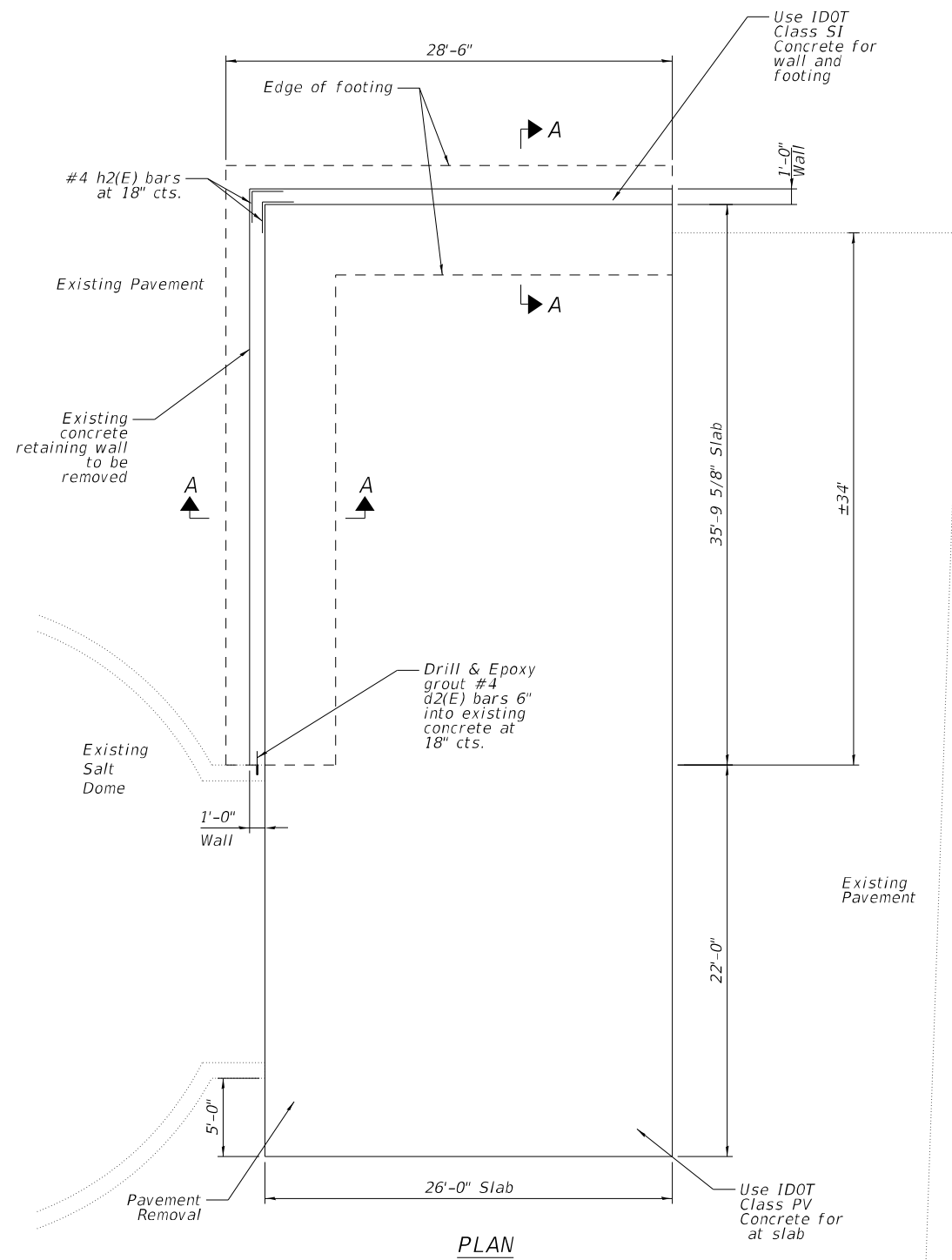

BILL OF MATERIAL

Bar	No.	Size	Length	Shape
d1(E)	124	#4	5'-0"	┌───┐
d2(E)	6	#4	2'-0"	┌───┐
h1(E)	12	#4	26'-8"	┌───┐
h2(E)	12	#4	4'-0"	┌───┐
h3(E)	12	#4	36'-5"	┌───┐
t1(E)	124	#6	6'-8"	┌───┐
v1(E)	62	#6	9'-9"	┌───┐
v2(E)	42	#4	9'-5"	┌───┐
w1(E)	14	#4	28'-2"	┌───┐
w2(E)	14	#4	38'-0"	┌───┐
Concrete Structures		Cu. Yd.	36.7	
Reinforcement Bars, Epoxy Coated		Pound	3990	
Earth Excavation		Cu. Yd.	102.3	
Non-Special Waste Disposal		Cu. Yd.	70.0	
Pavement Removal		Sq. Yd.	167.0	
Concrete Retaining Wall Removal		Foot	43.0	

SECTION A-A

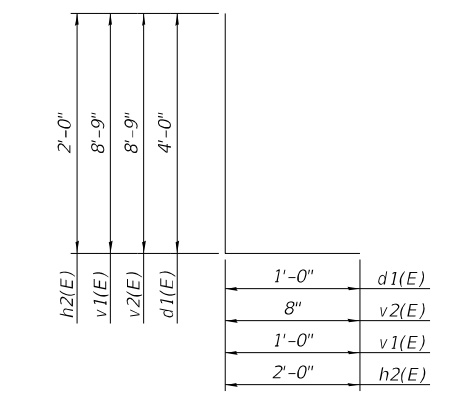

BARS d1(E), v1(E), v2(E), & h2(E)

GENERAL NOTES

- Reinforcement bars designated (E) shall be epoxy coated.
- The Push wall slab shall receive a light-broom finish, and the walls shall receive a normal finish in accordance with Article 503.15 of the Standard Specifications.
- The Push wall is designed for a 2,000 plf service load at 2' above the concrete slab.
- Maximum Applied Service Bearing Pressure Q_{max} , 1,500 psf.

*Bill of materials only pertain to retaining wall

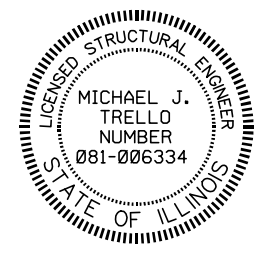

DATE: DECEMBER 4 20 23
EXPIRES: NOVEMBER 30 20 24

MODEL: SMODEL\NAMES
FILE NAME: p:\i\p\w\benley.com\FWIDOT\Documents\IDOT_O_ces\District_5\ORD Projects\0570F51\CAD\Detail\CADsheets\0570F51-Sh-Push Wall Details.dgn



USER NAME =	DESIGNED - PA	REVISED -
PLOT SCALE =	CHECKED - MJT	REVISED -
PLOT DATE = 12/7/2023	DRAWN - KTCE	REVISED -
STIMES	CHECKED - MJT	REVISED -

STATE OF ILLINOIS
DEPARTMENT OF TRANSPORTATION

PUSH WALL
CHAMPAIGN STORAGE FACILITY

SHEET 1 OF 1 SHEETS

F.A.P. RTE.	SECTION	COUNTY	TOTAL SHEETS	SHEET NO.
-	CHAMPAIGN IMP 2024-1	CHAMPAIGN	14	13
CONTRACT NO. 70F51				
ILLINOIS FED. AID PROJECT				

SIGN R7-I 101

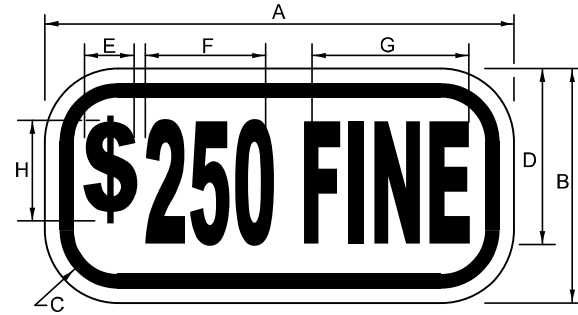

COLOR: LEGEND AND BORDER BACKGROUND GREEN NON-REFLECTORIZED WHITE REFLECTORIZED

SIGN SIZE	DIMENSIONS							
	A	B	C	D	E	F	G	H
6 x 12 (152.4 x 304.8)	12 (304.8)	6 (152.4)	1.5 (38.1)	4.5 (114.3)	1.15 (29.2)	3.4 (86.4)	4.6 (116.8)	4.0 (101.6)

SIGN SIZE	SERIES Lines	Margin	Border	BLK Std
6 x 12 (152.4 x 304.8)	1/3A	0.37 (9.5)	0.37 (9.5)	B5-126

To be used with R7-8
* \$ = SERIES 3A "S"

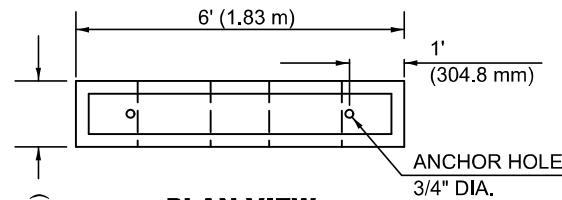

PLAN VIEW

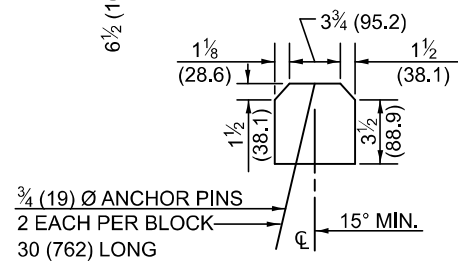

END VIEW

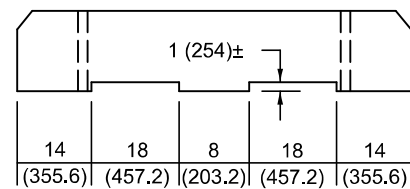

ELEVATION VIEW

NOTE: NOMINAL DIMENSIONS OF BLOCKS MAY VARY
CLASS P.C. CONCRETE SHALL BE USED THROUGHOUT.

BUMPER BLOCK DETAIL

SIGN R7-8



ARROW
(USE ARROW AT
LOCATIONS WHERE
THERE ARE TWO
HANDICAP SPOTS
NEXT TO EACH OTHER.)

COLORS
LEGEND AND BORDER - GREEN
WHITE SYMBOL ON BLUE BACKGROUND
BACKGROUND - WHITE

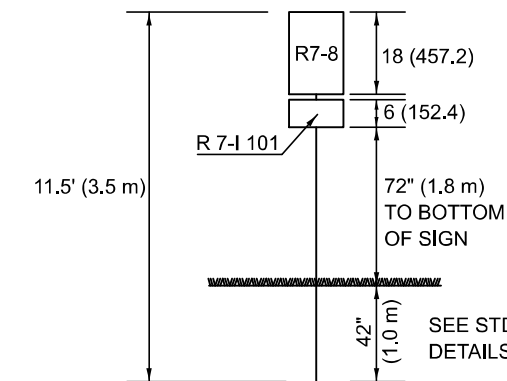

SEE STD. 720011 & 729001 FOR
DETAILS OF METAL POST, TYPE A

ESTIMATED QUANTITY

72900110 METAL POST - TYPE A = 11.5' (3.5 m)	
72000100 SIGN PANEL R 7-I 101	0.5 SQ.FT. (.046 m ²)
72000100 SIGN PANEL R 7-8	1.5 SQ.FT. (.139 m ²)
TOTAL	2.0 SQ.FT. (.185 m²)

SIGN POST DETAILS

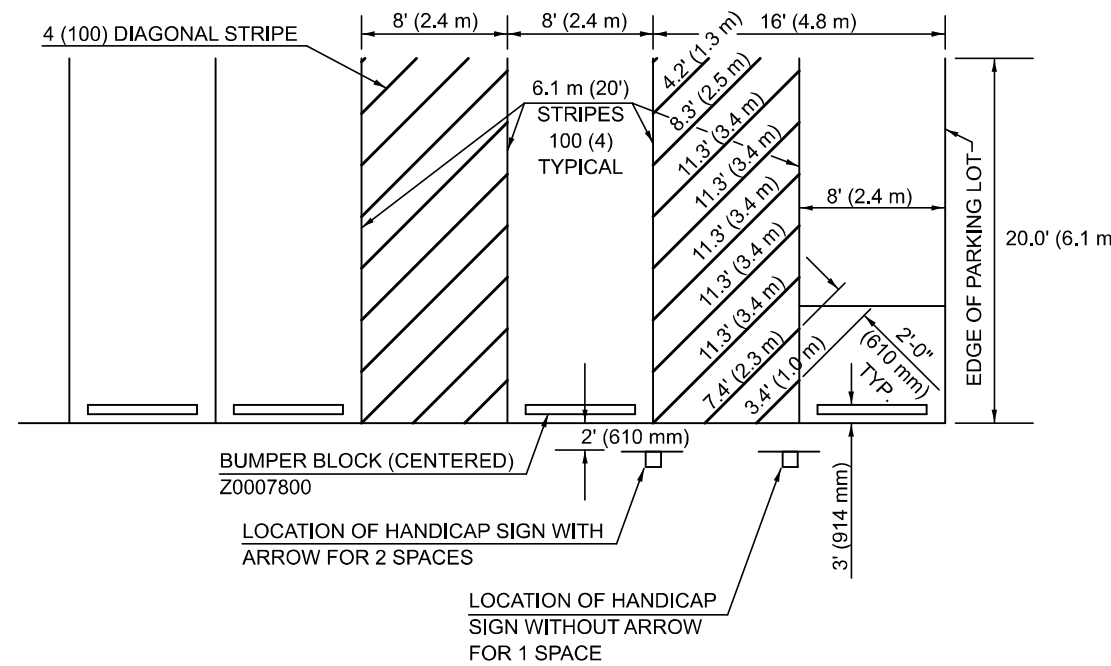

THIS DRAWING HAS NO SCALE.

ESTIMATED QUANTITY OF PAVEMENT
MARKING-LINE 4" (100 mm) (FOR 1 SPACE)
TOTAL DIAGONALS = 80' (24.4 m)

SEE DETAIL FOR HANDICAP SIGN.

DETAIL OF PARKING SPACES

Note: All dimensions are in INCHES
(millimeters) unless otherwise shown.

DISTRICT 5 DETAIL NO. 72000100

F.A. RTE.	SECTION	COUNTY	TOTAL SHEETS	SHEET NO.
	CHAMPAIGN IMP 2024-1	CHAMPAIGN	14	14
				CONTRACT NO. 70F51

STATE OF ILLINOIS
DEPARTMENT OF TRANSPORTATION

DISABLED PARKING

SCALE: SHEET 1 OF 1 SHEETS STA. TO STA.

USER NAME = Kary.Dawson	DESIGNED -	REVISED - 11/06
	DRAWN -	REVISED - 12/27/17 JWS
PLOT SCALE = 0.16666633' / in.	CHECKED -	REVISED -
PLOT DATE = 11/16/2023	DATE -	REVISED -