

STATE OF ILLINOIS
DEPARTMENT OF TRANSPORTATION

F.A.P. RTE.	SECTION	COUNTY	TOTAL SHEETS	SHEET NO.
781	1Z,17Z)RS-2	CRAWFORD	19	1
		ILLINOIS	CONTRACT NO. 74980	

D-97-057-20

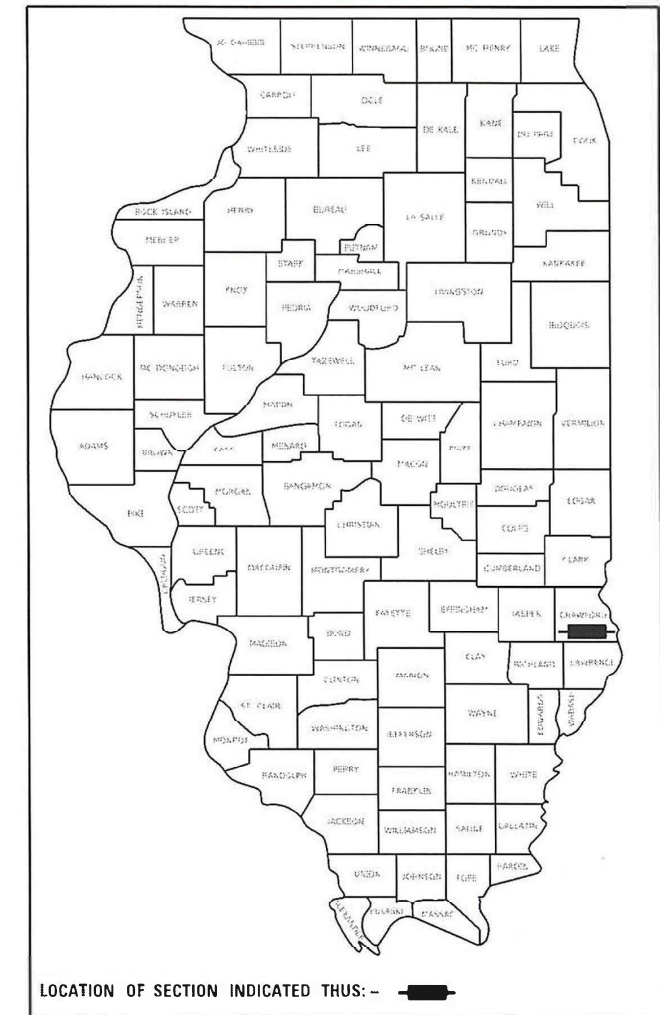

PROPOSED HIGHWAY PLANS

FAP 781 (IL 33)
SECTION (1Z,17Z)RS-2
PROJECT STP-TCJS(904)
STANDARD INLAY
CRAWFORD COUNTY

C-97-063-20

FOR INDEX OF SHEETS, SEE SHEET NO. 2

ADT (2021) = 9400
% TRUCKS = 6.1%

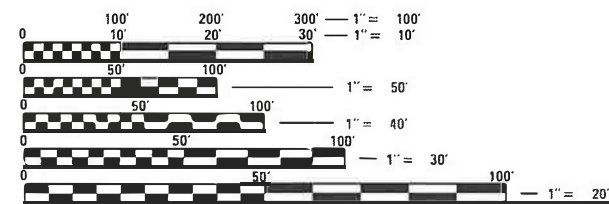
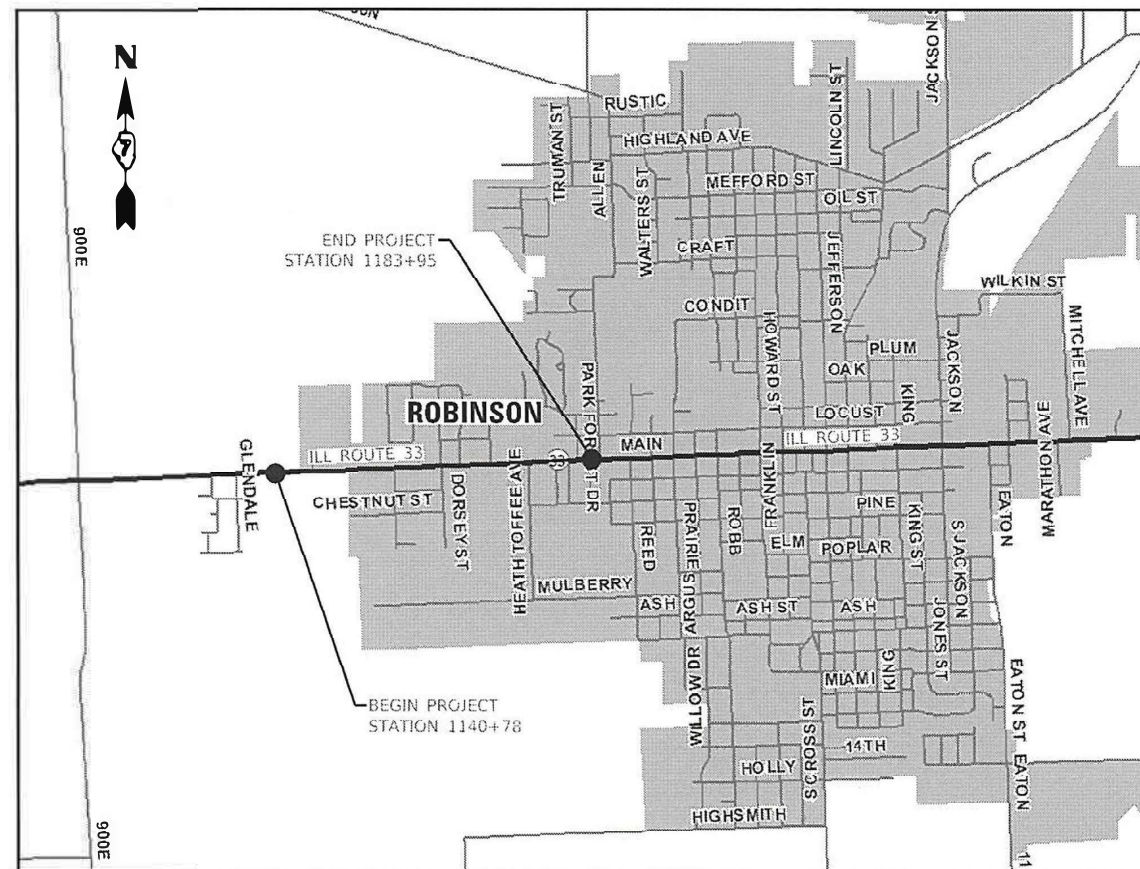

FULL SIZE PLANS HAVE BEEN PREPARED USING STANDARD ENGINEERING SCALES. REDUCED SIZED PLANS WILL NOT CONFORM TO STANDARD SCALES. IN MAKING MEASUREMENTS ON REDUCED PLANS, THE ABOVE SCALES MAY BE USED.

J.U.L.I.E.
JOINT UTILITY LOCATION INFORMATION FOR EXCAVATORS
1-800-892-0123
OR 811

PROJECT ENGINEER: JACQUELYN SEALS
PROJECT MANAGER: LEAH HILLE

CONTRACT NO. 74980

GROSS LENGTH = 4224.0 FT. = 0.8 MILE
NET LENGTH = 4224.0 FT. = 0.8 MILE

STATE OF ILLINOIS
DEPARTMENT OF TRANSPORTATION

SUBMITTED NOVEMBER 29 2023
Jeffrey P. Myers
REGIONAL ENGINEER

February 2, 2024
Steph A. Etk
ENGINEER OF DESIGN AND ENVIRONMENT

February 2, 2024
Steph A. Etk
DIRECTOR OF HIGHWAYS PROJECT IMPLEMENTATION

PRINTED BY THE AUTHORITY
OF THE STATE OF ILLINOIS

GENERAL NOTES

THIS PROJECT IS LOCATED ON FAP ROUTE 781 (ILL 133) IN CRAWFORD COUNTY FROM 0.2 MILES EAST OF GLENDALE ROAD TO PARK FOREST DRIVE IN ROBINSON. THE WORK INCLUDED IN SECTION (1Z, 17Z)RS-2 CONSISTS OF PATCHING, MILLING, HOT-MIX ASPHALT RESURFACING, AND ANY OTHER WORK NECESSARY TO COMPLETE THIS SECTION.

THE EXISTING PAVEMENT SHALL BE PATCHED IN ACCORDANCE WITH SECTION 442 OF THE STANDARD SPECIFICATIONS AND THE SPECIAL PROVISIONS. THE QUANTITY OF PATCHING SHOWN ON THE PLANS IS AN ESTIMATE. THE FINAL LOCATIONS AND QUANTITY SHALL BE DETERMINED BY THE ENGINEER IN THE FIELD.

VIBRATORY ROLLERS IN DYNAMIC MODE WILL NOT BE PERMITTED. DENSITY REQUIREMENTS MUST STILL BE MET.

MILLED PAVEMENT SHALL BE RESURFACED WITH BINDER WITHIN 5 CALENDAR DAYS.

WHEN APPLYING SHORT TERM PAVEMENT MARKINGS, TEMPORARY TAPE SHALL BE USED ON THE SURFACE AND PAINT SHALL BE USED ON THE MILLED AND BINDER SURFACES.

ALL GROOVING OF PAVEMENT MARKING SMBOLS SHALL BE DONE IN THE SHAPE OF THE SYMBOL.

SEE PAGE 6 FOR PAVEMENT MARKING SCHEDULE.

LONGITUDINAL JOINT SEALANT WILL BE APPLIED AT ALL CENTERLINE AND TURN LANE JOINTS.

A UNIFORMLY STRAIGHT SAW CUT SHALL BE MADE AT LOCATIONS WHERE PROPOSED NEW CONSTRUCTION WILL ABUT EXISTING HOT-MIX ASPHALT SURFACES. THE SAW CUT SHALL BE MADE THE SAME DEPTH AS THE HOT-MIX ASPHALT SURFACE REMOVAL. THIS WORK WILL BE CONSIDERED INCLUDED IN THE COST OF THE CONTRACT ITEMS INVOLVED AND NO EXTRA COMPENSATION WILL BE ALLOWED.

ANY FRAME AND GRATES DAMAGED BY THE CONTRACTOR DURING CONSTRUCTION SHALL BE REPLACED BY THE CONTRACTOR AT THEIR EXPENSE.

THE RESIDENT ENGINEER SHALL BE THE SOLE JUDGE CONCERNING THE CURING TIME FOR THE VARIOUS HOT-MIX ASPHALT LIFTS

INDEX OF SHEETS

SHEET NO.	ITEM
1	COVER SHEET
2	INDEX OF SHEETS, LIST OF STANDARDS, AND GENERAL NOTES
3-4	SUMMARY OF QUANTITIES
5	TYPICAL SECTIONS
6	SCHEDULE OF QUANTITIES
7-10	PLAN SHEETS
11-14	PAVEMENT MARKING SHEETS
15-19	DISTRICT 7 DETAILS

THE FOLLOWING STANDARDS ARE A PART OF THESE PLANS AND ARE INCLUDED AFTER SHEET NO. 19:

STANDARD NO.	DESCRIPTION
000001-08	STANDARD SYMBOLS, ABBREVIATIONS AND PATTERNS
001001-02	AREAS OF REINFORCEMENT BARS
001006	DECIMAL OF AN INCH AND OF A FOOT
442201-03	CLASS C AND D PATCHES
667101-02	PERMANENT SURVEY MARKERS
701001-02	OFF-ROAD OPERATIONS, 2L, 2W, MORE THAN 15' AWAY
701006-05	OFF-ROAD OPERATIONS, 2L, 2W, 15' TO 24" FROM PAVEMENT EDGE
701011-04	OFF-ROAD MOVING OPERATIONS, 2L, 2W, DAY ONLY
701106-05	OFF-ROAD OPERATIONS, MULTILANE, MORE THAN 15' AWAY
701301-04	LANE CLOSURE, 2L, 2W, SHORT TIME OPERATIONS
701306-04	LANE CLOSURE, 2L, 2W, SLOW MOVING OPERATIONS DAY ONLY, FOR SPEEDS \geq 45 MPH
701311-03	LANE CLOSURE, 2L, 2W, MOVING OPERATIONS - DAY ONLY
701427-05	LANE CLOSURE, MULTILANE, INTERMITTENT OR MOVING OPER., FOR SPEEDS \leq 40 MPH
701501-06	URBAN LANE CLOSURE, 2L, 2W, UNDIVIDED
701502-09	URBAN LANE CLOSURE, 2L, 2W, WITH BIDIRECTIONAL LEFT TURN LANE
701602-10	URBAN LANE CLOSURE, MULTILANE, 2W WITH BIDIRECTIONAL LEFT TURN LANE
701901-09	TRAFFIC CONTROL DEVICES
780001-05	TYPICAL PAVEMENT MARKINGS
781001-04	TYPICAL APPLICATIONS RAISED REFLECTIVE PAVEMENT MARKERS
701101-05	OFF-ROAD OPERATIONS, MULTILANE, 15' TO 24" FROM PAVEMENT EDGE

APPLICATION RATES

THE FOLLOWING APPLICATION RATES WERE USED IN CALCULATING PLAN QUANTITIES AND HAVE BEEN INCLUDED FOR REFERENCE:

BITUMINOUS MATERIALS (TACK COAT)	0.05 LB/SQ FT (ON MILLED SURFACES)
	0.025 LB/SQ FT (ON HMA LIFTS)

MIXTURE REQUIREMENTS

THE FOLLOWING MIXTURE REQUIREMENTS ARE APPLICABLE TO THIS PROJECT:

LOCATION(S)	MIXTURE USE(S)	PG	DESIGN AIR VOIDS	MIXTURE COMPOSITION	FRICTION AGGREGATE	MIXTURE WEIGHT	QUALITY MANAGEMENT PROGRAM	SUBLOT SIZE	MATERIAL TRANSFER DEVICE (REQUIRED?)
MAINLINE	POLYMERIZED HMA SURFACE COURSE, IL-9.5, MIX "D", N90	PG 70-22	4.0% @ N=90	IL - 9.5	MIXTURE D	N90	QC/QA	3000	N/A
MAINLINE	POLYMERIZED HMA BINDER COURSE, IL-9.5FG, N90	PG 70-22	4.0% @ N=90	IL - 9.5FG	N/A	N90	QC/QA	3000	N/A
PATCHING	HMA BINDER COURSE, IL-19.0, N90	PG 64-22	4.0% @ N=90	IL - 19.0	N/A	N90	QC/QA	3000	N/A

REV. - MS

MODEL: Default
 FILE: MainE_PlanIndex.dwg
 USER: hbenitez
 DATE: 1/4/2024
 PROJECT: 74980_CADDData\CAD\Sheet\74980-17Z-19-2.dgn

USER NAME = Default	DESIGNED - LMH	REVISED -	STATE OF ILLINOIS DEPARTMENT OF TRANSPORTATION	INDEX OF SHEETS & GENERAL NOTES			F.A.P. RTE.	SECTION	COUNTY	TOTAL SHEETS	SHEET NO.
DRAWN - LMH	REVISED -	781					(1Z,17Z)RS-2	CRAWFORD	19	2	
PLOT SCALE = 100,0000' / in.	CHECKED -	REVISED -		SCALE: NO SCALE SHEET 1 OF 1 SHEETS STA. TO STA.			CONTRACT NO. 74980				
PLOT DATE = 1/4/2024	DATE - 1/4/2024	REVISED -					ILLINOIS FED. AID PROJECT				

URBAN

URBAN

SUMMARY OF QUANTITIES			TOTAL QUANTITIES	CONSTRUCTION TYPE CODE		
CODE NO	ITEM	UNIT		0005 80% FEDERAL 20% STATE		
40600290	BITUMINOUS MATERIALS (TACK COAT)	POUND	14380	14380		
40600370	LONGITUDINAL JOINT SEALANT	FOOT	10810	10810		
40600990	TEMPORARY RAMP	SQ YD	350	350		
40603219	POLYMERIZED HOT-MIX ASPHALT BINDER COURSE, IL-9.5FG, N90	TON	1500	1500		
40604164	POLYMERIZED HOT-MIX ASPHALT SURFACE COURSE, IL-9.5, MIX "D", N90	TON	1790	1790		
44000160	HOT-MIX ASPHALT SURFACE REMOVAL, 2 3/4"	SQ YD	21310	21310		
44201835	CLASS D PATCHES, TYPE I, 16 INCH	SQ YD	10	10		
44201839	CLASS D PATCHES, TYPE II, 16 INCH	SQ YD	180	180		
66700205	PERMANENT SURVEY MARKERS, TYPE I	EACH	1	1		
67000400	ENGINEER'S FIELD OFFICE, TYPE A	CAL MO	3	3		
67100100	MOBILIZATION	L SUM	1	1		
70100460	TRAFFIC CONTROL AND PROTECTION, STANDARD 701306	L SUM	1	1		
70102620	TRAFFIC CONTROL AND PROTECTION, STANDARD 701501	L SUM	1	1		

SUMMARY OF QUANTITIES			TOTAL QUANTITIES	CONSTRUCTION TYPE CODE		
CODE NO	ITEM	UNIT		0005 80% FEDERAL 20% STATE		
70102622	TRAFFIC CONTROL AND PROTECTION, STANDARD 701502	L SUM	1	1		
70102632	TRAFFIC CONTROL AND PROTECTION, STANDARD 701602	L SUM	1	1		
70107025	CHANGEABLE MESSAGE SIGN	CAL DA	28	28		
70300100	SHORT TERM PAVEMENT MARKING	FOOT	8170	8170		
70300150	SHORT TERM PAVEMENT MARKING REMOVAL	SQ FT	1950	1950		
* 78000100	THERMOPLASTIC PAVEMENT MARKING - LETTERS AND SYMBOLS	SQ FT	770	770		
* 78000200	THERMOPLASTIC PAVEMENT MARKING - LINE 4"	FOOT	11540	11540		
* 78000400	THERMOPLASTIC PAVEMENT MARKING - LINE 6"	FOOT	510	510		
* 78000600	THERMOPLASTIC PAVEMENT MARKING - LINE 12"	FOOT	220	220		
* 78011000	GROOVING FOR RECESSED PAVEMENT MARKING, LETTERS AND SYMBOLS	SQ FT	770	770		
* 78011025	GROOVING FOR RECESSED PAVEMENT MARKING 5"	FOOT	11540	11540		
* 78011035	GROOVING FOR RECESSED PAVEMENT MARKING 7"	FOOT	510	510		

*SPECIALTY ITEM

REV. - MS

MODEL: Default
 FILE: M:\MS_E_Plan\pilot-cw-bentley.com\PROJECTS\74980\CADD\DATA\CAD\Sheets\DOT\74980-RS-SC00.dgn

USER NAME = jessica.hille	DESIGNED - LMH	REVISED -
	DRAWN - LMH	REVISED -
PLOT SCALE = 100.0000' / in.	CHECKED -	REVISED -
PLOT DATE = 12/5/2023	DATE - 12/5/2023	REVISED -

**STATE OF ILLINOIS
DEPARTMENT OF TRANSPORTATION**

SUMMARY OF QUANTITIES

SCALE: NO SCALE SHEET OF SHEETS STA. TO STA.

F.A.P. RTE.	SECTION	COUNTY	TOTAL SHEETS	SHEET NO.
781	(12.17Z)RS-2	CRAWFORD	19	3
CONTRACT NO. 74980				
ILLINOIS FED. AID PROJECT				

URBAN

SUMMARY OF QUANTITIES			TOTAL QUANTITIES	CONSTRUCTION TYPE CODE		
CODE NO	ITEM	UNIT		0005 80% FEDERAL 20% STATE		
* 78011065	GROOVING FOR RECESSED PAVEMENT MARKING 13"	FOOT	220	220		
* 78100100	RAISED REFLECTIVE PAVEMENT MARKER	EACH	233	233		
78300200	RAISED REFLECTIVE PAVEMENT MARKER REMOVAL	EACH	233	233		
X4060995	TEMPORARY RAMP (SPECIAL)	SQ YD	549	549		
X6026627	VAULTS TO BE REMOVED	EACH	1	1		
Z0049799	PROTECTING OR RESETTING SURVEY MARKERS	EACH	2	2		

SUMMARY OF QUANTITIES			TOTAL QUANTITIES	CONSTRUCTION TYPE CODE		
CODE NO	ITEM	UNIT		0005 80% FEDERAL 20% STATE		

*SPECIALTY ITEM

REV. - MS

MODEL: Default
FILE: Main.ctb
PLOT: plot.ctb
CADD: C:\Users\jessica.hille\AppData\Local\Temp\1215202315135811\1215202315135811.ctb
PROJECT: 74980\CADD\Drawings\DOT Office\District 7\Projects\74980\CADD\Drawings\DOT Office\District 7\Projects\74980.ctb\SC00.dgn

USER NAME = jessica.hille	DESIGNED - LMH	REVISED -
DRAWN - LMH	CHECKED -	REVISED -
PLOT SCALE = 100.0000' / in.	DATE - 12/5/2023	REVISED -
PLOT DATE = 12/5/2023		

STATE OF ILLINOIS
DEPARTMENT OF TRANSPORTATION

SUMMARY OF QUANTITIES			
SCALE: NO SCALE	SHEET	OF SHEETS	STA. TO STA.

F.A.P. RTE.	SECTION	COUNTY	TOTAL SHEETS	SHEET NO.
781	(12.17Z)RS-2	CRAWFORD	19	4
CONTRACT NO. 74980				
ILLINOIS FED. AID PROJECT				

EXISTING TYPICAL CROSS SECTIONS (ILL 33)

STATION 1140+78 TO STATION 1183+95

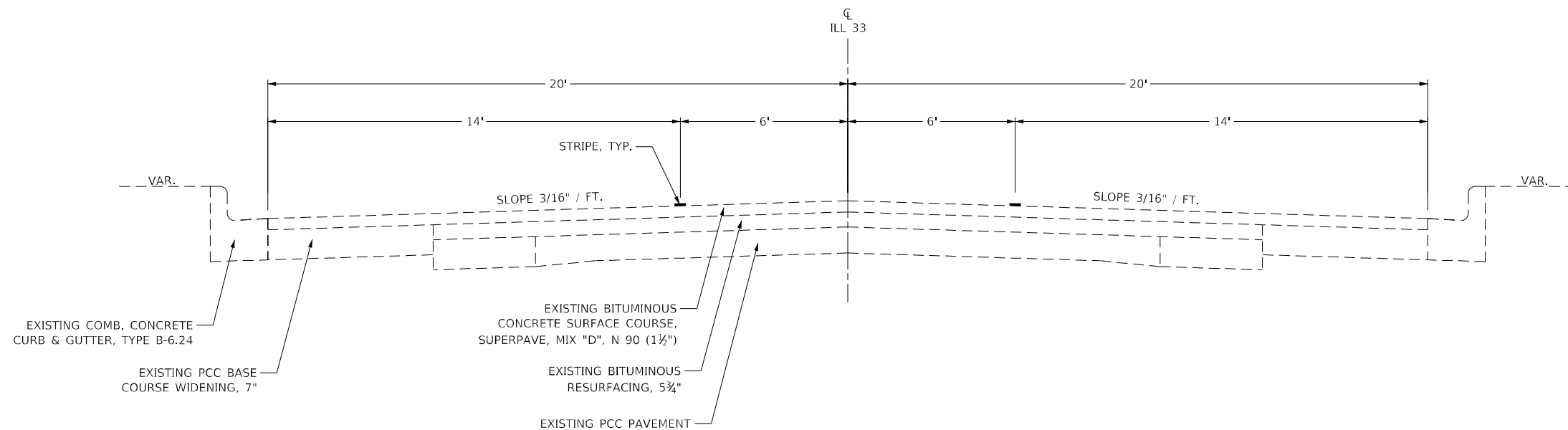

PROPOSED TYPICAL CROSS SECTIONS (ILL 33)

STATION 1140+78 TO STATION 1183+95

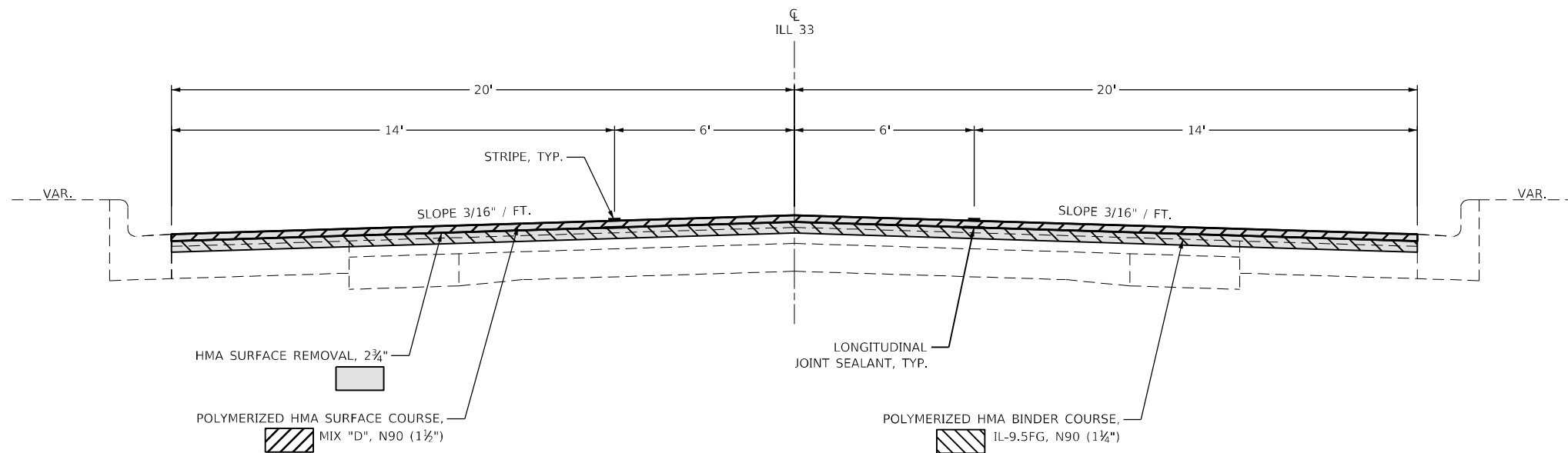

MODEL: Default
 FILE: \\mllc-pw-bentley.com\P\DOT\Documents\DOT Office\Director_7\Projects\74980\CADD\Drawings\CAD\Sheets\0774980\p1-typical.dgn

USER NAME = jessica.hille	DESIGNED - LMH	REVISED -
	DRAWN - LMH	REVISED -
PLOT SCALE = 100,0000' / in.	CHECKED -	REVISED -
PLOT DATE = 12/5/2023	DATE - 12/5/2023	REVISED -

STATE OF ILLINOIS
DEPARTMENT OF TRANSPORTATION

TYPICAL SECTIONS

SCALE: NO SCALE SHEET 1 OF 1 SHEETS STA. TO STA.

F.A.P. RTE.	SECTION	COUNTY	TOTAL SHEETS	SHEET NO.
781	(1Z,17Z)RS-2	CRAWFORD	19	5
CONTRACT NO. 74980				
ILLINOIS FED. AID PROJECT				

PAVING SCHEDULE									
STATION TO STATION	POUND	FOOT	SQ YD	TON	TON	SQ YD	EACH	EACH	
1140+78.0 TO 1143+06.0	601.2	228.0	150.0	62.3	74.8	890.7	14	14	
1143+06.0 TO 1153+00.0	2993.1	1988.0	-	310.4	372.5	4434.3	50	50	
1153+00.0 TO 1156+50.0	1264.8	1050.0	-	131.2	157.4	1873.8	18	18	
1156+50.0 TO 1166+36.0	2988.5	1972.0	-	309.9	371.9	4427.3	49	49	
1166+36.0 TO 1173+15.0	2427.9	2037.0	-	251.8	302.1	3596.9	38	38	
1173+15.0 TO 1176+72.0	1555.4	1428.0	-	161.3	193.6	2304.3	28	28	
1176+72.0 TO 1183+27.0	2364.1	1965.0	-	245.2	294.2	3502.4	33	33	
1183+27.0 TO 1183+95.0	184.7	136.0	200.0	19.2	23.0	273.6	3	3	
TOTALS:	14380	10810	350	1500	1790	21310	233	233	

PAVEMENT MARKING SCHEDULE											
STATION TO STATION	FOOT	SQ FT	SQ FT	SQ FT	FOOT	FOOT	FOOT	FOOT	FOOT	FOOT	FOOT
1140+78.0 TO 1143+06.0	171	38	-	-	912	912	-	-	107	107	
1143+06.0 TO 1153+00.0	1521	351	124.8	124.8	2485	2485	-	-	-	-	
1153+00.0 TO 1156+50.0	871	213	93.6	93.6	875	875	100	100	-	-	
1156+50.0 TO 1166+36.0	1540	369	156.0	156.0	2465	2465	-	-	-	-	
1166+36.0 TO 1173+15.0	1931	456	135.1	135.1	1912	1912	157	157	113	113	
1173+15.0 TO 1176+72.0	953	218	135.1	135.1	915	915	165	165	-	-	
1176+72.0 TO 1183+27.0	1074	278	124.8	124.8	1801	1801	81	81	-	-	
1183+27.0 TO 1183+95.0	102	23	-	-	170	170	-	-	-	-	
TOTALS:	8170	1950	770	770	11540	11540	510	510	220	220	

PATCHING SCHEDULE				
PATCH NUMBER	LANE	STATION	TYPE I	TYPE II
			SQ YD	SQ YD
1	EB	0+00	-	6.7
2	EB	0+19	-	9.0
3	EB	0+47	-	6.0
4	EB	1+05	-	7.2
5	EB	1+38	-	5.8
6	EB	1+73	-	5.8
7	EB	7+08	-	5.8
8	EB	11+19	-	5.8
9	EB	14+84	-	7.2
10	EB	16+63	-	7.2
11	EB	16+87	-	7.2
12	EB	19+12	-	10.0
13	EB	35+87	-	5.8
14	EB	42+50	-	5.8
15	WB	0+00	-	14.4
16	WB	6+47	-	5.8
17	WB	11+00	-	11.6
18	WB	11+72	-	5.8
19	WB	12+87	4.4	-
20	WB	23+02	4.4	-
21	WB	25+12	-	5.8
22	WB	28+73	-	5.8
23	WB	40+82	-	6.2
24	WB	41+48	-	5.8
25	WB	41+73	-	5.8
26	WB	42+25	-	14.4
TOTAL:			10	180

ENTRANCE SCHEDULE					
SIDE	STATION	TYPE	DESCRIPTION	WIDTH	X4060995 TEMPORARY RAMP, SPECIAL
LT	1141+02.0	PE		25	5.6
LT	1141+97.0	FE		25	5.6
RT	1142+28.0	FE		25	5.6
RT	1143+46.0	CE	CRAWFORD AUTO CENTER	30	6.7
LT	1144+58.0	PE		60	13.3
RT	1145+27.0	PE		25	5.6
RT	1147+15.0	PC		25	5.6
RT	1148+38.0	PE		25	5.6
LT	1148+41.0	CE	EAGLE THEATER	25	5.6
RT	1150+17.0	CE	FIRST NATIONAL BANK	50	11.1
LT	1150+24.0	CE		55	12.2
LT	1150+94.0	CE		55	12.2
RT	1151+32.0	CE	FIRST NATIONAL BANK	55	12.2
LT	1151+79.0	CE	SUBWAY	55	12.2
RT	1151+91.0	CE	COUNTRY VIEW INN & SUITES	50	11.1
LT	1153+21.0	CE	BEST ONE TIRE & SERVICE	55	12.2
RT	1153+55.0	PE		25	5.6
RT	1154+07.0	CE	5 GUYS WINE & SPIRITS	50	11.1
RT	1154+87.0	CE	MONICALS	50	11.1
RT	1156+53.0	PRA	S WHITE ST	70	15.6
LT	1156+57.0	CE	CASEY STATE BANK	50	11.1
LT	1157+29.0	CE	CASEY STATE BANK	55	12.2
RT	1157+44.0	CE	KEMPER CPA GROUP	50	11.1
LT	1157+79.0	PE		25	5.6
RT	1158+57.0	PE		30	6.7
LT	1159+16.0	PE		25	5.6
LT	1159+76.0	PC		25	5.6
RT	1159+84.0	CE	GAB EXHAUST	25	5.6
RT	1160+57.0	CE	JO DAWN MOTEL	40	8.9

ENTRANCE SCHEDULE CONTINUED					
SIDE	STATION	TYPE	DESCRIPTION	WIDTH	X4060995 TEMPORARY RAMP, SPECIAL
LT	1161+10.0	PE		25	5.6
RT	1161+18.0	PE		25	5.6
RT	1162+17.0	CE	CASEY'S GENERAL STORE	55	12.2
RT	1163+41.0	PRA	DORSEY RD	60	13.3
LT	1163+41.0	PRA	DORSEY RD	60	13.3
RT	1164+67.0	FE		25	5.6
LT	1164+09.0	CC	BIOLOGIC DENTAL LAB	35	7.0
RT	1165+01.0	PE		25	5.6
RT	1165+72.0	PE		25	5.6
LT	1166+19.0	PRA	SUNSET BLVD	65	14.4
RT	1166+35.0	PE		25	5.6
RT	1167+35.0	CE	HERSHEY	50	11.1
LT	1168+02.0	CE	BAYMONT HOTEL	55	12.2
RT	1169+87.0	CE	HERSHEY	50	11.1
LT	1170+78.0	PRA	CHRISTOPHER BLVD	70	15.6
LT	1173+06.0	CE	MCDONALDS	45	10.0
LT	1174+02.0	CE	MCDONALDS	45	10.0
RT	1176+25.0	PRA	HEATH TOFFEE AVE	75	16.7
LT	1176+48.0	PRA	HEATH TOFFEE AVE	55	12.2
LT	1178+02.0	CE	DIRTBUSTER CARWASH	48	10.7
LT	1179+16.0	CE	ARBY'S	55	12.2
LT	1179+93.0	CE	ARBY'S	55	12.2
RT	1180+37.0	PRA	ADAMS ST	60	13.3
LT	1181+24.0	PE		50	11.1
RT	1182+17.0	PRA	S ROOSEVELT AVE	60	13.3
RT	1183+27.0	PE		25	5.6
LT	1183+62.0	PRA	N PARK FOREST DR	60	13.3
RT	1183+75.0	PE		25	5.6
TOTALS:				549	

PERMANENT SURVEY MARKERS							66700205 PERMANENT SURVEY MARKERS, TYPE I	X5026627 VAULTS TO BE REMOVED	Z0049799 PROTECTING OR RESETTING SURVEY MARKERS
POINT	NORTHING	EASTING	DESCRIPTION	STATION	O/S	PROPOSED PROTECT OR RESET	EACH	EACH	EACH
1038	852231.744	1148015.181	PI BRASS DISK	1167+00	0.0'	TYPE I - DISK FLUSH	-	-	1
1039	852254.439	1149114.836	PI BRASS DISK	1178+00	0.0'	TYPE I - DISK FLUSH	-	-	1
1040	852218.052	1147641.615	ALUM DISK IN ALUM VAULT BURIED +/-12" MR BK1 PG 67	1163+26	5.5' RT.	REMOVE EXISTING VAULT AND INSTALL TYPE I - DISK FLUSH*	1	1	-
TOTALS:							1	1	2

* NEW MONUMENT RECORD REQUIRED

Model: Default
 File: Model - Paved - 11/19/2024
 Project: 174880-CADD-Data-CAD-Block-074880-etc - sheet.dwg

USER NAME = Default	DESIGNED - LMH	REVISED -
DRAWN - LMH	REVISIONS -	
PLOT SCALE = 100.0000' / in.	CHECKED -	REVISED -
PLOT DATE = 1/19/2024	DATE - 1/19/2024	REVISED -

**STATE OF ILLINOIS
DEPARTMENT OF TRANSPORTATION**

SCHEDULE OF QUANTITIES

SCALE: NO SCALE SHEET 1 OF 1 SHEETS STA. TO STA.

F.A.P. RTE.	SECTION	COUNTY	TOTAL SHEETS	SHEET NO.
781	(12,172)RS-2	CRAWFORD	19	6
ILLINOIS FED. AID PROJECT			CONTRACT NO. 74980	

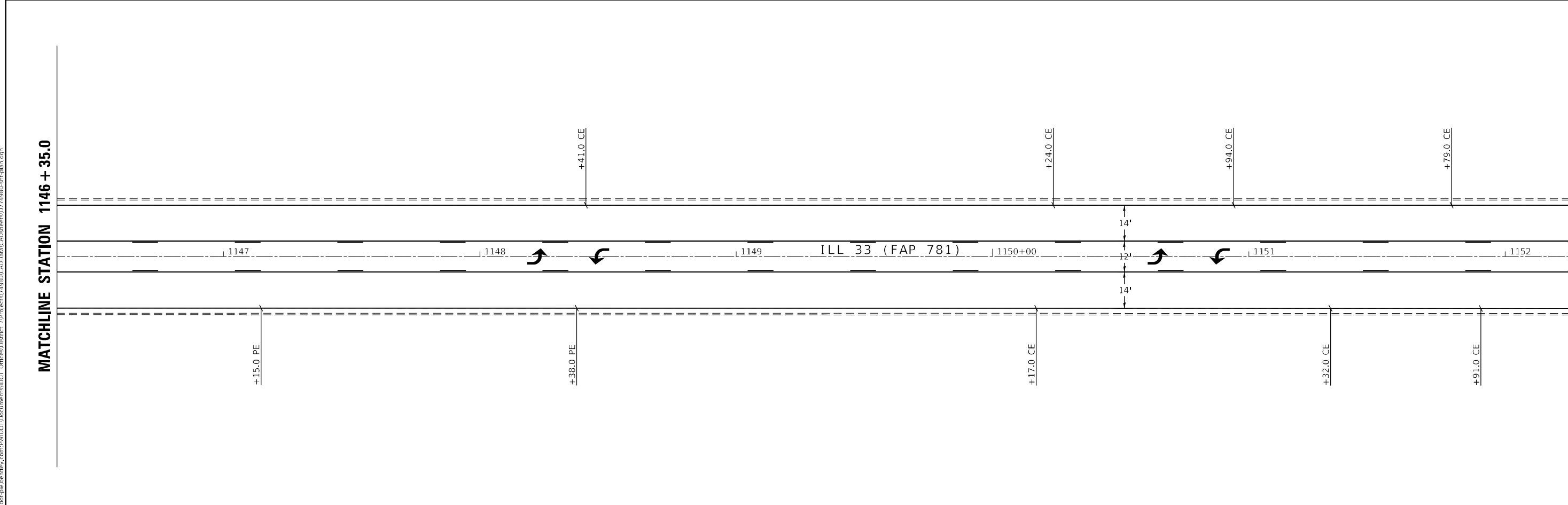
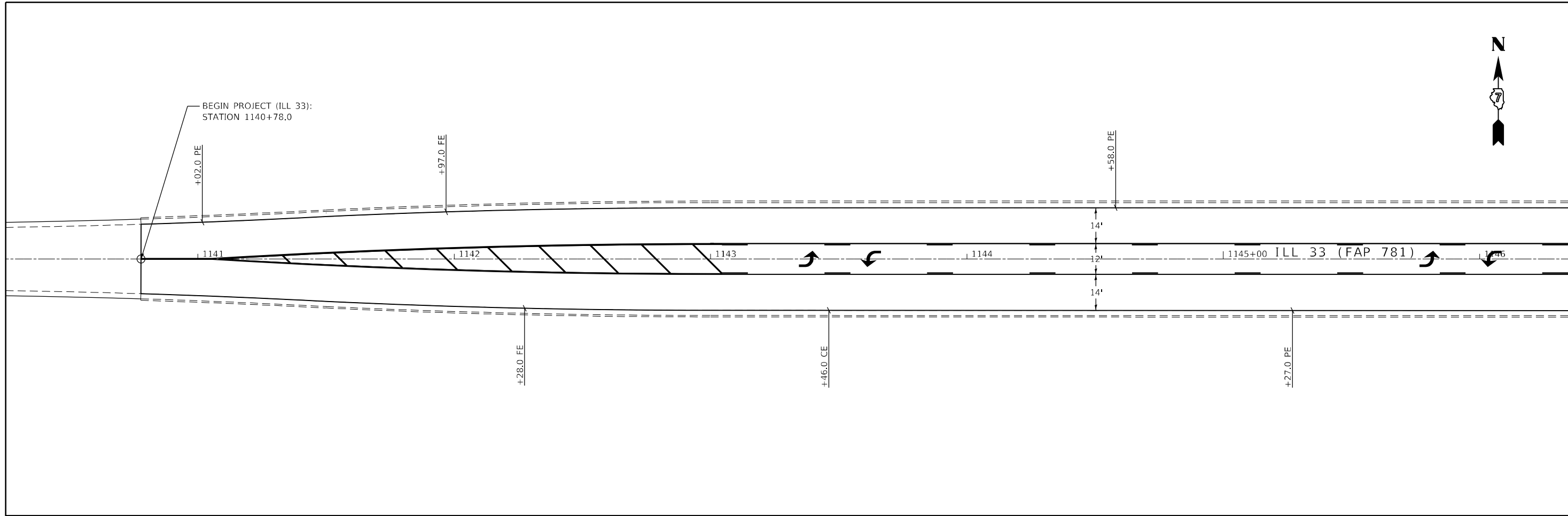

MODEL: Default
 FILE: Mainfile.pia\subject-cw-beadley.com\PIV\DOT\Documents\DOT Office\District 7\Projects\74980\CADD\Drawings\CAD\Sheets\74980-pts-dba.dwg

USER NAME = jessica.wille	DESIGNED - LMH	REVISED -
DRAWN - LMH	REVISIONS -	
PLOT SCALE = 40,0000 * / in.	CHECKED -	REVISED -
PLOT DATE = 12/5/2023	DATE - 12/5/2023	REVISED -

STATE OF ILLINOIS
DEPARTMENT OF TRANSPORTATION

PLAN SHEET
 SCALE: 40,0000 * / in. SHEET 1 OF 4 SHEETS STA. 1140+78 TO STA. 1152+25

F.A.P. RTE.	SECTION	COUNTY	TOTAL SHEETS	SHEET NO.
781	(1Z,17Z)RS-2	CRAWFORD	19	7
CONTRACT NO. 74980				
ILLINOIS FED. AID PROJECT				

MODEL: Default
 FILE: Mainfile_pdw\subject-cw-beadley.com\PIV\DOT\Documents\DOT_offices\Director_7\Projects\74980\CADD\Drawings\CADDsheets\0774980-pts-dba.dwg

MATCHLINE STATION 1152 + 25.0

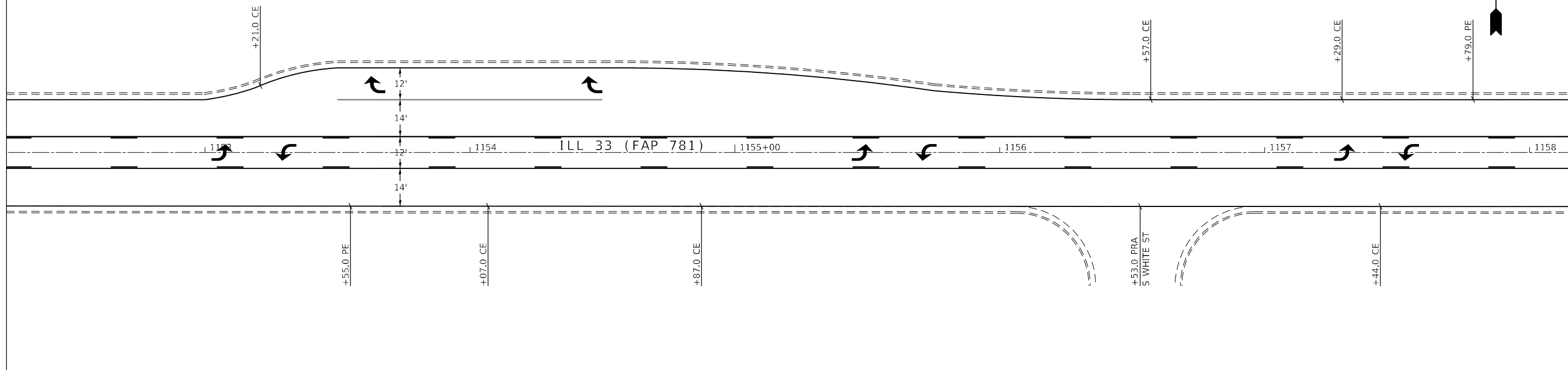

MATCHLINE STATION 1158 + 15.0

MATCHLINE STATION 1158 + 15.0

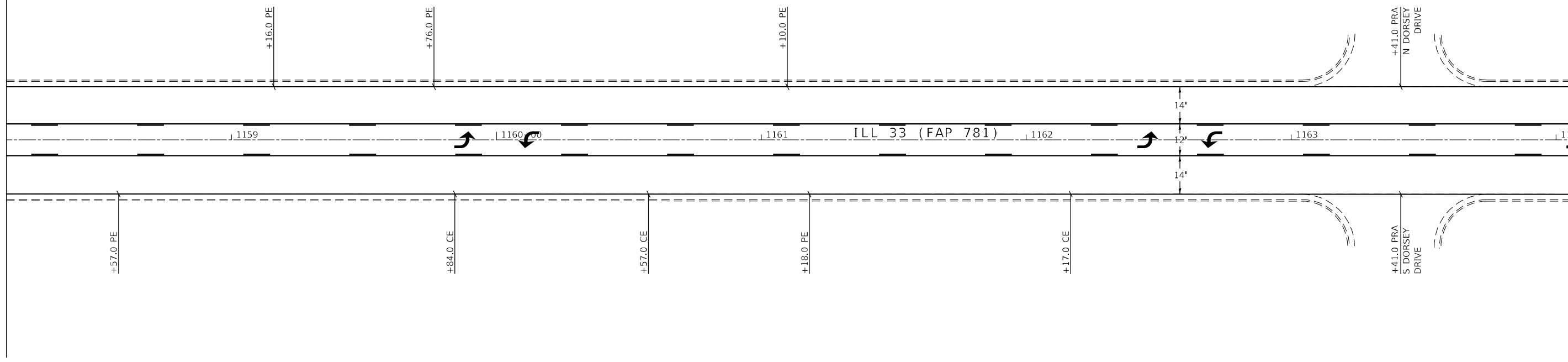

MATCHLINE STATION 1164 + 05.0

USER NAME = jessica.hille	DESIGNED - LMH	REVISED -
DRAWN - LMH	REVISIONS -	
PLOT SCALE = 40,0000 ' / in.	CHECKED -	REVISED -
PLOT DATE = 12/5/2023	DATE - 12/5/2023	REVISED -

**STATE OF ILLINOIS
 DEPARTMENT OF TRANSPORTATION**

PLAN SHEET

SCALE: 40,0000 ' / in. SHEET 2 OF 4 SHEETS STA. 1152+25 TO STA. 1164+05

F.A.P. RTE.	SECTION	COUNTY	TOTAL SHEETS	SHEET NO.
781	(1Z,17Z)RS-2	CRAWFORD	19	8
CONTRACT NO. 74980				
ILLINOIS FED. AID PROJECT				



MATCHLINE STATION 1164 + 05.0

MATCHLINE STATION 1169 + 95.0

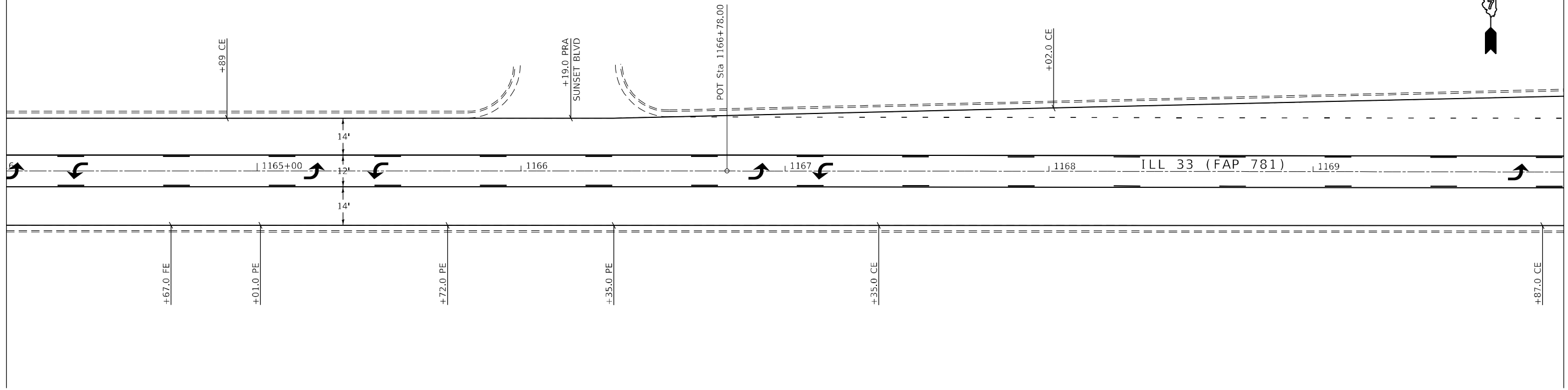

MATCHLINE STATION 1169 + 95.0

MATCHLINE STATION 1175 + 85.0

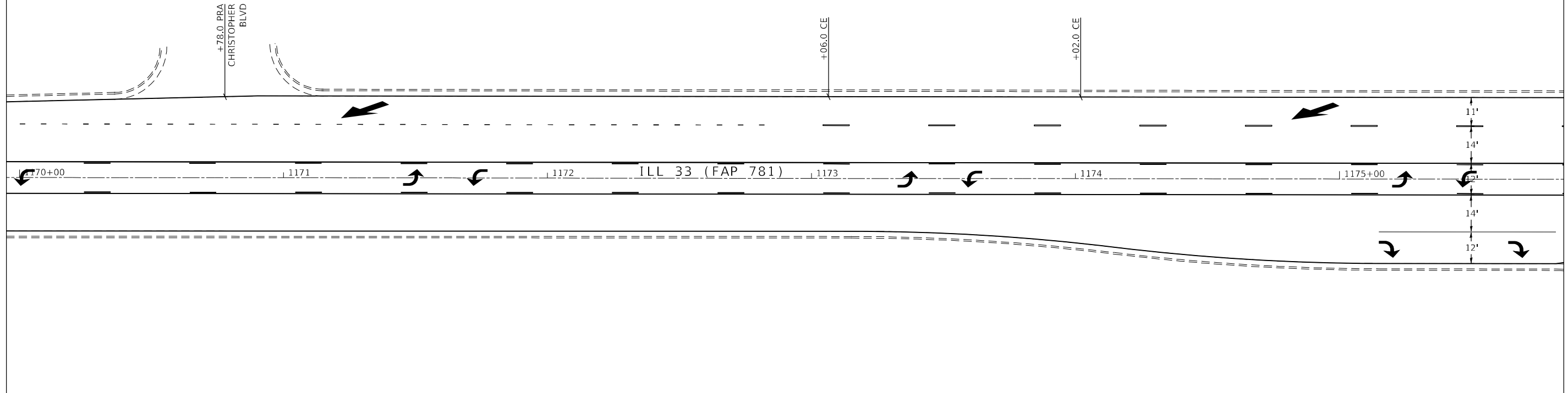

MODEL: Default
FILE: h:\m\p\p\subject-cw-beadley.com\PIV\DOT\Documents\DOT Office\Dir\refr_7\Project\74980\CADD\Drawn\CAD\sheet\074980-1164.dwg

USER NAME = jessica.hille	DESIGNED - LMH	REVISED -
	DRAWN - LMH	REVISED -
PLOT SCALE = 40,0000 * / in.	CHECKED -	REVISED -
PLOT DATE = 12/5/2023	DATE - 12/5/2023	REVISED -

**STATE OF ILLINOIS
DEPARTMENT OF TRANSPORTATION**

PLAN SHEET

SCALE: 40,0000 * / in. SHEET 3 OF 4 SHEETS STA. 1164+05 TO STA. 1175+85

F.A.P. RTE.	SECTION	COUNTY	TOTAL SHEETS	SHEET NO.
781	(1Z,17Z)RS-2	CRAWFORD	19	9
CONTRACT NO. 74980				
ILLINOIS FED. AID PROJECT				



MATCHLINE STATION 1175 + 85.0

MATCHLINE STATION 1181 + 75.0

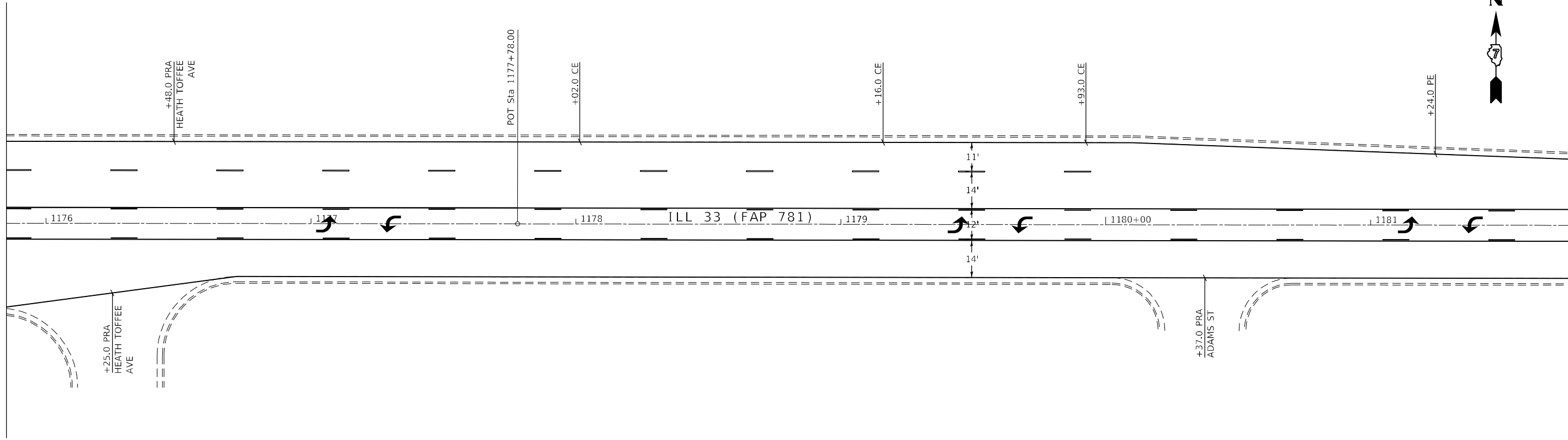

MATCHLINE STATION 1181 + 75.0

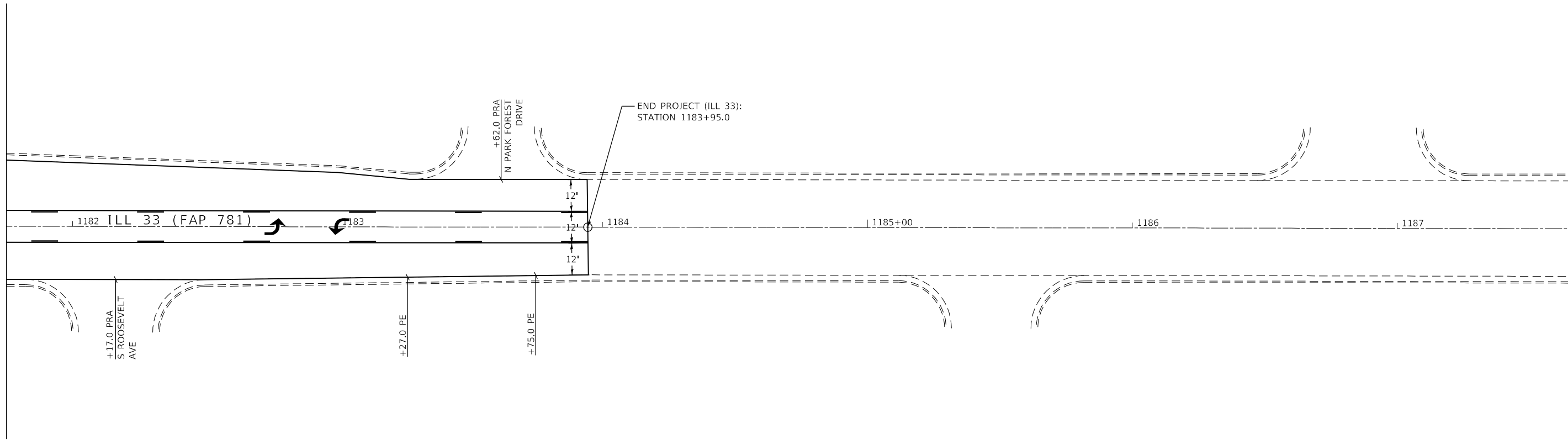

MODEL: Default
 FILE: \\na11c-pw-bentley.com\P\INDOT\Documents\DOT Office\Dir\dr_7\Project\74980\CADD\Drawings\Drawings\74980-1181.dwg

USER NAME = jessica.hille	DESIGNED - LMH	REVISED -
DRAWN - LMH	REVISIONS -	
PLOT SCALE = 40,0000 * / in.	CHECKED -	REVISED -
PLOT DATE = 12/5/2023	DATE - 12/5/2023	REVISED -

**STATE OF ILLINOIS
DEPARTMENT OF TRANSPORTATION**

PLAN SHEET

SCALE: 40,0000 * / in. SHEET 4 OF 4 SHEETS STA. 1175+85 TO STA. 1183+95

F.A.P. RTE.	SECTION	COUNTY	TOTAL SHEETS	SHEET NO.
781	(1Z,17Z)RS-2	CRAWFORD	19	10
CONTRACT NO. 74980				
ILLINOIS FED. AID PROJECT				

PAVEMENT MARKING LEGEND

- 1 4" (100) SKIP-DASH (YELLOW) 10' (3.05 m) 30' (9.15 m) 10' (3.05 m)
- 2 4" (100) SOLID (YELLOW)
- 3 12" (300) DIAGONAL (YELLOW) 45° 12" (300)
- 4 4" (100) DOUBLE YELLOW (NARROW) TRAFFIC → ← TRAFFIC
- 5 6" (300) SOLID WHITE 4" (100)
- 6 6" (100) SKIP-DASH (WHITE) 8" (200) CTS.
- 7 6" (100) DOTTED LINE (WHITE) 3' 9' 3'

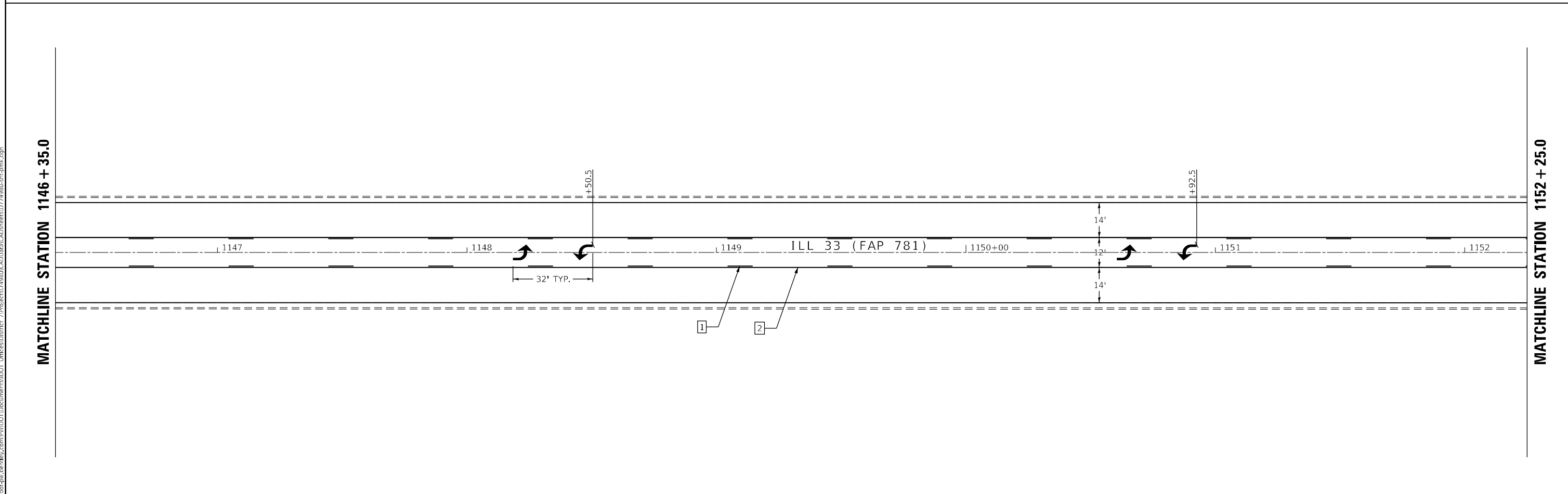
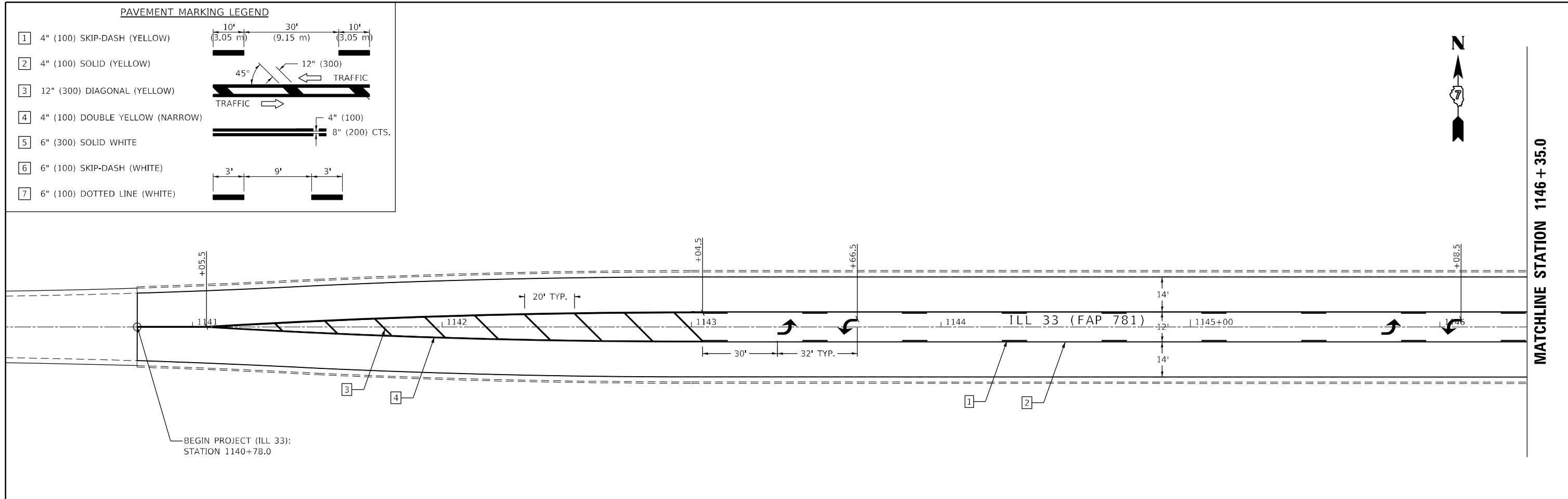

MODEL: Default
 FILE: \\marietta\paw\ludect-cw-beadefy.com\FW\DOT\Documents\DOT Office\Director_7\Project\74980\CADD\Drawings\CAD\Sheets\74980-117-pmk.dgn

USER NAME = jessica.ville	DESIGNED - LMH	REVISED -
DRAWN - LMH	REVISIONS -	
PLOT SCALE = 40,0000 * / in.	CHECKED -	REVISIONS -
PLOT DATE = 12/5/2023	DATE - 12/5/2023	REVISIONS -

**STATE OF ILLINOIS
DEPARTMENT OF TRANSPORTATION**

PAVEMENT MARKING SHEET

SCALE: 40,0000 * / in. SHEET 1 OF 4 SHEETS STA. 1140+78 TO STA. 1152+25

F.A.P. RTE.	SECTION	COUNTY	TOTAL SHEETS	SHEET NO.
781	(1Z,17Z)RS-2	CRAWFORD	19	11
CONTRACT NO. 74980				
ILLINOIS FED. AID PROJECT				



MATCHLINE STATION 1152 + 25.0

MATCHLINE STATION 1158 + 15.0

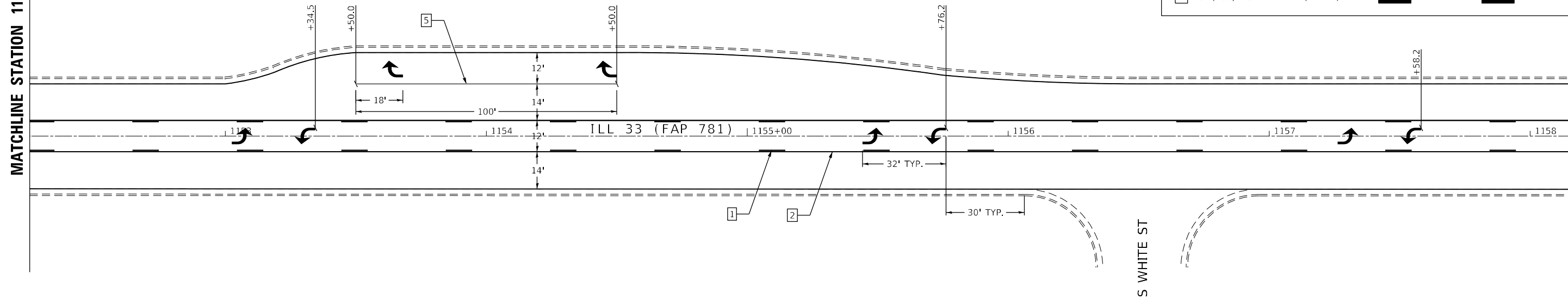

MATCHLINE STATION 1158 + 15.0

MATCHLINE STATION 1164 + 05.0

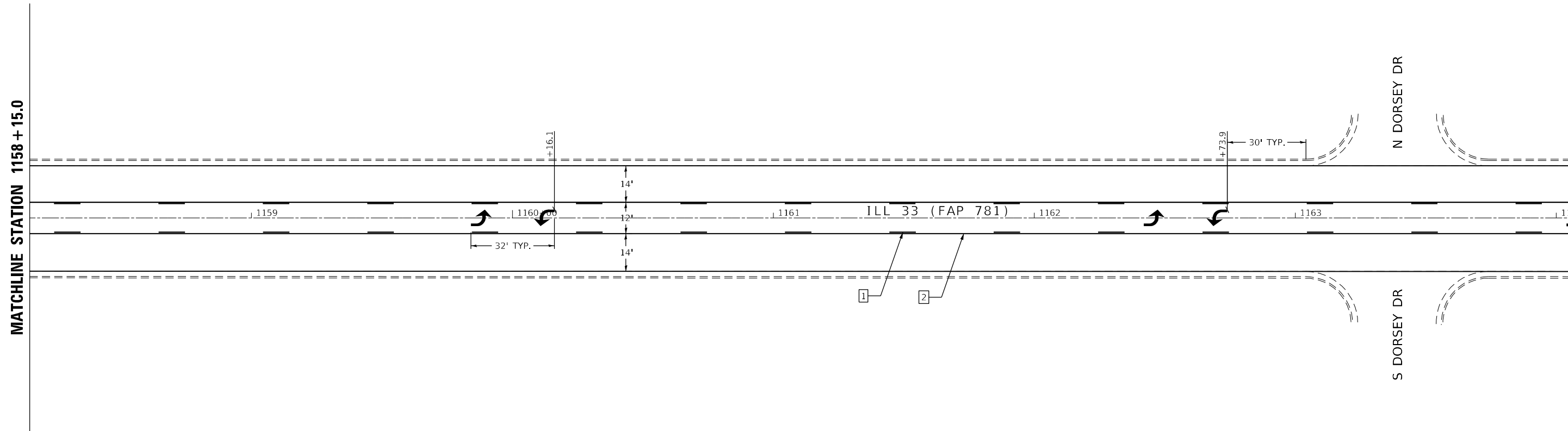

PAVEMENT MARKING LEGEND	
1	4" (100) SKIP-DASH (YELLOW)
2	4" (100) SOLID (YELLOW)
3	12" (300) DIAGONAL (YELLOW)
4	4" (100) DOUBLE YELLOW (NARROW)
5	6" (300) SOLID WHITE
6	6" (100) SKIP-DASH (WHITE)
7	6" (100) DOTTED LINE (WHITE)

MODEL: Default
 FILE: \\mupc-pw-bentley.com\PW\DOT\Documents\DOT Office\Director_T\Projects\74980\CADD\Drawings\CAD\Sheets\74980-PT-pmk.dgn

USER NAME = jessica.hille	DESIGNED - LMH	REVISED -
DRAWN - LMH	REVISOR -	
PLOT SCALE = 40,0000 * / in.	CHECKED -	REVISOR -
PLOT DATE = 12/5/2023	DATE - 12/5/2023	REVISOR -

**STATE OF ILLINOIS
DEPARTMENT OF TRANSPORTATION**

PAVEMENT MARKING SHEET

SCALE: 40,0000 * / in. SHEET 2 OF 4 SHEETS STA. 1152+25 TO STA. 1164+05

F.A.P. RTE.	SECTION	COUNTY	TOTAL SHEETS	SHEET NO.
781	(12,17Z)RS-2	CRAWFORD	19	12
CONTRACT NO. 74980				
ILLINOIS FED. AID PROJECT				

PAVEMENT MARKING LEGEND

- 1 4" (100) SKIP-DASH (YELLOW)
- 2 4" (100) SOLID (YELLOW)
- 3 12" (300) DIAGONAL (YELLOW)
- 4 4" (100) DOUBLE YELLOW (NARROW)
- 5 6" (300) SOLID WHITE
- 6 6" (100) SKIP-DASH (WHITE)
- 7 6" (100) DOTTED LINE (WHITE)

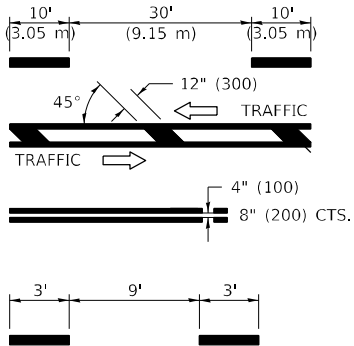

MATCHLINE STATION 1164 + 05.0

MATCHLINE STATION 1169 + 95.0

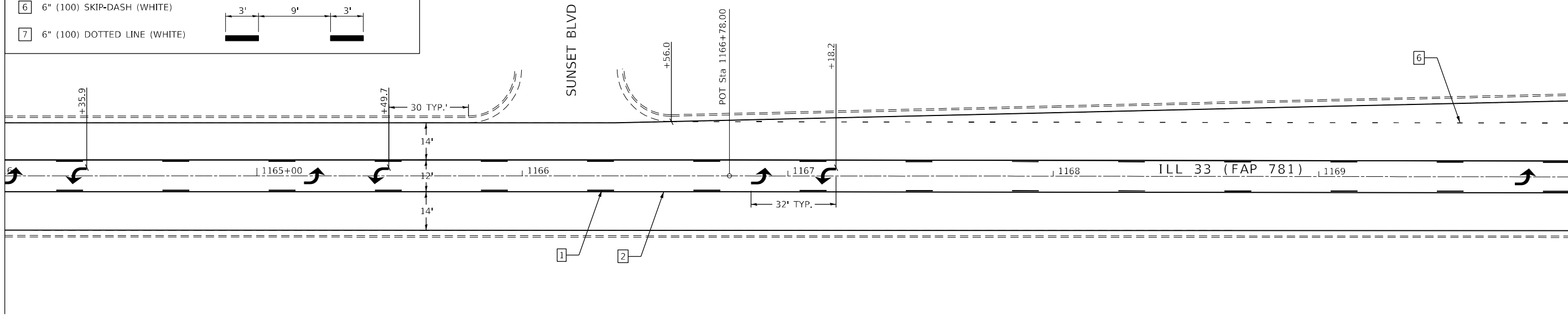

MATCHLINE STATION 1169 + 95.0

MATCHLINE STATION 1175 + 85.0

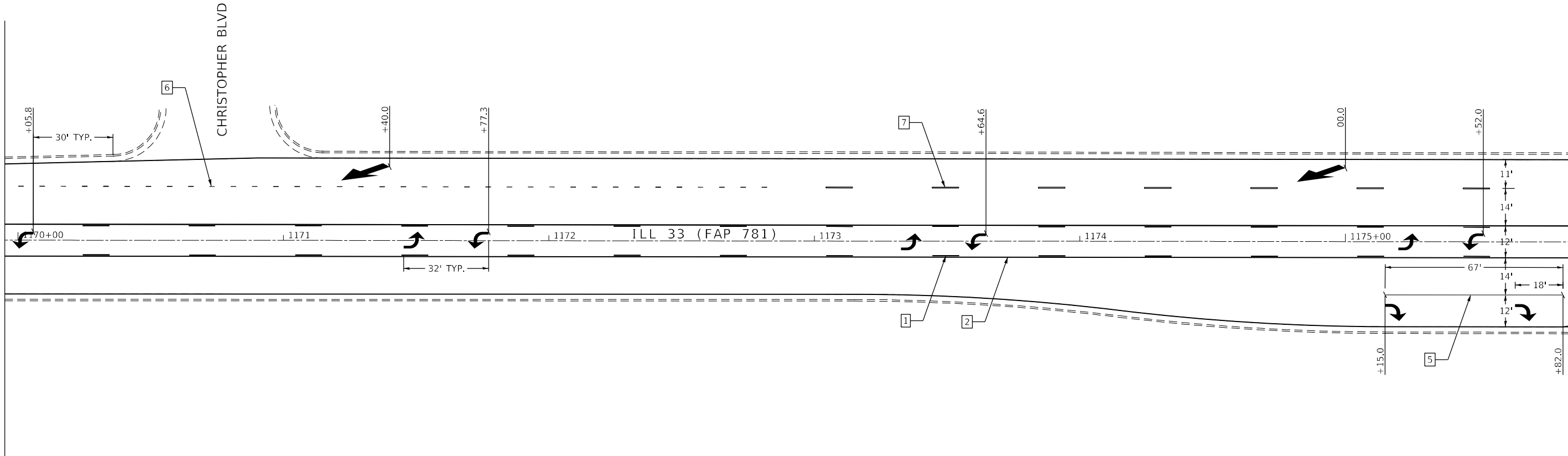

MODEL: Default
 FILE: Mainfile: p:\project-aw-beadefy.com\FW\DOT\Documents\DOT Office\Director: 7\Project\74980\CADD\Drawings\CAD\Drawings\74980-18-pmk.dgn

USER NAME = jessica.hille	DESIGNED - LMH	REVISED -
DRAWN - LMH	REVISIONS -	
PLOT SCALE = 40,0000 * / in.	CHECKED -	REVISED -
PLOT DATE = 12/5/2023	DATE - 12/5/2023	REVISED -

STATE OF ILLINOIS
DEPARTMENT OF TRANSPORTATION

PAVEMENT MARKING SHEET

SCALE: 40,0000 * / in. SHEET 3 OF 4 SHEETS STA. 1164+05 TO STA. 1175+85

F.A.P. RTE.	SECTION	COUNTY	TOTAL SHEETS	SHEET NO.
781	(1Z,17Z)RS-2	CRAWFORD	19	13
CONTRACT NO. 74980				
ILLINOIS FED. AID PROJECT				



PAVEMENT MARKING LEGEND	
1	4" (100) SKIP-DASH (YELLOW)
2	4" (100) SOLID (YELLOW)
3	12" (300) DIAGONAL (YELLOW)
4	4" (100) DOUBLE YELLOW (NARROW)
5	6" (300) SOLID WHITE
6	6" (100) SKIP-DASH (WHITE)
7	6" (100) DOTTED LINE (WHITE)

MATCHLINE STATION 1175 + 85.0

MATCHLINE STATION 1181 + 75.0

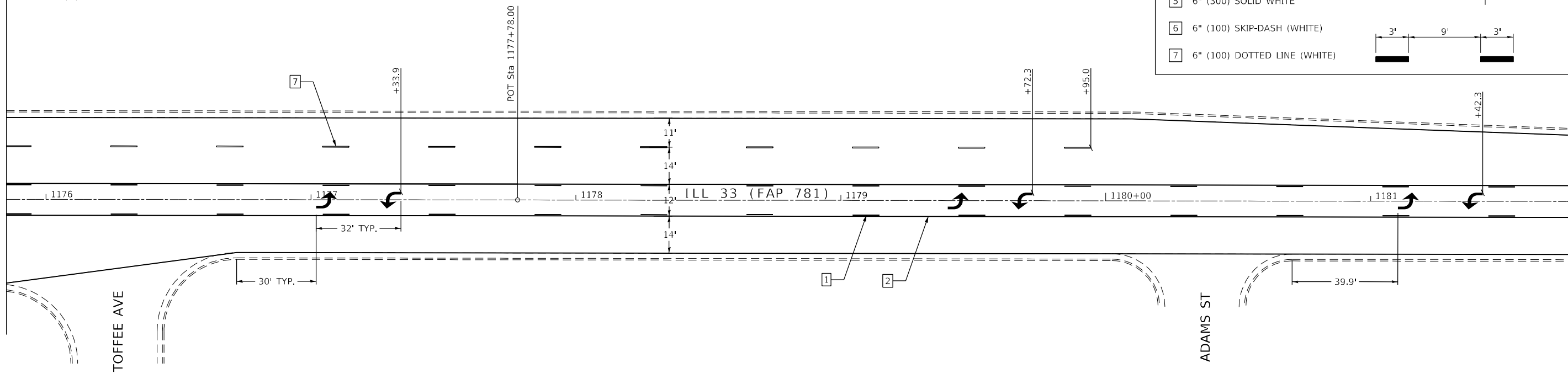

MATCHLINE STATION 1181 + 75.0

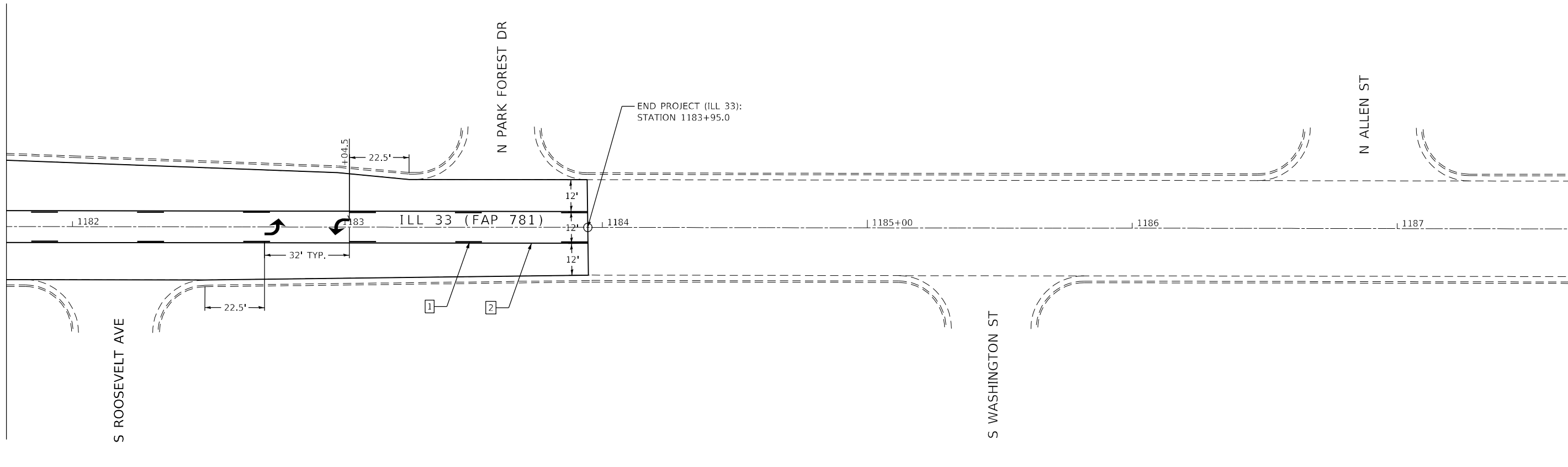

MODEL: Default
 FILE: \\mupc-pub\ultra-cw-bead\p\com\p\INDOT\Documents\DOT Office\Drawings\74980\Drawings\74980-PMK.dgn

USER NAME = jessica.hille	DESIGNED - LMH	REVISED -
DRAWN - LMH	REVISIONS -	
PLOT SCALE = 40,0000 * / in.	CHECKED -	REVISED -
PLOT DATE = 12/5/2023	DATE - 12/5/2023	REVISED -

**STATE OF ILLINOIS
DEPARTMENT OF TRANSPORTATION**

PAVEMENT MARKING SHEET

SCALE: 40,0000 * / in. SHEET 4 OF 4 SHEETS STA. 1175+85 TO STA. 1183+95

F.A.P. RTE.	SECTION	COUNTY	TOTAL SHEETS	SHEET NO.
781	(1Z,17Z)RS-2	CRAWFORD	19	14
CONTRACT NO. 74980				
ILLINOIS FED. AID PROJECT				

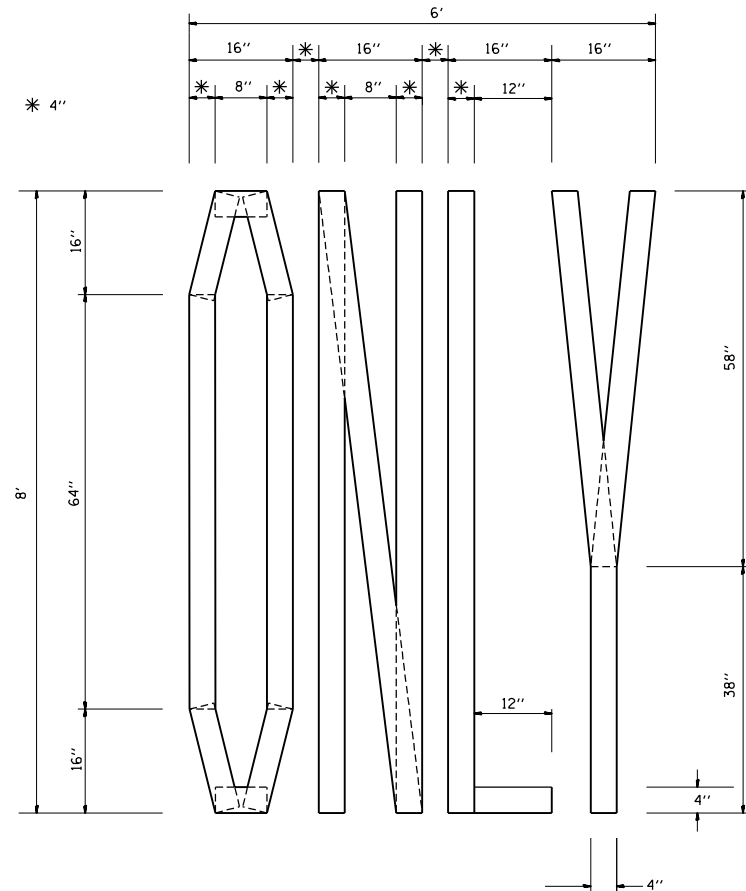

QUANTITY
4" LINE = 63.2 ft.
21.0 sq. ft.

SHORT TERM STOP BAR

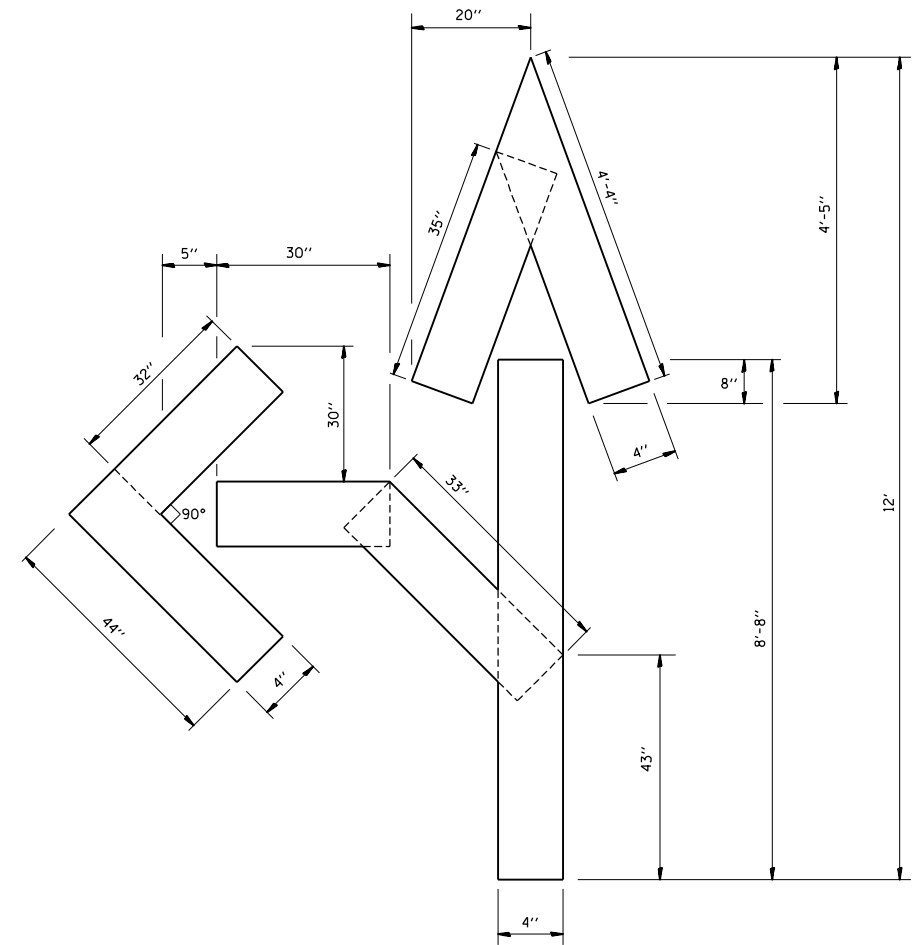
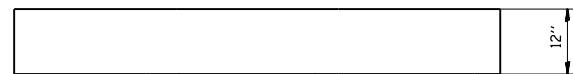

QUANTITY
4" LINE = 27.5 ft.
9.2 sq. ft.

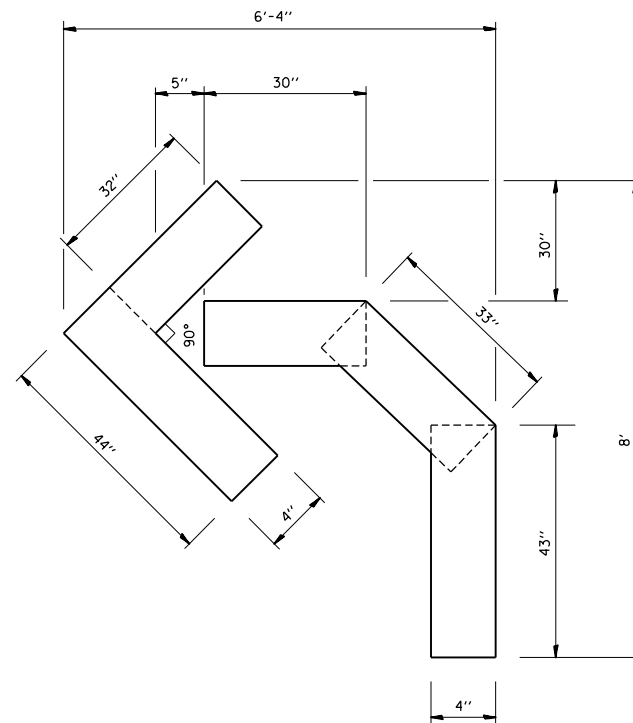

QUANTITY
4" LINE = 15.2 ft.
5.0 sq. ft.

STATE OF ILLINOIS
DEPARTMENT OF TRANSPORTATION

PAVEMENT MARKING LETTERS AND SYMBOLS
FOR TRAFFIC STAGING

SCALE: NO SCALE SHEET OF SHEETS STA. TO STA.

F.A.P. RTE.	SECTION	COUNTY	TOTAL SHEETS	SHEET NO.
781	(1Z,17Z)RS-2	CRAWFORD	19	15
CONTRACT NO. 74980				
ILLINOIS FED. AID PROJECT				

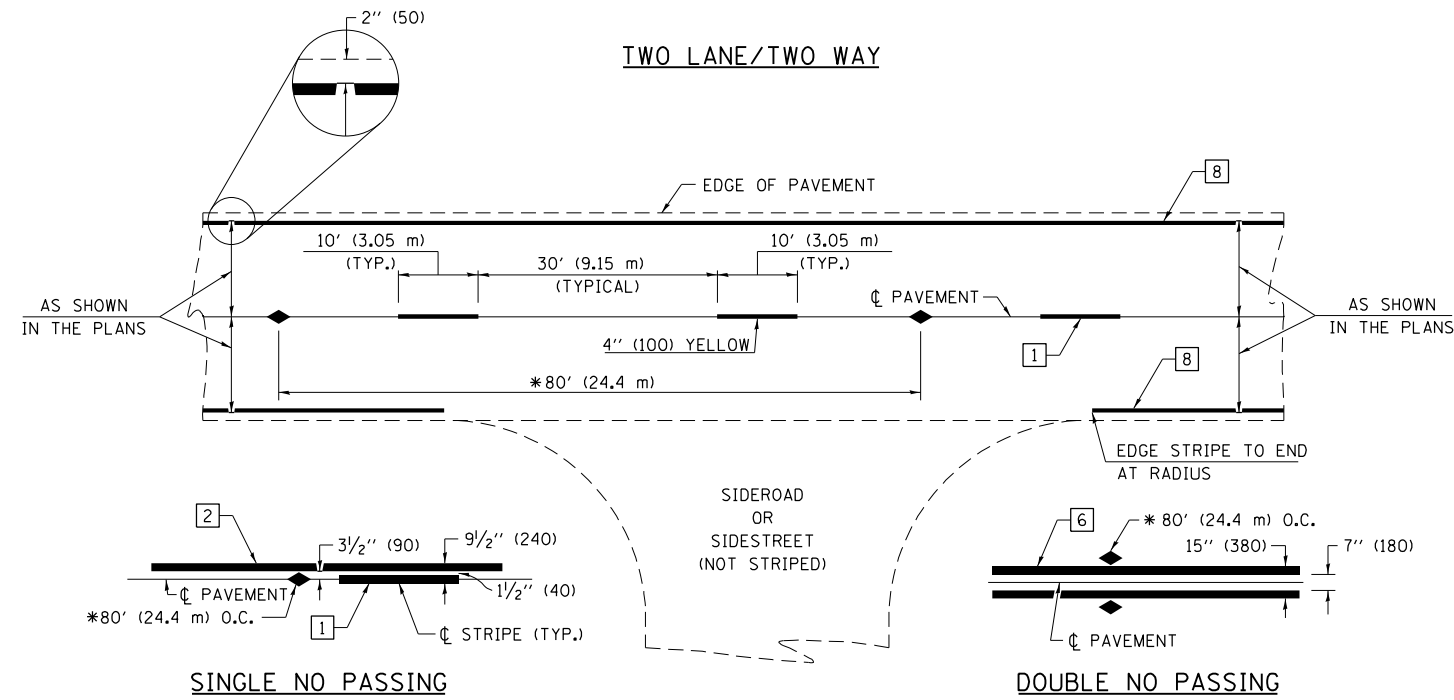

* REDUCE TO 40' (12.2 m) O.C. ON CURVES WITH POSTED OR ADVISORY SPEEDS OF 45 mph (70 km/h) OR LESS.

PAVEMENT MARKING LEGEND

- 1 4" (100) SKIP-DASH (YELLOW)
- 2 4" (100) SOLID (YELLOW)
- 3 12" (300) DIAGONAL (YELLOW)
- 4 4" (100) DOUBLE YELLOW (NARROW)
- 5 12" (300) SOLID WHITE
- 6 4" (100) DOUBLE YELLOW (WIDE)
- 7 6" (150) SKIP-DASH (WHITE)
- 8 4" (100) SOLID (WHITE)
- 9 12" (300) DIAGONAL (WHITE)
- 10 6" (150) SOLID (WHITE)
- 11 24" (600) STOP BAR (WHITE)
- 12 8" (200) SOLID (WHITE)
- 13 4" (100) PARKING WHITE

TYPICAL PAVEMENT MARKERS LEGEND

- ◆ TWO-WAY AMBER MARKER
- ▶ ONE-WAY AMBER MARKER
- ▷ ONE-WAY CRYSTAL MARKER

RELATIONSHIP OF STRIPES, MARKERS AND JOINTS

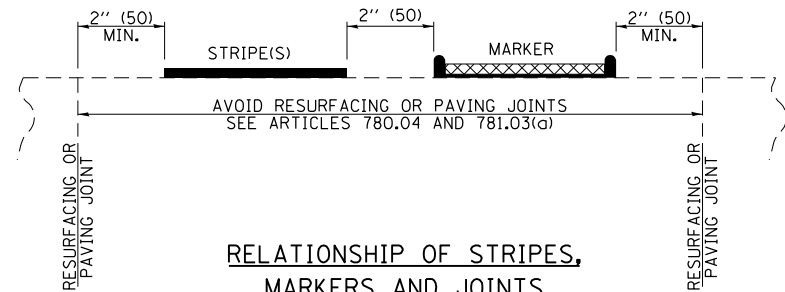

RAISED REFLECTIVE PAVEMENT MARKERS

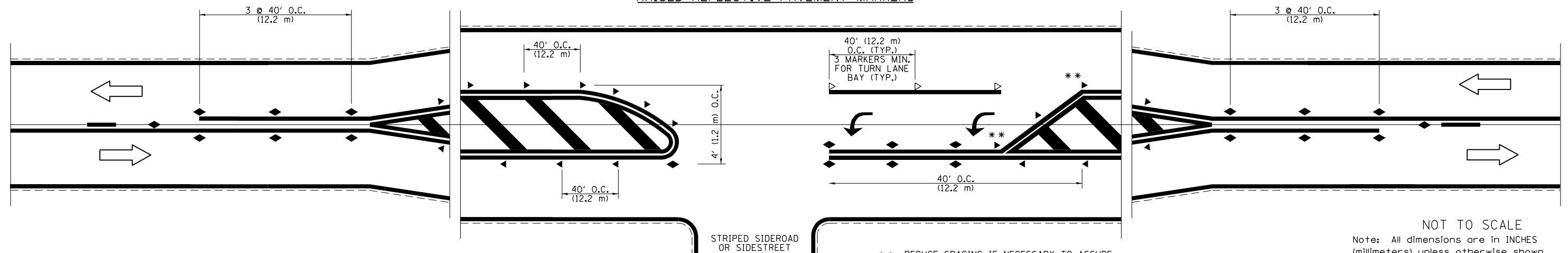

NOT TO SCALE
Note: All dimensions are in INCHES (millimeters) unless otherwise shown.

DISTRICT 7 DETAIL NO. 7800001

USER NAME = jessica.hille	DESIGNED -	REVISED - NAS 06/22
PLOT SCALE = 100,0000' / in.	DRAWN -	REVISED -
PLOT DATE = 12/5/2023	CHECKED -	REVISED -
	DATE -	REVISED -

STATE OF ILLINOIS
DEPARTMENT OF TRANSPORTATION

PAVEMENT MARKING AND RAISED REFLECTIVE PAVEMENT MARKERS
(RURAL & URBAN APPLICATIONS)

SCALE: NO SCALE SHEET 1 OF 4 SHEETS STA. TO STA.

F.A.P. RTE.	SECTION	COUNTY	TOTAL SHEETS	SHEET NO.
781	(12.172)RS-2	CRAWFORD	19	16
CONTRACT NO. 74980				

ILLINOIS FED. AID PROJECT

MODEL: Default
 FILE: \\naifc-proj\idest-cw-benefits.com\PIV\DOT\Documents\DOT Office\Director_7\Project\74980\CADD\Drawings\Sheet\74980-16.dwg
 PROJECT: 74980

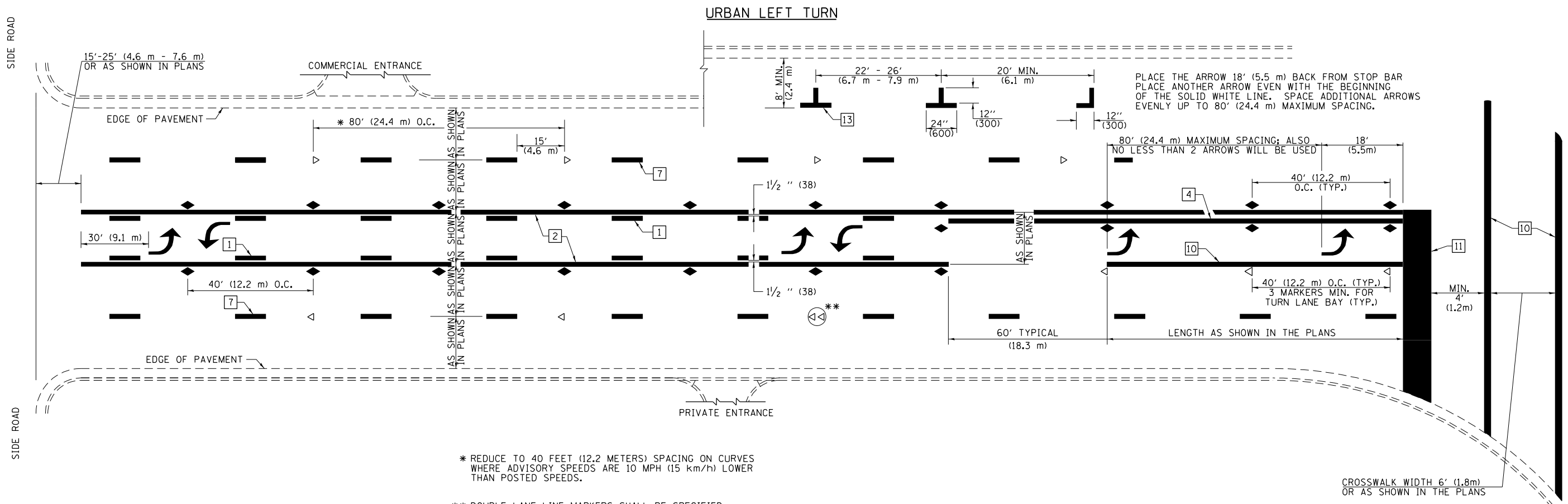

- * REDUCE TO 40 FEET (12.2 METERS) SPACING ON CURVES WHERE ADVISORY SPEEDS ARE 10 MPH (15 km/h) LOWER THAN POSTED SPEEDS.
- ** DOUBLE LANE LINE MARKERS SHALL BE SPECIFIED AND SPACED AS SHOWN IN HIGHWAY STANDARD 781001 FOR MULTI-LANE DIVIDED AND UNDIVIDED HIGHWAYS.

PAVEMENT MARKING LEGEND

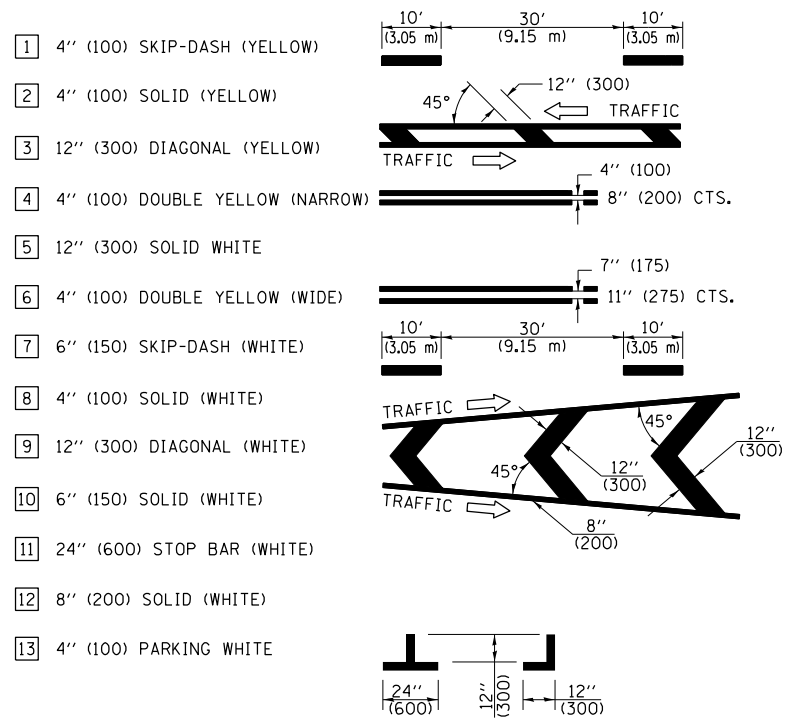

GENERAL NOTES

1. TURN ARROW PAIRS SHALL BE PLACED AT 250' (75 m) INTERVALS AND SHALL BE EVENLY SPACED BETWEEN BOTH ENDS OF THE BIDIRECTIONAL LEFT TURN LANE. USE A MINIMUM OF TWO PAIRS PER BLOCK.
2. THE SOLID YELLOW PAVEMENT MARKINGS [2] SHOULD GENERALLY START OR END NEAR THE RADIUS POINT OF EACH STREET RETURN EXCEPT WHERE ONE OR BOTH ENDS WOULD INCLUDE STOP BARS.
3. THE SKIP-DASH PAVEMENT MARKINGS [1] OR [7] SHOULD BE CENTERED BETWEEN BOTH ENDS OF EACH CITY BLOCK AND SHALL BE PLACED SO THEY LINE UP ACROSS FROM EACH OTHER.
4. USE LARGE ARROW SIZE FOR BOTH RURAL AND URBAN LOCATIONS. (SEE SECTION 780 FOR SYMBOLS TABLE)
5. LANE LINE EXTENSIONS SHALL BE THE SAME COLOR AND WIDTH AS THE LANE LINE BEING EXTENDED.
6. ALL WHITE SKIP-DASH LINES SHALL BE 6" IN WIDTH.

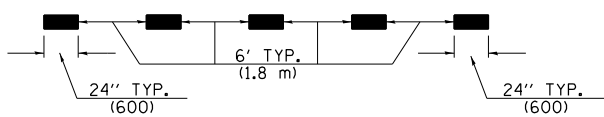

LANE LINE EXTENSIONS

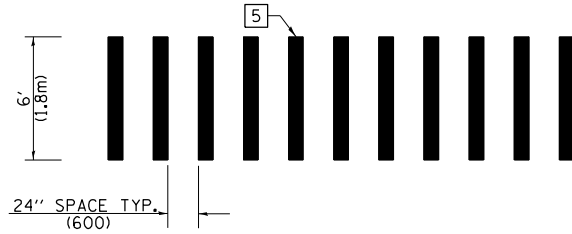

CROSSWALK DETAIL (DECATUR CITY LIMITS ONLY)

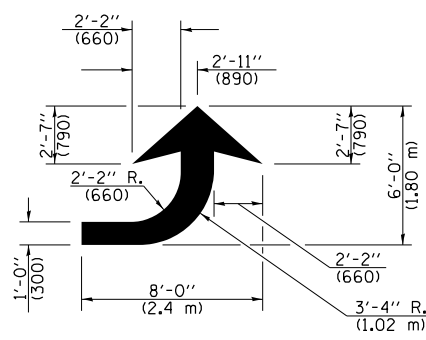

LEFT ARROW

REVERSE FOR RIGHT ARROW
AREA = 15.6 SQ. FT. (1.47 m²)
(WHITE)

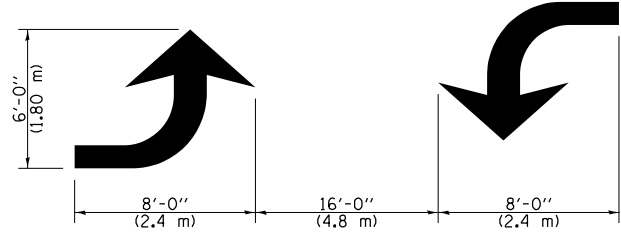

TYPICAL DOUBLE TURN ARROWS (WHITE)

NOT TO SCALE

Note: All dimensions are in INCHES (millimeters) unless otherwise shown.

DISTRICT 7 DETAIL NO. 7800001

USER NAME = jessica.wille	DESIGNED -	REVISED - NAS 06/22
PLOT SCALE = 100,0000' / in.	DRAWN -	REVISED -
PLOT DATE = 12/5/2023	CHECKED -	REVISED -
	DATE -	REVISED -

**STATE OF ILLINOIS
DEPARTMENT OF TRANSPORTATION**

**PAVEMENT MARKING AND RAISED REFLECTIVE PAVEMENT MARKERS
(RURAL & URBAN APPLICATIONS)**

SCALE: NO SCALE SHEET 2 OF 4 SHEETS STA. TO STA.

F.A.P. RTE.	SECTION	COUNTY	TOTAL SHEETS	SHEET NO.
781	(12.172)RS-2	CRAWFORD	19	17
CONTRACT NO. 74980				
ILLINOIS FED. AID PROJECT				

MODEL: Default
 FILE: \\naillc-pw-bendev.com\P\INDOT\Documents\DOT Office\Director_7\Projects\74980\CADD\Drawings\74980-17-detailed.dgn
 PROJECT: 74980\CADD\Drawings\74980-17-detailed.dgn

ISLANDS

OPTION 1

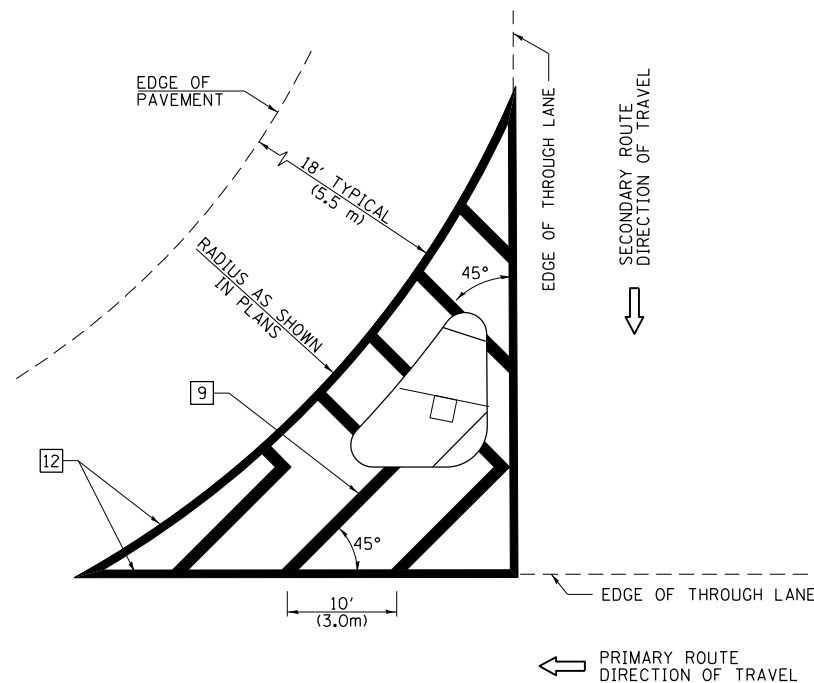

GENERAL NOTES

1. RAISED AND CORRUGATED MEDIANS SHALL BE OUTLINED WITH [2].
2. SOME OF THE INFORMATION INCLUDED WITH THIS DETAIL MAY NOT BE APPLICABLE TO THIS IMPROVEMENT.
3. PAVEMENT MARKINGS ARE TO BE EXTENDED THROUGH OMISSIONS WHEN APPLICABLE.
4. FINAL PAVEMENT MARKINGS SHALL BE IN PLACE PRIOR TO PLACING ANY RAISED REFLECTIVE PAVEMENT MARKERS.
5. THE FOLLOWING CRITERIA SHALL BE USED FOR SELECTING THE DIAGONAL PAVEMENT MARKING SPACING:

< 30 MPH (< 50 km/h)	15' (4.5 m)
30-45 MPH (50-75 km/h)	20' (6.0 m)
> 45 MPH (> 75 km/h)	30' (9.0 m)
6. THE USE OF ISLAND STRIPING OPTION 1 OR OPTION 2 SHALL BE AS SHOWN ON THE PLANS.

OPTION 2

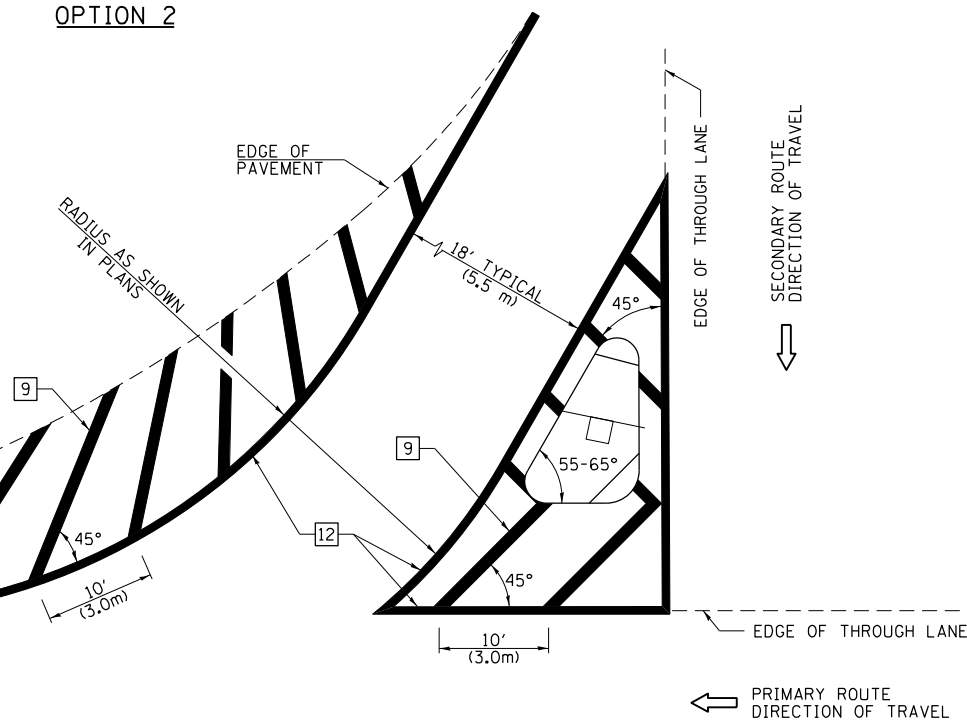

PAVEMENT MARKING LEGEND

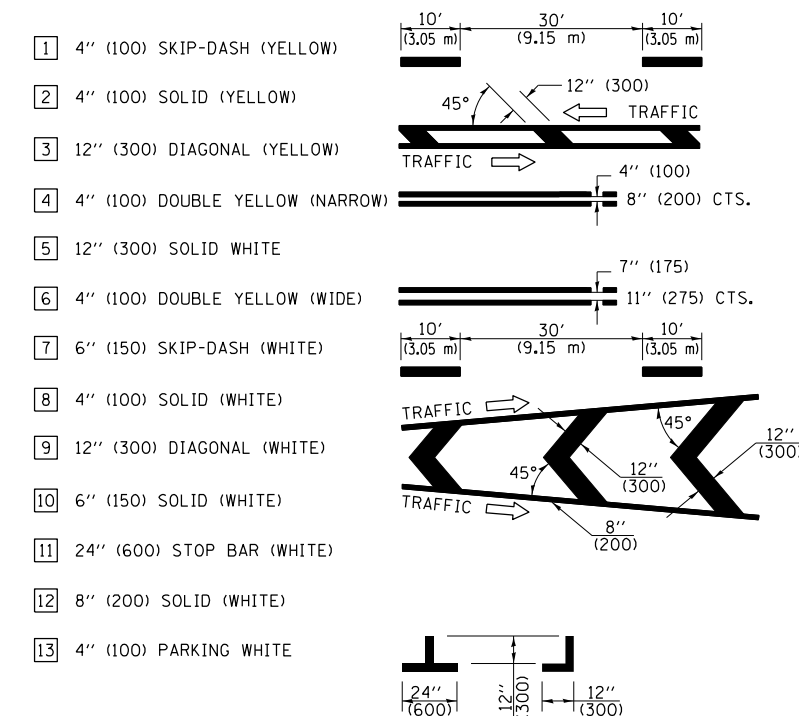

RURAL LEFT TURN STRIPING

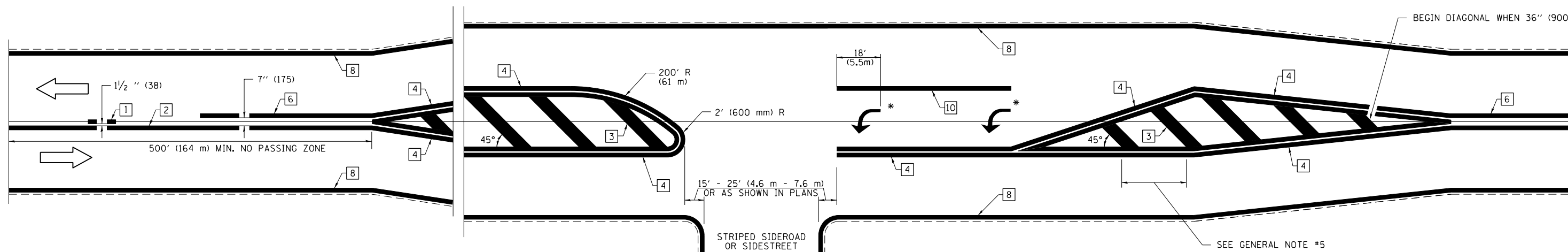

* PLACE AN ARROW 18' (5.5 m) BACK FROM END OF THE SOLID WHITE LINE. PLACE ANOTHER ARROW EVEN WITH THE BEGINNING OF THE SOLID WHITE LINE. SPACE ADDITIONAL ARROWS EVENLY UP TO 80' (24.4 m) MAXIMUM SPACING. USE MINIMUM OF 2 ARROWS.

NOT TO SCALE

Note: All dimensions are in INCHES (millimeters) unless otherwise shown.

DISTRICT 7 DETAIL NO. 7800001

USER NAME = jessica.ville	DESIGNED -	REVISOR - NAS	DATE - 06/22
	DRAWN -	REVISOR -	
PLOT SCALE = 100,0000' / in.	CHECKED -	REVISOR -	
PLOT DATE = 12/5/2023	DATE -	REVISOR -	

**STATE OF ILLINOIS
DEPARTMENT OF TRANSPORTATION**

**PAVEMENT MARKING AND RAISED REFLECTIVE PAVEMENT MARKERS
(RURAL & URBAN APPLICATIONS)**

SCALE: NO SCALE SHEET 3 OF 4 SHEETS STA. TO STA.

F.A.P. RTE.	SECTION	COUNTY	TOTAL SHEETS	SHEET NO.
781	(12.172)RS-2	CRAWFORD	19	18
CONTRACT NO. 74980				
ILLINOIS FED. AID PROJECT				

MODEL: Default
 FILE: \\nas101\pub\stdraw\beachfy.com\PIV\DOT\Documents\DOT Office\Director_7\Project\74980\CADD\Drawings\CD\Drawings\74980-18.dwg
 PLOT DATE: 12/5/2023

SUPPLEMENTAL PAVEMENT MARKING TREATMENT FOR RAILROAD-HIGHWAY GRADE CROSSING

PAVEMENT MARKING LEGEND

- 1 4" (100) SKIP-DASH (YELLOW)
 - 2 4" (100) SOLID (YELLOW)
 - 3 12" (300) DIAGONAL (YELLOW)
 - 4 4" (100) DOUBLE YELLOW (NARROW)
 - 5 12" (300) SOLID WHITE
 - 6 4" (100) DOUBLE YELLOW (WIDE)
 - 7 6" (150) SKIP-DASH (WHITE)
 - 8 4" (100) SOLID (WHITE)
 - 9 12" (300) DIAGONAL (WHITE)
 - 10 6" (150) SOLID (WHITE)
 - 11 24" (600) STOP BAR (WHITE)
 - 12 8" (200) SOLID (WHITE)
 - 13 4" (100) PARKING WHITE
-

PAVEMENT MARKINGS AT RAILROAD-HIGHWAY GRADE CROSSING

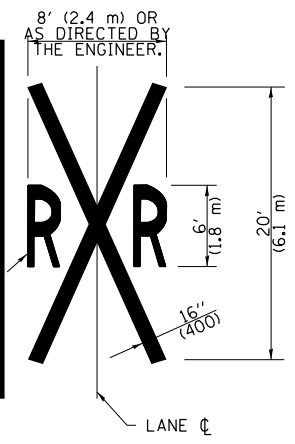
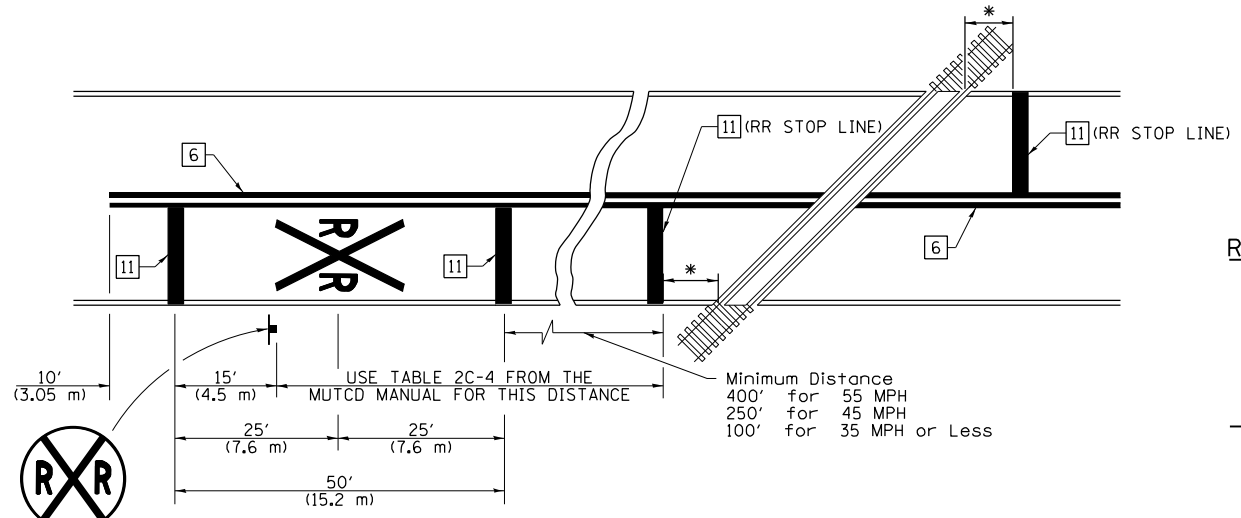

NOTES

THE TRAVERSE SPREAD OF THE "X" MAY VARY ACCORDING TO LANE WIDTH.

ON MULTI-LANE ROADS, THE STOP LINES SHALL EXTEND ACROSS ALL APPROACH LANES AND SEPARATE RRR SYMBOLS SHALL BE PLACED ADJACENT TO EACH OTHER IN EACH LANE.

WHEN THE PAVEMENT MARKING SYMBOL IS USED, A PORTION OF THE SYMBOL SHOULD BE LOCATED DIRECTLY ADJACENT TO THE ADVANCE WARNING SIGN (W10-1) AS PLACED BY TABLE II-1, CONDITION B OF THE MUTCD.

RAILROAD CROSSING WITH NON-SIGNALIZED INTERSECTION

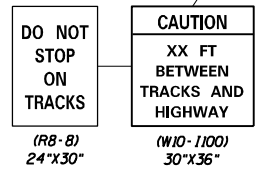
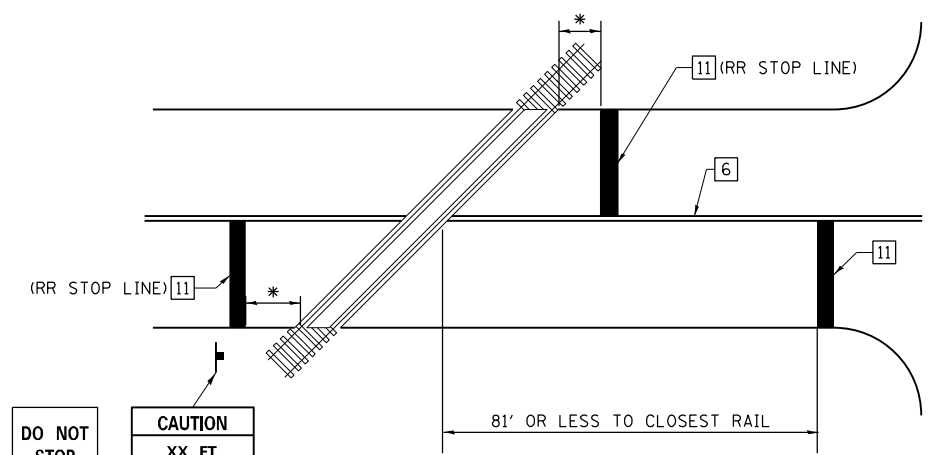

RAILROAD CROSSING WITH INTERCONNECT AND PRE-SIGNALS

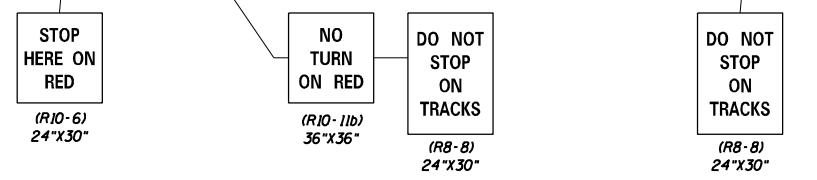
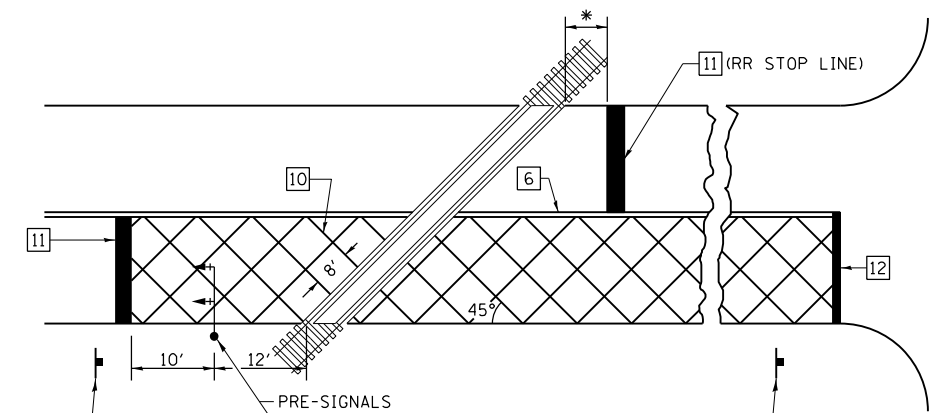

RAILROAD CROSSING WITH INTERCONNECT ONLY

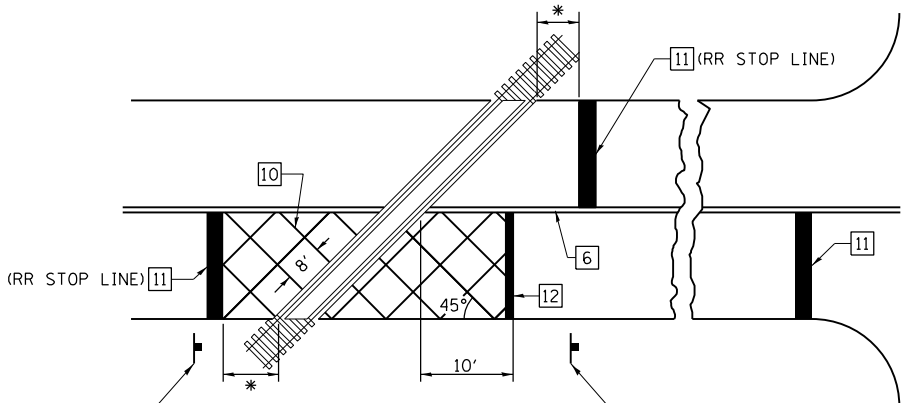

- ### GENERAL NOTES
- SUPPLEMENTAL PAVEMENT MARKINGS TO BE INSTALLED ONLY ON APPROACHES TO INTERSECTIONS CONTROLLED BY TRAFFIC SIGNALS WHICH ARE INTERCONNECTED WITH THE RAILROAD WARNING SIGNALS.
 - EXTEND PAVEMENT MARKINGS TO THE INTERSECTION ONLY WHERE PRE-SIGNALS ARE USED.
 - WHEN PEDESTRIAN SIGNALS ARE PRESENT WITH INTERCONNECTED SIGNALS, WARNING SIGN W10-1101 (18"X24") SHALL BE PLACED NEAR EACH PEDESTRIAN SIGNAL HEAD. COUNTDOWN PEDESTRIAN SIGNAL HEADS SHALL NOT BE UTILIZED ALONG WITH INTERCONNECTED SIGNALS.
 - PLEASE REFER TO THE IDOT BUREAU OF OPERATION MEMO OPS T-06 DATED DECEMBER 1, 2020 FOR ADDITIONAL INFORMATION.

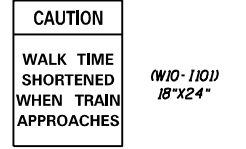

- * 15' FROM NEAR RAIL OR 8' FROM AND PARALLEL TO GATE IF PRESENT
- ** WARNING SIGN W10-1100 SHALL BE USED AS AN INTERIM MEASURE AT INTERCONNECTED SIGNAL LOCATIONS WHERE PRE-SIGNALS ARE TO BE INSTALLED IN THE FUTURE. THIS SIGN SHALL BE REMOVED WHEN THE PRE-SIGNALS ARE INSTALLED AND THE PAVEMENT MARKINGS ARE EXTENDED TO THE INTERSECTION.

NOT TO SCALE
Note: All dimensions are in INCHES (millimeters) unless otherwise shown.

DISTRICT 7 DETAIL NO. 7800001

MODEL: Default
FILE NAME: p:\idistrict-pw-beadefy.com\FWIDOT\Documents\IDOT Office\Director_7\Project\74980\CADD\Drawings\Sheet\0774980-01-detailed.dwg
PROJECT: 74980\CADD\Drawings\Sheet\0774980-01-detailed.dwg

USER NAME = jessica.hille	DESIGNED -	REVISED - NAS 06/22
PLOT SCALE = 100,0000' / in.	DRAWN -	REVISED -
PLOT DATE = 12/5/2023	CHECKED -	REVISED -
	DATE -	REVISED -

STATE OF ILLINOIS
DEPARTMENT OF TRANSPORTATION

PAVEMENT MARKING AND RAISED REFLECTIVE PAVEMENT MARKERS
(RURAL & URBAN APPLICATIONS)

SCALE: NO SCALE SHEET 4 OF 4 SHEETS STA. TO STA.

F.A.P. RTE.	SECTION	COUNTY	TOTAL SHEETS	SHEET NO.
781	(12.17Z)RS-2	CRAWFORD	19	19
CONTRACT NO. 74980				
ILLINOIS FED. AID PROJECT				