

STATE OF ILLINOIS
DEPARTMENT OF TRANSPORTATION

F.A.U. RTE.	SECTION	COUNTY	TOTAL SHEETS	SHEET NO.
9296	65Q	MONROE	6	1
		ILLINOIS	CONTRACT NO. 76T37	

FOR INDEX OF SHEETS, SEE SHEET NO. 2

PROPOSED HIGHWAY PLANS

FAU ROUTE 9296 (GHENT RD./OLD RTE. 3)
SECTION: 65Q
A2 BITUMINOUS SURFACE TREATMENT
MONROE COUNTY

D98-062-23



TRAFFIC DATA	
LOCATION	GHENT RD. (OLD RTE. 3)
2024 ADT	4800 (ACTUAL)
2044 ADT	5800 (ESTIMATED)
MU%	2.1
SU%	2.8

C-98-106-23

FUNCTIONAL CLASSIFICATION: MINOR ARTERIAL



BEGIN PROJECT:
(EXISTING JOINT)
STA. 0+00
LAT: 38.485569
LONG: -90.218850

END PROJECT:
(EXISTING JOINT)
STA. 65+47
LAT: 38.46808
LONG: -90.22413

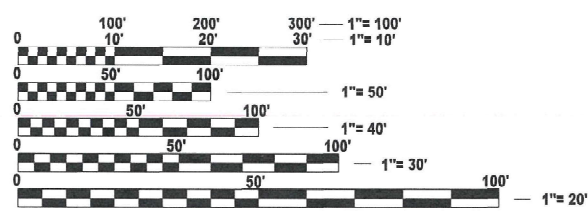

FULL SIZE PLANS HAVE BEEN PREPARED USING STANDARD ENGINEERING SCALES. REDUCED SIZED PLANS WILL NOT CONFORM TO STANDARD SCALES. IN MAKING MEASUREMENTS ON REDUCED PLANS, THE ABOVE SCALES MAY BE USED.

J.U.L.I.E.
JOINT UTILITY LOCATION INFORMATION FOR EXCAVATION
1-800-892-0123
OR 811

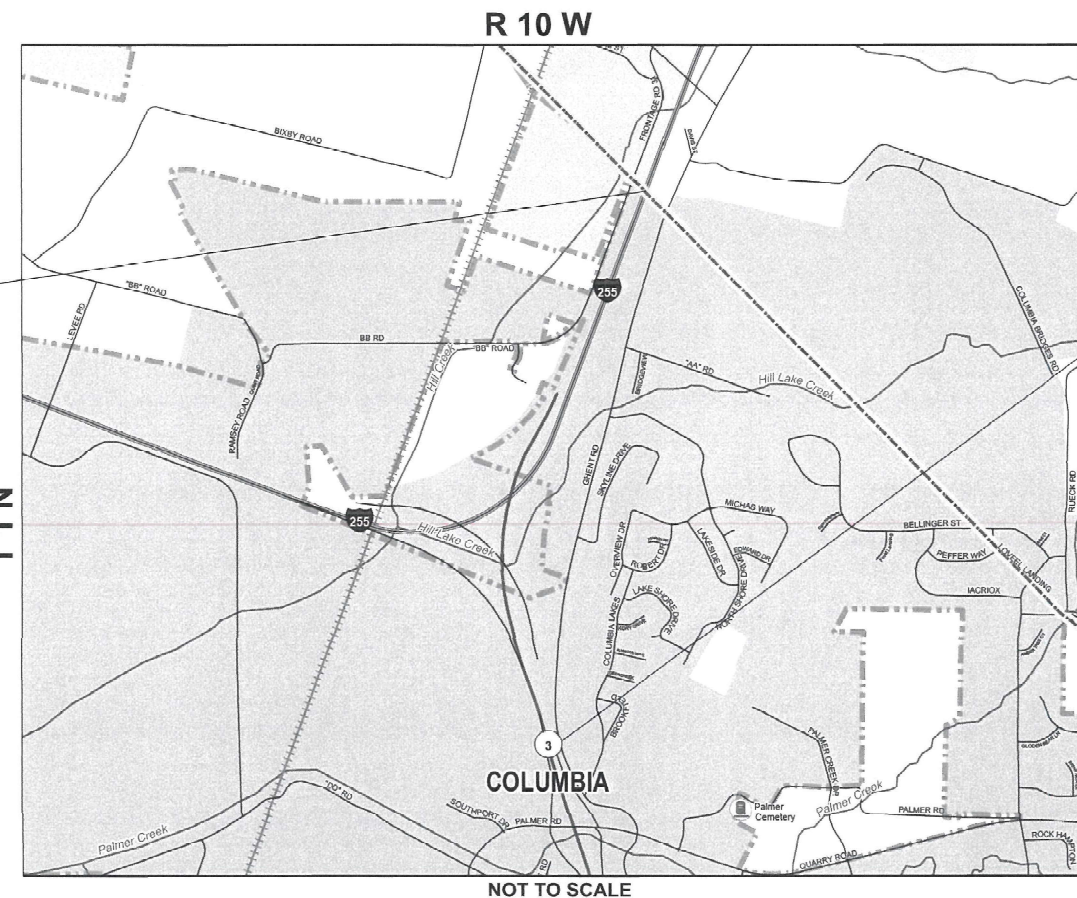

PROJECT ENGINEER: BILLIE OWEN
PROJECT MANAGER: MEIWU AN

GROSS LENGTH = 6,547.2 FT. = 1.24 MILE
NET LENGTH = 6,547.2 FT. = 1.24 MILE

CONTRACT NO. 76T37

STATE OF ILLINOIS
DEPARTMENT OF TRANSPORTATION

SUBMITTED December 14, 2023
Kenneth Brown
REGIONAL ENGINEER

February 2, 2024
John A. Etk
ENGINEER OF DESIGN AND ENVIRONMENT

February 2, 2024
Steph M. Lewis
DIRECTOR OF HIGHWAYS PROJECT IMPLEMENTATION

PRINTED BY THE AUTHORITY
OF THE STATE OF ILLINOIS

INDEX OF SHEETS

1. COVER SHEET
2. INDEX OF SHEETS, HIGHWAY STANDARDS, GENERAL NOTES AND COMMITMENTS
3. SUMMARY OF QUANTITIES
4. TYPICAL SECTION
5. SCHEDULE OF QUANTITIES
6. LOCATION MAP

HIGHWAY STANDARDS

000001-08	STANDARDS SYMBOLS ABBREVIATIONS & PATTERNS
001006	DECIMAL OF INCH & FOOT
701006-05	OFF ROAD OPERATIONS, 2L, 2W, 15' TO 24' FROM EDGE OF PAVEMENT
701201-05	LANE CLOSURE 2 LANE, 2 WAY, DAY ONLY
701301-04	LANE CLOSURE 2 LANE, 2 WAY, SHORT TERM OPERATIONS
701306-04	LANE CLOSURE 2 LANE, 2 WAY, SLOW MOVING OPERATION, DAY ONLY 45MPH OR MORE
701901-09	TRAFFIC CONTROL DEVICES
780001-05	TYPICAL PAVEMENT MARKINGS
781001-04	TYPICAL APPLICATION RAISED REFLECTION PAVEMENT MARKERS

GENERAL NOTES

1. UTILITIES KNOWN TO HAVE FACILITIES WITHIN THE PROJECT ARES

		AERIAL	BURIED
*AMEREN ILLINOIS	(GAS & ELECTRIC)	X	X
*CHARTER COMMUNICATIONS, INC	(CABLE TV)	X	X
*CLEARWAVE FIBER LLC	(COMMUNICATIONS)	X	X
*CITY OF COLUMBIA	(WATER & SANITARY SEWER)	X	X
*EVERSTREAM GLC HOLDING COMPANY LLC	(COMMUNICATIONS)	X	X
*HARRISONVILLE TELEPHONE COMPANY	(COMMUNICATIONS)	X	X
*VERIZON BUSINESS	(COMMUNICATIONS)	X	X
2. NO SURVEY WAS PREFORMED FOR THIS PROJECT AND THE PLANS WERE CREATED USING MICROFLIM AND FIELD MEASUREMENTS.
3. THE RESIDENT ENGINEER SHALL VERIFY THE EXISTENCE OF HIGHWAY LIGHTING, INTELLIGENT TRANSPORTATION SYSTEMS (I.T.S.) UTILITIES, AND/OR ELECTRICAL CABLES ASSOCIATED WITH TRAFFIC SIGNALS WITHIN THE PROJECT LIMITS. IF ANY OF THESE EXIST WITHIN THE PROJECT LIMITS, AND IF THESE ITEMS REQUIRE LOCATING, THE CONTRACTOR SHALL BE DIRECTED TO DO SO ACCORDING TO SECTION 803 OF THE STANDARD SPECIFICATIONS. THIS WORK SHALL BE PAID FOR ACCORDING TO ARTICLE 109.04 OF THE STANDARD SPECIFICATIONS.
4. THE DEPARTMENT STRONGLY ENCOURAGES THE PRIME CONTRACTOR AND THEIR APPROVED SUB-CONTRACTORS TO HIRE MINORITY, WOMEN AND DISADVANTAGED INDIVIDUALS FROM ITS FEDERALLY FUNDED HIGHWAY CONSTRUCTION CAREERS TRAINING PROGRAM (HCCTP) TO HELP MEET WORKFORCE AND TRAINEE GOALS. THIS PROGRAM IS TRAINING MINORITIES, WOMEN AND DISADVANTAGED INDIVIDUALS IN HIGHWAY CONSTRUCTION-RELATED SKILLS, E.G., MATH FOR THE TRADES, JOB READINESS, TECHNICAL SKILLS COURSEWORK (CARPENTRY, CONCRETE FLATWORK, BLUEPRINT READING, SITE PLANS, SITE WORK, TOOLS USE, ETC.) AND OSHA 10 HOUR CERTIFICATION, TO PREPARE THEM FOR A CAREER IN THE HIGHWAY CONSTRUCTION TRADES. GRADUATES ARE WELL-TRAINED AND READY TO BECOME PRODUCTIVE ENTRY-LEVEL CONSTRUCTION WORKERS. CONTACT THE DISTRICT 8 EEO OFFICE AT 618-346-3360 AND/OR THE HCCTP COORDINATOR AT 618-874-6528 TO LEARN MORE ABOUT THE PROGRAM AND FOR ASSISTANCE IN MEETING WORKFORCE AND TRAINEE GOALS.
5. THE CONTRACTOR SHALL USE CA-16 FOR THE SEAL AND COVER AGGREGATE.
6. THE VOID IN THE PAVEMENT WHICH RESULTS FROM THE RAISED REFLECTIVE PAVEMENT MARKER REMOVAL SHALL BE REPAIRED WITH MATERIAL AS DIRECTED BY THE ENGINEER. THE MATERIAL AND WORK SHALL BE PAID FOR IN ACCORDANCE WITH ARTICLE 783 OF THE STANDARD SPECIFICATIONS.
7. ALL TURF AREAS DISTURBED BY THE CONTRACTOR SHALL BE SEEDED WITH THE APPROPRAITE EROSION CONTROL, AS DIRECTED BY THE ENGINEER, AT THE CONTRACTOR'S EXPENSE.
8. THE PROPOSED PAVEMENT MARKING SHALL MATCH THE LOCATIONS OF THE EXISTING PAVEMENT MARKING, AS DIRECTED BY THE ENGINEER.

COMMITMENTS

NONE

MODEL: General Notes (Sheet)
FILE NAME: c:\p\work\pav\miller\ra\091452\1087\6137-sht-geomcdet.dgn

USER NAME = Rahshun.Miller	DESIGNED - BBB	REVISED - RV1
	DRAWN - CCC	REVISED - RV2
PLOT SCALE = 0.16666833' / in.	CHECKED - AAA	REVISED - RV3
PLOT DATE = 11/27/2023	DATE - XX/XX/XX	REVISED - RV4

**STATE OF ILLINOIS
DEPARTMENT OF TRANSPORTATION**

**INDEX OF SHEETS, HIGHWAY STANDARDS,
GENERAL NOTES, COMMITMENTS**

SCALE: 50 SHEET 1 OF 1 SHEETS STA. TO STA.

F.A.U RTE.	SECTION	COUNTY	TOTAL SHEETS	SHEET NO.
9296	65Q	MONROE	6	2
CONTRACT NO. 76T37				
		ILLINOIS	FED. AID PROJECT	

MODEL: SOQ (Sheet)
 FILE NAME: c:\p\work\pavimillera\091452\10876137-sht-SOQ.dgn

				CONSTR. CODE	
				100% STATE	
CODE NO.	ITEM	UNIT	TOTAL QUANTITY	ROADWAY	
				0005	URBAN
67100100	MOBILIZATION	L SUM	1	1	
70100450	TRAFFIC CONTROL AND PROTECTION, STANDARD 701201	L SUM	1	1	
70100460	TRAFFIC CONTROL AND PROTECTION, STANDARD 701306	L SUM	1	1	
* 78001110	PAINT PAVEMENT MARKING - LINE 4"	FOOT	15048	15048	
78100200	TEMPORARY RAISED REFLECTIVE PAVEMENT MARKER	EACH	82	82	
78300200	RAISED REFLECTIVE PAVEMENT MARKER REMOVAL	EACH	82	82	
X1500005	BITUMINOUS SURFACE TREATMENT, A2	SQ YD	16004	16004	
X4060107	BITUMINOUS MATERIALS (FOG SEAL)	POUND	6402	6402	

* SPECIALTY ITEM

USER NAME = Rahshun.Miller	DESIGNED - BBB	REVISED - RV1
	DRAWN - CCC	REVISED - RV2
PLOT SCALE = 0.16666833 1/ in.	CHECKED - AAA	REVISED - RV3
PLOT DATE = 12/12/2023	DATE - XX/XX/XX	REVISED - RV4

**STATE OF ILLINOIS
 DEPARTMENT OF TRANSPORTATION**

SUMMARY OF QUANTITIES

SCALE: 50 SHEET 1 OF 1 SHEETS STA. TO STA.

F.A.U. RTE.	SECTION	COUNTY	TOTAL SHEETS	SHEET NO.
9296	65Q	MONROE	3	3
CONTRACT NO. 76T37				
ILLINOIS FED. AID PROJECT				

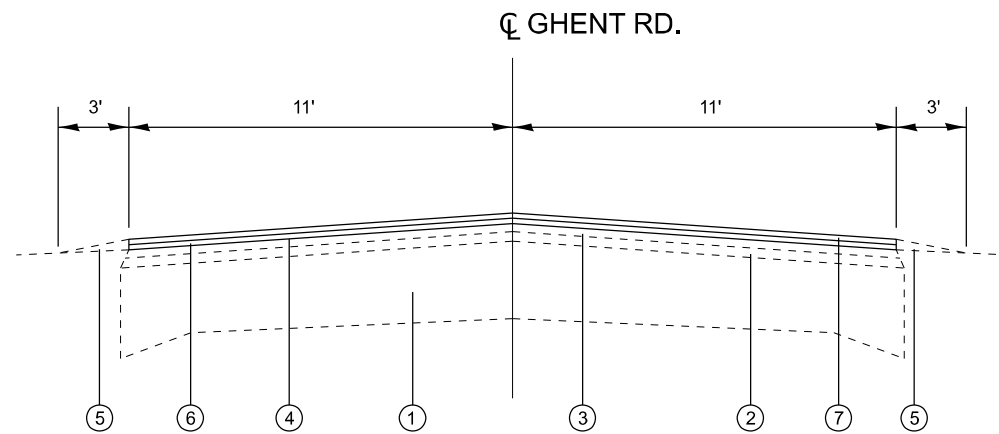

EXISTING TYPICAL SECTION

STA. 0+00 TO STA. 65+47

LEGEND

- ① EXISTING P.C.C. BASE COURSE, 9"-7"-9"
- ② EXISTING LEVELING BINDER (MACHINE METHOD)
- ③ EXISTING BITUMINOUS CONC. BINDER COURSE
- ④ EXISTING BITUMINOUS CONC. SURFACE COURSE
- ⑤ EXISTING AGGREGATE SHOULDER, TYPE B
- ⑥ PROPOSED A-2 SURFACE TREATMENT
- ⑦ PROPOSED FOG SEAL TREATMENT

MODEL: TYPICAL-1 (Sheet)
FILE NAME: c:\p\work\pav\miller\ra\0914527\0676137-sh1-typical.dgn

USER NAME = Rahshun.Miller	DESIGNED - BBB	REVISED - RV1
	DRAWN - CCC	REVISED - RV2
PLOT SCALE = 0.16666633' / in.	CHECKED - AAA	REVISED - RV3
PLOT DATE = 11/27/2023	DATE - XX/XX/XX	REVISED - RV4

**STATE OF ILLINOIS
DEPARTMENT OF TRANSPORTATION**

TYPICAL SECTION

SCALE: 50 SHEET OF 6 SHEETS STA. TO STA.

F.A.U. RTE.	SECTION	COUNTY	TOTAL SHEETS	SHEET NO.
9296	65Q	MONROE	6	4
CONTRACT NO. 76T37				
ILLINOIS			FED. AID PROJECT	

RESURFACING SCHEDULE							
STATION	TO	STATION	LENGTH	WIDTH	TOTAL	BITUMINOUS SURFACE	BITUMINOUS
			(FOOT)	(FOOT)	SQ FT	TREATMENT A2	FOG SEAL
						(SQ YD)	(LBS)
0+00	TO	10+00	1000	22	22000	2444	977.8
10+00	TO	20+00	1000	22	22000	2444	977.8
20+00	TO	30+00	1000	22	22000	2444	977.8
30+00	TO	40+00	1000	22	22000	2444	977.8
40+00	TO	50+00	1000	22	22000	2444	977.8
50+00	TO	60+00	1000	22	22000	2444	977.8
60+00	TO	65+47	547	22	12038.4	1338	535.0
TOTAL :						16004	6402

PAINT PAVEMENT MARKING SCHEDULE								
STA.	TO	STA.	LENGTH	4" WHITE	4" YELLOW		RAISED REFLECTIVE PAVEMENT MARKER REMOVAL	TEMPORARY RAISED REFLECTIVE PAVEMENT MARKER
				SOLID EDGE LINE (NB/SB)	SKIP-DASH	NO PASSING (NORTH BOUND)		
				FOOT	FOOT	FOOT		
0+00	TO	10+00	1000	2000	250		15	15
10+00	TO	20+00	1000	2000	250		12	12
20+00	TO	30+00	1000	2000	250		12	12
30+00	TO	40+00	1000	2000	250		12	12
40+00	TO	50+00	1000	2000	250		12	12
50+00	TO	60+00	1000	2000	250		12	12
60+00	TO	65+47	547	1094	136.8	316.8	7	7
SUB - TOTAL :				13094.0	1636.8	316.8		
TOTAL :				15048			82	82

MODEL: Schedule (Sheet)
 FILE NAME: c:\pw\work\pav\dotmill\rajd0914527\0876137-sht-typical.dgn

USER NAME = Rahshun.Miller	DESIGNED - BBB	REVISED - RV1
	DRAWN - CCC	REVISED - RV2
PLOT SCALE = 0.16666633 / in.	CHECKED - AAA	REVISED - RV3
PLOT DATE = 11/27/2023	DATE - XX/XX/XX	REVISED - RV4

STATE OF ILLINOIS
DEPARTMENT OF TRANSPORTATION

SCHEDULE OF QUANTITIES

SCALE: 50 SHEET OF 6 SHEETS STA. TO STA.

F.A.U. RTE.	SECTION	COUNTY	TOTAL SHEETS	SHEET NO.
9296	65Q	MONROE	6	5
CONTRACT NO. 76T37				
ILLINOIS FED. AID PROJECT				

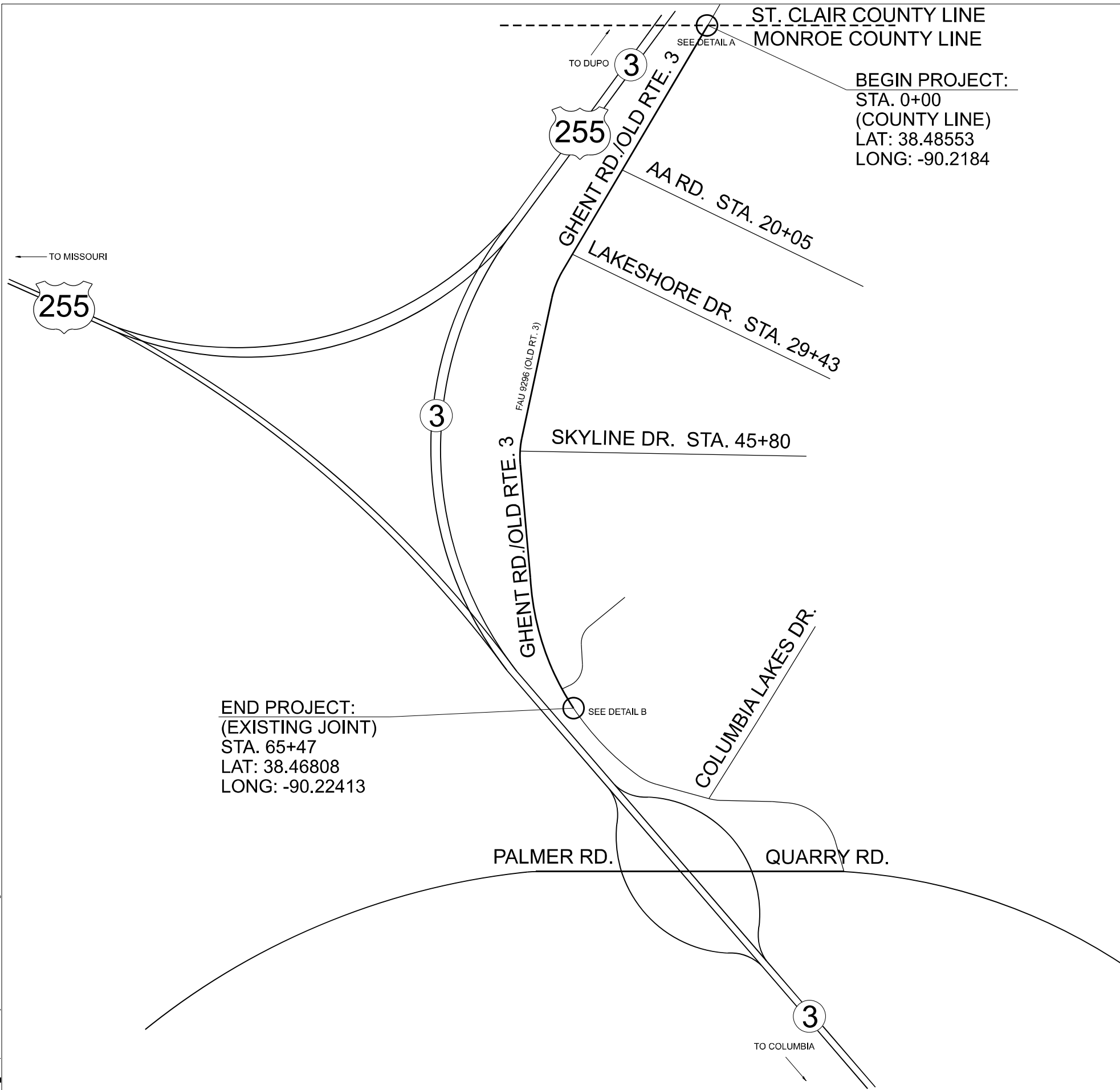

BEGIN PROJECT:
 STA. 0+00
 (COUNTY LINE)
 LAT: 38.48553
 LONG: -90.2184

END PROJECT:
 (EXISTING JOINT)
 STA. 65+47
 LAT: 38.46808
 LONG: -90.22413

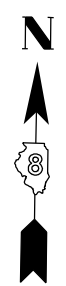

DETAIL A



DETAIL B

MODEL: Location Map (Sheet)
 FILE NAME: c:\p\work\rahsun\miller\rahsun\4527\0676137-sht-detail.dgn

USER NAME =	Rahshun.Miller	DESIGNED -	BBB	REVISED -	RV1
DRAWN -	CCC	REVISED -	RV2		
PLOT SCALE =	0.16666633" / in.	CHECKED -	AAA	REVISED -	RV3
PLOT DATE =	11/13/2023	DATE -	XX/XX/XX	REVISED -	RV4

STATE OF ILLINOIS
DEPARTMENT OF TRANSPORTATION

LOCATION MAP

SCALE: 50 SHEET 1 OF 1 SHEETS STA. TO STA.

F.A.U. RTE.	SECTION	COUNTY	TOTAL SHEETS	SHEET NO.
9296	65Q	MONROE	6	6
CONTRACT NO. 76T37				
ILLINOIS FED. AID PROJECT				