

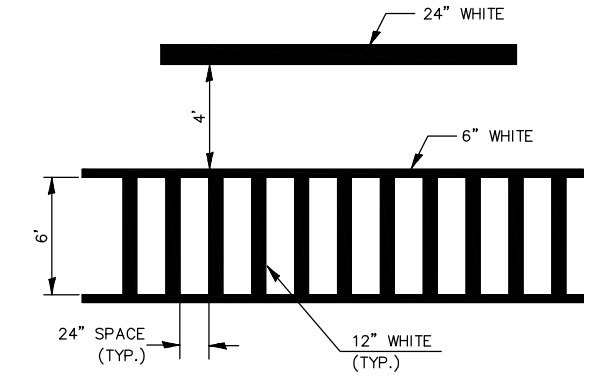

CHAMLIN & ASSOCIATES, INC. © 2023 Drawing Name: G:\Users\VA\66396-00-Ladd-Safe-Routes-to-School-2021\CAD\002-NOTES.dwg Last Modified: Tuesday, October 3, 2023 11:33:56 AM by Adam Oniola

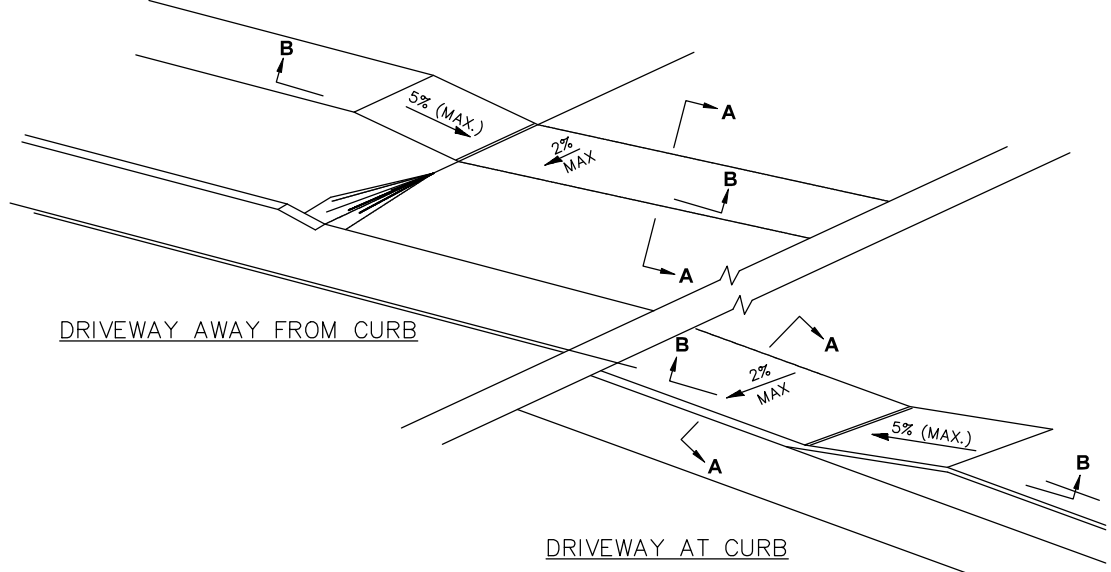
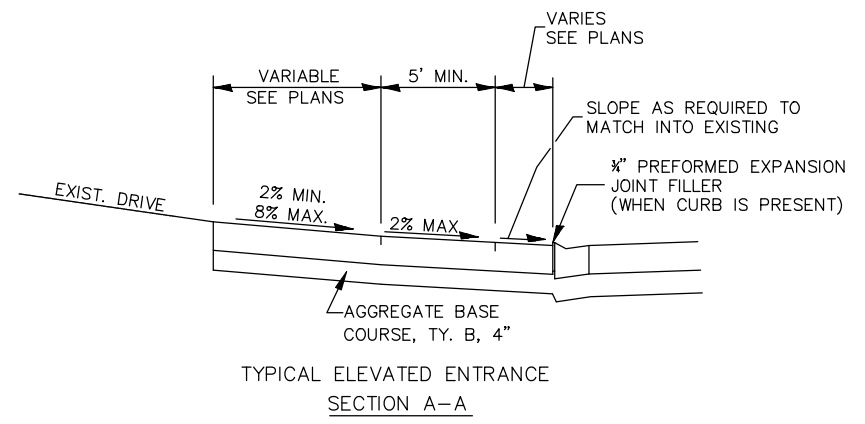
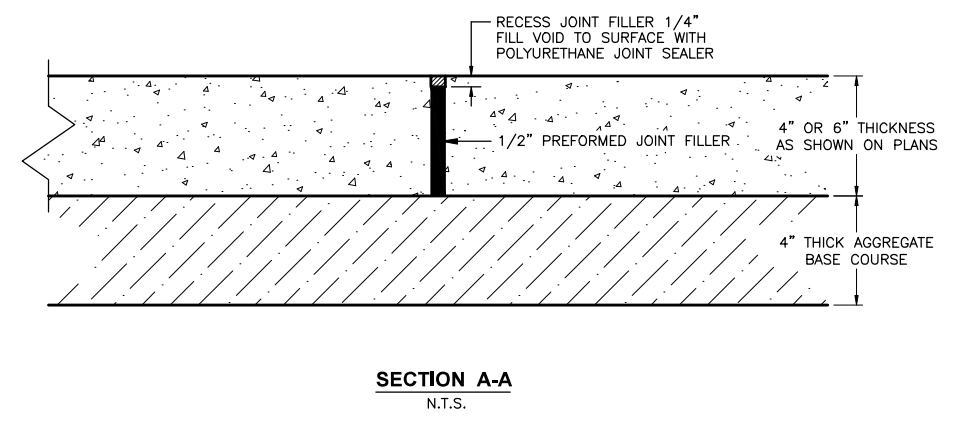
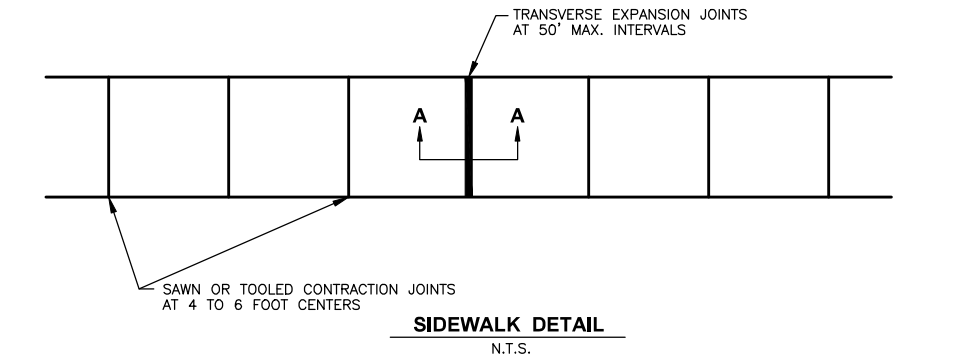
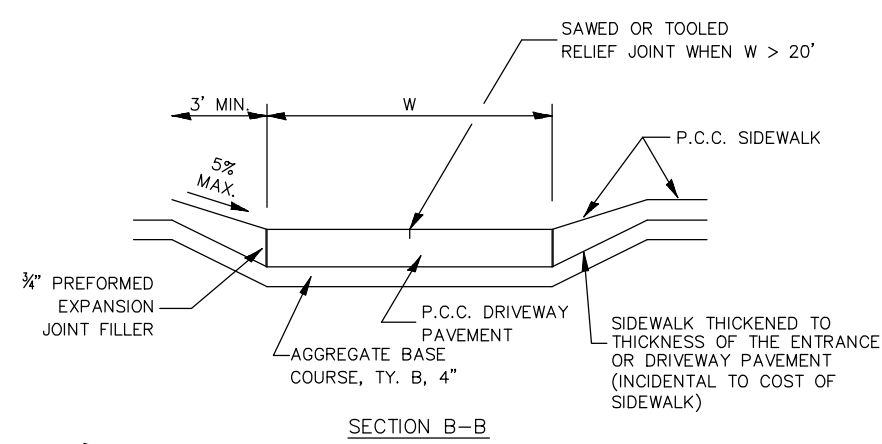
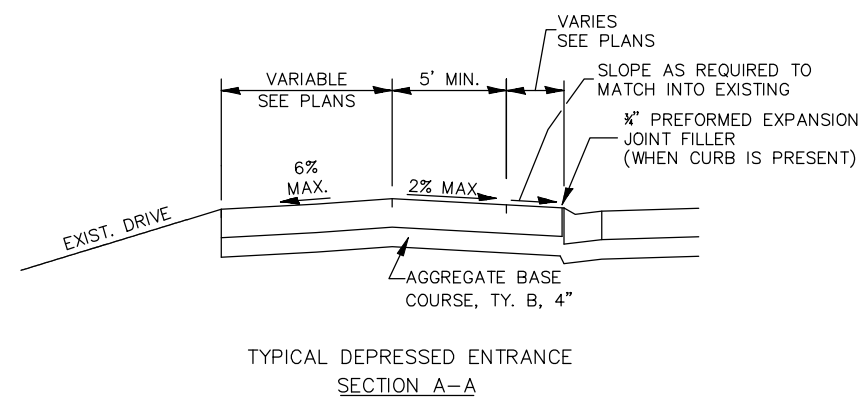

**GENERAL NOTES**

- LIMITS OF SIDEWALK REMOVAL IS GENERALLY INTENDED TO BE AT AN EXISTING JOINT IN THE SIDEWALK. A FULL DEPTH SAWCUT WILL BE REQUIRED AT ALL EDGES OF SIDEWALK OR PAVEMENT TO BE REMOVED THAT BORDERS OTHER SIDEWALKS OR PAVEMENTS.
- SEEDING WILL NOT BE PERMITTED AT ANY TIME WHEN THE GROUND IS FROZEN, WET, OR IN AN UNTILLABLE CONDITION, LOCATIONS TO BE SEEDED WILL BE DETERMINED BY THE ENGINEER.
- ONLY THOSE TREES DESIGNATED BY THE ENGINEER OR LISTED IN THE TREE REMOVAL SCHEDULE SHALL BE REMOVED. THE CONTRACTOR SHALL PROTECT ALL REMAINING TREES FROM DAMAGE DUE TO HIS OPERATIONS.
- DETECTABLE WARNING SURFACES SHALL EXTEND 2.0 FT MINIMUM IN THE DIRECTION OF PEDESTRIAN TRAVEL. AT CURB RAMP AND BLENDED TRANSITIONS, DETECTABLE WARNING SURFACES SHALL EXTEND THE FULL WIDTH OF THE RAMP RUN (EXCLUDING ANY FLARES) OR BLENDED TRANSITIONS. SOME DETECTABLE WARNING PRODUCTS REQUIRE A CONCRETE BORDER FOR PROPER INSTALLATION. THE CONCRETE BORDER SHALL NOT EXCEED 2 INCHES.
- ANY REFERENCE TO A STANDARD IN THESE PLANS SHALL BE INTERPRETED TO MEAN THE EDITION AS INDICATED BY THE SUBNUMBER SHOWN IN THE LIST OF STANDARDS OR THE COPY INCLUDED IN THE PLANS.
- THE CONTRACTOR SHALL CONTACT JULIE AT LEAST 48 HOURS PRIOR TO EXCAVATION TO DETERMINE WHICH UTILITIES ARE IN THE AREA.
- THE COST OF GRADING AND COMPACTING SUBBASE FOR SIDEWALK OR DRIVEWAYS SHALL BE INCLUDED IN THE COST OF SIDEWALK REMOVAL OR DRIVEWAY PAVEMENT REMOVAL.
- THE FINISHED EARTHWORK SHALL HAVE A VEGETATION SUSTAINING SOIL COVERING THE TOP FOUR INCHES IN AREAS TO BE SEEDED OR SODDED. THE VEGETATION SUSTAINING SOIL REQUIRED WILL NOT BE PAID FOR SEPARATELY BUT WILL BE INCLUDED IN THE COST OF THE LANDSCAPING, SPECIAL PAY ITEM.
- THE FOLLOWING RATES OF APPLICATION HAVE BEEN USED IN CALCULATING PLAN QUANTITIES:  

GRANULAR MATERIALS	2.05 TONS/CU YD
HMA RESURFACING	112 LBS/SQ YD/IN
- THE COST OF EXCAVATING AND DISPOSING OF MATERIAL BELOW AND/OR OUTSIDE OF EXISTING SIDEWALKS OR CURBS OR DRIVEWAYS AS REQUIRED TO INSTALL THE SPECIFIED AGGREGATE BASE AND AS MAY BE NECESSARY TO INSTALL FORMWORK SHALL BE CONSIDERED INCLUDED IN THE COST OF THE SIDEWALK, CURB, AND DRIVEWAY PAY ITEMS.
- THE FINISHED SURFACE OF SIDEWALKS SHALL HAVE A CROSS-SLOPE (MEASURED PERPENDICULAR TO THE TRAVEL DIRECTION) LESS THAN OR EQUAL TO 2%.
- WHERE 4' SIDEWALK WIDTHS ARE USED, ENSURE THAT A MINIMUM 5'x5' PASSING SPACE WITH SLOPE IN ANY DIRECTION NO MORE THAN 2% IS PROVIDED AT INTERVALS OF NO MORE THAN 200'. SUCH PASSING SPACES MAY BE PROVIDED USING ADJACENT SECTIONS OF 5' WIDE SIDEWALK OR USING DRIVEWAY PAVEMENTS.
- WHERE EXCAVATIONS ARE MADE OUTSIDE OF CURBS OR CURB AND GUTTER TO ALLOW FOR FORMWORK, SUCH EXCAVATIONS SHALL BE FILLED TO THE BOTTOM OF THE PROPOSED INCIDENTAL HMA USING CONTROLLED LOW STRENGTH MATERIAL OR USING CONCRETE. THIS WORK SHALL BE CONSIDERED INCLUDED IN THE COST OF THE CURB AND GUTTER PAY ITEM.
- WHERE INCIDENTAL HMA SURFACING IS SPECIFIED, REMOVAL OF EXISTING PAVEMENTS OR AGGREGATES TO A DEPTH AS REQUIRED TO CONSTRUCT THE 4" THICK INCIDENTAL HMA SURFACE ALONG WITH GRADING AND COMPACTING OF THE BASE WILL NOT BE PAID FOR SEPARATELY, BUT SHALL BE CONSIDERED INCLUDED IN THE COST OF THE INCIDENTAL HMA SURFACING PAY ITEM.
- REMOVED SIGN PANELS AND POSTS SHALL BE DELIVERED TO OWNER AT A LOCATION TO BE NAMED BY OWNER WITHIN THE VILLAGE LIMITS.
- CONCRETE FOUNDATION, TYPE A SHALL INCLUDE THE COST OF FURNISHING AND INSTALLING THE ANCHOR BOLTS PER ARTICLE 1077.01(C) OF THE STANDARD SPECIFICATIONS ALONG WITH THE GROUND ROD AND CONDUIT SWEEP ELBOW.

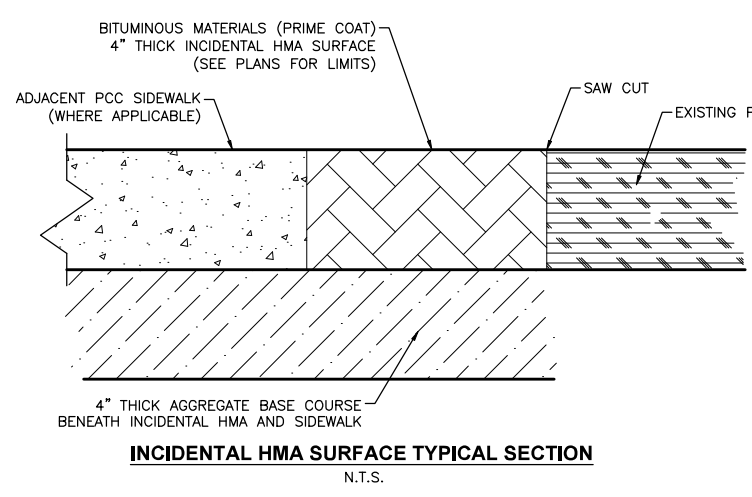
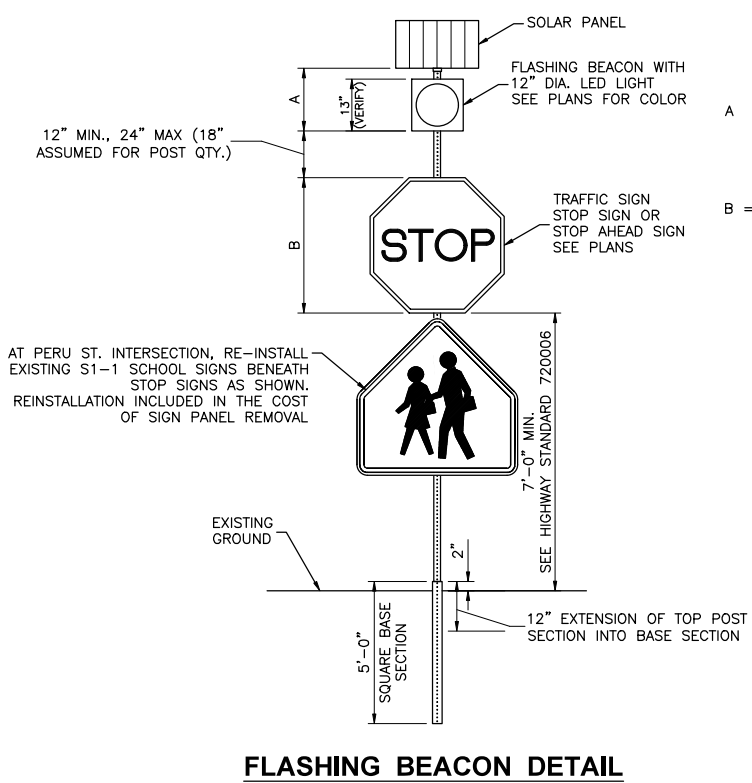

**TYPICAL SPACING DETAIL FOR CROSSWALKS AND STOP BARS**

HMA MIXTURE REQUIREMENT TABLE	
LOCATIONS:	ENTIRE PROJECT
MIXTURE USE(S):	INCIDENTAL HMA
BINDER GRADE (PG):	PG 64-22
DESIGN AIR VOIDS:	4.0% @ N50
MIXTURE COMPOSITION: (MIXTURE GRADATION)	IL 9.5
FRICTION AGGREGATE:	MIXTURE C
MIXTURE WEIGHT:	112.0 LB/SY/IN
QUALITY MANAGEMENT PROGRAM:	QCQA
SUBLOT SIZE:	N/A
DENSITY TEST METHOD:	SATISFACTION OF ENGINEER
MATERIAL TRANSFER DEVICE (REQUIRED):	NO

DRAWN BY: KED	REVISIONS			
	LEVEL	BY	DATE	DESCRIPTION
CHECKED BY: AJ0				
DATE: OCTOBER 2023				

PERU MORRIS  
OTTAWA MENDOTA  
ILLINOIS

**LADD SAFE ROUTES TO SCHOOL  
SECTION 22 - 00023 - 00 - SW  
LADD, ILLINOIS**

**GENERAL NOTES  
AND DETAILS**

**CONTRACT NO. 87842**

CURRENT AS OF: 10/3/2023	
SCALE: AS NOTED	SHEET 2
FILE NO.: 66396.00 Y-	OF 10

CHAIKH & ASSOCIATES, INC. © 2023  
 Drawing Name: C:\Users\A\66396-IG-Lans-Roadlet-0-School-2021\CAD\003-520.dwg  
 Last Modified: Tuesday, October 3, 2023 11:22:27 AM  
 Plotted On: Wednesday, December 30, 2023 2:42:40 PM  
 by: Adam Davis

### SUMMARY OF QUANTITIES

IDOT Pay Item #	Description	Unit	Quantity
35101400	AGGREGATE BASE COURSE, TYPE B	TON	427
40200800	AGGREGATE SURFACE COURSE, TYPE B	TON	74
40600275	BITUMINOUS MATERIALS (PRIME COAT)	POUND	328
40800050	INCIDENTAL HOT-MIX ASPHALT SURFACING	TON	35
42300200	PORTLAND CEMENT CONCRETE DRIVEWAY PAVEMENT, 6 INCH	SQ YD	245
42400100	PORTLAND CEMENT CONCRETE SIDEWALK 4 INCH	SQ FT	10555
42400300	PORTLAND CEMENT CONCRETE SIDEWALK 6 INCH	SQ FT	2506
42400800	DETECTABLE WARNINGS	SQ FT	388
44000200	DRIVEWAY PAVEMENT REMOVAL	SQ YD	230
44000500	COMBINATION CURB AND GUTTER REMOVAL	FOOT	92
44000600	SIDEWALK REMOVAL	SQ FT	10260
50105220	PIPE CULVERT REMOVAL	FOOT	14
50800105	REINFORCEMENT BARS	POUND	49
542C0213	PIPE CULVERTS, CLASS C, TYPE 1 8"	FOOT	12
56500600	DOMESTIC WATER SERVICE BOXES TO BE ADJUSTED	EACH	1
60260100	INLETS TO BE ADJUSTED	EACH	2
67100100	MOBILIZATION	LSUM	1
* 72000100	SIGN PANEL - TYPE 1	SQ FT	75
72400100	REMOVE SIGN PANEL ASSEMBLY - TYPE A	EACH	6
* 72800100	TELESCOPING STEEL SIGN SUPPORT	FOOT	77
* 78000400	THERMOPLASTIC PAVEMENT MARKING - LINE 6"	FOOT	278
* 78000600	THERMOPLASTIC PAVEMENT MARKING - LINE 12"	FOOT	276
* 78000650	THERMOPLASTIC PAVEMENT MARKING - LINE 24"	FOOT	36
78300202	PAVEMENT MARKING REMOVAL - WATER BLASTING	SQ FT	242
* 81026350	UNDERGROUND CONDUIT, PVC, 2" DIA.	FOOT	60
* 87301145	ELECTRIC CABLE IN CONDUIT, SIGNAL NO. 12 5C	FOOT	80
* 87800100	CONCRETE FOUNDATION, TYPE A	FOOT	3
* 89501510	RELOCATE EXISTING FLASHING BEACON	EACH	1
* 89502365	REMOVE EXISTING CONCRETE FOUNDATION	EACH	1
* X0325714	FLASHING BEACON, POST MOUNTED, SOLAR POWERED INSTALLATION	EACH	4
X0327618	LANDSCAPING, SPECIAL	L SUM	1
X6060048	COMBINATION CONCRETE CURB AND GUTTER, TYPE B-6.18 (SPECIAL)	FOOT	34
X6060052	COMBINATION CONCRETE CURB AND GUTTER, TYPE B-6.24 (SPECIAL)	FOOT	58
X7010216	TRAFFIC CONTROL AND PROTECTION, (SPECIAL)	L SUM	1

\* SPECIALTY ITEM

**CONTRACT NO. 87842**

DRAWN BY: KED	REVISIONS			
CHECKED BY: AJO	LEVEL	BY	DATE	DESCRIPTION
DATE: OCTOBER 2023				



PERU MORRIS  
OTTAWA MENDOTA  
ILLINOIS

**LADD SAFE ROUTES TO SCHOOL  
SECTION 22 - 00023 - 00 - SW  
LADD, ILLINOIS**

**SUMMARY OF QUANTITIES**

CURRENT AS OF: 12/20/2023	
SCALE: AS NOTED	SHEET 3
FILE NO.: 66396.00 Y-	OF 10





CHAMLIN & ASSOCIATES, INC. © 2023  
 Drawing Name: G:\Users\AJO\OneDrive - Chamlin & Associates, Inc. - Ladd - Safe Routes to School - 2021\CAD\006-LOCUST 01.dwg  
 Last Modified: Monday, October 2, 2023 3:48:18 PM  
 Plotted On: Tuesday, October 3, 2023 11:34:18 AM  
 by Adam Casala

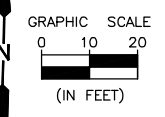
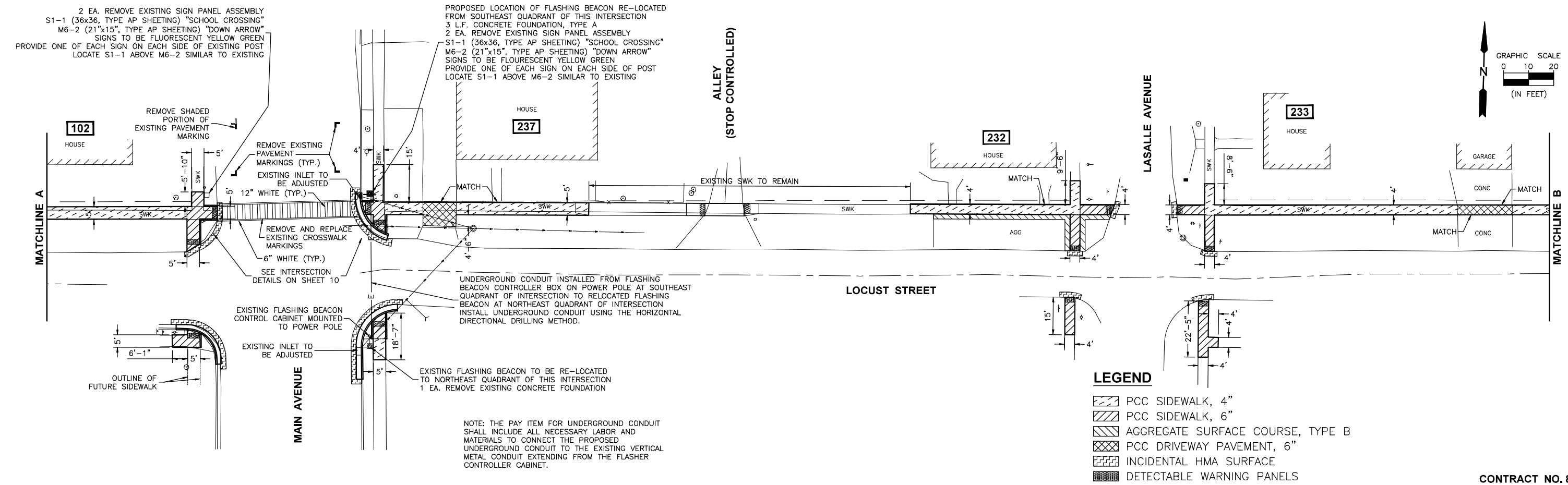
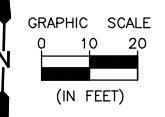
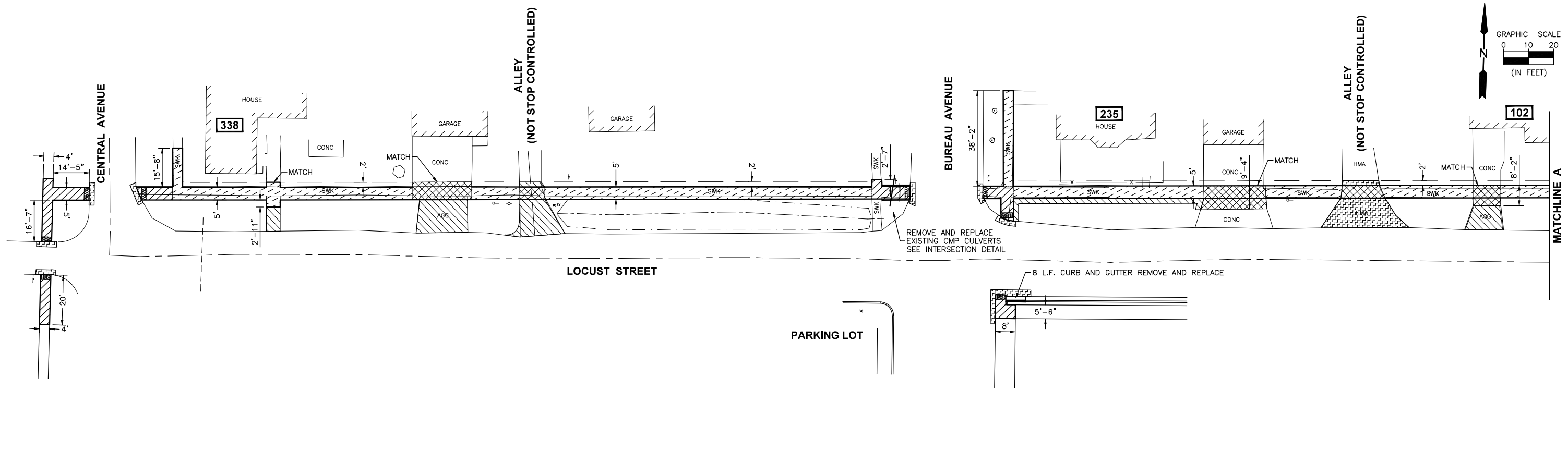

- LEGEND**
- PCC SIDEWALK, 4"
  - PCC SIDEWALK, 6"
  - AGGREGATE SURFACE COURSE, TYPE B
  - PCC DRIVEWAY PAVEMENT, 6"
  - INCIDENTAL HMA SURFACE
  - DETECTABLE WARNING PANELS

NOTE: THE PAY ITEM FOR UNDERGROUND CONDUIT SHALL INCLUDE ALL NECESSARY LABOR AND MATERIALS TO CONNECT THE PROPOSED UNDERGROUND CONDUIT TO THE EXISTING VERTICAL METAL CONDUIT EXTENDING FROM THE FLASHER CONTROLLER CABINET.

DRAWN BY: KED	REVISIONS			
CHECKED BY: AJO	LEVEL	BY	DATE	DESCRIPTION
DATE: OCTOBER 2023				

PERU MORRIS  
OTTAWA MENDOTA  
ILLINOIS

**LADD SAFE ROUTES TO SCHOOL  
SECTION 22 - 00023 - 00 - SW  
LADD, ILLINOIS**

**PLAN SHEET  
LOCUST STREET**

CURRENT AS OF: 10/2/2023	
SCALE: AS NOTED	SHEET 6
FILE NO.: 66396.00	OF 10

CONTRACT NO. 87842

CHAMLIN & ASSOCIATES, INC. © 2023  
 Drawing Name: G:\Users\G66396-00\Ladd-Safe-Routes-to-School-2021\CAD\007-LOCUST-02.dwg Last Modified: Tuesday, October 3, 2023 8:49:24 AM Plotted On: Tuesday, October 3, 2023 11:34:28 AM by Adam Osola

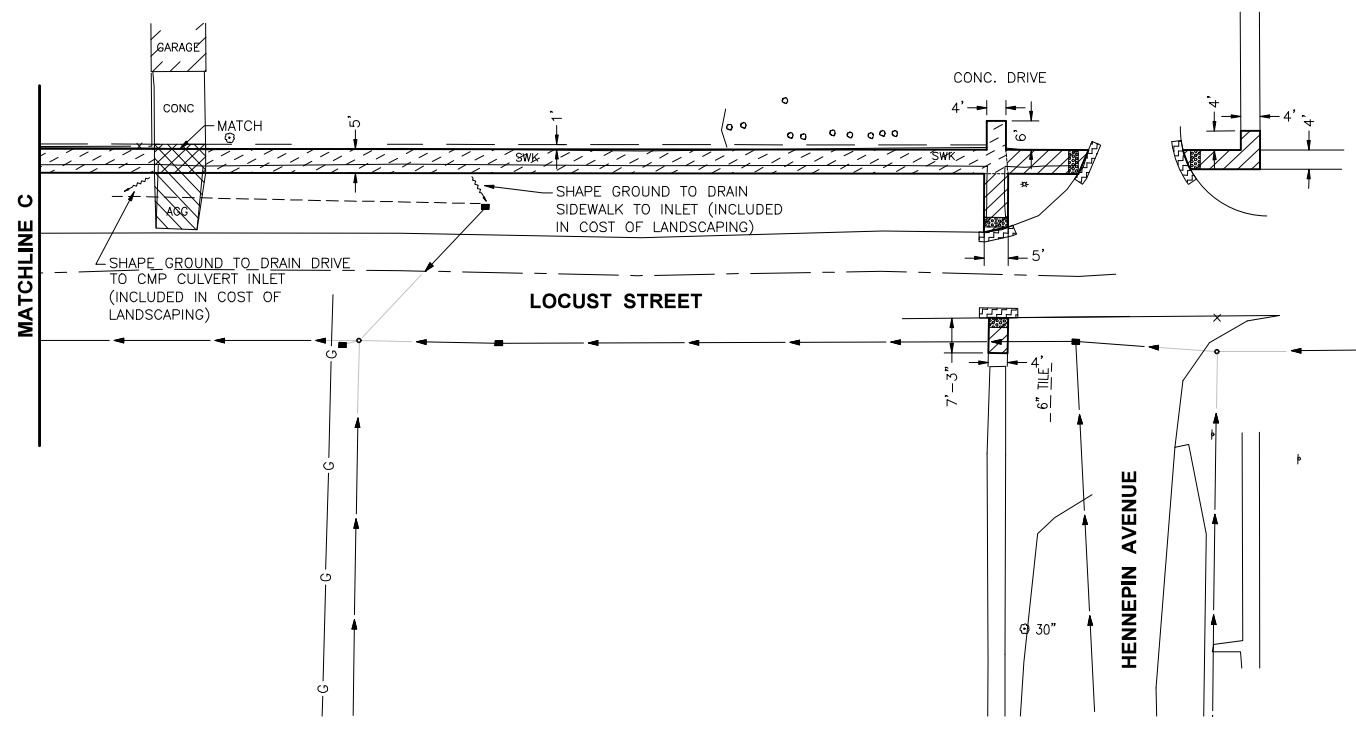
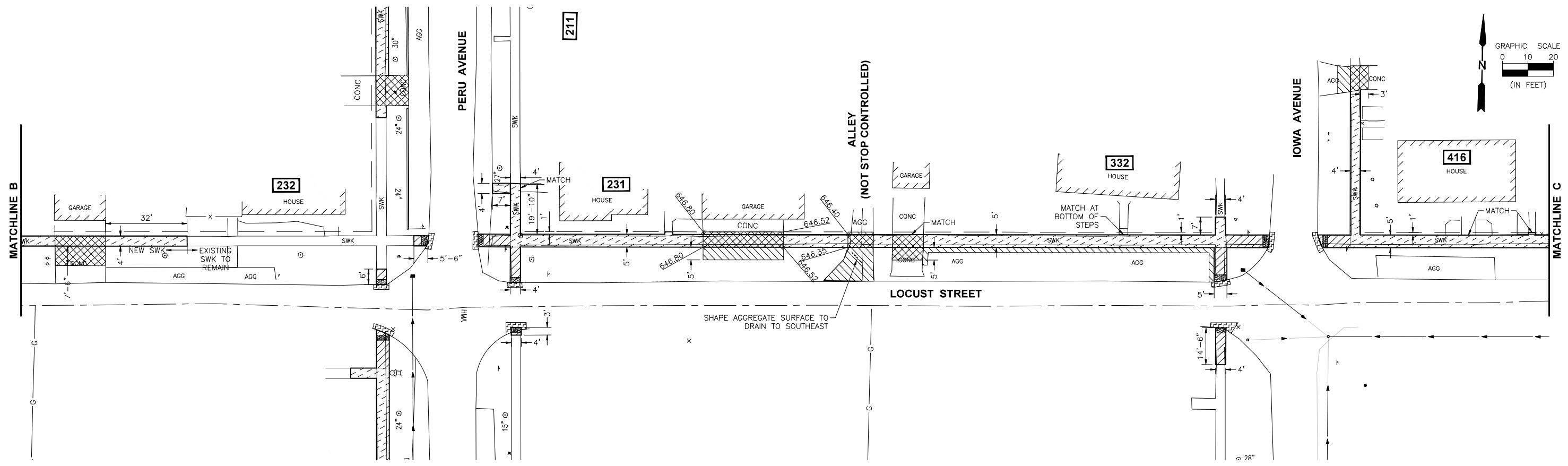

**LEGEND**

- PCC SIDEWALK, 4"
- PCC SIDEWALK, 6"
- AGGREGATE SURFACE COURSE, TYPE B
- PCC DRIVEWAY PAVEMENT, 6"
- INCIDENTAL HMA SURFACE
- DETECTABLE WARNING PANELS

DRAWN BY: KED	REVISIONS			
CHECKED BY: AJO	LEVEL	BY	DATE	DESCRIPTION
DATE: OCTOBER 2023				

PERU MORRIS  
 OTTAWA MENDOTA  
 ILLINOIS

**LADD SAFE ROUTES TO SCHOOL**  
**SECTION 22 - 00023 - 00 - SW**  
**LADD, ILLINOIS**

**PLAN SHEET**  
**LOCUST STREET**

CONTRACT NO. 87842	
CURRENT AS OF: 10/3/2023	
SCALE: AS NOTED	SHEET 7
FILE NO.: 66396.00 Y-	OF 10

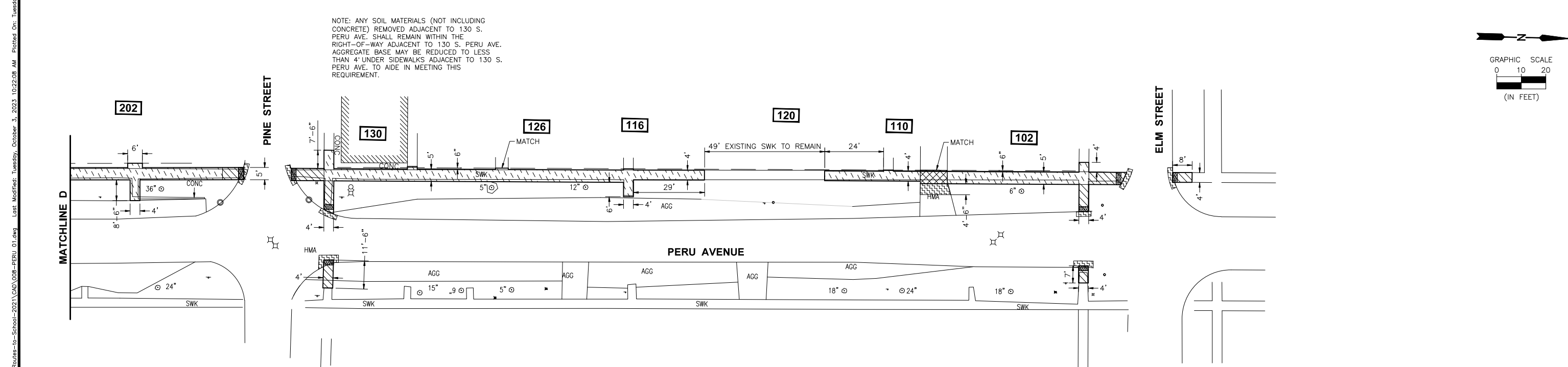
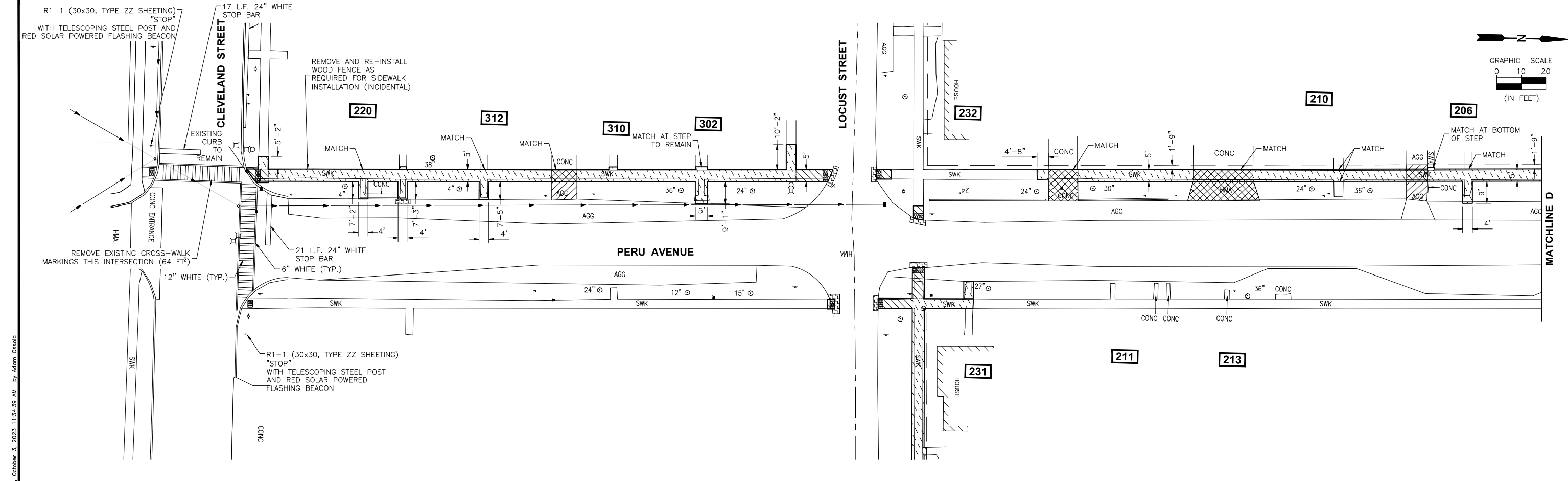

- LEGEND**
- PCC SIDEWALK, 4"
  - PCC SIDEWALK, 6"
  - AGGREGATE SURFACE COURSE, TYPE B
  - PCC DRIVEWAY PAVEMENT, 6"
  - INCIDENTAL HMA SURFACE
  - DETECTABLE WARNING PANELS

DRAWN BY: KED	REVISIONS		PERU MORRIS OTTAWA MENDOTA ILLINOIS	<b>LADD SAFE ROUTES TO SCHOOL SECTION 22 - 00023 - 00 - SW LADD, ILLINOIS</b>	<b>PLAN SHEET PERU AVENUE</b>	CONTRACT NO. 87842
CHECKED BY: AJQ	LEVEL	BY	DATE	DESCRIPTION	CURRENT AS OF: 10/3/2023	SCALE: AS NOTED
DATE: OCTOBER 2023					FILE NO.: 66396.00	SHEET 8 OF 10

CHAMIN & ASSOCIATES, INC. © 2023  
Drawing Name: G:\Users\GJ66396-00\Ladd-Safe-Routes-to-School-2021\CAD\008-PERU\_01.dwg  
Last Modified: Tuesday, October 3, 2023 10:22:08 AM  
Plotted On: Tuesday, October 3, 2023 11:34:39 AM  
by Adam Oniola



CHAMLIN & ASSOCIATES, INC. © 2023  
 Drawing Name: G:\Users\G66396-00\Ladd-Safe-Routes-to-School-2021\CAD\009-CLEVELAND.dwg Last Modified: Tuesday, October 3, 2023 10:25:34 AM Plotted On: Tuesday, October 3, 2023 11:34:50 AM by Adam Ossola

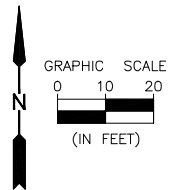
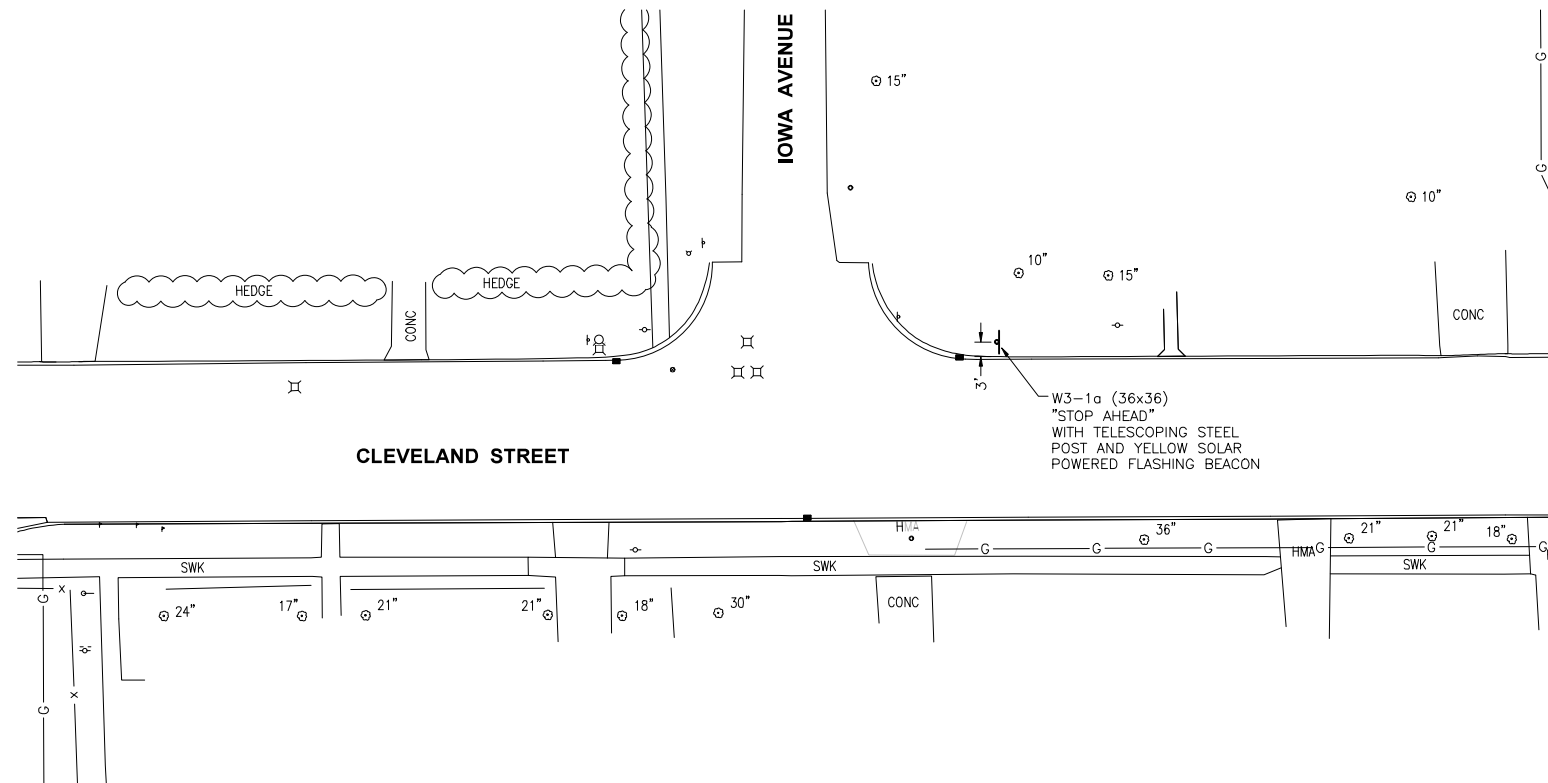
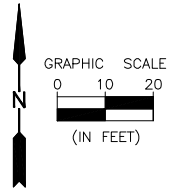
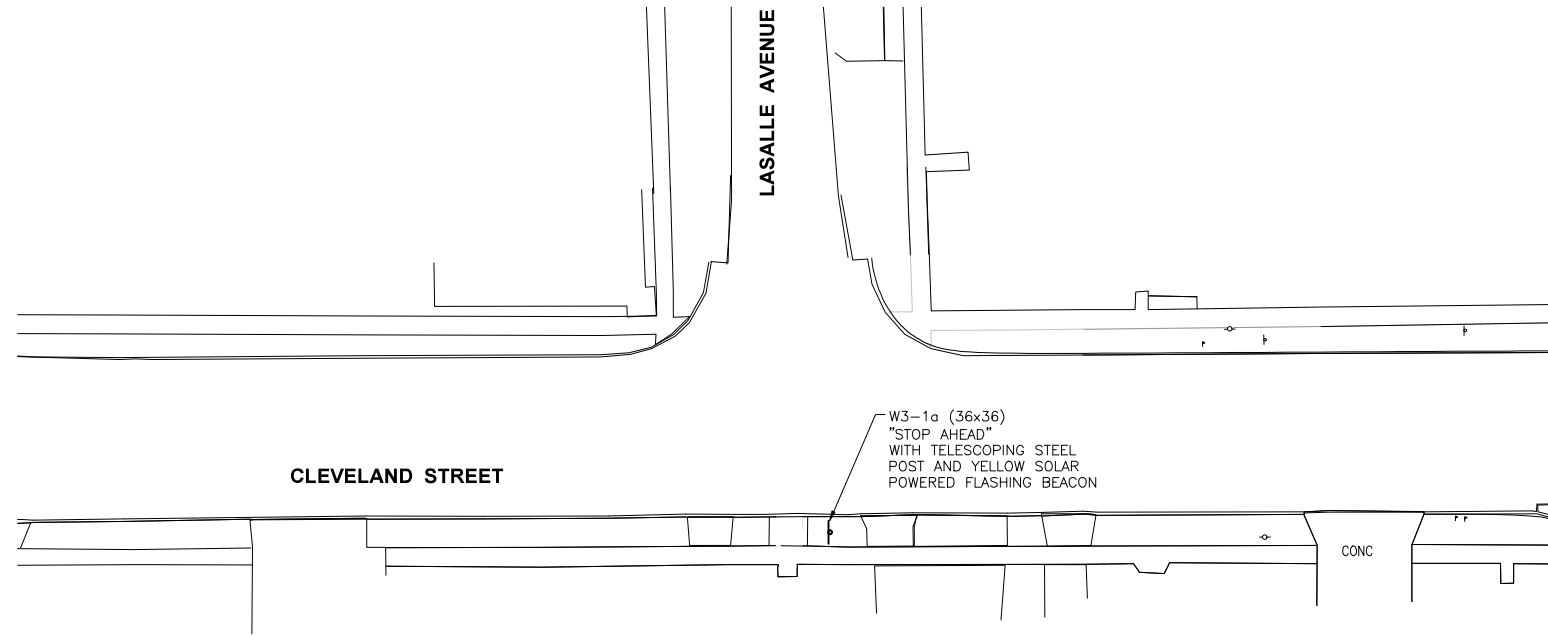

CONTRACT NO. 87842

DRAWN BY: KED	REVISIONS			
CHECKED BY: AJO	LEVEL	BY	DATE	DESCRIPTION
DATE: OCTOBER 2023				

PERU MORRIS  
 OTTAWA MENDOTA  
 ILLINOIS

**LADD SAFE ROUTES TO SCHOOL**  
**SECTION 22 - 00023 - 00 - SW**  
**LADD, ILLINOIS**

**PLAN SHEET**  
**CLEVELAND STREET**

CURRENT AS OF: 10/3/2023	
SCALE: AS NOTED	SHEET 9
FILE NO.: 66396.00 Y-	OF 10

CHAMLIN & ASSOCIATES, INC. © 2023  
 Drawing Name: G:\Users\AJO\OneDrive - Chamlin & Associates, Inc. - Ladd - Safe Routes to School - 2021\CAD\010-ADA-DTLs.dwg Last Modified: Monday, October 2, 2023 2:19:57 PM Plotted On: Tuesday, October 3, 2023 11:34:59 AM by Adam Dasola

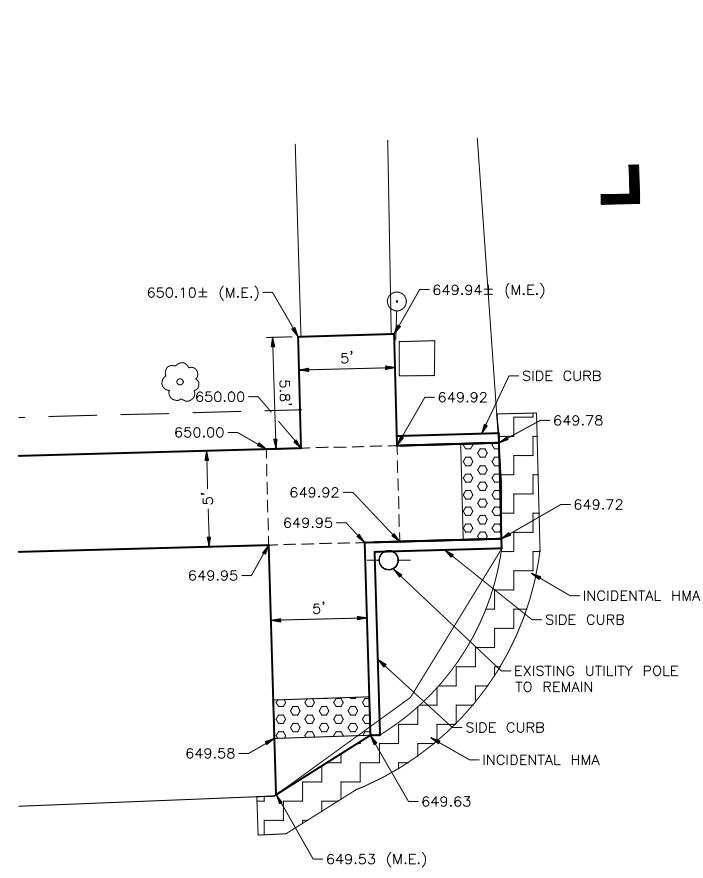

**MAIN ST**

**LOCUST ST**

SAW CUT EXISTING PAVEMENT PRIOR TO REMOVING EXISTING CURB. REMOVAL OF EXISTING PAVEMENT SHALL BE LIMITED TO THAT REQUIRED TO FORM NEW CURB AND BLEND PAVEMENT TO MATCH PROPOSED CURB GRADES AND PROMOTE DRAINAGE

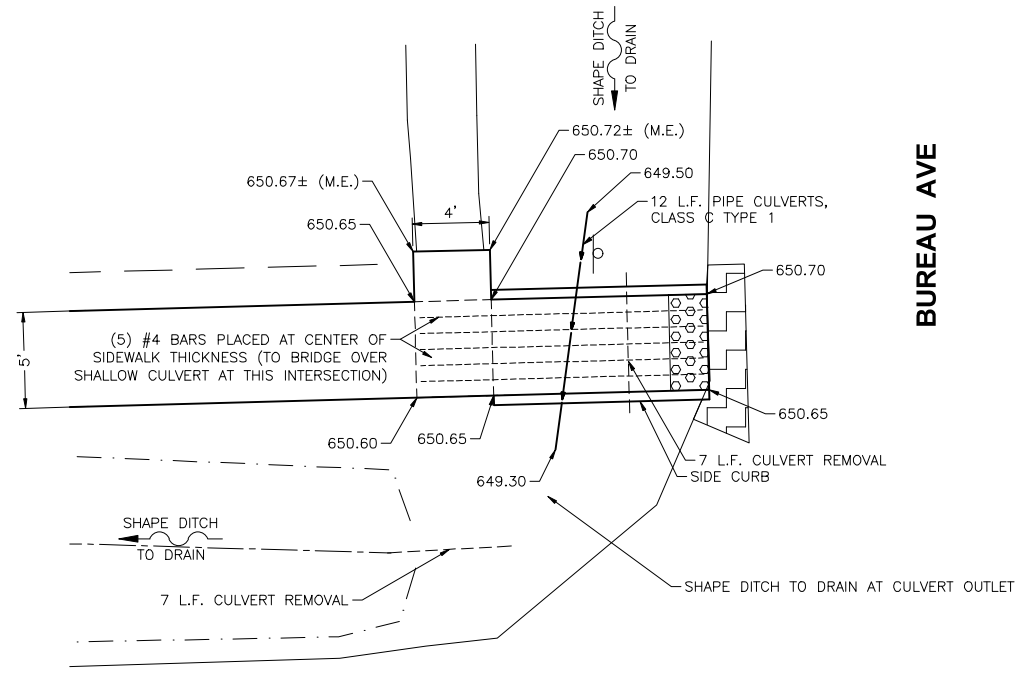
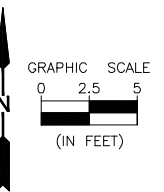
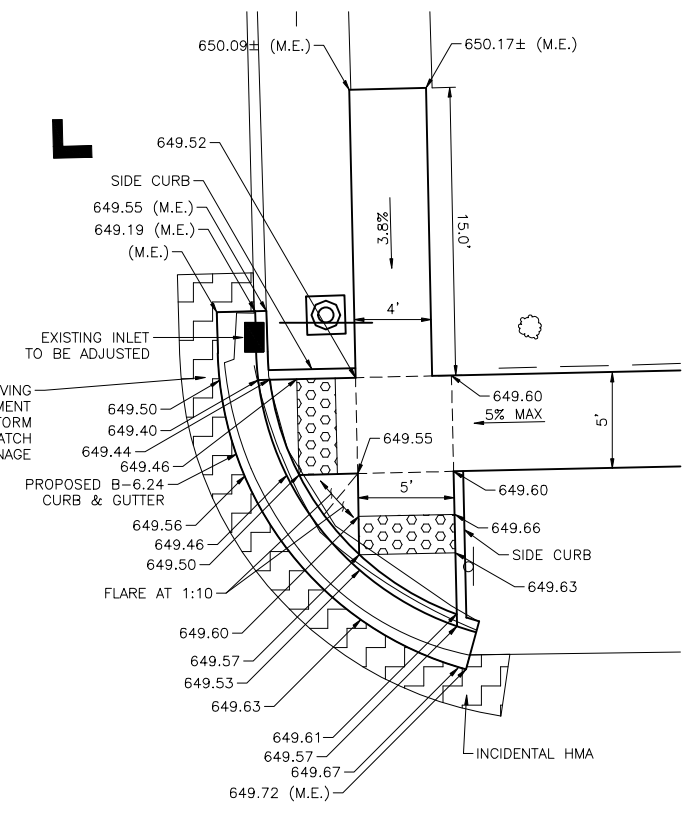

**BUREAU AVE**

**LOCUST ST**

**INTERSECTION DETAIL NORTHWEST QUADRANT  
LOCUST ST AND BUREAU AVE**

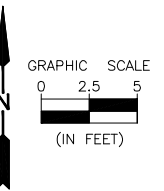

REINFORCEMENT BARS - 49 LB (THIS INTERSECTION)

NOTE: DO NOT SAW CUT OR TOOL JOINTS IN SIDEWALK CONTAINING REINFORCEMENT BARS.  
SHAPING AND GRADING DITCHES AS REQUIRED TO PROMOTE DRAINAGE IS INCLUDED IN THE COST OF THE PIPE CULVERTS

WHERE PIPE CULVERTS ARE BENEATH SIDEWALKS, PROVIDE TRENCH BACKFILL MATERIAL (USE SAME MATERIAL AS FOR AGGREGATE BASE) FROM 4" BELOW PIPE, SURROUNDING PIPE, AND TO BOTTOM OF 4" AGGREGATE BASE BENEATH SIDEWALK. FURNISHING AND INSTALLING THE TRENCH BACKFILL MATERIAL SHALL BE CONSIDERED INCLUDED IN THE COST OF THE PIPE CULVERTS.

**CONTRACT NO. 87842**

DRAWN BY: KED	REVISIONS			
	LEVEL	BY	DATE	DESCRIPTION
CHECKED BY: AJO				
DATE: OCTOBER 2023				

PERU MORRIS  
OTTAWA MENDOTA  
ILLINOIS

**LADD SAFE ROUTES TO SCHOOL  
SECTION 22 - 00023 - 00 - SW  
LADD, ILLINOIS**

**ADA RAMP DETAILS**

CURRENT AS OF: 10/2/2023	
SCALE: AS NOTED	SHEET 10
FILE NO.: 66396.00 Y-	OF 10