

F.A.P. RTE.	SECTION	COUNTY	TOTAL SHEETS	SHEET NO.
343	*	COOK	283	27
STA. 9+713.000 TO STA. 10+151.000				
FED. ROAD DIST. NO. 1 ILLINOIS FED. AID PROJECT				
* 70D-Y-B-R & 70HB-R-1 62897				

NOTES:

1. ALL DIMENSIONS ARE IN METERS (m) UNLESS OTHERWISE NOTED
2. FOR BRIDGE INFORMATION SEE STRUCTURAL PLANS
3. FOR TRANSITION OF THE RIGHT SIDE OF ROADWAY FROM SUPERELEVATED EXISTING CONDITION TO NORMAL CROWN PROPOSED CONDITION, AT THE BEGINNING OF THE PROJECT, SEE TABLE THIS SHEET
4. FOR PROPOSED GUARDRAIL LOCATIONS SEE PAVEMENT MARKING AND LANDSCAPING PLANS
5. FOR PROPOSED FENCE SEE PAVEMENT MARKING AND LANDSCAPING PLANS
6. FOR MORE SUPERELEVATION INFORMATION SEE SUPERELEVATION TRANSITION DETAIL
7. FOR MORE BUTT JOINT INFORMATION SEE BUTT JOINT DETAILS.

PAVEMENT SLOPE TRANSITION RIGHT SIDE	
STATION	SLOPE
9+713.000	0.00%
9+733.000	-2.00%

LEGEND:

- 1 PCC PAVEMENT, 260 mm (JOINTED)
- 2 AGGREGATE SUBGRADE 300 mm
- 3 STABILIZED SUB-BASE 115 mm

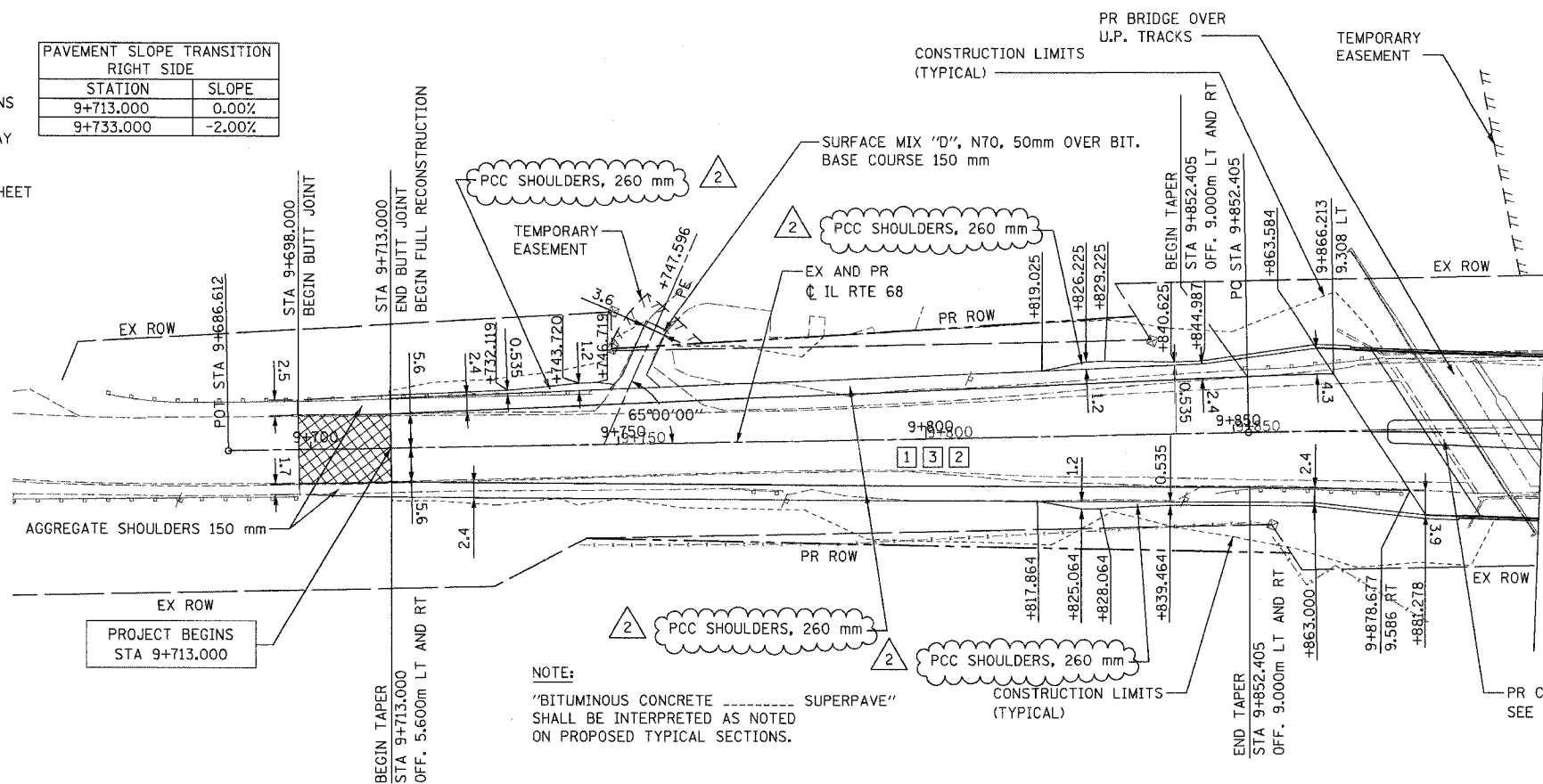

PROP. CURVE 68_CURVE.1
 PI STA = 9+966.854
 $\Delta = 14^\circ 54' 14''$ (RT)
 R = 875.000 m
 T = 114.450 m
 L = 227.607 m
 E = 7.453 m
 $e = 2.4\%$
 T.R. = 27.500 m
 S.E. RUN. = 33.000 m
 P.C. STA = 9+852.405
 P.T. STA = 10+080.012

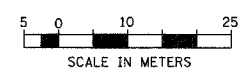

2 REV 2-15-07

PLAN	SURVEYED	DATE
	BY	
	NO. _____	
	RT. OF WAY CHECKED	
	CADD FILE NAME	

PROFILE	SURVEYED	DATE
	BY	
	NO. _____	
	GRADES CHECKED	
	B.M. NOTED	
	STRUCTURE NOTATIONS CHKD	

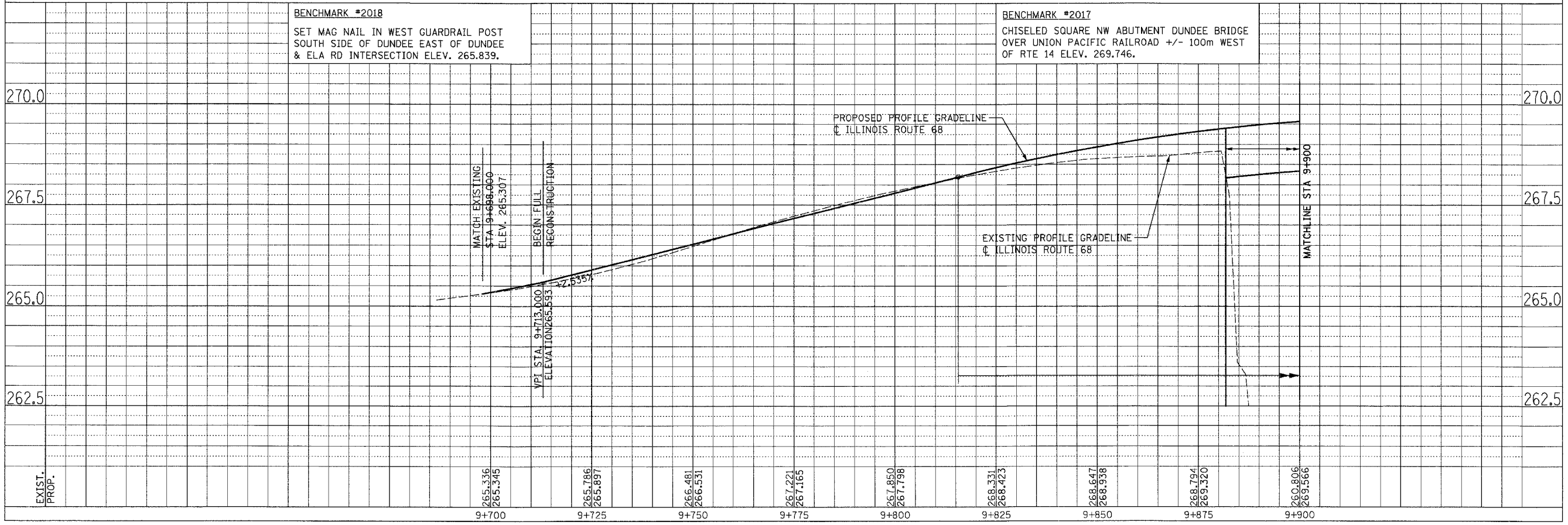

SCALE: H= 1:500, V=1:50 IL ROUTE 68-PROPOSED PLAN AND PROFILE -1