

F.A.P. RTE.	SECTION	COUNTY	TOTAL SHEETS	SHEET NO.
567	34X-BR	DEKALB	90	5
STA.		TO STA.		
FED. ROAD DIST. NO.		ILLINOIS FED. AID PROJECT		

HORIZONTAL AND VERTICAL CONTROL

BENCH MARKS
SEE PLAN & PROFILE SHEETS FOR BENCH MARK DATA.

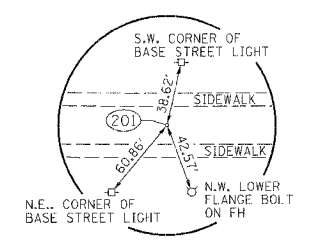
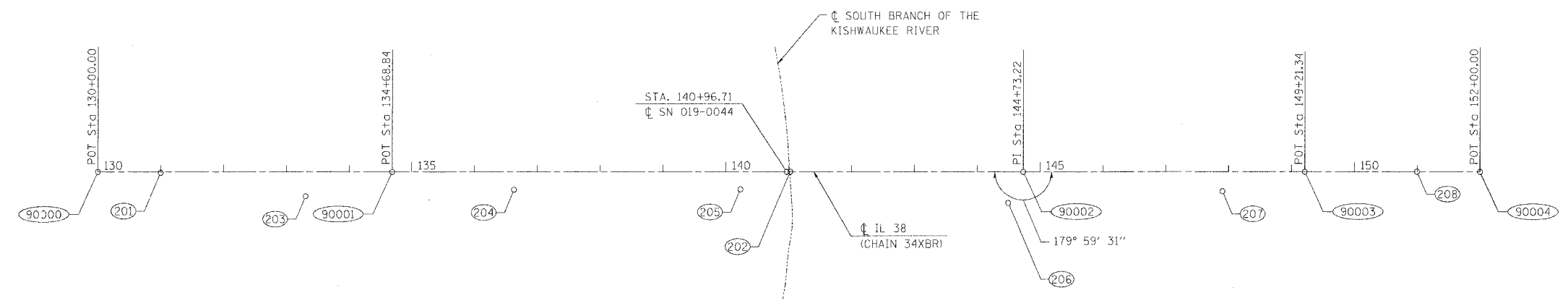
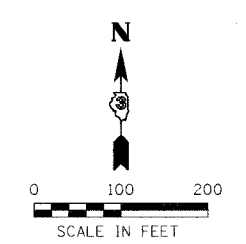

HORIZONTAL CONTROL
POINT NO. 201
STA. 130+99.87, 1.30' RT.

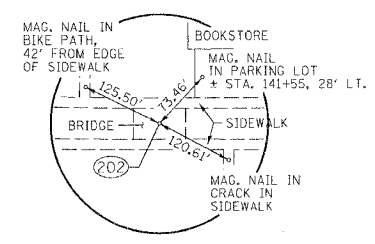

HORIZONTAL CONTROL
POINT NO. 202
STA. 141+02.40, 0.10' LT.

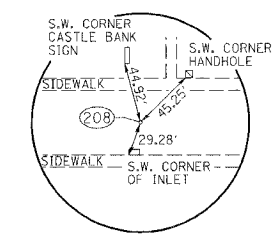

HORIZONTAL CONTROL
POINT NO. 208
STA. 150+99.68, 0.10' LT.

Chain 34XBR contains:
90000 90001 90002 90003 90004

Beginning chain 34XBR description

Point 90000	N	30,001.4432 E	28,897.6009 S-o	130+00.00
Course from 90000 to 90001: S 89° 55' 10.85" E Dist 468.8385				
Point 90001	N	30,000.7860 E	29,366.4390 Sta	134+68.84
Course from 90001 to 90002: S 89° 55' 10.85" E Dist 1,004.3860				
Point 90002	N	29,999.3780 E	30,370.8240 Sta	144+73.22
Course from 90002 to 90003: S 89° 54' 41.94" E Dist 448.1165				
Point 90003	N	29,998.6870 E	30,818.9400 Sta	149+21.34
Course from 90003 to 90004: S 89° 54' 41.94" E Dist 278.6590				
Point 90004	N	29,998.2573 E	31,097.5986 Sta	152+00.00

Ending chain 34XBR description

CHAIN	POINT	NORTHING	EASTING	STATION	OFFSET	DESCRIPTION
34XBR	201	30000.000	28997.4650	130+99.87	1.3032' RT.	MAG. NAIL
34XBR	202	30000.000	30000.0000	141+02.40	0.1022' LT.	MAG. NAIL
34XBR	203	29961.8770	29228.2830	133+30.74	39.1026' RT.	NAIL & BOTTLE CAP
34XBR	204	29971.8580	29560.3530	136+62.79	28.6561' RT.	NAIL & BOTTLE CAP
34XBR	205	29972.1280	29920.6830	140+23.12	27.8810' RT.	NAIL & BOTTLE CAP
34XBR	206	29949.9040	30346.9630	144+49.43	49.5074' RT.	IRON PIN (PROP. COR.)
34XBR	207	29967.7130	30687.7280	147+90.18	31.1763' RT.	NAIL & BOTTLE CAP
34XBR	208	29998.5157	30997.2839	150+99.68	0.1037' LT.	MAG. NAIL

* POINT HAS NO RECORDED TIES.

DATE = 10/25/06
FILE NAME = 10/25/06
PLOT SCALE = 1"=100'
REFERENCE = 10/25/06
OPERATOR = JSB

NAME	DATE
IDOT REVIEW	10/25/06

ILLINOIS DEPARTMENT OF TRANSPORTATION
HORIZONTAL AND VERTICAL CONTROL
FAP RTE 567 (IL RTE 38)
SECTION 34X-BR
DEKALB COUNTY

SCALE: VERT. 1" = 100'
HORIZ. 1" = 100'
DATE 9/30/05

DRAWN BY SUTHEARD
CHECKED BY BOTT

GREENE & BRADFORD, INC.
OF SPRINGFIELD
CONSULTING ENGINEERS
REGISTERED PROFESSIONAL ENGINEERS
PROFESSIONAL DESIGNERS, P.E. & SURVEYORS
SINCE 1954, 525 W. 40TH ST., SPRINGFIELD, ILL. 62761-2000

COMPUTER FILE NO. D10800HVC
PROJECT 05198
10/25/06-GSJ

HORIZONTAL AND VERTICAL CONTROL