

F.A.I. RTE.	SECTION	COUNTY	TOTAL SHEETS	SHEET NO.
39	141 / 201	•	46	9
STA. 1480+00		TO STA. 1510+00		
FED. ROAD DIST. NO.		ILLINOIS	FED. AID PROJECT	
•OGLE / WINNEBAGO				

U.S.G.S. DATUM
5th G.A. (1929)

Lt. Sta. 1480+19.46 C.F.A. 412
End 10" C.R.P.C.C. Pavement
Begin Bridge Appr. Slab Pavement
2" Exp. Joint W/ Dowel Bars

Limits of Bridge Approach
Slab Pavement (Std. 2353)

Lt. Sta. 1484+50.21 C.F.A. 412
End Bridge Appr. Slab Pavement
Begin 10" C.R.P.C.C. Pavement
2" Exp. Joint W/ Dowel Bars

Sta. 1487+75
2-Type F. Inlet Box
118-L.F. P.D. CS 12"
2-End Sections
4-16 Ga. C.S. Diaphragms-12"
20 S.Y. P.C.C. Shoulders
2 CONC. THRUST BLOCKS

Sta. 1489+55
2-Type F. Inlet Box
20 S.Y. P.C.C. Shoulders

Sta. 1489+80
2-Type F. Inlet Box
174-L.F. P.D. CS 12"
2-End Sections
4-16 Ga. C.S. Diaphragms-12"
20 S.Y. P.C.C. Shoulders
2 CONC. THRUST BLOCKS

SEC. 20, T40N, R2E, 3rd P.M.

Sta. 14+60.72 B Ramp "D"
End 10" J.R.P.C.C. Pavement
Begin 10" C.R.P.C.C.

PROPOSED HH 6
(STA. 1509+00, 205'L)

P.O.T. Sta. 14+60.72 B Ramp "D"
Sta. 1504+67.01 C.F.A. 412, 88.00' LT.

SCALE 1" = 100'

TREE LINE

MATCH LINE
STA. 1510+00

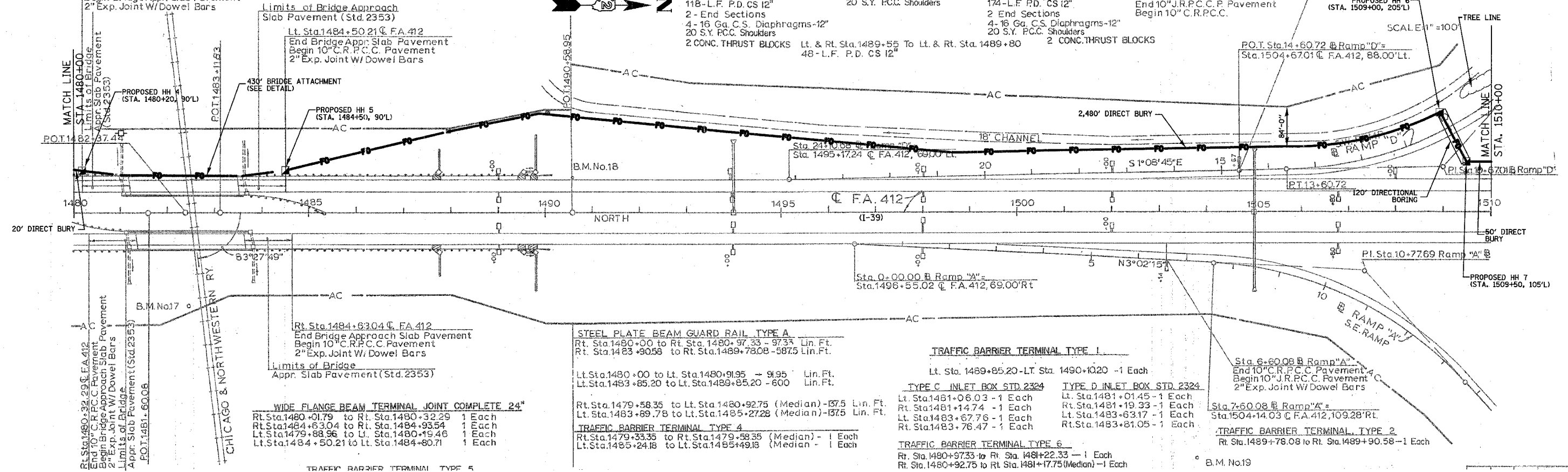

WIDE FLANGE BEAM TERMINAL JOINT COMPLETE 24"

Rt. Sta. 1480+01.79	to Rt. Sta. 1480+32.29	1 Each
Rt. Sta. 1484+63.04	to Rt. Sta. 1484+93.54	1 Each
Lt. Sta. 1479+88.96	to Lt. Sta. 1480+19.46	1 Each
Lt. Sta. 1484+50.21	to Lt. Sta. 1484+80.71	1 Each

STEEL PLATE BEAM GUARD RAIL TYPE A
Rt. Sta. 1480+00 to Rt. Sta. 1480+97.33 - 97.33 Lin. Ft.
Rt. Sta. 1483+90.58 to Rt. Sta. 1489+78.08 - 587.5 Lin. Ft.

Lt. Sta. 1480+00 to Lt. Sta. 1480+91.95 - 91.95 Lin. Ft.
Lt. Sta. 1483+85.20 to Lt. Sta. 1489+85.20 - 600 Lin. Ft.

Rt. Sta. 1479+58.35 to Lt. Sta. 1480+92.75 (Median) - 137.5 Lin. Ft.
Lt. Sta. 1483+69.78 to Lt. Sta. 1485+27.28 (Median) - 137.5 Lin. Ft.

TRAFFIC BARRIER TERMINAL TYPE 4
Rt. Sta. 1479+33.35 to Rt. Sta. 1479+58.35 (Median) - 1 Each
Lt. Sta. 1485+24.18 to Lt. Sta. 1485+49.18 (Median) - 1 Each

TRAFFIC BARRIER TERMINAL TYPE 1

Lt. Sta. 1489+85.20 - Lt. Sta. 1490+1020 - 1 Each

TYPE C INLET BOX STD. 2324	TYPE D INLET BOX STD. 2324
Lt. Sta. 1481+06.03 - 1 Each	Lt. Sta. 1481+01.45 - 1 Each
Rt. Sta. 1481+14.74 - 1 Each	Rt. Sta. 1481+19.33 - 1 Each
Lt. Sta. 1483+67.76 - 1 Each	Lt. Sta. 1483+63.17 - 1 Each
Rt. Sta. 1483+76.47 - 1 Each	Rt. Sta. 1483+81.05 - 1 Each

Sta. 6+60.08 B Ramp "A"
End 10" C.R.P.C.C. Pavement
Begin 10" J.R.P.C.C. Pavement
2" Exp. Joint W/ Dowel Bars

Sta. 7+60.08 B Ramp "A"
Sta. 1504+14.03 C.F.A. 412, 109.28' RT.

TRAFFIC BARRIER TERMINAL TYPE 2
Rt. Sta. 1489+78.08 to Rt. Sta. 1489+90.58 - 1 Each

B.M. No. 19

NOTES:
1. TEMPORARY EROSION CONTROL SEEDING SHALL BE PLACED EVERY SEVEN DAYS WITHIN THOSE AREAS THAT HAVE BEEN DISTURBED BY THE INSTALLATION OF THE PROPOSED FIBER OPTIC CABLES IN ACCORDANCE WITH SECTION 280 OF THE STANDARD SPECIFICATIONS.

PLOT DATE = 12/14/2006
 PLOT SCALE = 1" = 100'
 PLOT USER = JUSERR
 PLOT SCALE = 1" = 100'
 PLOT USER = JUSERR