

F.A. RTE.	SECTION	COUNTY	TOTAL SHEETS	SHEET NO.
VAR.	-	**	27	3

* D5 CRACK & JOINT SEAL 2007-2
** DEWITT/PIATT

LOCATION #1 - FAP 71 (IL 54) FROM IL 48 TO MCLEAN COUNTY LINE (RURAL 2-LANE)

LOCATION #2 - FAP 717 (IL10) FROM LOGAN COUNTY LINE TO IL 10/IL 54 JUNCTION IN CLINTON (RURAL/URBAN 2-LANE)

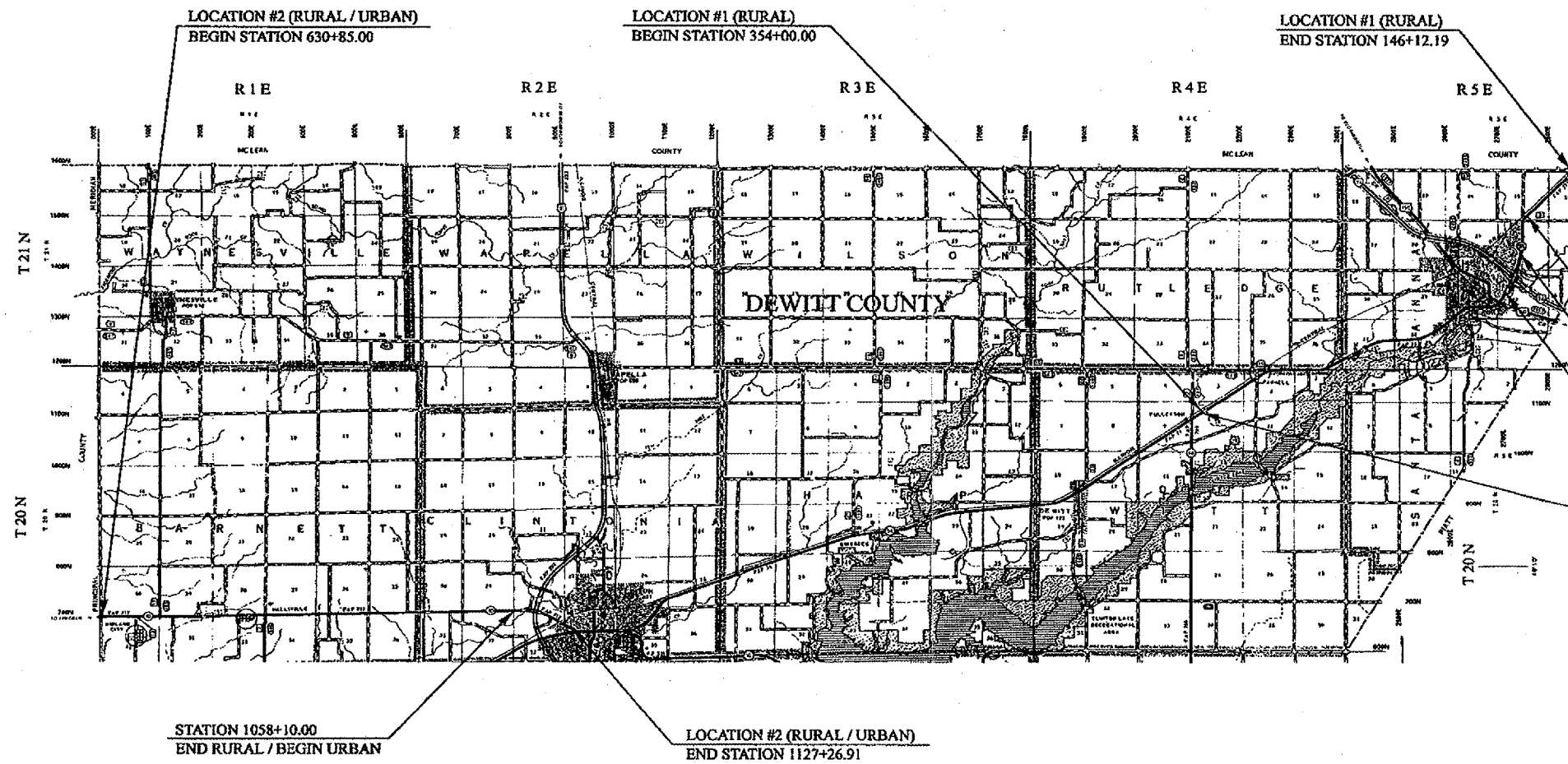

STATION EQUATIONS (LOC #1):

- ① STATION 802+43.40 (BACK) = STATION 78+00.00 (AHEAD)
- ② STATION 1753+53.76 (BACK) = STATION 753+53.76 (AHEAD)
- ③ STATION 720+61.92 (BACK) = STATION 1720+48.96 (AHEAD)
- ④ STATION 2648+16.21 (BACK) = STATION 354+00.00 (AHEAD)

STATION 1058+10.00
END RURAL / BEGIN URBAN

LOCATION #2 (RURAL / URBAN)
END STATION 1127+26.91

BRIDGE OMISSIONS (LOCATION #2):

S.N. 020-0006 - STA. 737+98.00 TO STA. 739+22.00
S.N. 020-0007 - STA. 1069+44.87 TO STA. 1070+51.14

RESURFACING OMISSIONS (LOCATION #2):

STA. 1073+84.00 TO STA. 1094+83.85
STA. 1107+00.00 TO STA. 1116+34.50

TOTAL LENGTH OF LOCATION #2 = 49,641.91 FEET = 9.402 MILES
NET LENGTH OF LOCATION #2 = 46,377.29 FEET = 8.784 MILES

BRIDGE OMISSIONS (LOCATION #1):

S.N. 020-0035 - STA. 1726+72.00 TO STA. 1727+80.50
S.N. 020-0034 - STA. 1734+93.06 TO STA. 1737+68.01
S.N. 020-0012 - STA. 140+81.40 TO STA. 142+74.60

RAILROAD OMISSION (LOCATION #1):

STA. 699+32.85 TO 699+40.85

TOTAL LENGTH OF LOCATION #1 = 51,668.55 FEET = 9.786 MILES
NET LENGTH OF LOCATION #1 = 51,083.90 FEET = 9.675 MILES

