

F.A. RYE.	SECTION	COUNTY	TOTAL SHEETS	SHEET NO.
		**	27	4

LOCATION #3 - FAS 1517 (US 150) FROM DEWITT/PIATT COUNTY LINE TO TR 122B (RURAL 2-LANE)

LOCATION #4 - FAS 1517 (US 150) FROM DEWITT/PIATT COUNTY LINE TO MCLEAN COUNTY LINE (RURAL 2-LANE)

* D5 CRACK & JOINT SEAL 2007-2
 ** DEWITT/PIATT

LOCATION #4 (RURAL)
 END STATION 264+36.50

LOCATION #4 (RURAL)
 BEGIN STATION 0+00.00

LOCATION #3 (RURAL)
 BEGIN STATION 0+00.00

LOCATION #3 (RURAL)
 END STATION 266+55.50 (TR 122B)

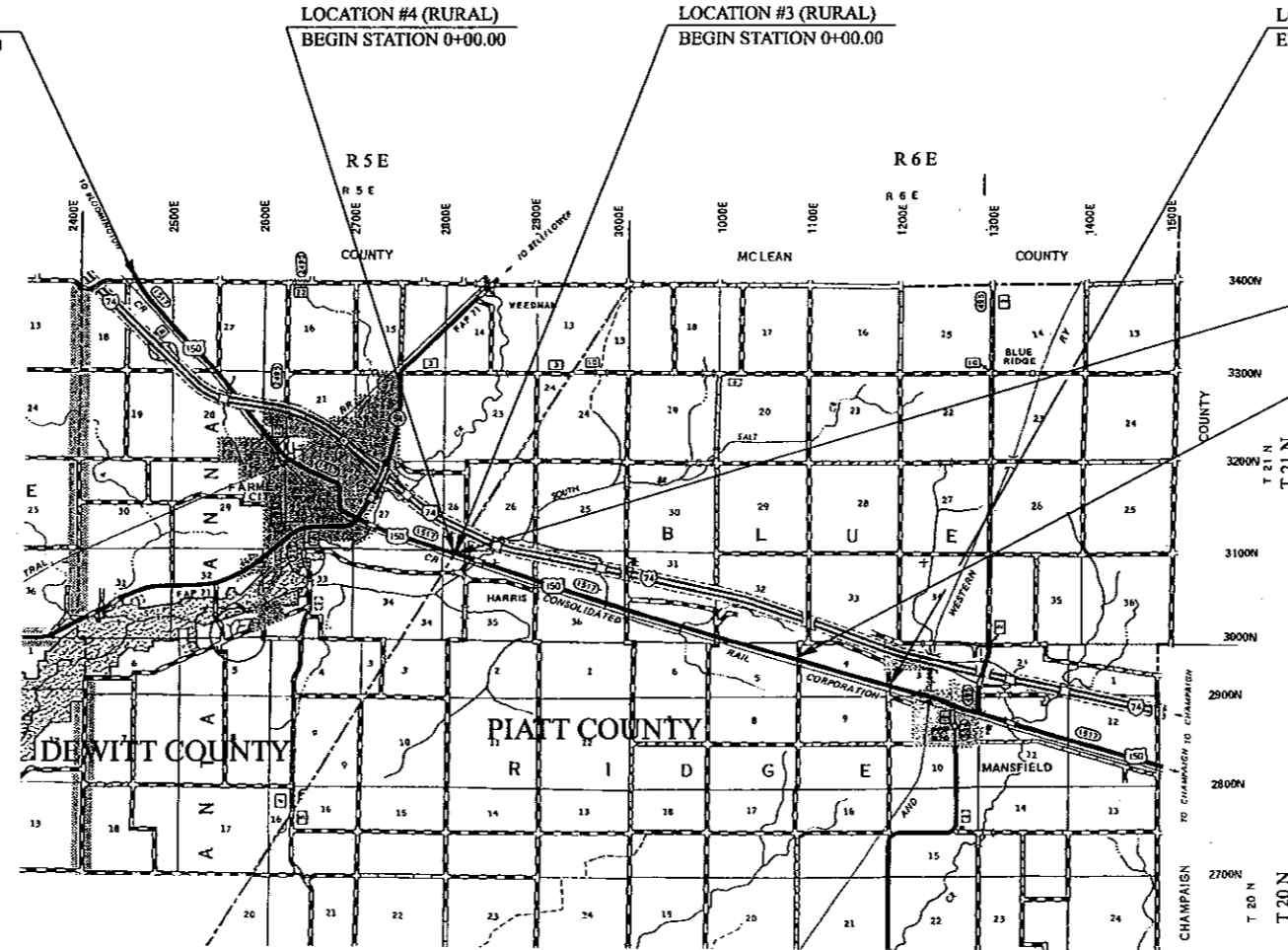

STATION EQUATIONS (LOCATION #3):
 ① STATION 0+00.00 (DEWITT COUNTY - BACK) = STATION 0+00.00 (PIATT COUNTY - AHEAD)
 ② STATION 199+34.30 (BACK) = STATION 206+64.80 (AHEAD)

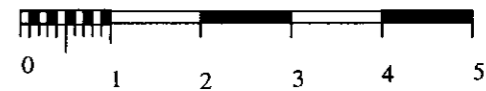

RAILROAD OMISSION (LOCATION #4):
 STATION 121+43.40 TO STATION 126+97.80

BRIDGE OMISSION (LOCATION #3):
 S.N. 074-0008 - STATION 4+93.60 TO STATION 5+56.40

BRIDGE OMISSION (LOCATION #4):
 S.N. 020-0058 - STATION 57+30.00 TO STATION 60+74.00

TOTAL LENGTH OF LOCATION #4 = 26,436.50 FEET = 5.007 MILES
 NET LENGTH OF LOCATION #4 = 25,538.10 FEET = 4.837 MILES

TOTAL LENGTH OF LOCATION #3 = 25,925.00 FEET = 4.910 MILES
 NET LENGTH OF LOCATION #3 = 25,862.20 FEET = 4.898 MILES