

F.A. RTE.	SECTION	COUNTY	TOTAL SHEETS	SHEET NO.
VAR.	*	**	27	6

* D5 CRACK & JOINT SEAL 2007-2
 ** DEWITT/PIATT

LOCATION #6 - FAP 721 (IL 10) FROM DEWITT COUNTY LINE TO I-72 (RURAL 2-LANE)

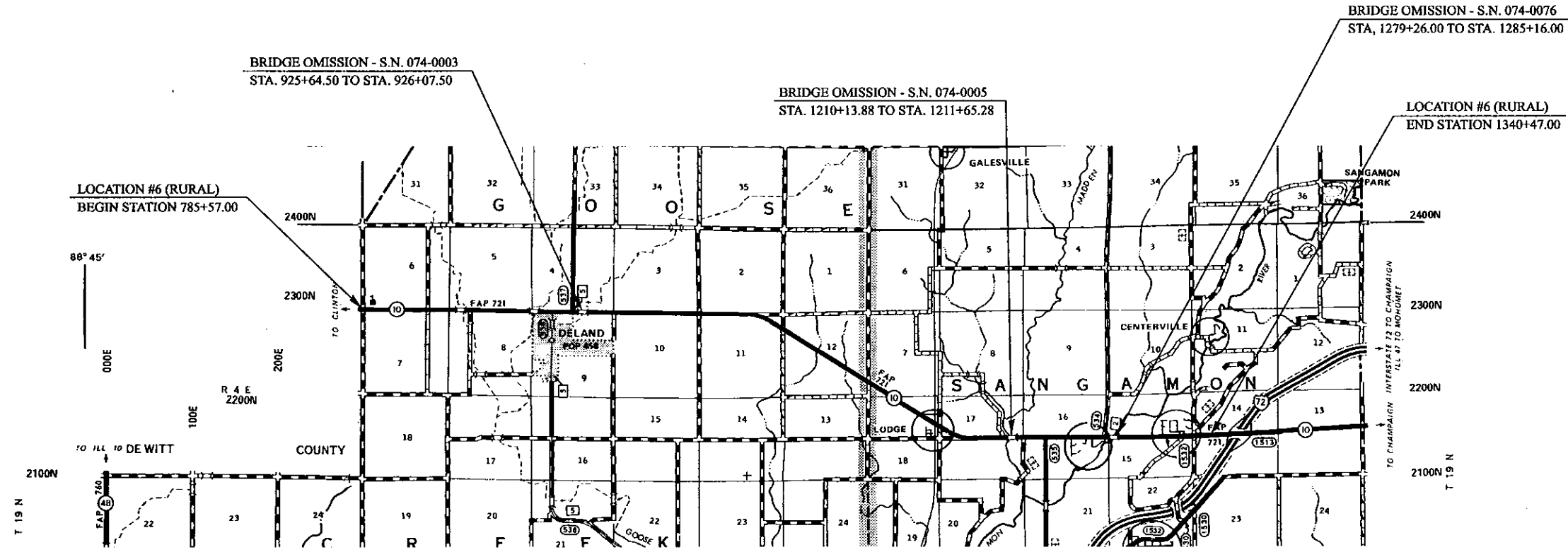

STATION EQUATIONS:
 STA. 825+83.00 (BACK) = STA. 825+88.00 (AHEAD)
 STA. 840+94.70 (BACK) = STA. 841+02.94 (AHEAD)
 STA. 878+94.00 (BACK) = STA. 879+01.00 (AHEAD)
 STA. 883+90.80 (BACK) = STA. 884+00.33 (AHEAD)
 STA. 915+83.60 (BACK) = STA. 915+84.09 (AHEAD)
 STA. 944+90.50 (BACK) = STA. 944+92.50 (AHEAD)
 STA. 984+96.00 (BACK) = STA. 985+00.00 (AHEAD)
 STA. 1024+75.00 (BACK) = STA. 1024+77.00 (AHEAD)

STATION EQUATIONS:
 STA. 1053+90.50 (BACK) = STA. 1053+85.00 (AHEAD)
 STA. 1085+00.00 (BACK) = STA. 1085+02.50 (AHEAD)
 STA. 1116+22.50 (BACK) = STA. 1116+24.00 (AHEAD)
 STA. 1142+55.50 (BACK) = STA. 1142+49.00 (AHEAD)
 STA. 1199+97.00 (BACK) = STA. 1199+97.53 (AHEAD)
 STA. 1273+75.50 (BACK) = STA. 1273+78.50 (AHEAD)
 STA. 1312+04.50 (BACK) = STA. 1312+04.00 (AHEAD)
 STA. 1330+19.00 (BACK) = STA. 1330+22.00 (AHEAD)

RESURFACING OMISSION:
 STA. 1155+87.00 TO STA. 1177+02.00

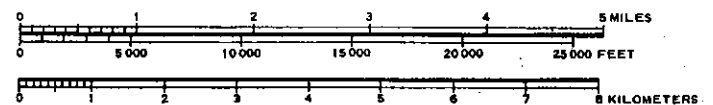

TOTAL LENGTH OF LOCATION #6 = 55,453.71 FEET = 10.503 MILES
 NET LENGTH OF LOCATION #6 = 52,554.31 FEET = 9.953 MILES

PLOT DATE: 11/15/2005
 FILE NAME: c:\pwworkspace\ad877066\100170564\100170564.dwg
 PLOT SCALE: 1/8" = 100'-0"
 USER NAME: phillips