

F.A. RTE. VAR	SECTION	COUNTY	TOTAL SHEETS	SHEET NO.
			27	1

* D5 CRACK & JOINT SEAL 2007-2
 ** DEWITT/PIATT

D-95-079-06

STATE OF ILLINOIS
 DEPARTMENT OF TRANSPORTATION
 DIVISION OF HIGHWAYS

**PROPOSED
 HIGHWAY PLANS**

ROUTE VARIOUS
 SECTION D5 CRACK & JOINT SEAL 2007-2
 DEWITT & PIATT COUNTIES

C-95-079-06
 ROUT & SEAL CRACKS

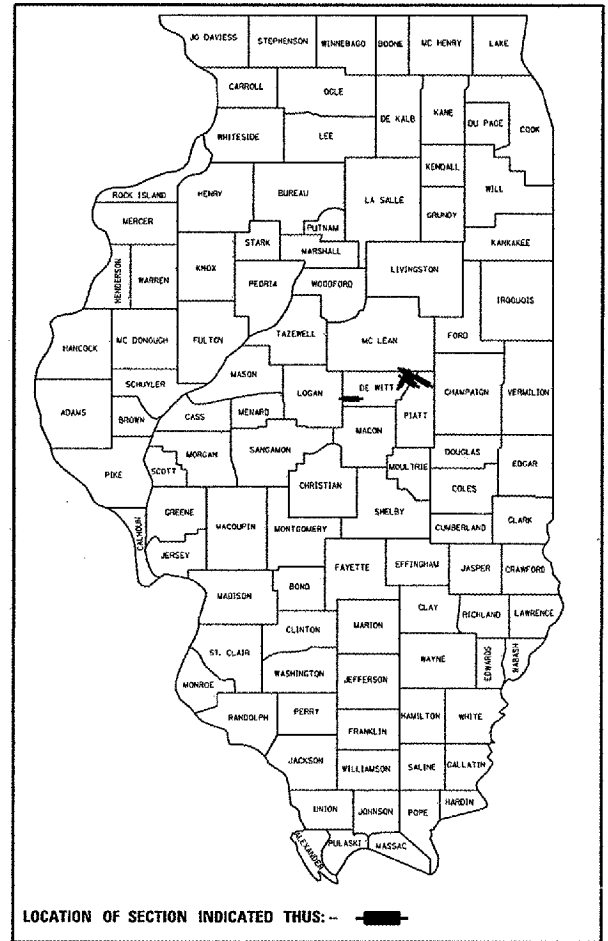

FOR INDEX OF SHEETS, SEE SHEET NO. 2
 FOR SUMMARY OF QUANTITIES, SEE SHEET NO. 8

CURRENT ADT:		
LOCATION #1	2,600	(2006)
LOCATION #2	2,000	(2006)
LOCATION #3	1,550	(2006)
LOCATION #4	1,550	(2006)
LOCATION #5	1,500	(2006)
LOCATION #6	1,650	(2006)

DESIGN DESIGNATION
 N/A

SEE SHEETS 3-6 FOR LOCATION MAPS

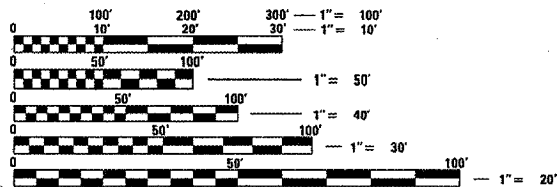

FULL SIZE PLANS HAVE BEEN PREPARED USING STANDARD ENGINEERING SCALES. REDUCED SIZED PLANS WILL NOT CONFORM TO STANDARD SCALES. IN MAKING MEASUREMENTS ON REDUCED PLANS, THE ABOVE SCALES MAY BE USED.

J.U.L.I.E.
 JOINT UTILITY LOCATION INFORMATION FOR EXCAVATION
 1-800-892-0123

FOR TOTAL & NET LENGTHS, SEE SHEETS 3-6

STATE OF ILLINOIS
 DEPARTMENT OF TRANSPORTATION
 DIVISION OF HIGHWAYS

SUBMITTED 11/20 2006
Joseph E. Gowen
 DEPUTY DIRECTOR OF HIGHWAYS, REGION ENGINEER

February 2, 2007
Eric E. Horn
 ENGINEER OF DESIGN AND ENVIRONMENT

February 2, 2007
Milton R. Seay
 DIRECTOR OF HIGHWAYS, CHIEF ENGINEER

PRINTED BY THE AUTHORITY
 OF THE STATE OF ILLINOIS

PROJECT ENGINEER: TIM BRANDENBURG (217)465-4181

PROJECT ENGINEER: TIM BRANDENBURG

SQUAD LEADER: MICHAEL LEROY

DESIGNER: DANA HENNESSY

PLOT DATE: 11/19/2006
 FILE NAME: c:\p\proj\03\0597986 (d)\17255400\01a1.dgn
 USER: MACE
 PLOTTER: HP DesignJet 500

CONTRACT NO. 70564

F.A. RITE.	SECTION	COUNTY	TOTAL SHEETS	SHEET NO.
VAR.	*	**	27	2

* D5 CRACK & JOINT SEAL 2007-2
 ** DEWITT/PIATT

INDEX OF SHEETS

1	COVER SHEET
2	INDEX OF SHEETS / HIGHWAY STANDARDS
3	LOCATION MAP - LOCATIONS #1 AND #2
4	LOCATION MAP - LOCATIONS #3 AND #4
5	LOCATION MAP - LOCATION #5
6	LOCATION MAP - LOCATION #6
7	GENERAL NOTES
8	SUMMARY OF QUANTITIES
9	SCHEDULE OF QUANTITIES
10 - 11	EXISTING TYPICAL CROSS SECTIONS - LOCATION #1
12 - 15	EXISTING TYPICAL CROSS SECTIONS - LOCATION #2
16	EXISTING TYPICAL CROSS SECTIONS - LOCATIONS #3 AND #4
17	EXISTING TYPICAL CROSS SECTIONS - LOCATION #5
18	EXISTING TYPICAL CROSS SECTIONS - LOCATIONS #5 AND #6
19 - 22	EXISTING TYPICAL CROSS SECTIONS - LOCATION #6
23	TYPICAL DETAILS FOR CRACK SEALING FOR BITUMINOUS PAVEMENT
24 - 27	PAVEMENT MARKING AND MARKERS (RURAL AND URBAN APPLICATIONS)

LIST OF HIGHWAY STANDARDS

000001-04	STANDARD SYMBOLS, ABBREVIATIONS AND PATTERNS
001006	DECIMAL OF AN INCH AND OF A FOOT
701306-01	LANE CLOSURE, 2L, 2W, SLOW MOVING OPERATIONS DAY ONLY, FOR SPEEDS ≥ 45 MPH
701311-02	LANE CLOSURE, 2L, 2W, MOVING OPERATIONS - DAY ONLY
701501-03	URBAN LANE CLOSURE, 2L, 2W, UNDIVIDED
702001-06	TRAFFIC CONTROL DEVICES
780001-01	TYPICAL PAVEMENT MARKINGS

F.A. RTE.	SECTION	COUNTY	TOTAL SHEETS	SHEET NO.
VAR.	-	**	27	3

* D5 CRACK & JOINT SEAL 2007-2
 ** DEWITT/PIATT

LOCATION #1 - FAP 71 (IL 54) FROM IL 48 TO MCLEAN COUNTY LINE (RURAL 2-LANE)

LOCATION #2 - FAP 717 (IL10) FROM LOGAN COUNTY LINE TO IL 10/IL 54 JUNCTION IN CLINTON (RURAL/URBAN 2-LANE)

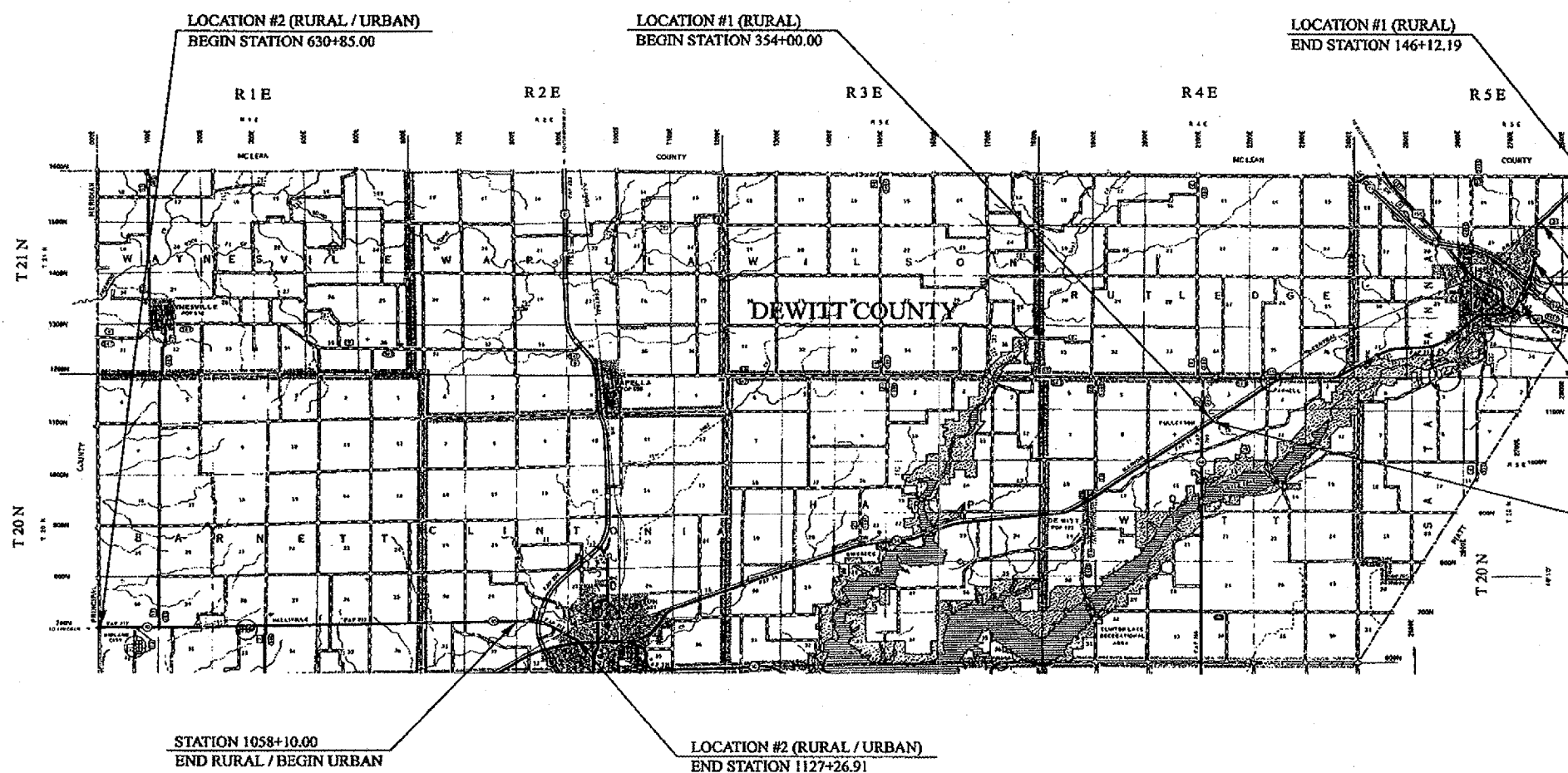

STATION EQUATIONS (LOC #1):

- ① STATION 802+43.40 (BACK) = STATION 78+00.00 (AHEAD)
- ② STATION 1753+53.76 (BACK) = STATION 753+53.76 (AHEAD)
- ③ STATION 720+61.92 (BACK) = STATION 1720+48.96 (AHEAD)
- ④ STATION 2648+16.21 (BACK) = STATION 354+00.00 (AHEAD)

STATION 1058+10.00
 END RURAL / BEGIN URBAN

LOCATION #2 (RURAL / URBAN)
 END STATION 1127+26.91

BRIDGE OMISSIONS (LOCATION #2):

S.N. 020-0006 - STA. 737+98.00 TO STA. 739+22.00
 S.N. 020-0007 - STA. 1069+44.87 TO STA. 1070+51.14

RESURFACING OMISSIONS (LOCATION #2):

STA. 1073+84.00 TO STA. 1094+83.85
 STA. 1107+00.00 TO STA. 1116+34.50

TOTAL LENGTH OF LOCATION #2 = 49,641.91 FEET = 9.402 MILES
 NET LENGTH OF LOCATION #2 = 46,377.29 FEET = 8.784 MILES

BRIDGE OMISSIONS (LOCATION #1):

S.N. 020-0035 - STA. 1726+72.00 TO STA. 1727+80.50
 S.N. 020-0034 - STA. 1734+93.06 TO STA. 1737+68.01
 S.N. 020-0012 - STA. 140+81.40 TO STA. 142+74.60

RAILROAD OMISSION (LOCATION #1):

STA. 699+32.85 TO 699+40.85

TOTAL LENGTH OF LOCATION #1 = 51,668.55 FEET = 9.786 MILES
 NET LENGTH OF LOCATION #1 = 51,083.90 FEET = 9.675 MILES

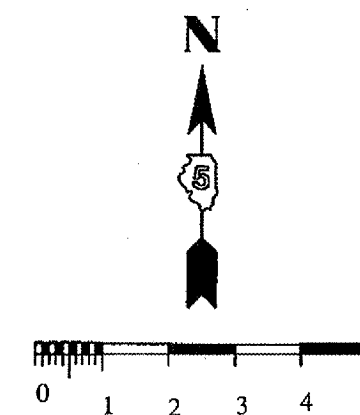

F.A. RY.	SECTION	COUNTY	TOTAL SHEETS	SHEET NO.
		**	27	4

LOCATION #3 - FAS 1517 (US 150) FROM DEWITT/PIATT COUNTY LINE TO TR 122B (RURAL 2-LANE)

LOCATION #4 - FAS 1517 (US 150) FROM DEWITT/PIATT COUNTY LINE TO MCLEAN COUNTY LINE (RURAL 2-LANE)

* D5 CRACK & JOINT SEAL 2007-2
 ** DEWITT/PIATT

LOCATION #4 (RURAL)
 END STATION 264+36.50

LOCATION #4 (RURAL)
 BEGIN STATION 0+00.00

LOCATION #3 (RURAL)
 BEGIN STATION 0+00.00

LOCATION #3 (RURAL)
 END STATION 266+55.50 (TR 122B)

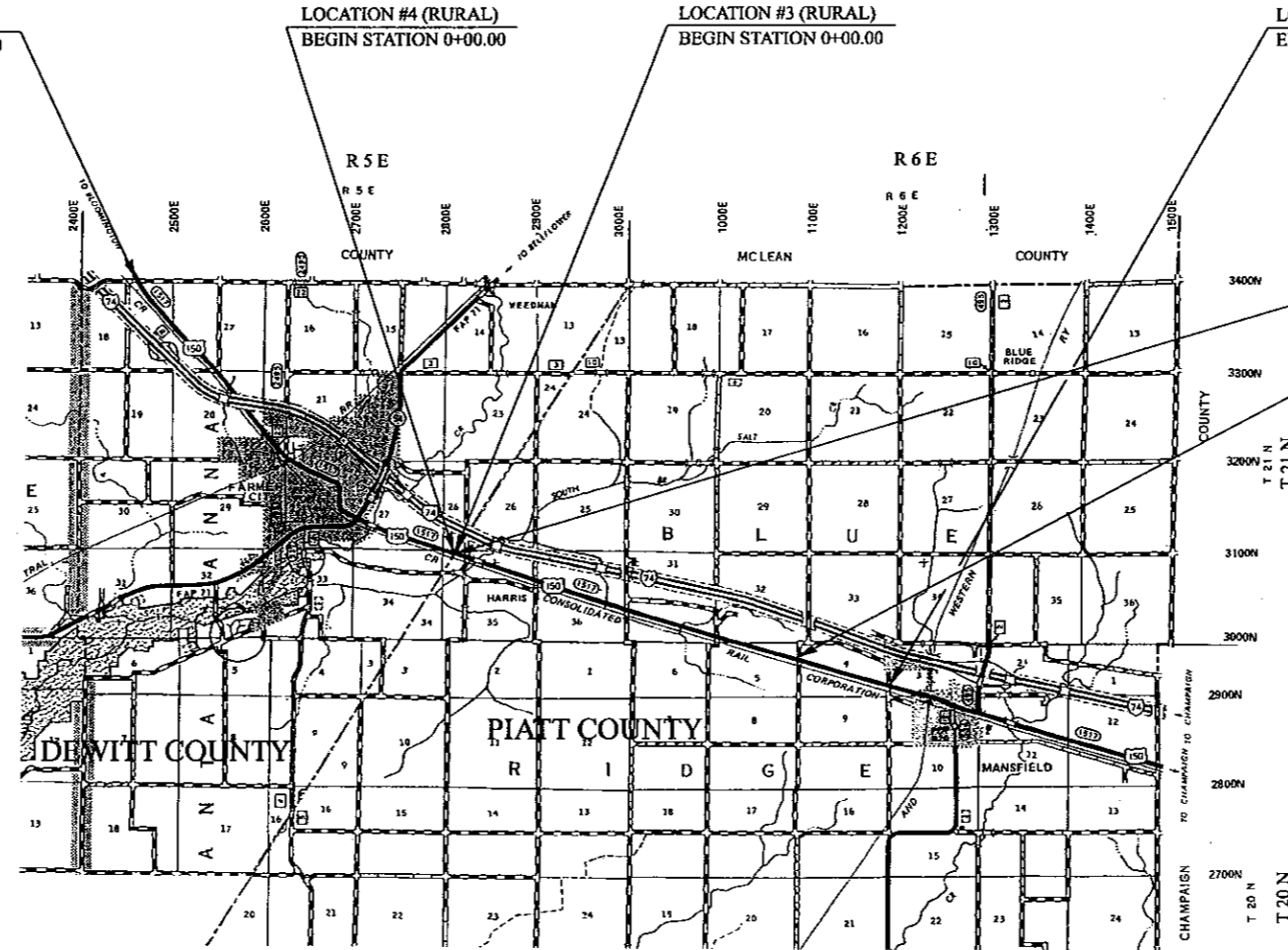

STATION EQUATIONS (LOCATION #3):
 ① STATION 0+00.00 (DEWITT COUNTY - BACK) = STATION 0+00.00 (PIATT COUNTY - AHEAD)
 ② STATION 199+34.30 (BACK) = STATION 206+64.80 (AHEAD)

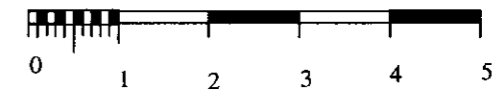

RAILROAD OMISSION (LOCATION #4):
 STATION 121+43.40 TO STATION 126+97.80

BRIDGE OMISSION (LOCATION #3):
 S.N. 074-0008 - STATION 4+93.60 TO STATION 5+56.40

BRIDGE OMISSION (LOCATION #4):
 S.N. 020-0058 - STATION 57+30.00 TO STATION 60+74.00

TOTAL LENGTH OF LOCATION #4 = 26,436.50 FEET = 5.007 MILES
 NET LENGTH OF LOCATION #4 = 25,538.10 FEET = 4.837 MILES

TOTAL LENGTH OF LOCATION #3 = 25,925.00 FEET = 4.910 MILES
 NET LENGTH OF LOCATION #3 = 25,862.20 FEET = 4.898 MILES

F.A. RT.:	SECTION	COUNTY	TOTAL SHEETS	SHEET NO.
VAR.	-	**	27	5

* D5 CRACK & JOINT SEAL 2007-2
 ** DEWITT/PIATT

LOCATION #5 - FAP 721 (IL 10) FROM IL 48 TO PIATT COUNTY LINE (RURAL 2-LANE)

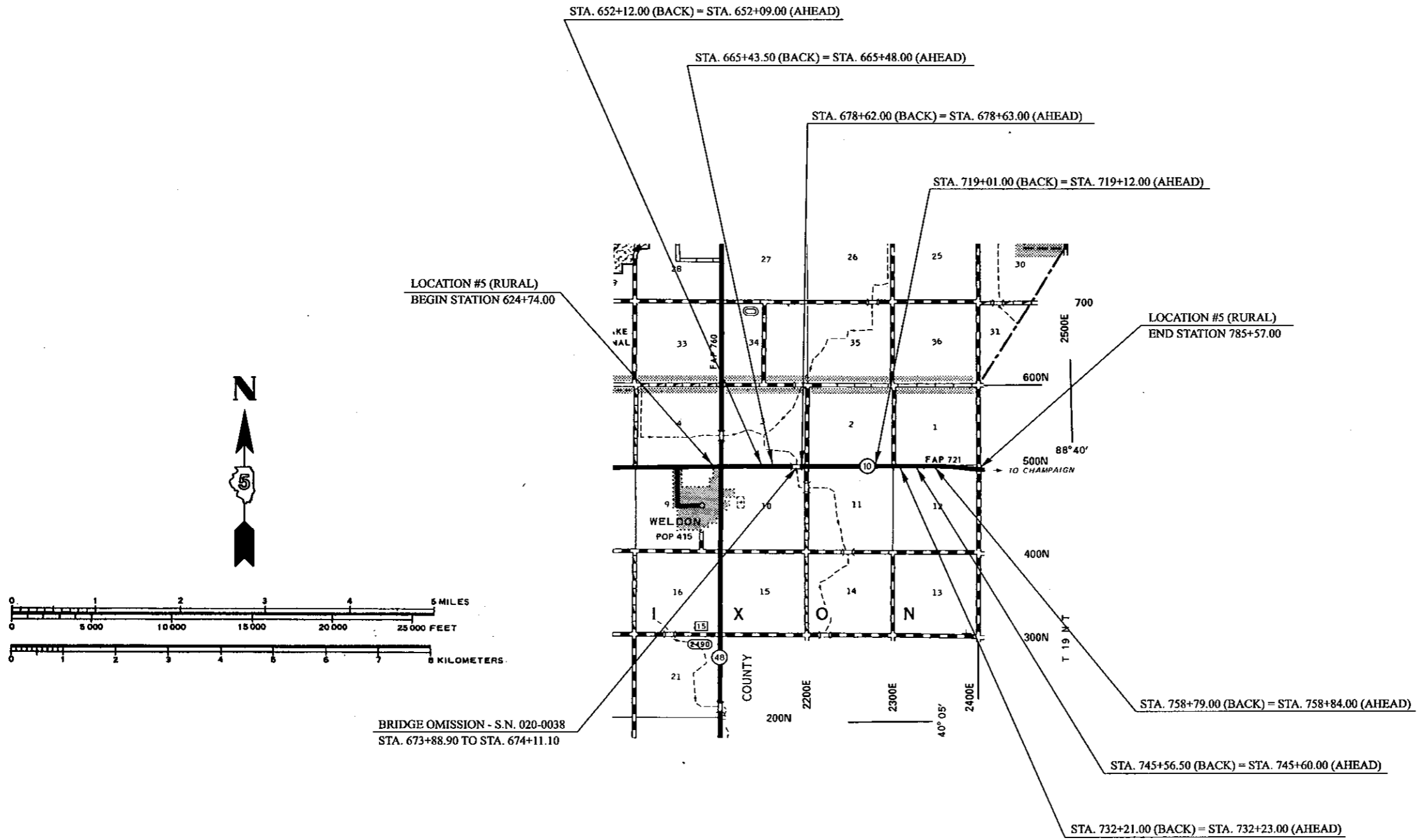

BRIDGE OMISSION - S.N. 020-0038
 STA. 673+88.90 TO STA. 674+11.10

TOTAL LENGTH OF LOCATION #5 = 16,059.00 FEET = 3.041 MILES
 NET LENGTH OF LOCATION #5 = 16,036.80 FEET = 3.037 MILES

PLOT DATE: 11/15/2008
 FILE NAME: c:\pwworkspace\70564\70564.dwg
 PLOT SCALE: 1/4" = 100'-0"
 USER NAME: philip

F.A. RTE.	SECTION	COUNTY	TOTAL SHEETS	SHEET NO.
VAR.	*	**	27	6

* D5 CRACK & JOINT SEAL 2007-2
 ** DEWITT/PIATT

LOCATION #6 - FAP 721 (IL 10) FROM DEWITT COUNTY LINE TO I-72 (RURAL 2-LANE)

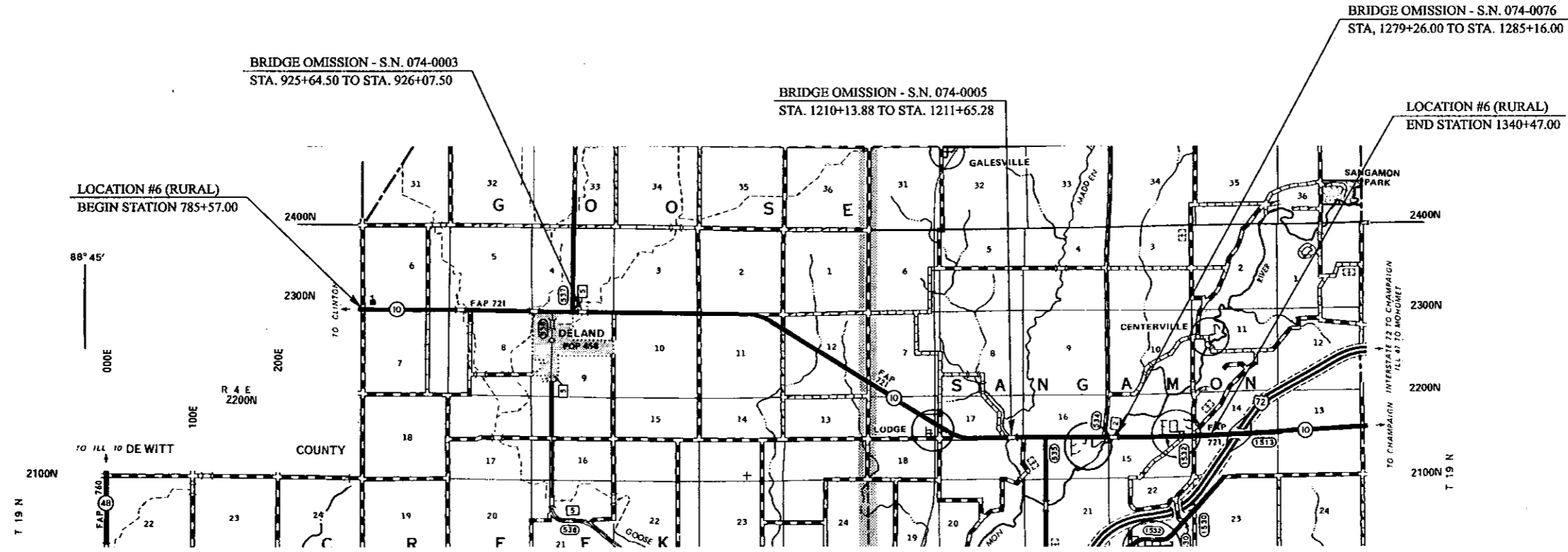

STATION EQUATIONS:
 STA. 825+83.00 (BACK) = STA. 825+88.00 (AHEAD)
 STA. 840+94.70 (BACK) = STA. 841+02.94 (AHEAD)
 STA. 878+94.00 (BACK) = STA. 879+01.00 (AHEAD)
 STA. 883+90.80 (BACK) = STA. 884+00.33 (AHEAD)
 STA. 915+83.60 (BACK) = STA. 915+84.09 (AHEAD)
 STA. 944+90.50 (BACK) = STA. 944+92.50 (AHEAD)
 STA. 984+96.00 (BACK) = STA. 985+00.00 (AHEAD)
 STA. 1024+75.00 (BACK) = STA. 1024+77.00 (AHEAD)

STATION EQUATIONS:
 STA. 1053+90.50 (BACK) = STA. 1053+85.00 (AHEAD)
 STA. 1085+00.00 (BACK) = STA. 1085+02.50 (AHEAD)
 STA. 1116+22.50 (BACK) = STA. 1116+24.00 (AHEAD)
 STA. 1142+55.50 (BACK) = STA. 1142+49.00 (AHEAD)
 STA. 1199+97.00 (BACK) = STA. 1199+97.53 (AHEAD)
 STA. 1273+75.50 (BACK) = STA. 1273+78.50 (AHEAD)
 STA. 1312+04.50 (BACK) = STA. 1312+04.00 (AHEAD)
 STA. 1330+19.00 (BACK) = STA. 1330+22.00 (AHEAD)

RESURFACING OMISSION:
 STA. 1155+87.00 TO STA. 1177+02.00

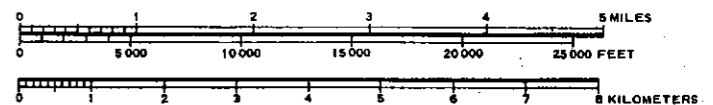

TOTAL LENGTH OF LOCATION #6 = 55,453.71 FEET = 10.503 MILES
 NET LENGTH OF LOCATION #6 = 52,554.31 FEET = 9.953 MILES

PLOT DATE: 11/15/2005
 FILE NAME: c:\projects\70564\70564.dwg
 PLOT SCALE: 1" = 1000'
 USER NAME: phillips

F.A. RTE.	SECTION	COUNTY	TOTAL SHEETS	SHEET NO.
VAR.	-	**	27	7

* D5 CRACK & JOINT SEAL 2007-2
 ** DEWITT/PIATT

GENERAL NOTES

G.N. - 100

ENGLISH UNITS OF MEASUREMENT SHALL GOVERN OVER AND SUPERSEDE ANY METRIC UNITS SHOWN IN THIS CONTRACT. WHERE INCLUDED, METRIC UNITS ARE FOR INFORMATION ONLY.

G.N. - 107.12A (SPECIAL)

RAILROAD PROTECTIVE LIABILITY INSURANCE IS NOT INCLUDED IN THIS CONTRACT. ALL ROUT AND SEAL OPERATIONS SHALL STOP JUST BEFORE AND RESUME JUST AFTER THE ADVANCED RAILROAD PAVEMENT MARKINGS NEAR THE RAILROAD ADVANCED WARNING SIGNS.

G.N. - 451 (SPECIAL)

CRACK ROUTING AND FILLING CONSISTS OF BOTH LONGITUDINAL AND TRANSVERSE CRACKS. AN APPLICATION RATE OF 0.40 LBS./FOOT WAS USED TO DETERMINE CRACK FILLING QUANTITIES.

LOCATION #1

THE INTENT AT LOCATION #1 IS TO ROUT AND SEAL ALL TRANSVERSE CRACKS, THE CENTERLINE LONGITUDINAL JOINT, LONGITUDINAL CRACKS AT WIDENING AND SHOULDER JOINTS, AND MISCELLANEOUS LONGITUDINAL CRACKS BETWEEN THE WHEEL LANES FROM STATION 354+00.00 TO STATION 146+12.19. CURB AND GUTTER CRACKS AND ALL CURB JOINTS ARE TO BE OMITTED.

LONGITUDINAL: 27,820.0 LBS.
 TRANSVERSE : 3,957.0 LBS.
 TOTAL: 31,777.0 LBS. (ESTIMATED)

LOCATION #2

THE INTENT AT LOCATION #2 IS TO ROUT AND SEAL ALL TRANSVERSE CRACKS, THE CENTERLINE LONGITUDINAL JOINT, LONGITUDINAL CRACKS AT WIDENING AND SHOULDER JOINTS, AND MISCELLANEOUS LONGITUDINAL CRACKS BETWEEN THE WHEEL LANES FROM STATION 630+85.00 TO STATION 1127+26.91. CURB AND GUTTER CRACKS AND ALL CURB JOINTS ARE TO BE OMITTED.

LONGITUDINAL: 23,255.0 LBS.
 TRANSVERSE : 2,036.0 LBS.
 TOTAL: 25,291.0 LBS. (ESTIMATED)

LOCATION #3

THE INTENT AT LOCATION #3 IS TO ROUT AND SEAL ALL TRANSVERSE CRACKS, THE CENTERLINE LONGITUDINAL JOINT, LONGITUDINAL CRACKS AT WIDENING AND SHOULDER JOINTS, AND MISCELLANEOUS LONGITUDINAL CRACKS BETWEEN THE WHEEL LANES FROM STATION 0+00.00 TO STATION 266+55.50. CURB AND GUTTER CRACKS AND ALL CURB JOINTS ARE TO BE OMITTED.

LONGITUDINAL: 20,896.0 LBS.
 TRANSVERSE : 6,162.0 LBS.
 TOTAL: 27,058.0 LBS. (ESTIMATED)

LOCATION #4

THE INTENT AT LOCATION #4 IS TO ROUT AND SEAL ALL TRANSVERSE CRACKS, THE CENTERLINE LONGITUDINAL JOINT, LONGITUDINAL CRACKS AT WIDENING AND SHOULDER JOINTS, AND MISCELLANEOUS LONGITUDINAL CRACKS BETWEEN THE WHEEL LANES FROM STATION 0+00.00 TO STATION 264+36.50. CURB AND GUTTER CRACKS AND ALL CURB JOINTS ARE TO BE OMITTED.

LONGITUDINAL: 17,618.0 LBS.
 TRANSVERSE : 9,909.0 LBS.
 TOTAL: 27,527.0 LBS. (ESTIMATED)

LOCATION #5

THE INTENT AT LOCATION #5 IS TO ROUT AND SEAL ALL TRANSVERSE CRACKS, THE CENTERLINE LONGITUDINAL JOINT, LONGITUDINAL CRACKS AT WIDENING AND SHOULDER JOINTS, AND MISCELLANEOUS LONGITUDINAL CRACKS BETWEEN THE WHEEL LANES FROM STATION 624+74.00 TO STATION 785+57.00. CURB AND GUTTER CRACKS AND ALL CURB JOINTS ARE TO BE OMITTED.

LONGITUDINAL: 7,785.0 LBS.
 TRANSVERSE : 483.0 LBS.
 TOTAL: 8,268.0 LBS. (ESTIMATED)

LOCATION #6

THE INTENT AT LOCATION #6 IS TO ROUT AND SEAL ALL TRANSVERSE CRACKS, THE CENTERLINE LONGITUDINAL JOINT, LONGITUDINAL CRACKS AT WIDENING AND SHOULDER JOINTS, AND MISCELLANEOUS LONGITUDINAL CRACKS BETWEEN THE WHEEL LANES FROM STATION 785+57.00 TO STATION 1340+47.00. CURB AND GUTTER CRACKS AND ALL CURB JOINTS ARE TO BE OMITTED.

LONGITUDINAL: 26,429.0 LBS.
 TRANSVERSE : 858.0 LBS.
 TOTAL: 27,287.0 LBS. (ESTIMATED)

NOTE: ANY CHANGES TO THE INTENT OF ROUTING AND SEALING AT THE ABOVE LISTED LOCATIONS SHALL BE APPROVED BY THE ENGINEER.

NO COMMITMENTS

F.I. RITE.	SECTION	COUNTY	TOTAL SHEETS	SHEET NO.
VAR.	*	**	27	8

* D5 CRACK & JOINT SEAL 2007-2
 ** DEWITT/PIATT

SUMMARY OF QUANTITIES

LOCATION OF WORK: VARIOUS ROUTES
 D5 CRACK AND JOINT SEAL 2007-2
 DEWITT & PIATT COUNTIES

CONSTRUCTION TYPE CODE:

DEWITT CO.
 RURAL
 100% STATE
 ROUT & SEAL
 F000

DEWITT CO.
 URBAN
 100% STATE
 ROUT & SEAL
 F000

PIATT CO.
 RURAL
 100% STATE
 ROUT & SEAL
 F000

CODE NO.	PAY ITEM	UNIT	TOTAL QUANTITY	QUANTITY	QUANTITY	QUANTITY
45100100	CRACK ROUTING (PAVEMENT)	FOOT	368,017.0	223,692.0	8,464.0	135,861.0
45100200	CRACK FILLING	POUND	147,208.0	89,478.0	3,385.0	54,345.0
67100100	MOBILIZATION	L SUM	1.0	0.5	0.1	0.4
70100460	TRAFFIC CONTROL AND PROTECTION, STANDARD 701306	L SUM	1.0	0.6	0.0	0.4
70102620	TRAFFIC CONTROL AND PROTECTION, STANDARD 701501	L SUM	1.0	0.8	0.2	0.0
* 78001110	PAINT PAVEMENT MARKING - LINE 4"	FOOT	96,592.0	63,479.0	2,934.0	30,179.0

* SPECIALTY ITEM

F.A. RTE.	SECTION	COUNTY	TOTAL SHEETS	SHEET NO.
VAR.	*	**	27	9

* D5 CRACK & JOINT SEAL 2007-2
 ** DEWITT/PIATT

SCHEDULE OF QUANTITIES

CODE NO.	PAY ITEM	UNIT	TOTAL QUANTITY	LOCATION OF WORK:							
				IL 54	IL 10	IL 10	US 150	US 150	IL 10	IL 10	
				DEWITT CO. 2-LANE RURAL 100% STATE STA. 354+00.00 TO STA. 146+12.19 LOCATION #1	DEWITT CO. 2-LANE RURAL 100% STATE STA. 630+85.00 TO STA. 1058+10.00 LOCATION #2	DEWITT CO. 2-LANE URBAN 100% STATE STA. 1058+10.00 TO STA. 1127+26.91 LOCATION #2	PIATT CO. 2-LANE RURAL 100% STATE STA. 0+00.00 TO STA. 266+55.50 LOCATION #3	DEWITT CO. 2-LANE RURAL 100% STATE STA. 0+00.00 TO STA. 264+36.50 LOCATION #4	DEWITT CO. 2-LANE RURAL 100% STATE STA. 624+74.00 TO STA. 785+57.00 LOCATION #5	PIATT CO. 2-LANE RURAL 100% STATE STA. 785+57.00 TO STA. 1340+47.00 LOCATION #6	
				LOCATION:	LOCATION #1	LOCATION #2	LOCATION #2	LOCATION #3	LOCATION #4	LOCATION #5	LOCATION #6
CODE NO.	PAY ITEM	UNIT	TOTAL QUANTITY	QUANTITY	QUANTITY	QUANTITY	QUANTITY	QUANTITY	QUANTITY	QUANTITY	
45100100	CRACK ROUTING (PAVEMENT)	FOOT	368,017.0	79,443.0	54,764.0	8,464.0	67,645.0	68,817.0	20,668.0	68,216.0	
45100200	CRACK FILLING	POUND	147,208.0	31,777.0	21,906.0	3,385.0	27,058.0	27,527.0	8,268.0	27,287.0	
67100100	MOBILIZATION	L SUM	1.0	0.2	0.1	0.1	0.1	0.1	0.1	0.3	
70100460	TRAFFIC CONTROL AND PROTECTION, STANDARD 701306	L SUM	1.0	0.1	0.2	0.0	0.2	0.2	0.1	0.2	
70102620	TRAFFIC CONTROL AND PROTECTION, STANDARD 701501	L SUM	1.0	0.4	0.0	0.2	0.0	0.4	0.0	0.0	
* 78001110	PAINT PAVEMENT MARKING - LINE 4"	FOOT	96,592.0	28,749.0	21,596.0	2,934.0	6,466.0	9,124.0	4,010.0	23,713.0	

* SPECIALTY ITEM

F.A. RTE.	SECTION	COUNTY	TOTAL SHEETS	SHEET NO.
VAR.	-	**	27	10

* D5 CRACK & JOINT SEAL 2007-2
 ** DEWITT/PIATT

LOCATION #1

EXISTING TYPICAL CROSS SECTION – FAP 71 (IL 54) ①

STATION	TO	STATION
639+80		641+88.16
649+27.44		674+20
699+37.66		706+04

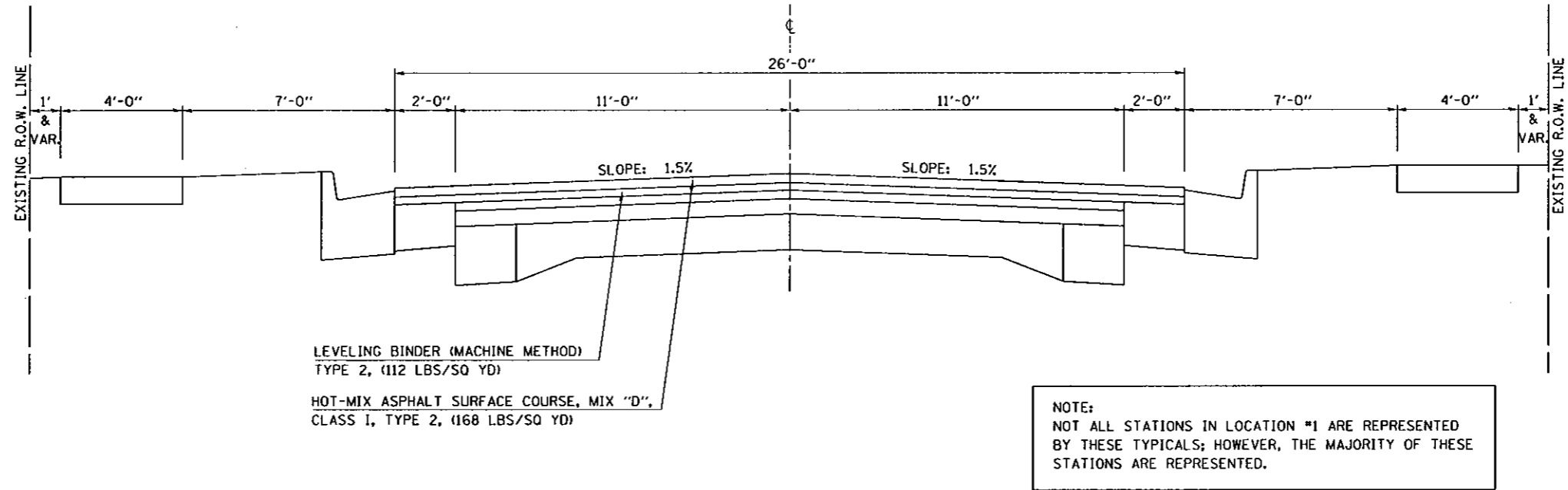

LOCATION #1

EXISTING TYPICAL CROSS SECTION – FAP 71 (IL 54) ②

STATION	TO	STATION
641+88.16		649+27.44

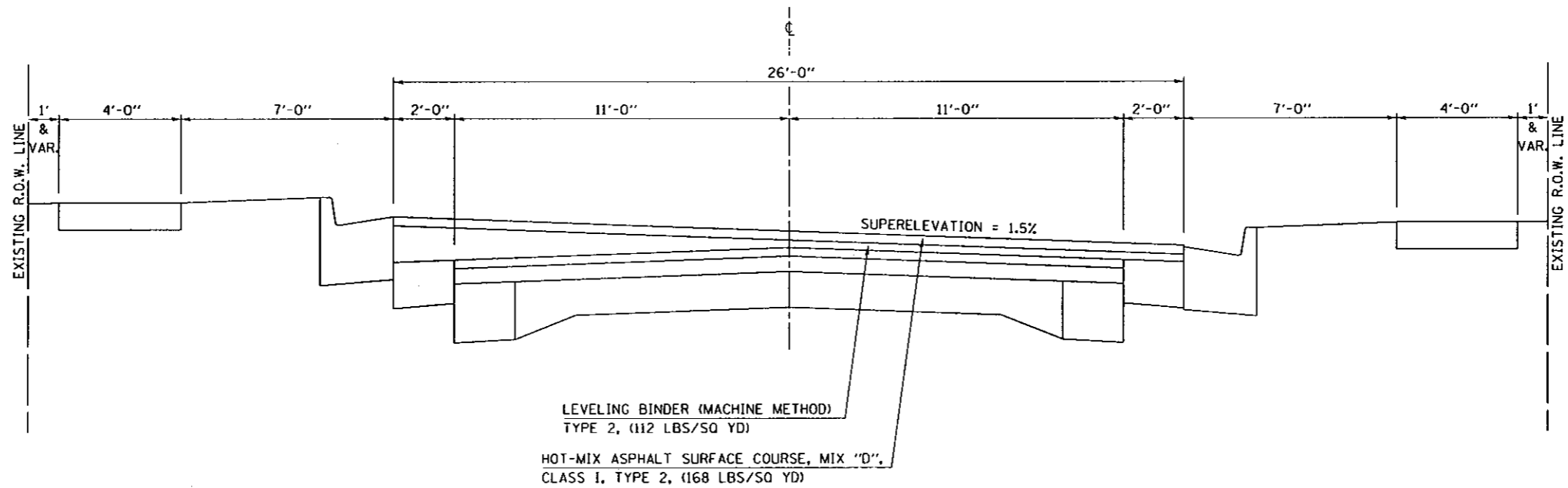

F.A. RTE.	SECTION	COUNTY	TOTAL SHEETS	SHEET NO.
VAR.	*	**	27	11

* D5 CRACK & JOINT SEAL 2007-2
 ** DEWITT/PIATT

EXISTING TYPICAL CROSS SECTION – FAP 71 (IL 54)

3

LOCATION #1

STATION	TO	STATION
1720+48.96		1726+72.60
1727+80.00		1734+53.54
1737+67.67		1753+53.76

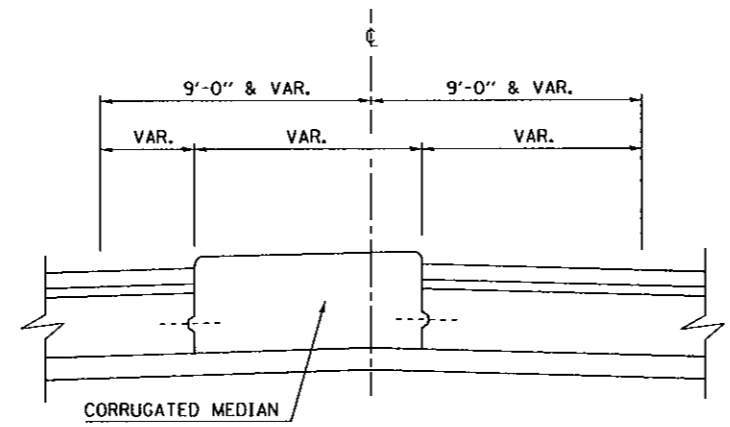
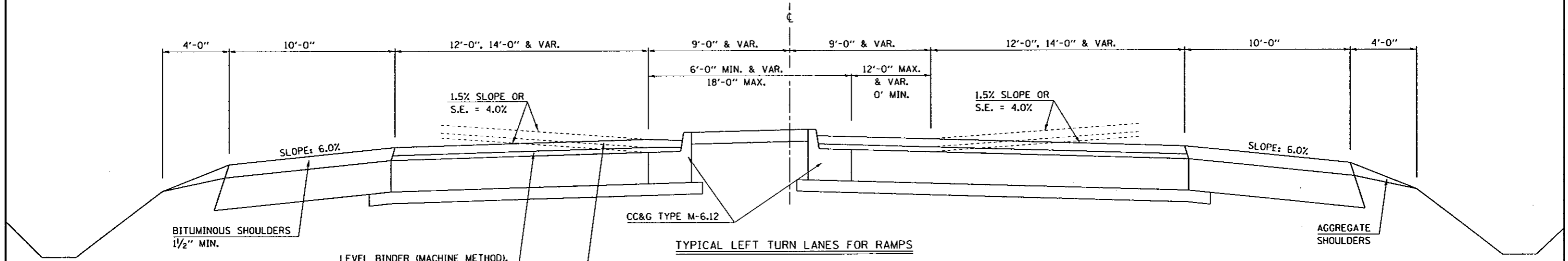

TYPICAL APPROACHES

PLOT DATE = 11/15/2008
 FILE NAME = c:\projects\70564\70564.dwg
 PLOT SCALE = 1/8"=1'-0"
 USER NAME = philipj

F.A. RTE.	SECTION	COUNTY	TOTAL SHEETS	SHEET NO.
VAR.	*	**	27	12

* D5 CRACK & JOINT SEAL 2007-2
 ** DEWITT/PIATT

EXISTING TYPICAL CROSS SECTION – FAP 717 (IL 10) ①

LOCATION #2

STATION	TO	STATION
632+00.00		737+98.00 (BRIDGE OMISSION) ①
① 739+22.00		960+57.40 ②
② 978+22.00		1018+51.00 ②
② 1029+47.00		1052+60.00 ②
② 1063+95.00		1069+44.87 (BRIDGE OMISSION) ①
① 1070+51.14		1073+84.00 (RESURFACING OMISSION) ③

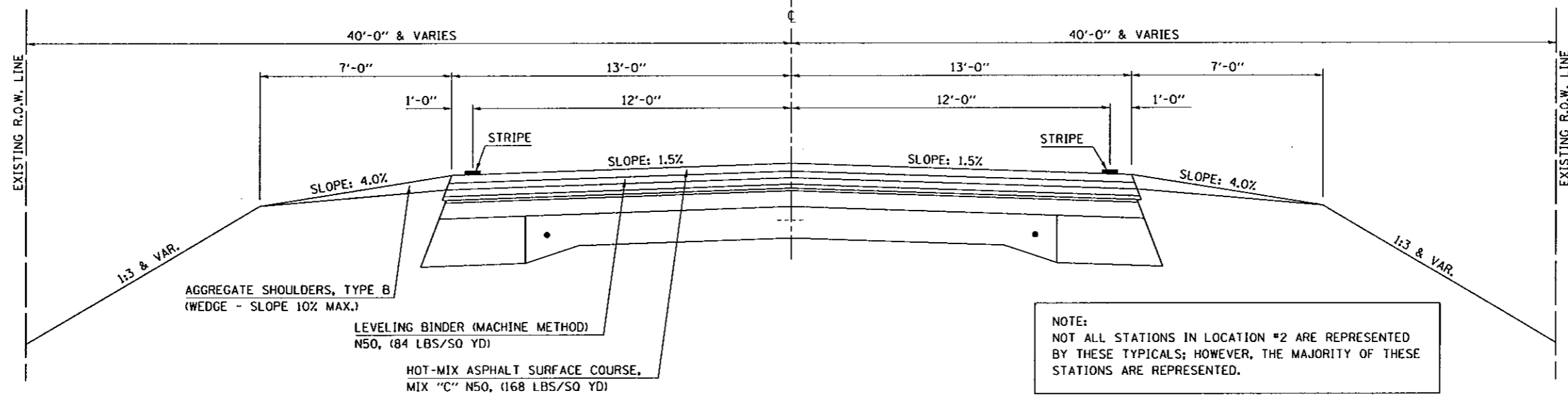

EXISTING TYPICAL CROSS SECTION – FAP 717 (IL 10) ②

LOCATION #2

STATION	TO	STATION
① 960+57.40		978+22.00 ①
① 1018+51.00		1029+47.00 ①
① 1052+60.00		1063+95.00 ①

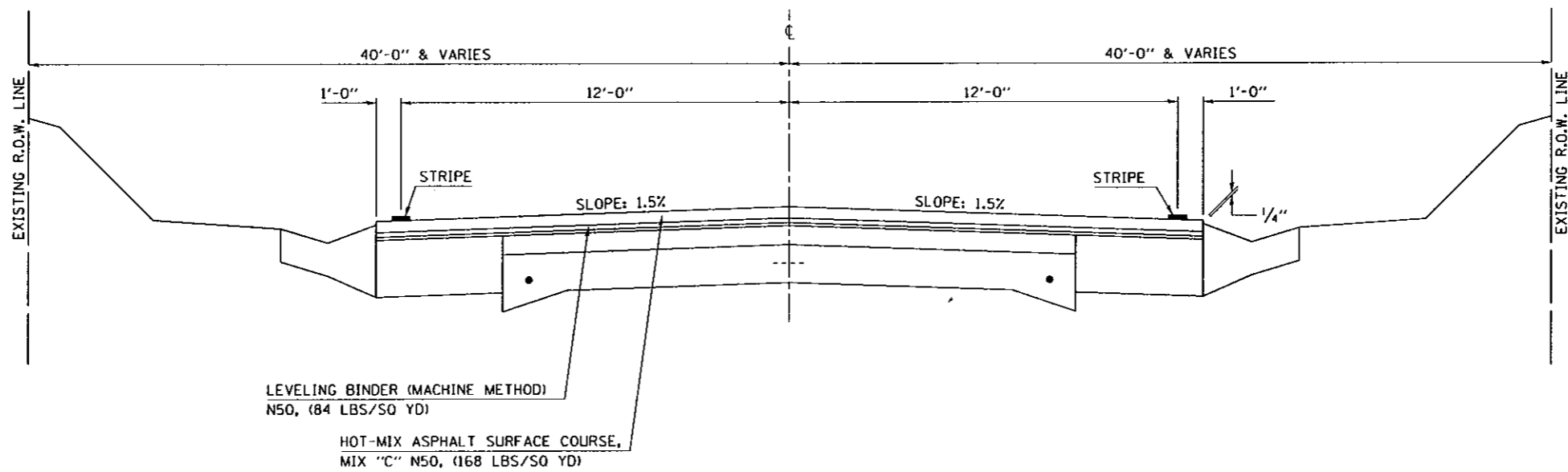

F.A. RTE.	SECTION	COUNTY	TOTAL SHEETS	SHEET NO.
VAR.	-	**	27	13

* 05 CRACK & JOINT SEAL 2007-2
 ** DEWITT/PIATT

EXISTING TYPICAL CROSS SECTION - FAP 717 (IL 10) ③

LOCATION #2

(END RESURFACING OMISSION) ① STATION TO STATION
 1094+83.85 TO 1095+43.00 ④

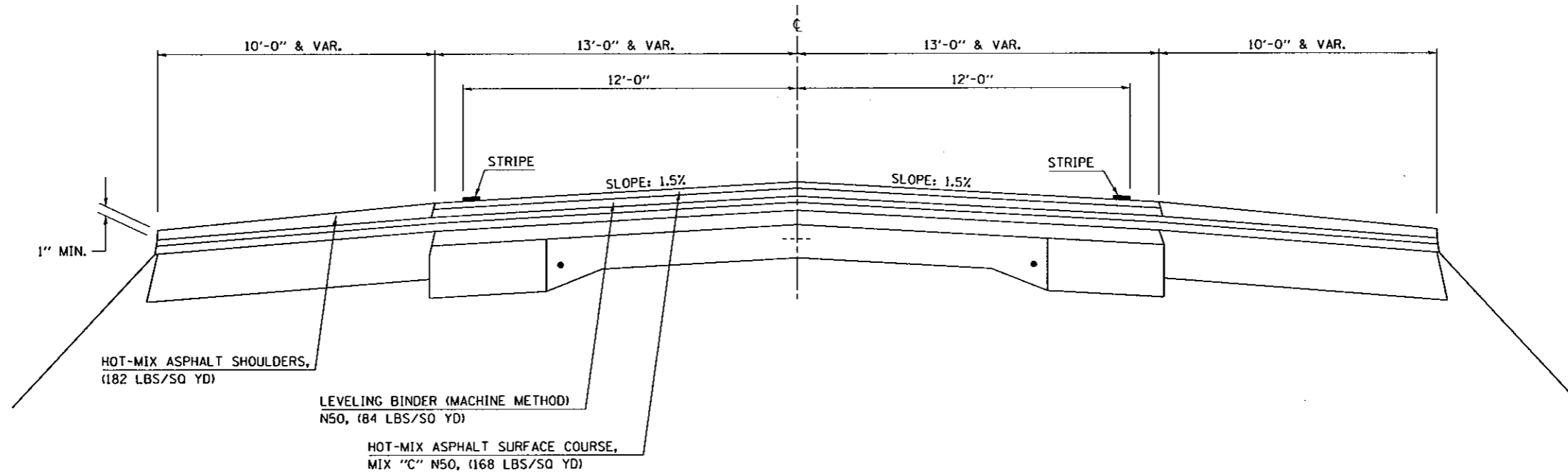

EXISTING TYPICAL CROSS SECTION - FAP 717 (IL 10) ④

LOCATION #2

STATION TO STATION
 ③ 1095+43.00 TO 1107+00.00 (RESURFACING OMISSION) ⑤

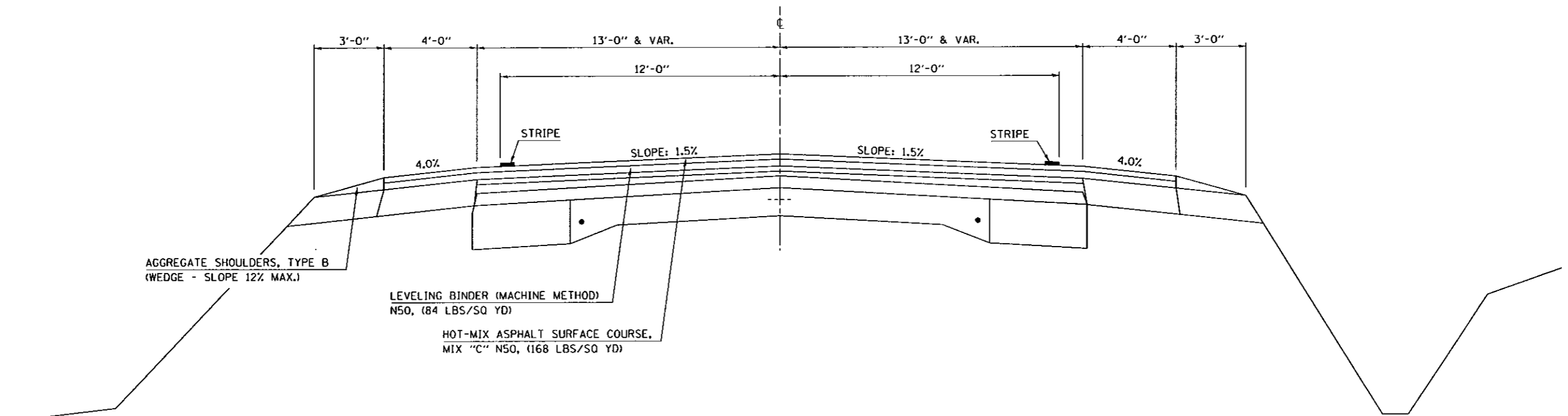

PLOT DATE: 11/15/2006
 FILE NAME: c:\projects\70564\70564.dwg
 PLOT SCALE: 1/8"=1'-0"
 USER NAME: phillips

F.A. RTE.	SECTION	COUNTY	TOTAL SHEETS	SHEET NO.
VAR.	*	**	27	14

* D5 CRACK & JOINT SEAL 2007-2
 ** DEWITT/PIATT

EXISTING TYPICAL CROSS SECTION – FAP 717 (IL 10) ⑤

LOCATION #2

(END RESURFACING OMISSION) ④ STATION 1116+34.50 TO STATION 1118+00.00 ⑥

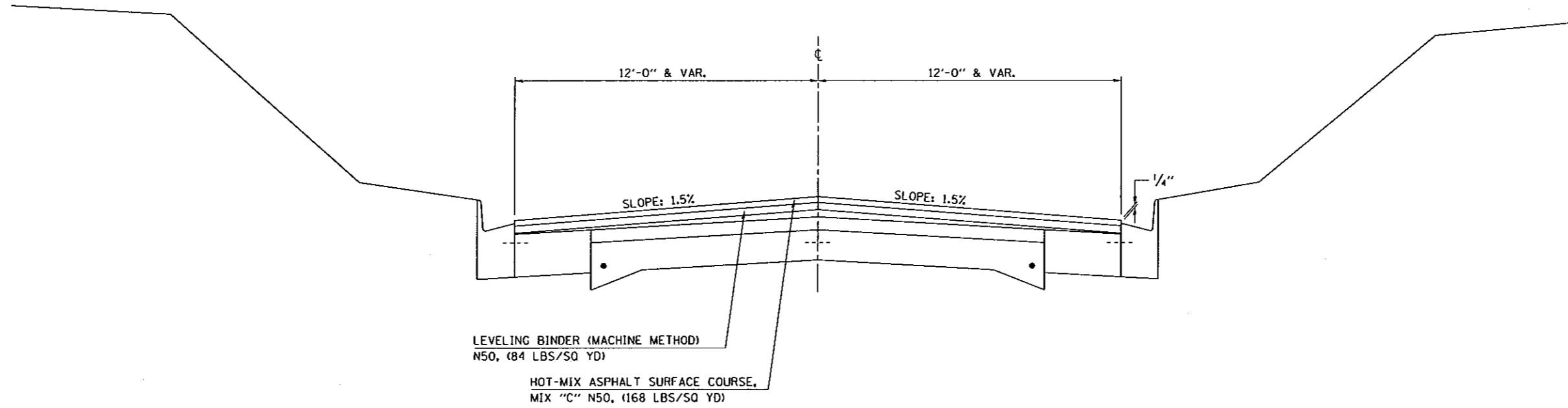

EXISTING TYPICAL CROSS SECTION – FAP 717 (IL 10) ⑥

LOCATION #2

STATION 1118+00.00 TO STATION 1124+15.00 ⑦

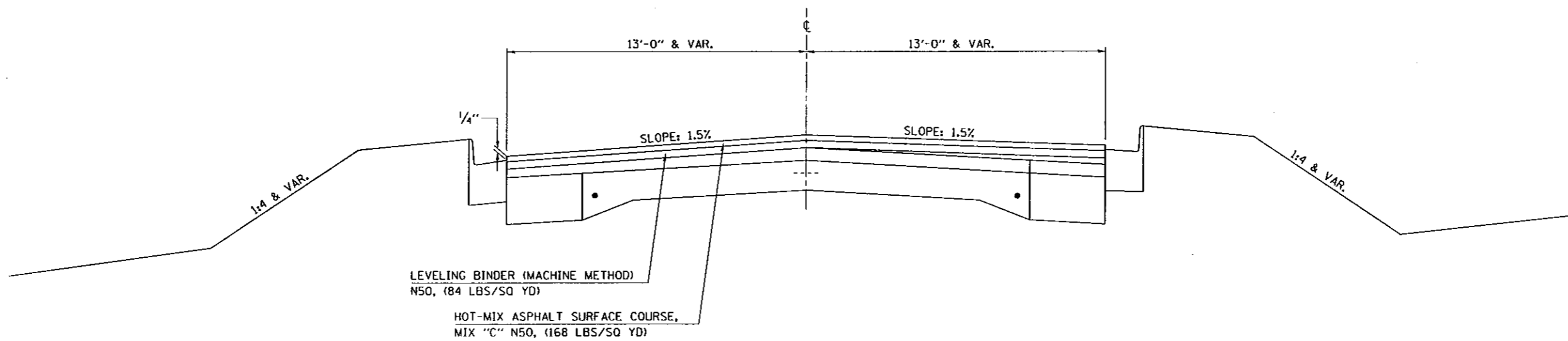

F.A. RTE.	SECTION	COUNTY	TOTAL SHEETS	SHEET NO.
VAR.	-	**	27	15

* D5 CRACK & JOINT SEAL 2007-2
 ** DEWITT/PIATT

EXISTING TYPICAL CROSS SECTION - FAP 717 (IL 10) ⑦

LOCATION #2

STATION TO STATION
 ⑥ 1124+15.00 1127+26.91

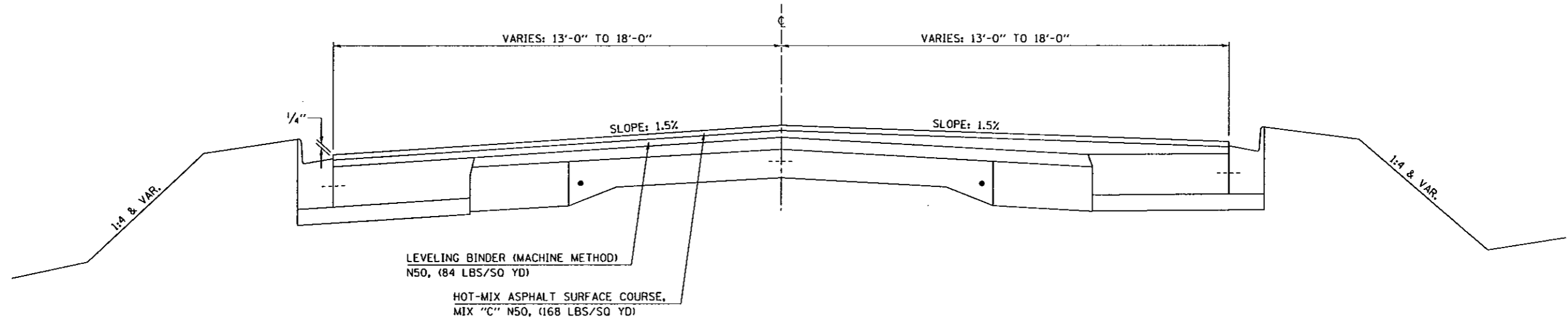

F.A. RYE.	SECTION	COUNTY	TOTAL SHEETS	SHEET NO.
VAR.	*	**	27	16

* DS CRACK & JOINT SEAL 2007-2
 ** DEWITT/PIATT

EXISTING TYPICAL CROSS SECTION - FAS 1517 (US 150)

LOCATIONS #3 & #4

STA. 264+36.50 - STA. 0+00.00 (BACK) DEWITT
 STA. 0+00.00 (AHEAD) - STA. 266+55.50 PIATT

STATION EQUATION (LOCATION #3)
 STATION 199+34.30 (BACK) =
 STATION 206+64.80 (AHEAD)

STATION EQUATION:
 STATION 0+00.00 (BACK) =
 STATION 0+00.00 (AHEAD)
 DEWITT/PIATT COUNTY LINE

** DEWITT COUNTY
 RT. STA. 80+25.00 TO RT. STA. 82+25.00

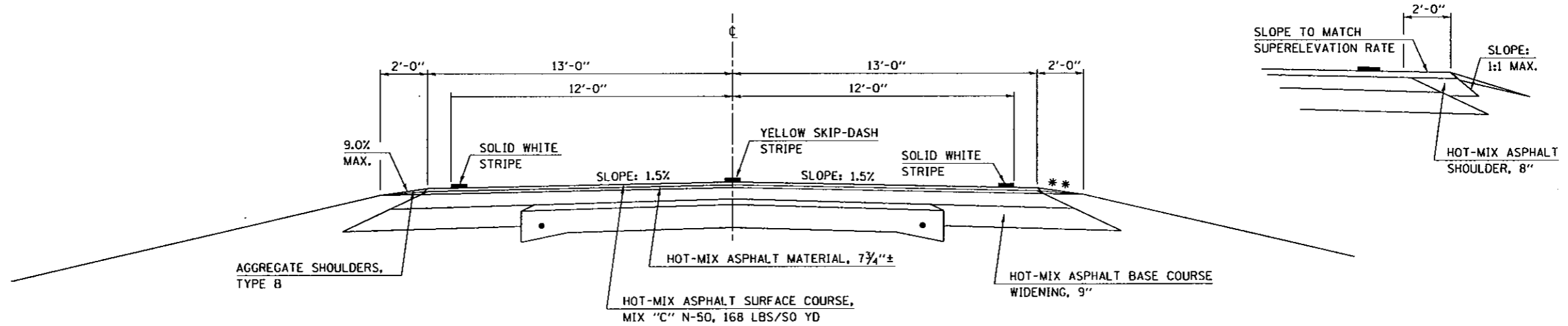

F.A. RTE.	SECTION	COUNTY	TOTAL SHEETS	SHEET NO.
VAR.	*	**	27	17

* D5 CRACK & JOINT SEAL 2007-2
 ** DEWITT/PIATT

EXISTING TYPICAL CROSS SECTION - FAP 721 (IL 10) ①

STATION TO STATION
 624+74.00 TO 628+77.50 ②

LOCATION #5

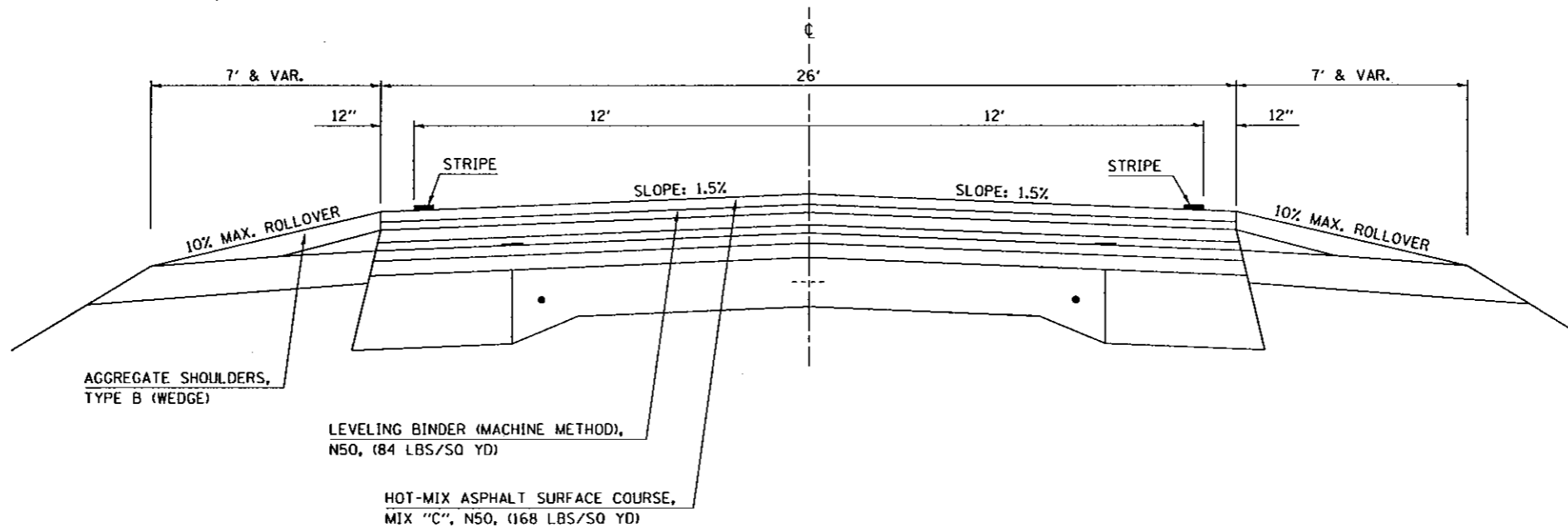

F.A. RTE.	SECTION	COUNTY	TOTAL SHEETS	SHEET NO.
	*	**	27	18

* D5 CRACK & JOINT SEAL 2007-2
 ** DEWITT/PIATT

EXISTING TYPICAL CROSS SECTION – FAP 721 (IL 10) ②

LOCATIONS #5 & #6

STATION TO STATION			STATION TO STATION		
①	628+77.50	652+12.00(BK)	②	944+92.50(AH)	984+96.00(BK)
②	652+09.00(AH)	665+43.50(BK)	②	985+00.00(AH)	1024+75.00(BK)
②	665+48.00(AH)	673+88.90(BO)	②	1024+77.00(AH)	1027+00.00
②	674+11.10	678+62.00(BK)	⑥	1042+58.00	1053+90.50(BK)
②	678+63.00(AH)	719+01.00(BK)	②	1053+85.00(AH)	1085+00.00(BK)
②	719+12.00(AH)	732+21.00(BK)	②	1085+02.50(AH)	1116+22.50(BK)
②	732+23.00(AH)	745+56.50(BK)	②	1116+24.00(AH)	1142+55.50(BK)
②	745+60.00(AH)	758+79.00(BK)	②	1142+49.00(AH)	1154+35.00
②	758+84.00(AH)	825+83.00(BK)	④	1188+05.00	1199+97.00(BK)
②	825+88.00(AH)	840+94.70(BK)	②	1199+97.53(AH)	1202+26.00
②	841+02.94(AH)	845+39.00	⑤	1227+11.00	1258+80.00
③	852+95.00	878+94.00(BK)	⑤	1262+83.00	1273+75.50(BK)
②	879+01.00(AH)	883+90.80(BK)	②	1273+78.50(AH)	1275+59.50
②	884+00.33(AH)	891+61.00	③	1289+11.00	1312+04.50(BK)
③	901+07.00	915+83.60(BK)	②	1312+04.00(AH)	1314+98.00
②	915+84.09(AH)	922+42.00	⑤	1323+95.00	1330+19.00(BK)
④	929+55.00	944+90.50(BK)	②	1330+22.00(AH)	1340+47.00

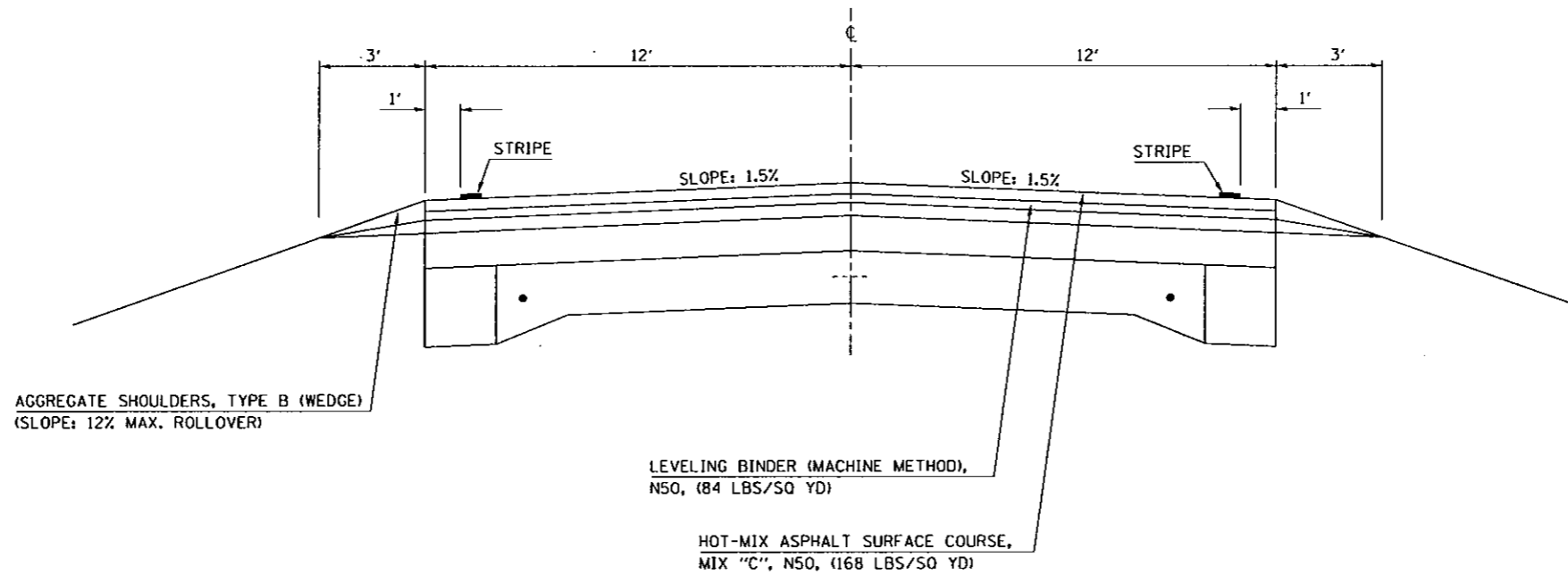

(BO) = BRIDGE OMISSION

PLOT DATE : 11/15/2006
 FILE NAME : c:\pcc\mca\6597965\65170564\typical.dgn
 PLOT SCALE : 1/8"=1'-0"
 USER NAME : philip

F.A. RTE.	SECTION	COUNTY	TOTAL SHEETS	SHEET NO.
			27	19

* DS CRACK & JOINT SEAL 2007-2
 ** DEWITT/PIATT

EXISTING TYPICAL CROSS SECTION - FAP 721 (IL 10) ③

LOCATION #6

STATION	TO	STATION	
② 845+39.00		852+95.00	②
② 891+61.00		901+07.00	②
② 1275+59.50		1279+26.00 (BO)	③
③ 1285+16.00		1289+11.00	②

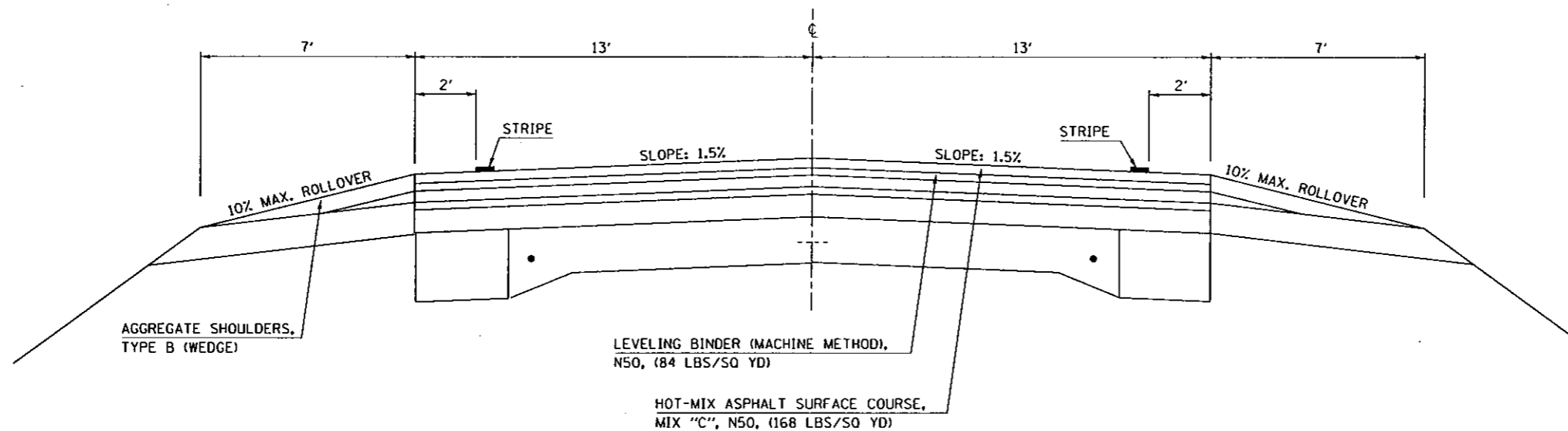

EXISTING TYPICAL CROSS SECTION - FAP 721 (IL 10) ④

LOCATION #6

STATION	TO	STATION	
② 922+42.00		925+64.50 (BO)	④
④ 926+07.50		929+55.00	②
② 1154+35.00		1155+87.00	⑧
⑦ 1185+48.00		1188+05.00	②
⑤ 1209+02.00		1210+13.88 (BO) (12' LEFT LANE, 13' RIGHT LANE)	④
④ 1211+65.28		1214+51.00 (12' LEFT LANE, 13' RIGHT LANE)	⑤

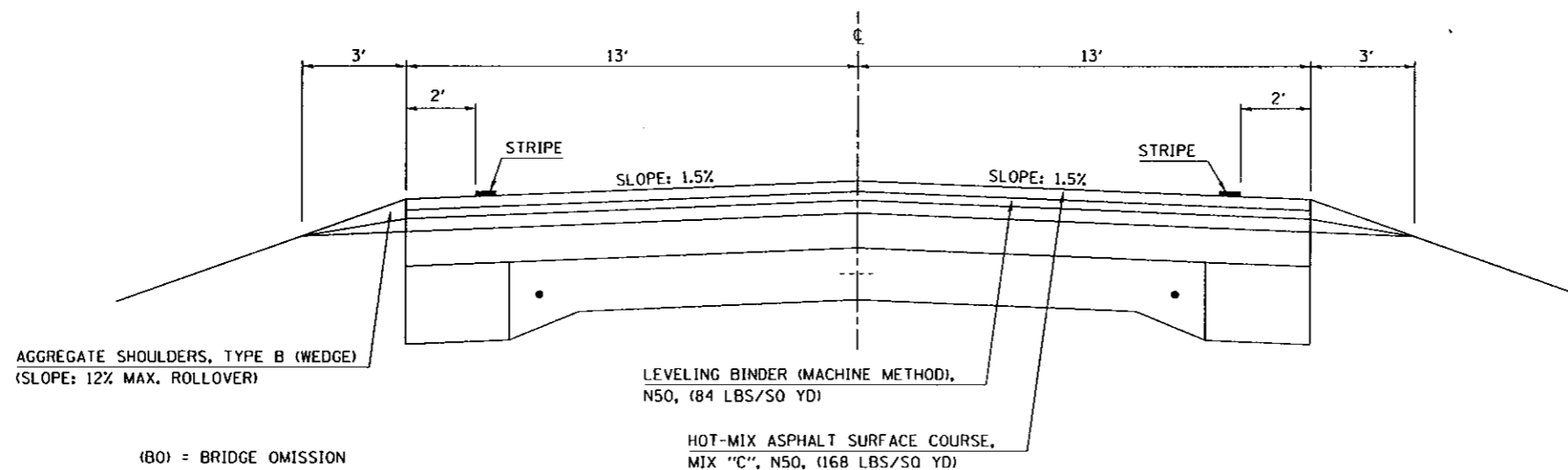

(BO) = BRIDGE OMISSION

F.A. RTE.	SECTION	COUNTY	TOTAL SHEETS	SHEET NO.
*	*	**	27	20

* D5 CRACK & JOINT SEAL 2007-2
 ** DEWITT/PIATT

EXISTING TYPICAL CROSS SECTION – FAP 721 (IL 10) ⑤

LOCATION #6

STATION	TO	STATION
② 1202+26.00		1209+02.00 ④
④ 1214+51.00		1227+11.00 ②
② 1258+80.00		1262+83.00 (GUTTER LEFT SIDE ONLY) ②
② 1314+98.00		1323+95.00 ②

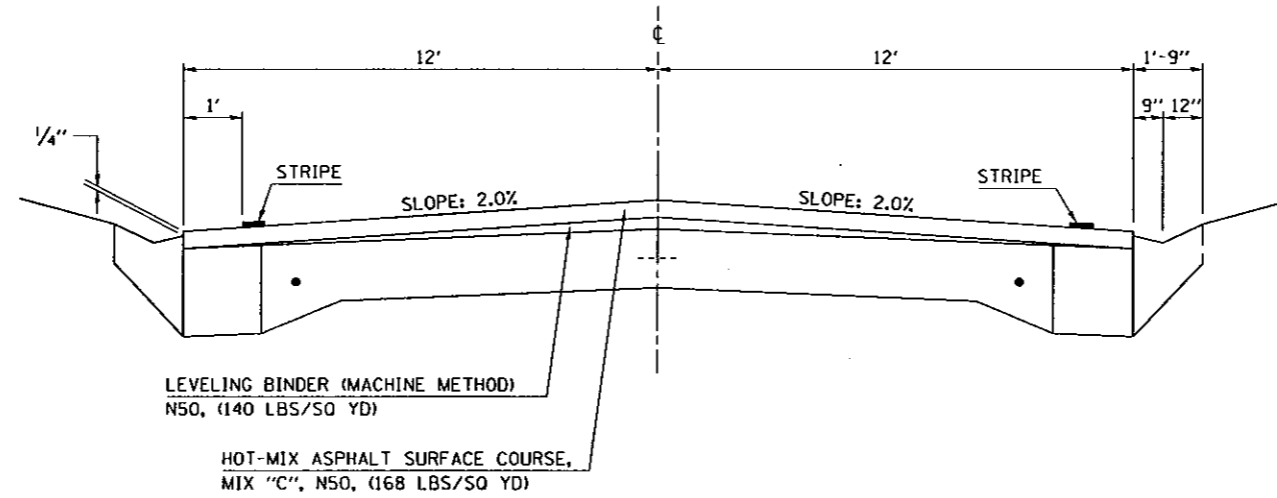

EXISTING TYPICAL CROSS SECTION – FAP 721 (IL 10) ⑥

LOCATION #6

STATION	TO	STATION
② 1027+00.00		1042+58.00 ②

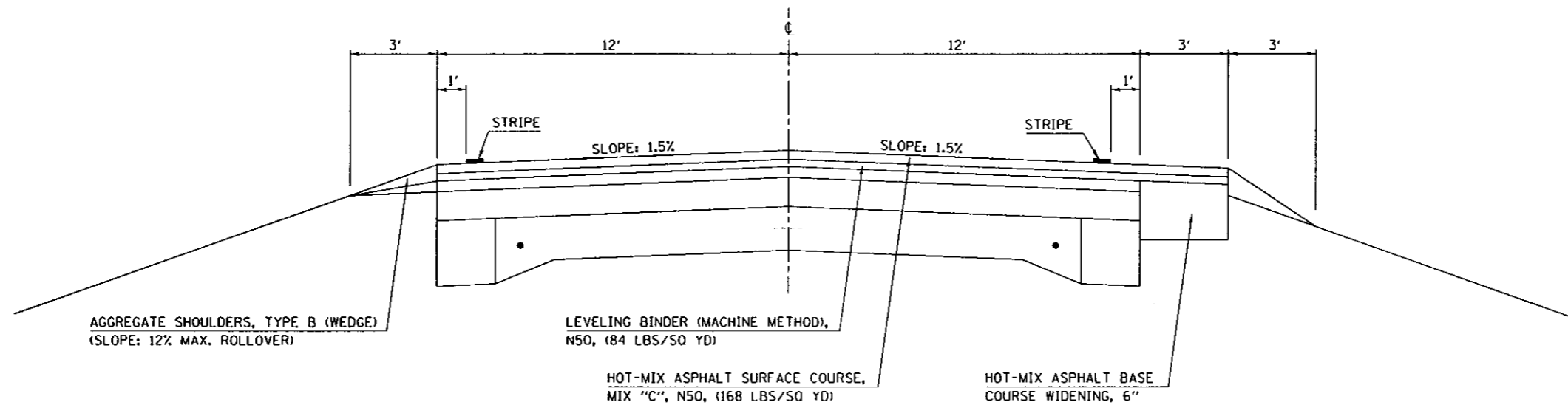

F.A. RTE.	SECTION	COUNTY	TOTAL SHEETS	SHEET NO.
VAR.	*	**	27	21

* D5 CRACK & JOINT SEAL 2007-2
 ** DEWITT/PIATT

EXISTING TYPICAL CROSS SECTION – FAP 721 (IL 10) 7

LOCATION #6

STATION TO STATION
 ⑨ 1177+02.00 1185+48.00 ④

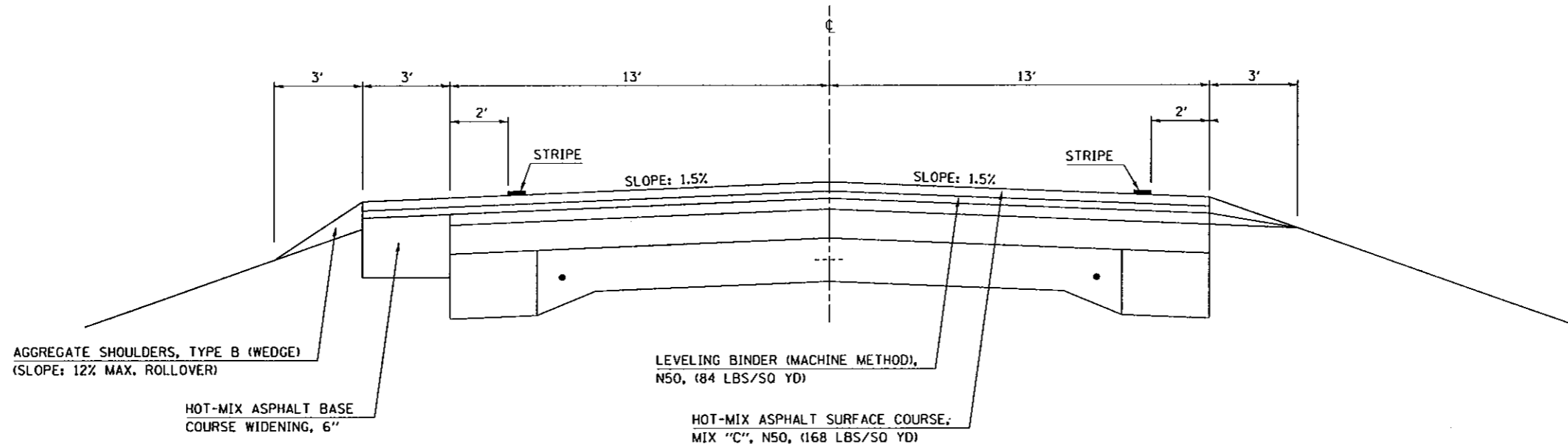

EXISTING TYPICAL CROSS SECTION – FAP 721 (IL 10) 8

LOCATION #6

STATION TO STATION
 ④ 1155+87.00 1166+91.18 (RAILROAD OMISSION)
 1167+02.26 1175+75.00 ⑨

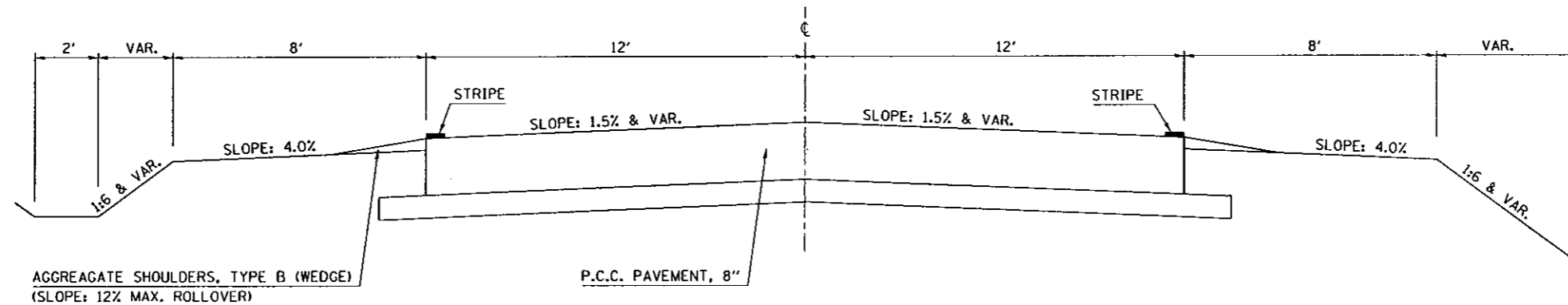

F.A. R.T.E.	SECTION	COUNTY	TOTAL SHEETS	SHEET NO.
VAR.	*	**	27	22

* DS CRACK & JOINT SEAL 2007-2
 ** DEWITT/PIATT

EXISTING TYPICAL CROSS SECTION – FAP 721 (IL 10) 9

LOCATION #6

STATION TO STATION
 ⑧ 1175+75.00 1177+02.00 ⑦

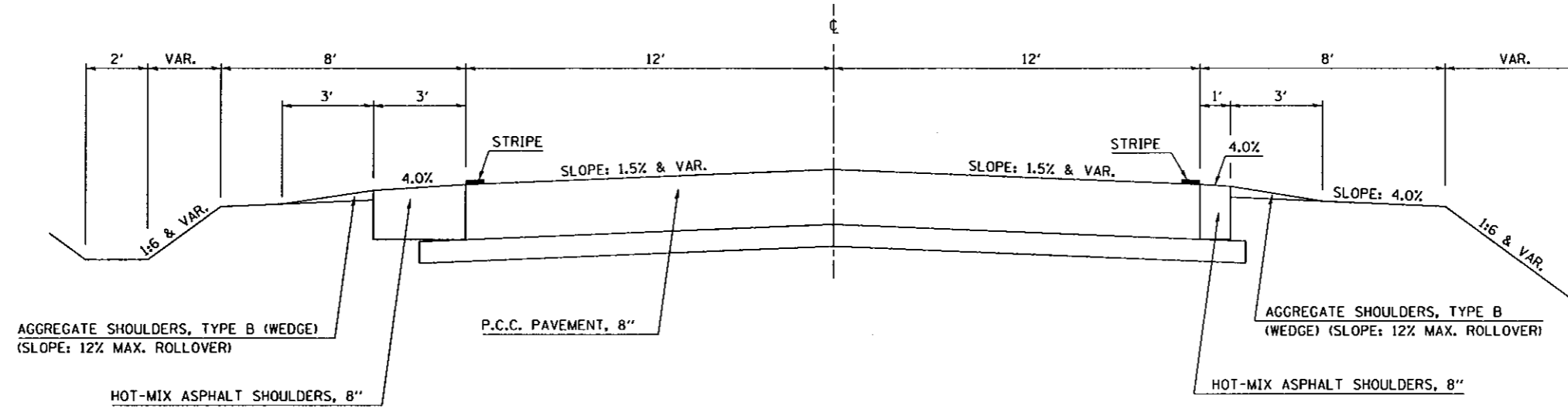

F.A. RTE.	SECTION	COUNTY	TOTAL SHEETS	SHEET NO.
	*	**	27	23

* D5 CRACK & JOINT SEAL 2007-2
 ** DEWITT/PIATT

TYPICAL DETAILS FOR CRACK SEALING FOR BITUMINOUS PAVEMENT

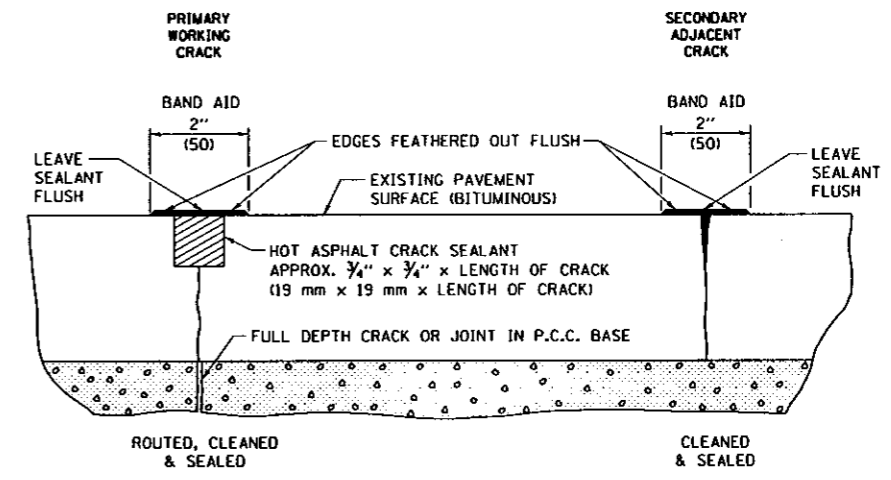

	NAME	DATE	REVISIONS	
			NAME	DATE
DESIGNED	SPRG.	04/90	K.A.G.	04/04
CHECKED	J.H.M.	05/90		
CADD NO.	X-2.05			

ALL DIMENSIONS ARE IN INCHES (MILLIMETERS)
 UNLESS OTHERWISE SHOWN.

F.A. RTE.	SECTION	COUNTY	TOTAL SHEETS	SHEET NO.
VAR.	*	**	27	24

* D5 CRACK & JOINT SEAL 2007-2
 ** DEWITT/PIATT

PAVEMENT MARKING AND MARKERS (RURAL AND URBAN APPLICATIONS)

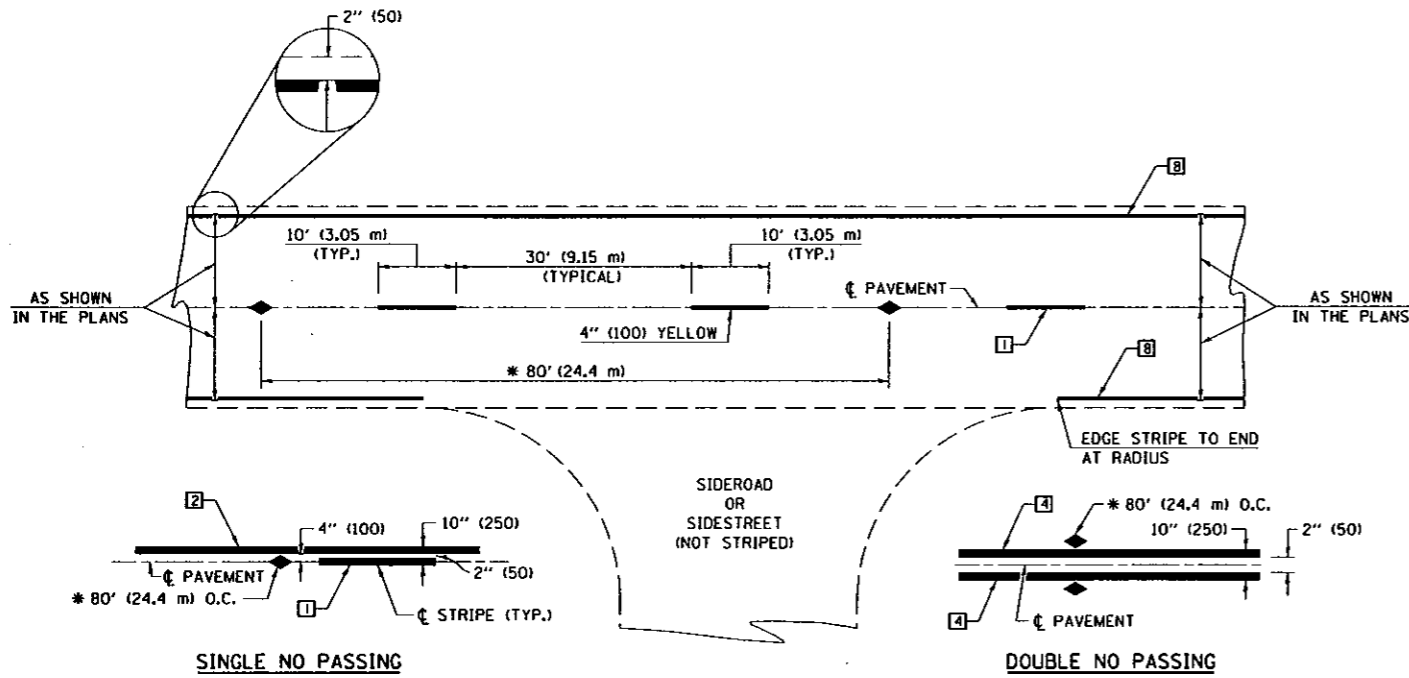

* REDUCE TO 40' (12.2 m) O.C. ON CURVES WITH POSTED OR ADVISORY SPEEDS OF 45 mph (70 km/h) OR LESS.

TWO LANE/TWO WAY

TYPICAL PAVEMENT MARKING LEGEND

- 1 4" (100) SKIP-DASH (YELLOW)
- 2 4" (100) SOLID (YELLOW)
- 3 12" (300) DIAGONAL (YELLOW)
- 4 4" (100) DOUBLE YELLOW (NARROW)
- 5 RESERVED
- 6 RESERVED
- 7 4" (100) SKIP-DASH (WHITE)
- 8 4" (100) SOLID (WHITE)
- 9 12" (300) DIAGONAL (WHITE)
- 10 6" (150) SOLID (WHITE)
- 11 24" (600) STOP BAR (WHITE)
- 12 8" (200) SOLID (WHITE)
- 13 4" (100) LANE LINE EXTENSIONS (WHITE)
- 14 4" (100) PARKING WHITE

TYPICAL PAVEMENT MARKERS LEGEND

- ◆ TWO-WAY AMBER MARKER
- ▶ ONE-WAY AMBER MARKER
- ▷ ONE-WAY CRYSTAL MARKER

RURAL LEFT TURN

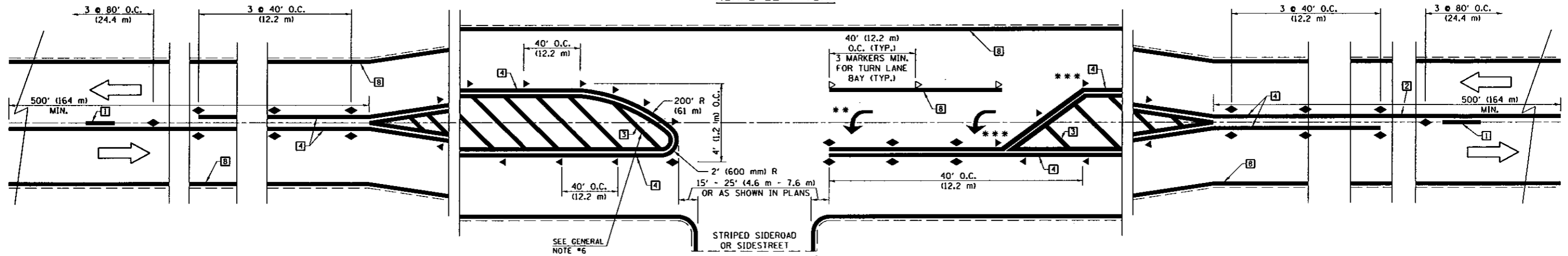

*** REDUCE SPACING IF NECESSARY TO ASSURE MARKERS AT CORNER POINTS.

** TURN ARROWS SHALL BE PLACED AS SHOWN ON SHEET *2.

ALL DIMENSIONS ARE IN INCHES (MILLIMETERS) UNLESS OTHERWISE SHOWN.

SHEET 1 OF 4

	NAME	DATE	REVISIONS		REVISIONS	
			NAME	DATE	NAME	DATE
DESIGNED	J.M.H.	5/85				
CHECKED	FUS	6/85	GEOMETRICS/K.A.G.	07/02	GEOMETRICS/K.A.G.	08/06
CADD NO.	7800XXXX		K.A.G.	09/05		

PLOT DATE: 11/15/2006
 FILE NAME: c:\projects\70564\70564.dwg
 USER: jh
 USER MARK: philip

F.A. R.T.E. VAR.	SECTION	COUNTY	TOTAL SHEETS	SHEET NO.
		**	27	25

* D5 CRACK & JOINT SEAL 2007-2
 ** DEWITT/PIATT

PAVEMENT MARKING AND MARKERS

(RURAL AND URBAN APPLICATIONS)

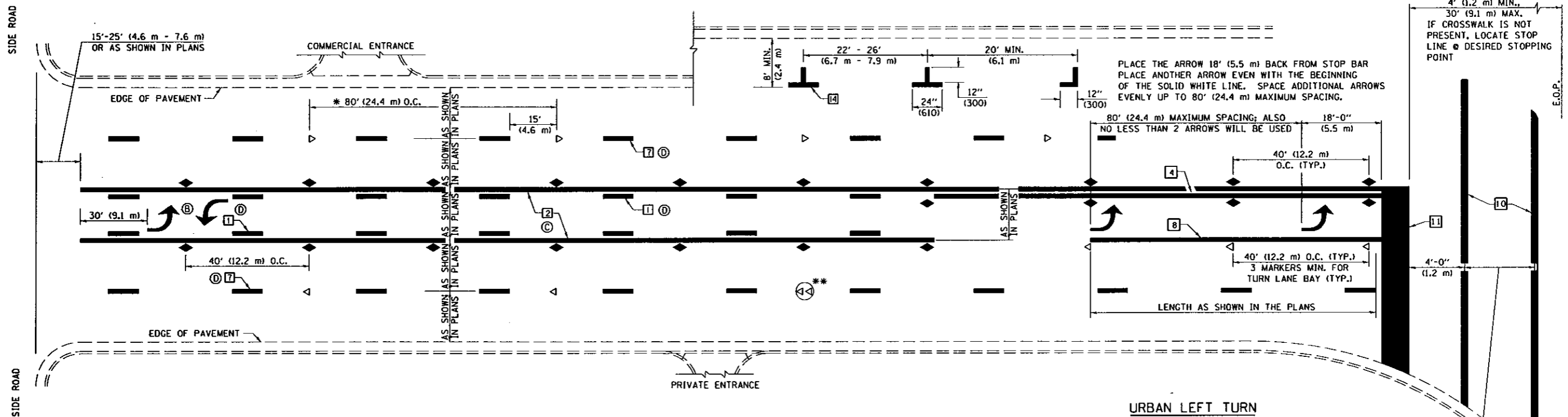

* REDUCE TO 40 FEET (12.2 METERS) ON CENTER ON CURVES WHERE ADVISORY SPEEDS ARE 10 MPH (15 km/h) LOWER THAN POSTED SPEEDS.

** DOUBLE LANE LINE MARKERS SHALL BE SPECIFIED AND SPACED AS SHOWN IN HIGHWAY STANDARD 781001 FOR MULTI-LANE DIVIDED AND UNDIVIDED HIGHWAYS.

(2 LANES TO 3 LANES OR 4 LANES TO 5 LANES)

NOTES:

- ⓑ TURN ARROW PAIRS SHALL BE PLACED AT 250' (75 m) INTERVALS AND SHALL BE EVENLY SPACED BETWEEN BOTH ENDS OF THE BIDIRECTIONAL LEFT TURN LANE.
- ⓒ THE SOLID YELLOW PAVEMENT MARKINGS ② SHOULD GENERALLY START OR END NEAR THE RADIUS POINT OF EACH STREET RETURN EXCEPT WHERE ONE OR BOTH ENDS WOULD INCLUDE STOP BARS.
- ⓓ THE SKIP-DASH PAVEMENT MARKINGS ① OR ⑦ SHOULD BE CENTERED BETWEEN BOTH ENDS OF EACH CITY BLOCK AND SHALL BE PLACED SO THEY LINE UP ACROSS FROM EACH OTHER. SEE EXAMPLE ON SHEET 2 OF 3.
- ⓔ TURN ARROW SIZE DEPENDS ON THE LOCATION. RURAL LOCATION - LARGE ARROW SIZE URBAN LOCATION - SMALL ARROW SIZE

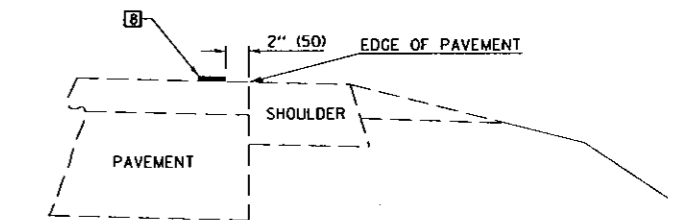
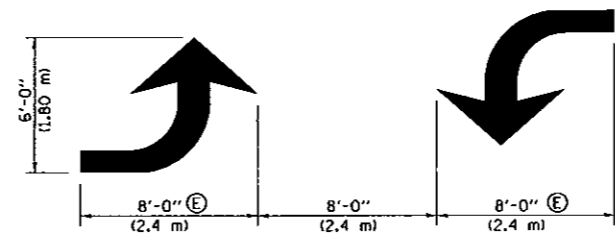
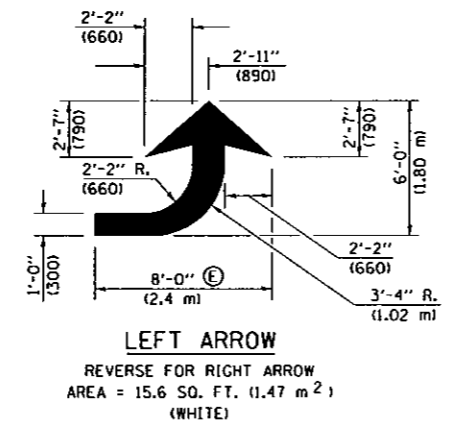
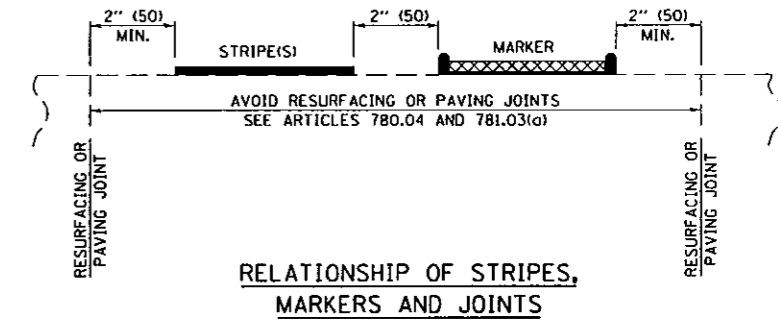
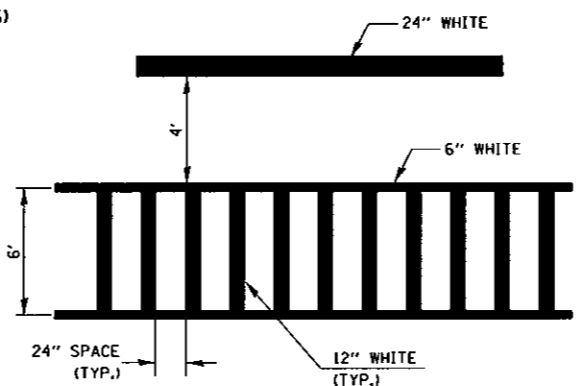

SHEET 2 OF 4

	NAME	DATE	REVISIONS	REVISIONS
DESIGNED	J.M.H.	5/85	NAME	DATE
CHECKED	FUS	6/85	GEOMETRICS/K.A.G.	07/02
CADD NO.	7800XXXX	6/88	GEOMETRICS/K.A.G.	08/06
			K.A.G.	09/05

ALL DIMENSIONS ARE IN INCHES (MILLIMETERS) UNLESS OTHERWISE SHOWN.

PLOT DATE: 11/15/2005
 FILE NAME: c:\pwork\70564\70564.dwg
 USER: jmh
 PLOTTER: HP DesignJet 500

F.A. RTE.	SECTION	COUNTY	TOTAL SHEETS	SHEET NO.
VAR.	*	**	27	26

* D5 CRACK & JOINT SEAL 2007-2
 ** DEWITT/PIATT

PAVEMENT MARKING AND MARKERS (RURAL AND URBAN APPLICATIONS)

GENERAL NOTES

1. WHEN MEDIANS ARE PRESENT, PAVEMENT MARKINGS ARE TO BE PLACED ADJACENT TO MEDIANS.
2. SOME OF THE INFORMATION INCLUDED WITH THIS DETAIL MAY NOT BE APPLICABLE TO THIS IMPROVEMENT.
3. PAVEMENT MARKINGS ARE TO BE EXTENDED THROUGH OMISSIONS WHEN APPLICABLE.
4. A STRIPING KEY IS AVAILABLE ELSEWHERE AND SHALL BE SHOWN WHERE THE QUANTITIES ARE LISTED.
5. FINAL PAVEMENT MARKINGS SHALL BE IN PLACE PRIOR TO PLACING ANY RAISED REFLECTIVE PAVEMENT MARKERS.
6. THE FOLLOWING CRITERIA SHALL BE USED FOR SELECTING THE DIAGONAL PAVEMENT MARKING SPACING:
 < 30 MPH USE 15' (< 50 km/h USE 4.5 m)
 30-45 MPH USE 20' (50-75 km/h USE 6.0 m)
 > 45 MPH USE 30' (> 75 km/h USE 9.0 m)

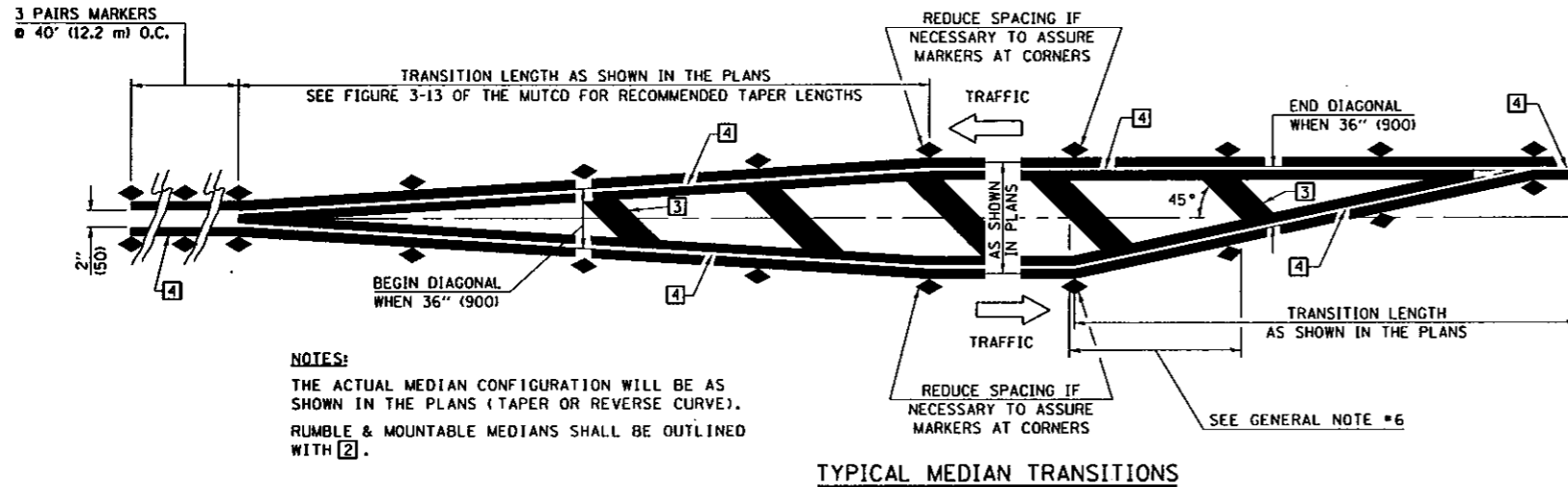

NOTES:
 THE ACTUAL MEDIAN CONFIGURATION WILL BE AS SHOWN IN THE PLANS (TAPER OR REVERSE CURVE).
 RUMBLE & MOUNTABLE MEDIANS SHALL BE OUTLINED WITH ②.

TYPICAL MEDIAN TRANSITIONS

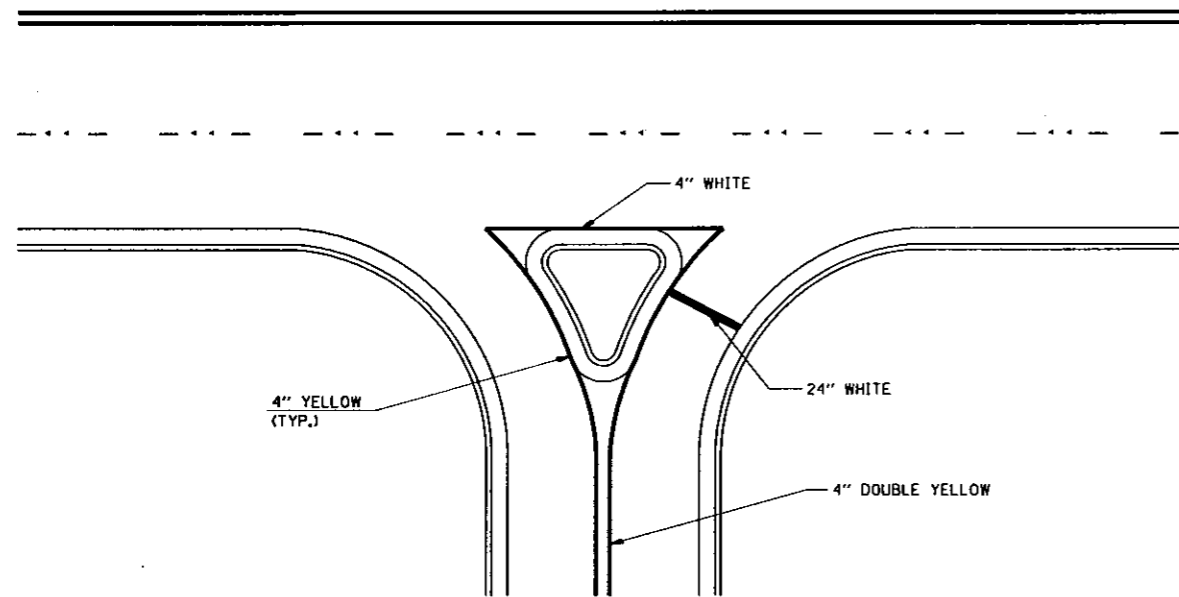

RIGHT IN - RIGHT OUT ACCESS

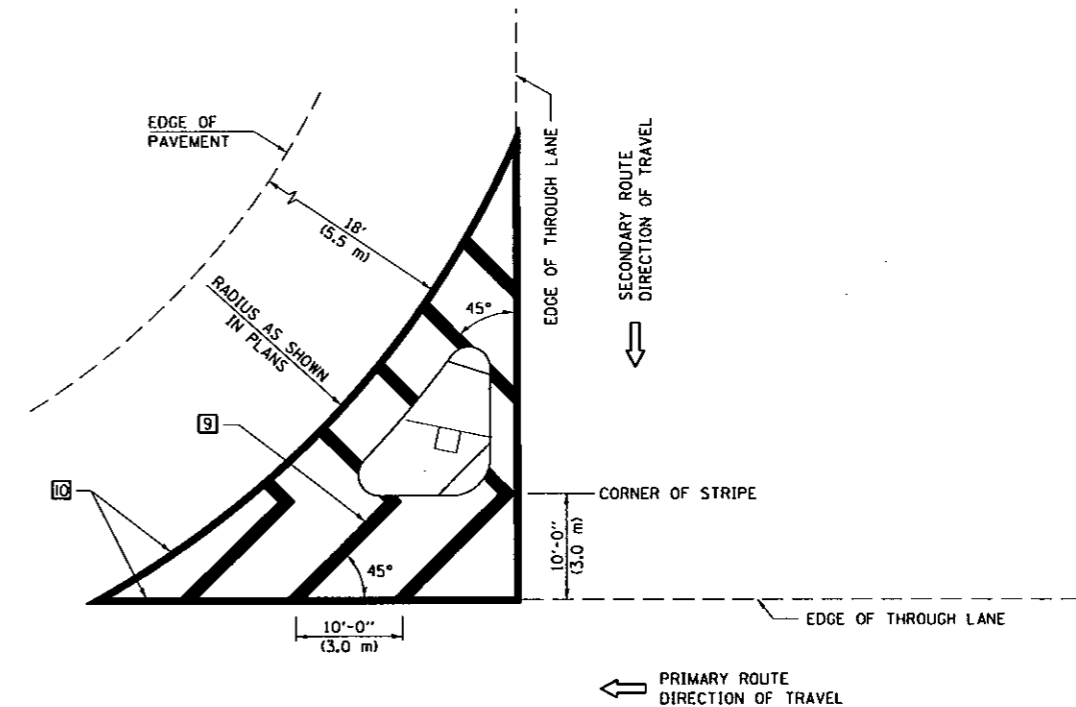

ISLAND

SHEET 3 OF 4

	NAME	DATE	REVISIONS		REVISIONS	
			NAME	DATE	NAME	DATE
DESIGNED	J.M.H.	5/85				
CHECKED	FWS	5/85	GEOMETRICS/K.A.G.	07/02	GEOMETRICS/K.A.G.	08/06
CADD NO.	7800XXXX		K.A.G.	09/05		

ALL DIMENSIONS ARE IN INCHES (MILLIMETERS) UNLESS OTHERWISE SHOWN.

PLOT DATE: 11/25/2008
 FILE NAME: s:\projects\080708\080708.dwg
 PLOT SCALE: 1/8" = 1'-0"
 USER NAME: philipj

F.A. RTE.	SECTION	COUNTY	TOTAL SHEETS	SHEET NO.
VAR.	*	**	27	27

* D5 CRACK & JOINT SEAL 2007-2
 ** DEWITT/PIATT

PAVEMENT MARKING AND MARKERS (RURAL AND URBAN APPLICATIONS)

RAILROAD CROSSING WITH INTERCONNECT ONLY

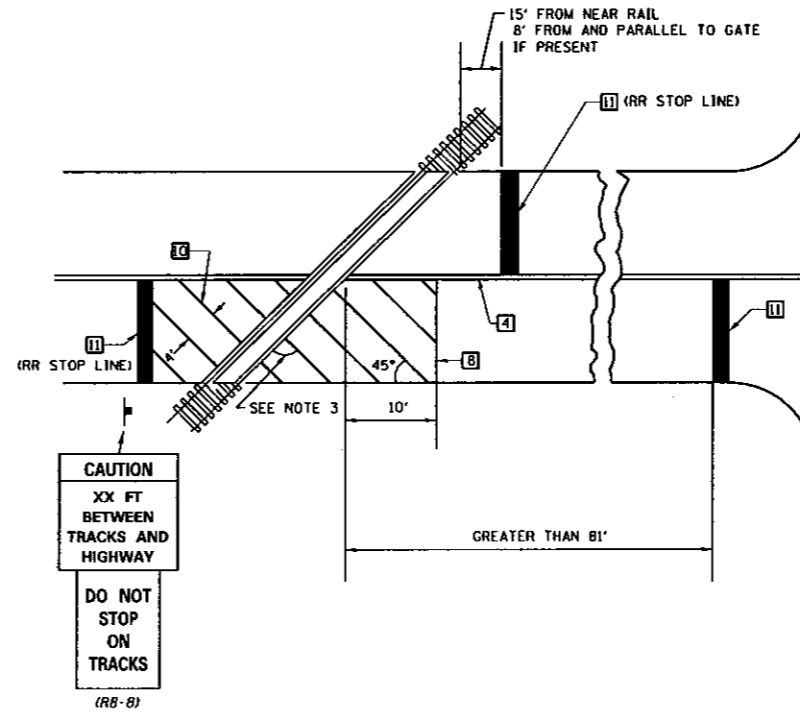

RAILROAD CROSSING WITH INTERCONNECT AND PRE-SIGNALS

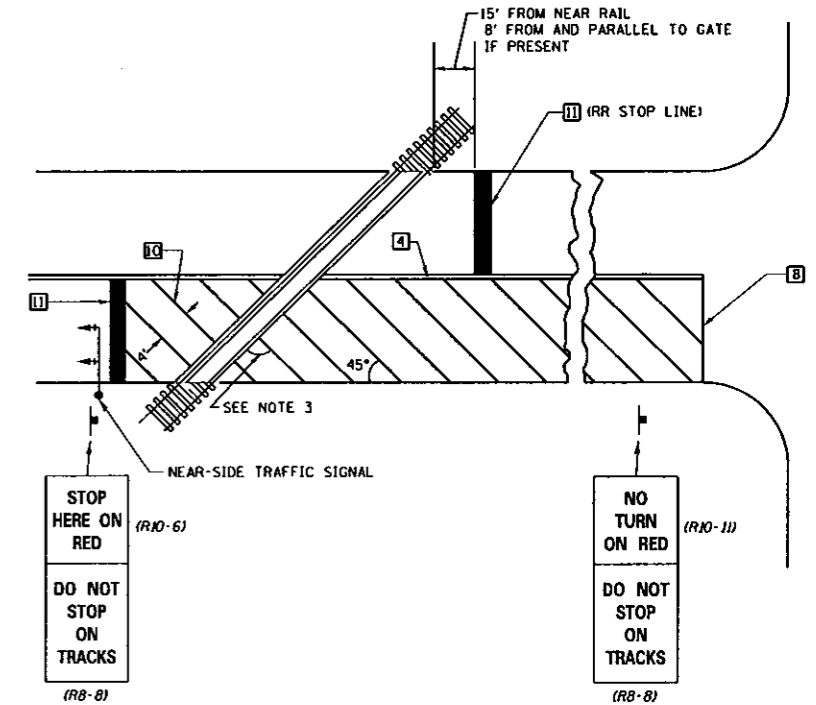

SUPPLEMENTAL PAVEMENT MARKING TREATMENT FOR RAILROAD-HIGHWAY GRADE CROSSING

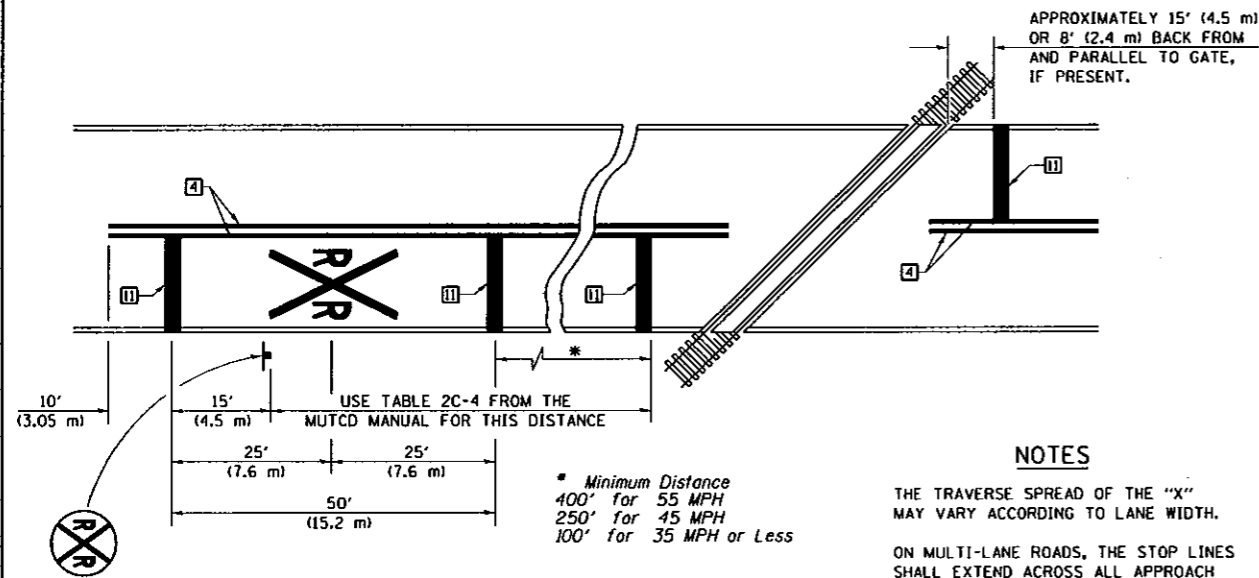

PAVEMENT MARKINGS AT RAILROAD-HIGHWAY GRADE CROSSING

NOTES

THE TRAVERSE SPREAD OF THE "X" MAY VARY ACCORDING TO LANE WIDTH.

ON MULTI-LANE ROADS, THE STOP LINES SHALL EXTEND ACROSS ALL APPROACH LINES AND SEPARATE R X R SYMBOLS SHALL BE PLACED ADJACENT TO EACH OTHER IN EACH LANE.

WHEN THE PAVEMENT MARKING SYMBOL IS USED, A PORTION OF THE SYMBOL SHOULD BE LOCATED DIRECTLY ADJACENT TO THE ADVANCE WARNING SIGN (W10-1) AS PLACED BY TABLE II-1, CONDITION B OF THE MUTCD.

NOTES

SUPPLEMENTAL PAVEMENT MARKINGS TO BE INSTALLED ONLY ON APPROACHES TO INTERSECTIONS CONTROLLED BY TRAFFIC SIGNALS WHICH ARE INTERCONNECTED WITH THE RAILROAD WARNING SIGNALS.

EXTEND PAVEMENT MARKINGS TO THE INTERSECTION ONLY WHERE NEAR-SIDE TRAFFIC SIGNALS ARE USED.

WHERE THE ANGLE BETWEEN THE DIAGONAL PAVEMENT MARKINGS AND THE TRACK WOULD BE LESS THAN 20°, THE PAVEMENT MARKINGS SHOULD BE PLACED IN THE OPPOSITE DIRECTION FROM THAT SHOWN.

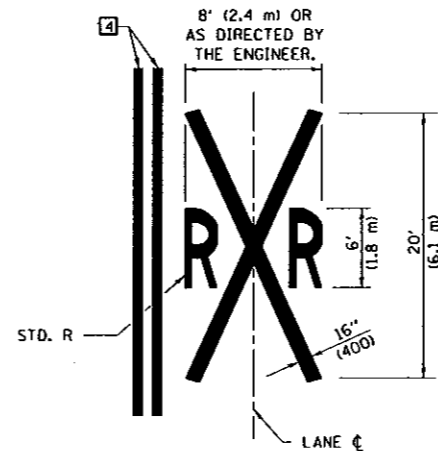

ALL DIMENSIONS ARE IN INCHES (MILLIMETERS) UNLESS OTHERWISE SHOWN.

SHEET 4 OF 4

	NAME	DATE	REVISIONS	REVISIONS
	NAME	DATE	NAME	DATE
DESIGNED	J.M.H.	5/85		
CHECKED	FMS	6/85	GEOMETRICS/K.A.G.	07/02
CADD NO.	7800XXXX		K.A.G.	09/05

PLOT DATE: 11/15/2006
 FILE NAME: s:\projects\70564\70564.dwg
 PLOT SCALE: 1/8" = 1'-0"
 USER: phillips