

Existing Structure: Weigh Stations at CarLock were originally built in 1966 as F.A.I. Route 74, Section 57-18WS-1 McLean County. The existing concrete deck and upper 1'-0" of concrete pit perimeter are to be removed and replaced. Traffic will be detoured.

STATE OF ILLINOIS  
DEPARTMENT OF TRANSPORTATION

ROUTE NO.	SECTION	COUNTY	SHEET NO.	SHEET TOTAL	SHEET NO. 1
F.A.I. 74	57-18 WS-2	McLean	26	14	7 SHEETS
FED. ROAD DIST. NO. 7	ILLINOIS	FED. AID PROJECT-			

Contract #70569

INDEX OF SHEETS

1. General Data
- 2-3. General Plan & Elevation
4. Concrete Removal Details
5. Concrete Deck Details
- 6-7. Concrete Pit Details

SCOPE OF WORK

1. Remove and replace concrete decks of the 4 platform scales.
2. Clean and paint structural steel.
3. Remove and replace the top 1'-0" of the concrete pit on the perimeter of the 4 platform scales.
4. Remove, reinstall and recalibrate existing load cells. See Special Provision.

LOADING HS20-44

No Future wearing surface allowed

DESIGN SPECIFICATIONS

1996 AASHTO w/ 1997 thru 2002 Interims

DESIGN STRESSES

NEW CONSTRUCTION

- $f'_c = 3,500$  psi (Deck and Pit)  
 $f_y = 60,000$  psi (Reinforcement)  
 $f_s = 36,000$  psi (Structural Steel AASHTO M270 Grade 36)

FIELD UNITS

- $f_c = 1,000$  psi (Pit)  
 $f_s = 20,000$  psi (Reinforcement)  
 $f_s = 20,000$  psi (Structural Steel)

GENERAL NOTES

Reinforcement bars shall conform to the requirements of ASTM A 706 Gr. 60 (IL Modified). See Special Provisions.  
 Plan dimensions and details relative to existing plans are subject to routine variations. The Contractor shall field verify existing dimensions and details affecting new construction and make necessary approved adjustments prior to construction or ordering of materials. Such variations shall not be cause for additional compensation for a change in scope of the work, however, the Contractor will be paid for the quantity actually furnished based upon the unit price bid for the work.  
 Reinforcement bars designated (E) shall be epoxy coated.  
 The existing structural steel coating contains lead. The Contractor shall take appropriate precautions to deal with the presence of lead on this project.  
 The cost of any structure excavation shall be included with Concrete Removal. Cleaning and painting of the existing structural steel shall be as specified in the special provision for "Cleaning and Painting Existing Steel Structures". All existing steel shall be cleaned per Near White Blast Cleaning-SSPC-SPI10. All existing steel shall be painted according to the requirements of Paint System 1-OZ/E/U. The color of the final finish coat shall be Gray, Munsell No 5B 7/1.  
 The SSPC-QP1 and SSPC-QP2 Painting Contractor Certifications will not be required for these Weigh Stations.  
 No field welding is permitted except as specified in the contract documents.  
 Prior to pouring the new concrete deck, all heavy or loose rust, loose mill scale, and other loose or potentially detrimental foreign material shall be removed from the surfaces in contact with concrete. Tightly adhered paint may remain unless otherwise noted. Removal shall be accomplished by methods that will not damage the steel and the cost will be included in the pay item covering removal of the existing concrete.  
 As directed by the Engineer, existing construction accessories welded to the top flange of beams and girders shall be removed. The weld areas shall be ground flush and inspected for cracks using magnetic particle testing (MT) or dye penetrant testing (PT) by an individual acceptable to the Engineer. Any cracks that can not be removed by grinding 1/4 in. deep shall be identified and reported to the Bureau of Bridges and Structures for further disposition. The cost of removing welded accessories, grinding and inspecting weld areas and grinding cracks will be paid for according to Article 109.04 of the Standard Specifications.  
 The Contractor shall line the concrete surface of the platforms according to Article 420.09(e)(1) of the Standard Specifications. Cost included in Concrete Superstructure.

TOTAL BILL OF MATERIAL

ITEM	UNIT	SUPER	SUB	TOTAL
Concrete Superstructure	Cu. Yd.	30.0		30.0
Removal of Existing Concrete Deck	L. Sum	1		1
Reinforcement Bars, Epoxy Coated	Pound	10730		10730
Concrete Removal	Cu. Yd.		15.4	15.4
Protective Coat	Sq. Yd.	222		222
Furnishing and Erecting Structural Steel	Pound	7700		7700
Concrete Structures	Cu. Yd.		15.4	15.4
Reinforcement Bars	Pound		2060	2060
Cleaning and Painting Steel Bridge	L. Sum			1
Containment and Disposal of Lead Paint Cleaning Residues	L. Sum			1
Jack, Remove and Replace Load Cells	L. Sum			1

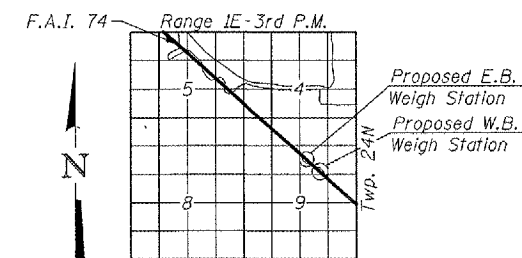

LOCATION SKETCH

GENERAL DATA  
**CARLOCK WEIGH STATIONS**  
**F.A.I. ROUTE 74 SECT. 57-18WS-2**  
**McLEAN COUNTY**  
**STA. 1680+00.00 (WB) &**  
**STA. 1666+50.00 (EB)**

DESIGNED *Stephan M. Papp*  
 CHECKED *Fesseln Teklelem*  
 DRAWN *R. Sommer*  
 CHECKED *SMR/FT*

EXAMINED *Thomas J. Smayda*  
 PASSED *Ralph E. Adams*  
 January 18, 2007  
 ENGINEER OF BRIDGE DESIGN  
 ENGINEER OF BRIDGES AND STRUCTURES



EXPIRES 11-30-2008