

F.A.P. RTE.	SECTION	COUNTY	TOTAL SHEETS	SHEET NO.
322	*	DEWITT	35	16
STA.		TO STA.		
FED. ROAD DIST. NO.	ILLINOIS	FED. AID PROJECT		

* (52BR-1 & 53R-B)BJR

SHEET 4 OF 7

JOINT REPAIR AT NORTH ABUTMENT

S.N. 020-0053

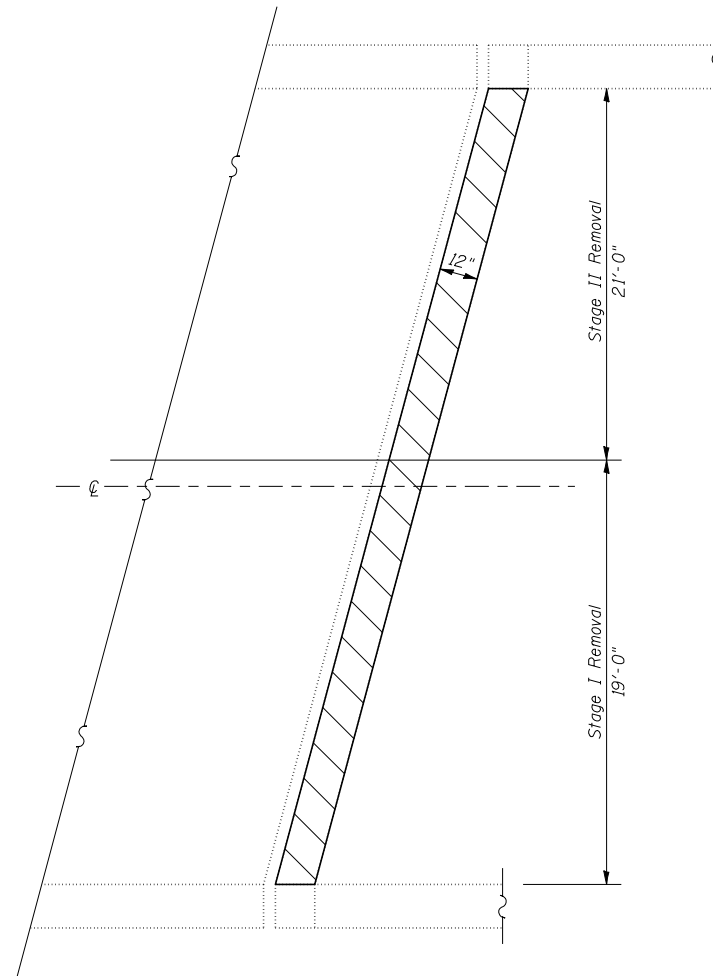

EXISTING PARTIAL PLAN
Joint at North Abutment

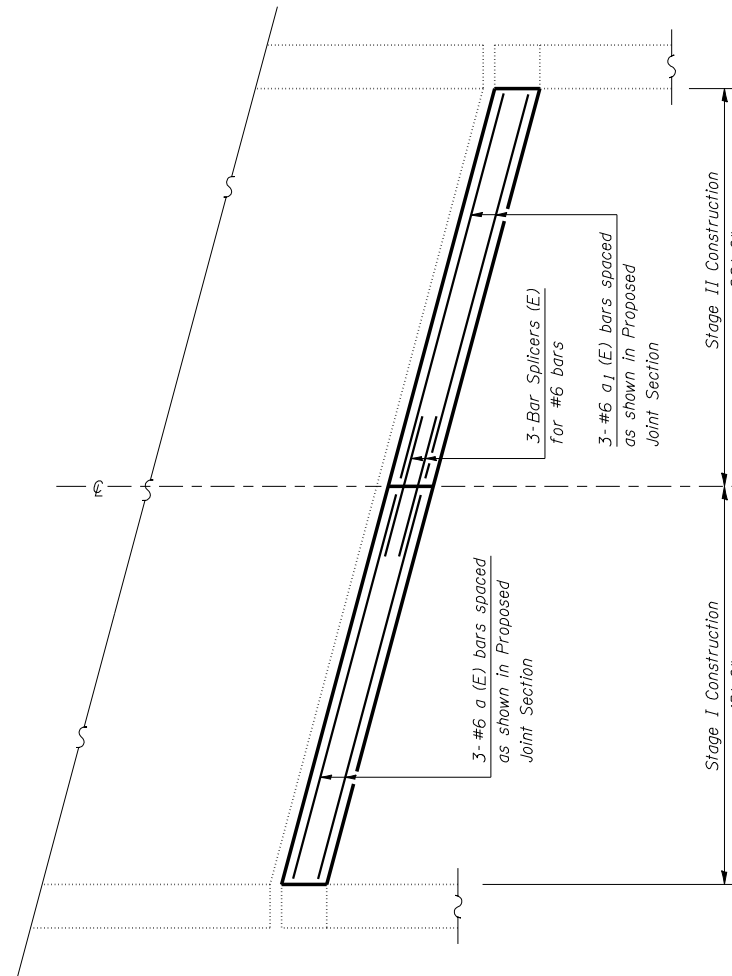

PROPOSED PARTIAL PLAN
Joint at North Abutment

Concrete Removal

BAR LIST

Bar	No.	Size	Length	Shape
a (E)	3	#6	18'-10"	—
a1 (E)	3	#6	23'-2"	—

Reinforcement bars designated (E) shall be epoxy coated.

Hatched areas indicates Concrete Removal.

See Sheet 5 of 7 for Proposed Joint Section.

PLOT DATE : 12/21/2006
 FILE NAME : c:\projects\0510206 (v81)70593b-edgeset.dwg
 PLOT SCALE : 42,352% / IN.
 USER NAME : creig

ILLINOIS DEPARTMENT OF TRANSPORTATION
JOINT REPAIR AT NORTH ABUTMENT
 F.A.P. ROUTE 322
 SECTION (52BR-1 & 53R-B)BJR
 DEWITT COUNTY
 S.N. 020-0053
 SCALE: NA
 DATE: 11/06/06
 DRAWN BY: JRP
 CHECKED BY: