

| FAU ROUTE | SECTION | COUNTY   | TOTAL SHEETS | SHEET NO. |
|-----------|---------|----------|--------------|-----------|
| FAI 72    | *       | SANGAMON | 559          | 1         |
|           |         |          | + 5          | + total   |
|           |         |          | 564          | pgs       |

D-96-536-02



LOCATION OF SECTION INDICATED THUS: [Symbol]

APPROVED 12/21/06 *Timothy J. Dahlen* MAYOR

APPROVED 12/21/06 *Shirley J. Huber for City Engineer* CITY ENGINEER

APPROVED Dec 21 2006 *Christy M. Reed* DEPUTY DIRECTOR OF HIGHWAYS, REGION FOUR ENGINEER

APPROVED February 2, 2007 *Eric E. Horn* ENGINEER OF DESIGN AND ENVIRONMENT

APPROVED February 2, 2007 *Milton R. See, P.E.* DIRECTOR, DIVISION OF HIGHWAYS



39072 REGISTERED PROFESSIONAL ENGINEER OF ILLINOIS

*James W. Hill*

SIGNATURE: [Signature]

DATE SIGNED: 12-21-06

LISC. EXP. DATE: 11-30-07

STATE OF ILLINOIS  
DEPARTMENT OF TRANSPORTATION  
DIVISION OF HIGHWAYS

**GRADING & STRUCTURES  
PROPOSED HIGHWAY PLANS**

FAU ROUTE 8071 (MACARTHUR BLVD) AND FAI ROUTE 72 (I-72)  
SECTION (84-9-4)A,HBK,BY,BY-1

NOTE: WHEREVER IN THESE PLANS REFERENCE IS MADE TO SECTION (84-9-4)A,HBK,BY,BY-1 & 02-00382-02-PV IT SHALL MEAN SECTION (84-9-4)A,HBK,BY,BY-1.

TYPE OF IMPROVEMENT: NEW CONSTRUCTION  
SANGAMON COUNTY  
C-96-523-04

**UTILITY NOTE**

THE LOCATIONS OF THOSE BURIED AND ABOVEGROUND UTILITIES SHOWN ARE APPROXIMATE, ARE SHOWN FOR CONTRACTOR INFORMATIONAL USE ONLY, AND ARE NOT TO BE REFERENCED FOR CONSTRUCTION PURPOSES. THE IMPLIED PRESENCE OR ABSENCE OF UTILITIES IS NOT TO BE CONSTRUED BY THE OWNER, ENGINEER, CONTRACTOR, OR SUBCONTRACTORS TO BE AN ACCURATE AND COMPLETE REPRESENTATION OF UTILITIES THAT MAY OR MAY NOT EXIST ON THE CONSTRUCTION SITE. BURIED AND ABOVEGROUND UTILITY LOCATION, IDENTIFICATION, AND MARKING ARE THE SOLE RESPONSIBILITY OF THE CONTRACTOR. REROUTING, DISCONNECTION, PROTECTION, ETC. OF ANY UTILITIES MUST BE COORDINATED BETWEEN THE CONTRACTOR, UTILITY COMPANY, AND OWNER. SITE SAFETY, INCLUDING THE AVOIDANCE OF HAZARDS ASSOCIATED WITH BURIED AND ABOVEGROUND UTILITIES, REMAIN THE SOLE RESPONSIBILITY OF THE CONTRACTOR.

J.U.L.I.E.  
JOINT UTILITY LOCATION INFORMATION FOR EXCAVATION  
1-800-892-0123

FOR INDEX OF SHEETS, SEE SHEET NO. 2  
FOR LIST OF STANDARDS, SEE SHEET NO. 2

SECTION (84-9-4)HBK,BY,BY-1 INCLUDES:

- CONSTRUCTION OF SN 084-0513 (2 SPAN, 228.00' BK-BK ABUT) TO CARRY MACARTHUR BLVD OVER I-72
- CONSTRUCTION OF SN 084-0514 (4 SPAN, 316.34' BK-BK ABUT) TO CARRY RAMP B (EB ON RAMP) OVER UNION PACIFIC RAILROAD
- CONSTRUCTION OF SN 084-0516 (4 SPAN, 229.11' BK-BK ABUT) TO CARRY RAMP C (WB OFF RAMP) OVER UNION PACIFIC RAILROAD
- REHABILITATION OF SN 084-0075 WB (4 SPAN, 233.08' BK-BK ABUT) AND SN 084-0074 EB (4 SPAN, 241.21' BK-BK ABUT) CARRYING I-72 OVER UNION PACIFIC RAILROAD

SECTION 02-00382-02-PV INCLUDES

- CONSTRUCTION OF SN 084-0512 (3 SPAN, 230.00 BK-BK ABUT) TO CARRY MACARTHUR BLVD OVER NORFOLK SOUTHERN RAILWAY.
- CONSTRUCTION OF SN 084-7008 (3 SPAN, 231.00 BK-BK ABUT) TO CARRY INTERURBAN TRAIL OVER NORFOLK SOUTHERN RAILWAY.
- CONSTRUCTION OF SN 084-7009 (144'-0" OUT-OUT HEADWALLS) TO CARRY MACARTHUR BLVD OVER INTERURBAN TRAIL

SECTION (84-9-4)A,HBK,BY,BY-1

I-72 = 1.053 MILES  
MACARTHUR = .533 MILES  
NET LENGTH = 1.586 MILES

SECTION 02-00382-02-PV

GROSS LENGTH = 1.481 MILES  
NET LENGTH = 1.481 MILES

CONTRACT # 72541

IDOT DISTRICT 6  
PROJECT ENGINEER - SAL MADONIA, 217-782-4761  
STUDY TEAM ENGINEER -

12/21/2006  
LAYOUT  
DRAWN  
CHECKED

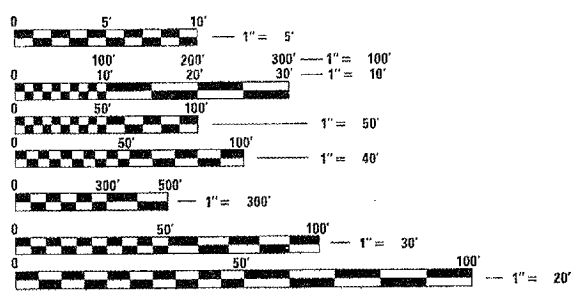

FULL SIZE PLANS HAVE BEEN PREPARED USING STANDARD ENGINEERING SCALES. REDUCED SIZED PLANS WILL NOT CONFORM TO STANDARD SCALES. IN MAKING MEASUREMENTS ON REDUCED PLANS, THE ABOVE SCALES MAY BE USED.

BEGIN SECTION (84-9-4) HBK,BY,BY-1  
STA 569+89.06 @ I-72

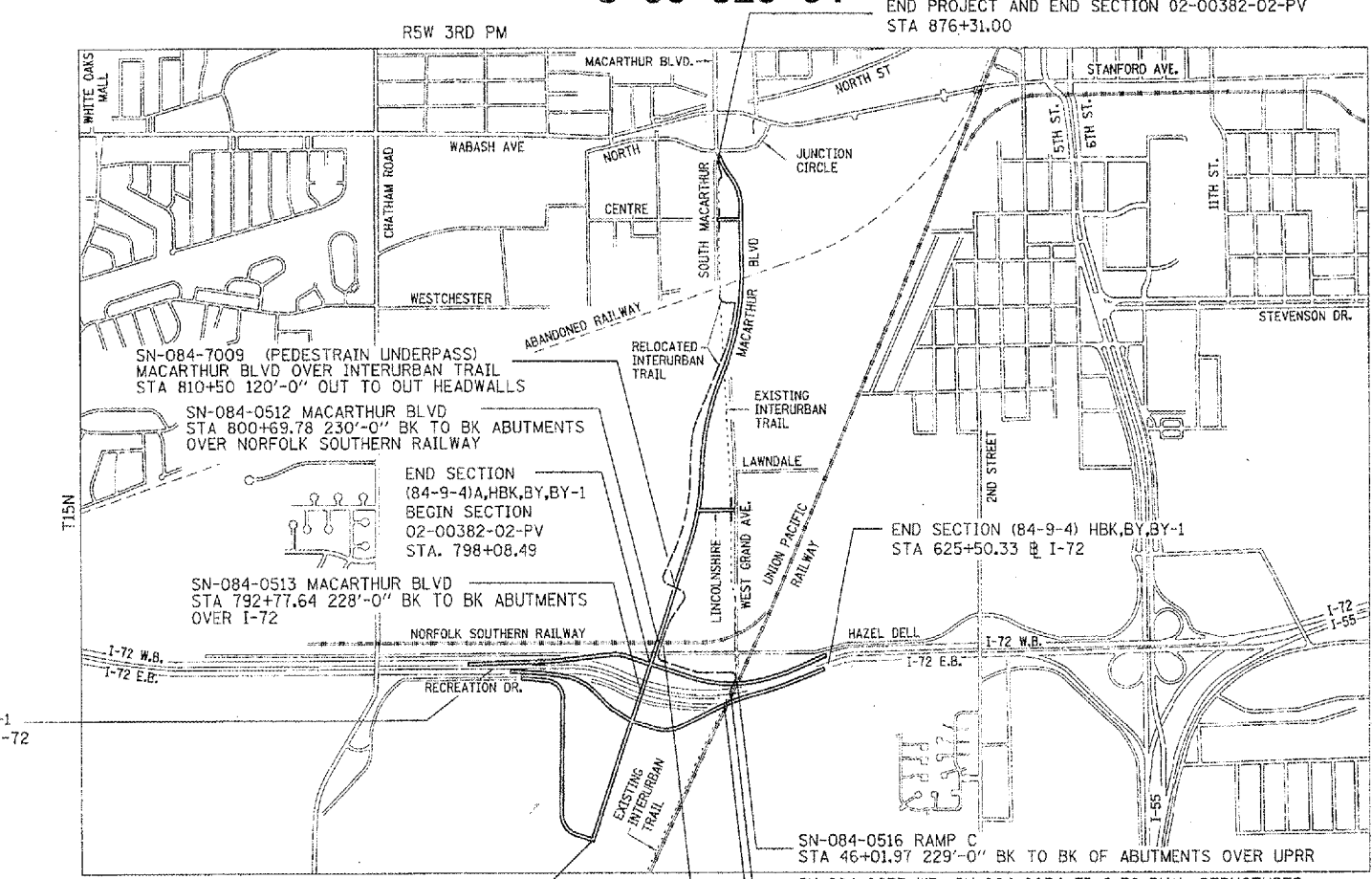

BEGIN PROJECT AND BEGIN SECTION (84-9-4)A,HBK,BY,BY-1  
STA 769+93.00

SN-084-7008 INTERURBAN TRAIL  
STA 26+02.50 231'-0" BK TO BK OF ABUTMENTS OVER NSRR

SN-084-0516 RAMP C  
STA 46+01.97 229'-0" BK TO BK OF ABUTMENTS OVER UPRR

SN-084-0075 WB, SN-084-0074 EB I-72 DUAL STRUCTURES  
STA 608+51.98 237'-0 1/2" BK TO BK OF ABUTMENTS OVER UPRR

SN-084-0514 RAMP B  
STA 33+95.61 316'-0" BK TO BK OF ABUTMENTS OVER UPRR

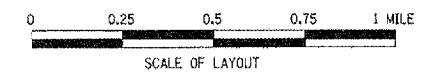

DESIGN DESIGNATION:  
FAI ROUTE 72 - INTERSTATE, ADT 2003 (2023)= 31,000 (46,100)  
FAU ROUTE 8071 SOUTH OF I-72 - MINOR ARTERIAL  
FAU ROUTE 8071 NORTH OF I-72 - OTHER PRINCIPAL ARTERIAL  
ADT 2023 = 26,600

DESIGN SPEED:  
I-72 70 MPH  
RAMPS 50 MPH TO 30 MPH (SEE SUPERELEVATION TRANSITION DETAILS)  
MACARTHUR 45 MPH BACK OF STA 852+50  
40 MPH AHEAD OF STA 852+50

PRINTED BY THE AUTHORITY OF THE STATE OF ILLINOIS